

KINGSMEN (THAMES) INC. / Havelock Corners (Kingsmen)

Lot/Unit: 213 Block 156    Phase/Building: 5B    Model/Floor Plan: William (2603) Elev B2 Opt  
3 Bed - 3+1 Bath

ELECTRICAL

Inv.6074	1 - To supply & install the standard T.V. rough in in the great room and master bedroom... see sketch # 1 & # 2	
Line 77325	Note:	
24Feb23 / 27Feb23		
Inv.6074	1 - To supply & install the standard Phone ( CAT5 ) rough in in the great room, master bedroom and Bedroom # 2 ... see sketch # 1 & # 2	
Line 77326	Note:	
24Feb23 / 27Feb23		

HEATING AND AIR CONDITIONING

Inv.6074	1 - As per schedule "PE": Vendor to install capped gas line ( Rough in only ) at rear of home for future BBQ location. Location to be finalized at vendors sole discretion	
Line 77323	Note:	
24Feb23 / 27Feb23		
Inv.6074	1 - As per schedule "PE": Vendor to supply & install air conditioning unit, sized accordingly, from vendors standard samples.	
Line 77324	Note:	
24Feb23 / 27Feb23		

EXTRAS AS PER OFFER

5 FREE APPLIANCES ? STAINLESS STEEL FRONT - FRIDGE: STOVE AND DISHWASHER. WHITE WASHER AND DRYER (SUPPLIED ONLY, NOT INSTALLED, FROM BUILDERS STANDARD LINE). AN APPLIANCES VOUCHER WILL BE GIVEN BY OUR DECOR CONSULTANT AT THE TIME OF BOOKING YOUR COLOUR A Worksheet    Note:	
5 FREE APPLIANCES – STAINLESS STEEL FRONT - FRIDGE; STOVE AND DISHWASHER. WHITE WASHER AND DRYER (SUPPLIED ONLY, NOT INSTALLED, FROM BUILDERS STANDARD LINE). AN APPLIANCES VOUCHER WILL BE GIVEN BY OUR DECOR CONSULTANT AT THE TIME OF BOOKING YOUR COLOUR A Worksheet    Note:	
VENDOR TO INSTALL CAPPED GAS LINE (ROUGH-IN ONLY) AT REAR OF HOME FOR FUTURE BBQ LOCATION. LOCATION TO BE FINALIZED AT VENDORS SOLE DISCRETION. Worksheet    Note:	
VENDOR TO SUPPLY & INSTALL AIR CONDITIONING UNIT, SIZED ACCORDINGLY, FROM VENDORS STANDARD SAMPLES. Worksheet    Note:	

MAR 03 2023

Purchasers:

HITESHKUMAR,J LAD, & TUSHARKUMAR,P P

Property: 213 Block 156 of Plan - Draft Approval SB

Telephone Res. / Bus: /

Project: KINGSMEN (THAMES) INC.

Decor Advisor: Barbara Coccia

Model and Elevation: William (2603) Elev B2 Opt 3 Bed - 3+1 Ba

Layout Changes: ☐ Yes ☒ No

Sketch Attached: ☒ Yes ☐ No

Exterior Colour Scheme:

1. Cabinetry	Style and Colour	Counter Top	Hardware
Kitchen / Breakfast	# 3 Charleston 3DL Moonlight	#1, C/S # 9141 Ice Snow 3cm.	# 135 Knob
Kitchen Island	# 3 Charleston 3DL Moonlight	#1, C/S # 9141 Ice Snow 3cm.	# 135 Knob
Laundry Room	/		
Powder Room	# 3 Charleston 3DL Moonlight	# 4925K-07 Calcutta Marble	# 135 Knob
Main Bathroom	# 3 Charleston 3DL Orchid	#4926K-07 Black Alicante	# 135 Knob
Master Ensuite Bathroom	# 3 Charleston 3DL Orchid	#4926K-07 Black Alicante	# 135 Knob
Second Ensuite Bathroom (If Applicable)	# 3 Charleston 3DL Orchid	#4926K-07 Black Alicante	# 135 Knob
	/		
	/		

Appliances

Custom Size Fridge

☐ Yes ☒ No

Valance Lighting

☐ Yes ☒ No

Microwave / Range Hood

☐ Yes ☒ No

Cooktop / Rangetop

☐ Yes ☒ No

Built in Wall Oven

☐ Yes ☒ No

Slide-in Range

☐ Yes ☒ No

Comment

/

2. Flooring	Selection
Foyer	13 x13" Malena Ice
Main Hall	3 1/2" Elements oak Natural
Back Hall	/
Breakfast	13 x13" Malena Ice
Laundry Room	13 x13" Malena Carbon
Kitchen	13 x13" Malena Ice
Powder Room	( & small hallway infront of powder room ) 13 x13" Malena Ice
Main Bathroom	13 x13" Malena Carbon
Master Ensuite	13 x13" Malena Carbon
Bathroom (If Applicable)	ENSUITE #2: 13 x13" Malena Carbon
Mud Room	13 x13" Malena Ice
Master & Ens. 2's	Shower floor: 2x2" Ontario Snow White Matte
Living Room	/
Dining Room	3 1/2" Elements oak Natural
Family / Great Room	3 1/2" Elements oak Natural
Den / Library / Study	/
Basement Landing (If Applies)	
Lower Landing (If Applicable)	3 1/2" Elements oak Natural
Upper Landing	( If applicable ) 3 1/2" Elements oak Natural
Upper Hall	Modern Story 1, # 927 Morning Rain
Master Bedroom	Modern Story 1, # 927 Morning Rain
Bedroom #2	Modern Story 1, # 927 Morning Rain
Bedroom #3	Modern Story 1, # 927 Morning Rain
Bedroom #4	/
Bedroom #5	/
Master & Ens. 2's	Shower jamb: Anatolia Marmilne SNOW

SEE ATTACHED FOR SIGNATURES

MAR 03 2023

Purchasers: HITESHKUMAR, J LAD, & TUSHARKUMAR, P P Property: 213 Block 156 of Plan - Draft Approval SB
Telephone Res. / Bus: / Project: KINGSMEN (THAMES) INC.
Decor Advisor: Barbara Coccia Model and Elevation: William (2603) Elev B2 Opt 3 Bed - 3+1 Ba
2. Flooring - Continued -

Upgrade Underpad Type Area
Standard 2nd. Floor
Carpet on Stairs Capped Runner - \*Upgrade
Comment /

3. Plumbing Fixtures / Faucets

Kitchen Standard Second Ensuite Standard Powder Room Standard
Master Ensuite Standard Other Room /
Main Bathroom Standard /

Comment
Still to install the standard top mount kitchen sink.

4. Wall Tile

Tile Selection Listello Insert Insert Selection
Main Bathroom 8x10" Malena Ice
Master Ensuite
Tub Deck 13 x13" Malena Carbon
Tub Apron 13 x13" Malena Carbon
Tub Surround 13 x13" Malena Carbon
Shower Stall 8x10" Malena Ice
Second Ensuite 8x10" Malena Ice
Kitchen Backsplash
Complete Backsplash

Comment

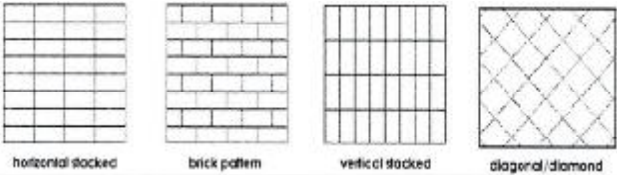

5. Fireplace

Living Room Family Room Other Room - Specify Great Room
Purchased As Per Plan N/A Purchased As Per Plan N/A Purchased As Per Plan N/A
Fireplace Type
Mantle Type
Over Mantle
Colour / Stain
Surround
Hearth
Comment

SEE ATTACHED FOR SIGNATURES

Handwritten initials and red circles.

Initial:



MAR 03 2023

Purchasers: HITESHKUMAR, J LAD, & TUSHARKUMAR, P P  
Telephone Res. / Bus: /  
Decor Advisor: Barbara Coccia  
Property: 213 Block 156 of Plan - Draft Approval SB  
Project: KINGSMEN (THAMES) INC.  
Model and Elevation: William (2603) Elev B2 Opt 3 Bed - 3+1 Ba

## 6. Trim Carpentry

Door Hardware Standard Handle

Interior Trim Standard

Comment

/

## Interior Doors

☐ 2 Panel Arch Top☒ 2 Panel Square Top☐ 6 Panel

Initial for Door Style

K

## 7. Railings and Pickets

Railing Package Standard Oak TURNED picket package

Railing Colour Elements Natural

Wood Stairs ☐ No ☒ Oak

Picket Colour Elements Natural

Tread Colour Elements Natural

Comment

/

SEE ATTACHED FOR SIGNATURES

## 8. Plaster Mouldings and Medallions

Foyer /

Main Hall /

Living Room /

Dining Room /

Family Room /

Kitchen/Breakfast /

Den/Library /

Lower Landing /

Comment

/

## 9. Wall Paint

Kingsmen White

Smooth Ceilings ☐ First Floor☐ First Floor incl. Second Floor Hall☐ First and Second Floor☒ Throughout☐ Not Applicable

Trim Paint Kingsmen White

## 10. Additional Comments

/

## 11. Disclaimers and Notes

- Colours of all materials are as close as possible to builder's selection, but not necessarily identical due to variances in manufacturing.
- Any extras listed above are null and void unless accompanied by a separate invoice/amendment. Said invoice must be paid in full.
- The Purchaser acknowledges that after Interior Colour Selection form is signed and dated, no further changes will be permitted other than re-selection due to unavailability. K Purchaser's Initials
- The Purchaser acknowledges reading and accepting the "Kingsmen Group Décor Centre Disclaimers" form. This document contains other miscellaneous disclaimers.

SEE ATTACHED FOR SIGNATURES

This Interior Colour Selection is final and approved by:

Purchaser:

Signature: J. Pappas Date: 27/Feb 23Signature: SEE ATTACHED FOR SIGNATURES Date: 27/Feb 23

Vendor:

KINGSMEN (THAMES) INC.

SCHEDULE "B-1"  
Floor Plan

MAR 13 2023

5B-213  
Townhouse No. 213 Block 156  
Phase 5B  
Model: William (2603) Elev B2 Opt 3 Bed - 3+1 Bath  
End - Optional Plan

Sketch 4/

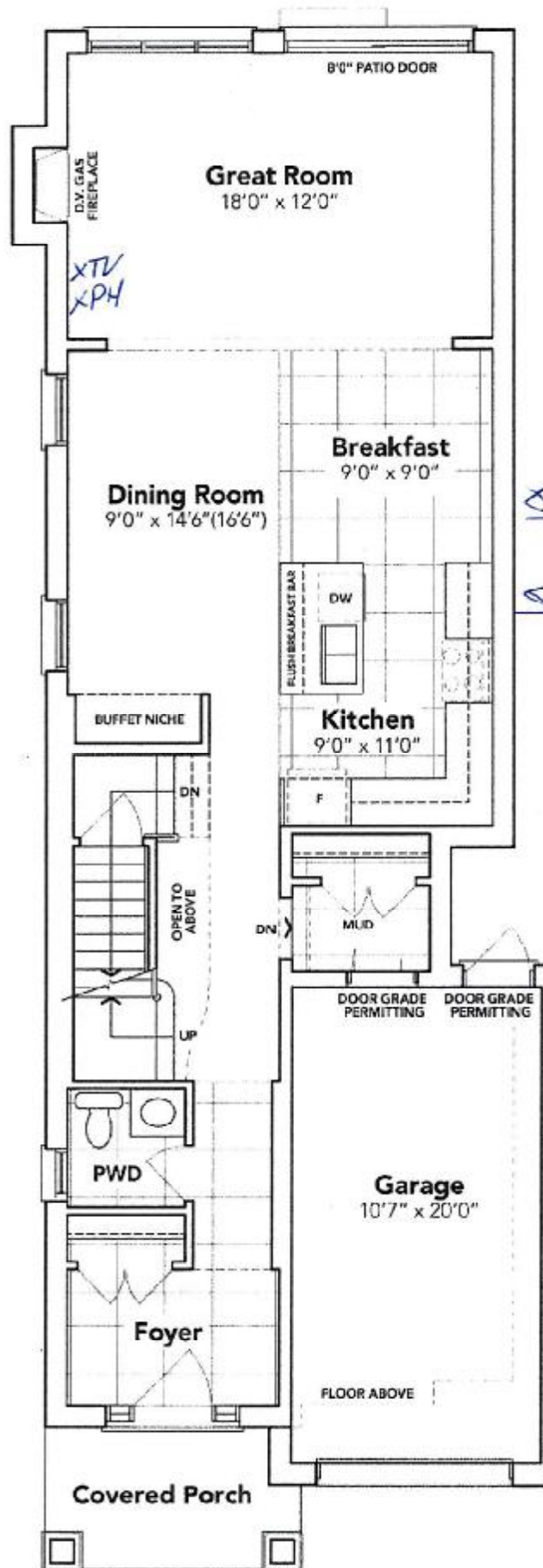

S. T.P. Murphy

SEE ATTACHED FOR SIGNATURES

MAIN FLOOR EL. B2A

The floor plans and elevations shown are pre-construction plans and may be revised or improved as necessitated by architectural controls and the construction process. The measurements adhere to the rules and regulations of the TARIION Warranty Corporation's official method for the calculation of floor area. Materials, specifications and floor plans are subject to change without notice. All house renderings are artist's concept only. Actual usable floor space may vary from the stated floor area. All options shown are upgrades. E. & O. E.

KL

T.P.

**SCHEDULE "B-1"**  
**Floor Plan**

MAR 03 2023

Model: William (2603) Elev B2 Opt 3 Bed - 3+1 Bath  
 End - Optional Plan

5B-213  
 Townhouse No. 213 Block 156  
 Phase 5B

Sketch #2

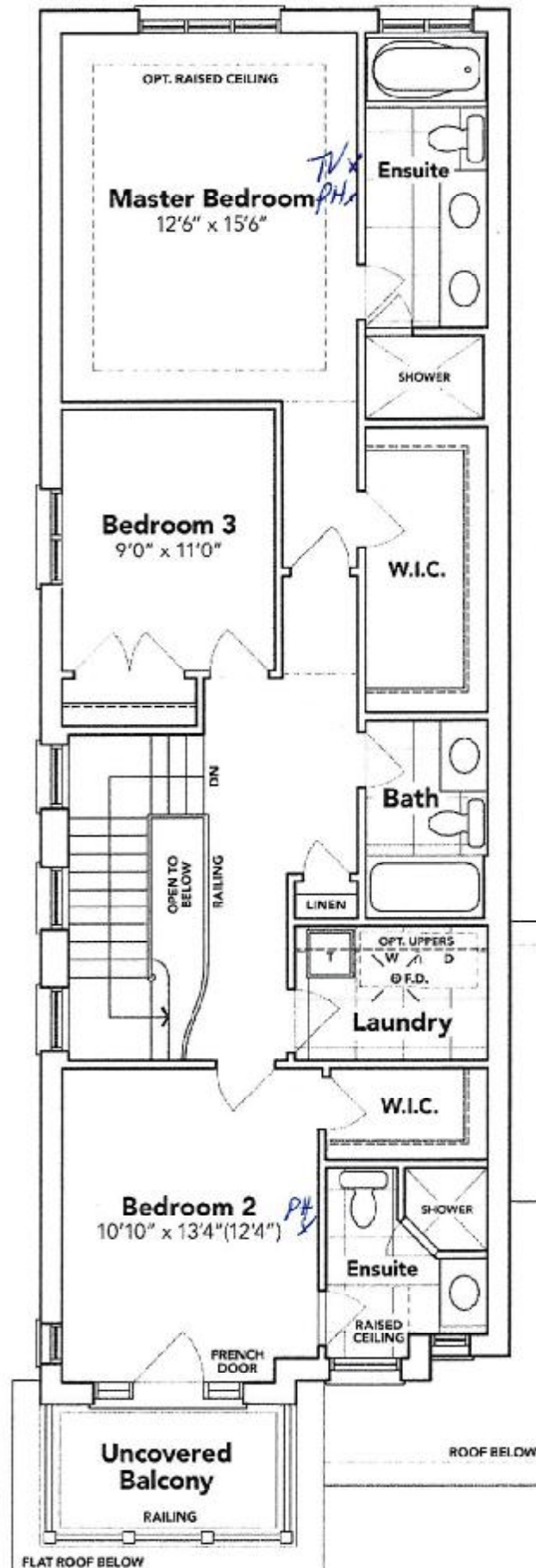

8 T.P. signature

SEE ATTACHED FOR SIGNATURES

8

**OPT. SECOND FLOOR EL. B2A**

The floor plans and elevations shown are pre-construction plans and may be revised or improved as necessitated by architectural controls and the construction process. The measurements adhere to the rules and regulations of the TARIION Warranty Corporation's official method for the calculation of floor area. Materials, specifications and floor plans are subject to change without notice. All house renderings are artist's concept only. Actual usable floor space may vary from the stated floor area. All options shown are upgrades. E. & O. E.



**SCHEDULE "B-1"**  
**Floor Plan**

MAR 03 2023

Model: William (2603) Elev B2 Opt 3 Bed - 3+1 Bath  
End - Optional Plan

Townhouse No. 213 Block 156

Phase 5B

5B-213

Sketch #3

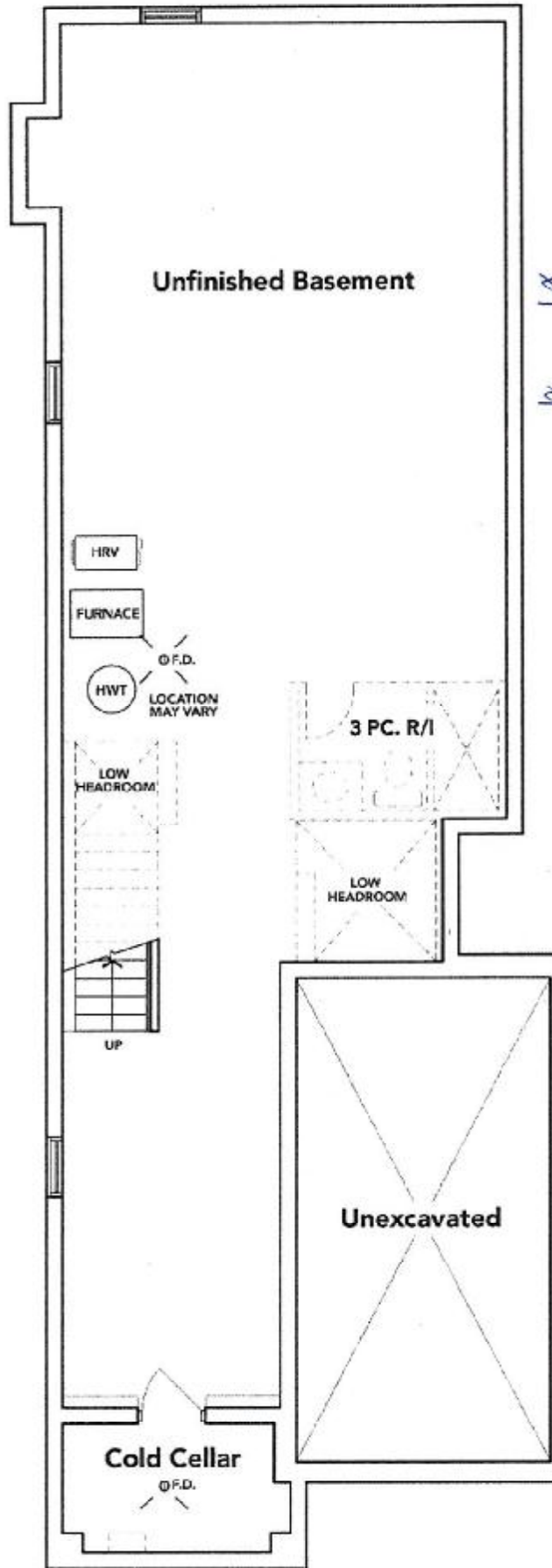

T.P. Pyper

SEE ATTACHED FOR SIGNATURES

**BASEMENT EL. B2A**

The floor plans and elevations shown are pre-construction plans and may be revised or improved as necessitated by architectural controls and the construction process. The measurements adhere to the rules and regulations of the TARION Warranty Corporation's official method for the calculation of floor area. Materials, specifications and floor plans are subject to change without notice. All house renderings are artist's concept only. Actual usable floor space may vary from the stated floor area. All options shown are upgrades. E. & O. E.