



CONSTRUCTION SUMMARY

KINGSMEN (THAMES) INC. / Havelock Corners (Kingsmen)

Lot/Unit: 212 Block 155 Phase/Building: 5B Model/Floor Plan: George (2603) Elev B1 4
Bed - 2+1 Bath

CABINETRY VANITY

Inv.6089	1 - To supply & install a VANITY BANK OF DRAWERS - in the master ensuite bathroom...see sketch # 2	
Line 77482	Note:	
3Mar23 / 6Mar23		

COUNTER TOP - EXTRAS

Inv.6089	1 - To supply & install the Quartz shower niche " IMPERIAL BLACK " in the master ensuite shower...see sktetch #2 for installation location.	
Line 77481	Note:	
3Mar23 / 6Mar23		

ELECTRICAL

Inv.6089	1 - To supply & install the standard T.V. rough in in the great room and master bedroom... see sketch # 1 & # 2	
Line 77431	Note: Install the standard T.V. Rough in at approx. 66" + - up from the floor centered +- to the F/P mantle in the great room.	
3Mar23 / 6Mar23		

Inv.6089	1 - To supply & install the standard Phone (CAT5) rough in in the great room, master bedroom and Bedroom # 3 ... see sketch # 1 & # 2	
Line 77432	Note: Install the standard Phone (CAT 5) Rough in at approx. 66" + - up from the floor centered +- to the F/P mantle in the great room.	
3Mar23 / 6Mar23		

Inv.6089	1 - To SUPPLY AND INSTALL AN ADDITIONAL BASIC RECEPTACLE (NOT DEDICATED) at approx. 66" + - up from the floor centered +- to the F/P mantle	
Line 77477	Note: in the great room... see sketch # 1	
3Mar23 / 6Mar23		
This is for a future wall mount T.V. NO CONDUIT PIPE HAS BEEN PURCHASED.		

Inv.6089	1 - SUPPLY AND INSTALL EXTRA CEILING BOX ROUGH IN CAPPED (DOES NOT INCLUDE SWITCH) over the island in the kitchen...see sketch # 1	
Line 77478	Note: This capped elec. will be connected to a sep. switch, switch is sold sep.	
3Mar23 / 6Mar23		

Inv.6089	1 - To supply & install AN ADDITIONAL SINGLE POLE SWITCH connected to the upgraded capped elec. over the island in the kitchen.	
Line 77479	Note:	
3Mar23 / 6Mar23		

Inv.6089	1 - Relocate the standard ceiling light from the upper stair landing to the O.T.B. area on the second floor... see sketch # 2	
Line 77480	Note:	
3Mar23 / 6Mar23		

HEATING AND AIR CONDITIONING

Inv.6089	1 - As per schedule "PE": Vendor to install capped gas line (Rough in only) at rear of home for future BBQ location. Location to be finalized at vendors sole discretion.	
Line 77429	Note:	
3Mar23 / 6Mar23		

KINGSMEN (THAMES) INC. / Havelock Corners (Kingsmen)

Lot/Unit: 212 Block 155 Phase/Building: 5B Model/Floor Plan: George (2603) Elev B1 4
Bed - 2+1 Bath

Inv.6089	1 - As per schedule "PE": Vendor to supply & install air conditioning unit, sized accordingly, from vendors standard samples.	
Line 77430	Note:	
3Mar23 / 6Mar23		

PLUMBING

Inv.6089	1 - Raise the standard toe tester in the master ensuite shower to approx. 28" + - up from unfinished shower floor.	
Line 77483	Note:	
3Mar23 / 6Mar23		

EXTRAS AS PER OFFER

5 FREE APPLIANCES ? STAINLESS STEEL FRONT - FRIDGE: STOVE AND DISHWASHER. WHITE WASHER AND DRYER (SUPPLIED ONLY, NOT INSTALLED, FROM BUILDERS STANDARD LINE). AN APPLIANCES VOUCHER WILL BE GIVEN BY OUR DECOR CONSULTANT AT THE TIME OF BOOKING YOUR COLOUR A <i>Worksheet</i> Note:	
5 FREE APPLIANCES – STAINLESS STEEL FRONT - FRIDGE; STOVE AND DISHWASHER. WHITE WASHER AND DRYER (SUPPLIED ONLY, NOT INSTALLED, FROM BUILDERS STANDARD LINE). AN APPLIANCES VOUCHER WILL BE GIVEN BY OUR DECOR CONSULTANT AT THE TIME OF BOOKING YOUR COLOUR A <i>Worksheet</i> Note:	
VENDOR TO INSTALL CAPPED GAS LINE (ROUGH-IN ONLY) AT REAR OF HOME FOR FUTURE BBQ LOCATION. LOCATION TO BE FINALIZED AT VENDORS SOLE DISCRETION. <i>Worksheet</i> Note:	
VENDOR TO SUPPLY & INSTALL AIR CONDITIONING UNIT, SIZED ACCORDINGLY, FROM VENDORS STANDARD SAMPLES. <i>Worksheet</i> Note:	

MAR 08 2023

Purchasers: JASPAL, S MANN, & HARPAL KAUR MANN, **Property:** 212 Block 155 of Plan - Draft Approval SB
Telephone Res. / Bus: / **Project:** KINGSMEN (THAMES) INC.
Decor Advisor: Barbara Coccia **Model and Elevation:** George (2603) Elev B1 4 Bed - 2+1 Bath
Layout Changes: ☐ Yes ☒ No **Sketch Attached:** ☒ Yes ☐ No **Exterior Colour Scheme:** _____

1. Cabinetry

	Style and Colour	Counter Top	Hardware
Kitchen / Breakfast	#3 Simcoe Moonlight	#1, C/S # 9141 Ice Snow 3cm.	#12881 Handle
Kitchen Island	#3 Simcoe Moonlight	#1, C/S # 9141 Ice Snow 3cm.	#12881 Handle
Laundry Room	/		
Powder Room	#3 Simcoe Moonlight	# 6698-46 Paloma Polar	#12881 Handle
Main Bathroom	#3 Simcoe Moonlight	# 4925K-07 Calcutta Marble	#12881 Handle
Master Ensuite Bathroom	#3 Simcoe Moonlight	# 4925K-07 Calcutta Marble	#12881 Handle
Second Ensuite Bathroom (If Applicable)	/		
	/		
	/		

Appliances

Custom Size Fridge

☐ Yes ☒ No

Valance Lighting

☐ Yes ☒ No

Microwave / Range Hood

☐ Yes ☒ No

Cooktop / Rangetop

☐ Yes ☒ No

Built in Wall Oven

☐ Yes ☒ No

Slide-in Range

☐ Yes ☒ No

Comment

/

2. Flooring

	Selection
Foyer	13 x13" Malena Ice
Main Hall	3 1/2" Elements oak Natural
Back Hall	/
Breakfast	13 x13" Malena Ice
Laundry Room	13 x13" Malena Carbon
Kitchen	13 x13" Malena Ice
Powder Room	(& small hallway in front of powder room) 13 x13" Malena Ice
Main Bathroom	13 x13" Malena Carbon
Master Ensuite	13 x13" Malena Carbon
Bathroom (If Applicable)	/
Mud Room	13 x13" Malena Ice
Master ens. shower floor:	2x2" Ontario Snow White Matte
Living Room	/
Dining Room	3 1/2" Elements oak Natural
Family / Great Room	3 1/2" Elements oak Natural
Den / Library / Study	/
Basement Landing (If Applies)	
Lower Landing (If Applicable)	3 1/2" Elements oak Natural
Upper Landing	3 1/2" Elements oak Natural
Upper Hall	Modern Story 1, # 966 Spellbound
Master Bedroom	Modern Story 1, # 966 Spellbound
Bedroom #2	Modern Story 1, # 966 Spellbound
Bedroom #3	Modern Story 1, # 966 Spellbound
Bedroom #4	Modern Story 1, # 966 Spellbound
Bedroom #5	/
Master ens. shower jamb:	Anatolia Marmiline SNOW

SEE ATTACHED FOR SIGNATURES

Flooring Continued on Page 2

Initial: _____

Page 1 of 3

MAR 08 2023

Purchasers: JASPAL, S MANN, & HARPAL KAUR MANN, **Property:** 212 Block 155 of Plan - Draft Approval SB
Telephone Res. / Bus: / **Project:** KINGSMEN (THAMES) INC.
Decor Advisor: Barbara Coccia **Model and Elevation:** George (2603) Elev B1 4 Bed - 2+1 Bath
 2. Flooring - Continued -

Upgrade Underpad	Type	Area
	Standard	2nd. Floor
Carpet on Stairs	Capped	Runner - *Upgrade
Comment	/	/

3. Plumbing Fixtures / Faucets

Kitchen	Standard	Second Ensuite	/	Powder Room	Standard
Master Ensuite	Standard			Other Room	/
Main Bathroom	Standard				

Comment
 Still to install the standard top mount kitchen sink.

4. Wall Tile

	Tile Selection	Listello	Insert	Insert Selection
Main Bathroom	8x10" Malena Ice	<input type="checkbox"/>	<input type="checkbox"/>	
Master Ensuite				
Tub Deck	13 x13" Malena Carbon	<input type="checkbox"/>	<input type="checkbox"/>	
Tub Apron	13 x13" Malena Carbon	<input type="checkbox"/>	<input type="checkbox"/>	
Tub Surround	13 x13" Malena Carbon	<input type="checkbox"/>	<input type="checkbox"/>	
Shower Stall	8x10" Malena Ice	<input type="checkbox"/>	<input type="checkbox"/>	
Second Ensuite	/	<input type="checkbox"/>	<input type="checkbox"/>	
	/	<input type="checkbox"/>	<input type="checkbox"/>	
	/	<input type="checkbox"/>	<input type="checkbox"/>	
Kitchen Backsplash	/	<input type="checkbox"/>	<input type="checkbox"/>	
Complete Backsplash	/	<input type="checkbox"/>	<input type="checkbox"/>	

Comment
 /

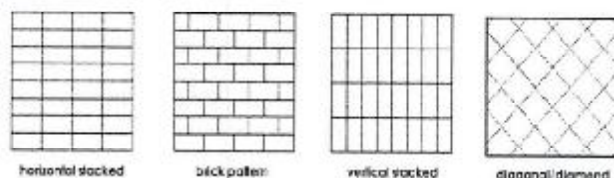

5. Fireplace

	Living Room			Family Room			Other Room - Specify Great Room		
	Purchased	As Per Plan	N/A	Purchased	As Per Plan	N/A	Purchased	As Per Plan	N/A
Fireplace Type	<input type="radio"/>	<input type="radio"/>	<input checked="" type="radio"/>	<input type="radio"/>	<input type="radio"/>	<input checked="" type="radio"/>	<input type="radio"/>	<input checked="" type="radio"/>	<input type="radio"/>
Mantle Type									
Over Mantle									
Colour / Stain									
Surround									
Hearth									
Comment									

SEE ATTACHED FOR SIGNATURES

Initial: hm

Initial:

MAR 08 2023

Purchasers: JASPAL S MANN, & HARPAL KAUR MANN, **Property:** 212 Block 155 of Plan - Draft Approval SB
Telephone Res. / Bus: / **Project:** KINGSMEN (THAMES) INC.
Decor Advisor: Barbara Coccia **Model and Elevation:** George (2603) Elev B1 4 Bed - 2+1 Bath

6. Trim Carpentry

Door Hardware Standard handle

Interior Trim Standard

Comment

/

Interior Doors

☐ 2 Panel Arch Top

☒ 2 Panel Square Top

☐ 6 Panel



Initial for Door Style

H.M.

7. Railings and Pickets

Railing Package Standard Oak STRAIGHT picket package

Railing Colour Elements Natural

Picket Colour Elements Natural

Wood Stairs ☐ No ☒ Oak

Tread Colour Elements Natural

Comment

/

SEE ATTACHED FOR SIGNATURES

8. Plaster Mouldings and Medallions

Foyer /

Main Hall /

Living Room /

Dining Room /

Family Room /

Kitchen/Breakfast /

Den/Library /

Lower Landing /

Comment

/

9. Wall Paint

Kingsmen White

Smooth Ceilings

☐ First Floor

☐ First Floor incl. Second Floor Hall

☐ First and Second Floor

☒ Throughout

☐ Not Applicable

Trim Paint Kingsmen White

10. Additional Comments

/

11. Disclaimers and Notes

- Colours of all materials are as close as possible to builder's selection, but not necessarily identical due to variances in manufacturing.
- Any extras listed above are null and void unless accompanied by a separate invoice/amendment. Said invoice must be paid in full.
- The Purchaser acknowledges that after Interior Colour Selection form is signed and dated, no further changes will be permitted other than re-selection due to unavailability. H.M. Purchaser's Initials
- The Purchaser acknowledges reading and accepting the "Kingsmen Group Décor Centre Disclaimers" form. This document contains other miscellaneous disclaimers.

SEE ATTACHED FOR SIGNATURES

This Interior Colour Selection is final and approved by:

Purchaser:

Signature: Harman Date: March 6th, 2023

SEE ATTACHED FOR SIGNATURES

Signature: _____ Date: _____

Vendor: _____

KINGSMEN (THAMES) INC.

5B-212

all 3 items @
66" ± up from
floor
↓
↓
↓
TV PH

Capped elec.
on a sep.
Sunked

LOT 212
BLOCK 155
THAMES PH. 5B
SKETCH # 1

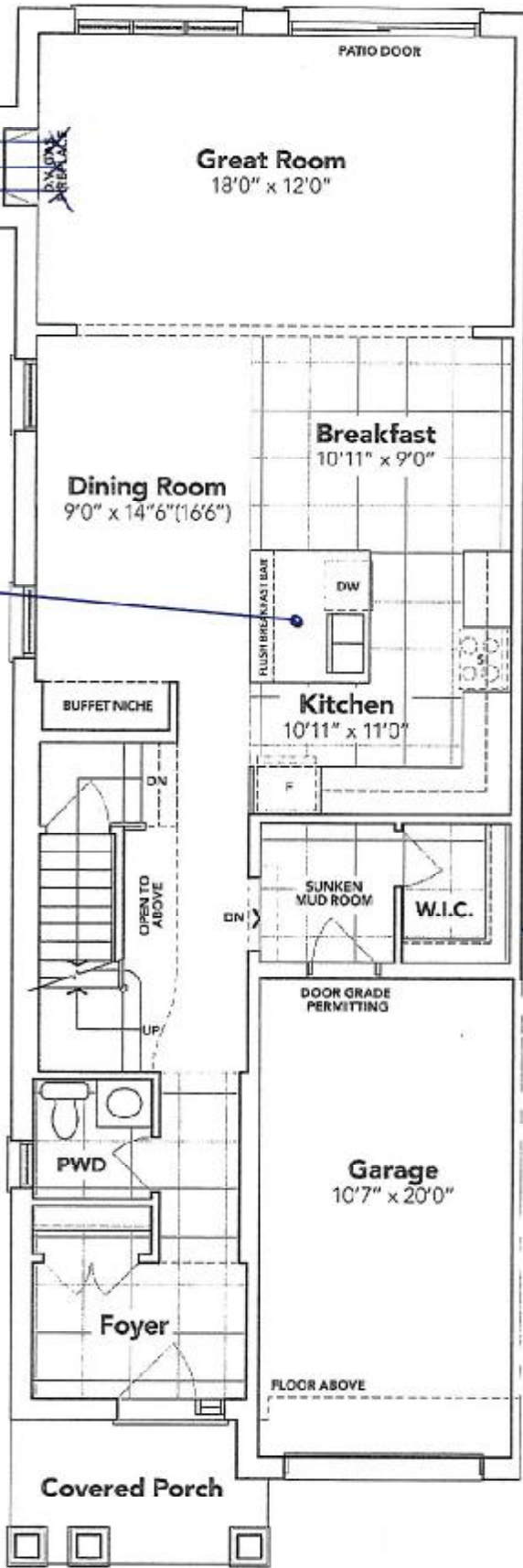

MAIN FLOOR EL. B1

The floor plans and elevations shown are pre-construction plans and may be revised or improved as necessitated by architectural controls and the construction process. The measurements adhere to the rules and regulations of the TARIION Warranty Corporation's official method for the calculation of floor area. Materials, specifications and floor plans are subject to change without notice. All house renderings are artist's concept only. Actual usable floor space may vary from the stated floor area. All options shown are upgrades. E. & C. E.

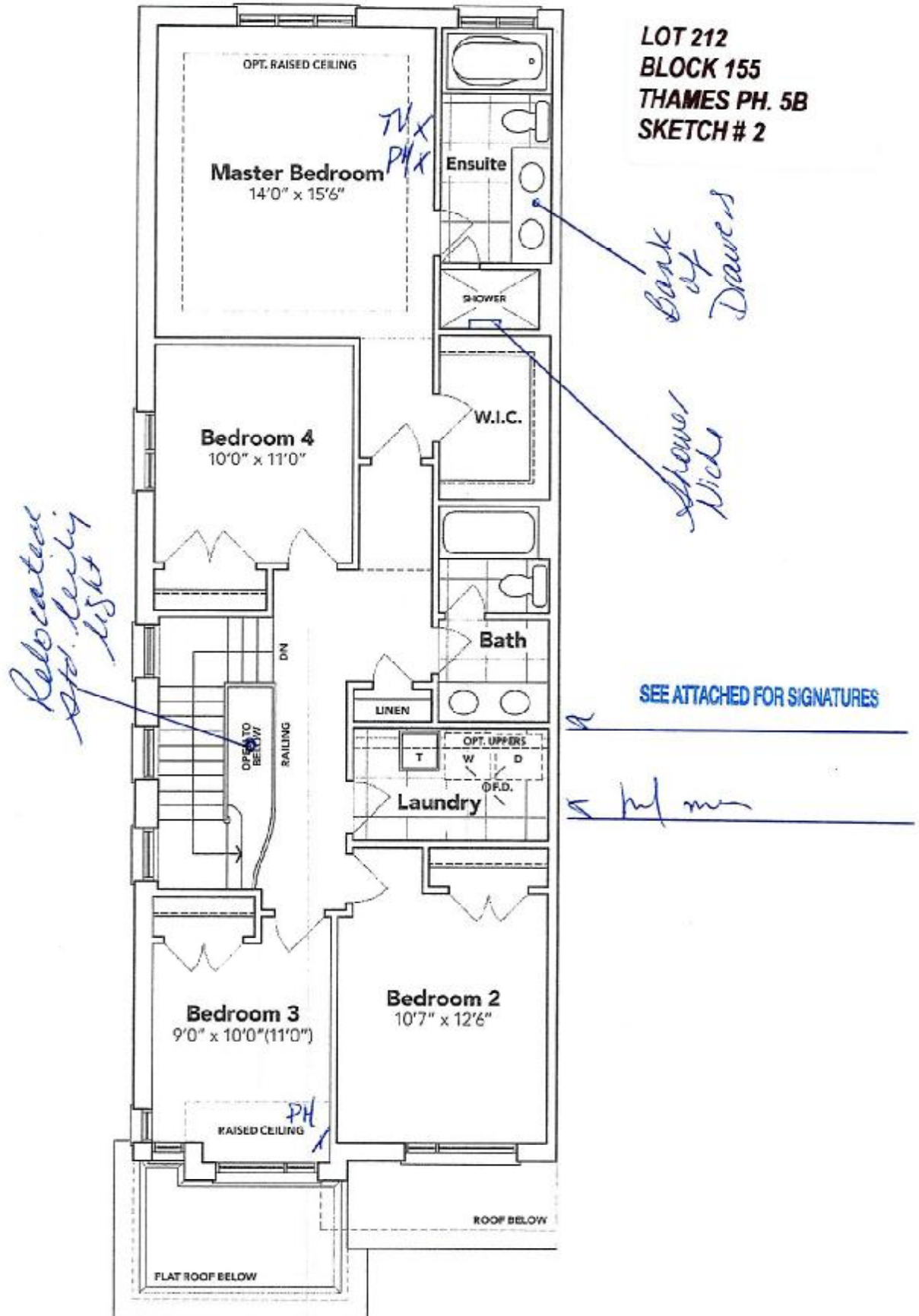

SCHEDULE "B" Page 2 of 3
Initials: HEM JSM

5B-212

SCHEDULE "B-1"
Floor Plan

Townhouse No. 212 Block 155
Phase 5B
Model: George (2603) Elev B1 4 Bed - 2+1 Bath
End Alternate - Standard

LOT 212
BLOCK 155
THAMES PH. 5B
SKETCH # 3

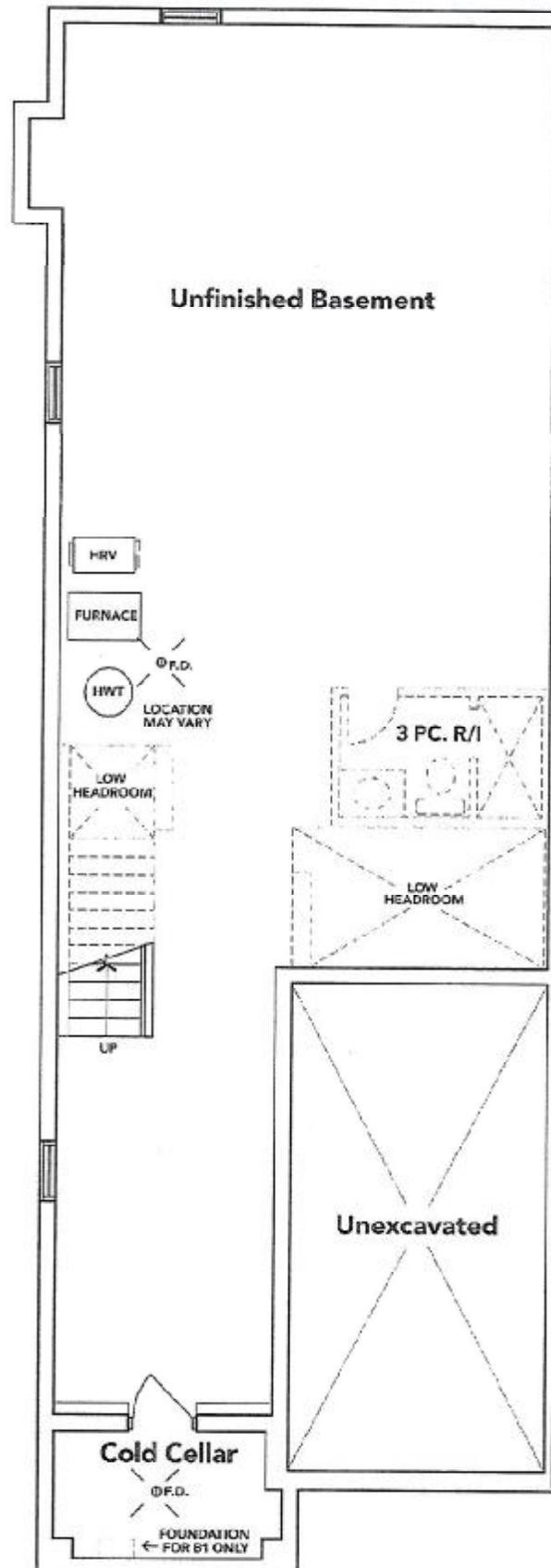

SEE ATTACHED FOR SIGNATURES

hul me

BASEMENT EL. B1

The floor plans and elevations shown are pre-construction plans and may be revised or improved as necessitated by architectural controls and the construction process. The measurements adhere to the rules and regulations of the TARION Warranty Corporation's official method for the calculation of floor area. Materials, specifications and floor plans are subject to change without notice. All house renderings are artist's concept only. Actual usable floor space may vary from the stated floor area. All options shown are upgrades. E. & O. E.