

Lindsay 2017 Developments Inc. / Sugarwood

Lot/Unit: 13 Phase/Building: 1 Model/Floor Plan: Fishog Lake (4203) Elev A 2Bed 2Bath

CABINETRY VANITY

Inv.6133	1 - TO INCREASE VANITY TO KITCHEN HEIGHT GREATER THAN 3FT - 90CM HIGH - MAINTAINS VANITY DEPTH - CLASSIC SERIES IN THE MASTR ENSUITE	
Line 77811	Note:	
4Apr23 / 4Apr23		

ELECTRICAL

Inv.6133	1 - TO SUPPLY AND INSTALL AN ADDITIONAL BASIC RECEPTACLE (NOT DEDICATED) AT APPROX. 66" UP FROM THE F/P IN THE GREAT ROOM, NEXT TO THE STANDARD TV AND PHONE ROUGH-IN.. SEE SKETCH #1 FOR DETAILS	
Line 77809	Note:	
4Apr23 / 4Apr23		
Inv.6133	1 - TO SUPPLY AND INSTALL THE STANDARD TV ROUGH-IN, IN THE GREAT ROOM AND MASTER BEDROOM.. SEE SKETCH #1	
Line 77802	Note:	
4Apr23 / 4Apr23		
Inv.6133	1 - TO SUPPLY AND INSTALL THE STANDARD PHONE (CAT 5) ROUGH-IN, IN THE GREAT ROOM, MASTER BEDROOM AND BEDROOM #2.. SEE SKETCH #1	
Line 77803	Note:	
4Apr23 / 4Apr23		

FIREPLACE

Inv.6133	1 - TO SUPPLY AND INSTALL THE OPTIONAL GAS FIREPLACE IN THE GREAT ROOM.. SEE COLOUR CHART FOR DETAILS	
Line 77808	Note:	
4Apr23 / 4Apr23		

HARDWOOD

Inv.6133	1 - TO SUPPLY AND INSTALL 3 1/2" ELEMENTS OAK STURGEON IN LIEU OF THE STANDARD HARDWOOD.. SEE COLOUR CHART FOR DETAILS	
Line 77812	Note:	
4Apr23 / 4Apr23		

HVAC

Inv.6133	1 - TO SUPPLY AND INSTALL THE GASLINE REQUIRED FOR THE OPTIONAL GAS FIREPLACE IN THE GREAT ROOM...	
Line 77807	Note:	
4Apr23 / 4Apr23		

MISCELLANEOUS

PLUMBING

Inv.6133	1 - TO SUPPLY AND INSTALL KITCHEN SINK - BLANCO QUATRUS U2 UNDERMOUNT - MODEL 401247 IN LIEU OF THE STANDARD.. SEE SPEC'S	
Line 77810	Note:	
4Apr23 / 4Apr23		

Lindsay 2017 Developments Inc. / Sugarwood

Lot/Unit: 13 Phase/Building: 1 Model/Floor Plan: Fishog Lake (4203) Elev A 2Bed 2Bath

EXTRAS AS PER OFFER

Purchaser: PETER J VAN HAEFTEN

Property: 13 of Plan -

Telephone Res. / Bus: (905) 550-7865 /

Project: Lindsay 2017 Developments Inc.

Decor Advisor: Samantha Castelli

Model and Elevation: Fishog Lake (4203) Elev A 2Bed 2Bath

Layout Changes: ☐ Yes ☒ No

Sketch Attached: ☒ Yes ☐ No

Exterior Colour Scheme:

1. Cabinetry

	Style and Colour	Counter Top	Hardware
Kitchen / Breakfast	#3 Trinity LPL First Class L583K	#1 C/S #9141 ICE SNOW	12881 HANDLE
Kitchen Island	#3 Trinity LPL First Class L583K	#1 C/S #9141 ICE SNOW	12881 HANDLE
Laundry Room	/	/	/
Powder Room	/	/	/
Main Bathroom	#3 Trinity LPL First Class L583K	Paloma Polar 6698-46	12843 HANDLE
Master Ensuite Bathroom	#3 Trinity LPL First Class L583K	Paloma Polar 6698-46	12843 HANDLE
Second Ensuite Bathroom (If Applicable)	/	/	/

Appliances

Custom Size Fridge

☐ Yes ☒ No

Valance Lighting

☐ Yes ☒ No

Microwave / Range Hood

☐ Yes ☒ No

Cooktop / Rangetop

☐ Yes ☒ No

Built in Wall Oven

☐ Yes ☒ No

Slide-in Range

☐ Yes ☒ No

Comment

RECU/RECEIVED

05-04-2023

2. Flooring

	Selection
Foyer	13x13" Cinq White
Main Hall	13x13" Cinq White
Back Hall	* 3 1/2" Elements Oak Sturgeon
Breakfast	* 3 1/2" Elements Oak Sturgeon
Laundry Room	/
Kitchen	13x13" Cinq White
Powder Room	/
Main Bathroom	13x13" Cinq White
Master Ensuite	13x13" Cinq Grey
Bathroom (If Applicable)	/
Mud Room	13x13" Cinq White
Main/Master Ens. Shower FI	2x2" Ontario Snow White Matte
Living Room	/
Dining Room	/
Family / Great Room	* 3 1/2" Elements Oak Sturgeon
Den / Library / Study	/
Basement Landing (If Applies)	/
Lower Landing (If Applicable)	/
Upper Landing	/
Upper Hall	/
Master Bedroom	* 3 1/2" Elements Oak Sturgeon
Bedroom #2	* 3 1/2" Elements Oak Sturgeon
Bedroom #3	/
Bedroom #4	/
Bedroom #5	/
Main/Master Shower Jamb	Anatolia Marmiline SNOW

Flooring Continued on Page 2

Initial:

P. J. H.

Page 1 of 3

Purchaser: PETER J VAN HAEFTEN

Telephone Res. / Bus: (905) 550-7865 /

Decor Advisor: Samantha Castelli

2. Flooring - Continued -

Property: 13 of Plan -

Project: Lindsay 2017 Developments Inc.

Model and Elevation: Fishog Lake (4203) Elev A 2Bed 2Bath

Upgrade Underpad	Type	Area
	/	/
Carpet on Stairs	Capped	Runner - *Upgrade
Comment	/	/

3. Plumbing Fixtures / Faucets

Kitchen	Standard	Second Ensuite	/	Powder Room	/
Master Ensuite	Standard			Other Room	
Main Bathroom	Standard				

Comment

TO SUPPLY AND INSTALL THE UPGRADED UNDERMOUNT KITCHEN SINK, WITH THE STANDARD FAUCET. TO SUPPLY AND INSTALL ALL STANDARD FIXTURES IN ALL BATHROOMS.

4. Wall Tile

	Tile Selection	Listello	Insert	Insert Selection
Main Bathroom	8x10" Malena Ice	<input type="checkbox"/>	<input type="checkbox"/>	
Master Ensuite				
Tub Deck	/	<input type="checkbox"/>	<input type="checkbox"/>	
Tub Apron	/	<input type="checkbox"/>	<input type="checkbox"/>	
Tub Surround	/	<input type="checkbox"/>	<input type="checkbox"/>	
Shower Stall	8x10" Cinq Grey	<input type="checkbox"/>	<input type="checkbox"/>	
Second Ensuite	/	<input type="checkbox"/>	<input type="checkbox"/>	
		<input type="checkbox"/>	<input type="checkbox"/>	
Kitchen Backsplash		<input type="checkbox"/>	<input type="checkbox"/>	
Complete Backsplash		<input type="checkbox"/>	<input type="checkbox"/>	

Comment



horizontal stacked



brick pattern



vertical stacked



diagonal/diamond

5. Fireplace

Living Room

Purchased ☐ As Per Plan ☐ N/A ☐

Family Room

Purchased ☐ As Per Plan ☐ N/A ☐

Other Room - Specify/

Purchased ☒ As Per Plan ☐ N/A ☐

Fireplace Type

Mantle Type

Over Mantle

Colour / Stain

Surround

Hearth

Comment

Front Facing

NF-08

/

White

Initial:

PVH

Page 2 of 3

Purchaser: PETER J VAN HAEFTEN
 Telephone Res. / Bus: (905) 550-7865 /
 Decor Advisor: Samantha Castelli

Property: 13 of Plan -
 Project: Lindsay 2017 Developments Inc.
 Model and Elevation: Fishog Lake (4203) Elev A 2Bed 2Bath

6. Trim Carpentry

Door Hardware Standard Handle

Interior Trim Standard

Comment

Interior Doors

☐ 2 Panel Arch Top

☒ 2 Panel Square Top

☐ 6 Panel

Initial for Door Style

PJH

7. Railings and Pickets

Railing Package /

Railing Colour /

Wood Stairs ☒ No ☐ Oak

Picket Colour /

Tread Colour

Comment

8. Plaster Mouldings and Medallions

Foyer

Main Hall

Living Room

Dining Room

Family Room

Comment

Kitchen/Breakfast

Den/Library

Lower Landing

9. Wall Paint

Kingsmen White

Smooth Ceilings

☐ First Floor

☐ First Floor incl. Second Floor Hall

☐ First and Second Floor

☒ Throughout

☐ Not Applicable

Trim Paint Kingsmen White

10. Additional Comments



11. Disclaimers and Notes

- Colours of all materials are as close as possible to builder's selection, but not necessarily identical due to variances in manufacturing.
- Any extras listed above are null and void unless accompanied by a separate invoice/amendment. Said invoice must be paid in full.
- The Purchaser acknowledges that after Interior Colour Selection form is signed and dated, no further changes will be permitted other than re-selection due to unavailability. *PJH* Purchaser's Initials
- The Purchaser acknowledges reading and accepting the "Kingsmen Group Décor Centre Disclaimers" form. This document contains other miscellaneous disclaimers.

This Interior Colour Selection is final and approved by:

Purchaser:

Signature: *P. Van Haeften*

Date: *April 4/2023*

Vendor:

Lindsay 2017 Developments Inc.

April 6/23

SCHEDULE "B-1"
Floor Plan

Lindsay PH.1 Lot 13

Lot 13
Phase 1
Model: Fishog Lake (4203) Elev A 2Bed 2Bath
Standard

SKETCH 1

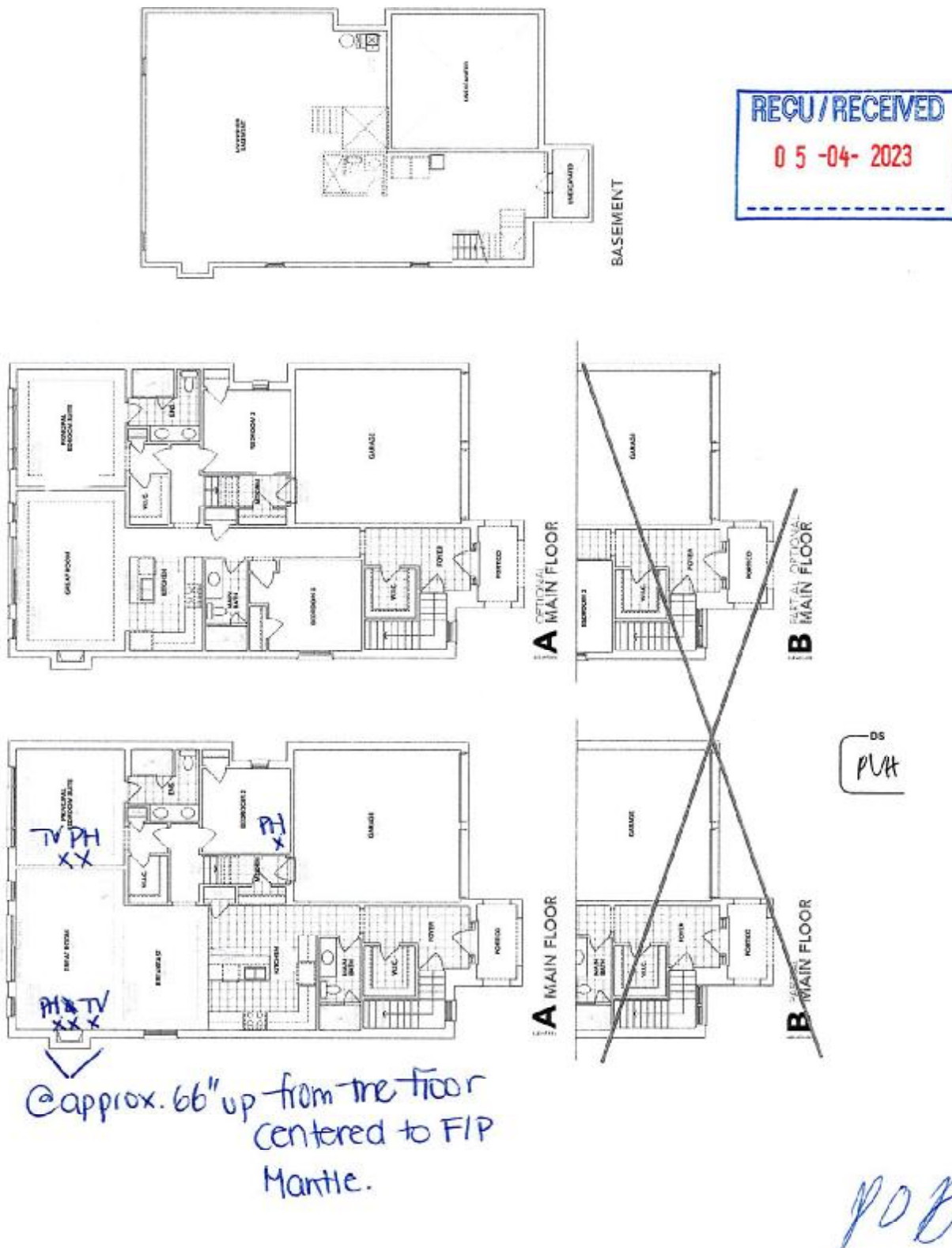

The floor plans and elevations shown are pre-construction plans and may be revised or improved as necessitated by architectural controls and the construction process. The measurements adhere to the rules and regulations of the TARIION Warranty Corporation's official method for the calculation of floor area. Materials, specifications and floor plans are subject to change without notice. All house renderings are artist's concept only. Actual usable floor space may vary from the stated floor area. All options shown are upgrades. E. & O. E.

4/2/23

Lindsay PH.1 Lot 13

LOT 13-LINDSAY SUGARWOOD PHASE 1

Re: UPG. KITCHEN SINK

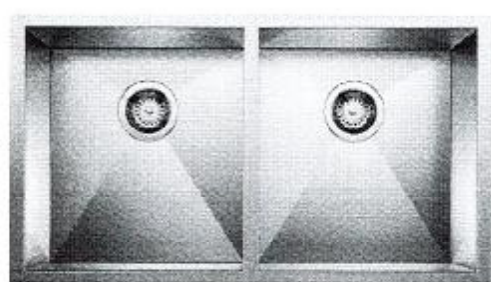

QUATRUS U 2

Stainless steel brushed finish SKU 401247

- 3 3/4" (90 mm) stainless steel strainer
- Installation instructions
- Cut-out template



PH