

Lindsay 2017 Developments Inc. / Sugarwood

Lot/Unit: 58    Phase/Building: 1    Model/Floor Plan: Talbot Lake (3703) Elev A 3Bed 2.5Bath

CABINETRY

Inv.5952	1 - TO SUPPLY A TWO TONE KITCHEN.. #3 SIMCOE ORCHID ON THE UPPER CABINETRY AND #3 SIMCOE NAVY BLUE ON THE LOWER CABINETRY INCLUDING THE ISLAND	
Line 78101	Note:	
26Oct22 / 16Apr23		

CABINETRY APPLIANCE - FRIDGE

Inv.5952	1 - TO SUPPLY AND INSTALL 66CM DEEP FRIDGE ENCLOSURE - COUNTER DEPTH WITH - 1 WALL - 1 66CM DEEP GABLE AND 1 66CM DEEP CABINET - THIS IS NOT A ZERO CLEARANCE ENCLOSURE. STANDARD HEIGHTS AND WIDTHS WILL BE USED. - CLASSIC SERIES.. SEE SKETCH #1	
Line 78102	Note:	
26Oct22 / 16Apr23		

ELECTRICAL

Inv.5952	1 - TO SUPPLY AND INSTALL THE STANDARD TV ROUGH-IN, IN THE GREAT ROOM AND MASTER BEDROOM.. SEE SKETCH #1 AND #2	
Line 75323	Note:	
26Oct22 / 16Apr23		
Inv.5952	1 - TO SUPPLY AND INSTALL THE STANDARD PHONE ROUGH-IN, IN THE GREAT ROOM, MASTER BEDROOM AND BEDROOM #2.. SEE SKETCH #1 AND #2	
Line 78071	Note:	
26Oct22 / 16Apr23		
Inv.5952	1 - TO SUPPLY AND INSTALL A CAPPED ELEC. ON A SEPARATE SWITCH OVER THE BREAKFAST BAR IN THE KITCHEN.. SEE SKETCH #1	
Line 78099	Note:	
26Oct22 / 16Apr23		

MISCELLANEOUS

PLUMBING

Inv.5952	1 - TO SUPPLY AND INSTALL KITCHEN SINK - BLANCO QUATRUS U2 DBL UNDERMOUNT - MODEL 401247 IN THE KITCHEN, IN LIEU OF THE STANDARD.. SEE SPEC'S	
Line 78100	Note:	
26Oct22 / 16Apr23		

STAIRS AND RAILINGS

Inv.5952	1 - TO SUPPLY AND INSTALL THE SRAIGHT OAK PICKETS.. SEE COLOUR CHART	
Line 78103	Note:	
26Oct22 / 16Apr23		

TILE - BACKSPLASH

Inv.5952	1 - TO SUPPLY AND INSTALL LEVEL 1 KITCHEN BACKSLASH STACKED.. SEE COLOUR CHART FOR DETAILS	
Line 78104	Note:	
26Oct22 / 16Apr23		

**Lindsay 2017 Developments Inc. / Sugarwood**

**Lot/Unit: 58    Phase/Building: 1    Model/Floor Plan: Talbot Lake (3703) Elev A 3Bed 2.5Bath**

**EXTRAS AS PER OFFER**

Purchaser: RAHUL ROHATGI

Property: 58 of Plan -

Telephone Res. / Bus: (647) 668-0139 /

Project: Lindsay 2017 Developments Inc.

Decor Advisor: Samantha Castelli

Model and Elevation: Talbot Lake (3703) Elev A 3Bed 2.5Bath

Layout Changes: ☐ Yes ☒ No

Sketch Attached: ☒ Yes ☐ No

Exterior Colour Scheme:

1. Cabinetry	Style and Colour	Counter Top	Hardware
Kitchen / Breakfast	#3 Simcoe Raincloud & Navy Blue	#1 C/S #9141 ICE SNOW	12881 handle
Kitchen Island	#3 Simcoe Navy Blue	#1 C/S #9141 ICE SNOW	12881 handle
Laundry Room	/	/	/
Powder Room	/	/	/
Main Bathroom	#3 Simcoe Orchid	Black Alicante 4926k-07	12881 handle
Master Ensuite Bathroom	#3 Simcoe Orchid	Black Alicante 4926k-07	12881 handle
Second Ensuite Bathroom (If Applicable)			

Appliances

Custom Size Fridge

☐ Yes ☒ No

Valance Lighting

☐ Yes ☒ No

Microwave / Range Hood

☐ Yes ☒ No

Cooktop / Rangetop

☐ Yes ☒ No

Built in Wall Oven

☐ Yes ☒ No

Slide-in Range

☐ Yes ☒ No

Comment

REC'D / RECEIVED

17-04-2023

## 2. Flooring

	Selection
Foyer	13x13" Malena Ice
Main Hall	3 1/2" Elements Oak Natural
Back Hall	/
Breakfast	3 1/2" Elements Oak Natural
Laundry Room	13x13" Cinq Grey
Kitchen	13x13" Malena Ice
Powder Room	13x13" Malena Ice
Main Bathroom	13x13" Cinq Grey
Master Ensuite	13x13" Cinq Grey
Bathroom (If Applicable)	/
Mud Room	13x13" Malena Ice
Master Ens. Shower Floor	2x2" Ontario Snow White Matte
Living Room	/
Dining Room	/
Family / Great Room	3 1/2" Elements Oak Natural
Den / Library / Study	/
Basement Landing (If Applies)	
Lower Landing (If Applicable)	3 1/2" Elements Oak Natural
Upper Landing	3 1/2" Elements Oak Natural
Upper Hall	Opening Night: 03
Master Bedroom	Opening Night: 03
Bedroom #2	Opening Night: 03
Bedroom #3	Opening Night: 03
Bedroom #4	/
Bedroom #5	/
Master Ens. Shower Jamb	ANATOLIA MARMILINE SNOW

Flooring Continued on Page 2

Initial:

*RA*

Page 1 of 3

Purchaser: RAHUL ROHATGI

Telephone Res. / Bus: (647) 668-0139 /

Decor Advisor: Samantha Castelli

2. Flooring - Continued -

Property: 58 of Plan -

Project: Lindsay 2017 Developments Inc.

Model and Elevation: Talbot Lake (3703) Elev A 3Bed 2.5Bath

Upgrade Underpad	Type STANDARD	Area 2nd floor
Carpet on Stairs	Capped	Runner - *Upgrade
Comment		

3. Plumbing Fixtures / Faucets

Kitchen	STANDARD	Second Ensuite		Powder Room	STANDARD
Master Ensuite	STANDARD			Other Room	
Main Bathroom	STANDARD				

Comment

NOTE: TO SUPPLY AND INSTALL THE UPGRADED UNDERMOUNT SINK, WITH THE STANDARD FAUCET IN THE KITCHEN. TO SUPPLY AND INSTALL ALL STANDARD PLUMBING FIXTURES IN ALL BATHROOMS.

4. Wall Tile

	Tile Selection	Listello	Insert	Insert Selection
Main Bathroom	8x10" Cinq Grey	<input type="checkbox"/>	<input type="checkbox"/>	
Master Ensuite				
Tub Deck	/	<input type="checkbox"/>	<input type="checkbox"/>	
Tub Apron	/	<input type="checkbox"/>	<input type="checkbox"/>	
Tub Surround	/	<input type="checkbox"/>	<input type="checkbox"/>	
Shower Stall	8x10" Cinq Black	<input type="checkbox"/>	<input type="checkbox"/>	
Second Ensuite	/	<input type="checkbox"/>	<input type="checkbox"/>	
		<input type="checkbox"/>	<input type="checkbox"/>	
		<input type="checkbox"/>	<input type="checkbox"/>	
Kitchen Backsplash	*4x16" Soho White Glossy Pressed STACKED	<input type="checkbox"/>	<input type="checkbox"/>	
Complete Backsplash		<input type="checkbox"/>	<input type="checkbox"/>	

Comment



horizontal stacked



brick pattern



vertical stacked



diagonal/diamond

5. Fireplace

	Living Room			Family Room			Other Room - Specify GREAT ROOM		
	Purchased	As Per Plan	N/A	Purchased	As Per Plan	N/A	Purchased	As Per Plan	N/A
Fireplace Type	<input type="radio"/>	<input type="radio"/>	<input type="radio"/>	<input type="radio"/>	<input type="radio"/>	<input type="radio"/>	<input type="radio"/>	<input checked="" type="radio"/>	<input type="radio"/>
Mantle Type									
Over Mantle									
Colour / Stain									
Surround									
Hearth									
Comment									

Initial:

Page 2 of 3



Purchaser: RAHUL ROHATGI

Telephone Res. / Bus: (647) 668-0139 /

Decor Advisor: Samantha Castelli

Property: 58 of Plan -

Project: Lindsay 2017 Developments Inc.

Model and Elevation: Talbot Lake (3703) Elev A 3Bed 2.5Bath

6. Trim Carpentry

Door Hardware Standard handle

Interior Trim standard

Comment

Interior Doors

☐ 2 Panel Arch Top

☒ 2 Panel Square Top

☐ 6 Panel



Initial for Door Style RL

7. Railings and Pickets

Railing Package STRAIGHT OAK PICKETS

Railing Colour ELEMENTS NATURAL

Wood Stairs ☐ No ☒ Oak

Comment

Picket Colour ELEMENTS NATURAL

Tread Colour ELEMENTS NATURAL

8. Plaster Mouldings and Medallions

Foyer			Kitchen/Breakfast		
Main Hall			Den/Library		
Living Room			Lower Landing		
Dining Room					
Family Room					
Comment					

9. Wall Paint

KINGSMEN WHITE

Smooth Ceilings ☐ First Floor  
☐ First Floor incl. Second Floor Hall  
☐ First and Second Floor  
☒ Throughout  
☐ Not Applicable

Trim Paint KINGSMEN WHITE

10. Additional Comments

REC'D/RECEIVED

17-04-2023

11. Disclaimers and Notes

1) Colours of all materials are as close as possible to builder's selection, but not necessarily identical due to variances in manufacturing.

2) Any extras listed above are null and void unless accompanied by a separate invoice/amendment. Said invoice must be paid in full.

3) The Purchaser acknowledges that after Interior Colour Selection form is signed and dated, no further changes will be permitted other than re-selection due to unavailability. RL Purchaser's Initials

4) The Purchaser acknowledges reading and accepting the "Kingsmen Group Décor Centre Disclaimers" form. This document contains other miscellaneous disclaimers.

This Interior Colour Selection is final and approved by:

Purchaser: [Signature] Date: Apr 16, 2023

Signature: [Signature] Vendor: [Signature]

Lindsay 2017 Developments Inc.

SCHEDULE "B-1"  
Floor Plan

Lot 58  
Phase 1  
Model: Talbot Lake (3703) Elev A 3Bed 2.5Bath  
Standard

SKETCH #1

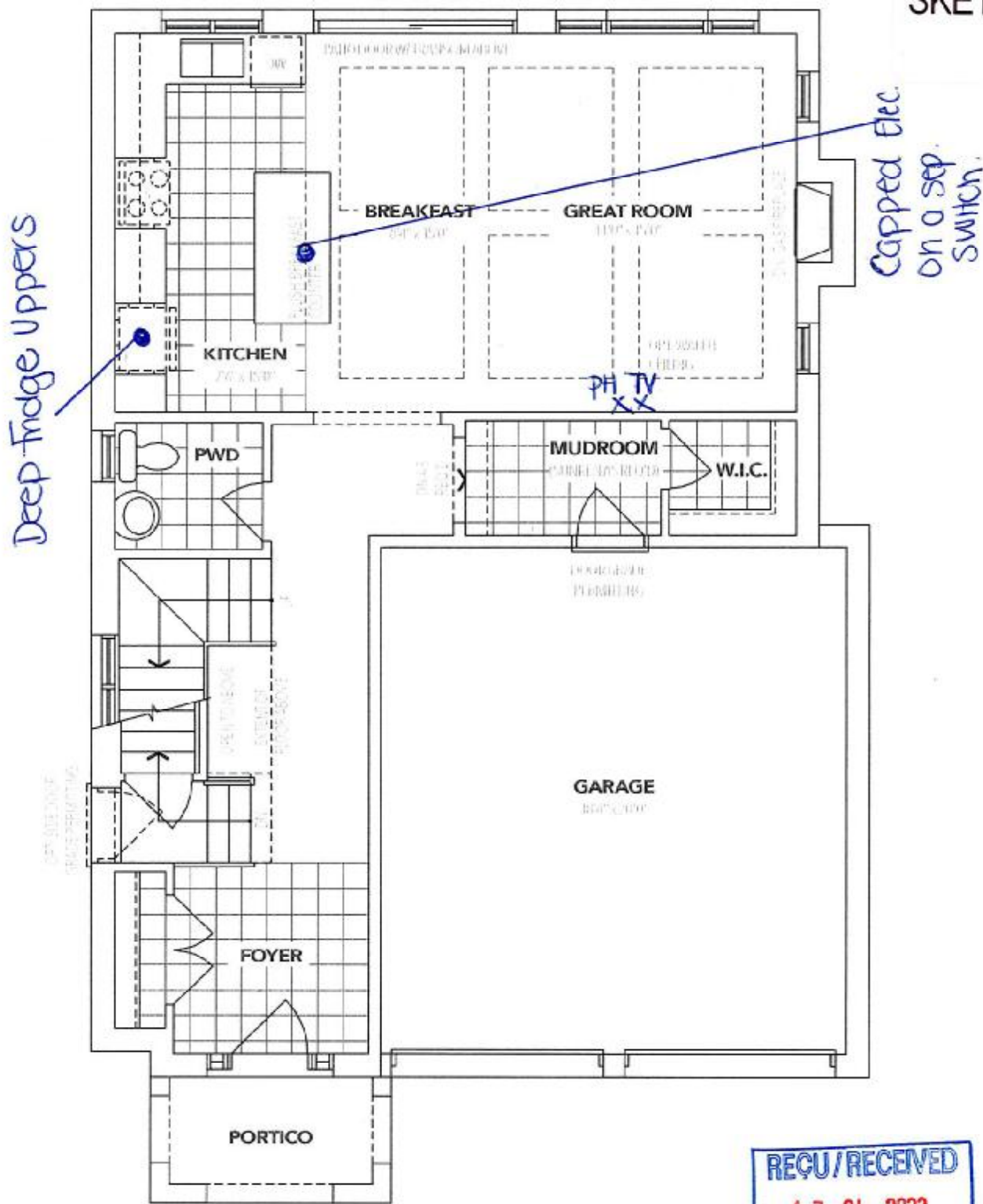

ELEVATION **A** MAIN FLOOR

The floor plans and elevations shown are pre-construction plans and may be revised or improved as necessitated by architectural controls and the construction process. The measurements adhere to the rules and regulations of the TARIION Warranty Corporation's official method for the calculation of floor area. Materials, specifications and floor plans are subject to change without notice. All house renderings are artist's concept only. Actual usable floor space may vary from the stated floor area. All options shown are upgrades. P. & O. E.

Lindsay PH.1 Lot 58

SCHEDULE "B-1"  
Floor Plan

Lot 58  
Phase 1  
Model: Talbot Lake (3703) Elev A 3Bed 2.5Bath  
Standard

SKETCH #2

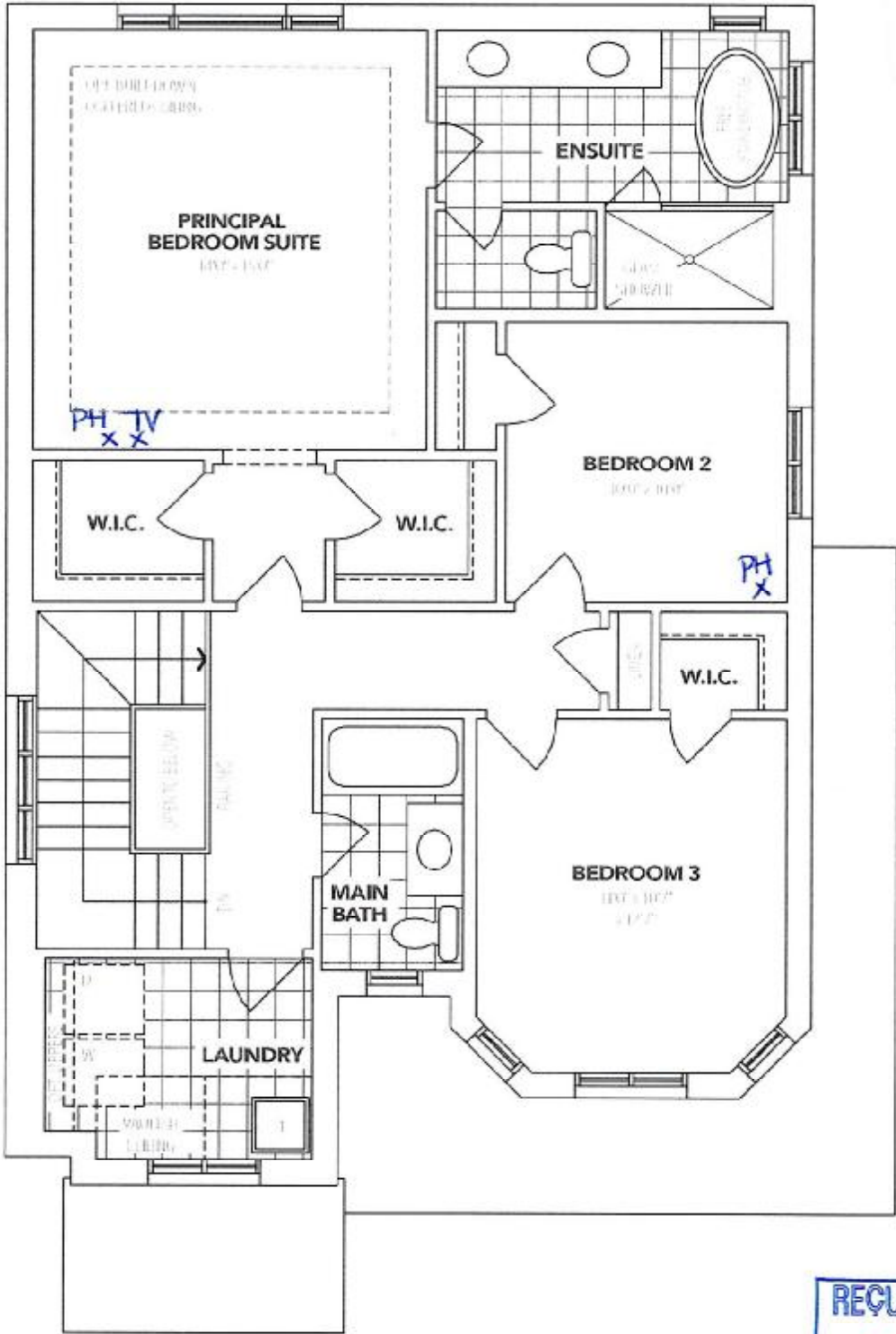

REGU/RECEIVED  
17-04-2023

ELEVATION **A** SECOND FLOOR

The floor plans and elevations shown are pre-construction plans and may be revised or improved as necessitated by architectural controls and the construction process. The measurements adhere to the rules and regulations of the TARION Warranty Corporation's official method for the calculation of floor area. Materials, specifications and floor plans are subject to change without notice. All house renderings are artist's concept only. Actual usable floor space may vary from the stated floor area. All options shown are upgrades. E. & O. E.



Lindsay PH.1 Lot 58

SCHEDULE "B-1"  
Floor Plan

Lot 58  
Phase 1  
Model: Talbot Lake (3703) Elev A 3Bed 2.5Bath  
Standard

SKETCH #3

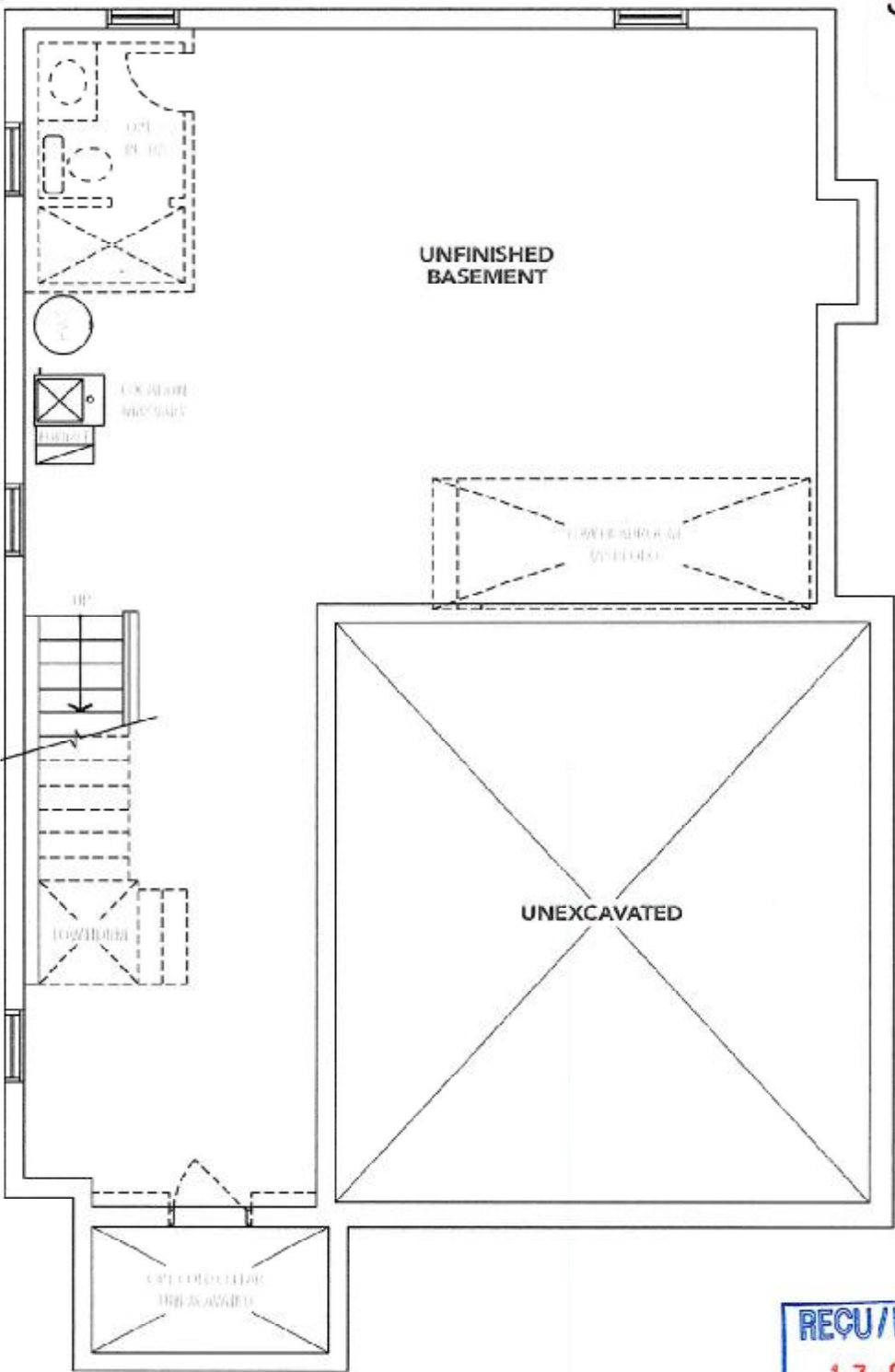

ELEVATION **A** BASEMENT

REC'D/RECEIVED  
17-04-2023

The floor plans and elevations shown are pre-construction plans and may be revised or improved as necessitated by architectural controls and the construction process. The measurements adhere to the rules and regulations of the TARION Warranty Corporation's official method for the calculation of floor area. Materials, specifications and floor plans are subject to change without notice. All house renderings are artist's concept only. Actual usable floor space may vary from the stated floor area. All options shown are upgrades. E. & O. E.



Lindsay ph.1 Lot 58

LOT 58

LINDSAY PHASE 1

RE: UPG KITCHEN SINK

**BLANCO**

Sink Specifications

Colour                      SKU  
brushed finish            401247

Design and planning tips

- Min cabinet size: 36 in ( 915 mm )
- Bowl Depth: 9 in ( 230.0 mm )

Specifications:  
3 1/2" (90 mm) stainless steel strainer(s)  
Installation instructions  
Cut-out template  
Mounting clips  
Limited lifetime warranty

Depending on cabinet construction, a different cabinet size may be required. Consult the cabinet manufacturer.  
Cubed weight: 72 lbs.

QUATRUS U 2

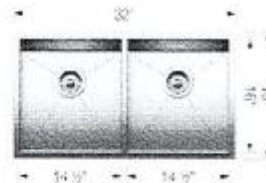

*[Handwritten signature]*