

KINGSMEN (THAMES) INC. / Havelock Corners (Kingsmen)

Lot/Unit: 79    Phase/Building: 5B    Model/Floor Plan: Andrew (3603) Elev B 4 Bed - 2+1 Bath

CABINETRY

Inv.6138	1 - To accomodate for the upgraded 30" Chimney hood fan in the kitchen..	
Line 78016	Note:	
6Apr23 / 14Apr23		

CABINETRY BASE CABINETS

Inv.6138	1 - To supply & install the POTS & PANS DRAWER in the kitchen... see sketch # 1	
Line 78021	Note:	
6Apr23 / 14Apr23		

CABINETRY HOOD FANS

Inv.6138	1 - To supply & install the HOOD FAN - PRO COLLECTION (SCB72230) WALL MOUNT RANGE HOOD WITH 650 CFM FAN - 30 INCH in lieu of the standard hood fan... see spec's	
Line 78015	Note:	
6Apr23 / 14Apr23		

CABINETRY VANITY

Inv.6138	2 - To supply & install a LOWER DRAWER in the powder room... see sketch # 1	
Line 78022	Note:	
6Apr23 / 14Apr23		
Inv.6138	2 - To supply & install TWO VANITY TOP DRAWERS in the main bathroom... see sketch # 2	
Line 78023	Note:	
6Apr23 / 14Apr23		
Inv.6138	1 - To supply & install a VANITY BANK OF DRAWERS in the master ensuite bathroom... see sketch # 2	
Line 78024	Note:	
6Apr23 / 14Apr23		

CABINETRY WALL AND HUTCH

Inv.6138	1 - To supply & install the UPPER ANGLE CORNER PER UNIT - in the kitchen... see sketch # 1	
Line 78018	Note:	
6Apr23 / 14Apr23		
Inv.6138	1 - To supply & install a - CLEAR --Glass door to the upper corner cabinet... see sketch # 1	
Line 78019	Note:	
6Apr23 / 14Apr23		

ELECTRICAL

Inv.6138	1 - To supply & install the standard T.V. rough in in the great room and master bedroom... see sketch # 1 & # 2	
Line 77842	Note: Install the standard T.V. rough in at approx. 66" + - up the floor in the great room and master bedroom... see sketch # 1 & # 2	
6Apr23 / 14Apr23		
Inv.6138	1 - To supply & install the standard Phone ( CAT5 ) rough in in the great room, master bedroom and bedroom # 4 ... see sketch # 1 & # 2	
Line 77843	Note: Install the standard Phone ( CAT 5 ) rough in at approx. 66" + - up the floor in the great room and master bedroom... see sketch # 1 & # 2	
6Apr23 / 14Apr23		

KINGSMEN (THAMES) INC. / Havelock Corners (Kingsmen)

Lot/Unit: 79    Phase/Building: 5B    Model/Floor Plan: Andrew (3603) Elev B 4 Bed - 2+1 Bath

Inv.6138	1 - To SUPPLY AND INSTALL AN ADDITIONAL BASIC RECEPTACLE (NOT DEDICATED) at approx. 66" + - up from the floor centered + - to the F/P mantle	
Line 78010	Note: in the great room... see sketch # 1	
6Apr23 / 14Apr23	This is for a future wall mount T.V. NO CONDUIT PIPE HAS BEEN PURCHASED.	
Inv.6138	1 - To SUPPLY AND INSTALL AN ADDITIONAL BASIC RECEPTACLE (NOT DEDICATED) at approx. 66" + - up from the floor in the master bedroom..see sketch # 2	
Line 78011	Note: This is for a future wall mount T.V. NO CONDUIT PIPE HAS BEEN PURCHASED.	
6Apr23 / 14Apr23		
Inv.6138	1 - Relocate the standard ceiling light from the upper stair landing to the O.T.B. area on the second floor... see sketch # 2	
Line 78012	Note:	
6Apr23 / 14Apr23		

HEATING AND AIR CONDITIONING

Inv.6138	1 - As per schedule "PE": Vendor to install capped gas line ( Rough in only ) at rear of home for future BBQ location. Location to be finalized at vendors sole discretion	
Line 77840	Note:	
6Apr23 / 14Apr23		
Inv.6138	1 - As per schedule "PE": Vendor to supply & install air conditioning unit, sized accordingly, from vendors standard samples.	
Line 77841	Note:	
6Apr23 / 14Apr23		

MISCELLANEOUS

Inv.6138	1 - Do not supply or install the the shelf(s) & rod(s) and double doors to the closet in mud room, close off with a wall, drywalled and painted. To supply & install a door from the dining area into walk in pantry area. ( No cabinets, no countertops,	
Line 78014	Note: no shelves. Still to install the standard light and same standard floor tiles in the mud room and kitchen area... see sketch # 1	
6Apr23 / 14Apr23	THIS IS SUBJECT TO CONSTRUCTION APPROVAL, IF THIS CANNOT BE ACCOMODATED A FULL REFUND WILL BE ISSUED ON CLOSING.	



CONSTRUCTION SUMMARY

KINGSMEN (THAMES) INC. / Havelock Corners (Kingsmen)

Lot/Unit: 79    Phase/Building: 5B    Model/Floor Plan: Andrew (3603) Elev B 4 Bed - 2+1 Bath

EXTRAS AS PER OFFER

5 FREE APPLIANCES ? STAINLESS STEEL FRONT - FRIDGE: STOVE AND DISHWASHER. WHITE WASHER AND DRYER (SUPPLIED ONLY, NOT INSTALLED, FROM BUILDERS STANDARD LINE). AN APPLIANCES VOUCHER WILL BE GIVEN BY OUR DECOR CONSULTANT AT THE TIME OF BOOKING YOUR COLOUR A <i>Worksheet</i> Note:	
5 FREE APPLIANCES – STAINLESS STEEL FRONT - FRIDGE; STOVE AND DISHWASHER. WHITE WASHER AND DRYER (SUPPLIED ONLY, NOT INSTALLED, FROM BUILDERS STANDARD LINE). AN APPLIANCES VOUCHER WILL BE GIVEN BY OUR DECOR CONSULTANT AT THE TIME OF BOOKING YOUR COLOUR A <i>Worksheet</i> Note:	
VENDOR TO INSTALL CAPPED GAS LINE (ROUGH-IN ONLY) AT REAR OF HOME FOR FUTURE BBQ LOCATION.    LOCATION TO BE FINALIZED AT VENDORS SOLE DISCRETION. <i>Worksheet</i> Note:	
VENDOR TO SUPPLY & INSTALL AIR CONDITIONING UNIT, SIZED ACCORDINGLY, FROM VENDORS STANDARD SAMPLES. <i>Worksheet</i> Note:	

APR 14 2023

Purchasers: SUKHWINDER SINGH, & GURPREET KAUR JH

Property: 79 of Plan - Draft Approval SB17-03-08

Telephone Res. / Bus: /

Project: KINGSMEN (THAMES) INC.

Decor Advisor: Barbara Coccia

Model and Elevation: Andrew (3603) Elev B 4 Bed - 2+1 Bath

Layout Changes: ☐ Yes ☒ No

Sketch Attached: ☒ Yes ☐ No

Exterior Colour Scheme:

1. Cabinetry	Style and Colour	Counter Top	Hardware
Kitchen / Breakfast	#3 Muskoka Orchid	# 1, C/S # 3040 Cement 3cm.	# 12843 Handle
Kitchen Island	#3 Muskoka Orchid	# 1, C/S # 3040 Cement 3cm.	# 12843 Handle
Laundry Room	/		
Powder Room	#3 Muskoka Rain Cloud	6698-46 Paloma Polar	#12881 Handle
Main Bathroom	#3 Muskoka Rain Cloud	6698-46 Paloma Polar	# 12843 Handle
Master Ensuite Bathroom	#2 Huron Ontario White	4926K-07 Black Alicante	#12881 Handle
Second Ensuite Bathroom (If Applicable)	/		
	/		
	/		

Appliances

Custom Size Fridge  
☐ Yes ☒ No

Valance Lighting  
☐ Yes ☒ No

Microwave / Range Hood  
☐ Yes ☒ No

Cooktop / Rangetop  
☐ Yes ☒ No

Built in Wall Oven  
☐ Yes ☒ No

Slide-in Range  
☐ Yes ☒ No

Comment  
/

2. Flooring	Selection
Foyer	13 x 13" Malena Ice
Main Hall	13 x 13" Malena Ice
Back Hall	/
Breakfast	/
Laundry Room	13 x 13" Malena Carbon
Kitchen	13 x 13" Malena Ice
Powder Room	13 x 13" Malena Ice
Main Bathroom	13 x 13" Malena Ice
Master Ensuite	13 x 13" Malena Carbon
Bathroom (If Applicable)	/
Mud Room	13 x 13" Malena Ice
Master ens. bathroom	shower floor: 2x2" Onario Snow White matte
Living Room	/
Dining Room	3 1/2" Elements oak natural
Family / Great Room	3 1/2" Elements oak natural
Den / Library / Study	/
Basement Landing (If Applies)	
Lower Landing (If Applicable)	3 1/2" Elements oak natural
Upper Landing	( If applicable ) 3 1/2" Elements oak natural
Upper Hall	Modern Story 1, # 945 Flet Hat
Master Bedroom	Modern Story 1, # 945 Flet Hat
Bedroom #2	Modern Story 1, # 945 Flet Hat
Bedroom #3	Modern Story 1, # 945 Flet Hat
Bedroom #4	Modern Story 1, # 945 Flet Hat
Bedroom #5	/
Master ens. bathroom	Shower jamb: Anatolia Marmiline SNOW



APR 14 2023

Purchasers: SUKHWINDER SINGH, & GURPREET KAUR JH Property: 79 of Plan - Draft Approval SB17-03-08  
Telephone Res. / Bus: / Project: KINGSMEN (THAMES) INC.  
Decor Advisor: Barbara Coccia Model and Elevation: Andrew (3603) Elev B 4 Bed - 2+1 Bath  
2. Flooring - Continued -

Upgrade Underpad	Type	Area
	Standard	2nd. Floor
Carpet on Stairs	Capped	Runner - *Upgrade
Comment	/	/

3. Plumbing Fixtures / Faucets

Kitchen	Standard	Second Ensuite	/	Powder Room	Standard
Master Ensuite	Standard			Other Room	/
Main Bathroom	Standard		/		
Comment	Stfill to install the standard top mount kitchen sink with the standard kitchen faucet.				

4. Wall Tile

	Tile Selection	Listello	Insert	Insert Selection
Main Bathroom	8x10" Malena Ice	<input type="checkbox"/>	<input type="checkbox"/>	
Master Ensuite				
Tub Deck	13 x13" Malena Carbon	<input type="checkbox"/>	<input type="checkbox"/>	
Tub Apron	13 x13" Malena Carbon	<input type="checkbox"/>	<input type="checkbox"/>	
Tub Surround	13 x13" Malena Carbon	<input type="checkbox"/>	<input type="checkbox"/>	
Shower Stall	8x10" Malena Ice	<input type="checkbox"/>	<input type="checkbox"/>	
Second Ensuite	/	<input type="checkbox"/>	<input type="checkbox"/>	
	/	<input type="checkbox"/>	<input type="checkbox"/>	
	/	<input type="checkbox"/>	<input type="checkbox"/>	
Kitchen Backsplash	/	<input type="checkbox"/>	<input type="checkbox"/>	
Complete Backsplash	/	<input type="checkbox"/>	<input type="checkbox"/>	
Comment	Install the standard 8x10" wall tiles on the 10" side stacked horizontally in the bathrooms where applicable.			

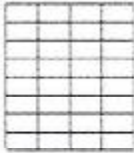

horizontal stacked

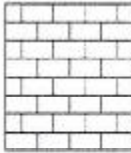

brick pattern



vertical stacked



diagonal/diamond

5. Fireplace

	Living Room			Family Room			Other Room - Specify Great Room		
	Purchased	As Per Plan	N/A	Purchased	As Per Plan	N/A	Purchased	As Per Plan	N/A
Fireplace Type	<input type="radio"/>	<input type="radio"/>	<input checked="" type="radio"/>	<input type="radio"/>	<input type="radio"/>	<input checked="" type="radio"/>	<input type="radio"/>	<input checked="" type="radio"/>	<input type="radio"/>
Mantle Type							Front Facing		
Over Mantle							NF-08		
Colour / Stain							/		
Surround							White		
Hearth							/		
Comment	/								

Initial:

Initials: [Signature]

APR 14 2023

Purchasers: SUKHWINDER SINGH, & GURPREET KAUR JI-Property: 79 of Plan - Draft Approval SB17-03-08  
Telephone Res. / Bus: / Project: KINGSMEN (THAMES) INC.  
Decor Advisor: Barbara Coccia Model and Elevation: Andrew (3603) Elev B 4 Bed - 2+1 Bath

6. Trim Carpentry

Door Hardware

Standard Handle

Interior Trim

Standard

Comment

/

Interior Doors

☐ 2 Panel Arch Top

☒ 2 Panel Square Top

☐ 6 Panel



Initial for Door Style



7. Railings and Pickets

Railing Package

Standard oak TURNED picket package

Railing Colour

Elements Natural

Wood Stairs

☐ No☒ Oak

Picket Colour

Elements Natural

Tread Colour

Elements Natural

Comment

/

8. Plaster Mouldings and Medallions

Foyer	/	Kitchen/Breakfast	/
Main Hall	/	Den/Library	/
Living Room	/	Lower Landing	/
Dining Room	/		/
Family Room	/		/

Comment

/

9. Wall Paint

Kingsmen White

Smooth Ceilings

☐ First Floor

☐ First Floor incl. Second Floor Hall

☐ First and Second Floor

☒ Throughout

☐ Not Applicable

Trim Paint

Kingsmen White

10. Additional Comments



/

11. Disclaimers and Notes

- 1) Colours of all materials are as close as possible to builder's selection, but not necessarily identical due to variances in manufacturing.

2) Any extras listed above are null and void unless accompanied by a separate invoice/amendment. Said invoice must be paid in full.

3) The Purchaser acknowledges that after Interior Colour Selection form is signed and dated, no further changes will be permitted other than re-selection due to unavailability.

4) The Purchaser acknowledges reading and accepting the "Kingsmen Group Décor Centre Disclaimers" form. This document contains other miscellaneous disclaimers.
- 

Purchaser's Initials

This Interior Colour Selection is final and approved by:

Purchaser:

Signature:  Date: 04/14/23

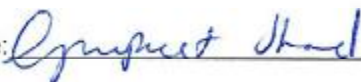
Signature:  Date: April 14, 2023

Vendor:   
KINGSMEN (THAMES) INC.



APR 14 2023

5B-LOT 7'

LOT: 79  
THAMES PH. 5B  
SKETCH #1

Bottom  
Drawer  
Not to scale.

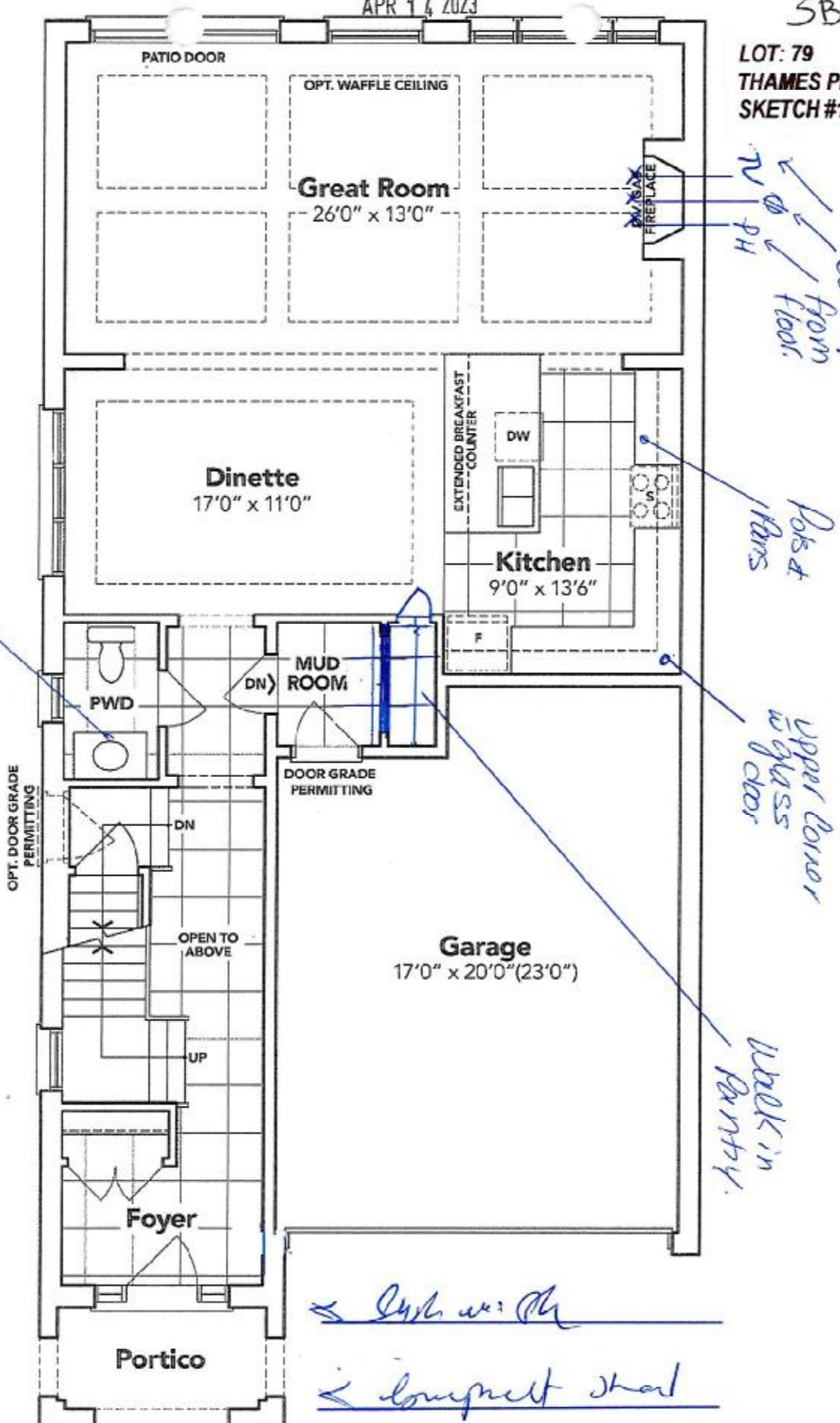

## GROUND FLOOR EL. B

The floor plans and elevations shown are pre-construction plans and may be revised or improved as necessitated by architectural controls and the construction process. The measurements adhere to the rules and regulations of the TARION Warranty Corporation's official method for the calculation of floor area. Materials, specifications and floor plans are subject to change without notice. All house renderings are artist's concept only. Actual usable floor space may vary from the stated floor area. All options shown are upgrades. E. & O. E.

APR 14 2023

5B-Lot 79

LOT: 79  
THAMES PH. 5B  
SKETCH #2

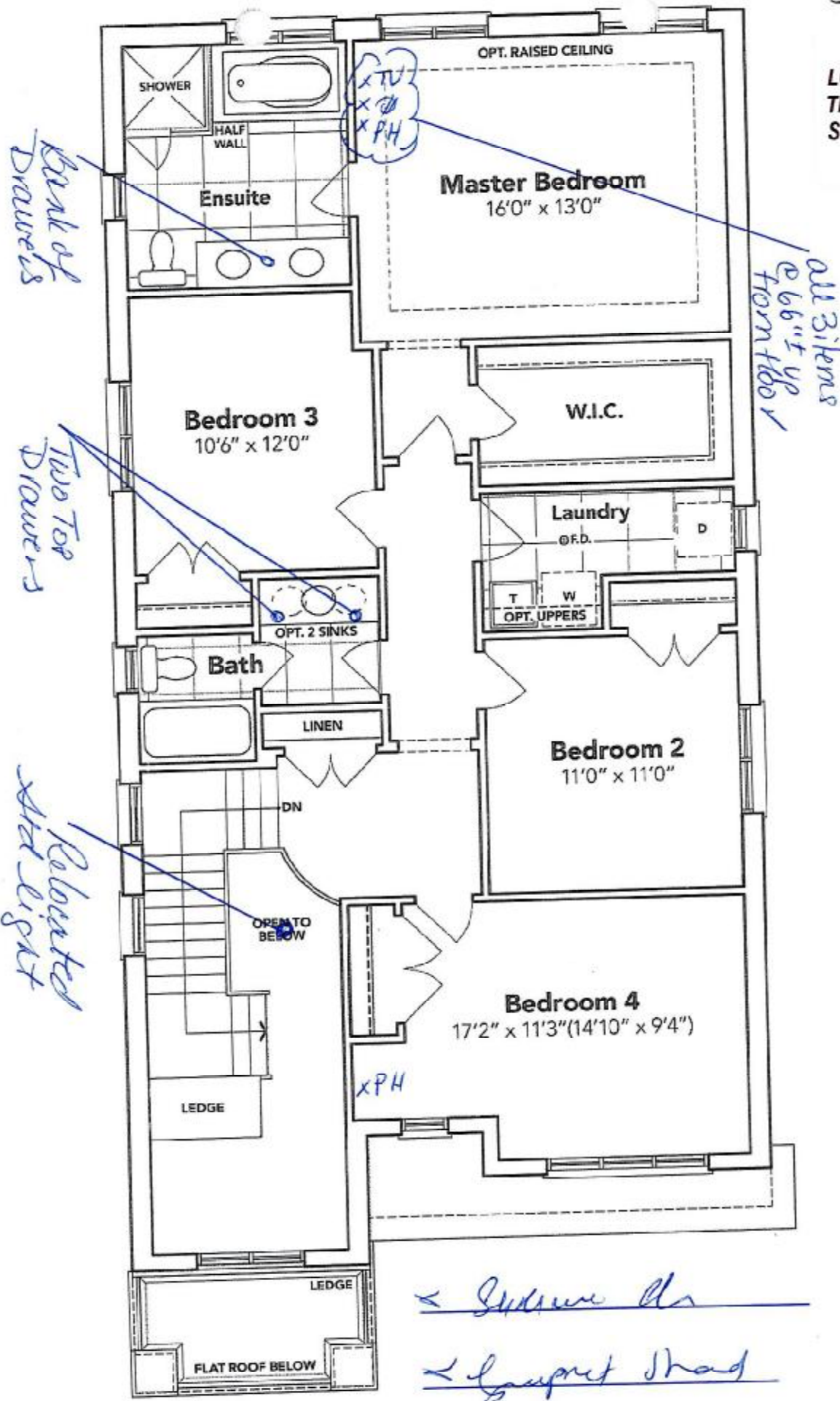

## SECOND FLOOR EL. B

The floor plans and elevations shown are pre-construction plans and may be revised or improved as necessitated by architectural controls and the construction process. The measurements adhere to the rules and regulations of the TARIION Warranty Corporation's official method for the calculation of floor area. Materials, specifications and floor plans are subject to change without notice. All house renderings are artist's concept only. Actual usable floor space may vary from the stated floor area. All options shown are upgrades. E. & O. E.



LOT: 79  
THAMES PH. 5B  
SKETCH #3

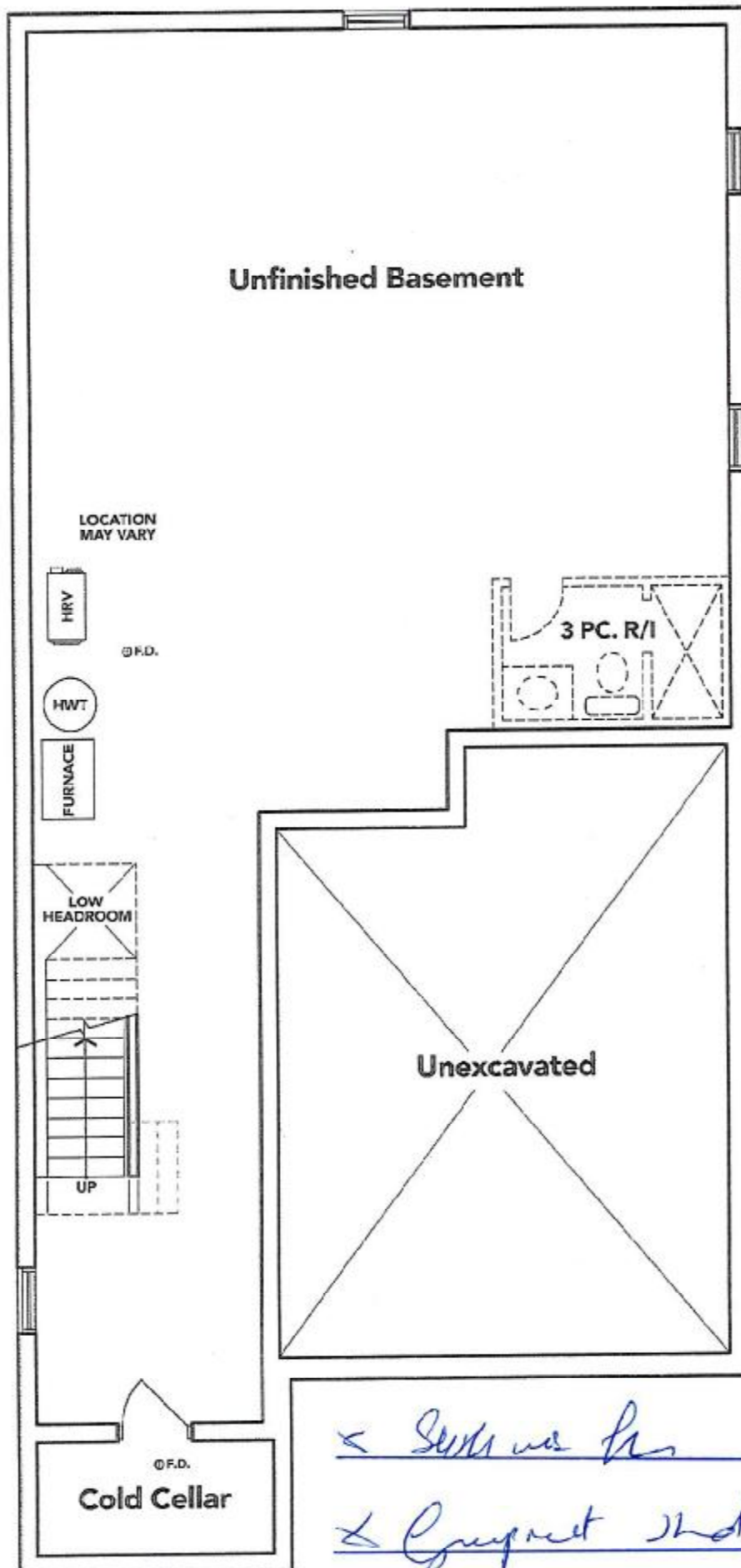

< Sewer was for  
< Gas meter and

**BASEMENT EL. B**

The floor plans and elevations shown are pre-construction plans and may be revised or improved as necessitated by architectural controls and the construction process. The measurements adhere to the rules and regulations of the TARIION Warranty Corporation's official method for the calculation of floor area. Materials, specifications and floor plans are subject to change without notice. All house renderings are artist's concept only. Actual usable floor space may vary from the stated floor area. All options shown are upgrades. E. & O. E.

Specifications

Air Flow Volume: 650 CFM (2000 CFM)  
Electrical Connection: 120V/60Hz  
Power Consumption: 240 Watts (200 Watts)  
Current: 2.0 Amps (1.8 Amps)  
Fan Speed: 1599 RPM (1350 RPM)  
Finishes: Stainless Steel  
Duct: 6" Round  
Dimensions: Width: 30"/36"  
Height: 44 1/2"  
Depth: 19 3/4"  
Noise Level: Min. 2 Sones  
Max. 7 Sones (4 Sones)

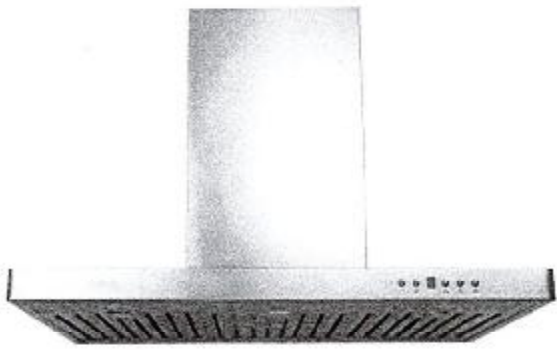

Baffle Filter



Ordering Model Chart

Model	Colour	Duct	Size	Filter	CFM
SCB72230	Stainless Steel	6"	30"	Baffle	650
SCB72236	Stainless Steel	6"	36"	Baffle	650
SCB32230	Stainless Steel	6"	30"	Baffle	300
SCB32236	Stainless Steel	6"	36"	Baffle	300

Notes

X. Gurbob Ali

X. Gurbat Mag

