

Lindsay 2017 Developments Inc. / Sugarwood

Lot/Unit: 26 Phase/Building: 1 Model/Floor Plan: Lovesick Lake (3705) Elev B 4Bed
2.5Bath

CABINETRY VANITY

Inv.6109	1 - TO INCREASE VANITY TO KITCHEN HEIGHT 90CM HIGH - MAINTAINS VANITY DEPTH - CLASSIC SERIES IN THE MASTER ENSUITE	
Line 77638	Note:	
15Mar23 / 20Apr23		
Inv.6109	1 - TO SUPPLY INCREASE VANITY TO KITCHEN HEIGHT - 90CM HIGH - MAINTAINS VANITY DEPTH - CLASSIC SERIES IN THE MAIN BATHROOM	
Line 77639	Note:	
15Mar23 / 20Apr23		

ELECTRICAL

Inv.6109	1 - To supply and install the standard TV Rough-in, in the Great Room and Master Bedroom.. see sketch #1 for details	
Line 77622	Note:	
15Mar23 / 20Apr23		
Inv.6109	1 - To supply and install the standard PHONE (CAT 5) Rough-in, in the Great Room, Master Bedroom, and Bedroom #3... see sketch #1 for details	
Line 77623	Note:	
15Mar23 / 20Apr23		
Inv.6109	1 - TO SUPPLY AND INSTALL AN ADDITIONAL BASIC RECEPTACLE (NOT DEDICATED) AT APPROX. 66" UP FROM THE FLOOR OVER THE F/P MANTLE IN THE GREAT ROOM NEXT TO +- THE STANDARD PHONE AND TV ROUGH-IN.. SEE SKETCH #1	
Line 77630	Note:	
15Mar23 / 20Apr23		

HARDWOOD

Inv.6109	1 - TO SUPPLY AND INSTALL 3 1/2" ELEMENTS OAK WOLFHOUND HARDWOOD ON THE MAIN FLOOR IN LIEU OF THE STANDARD.. SEE COLOUR CHART FOR DETAILS	
Line 77637	Note:	
15Mar23 / 20Apr23		

MISCELLANEOUS

PAINT AND DRYWALL

Inv.6109	1 - TO SUPPLY AND INSTALL A STAIN TO THE STAIRCASE IN LIEU OF THE STANDARD STAIN.. SEE COLOUR CHART FOR DETAILS	
Line 77636	Note:	
15Mar23 / 20Apr23		

EXTRAS AS PER OFFER

Lindsay PH.1 Lot 26

KINGSIIEN
GROUP INC.**INTERIOR COLOUR SCHEME****Purchaser:** DOMINIQUE CHANELLE CHEVERS**Property:** 26 of Plan -**Telephone Res. / Bus:** (647) 468-8704 /**Project:** Lindsay 2017 Developments Inc.**Decor Advisor:** Samantha Castelli**Model and Elevation:** Lovesick Lake (3705) Elev B 4Bed 2.5Bath**Layout Changes:** ☐ Yes ☒ No**Sketch Attached:** ☒ Yes ☐ No**Exterior Colour Scheme:** **1. Cabinetry**

	Style and Colour	Counter Top	Hardware
Kitchen / Breakfast	#3 Simcoe Rain Cloud	#1 C/S #9141 ICE SNOW	135 KNOB
Kitchen Island	#3 Simcoe Rain Cloud	#1 C/S #9141 ICE SNOW	135 KNOB
Laundry Room	/	/	/
Powder Room	/	/	/
Main Bathroom	#3 Simcoe Rain Cloud	Paloma Polar 6698-46	135 KNOB
Master Ensuite Bathroom	#3 Simcoe Rain Cloud	Paloma Polar 6698-46	135 KNOB
Second Ensuite Bathroom (If Applicable)	/	/	/

Appliances**Custom Size Fridge**☐ Yes ☒ No**Valance Lighting**☐ Yes ☒ No**Microwave / Range Hood**☐ Yes ☒ No**Cooktop / Rangetop**☐ Yes ☒ No**Built in Wall Oven**☐ Yes ☒ No**Slide-in Range**☐ Yes ☒ No**Comment**

REC'D/RECEIVED

24-04-2023

2. Flooring

	Selection
Foyer	13x13" Keaton Ice
Main Hall	**3 1/2" Elements Oak Wolfhound
Back Hall	/
Breakfast	13x13" Keaton Ice
Laundry Room	13x13" Keaton Ice
Kitchen	13x13" Keaton Ice
Powder Room	13x13" Keaton Ice
Main Bathroom	13x13" Keaton Ice
Master Ensuite	13x13" Keaton Ice
Bathroom (If Applicable)	/
Mud Room	13x13" Keaton Ice
Master Ens. Shower Floor	Anatolia Marmiline SNOW
Living Room	/
Dining Room	/
Family / Great Room	**3 1/2" Elements Oak Wolfhound
Den / Library / Study	/
Basement Landing (If Applies)	/
Lower Landing (If Applicable)	**3 1/2" Elements Oak Wolfhound
Upper Landing	**3 1/2" Elements Oak Wolfhound
Upper Hall	Opening Night: 03
Master Bedroom	Opening Night: 03
Bedroom #2	Opening Night: 03
Bedroom #3	Opening Night: 03
Bedroom #4	Opening Night: 03
Bedroom #5	/
Master Ens. Shower Jamb	Anatolia Marmiline SNOW

Flooring Continued on Page 2

Initial:

Page 1 of 3

KINGSIIEN
GROUP INC.**INTERIOR COLOUR SCHEME****Purchaser:** DOMINIQUE CHANELLE CHEVERS**Property:** 26 of Plan -**Telephone Res. / Bus:** (647) 468-8704 /**Project:** Lindsay 2017 Developments Inc.**Decor Advisor:** Samantha Castelli**Model and Elevation:** Lovesick Lake (3705) Elev B 4Bed 2.5Bath**2. Flooring - Continued**

Upgrade Underpad	Type	Area
	Standard	SECOND FLOOR
Carpet on Stairs	Capped	Runner - *Upgrade
Comment		

3. Plumbing Fixtures / Faucets

Kitchen	Standard	Second Ensuite		Powder Room	Standard
Master Ensuite	Standard			Other Room	
Main Bathroom	Standard				

Comment



NOTE TO SUPPLY AND INSTALL THE STANDARD TOPMOUNT SINK, WITH THE STANDARD FAUCET IN THE KITCHEN.
TO SUPPLY AND INSTALL THE STANDARD PLUMBING FIXTURES IN ALL BATHROOMS.

RECU/RECEIVED

24-04-2023

4. Wall Tile

	Tile Selection	Listello	Insert	Insert Selection
Main Bathroom	8x10" Keaton Ice	<input type="checkbox"/>	<input type="checkbox"/>	
Master Ensuite		<input type="checkbox"/>	<input type="checkbox"/>	
Tub Deck		<input type="checkbox"/>	<input type="checkbox"/>	
Tub Apron		<input type="checkbox"/>	<input type="checkbox"/>	
Tub Surround		<input type="checkbox"/>	<input type="checkbox"/>	
Shower Stall	8x10" Keaton Ice	<input type="checkbox"/>	<input type="checkbox"/>	
Second Ensuite		<input type="checkbox"/>	<input type="checkbox"/>	
Kitchen Backsplash		<input type="checkbox"/>	<input type="checkbox"/>	
Complete Backsplash		<input type="checkbox"/>	<input type="checkbox"/>	
Comment				

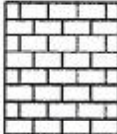
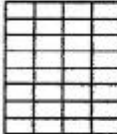

horizontal stacked brick pattern vertical stacked diagonal/diamond

5. Fireplace

	Living Room			Family Room			Other Room - Specify Great Room		
	Purchased	As Per Plan	N/A	Purchased	As Per Plan	N/A	Purchased	As Per Plan	N/A
	<input type="radio"/>	<input type="radio"/>	<input type="radio"/>	<input type="radio"/>	<input type="radio"/>	<input type="radio"/>	<input type="radio"/>	<input checked="" type="radio"/>	<input type="radio"/>
Fireplace Type							Front Facing		
Mantle Type							NF-08		
Over Mantle							/		
Colour / Stain							White		
Surround									
Hearth									
Comment									

Initial:

DS

Page 2 of 3

KINGSMEN
GROUP INC.**INTERIOR COLOUR SCHEME****Purchaser:** DOMINIQUE CHANELLE CHEVERS**Property:** 26 of Plan -**Telephone Res. / Bus:** (647) 468-8704 /**Project:** Lindsay 2017 Developments Inc.**Decor Advisor:** Samantha Castelli**Model and Elevation:** Lovesick Lake (3705) Elev B 4Bed 2.5Bath**6. Trim Carpentry****Door Hardware** Standard Handle**Interior Trim** Standard**Comment****Interior Doors**☐ 2 Panel Arch Top☒ 2 Panel Square Top☐ 6 Panel

Initial for Door Style

**7. Railings and Pickets****Railing Package** Standard Turned Oak Pickets**Railing Colour** Elements Oak Wolfhound**Picket Colour** Elements Oak Wolfhound**Wood Stairs** ☐ No ☒ Oak**Tread Colour** Elements Oak Wolfhound**Comment****8. Plaster Mouldings and Medallions****Foyer****Main Hall****Living Room****Dining Room****Family Room****Kitchen/Breakfast****Den/Library****Lower Landing****Comment**

REC'D/RECEIVED

24-04-2023

9. Wall Paint

Kingsmen White

Smooth Ceilings☐ First Floor☐ First Floor incl. Second Floor Hall☐ First and Second Floor☒ Throughout☐ Not Applicable**Trim Paint** Kingsmen White**10. Additional Comments****11. Disclaimers and Notes**

- 1) Colours of all materials are as close as possible to builder's selection, but not necessarily identical due to variances in manufacturing.
- 2) Any extras listed above are null and void unless accompanied by a separate invoice/amendment. Said invoice must be paid in full.
- 3) The Purchaser acknowledges that after Interior Colour Selection form is signed and dated, no further changes will be permitted other than re-selection due to unavailability.  Purchaser's Initials
- 4) The Purchaser acknowledges reading and accepting the "Kingsmen Group Décor Centre Disclaimers" form. This document contains other miscellaneous disclaimers.

This Interior Colour Selection is final and approved by:**Purchaser:** DocuSigned by:

4/23/2023

Signature: **Date:**

8044C45561DA497...

Vendor: 

Lindsay 2017 Developments Inc.

April 25/23

Lindsay pt. 1 Lot 26

SCHEDULE "B-1"
Floor Plan

Lot 26
Phase 1
Model: Lovesick Lake (3705) Elev B 4Bed 2.5Bath
Standard

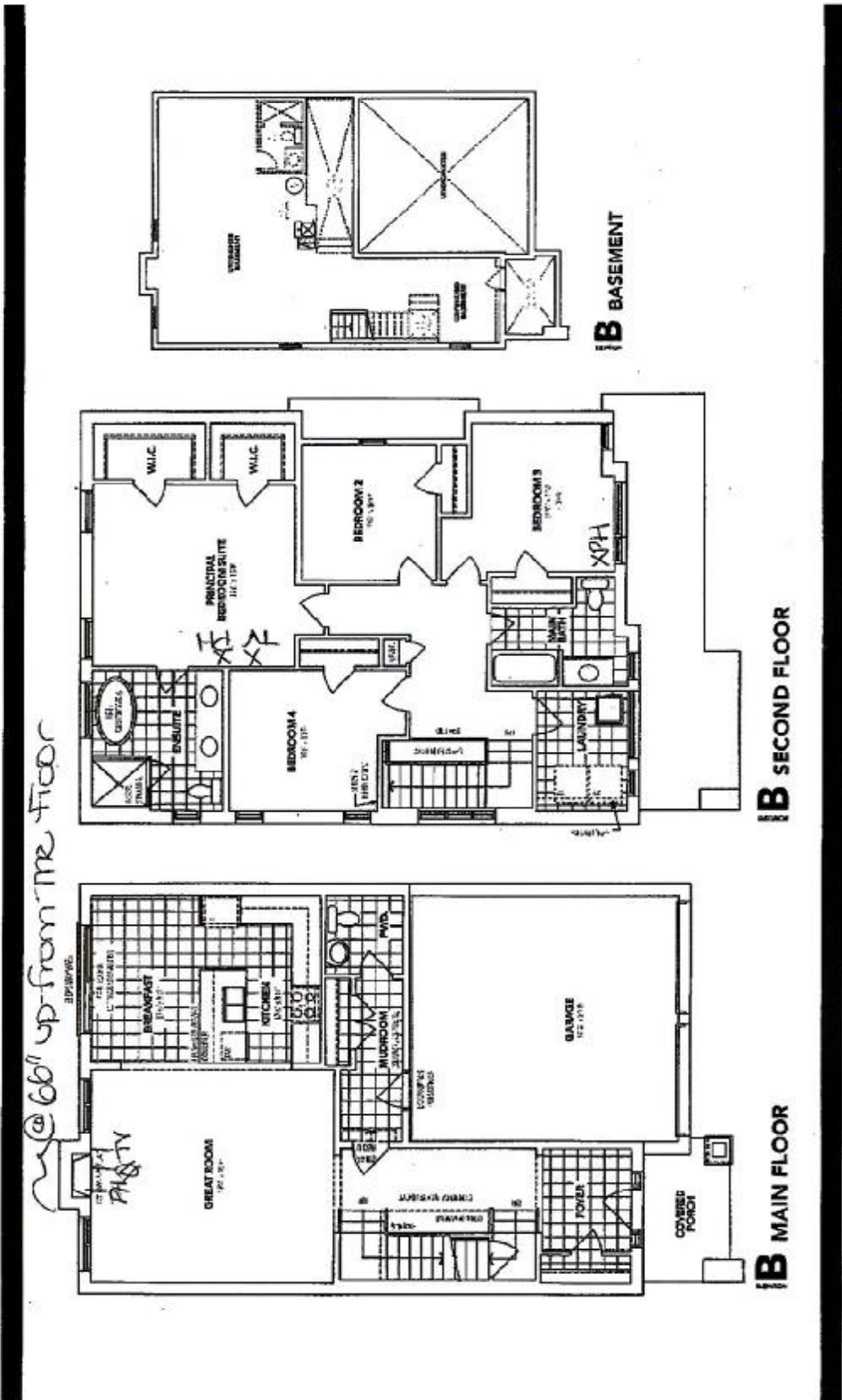

The floor plans and elevations shown are pre-construction plans and may be revised or improved as necessitated by architectural controls and the construction process. The measurements adhere to the rules and regulations of the TARIION Warranty Corporation's official method for the calculation of floor area. Materials, specifications and floor plans are subject to change without notice. All house renderings are artist's concept only. Actual usable floor space may vary from the stated floor area. All options shown are upgrades. E. & O. E.

DS

DS