



CONSTRUCTION SUMMARY

Lindsay 2017 Developments Inc. / Sugarwood

Lot/Unit: 60    Phase/Building: 1    Model/Floor Plan: Silver Lake (3702) Elev B 3Bed 2.5Bath

DOORS AND WINDOWS

ELECTRICAL

Inv. 6170	1 - TO SUPPLY AND INSTALL THE STANDARD TV ROUGH-IN, IN THE GREAT ROOM AND MASTER BEDROOM.. SEE SKETCH #2	
Line 78156	Note:	
17Apr23 / 20Apr23		
Inv. 6170	1 - TO SUPPLY AND INSTALL THE STANDARD PHONE ROUGH-IN, IN THE GREAT ROOM, MASTER BEDROOM AND BEDROOM #3.. SEE SKETCH #2	
Line 78157	Note:	
17Apr23 / 20Apr23		

MISCELLANEOUS

PLUMBING

EXTRAS AS PER OFFER

**KINGSIIEN**  
GROUP INC.

## INTERIOR COLOUR SCHEME

Lindsay PH.1 Lot 60

Purchasers: RAVINDER, PAL, SINGH GULATI &amp; DHIRENDRA Property: 60 of Plan -

Telephone Res. / Bus: (647) 892-9224 /

Project: Lindsay 2017 Developments Inc.

Decor Advisor: Samantha Castelli

Model and Elevation: Silver Lake (3702) Elev B 3Bed 2.5Bath

Layout Changes: ☐ Yes ☒ NoSketch Attached: ☒ Yes ☐ NoExterior Colour Scheme: 

## 1. Cabinetry

	Style and Colour	Counter Top	Hardware
Kitchen / Breakfast	#3 Charleston 3DL ORCHID	#1 C/S #9141 ICE SNOW	9661 HANDLE
Kitchen Island	#3 Charleston 3DL ORCHID	#1 C/S #9141 ICE SNOW	9661 HANDLE
Laundry Room	/	/	/
Powder Room	/	/	/
Main Bathroom	#3 Charleston 3DL ORCHID	Paloma Polar 6698-46	9661 HANDLE
Master Ensuite Bathroom	#3 Charleston 3DL ORCHID	Paloma Polar 6698-46	9661 HANDLE
Second Ensuite Bathroom (If Applicable)			

## Appliances

## Custom Size Fridge

☐ Yes ☒ No

## Valance Lighting

☐ Yes ☒ No

## Microwave / Range Hood

☐ Yes ☒ No

## Cooktop / Rangetop

☐ Yes ☒ No

## Built in Wall Oven

☐ Yes ☒ No

## Slide-in Range

☐ Yes ☒ No

## Comment

REQD/RECEIVED

24-04-2023

## 2. Flooring

	Selection
Foyer	13x13" Cinq White
Main Hall	3 1/2" Elements Oak Natural
Back Hall	/
Breakfast	13x13" Cinq White
Laundry Room	/
Kitchen	13x13" Cinq White
Powder Room	13x13" Cinq White
Main Bathroom	13x13" Cinq White
Master Ensuite	13x13" Cinq White
Bathroom (If Applicable)	/
Mud Room	/
Master Ens. Shower Floor	2x2" Ontario Snow White Matte
Living Room	/
Dining Room	/
Family / Great Room	3 1/2" Elements Oak Natural
Den / Library / Study	/
Basement Landing (If Applies)	/
Lower Landing (If Applicable)	3 1/2" Elements Oak Natural
Upper Landing	3 1/2" Elements Oak Natural
Upper Hall	Opening Night: 04
Master Bedroom	Opening Night: 04
Bedroom #2	Opening Night: 04
Bedroom #3	Opening Night: 04
Bedroom #4	/
Bedroom #5	/
Master Ens. Shower Jamb	Anatolia Marmiline SNOW

Flooring Continued on Page 2

Initial:

DS  
Dkg RPSG

Page 1 of 3



**KINGSIIEN**  
GROUP INC.

## INTERIOR COLOUR SCHEME

Lindsay Ph.1 Lot 60

Purchasers: RAVINDER, PAL, SINGH GULATI &amp; DHIRENDRA Property: 60 of Plan -

Telephone Res. / Bus: (647) 892-9224 /

Project: Lindsay 2017 Developments Inc.

Decor Advisor: Samantha Castelli

Model and Elevation: Silver Lake (3702) Elev B 3Bed 2.5Bath

## 2. Flooring - Continued

Upgrade Underpad	Type STANDARD	Area 2ND FLOOR
Carpet on Stairs	Capped	Runner - *Upgrade
Comment		

## 3. Plumbing Fixtures / Faucets

Kitchen	STANDARD	Second Ensuite		Powder Room	STANDARD
Master Ensuite	STANDARD			Other Room	
Main Bathroom	STANDARD				

## Comment

NOTE: TO SUPPLY AND INSTALL THE STANDARD TOPMOUNT KITCHEN SINK, WITH THE STANDARD FAUCET. TO SUPPLY AND INSTALL ALL STANDARD PLUMBING FIXTURES IN ALL BATHROOMS.



REQD/RECEIVED

24-04-2023

## 4. Wall Tile

	Tile Selection	Listello	Insert	Insert Selection
Main Bathroom	8x10" Cinq White	<input type="checkbox"/>	<input type="checkbox"/>	
Master Ensuite				
Tub Deck		<input type="checkbox"/>	<input type="checkbox"/>	
Tub Apron		<input type="checkbox"/>	<input type="checkbox"/>	
Tub Surround		<input type="checkbox"/>	<input type="checkbox"/>	
Shower Stall	8x10" Cinq White	<input type="checkbox"/>	<input type="checkbox"/>	
Second Ensuite		<input type="checkbox"/>	<input type="checkbox"/>	
		<input type="checkbox"/>	<input type="checkbox"/>	
Kitchen Backsplash		<input type="checkbox"/>	<input type="checkbox"/>	
Complete Backsplash		<input type="checkbox"/>	<input type="checkbox"/>	

Comment

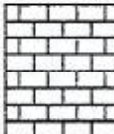
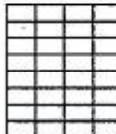

horizontal stacked    brick pattern    vertical stacked    diagonal/diamond

## 5. Fireplace

	Living Room			Family Room			Other Room - Specify		
	Purchased	As Per Plan	N/A	Purchased	As Per Plan	N/A	Purchased	As Per Plan	N/A
Fireplace Type	<input type="radio"/>	<input type="radio"/>	<input type="radio"/>	<input type="radio"/>	<input type="radio"/>	<input type="radio"/>	<input type="radio"/>	<input type="radio"/>	<input checked="" type="radio"/>
Mantle Type									
Over Mantle									
Colour / Stain									
Surround									
Hearth									
Comment									

Initial:

DS  
DEG RPSG

Page 2 of 3

**KINGSMEN**  
GROUP INC.**INTERIOR COLOUR SCHEME**

Lindsay ph.1 Lot 610

**Purchasers:** RAVINDER, PAL, SINGH GULATI & DHIRENDRA Property: 60 of Plan -**Telephone Res. / Bus:** (647) 892-9224 /**Project:** Lindsay 2017 Developments Inc.**Decor Advisor:** Samantha Castelli**Model and Elevation:** Silver Lake (3702) Elev B 3Bed 2.5Bath**6. Trim Carpentry****Door Hardware** STANDARD HANDLE**Interior Trim** STANDARD**Comment****Interior Doors**☐ 2 Panel Arch Top☒ 2 Panel Square Top☐ 6 PanelDS  
D&G RPSG

Initial for Door Style

**7. Railings and Pickets****Railing Package** STANDARD TURNED OAK PICKETS**Railing Colour** ELEMENTS NATURAL**Picket Colour** ELEMENTS NATURAL**Wood Stairs** ☐ No ☒ Oak**Tread Colour** ELEMENTS NATURAL**Comment****8. Plaster Mouldings and Medallions****Foyer****Main Hall****Living Room****Dining Room****Family Room****Kitchen/Breakfast****Den/Library****Lower Landing****Comment**

REGU/RECEIVED

24-04-2023

**9. Wall Paint**

KINGSMEN WHITE

**Smooth Ceilings**☐ First Floor☐ First Floor incl. Second Floor Hall☐ First and Second Floor☒ Throughout☐ Not Applicable**Trim Paint** KINGSMEN WHITE**10. Additional Comments****11. Disclaimers and Notes**

- Colours of all materials are as close as possible to builder's selection, but not necessarily identical due to variances in manufacturing.
- Any extras listed above are null and void unless accompanied by a separate invoice/amendment. Said invoice must be paid in full.
- The Purchaser acknowledges that after Interior Colour Selection form is signed and dated, no further changes will be permitted other than re-selection due to unavailability. *D&G RPSG* Purchaser's Initials
- The Purchaser acknowledges reading and accepting the "Kingsmen Group Décor Centre Disclaimers" form. This document contains other miscellaneous disclaimers.

This Interior Colour Selection is final and approved by:

Purchaser:

Signature: *Dhirendra kaur GULATI* Date: 4/20/2023

DocuSigned by:

Signature: *Ravinder Pal Singh GULATI* Date: 4/20/2023

DocuSigned by:

Vendor:

Lindsay 2017 Developments Inc.

April 25/23

Page 3 of 3



Lindsay PH.1 Lot 60

DS  
DkG

DS  
RPSG

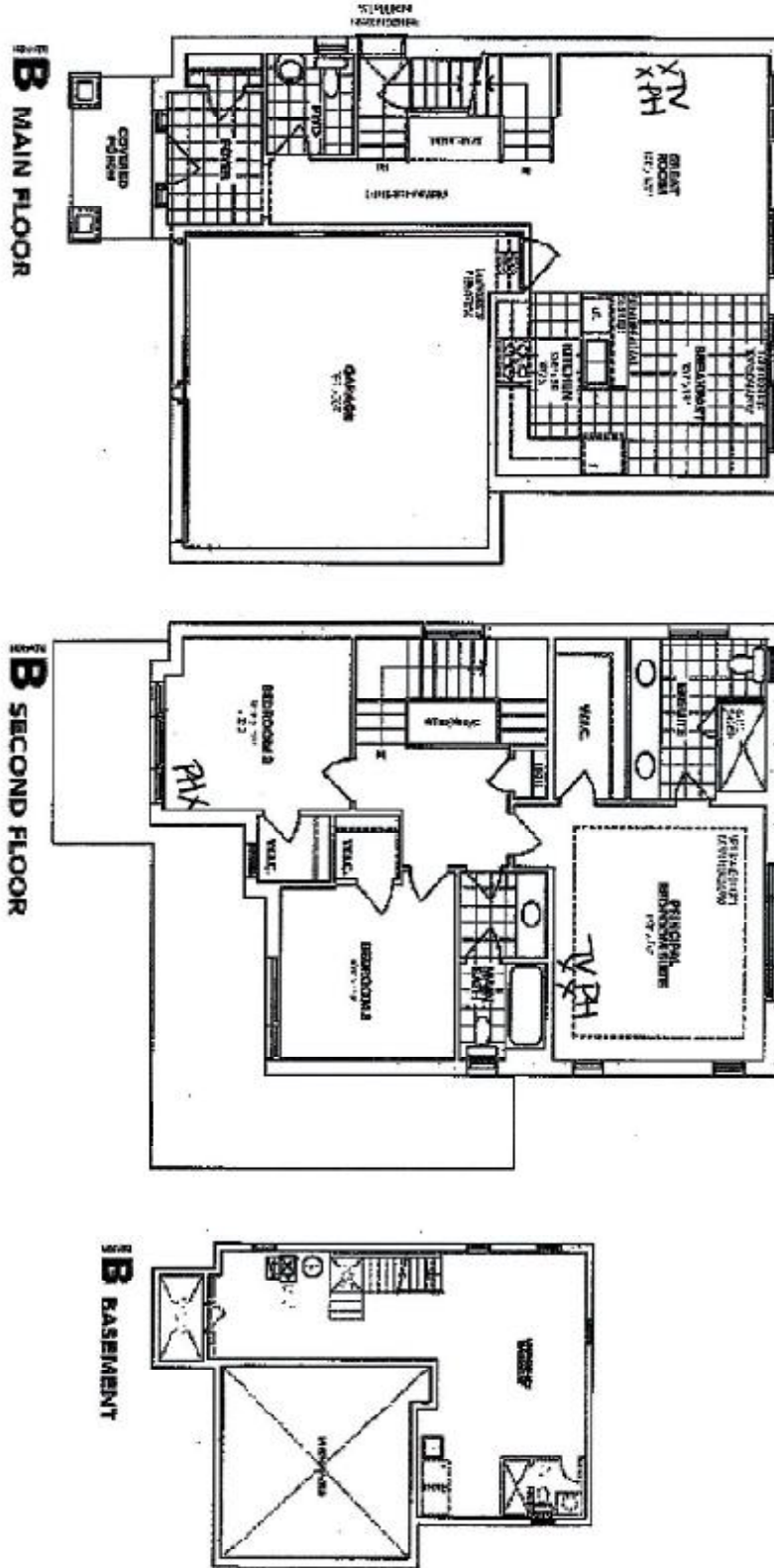

Lot 60  
Phase 1  
Model: Silver Lake (3792) Elev B 3Bed 2.5Bath  
Standard

SKETCH #2

REC'D / RECEIVED  
24-04-2023

SCHEDULE "B"  
Floor Plan