

KINGSMEN (THAMES) INC. / Havelock Corners (Kingsmen)

Lot/Unit: 108    Phase/Building: 5B    Model/Floor Plan: Andrew (3603) Elev B 4 Bed - 2+1 Bath

CABINETRY

Inv.6313	1 - To supply & install the CAPE COD painted cabinet door in the kitchen in lieu of the standard cabinet door... see colour chart for detials.	
Line 79447	Note:	
23Jun23 / 28Jun23		
Inv.6313	1 - To supply & install the CAPE COD painted cabinet door in the powder room in lieu of the standard cabinet door... see colour chart for detials.	
Line 79448	Note:	
23Jun23 / 28Jun23		

CABINETRY APPLIANCE - FRIDGE

Inv.6313	1 - To supply & install the 66CM DEEP FRIDGE ENCLOSURE - COUNTER DEPTH WITH - 1 WALL - 1 66CM DEEP GABLE AND 1 66CM DEEP CABINET - THIS IS NOT A ZERO CLEARANCE ENCLOSURE. STANDARD HEIGHTS AND WIDTHS WILL BE USED in the kitchen...see sketch # 4	
Line 79435	Note:	
23Jun23 / 28Jun23		

CABINETRY HARDWARE

Inv.6313	1 - To supply & install the KITCHEN - CABINET HARDWARE - UPGRADE 2 - DISPLAY BOARD in lieu of the standard hardware... see colour chart for details.	
Line 79463	Note:	
23Jun23 / 28Jun23		
Inv.6313	1 - To supply & install the VANITY - CABINET HARDWARE - UPGRADE 2 - DISPLAY BOARD in the powder room ONLY...see colour chart for details.	
Line 79464	Note:	
23Jun23 / 28Jun23		

CABINETRY HOOD FANS

Inv.6313	1 - To supply & install the HOOD FAN - PRO COLLECTION (SCB72230) WALL MOUNT RANGE HOOD WITH 650 CFM FAN - 30 INCH in lieu of the standard stainless steel hood fan.. see spec's	
Line 79429	Note:	
23Jun23 / 28Jun23		
Inv.6313	1 - To accomodate the cabinets for the upgraded 30" Chimney hood fan... see spec's	
Line 79430	Note:	
23Jun23 / 28Jun23		

CABINETRY MICROWAVE OVEN STOVE COOKTOP

Inv.6313	1 - To supply & install the WALL CABINET WITH SHELF FOR MICROWAVE - FINISHED INTERIOR - OPENING 24 INCHES W X 13 3 - 4 INCCHESH X 17 INCHES D -in the kitchen...see sketch # 4	
Line 79436	Note: Elec. outlet for this upgraded is sold sep.	
23Jun23 / 28Jun23		

CABINETRY VANITY

**KINGSMEN (THAMES) INC. / Havelock Corners (Kingsmen)**

**Lot/Unit: 108    Phase/Building: 5B    Model/Floor Plan: Andrew (3603) Elev B 4 Bed - 2+1 Bath**

Inv.6313 Line 79438  23Jun23 / 28Jun23	<b>2</b> - To supply & install TWO VANITY TOP DRAWERS in the main bathroom...see sketch # 5 Note:	
Inv.6313 Line 79439  23Jun23 / 28Jun23	<b>1</b> - To supply & install a VANITY BANK OF DRAWERS in the master bedroom... see sketh # 5 Note:	
Inv.6313 Line 79440  23Jun23 / 28Jun23	<b>1</b> - To supply & install an INCREASED VANITY TO KITCHEN HEIGHT - MAINTAINS VANITY DEPTH - in the powder room in lieu of the standard height vanity. Note:	
Inv.6313 Line 79441  23Jun23 / 28Jun23	<b>1</b> - To supply & install an INCREASED VANITY TO KITCHEN HEIGHT - MAINTAINS VANITY DEPTH - in the main bathroom in lieu of the standard height vanity. Note:	
Inv.6313 Line 79442  23Jun23 / 28Jun23	<b>1</b> - To supply & install an INCREASED VANITY TO KITCHEN HEIGHT - MAINTAINS VANITY DEPTH - in the master ensuite bathroom in lieu of the standard height vanity. Note:	

**COUNTER TOP**

Inv.6313 Line 79457  23Jun23 / 28Jun23	<b>1</b> - To supply & install the level #1 quartz to the powder room in lieu of the standard laminate countertop... see colour chart for details. Purchaser has upgraded to an under mount sink, sold sep. Still to install the standard lav. faucet. Note:	
Inv.6313 Line 79458  23Jun23 / 28Jun23	<b>1</b> - To supply & install the level #1 quartz to the main bathroom in lieu of the standard laminate countertop... see colour chart for details. Purchaser has upgraded to an under mount sink, sold sep. Still to install the standard lav. faucet. Note:	
Inv.6313 Line 79459  23Jun23 / 28Jun23	<b>1</b> - To supply & install the level #1 quartz to the master ensuite bathroom in lieu of the standard laminate countertop... see colour chart for details. Purchaser has upgraded to an under mount sink, sold sep. Still to install the standard lav. faucet. Note:	

**ELECTRICAL**

Inv.6313 Line 79437  23Jun23 / 28Jun23	<b>1</b> - SUPPLY AND INSTALL AN ADDITIONAL BASIC RECEPTACLE (DEDICATED CIRCUIT AND INCLUDES ARC FAULT BREAKER) Note:	
---	--	--

KINGSMEN (THAMES) INC. / Havelock Corners (Kingsmen)

Lot/Unit: 108    Phase/Building: 5B    Model/Floor Plan: Andrew (3603) Elev B 4 Bed - 2+1 Bath

Inv.6313	1 - To supply & install the standard T.V. rough in in the great room and master bedroom... see sketch # 4 & #5	
Line 79416	Note: Install the standard T.V. rough in at approx. 66" + - up from the floor in the great room.	
23Jun23 / 28Jun23		
Inv.6313	1 - To supply & install the standard Phone ( CAT5 ) rough in in the great room, master bedroom and Bedroom # 4 ... see sketch # 4 & # 5 ( B/C June 28, 2023)	
Line 79417	Note: Install the standard Phone ( CAT 5 ) rough in at approx. 66" + - up from the floor in the great room.	
23Jun23 / 28Jun23		
Inv.6313	1 - To SUPPLY AND INSTALL AN ADDITIONAL BASIC RECEPTACLE (NOT DEDICATED) at approx. 66" + - up from the floor centered + - to the F/P mantle	
Line 79423	Note: in the great room... see sketch # 4	
23Jun23 / 28Jun23                      This is for a future wall mount TV NO CONDUIT PIPE HAS BEEN PURCHASED.		
Inv.6313	1 - To SUPPLY AND INSTALL EXTRA CEILING BOX ROUGH IN CAPPED (DOES NOT INCLUDE SWITCH) over the island in the kitchen... see sketch # 4	
Line 79426	Note: This capped elec. will be connected to a sep. switch, switch is sold sep.	
23Jun23 / 28Jun23		
Inv.6313	1 - To supply & install a sep. switch connected to the upgraded capped elec. over the island in the kitchen.	
Line 79427	Note:	
23Jun23 / 28Jun23		
Inv.6313	1 - Relocate the standard ceiling light from the upper stair landing to the O.T.B. area on the second floor... see sketch # 5	
Line 79428	Note:	
23Jun23 / 28Jun23		

HARDWOOD

Inv.6313	1 - To supply & install the 5" Vintage Norther Solid Sawn engineered hardwood floor to the main floor area & stair landings ( Where applicable ) in lieu of the standard hardwood floor... see colour chart for details.	
Line 79443	Note:	
23Jun23 / 28Jun23		
Inv.6313	1 - To supply & install the 5" Vintage Norther Solid Sawn engineered hardwood floor to the upper hallway area in lieu of the standard carpet... see colour chart for details.	
Line 79444	Note:	
23Jun23 / 28Jun23		

HEATING AND AIR CONDITIONING

Inv.6313	1 - To supply & install a gas line ( rough in only) at stove location in the kitchen, to include a 110V elec. code requirement.	
Line 79431	Note:	
23Jun23 / 28Jun23		

MISCELLANEOUS

PAINT AND DRYWALL

KINGSMEN (THAMES) INC. / Havelock Corners (Kingsmen)

Lot/Unit: 108    Phase/Building: 5B    Model/Floor Plan: Andrew (3603) Elev B 4 Bed - 2+1 Bath

Inv.6313	1 - To supply & install the PAINT EXTRAS - STAIN RAILINGS WITH IRON PICKETS (INCLUDING STAIRS)... see colour chart for details.	
Line 79446	Note:	
23Jun23 / 28Jun23		

PLUMBING

Inv.6313	1 - To supply & install the VANITY SINK - CONTRAC CATENA UNDERMOUNT - MODEL 4210CIY in the powder room in lieu of the standard top mount sink...see spec's	
Line 79454	Note: Still to install the standard lav. faucet.	
23Jun23 / 28Jun23		
Inv.6313	1 - To supply & install the VANITY SINK - CONTRAC CATENA UNDERMOUNT - MODEL 4210CIY in the main bathroom in lieu of the standard top mount sink...see spec's	
Line 79455	Note: Still to install the standard lav. faucet.	
23Jun23 / 28Jun23		
Inv.6313	2 - To supply & install the VANITY SINK - CONTRAC CATENA UNDERMOUNT - MODEL 4210CIY in the master bathroom in lieu of the standard top mount sink...see spec's	
Line 79456	Note: Still to install the standard lav. faucets.	
23Jun23 / 28Jun23		
Inv.6313	1 - To supply & instal the WATERLINE ROUGH-IN TO THE FRIDGE LOCATION (NO HOOK UP) in the kitcchen.	
Line 79432	Note:	
23Jun23 / 28Jun23		
Inv.6313	1 - To supply & install the KITCHEN SINK - BLANCO QUATRUS U2 DBL UNDERMOUNT - MODEL 401247 in the kitchen in lieu of the standard kitchen sink...see spec's	
Line 79433	Note: Still to install the standard single hole kitchen faucet, NO PLATE.	
23Jun23 / 28Jun23		
Inv.6313	1 - To supply & install the KITCHEN SOAP Dispencer - MOEN CHROME - MODEL 3942 in the kitchen...see spec's...see sketch # 4 for installation location.	
Line 79434	Note:	
23Jun23 / 28Jun23		

RAILING

Inv.6313	1 - To supply & install the RAILING - UPGRADE 1 - METAL HANDRAIL 3 INCH OVAL IN OAK - PICKETS STEEL ½ INCH SQUARE, PLAIN, WITH SHOES IN FLAT BLACK - POSTS 3½ INCH SQUARE, WITH CAP OAK IN OAK in lieu of the standard pickets and rails.	
Line 79445	Note:	
23Jun23 / 28Jun23		

TILE - FLOOR

Inv.6313	1 - To supply & instal lthe UPGRADE 2 - FLOOR TILE -STACKED - FOYER TILE in lieu of the standard floor tiles... see colour chart for details. See sketch #4 for installation direction.	
Line 79449	Note:	
23Jun23 / 28Jun23		

KINGSMEN (THAMES) INC. / Havelock Corners (Kingsmen)

Lot/Unit: 108    Phase/Building: 5B    Model/Floor Plan: Andrew (3603) Elev B 4 Bed - 2+1 Bath

Inv.6313	1 - To supply & instal lthe UPGRADE 2 - FLOOR TILE -STACKED - MIAN HALLWAY TILE in lieu of the standard floor tiles... see colour chart for details. See sketch #4 for installation direction.	
Line 79450	Note:	
23Jun23 / 28Jun23		
Inv.6313	1 - To supply & instal lthe UPGRADE 2 - FLOOR TILE -STACKED - POWDER ROOM TILE in lieu of the standard floor tiles... see colour chart for details. See sketch #4 for installation direction.	
Line 79451	Note:	
23Jun23 / 28Jun23		
Inv.6313	1 - To supply & instal lthe UPGRADE 2 - FLOOR TILE -STACKED - MUD ROOM TILE in lieu of the standard floor tiles... see colour chart for details. See sketch #4 for installation direction.	
Line 79452	Note:	
23Jun23 / 28Jun23		
Inv.6313	1 - To supply & instal lthe UPGRADE 2 - FLOOR TILE -STACKED - KITCHEN TILE in lieu of the standard floor tiles... see colour chart for details. See sketch #4 for installation direction.	
Line 79453	Note:	
23Jun23 / 28Jun23		

TRIM

Inv.6313	1 - To supply & install the MONTREAL SQUARE HANDLE and the HINGES in MATTE BLACK throughout the house where applicable.	
Line 79462	Note:	
23Jun23 / 28Jun23		

EXTRAS AS PER OFFER

5 FREE APPLIANCES ? STAINLESS STEEL FRONT - FRIDGE: STOVE AND DISHWASHER. WHITE WASHER AND DRYER (SUPPLIED ONLY, NOT INSTALLED, FROM BUILDERS STANDARD LINE). AN APPLIANCES VOUCHER WILL BE GIVEN BY OUR DECOR CONSULTANT AT THE TIME OF BOOKING YOUR COLOUR A <i>Worksheet</i> Note:	
5 FREE APPLIANCES – STAINLESS STEEL FRONT - FRIDGE; STOVE AND DISHWASHER. WHITE WASHER AND DRYER (SUPPLIED ONLY, NOT INSTALLED, FROM BUILDERS STANDARD LINE). AN APPLIANCES VOUCHER WILL BE GIVEN BY OUR DECOR CONSULTANT AT THE TIME OF BOOKING YOUR COLOUR A <i>Worksheet</i> Note:	
VENDOR TO INSTALL CAPPED GAS LINE (ROUGH-IN ONLY) AT REAR OF HOME FOR FUTURE BBQ LOCATION. LOCATION TO BE FINALIZED AT VENDORS SOLE DISCRETION. <i>Worksheet</i> Note:	
VENDOR TO SUPPLY & INSTALL AIR CONDITIONING UNIT, SIZED ACCORDINGLY, FROM VENDORS STANDARD SAMPLES. <i>Worksheet</i> Note:	



Purchaser:JOBANDEEP SINGH,

Property: 108 of Plan - Draft Approval SB17-03-08

Telephone Res. / Bus: /

Project: KINGSMEN (THAMES) INC.

Decor Advisor: Barbara Coccia

Model and Elevation: Andrew (3603) Elev B 4 Bed - 2+1 Bath

Layout Changes: ☐ Yes ☒ No

Sketch Attached: ☒ Yes ☐ No

Exterior Colour Scheme:

1. Cabinetry	Style and Colour	Counter Top	Hardware
Kitchen / Breakfast	**Cape Cod Painted Winter White	#1, C/S # 9141 Ice Snow 3cm.	*12805MB Black
Kitchen Island	**Cape Cod Painted Winter White	#1, C/S # 9141 Ice Snow 3cm.	*12805MB Black
Laundry Room	/		
Powder Room	**Cape Cod Painted Winter White	**#1, C/S # 9141 Ice Snow 2cm.	*12805MB Black
Main Bathroom	#3 Manchester Maple Shale Grey CL	**#1, C/S # 9141 Ice Snow 2cm.	# 12881 Handle
Master Ensuite Bathroom	#3 Manchester Maple Shale Grey CL	**#1, C/S # 9141 Ice Snow 2cm.	# 12881 Handle
Second Ensuite Bathroom (If Applicable)	/		
	/		
	/		

Appliances

Custom Size Fridge  
☐ Yes ☒ No

Valance Lighting  
☐ Yes ☒ No

Microwave / Range Hood  
☐ Yes ☒ No

Cooktop / Rangetop  
☐ Yes ☒ No

Built in Wall Oven  
☐ Yes ☒ No

Slide-in Range  
☐ Yes ☒ No

Comment

2. Flooring	Selection
Foyer	** 12 x24" Classic Calacatta HD Porc. STACKED
Main Hall	** 12 x24" Classic Calacatta HD Porc. STACKED
Back Hall	/
Breakfast	/
Laundry Room	13x13" Burlingstone Lt. Grey
Kitchen	** 12 x24" Classic Calacatta HD Porc. STACKED
Powder Room	** 12 x24" Classic Calacatta HD Porc. STACKED
Main Bathroom	13x13" Keaton Ice
Master Ensuite	13x13" Keaton Ice
Bathroom (If Applicable)	/
Mud Room	** 12 x24" Classic Calacatta HD Porc. STACKED
Master ens. shower floor:	2x2" Ontario Snow White Matte
Living Room	/
Dining Room	( Dinette) ** 5" Vintage Northern Solid Sawn Collection Engineered Character PEARL OAK "SHALE" <i>bc</i>
Family / Great Room	** 5" Vintage Northern Solid Sawn Collection Engineered Character PEARL OAK "SHALE" <i>bc</i>
Den / Library / Study	/
Basement Landing (If Applies)	
Lower Landing (If Applicable)	** 5" Vintage Northern Solid Sawn Collection Engineered Character PEARL OAK "SHALE" <i>bc</i>
Upper Landing	( if applicable) ** 5" Vintage Northern Solid Sawn Collection Engineered Character PEARL OAK "SHALE" <i>bc</i>
Upper Hall	** 5" Vintage Northern Solid Sawn Collection Engineered Character PEARL OAK "SHALE" <i>bc</i>
Master Bedroom	Modern Story 1, # 809 Gondola
Bedroom #2	Modern Story 1, # 809 Gondola
Bedroom #3	Modern Story 1, # 809 Gondola
Bedroom #4	Modern Story 1, # 809 Gondola
Bedroom #5	/
Master ens. shower jamb:	Anatolia Marmiline SNOW

Purchaser: JOBANDEEP SINGH, Property: 108 of Plan - Draft Approval SB17-03-08
Telephone Res. / Bus: / Project: KINGSMEN (THAMES) INC.
Decor Advisor: Barbara Coccia Model and Elevation: Andrew (3603) Elev B 4 Bed - 2+1 Bath
2. Flooring - Continued -

Table with 3 columns: Upgrade Underpad, Type, Area. Rows include Master bedroom, bedroom #2, #3 & #4; Carpet on Stairs; Comment.

3. Plumbing Fixtures / Faucets
Kitchen, Master Ensuite, Main Bathroom, Second Ensuite, Powder Room, Other Room
Comment: Purchaser has upgraded to an under mount kitchen sink, still to install the standard single hole kitchen faucet, NO PLATE. Purchaser has upgraded to under mount sinks in ALL bathrooms, still to install the standard lav faucet.

4. Wall Tile
Main Bathroom, Master Ensuite, Tub Deck, Tub Apron, Tub Surround, Shower Stall, Second Ensuite, Kitchen Backsplash, Complete Backsplash
Tile Selection, Listello, Insert, Insert Selection
Comment, tile pattern diagrams (horizontal stacked, brick pattern, vertical stacked, diagonal/diamond)

5. Fireplace
Living Room, Family Room, Other Room - Specify Great Room
Fireplace Type, Mantle Type, Over Mantle, Colour / Stain, Surround, Hearth, Comment



Purchaser: **JOBANDEEP SINGH,** Property: 108 of Plan - Draft Approval SB17-03-08  
 Telephone Res. / Bus: / Project: **KINGSMEN (THAMES) INC.**  
 Decor Advisor: **Barbara Coccia** Model and Elevation: **Andrew (3603) Elev B 4 Bed - 2+1 Bath**

**6. Trim Carpentry**

Door Hardware \* Montreal square handle **MATTE BLACK**

Interior Trim Standard

Comment  
 Purchaser has upgraded to 8' taller doors on the main floor, see early structural paper work. Purchaser has upgraded to have the standard hinges in **MATTE BLACK**.

Interior Doors

☐ 2 Panel Arch Top

☒ 2 Panel Square Top

☐ 6 Panel

Initial for Door Style **P**

**7. Railings and Pickets**

Railing Package \*Upg. #1 Metal picket package

Railing Colour \* Vintage **SHALE BC**

Wood Stairs ☐ No ☒ Oak

Picket Colour **BLACK**

Tread Colour \* Vintage **SHALE BC**

Comment  
 /

**8. Plaster Mouldings and Medallions**

Foyer	/	Kitchen/Breakfast	/
Main Hall	/	Den/Library	/
Living Room	/	Lower Landing	/
Dining Room	/		
Family Room	/		

Comment  
 /

**9. Wall Paint**

Kingsmen White

Smooth Ceilings ☐ First Floor

☐ First Floor incl. Second Floor Hall

☐ First and Second Floor

☒ Throughout

☐ Not Applicable

Trim Paint **Kingsmen White**

**10. Additional Comments**

/

**11. Disclaimers and Notes**

1) Colours of all materials are as close as possible to builder's selection, but not necessarily identical due to variances in manufacturing.

2) Any extras listed above are null and void unless accompanied by a separate invoice/amendment. Said invoice must be paid in full.

3) The Purchaser acknowledges that after Interior Colour Selection form is signed and dated, no further changes will be permitted other than re-selection due to unavailability. **P** Purchaser's Initials

4) The Purchaser acknowledges reading and accepting the "Kingsmen Group Décor Centre Disclaimers" form. This document contains other miscellaneous disclaimers.

This Interior Colour Selection is final and approved by:

Purchaser: **P**

Signature: **P** Date: **Jun/26/23**

Vendor: **NO**

KINGSMEN (THAMES) INC.



LOT 108  
THAMES PH. 5B  
SKETCH #4

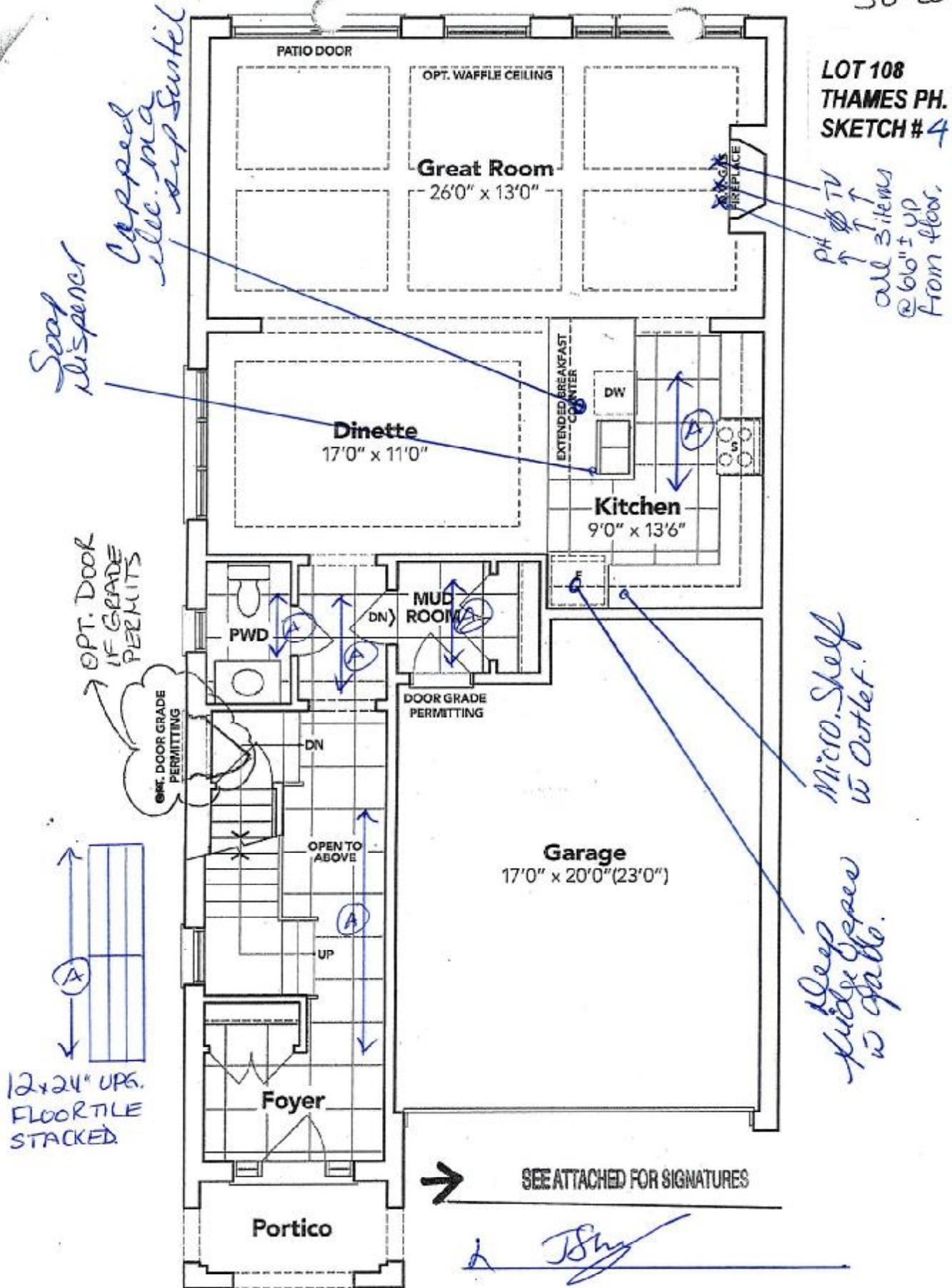

GROUND FLOOR EL. B

The floor plans and elevations shown are pre-construction plans and may be revised or improved as necessitated by architectural controls and the construction process. The measurements adhere to the rules and regulations of the TARIION Warranty Corporation's official method for the calculation of floor area. Materials, specifications and floor plans are subject to change without notice. All house renderings are artist's concept only. Actual usable floor space may vary from the stated floor area. All options shown are upgrades. E. & O. E.

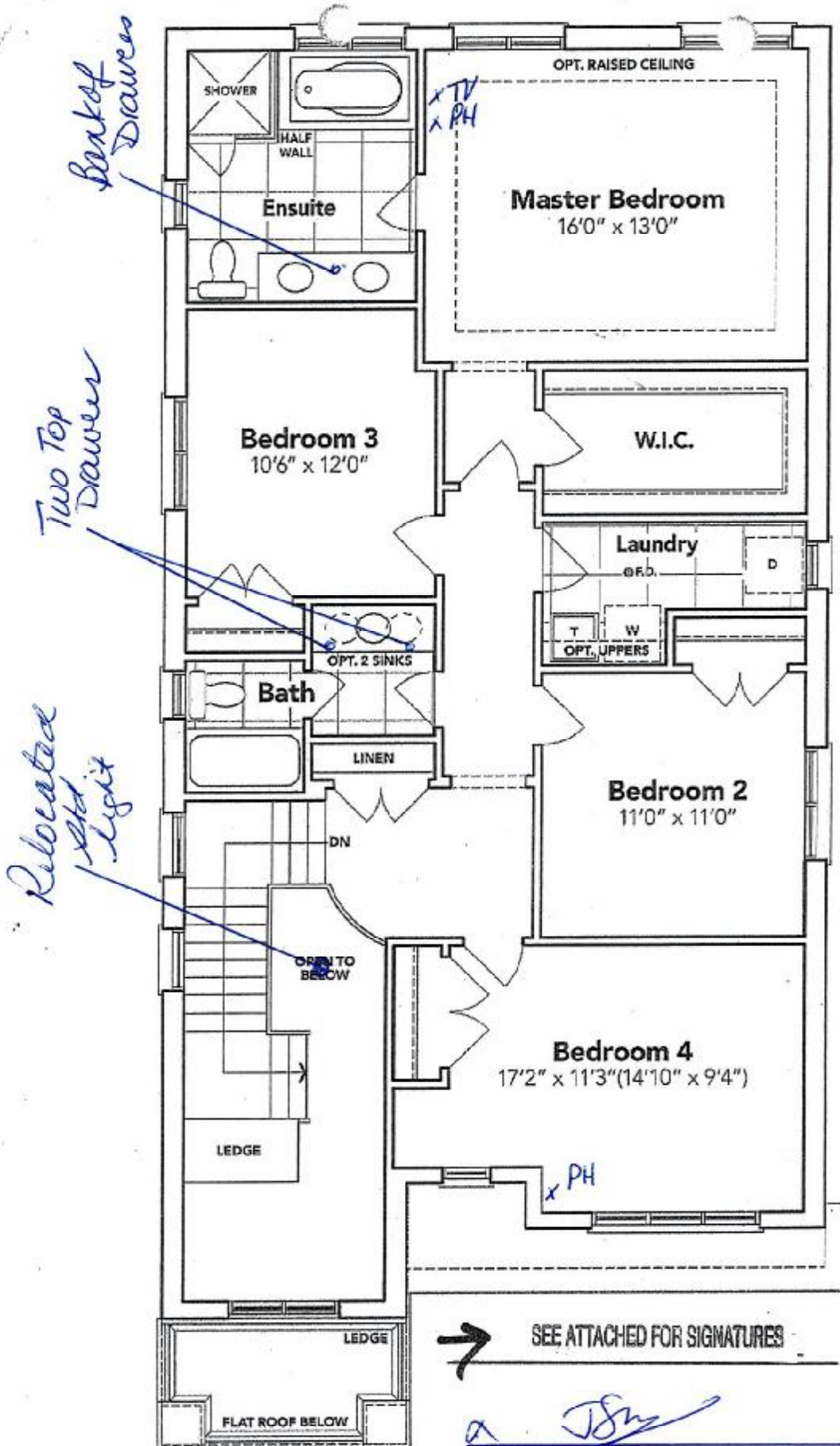

## SECOND FLOOR EL. B

The floor plans and elevations shown are pre-construction plans and may be revised or improved as necessitated by architectural controls and the construction process. The measurements adhere to the rules and regulations of the TARION Warranty Corporation's official method for the calculation of floor area. Materials, specifications and floor plans are subject to change without notice. All house renderings are artist's concept only. Actual usable floor space may vary from the stated floor area. All options shown are upgrades. E. & O. E.



5B-108

LOT 108 THAMES PH. 5B  
RE: UPG. UNDER MOUNT KITCHEN SINK  
WITH SOAP DISPENSER

X JS

# BLANCO

## Sink Specifications

Colour **SKU**  
brushed finish 401247

## QUATRUS U 2

### Design and planning tips

- Min cabinet size: 36 in ( 915 mm )
- Bowl Depth: 9 in ( 230.0 mm )

#### Specifications:

Installation clips, Sink template, Installation instructions, 3  
1/2" (90 mm) stainless steel strainers

Depending on cabinet construction, a different cabinet  
size may be required. Consult the cabinet manufacturer.

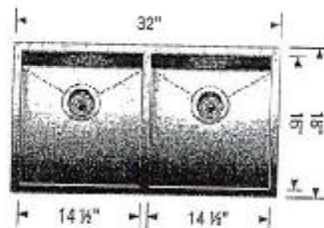

## Soap or Lotion Dispensers

Traditional Transitional Modern

*However you define your faucet's style,  
you can assure a coordinated look with Moen soap dispensers.*



Transitional Soap or  
Lotion Dispenser

Model 3942

Chrome

KITCHEN

5B-108

LOT 108 THAMES PH. 5B  
RE: UPG. 30" CHIMNEY HOOD FAN

Specifications

Air Flow Volume: 650 CFM  
Electrical Connection: 120V/60Hz  
Power Consumption: 240 Watts  
Current: 2.0 Amps  
Fan Speed: 1599 RPM  
Finishes: Stainless Steel  
Duct: 6" Round  
Knock-out: 6" Round - Top Only  
Dimensions: Width: 30"/36"  
Height: 44 1/2"  
Depth: 19 3/4"  
Noise Level: Min. 2 Sones  
Max. 7 Sones

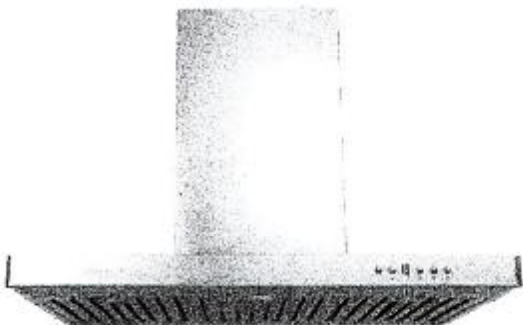

SCB722 - Baffle Filter



Ordering Model Chart

Model	Colour	Knock-out	Duct	Size	Filter	CFM
SCB72230	Stainless Steel	6"	6" Round	30"	Baffle	650
<del>SCB72236</del>	<del>Stainless Steel</del>	<del>6"</del>	<del>6" Round</del>	<del>36"</del>	<del>Baffle</del>	<del>650</del>

Notes

*[Handwritten signature]*





5B-108

LOT 108 THAMES PH. 5B  
RE: UPG. UNDER MOUNT VANITY SINK  
FOR ALL BATHROOMS

contrac

## CATENA

RECTANGULAR UNDERMOUNT SINK

4210CIY

Undermount Sink

### PRODUCT SPECS:

- Vitreous china
- Front overflow hole
- Template and mounting hardware supplied

### DIMENSIONS:

#### Outer:

510mm W x 390mm D x 190mm H  
20" W x 15 3/8" D x 7 1/2" H

#### Inner:

458mm W x 340mm D x 140mm H  
18" W x 13 3/8" D x 5 1/2" H

### COMPLIANCE CERTIFICATIONS

Meets or exceeds the following:

- IAPMO cUPC
- ASME A112.19.2 / CSA B45.1
- OBC Section 3.8 Barrier Free design and CSA B651 Standard

### SHIPPING

Cube 1.72  
GW 27 lbs

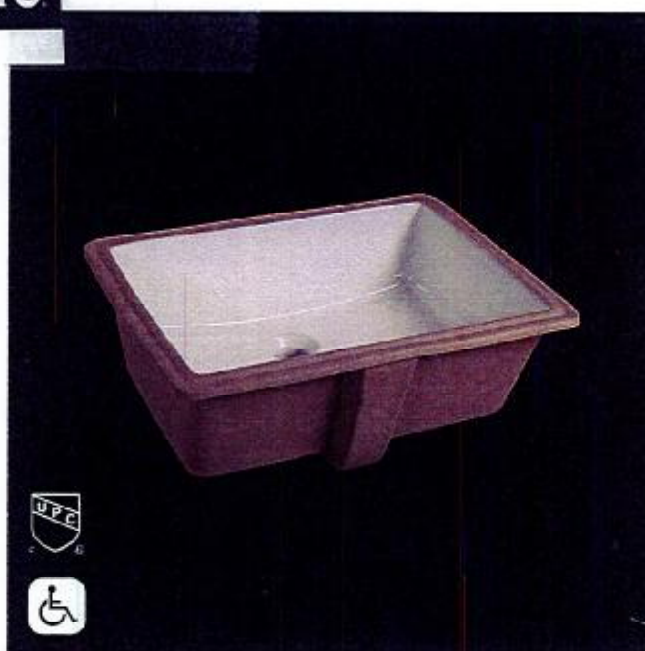

### TO BE SPECIFIED

Colour:

- Soft White

NOTES: Dimensions of fixtures are nominal and may vary within the range of tolerances established by ASME standard A112.19.2. These measurements are subject to change or cancellation. No responsibility is assumed for use of superseded or voided pages.

Products are designed to comply with CSA B651 Standard and OBC barrier-free requirements. It shall be the responsibility of the installer to comply with the local disability codes and standards prior to installing the product.

*[Handwritten signature]*