

KINGSMEN (THAMES) INC. / Havelock Corners (Kingsmen)

Lot/Unit: 32    Phase/Building: 5B    Model/Floor Plan: Spencer (4204) Elev C 4 Bed - 4+1 Bath

CABINETRY APPLIANCE - FRIDGE

Inv.6318	1 - To supply & install the 66CM DEEP FRIDGE ENCLOSURE - COUNTER DEPTH WITH - 1 WALL - 1 66CM DEEP GABLE AND 1 66CM DEEP CABINET - THIS IS NOT A ZERO CLEARANCE ENCLOSURE. STANDARD HEIGHTS AND WIDTHS WILL BE USED in the kitchen..see sketch # 4	
Line 79507	Note:	
27Jun23 / 28Jun23		

CABINETRY HOOD FANS

Inv.6318	1 - To supply & install the HOOD FAN - PRO COLLECTION (SCB72230) WALL MOUNT RANGE HOOD WITH 650 CFM FAN - 30 INCH in lieu of the standard stainless steel hood fan...see spec's	
Line 79501	Note:	
27Jun23 / 28Jun23		
Inv.6318	1 - To accomodate the cabinetry for the upgraded 30" chimney hood fan.. see spec's	
Line 79502	Note:	
27Jun23 / 28Jun23		

CABINETRY MICROWAVE OVEN STOVE COOKTOP

Inv.6318	1 - To supply & install the WALL CABINET WITH SHELF FOR MICROWAVE - FINISHED INTERIOR - OPENING 24 INCHES W X 13 3 - 4 INCHES H X 17 INCHES D in the kitchen... see sketch # 4	
Line 79508	Note: Elec. for this upgrade is sold sep.	
27Jun23 / 28Jun23		

CABINETRY VANITY

Inv.6318	1 - To supply & install a VANITY BANK OF DRAWERS - in the master ensuite... see sketch # 5	
Line 79510	Note:	
27Jun23 / 28Jun23		

CARPET

Inv.6318	1 - To supply & install the Escape to Maui carpet to the master bedroom, bedroom #2, #3 & # 4 in lieu of the standard carpet, see colour chart for details.	
Line 79516	Note:	
27Jun23 / 28Jun23		

COUNTER TOP - ACCESSORIES

Inv.6318	1 - To supply & install the quartz shower niche "IMPERIAL WHITE" in the master ensuite... see sketch #5 for installation location.	
Line 79506	Note:	
27Jun23 / 28Jun23		

ELECTRICAL

Inv.6318	1 - To SUPPLY AND INSTALL AN ADDITIONAL BASIC RECEPTACLE (DEDICATED CIRCUIT AND INCLUDES ARC FAULT BREAKER) to be installed at upg. microwave shelf	
Line 79509	Note: in the kitchen... see sketch # 4	
27Jun23 / 28Jun23		

KINGSMEN (THAMES) INC. / Havelock Corners (Kingsmen)

Lot/Unit: 32    Phase/Building: 5B    Model/Floor Plan: Spencer (4204) Elev C 4 Bed - 4+1 Bath

Inv.6318	1 - To supply & install the standard T.V. rough in in the great room and master bedroom... see sketch # 4 & # 5	
Line 79466	Note: Install the standard T.V. rough in at approx. 66" + - up from the floor in the great room and master bedroom.	
27Jun23 / 28Jun23		
Inv.6318	1 - To supply & install the standard Phone ( CAT5 ) rough in in the great room, master bedroom and Media Nice area on the 2nd. floor ... see sketch # 4 & # 5	
Line 79467	Note: Install the standard Phone ( CAT 5) rough in at approx. 66" + - up from the floor in the great room and master bedroom.	
27Jun23 / 28Jun23		
Inv.6318	1 - To SUPPLY AND INSTALL AN ADDITIONAL BASIC RECEPTACLE (NOT DEDICATED) at approx. 66" + - up from the floor centered + - to the F/P mantle	
Line 79494	Note: in the great room... see sketch # 4	
27Jun23 / 28Jun23		
This is for a future wall mount T.V. NO CONDUIT PIPE HAS BEEN PURCHASED		
Inv.6318	1 - To SUPPLY AND INSTALL AN ADDITIONAL BASIC RECEPTACLE (NOT DEDICATED) at approx. 66" + - up from the floor in the master bedroom... see sketch # 5	
Line 79495	Note: This is for a future wall mount T.V. NO CONDUIT PIPE HAS BEEN PURCHASED	
27Jun23 / 28Jun23		
Inv.6318	1 - Relocate the standard light in the kitchen over to the island area... see sketch # 4 ( still connected to its standard switch )	
Line 79496	Note:	
27Jun23 / 28Jun23		
Inv.6318	1 - To supply & install FIVE pot lights in the kitchen area connected to a sep. switch... see sketch # 4	
Line 79497	Note:	
27Jun23 / 28Jun23		
Inv.6318	1 - To supply & install FOUR pot lights in the great room area connected to a sep. switch... see sketch # 4	
Line 79498	Note: Still to install the standard ceiling light in the great room, on its own standard switch.	
27Jun23 / 28Jun23		
Inv.6318	1 - Relocate the standard ceiling light from the upper stair landing to the O.T.B. area on the second floor... see sketch #5	
Line 79499	Note:	
27Jun23 / 28Jun23		

HARDWOOD

Inv.6318	1 - To supply & install the 3 1/2" Elements stained engineered hardwood floor to the upper hallway and Media niche area in lieu of the standard carpet... see colour chart for details.	
Line 79515	Note:	
27Jun23 / 28Jun23		

HEATING AND AIR CONDITIONING

Inv.6318	1 - To supply & install a capped gas line ( rough in only) at stove location in the kitchen, to include a 110 elec. outlet, code requirement.	
Line 79500	Note:	
27Jun23 / 28Jun23		

MISCELLANEOUS

KINGSMEN (THAMES) INC. / Havelock Corners (Kingsmen)

Lot/Unit: 32    Phase/Building: 5B    Model/Floor Plan: Spencer (4204) Elev C 4 Bed - 4+1 Bath

Inv.6318	1 - To supply & install the COFFERED ceiling in the Dining room as per plan.. see sketch #4	
Line 79468	Note:	
27Jun23 / 28Jun23		

PLUMBING

Inv.6318	1 - To supply & instal lthe WATERLINE ROUGH-IN TO THE FRIDGE LOCATION (NO HOOK UP) in the kitchen.	
Line 79503	Note:	
27Jun23 / 28Jun23		
Inv.6318	1 - To supply & install the KITCHEN SINK - BLANCO QUATRUS U2 DBL UNDERMOUNT - MODEL 401247 in the kitchen in lieu of the standard under mount kitchen sink...see spec's	
Line 79504	Note: Still to install the standard single hole kitchen faucet NO PLATE.	
27Jun23 / 28Jun23		
Inv.6318	1 - To supply & install the MIROLIN " BROOKE" free standing tub in the master ens. in lieu of the standard free standing tub..see spec's	
Line 79505	Note:	
27Jun23 / 28Jun23		

TILE - FLOOR

Inv.6318	1 - To supply & install the UPGRADE 2 - FLOOR TILE - FOYER TILE STACKED in lieu of the standard floor tile... see sketch #4 for installation direction.	
Line 79511	Note:	
27Jun23 / 28Jun23		
Inv.6318	1 - To supply & install the UPGRADE 2 - FLOOR TILE - MUD ROOM TILE STACKED in lieu of the standard floor tile... see sketch #4 for installation direction.	
Line 79512	Note:	
27Jun23 / 28Jun23		
Inv.6318	1 - To supply & install the UPGRADE 2 - FLOOR TILE - POWDER ROOM TILE STACKED in lieu of the standard floor tile... see sketch #4 for installation direction.	
Line 79513	Note:	
27Jun23 / 28Jun23		
Inv.6318	1 - To supply & install the UPGRADE 2 - FLOOR TILE - KITCHNE/BREAKFAST TILE STACKED in lieu of the standard floor tile... see sketch #4 for installation direction.	
Line 79514	Note:	
27Jun23 / 28Jun23		



CONSTRUCTION SUMMARY

KINGSMEN (THAMES) INC. / Havelock Corners (Kingsmen)

Lot/Unit: 32    Phase/Building: 5B    Model/Floor Plan: Spencer (4204) Elev C 4 Bed - 4+1 Bath

EXTRAS AS PER OFFER

5 FREE APPLIANCES ? STAINLESS STEEL FRONT - FRIDGE: STOVE AND DISHWASHER. WHITE WASHER AND DRYER (SUPPLIED ONLY, NOT INSTALLED, FROM BUILDERS STANDARD LINE). AN APPLIANCES VOUCHER WILL BE GIVEN BY OUR DECOR CONSULTANT AT THE TIME OF BOOKING YOUR COLOUR A <i>Worksheet</i> Note:	
VENDOR TO INSTALL CAPPED GAS LINE (ROUGH-IN ONLY) AT REAR OF HOME FOR FUTURE BBQ LOCATION.    LOCATION TO BE FINALIZED AT VENDORS SOLE DISCRETION. <i>Worksheet</i> Note:	
VENDOR TO SUPPLY & INSTALL AIR CONDITIONING UNIT, SIZED ACCORDINGLY, FROM VENDORS STANDARD SAMPLES. <i>Worksheet</i> Note:	

Purchasers: MICHAEL, E LE PAGE, & LAURA, GABRIELA LE Property: 32 of Plan - Draft Approval SB17-03-08  
Telephone Res. / Bus: (416) 464-9040 / Project: KINGSMEN (THAMES) INC.  
Decor Advisor: Barbara Coccia Model and Elevation: Spencer (4204) Elev C 4 Bed - 4+1 Bath  
Layout Changes: ☐ Yes ☒ No Sketch Attached: ☒ Yes ☐ No Exterior Colour Scheme:

1. Cabinetry

	Style and Colour	Counter Top	Hardware
Kitchen / Breakfast	#3 Charleston 3DL Orchid	#1, C/S # 9141 Ice Snow 3cm.	# 12881 Handle
Kitchen Island	#3 Charleston 3DL Orchid	#1, C/S # 9141 Ice Snow 3cm.	# 12881 Handle
Laundry Room	/		
Powder Room	#3 Charleston 3DL Orchid	# 6698-46 Paloma Polar	# 12881 Handle
Main Bathroom	/		
Master Ensuite Bathroom	#3 Charleston 3DL Orchid	# 4925K-07 Calcutta Marble	# 12881 Handle
Second Ensuite Bathroom (If Applicable)	#3 Charleston 3DL Orchid	# 4925K-07 Calcutta Marble	# 12881 Handle
Ens. #3's bathroom	#3 Charleston 3DL Rain Cloud	# 4925K-07 Calcutta Marble	# 12881 Handle
Ens. #4's bathroom	#3 Charleston 3DL Rain Cloud	# 4925K-07 Calcutta Marble	# 12881 Handle

Appliances

Custom Size Fridge

☐ Yes ☒ No

Cooktop / Rangetop

☐ Yes ☒ No

Valance Lighting

☐ Yes ☒ No

Built in Wall Oven

☐ Yes ☒ No

Microwave / Range Hood

☐ Yes ☒ No

Slide-in Range

☐ Yes ☒ No

Comment

2. Flooring

	Selection
Foyer	**12x24" Classic Calacatta HD Porc. STACKED
Main Hall	3 1/2" Elements Oak Strugeon
Back Hall	/
Breakfast	**12x24" Classic Calacatta HD Porc. STACKED
Laundry Room	13X13" Piaggio Grey
Kitchen	**12x24" Classic Calacatta HD Porc. STACKED
Powder Room	**12x24" Classic Calacatta HD Porc. STACKED
Main Bathroom	Ens. #2's Bathroom: 13X13" Piaggio Grey
Master Ensuite	13X13" Piaggio Grey
Bathroom (If Applicable)	Ens. #3's Bathroom: 13x13" Burlingstone White
Mud Room	**12x24" Classic Calacatta HD Porc. STACKED
Master ens. & ens. #2's	Shower floor: 2x2" Onatrio Snow white matte
Living Room	Ens. #4's Bathroom: 13x13" Burlingstone White
Dining Room	3 1/2" Elements Oak Strugeon
Family / Great Room	3 1/2" Elements Oak Strugeon
Den / Library / Study	/
Basement Landing (If Applies)	
Lower Landing (If Applicable)	3 1/2" Elements Oak Strugeon
Upper Landing	( If applicable) 3 1/2" Elements Oak Strugeon
Upper Hall	( & Media Niche area) **3 1/2" Elements Oak Strugeon
Master Bedroom	** Escape to Maui # 89816 Pilgrim's Path
Bedroom #2	** Escape to Maui # 89816 Pilgrim's Path
Bedroom #3	** Escape to Maui # 89816 Pilgrim's Path
Bedroom #4	** Escape to Maui # 89816 Pilgrim's Path
Bedroom #5	/
Master ens. & ens. #2's	Shower jamb: Anatolia Marmiline SNOW

SEE ATTACHED FOR SIGNATURES

Flooring Continued on Page 2

Initial:

Page 1 of 3



Purchasers: MICHAEL, E LE PAGE, & LAURA, GABRIELA LE Property: 32 of Plan - Draft Approval SB17-03-08  
Telephone Res. / Bus: (416) 464-9040 / Project: KINGSMEN (THAMES) INC.  
Decor Advisor: Barbara Coccia Model and Elevation: Spencer (4204) Elev C 4 Bed - 4+1 Bath  
2. Flooring - Continued -





Upgrade Underpad	Type	Area
	Standard	Master bedroom, bedroom #2, # 3 & # 4
Carpet on Stairs	Capped	Runner - *Upgrade
Comment	/	/

3. Plumbing Fixtures / Faucets

Kitchen	Standard	Second Ensuite	Standard	Powder Room	Standard
Master Ensuite	Standard			Other Room	/
Main Bathroom	/	Ens. 2 & 3 bathrooms	Standard		
Comment	Purchaser has upgraded the under mount kitchen sink, still to install the standard single hole kitchen faucet NO PLATE.				

4. Wall Tile

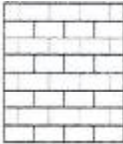
	Tile Selection	Listello	Insert	Insert Selection
Main Bathroom	/	<input type="checkbox"/>	<input type="checkbox"/>	
Master Ensuite				
Tub Deck	/	<input type="checkbox"/>	<input type="checkbox"/>	
Tub Apron	/	<input type="checkbox"/>	<input type="checkbox"/>	
Tub Surround	/	<input type="checkbox"/>		
Shower Stall	8x10" Weave White	<input type="checkbox"/>	<input type="checkbox"/>	
Second Ensuite	8x10" Weave White	<input type="checkbox"/>	<input type="checkbox"/>	
Ens. #3's bathroom	8x10" Weave White	<input type="checkbox"/>	<input type="checkbox"/>	
Ens. #4's bathroom	8x10" Weave White	<input type="checkbox"/>	<input type="checkbox"/>	
Kitchen Backsplash	/	<input type="checkbox"/>	<input type="checkbox"/>	
Complete Backsplash	/	<input type="checkbox"/>	<input type="checkbox"/>	
Comment				





horizontal stackedbrick patternvertical stackeddiagonal/diamond

5. Fireplace

	Living Room			Family Room			Other Room - Specify Great Room		
	Purchased	As Per Plan	N/A	Purchased	As Per Plan	N/A	Purchased	As Per Plan	N/A
Fireplace Type	<input type="radio"/>	<input type="radio"/>	<input checked="" type="radio"/>	<input type="radio"/>	<input type="radio"/>	<input checked="" type="radio"/>	<input type="radio"/>	<input checked="" type="radio"/>	<input type="radio"/>
Mantle Type							Front Facing		
Over Mantle							NF-08		
Colour / Stain							/		
Surround							White		
Hearth							/		
Comment	/								

SEE ATTACHED FOR SIGNATURES

Initial:



**Purchasers:** MICHAEL E LE PAGE, & LAURA, GABRIELA LE **Property:** 32 of Plan - Draft Approval SB17-03-08  
**Telephone Res. / Bus:** (416) 464-9040 / **Project:** KINGSMEN (THAMES) INC.  
**Decor Advisor:** Barbara Coccia **Model and Elevation:** Spencer (4204) Elev C 4 Bed - 4+1 Bath

### 6. Trim Carpentry

Door Hardware Standard Handle

Interior Trim Standard

Comment

/

#### Interior Doors

☐ 2 Panel Arch Top

☒ 2 Panel Square Top

☐ 6 Panel

Initial for Door Style

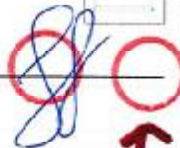

### 7. Railings and Pickets

Railing Package Standard Oak STRAIGHT picket package

Railing Colour Elements Strugeon

Picket Colour

Elements Strugeon

Wood Stairs ☐ No ☒ Oak

Tread Colour

Elements Strugeon

Comment

/

SEE ATTACHED FOR SIGNATURES

### 8. Plaster Mouldings and Medallions

Foyer

/

Kitchen/Breakfast

/

Main Hall

/

Den/Library

/

Living Room

/

Lower Landing

/

Dining Room

/

/

Family Room

/

Comment

/

### 9. Wall Paint

Kingsmen White

#### Smooth Ceilings

☐ First Floor

☐ First Floor incl. Second Floor Hall

☐ First and Second Floor

☒ Throughout

☐ Not Applicable

Trim Paint Kingsmen White

### 10. Additional Comments

/

### 11. Disclaimers and Notes

- Colours of all materials are as close as possible to builder's selection, but not necessarily identical due to variances in manufacturing.
- Any extras listed above are null and void unless accompanied by a separate invoice/amendment. Said invoice must be paid in full.
- The Purchaser acknowledges that after Interior Colour Selection form is signed and dated, no further charges will be permitted other than re-selection due to unavailability. Purchaser's Initials
- The Purchaser acknowledges reading and accepting the "Kingsmen Group Décor Centre Disclaimers" form. This document contains other miscellaneous disclaimers.

This Interior Colour Selection is final and approved by:

Purchaser:

Signature: Laura Le Page Date: June 28, 2023

SEE ATTACHED FOR SIGNATURES

Signature:

Date:

Vendor:

KINGSMEN (THAMES) INC.



SCHEDULE "B-1"  
Floor Plan

5B-32

Lot 32

Phase 5B

Model: Spencer (4204) Elev C 4 Bed - 4+1 Bath

Standard

sketch #4

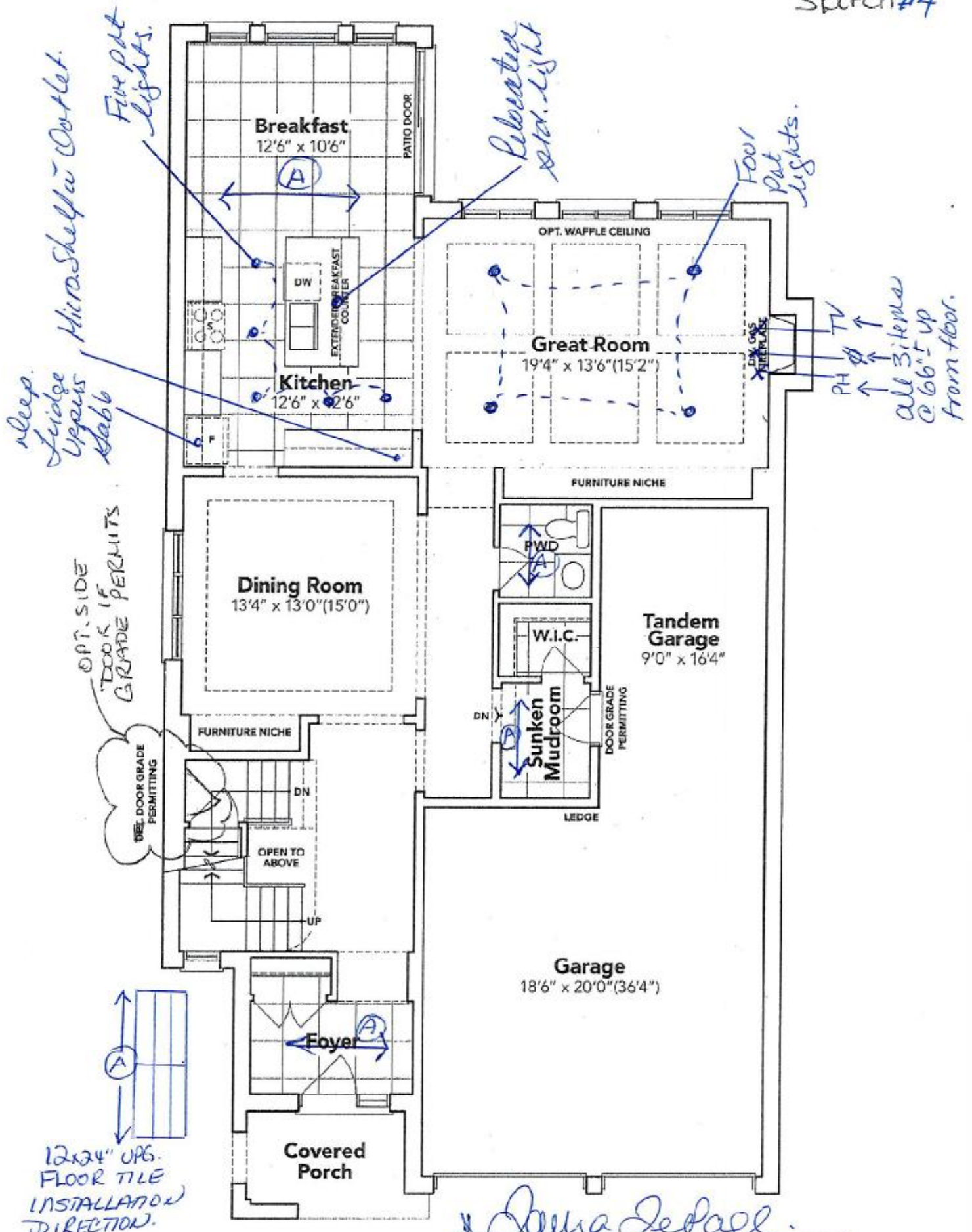

GROUND FLOOR EL. C

SEE ATTACHED FOR SIGNATURES

The floor plans and elevations shown are pre-construction plans and may be revised or improved as necessitated by architectural controls and the construction process. The measurements adhere to the rules and regulations of the TARION Warranty Corporation's official method for the calculation of floor area. Materials, specifications and floor plans are subject to change without notice. All house renderings are artist's concept only. Actual usable floor space may vary from the stated floor area. All options shown are upgrades.

E. & O. E.

SEE ATTACHED FOR SIGNATURES

SEE ATTACHED FOR SIGNATURES



5B-32

SCHEDULE "B-1"  
Floor Plan

Lot 32  
Phase 5B  
Model: Spencer (4204) Elev C 4 Bed - 4+1 Bath  
Standard  
Sketch #5

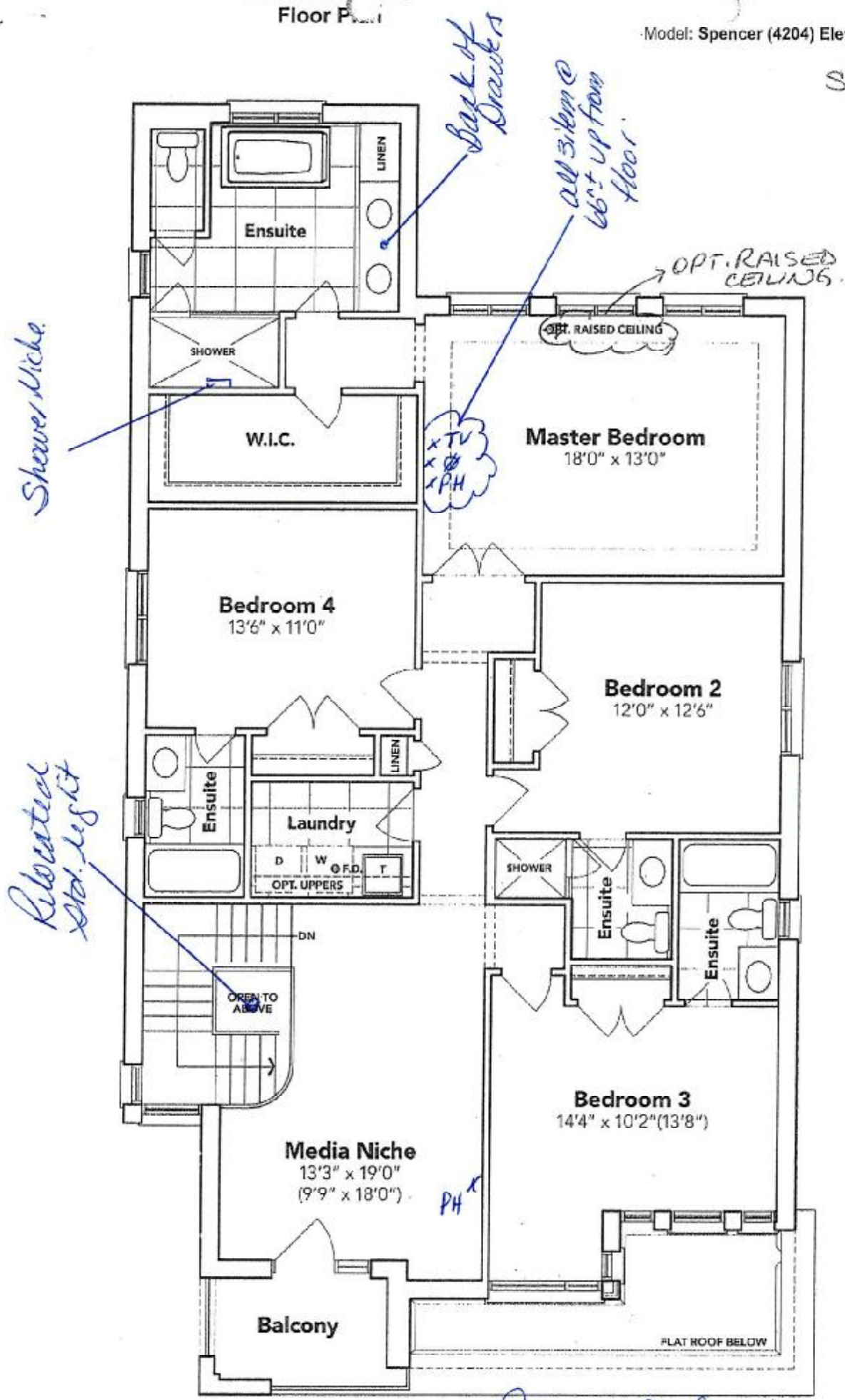

SECOND FLOOR EL. C

*Shana To Page*  
SEE ATTACHED FOR SIGNATURES

The floor plans and elevations shown are pre-construction plans and may be revised or improved as necessitated by architectural controls and the construction process. The measurements adhere to the rules and regulations of the TARION Warranty Corporation's official method for the calculation of floor area. Materials, specifications and floor plans are subject to change without notice. All house renderings are artist's concept only. Actual usable floor space may vary from the stated floor area. All options shown are upgrades. E. & O. E.

→ SEE ATTACHED FOR SIGNATURES

→ SEE ATTACHED FOR SIGNATURES

SB-32

LOT 32 THAMES PH. 5B  
RE: UPG. 30" CHIMNEY HOOD FAN

Specifications

Air Flow Volume: 650 CFM  
Electrical Connection: 120V/60Hz  
Power Consumption: 240 Watts  
Current: 2.0 Amps  
Fan Speed: 1599 RPM  
Finishes: Stainless Steel  
Duct: 6" Round  
Knock-out: 6" Round - Top Only  
Dimensions: Width: 30"/36"  
Height: 44 1/2"  
Depth: 19 3/4"  
Noise Level: Min. 2 Sones  
Max. 7 Sones

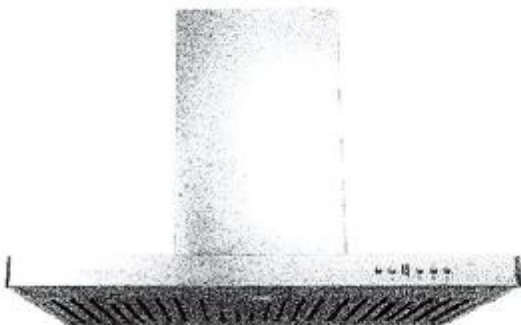

SCB722 - Baffle Filter



Ordering Model Chart

Model	Colour	Knock-out	Duct	Size	Filter	CFM
SCB72230	Stainless Steel	6"	6" Round	30"	Baffle	650
<del>SCB72236</del>	<del>Stainless Steel</del>	<del>6"</del>	<del>6" Round</del>	<del>36"</del>	<del>Baffle</del>	<del>650</del>

Notes

*James DePage*

SEE ATTACHED FOR SIGNATURES

Cyclone®  
Breathe Better

SB-32

LOT 32 THAMES PH. 5B  
RE: UPG. UNDER MOUNT KITCHEN SINK

# BLANCO

## Sink Specifications

Colour	SKU
brushed finish	401247

## QUATRUS U 2

### Design and planning tips

- Min cabinet size: 36 in ( 915 mm )
- Bowl Depth: 9 in ( 230.0 mm )

#### Specifications:

Installation clips, Sink template, Installation instructions, 3  
½" (90 mm) stainless steel strainers

Depending on cabinet construction, a different cabinet  
size may be required. Consult the cabinet manufacturer.

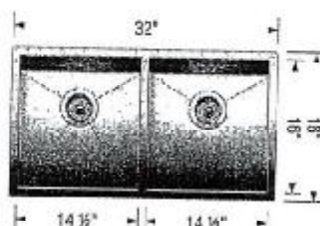

*Jenna D. Page*

SEE ATTACHED FOR SIGNATURES





LOT 32 THAMES PH. 5B  
RE: UPG. FREE STANDING TUB

SB-32



Brooke™ | 1

## Brooke™

Categories: Acrylic Freestanding

### DESCRIPTION

68" Freestanding Bath  
SKU #: CF2002

### FEATURES

- Installation friendly two piece design
- Accepts deck mounted faucet
- Includes a chrome integral pop up drain and rectangular overflow
- ~~• Brushed nickel drain and overflow covers available~~
- Centre drain
- Includes levelling feet
- Available in White Only



### DIMENSIONS

68" x 36" x 23"

*[Handwritten Signature]*

SEE ATTACHED FOR SIGNATURES

