

KINGSMEN (THAMES) INC. / Havelock Corners (Kingsmen)

Lot/Unit: 33 Phase/Building: 5B Model/Floor Plan: Arthur (4205) Elev C 4 Bed - 4+1 Bath

CABINETRY

Inv.6328	1 - To accomodate for a future 36" stove opening in lieu of the standard 30" stove opening in the kitchen.	
Line 79622	Note:	
7Jul23 / 7Jul23		

CABINETRY APPLIANCE - FRIDGE

Inv.6328	1 - To supply & install a 66CM DEEP FRIDGE ENCLOSURE - COUNTER DEPTH WITH - 1 WALL - 1 66CM DEEP GABLE AND 1 66CM DEEP CABINET - THIS IS NOT A ZERO CLEARANCE ENCLOSURE. STANDARD HEIGHTS AND WIDTHS WILL BE USED in the kitchen... see sketch # 1	
Line 79621	Note:	
7Jul23 / 7Jul23		

CABINETRY HOOD FANS

Inv.6328	1 - To supply & install the HOOD FAN - PRO COLLECTION (SCB72236) WALL MOUNT RANGE HOOD WITH 650 CFM FAN - 36 INCH in lieu of the standard stainless steel hood fan... see spec's	
Line 79623	Note:	
7Jul23 / 7Jul23		
Inv.6328	1 - To accomodate for the upgraded 36" chimney hood fan... see spec's	
Line 79624	Note:	
7Jul23 / 7Jul23		

CABINETRY MICROWAVE OVEN STOVE COOKTOP

Inv.6328	1 - To supply & install COOKTOP CABINET WITH FALSE TOP DRAWER AND POTS AND PANS DRAWERS BELOW - SUPPLY SPECS... see sketch # 1	
Line 79626	Note:	
7Jul23 / 7Jul23		
Inv.6328	1 - To supply & install BUILT-IN TALL APPLIANCE CABINET WITH DRAWER in the kitchen...see spec's... see sketch # 1	
Line 79630	Note:	
7Jul23 / 7Jul23		

CABINETRY VANITY

Inv.6328	1 - To supply & install a VANITY BANK OF DRAWERS in the master ensuite... see sketch # 2	
Line 79610	Note:	
7Jul23 / 7Jul23		

COUNTER TOP

Inv.6328	1 - To accomodate the quartz countertop for the future 36" cook top... see spec's	
Line 79625	Note:	
7Jul23 / 7Jul23		

ELECTRICAL

KINGSMEN (THAMES) INC. / Havelock Corners (Kingsmen)

Lot/Unit: 33 Phase/Building: 5B Model/Floor Plan: Arthur (4205) Elev C 4 Bed - 4+1 Bath

Inv.6328 Line 79606 7Jul23 / 7Jul23	3 - To SUPPLY AND INSTALL AN ADDITIONAL BASIC RECEPTACLE (NOT DEDICATED) at approx. 66" + - up from the floor in bedroom #2, #3 & # 4..see sketch # 2 Note: 	
Inv.6328 Line 79607 7Jul23 / 7Jul23	1 - To SUPPLY AND INSTALL EXTRA CEILING BOX ROUGH IN CAPPED (DOES NOT INCLUDE SWITCH) over the island in the kitchen... see sketch # 1 Note: This capped elec. will be connected to a sep. switch, switch sold sep. 	
Inv.6328 Line 79608 7Jul23 / 7Jul23	1 - To supply & install AN ADDITIONAL SINGLE POLE SWITCH connected to the upgraded capped elec. over the island in the kitchen. Note: 	
Inv.6328 Line 79597 7Jul23 / 7Jul23	1 - To supply & install the standard T.V. rough in in the great room and master bedroom... see sketch # 1 & # 2 Note: Install the standard T.V. rough in at approx. 66" + - up from the floor in the great room and master bedroom. 	
Inv.6328 Line 79598 7Jul23 / 7Jul23	1 - To supply & install the standard Phone (CAT5) rough in in the great room, master bedroom and Computer Niche area on the second floor ... see sketch # 1 & # 2 Note: Install the standard Phone (CAT 5) rough in at approx. 66" + - up from the floor in the great room and master bedroom. 	
Inv.6328 Line 79601 7Jul23 / 7Jul23	1 - To SUPPLY AND INSTALL AN ADDITIONAL BASIC RECEPTACLE (NOT DEDICATED) at approx. 66" + - up from the floor centered + - to the F/P mantle Note: in the great room... see sketch # 1 This is for a future wall mount T.V. NO CONDUIT PIPE HAS BEEN PURCHASED.	
Inv.6328 Line 79602 7Jul23 / 7Jul23	1 - To SUPPLY AND INSTALL AN ADDITIONAL BASIC RECEPTACLE (NOT DEDICATED) at approx. 66" + - up from the floor in the master bedroom... see sketch # 2 Note: This is for a future wall mount T.V. NO CONDUIT PIPE HAS BEEN PURCHASED.	
Inv.6328 Line 79629 7Jul23 / 7Jul23	1 - To SUPPLY AND INSTALL EXTRA 240 STOVE PLUG for the future built in microwave and wall oven... see spec's Note: 	

HARDWOOD

Inv.6328 Line 79613 7Jul23 / 7Jul23	1 - To supply & install the 3 1/2" Elements stained engineered oak hardwood floor to the upper hallway and computer niche area in lieu of the standard carpet... see colour chart for details. Note: 	
---	--	--

HEATING AND AIR CONDITIONING

Inv.6328 Line 79627 7Jul23 / 7Jul23	1 - To supply & install a capped gas line (rough in only) at stove location in the kitchen.. Note: 	
Inv.6328 Line 79595 7Jul23 / 7Jul23	1 - As per schedule "PE": Vendor to install capped gas line (Rough in only) at rear of home for future BBQ location. Location to be finalized at vendors sole discretion. Note: 	

KINGSMEN (THAMES) INC. / Havelock Corners (Kingsmen)

Lot/Unit: 33 Phase/Building: 5B Model/Floor Plan: Arthur (4205) Elev C 4 Bed - 4+1 Bath

Inv.6328	1 - As per schedule "PE": Vendor to supply & install air conditioning unit, sized accordingly, from vendors standard samples.	
Line 79596	Note:	
7Jul23 / 7Jul23		

MISCELLANEOUS

Inv.6328	1 - Reinforce back wall above the F/P on great room side with Backboard for the future wall mount T.V.	
Line 79603	Note:	
7Jul23 / 7Jul23		

Inv.6328	1 - To supply & install the standard COFFERED CEILING in the dining room as per plan.	
Line 79599	Note:	
7Jul23 / 7Jul23		

Inv.6328	1 - Enlarge wall slightly on great room side to accomodate the standard NF-08 F/P mantle.	
Line 79600	Note:	
7Jul23 / 7Jul23		

PLUMBING

Inv.6328	1 - To supply & install the KITCHEN SOAP Dispencer - MOEN CHROME - MODEL 3942 in the kitchen... see spec's...see sketch # 1 for installation location.	
Line 79636	Note:	
7Jul23 / 7Jul23		

Inv.6328	1 - To supply & install the MIROLIN " BROOKE" freestanding tub in the master ensuite in lieu of the standard free standing tub.. see spec's	
Line 79612	Note:	
7Jul23 / 7Jul23		

TILE - FLOOR

Inv.6328	1 - To supply & install the UPGRADE 3 - FLOOR TILE - STACKED - FOYER TILE area in lieu of the standard floor tiles... see colour chart for details.	
Line 79633	Note:	
7Jul23 / 7Jul23		

Inv.6328	1 - To supply & install the UPGRADE 3 - FLOOR TILE - STACKED - KITCHEN/BREAKFAST TILE area in lieu of the standard floor tiles... see colour chart for details.	
Line 79634	Note:	
7Jul23 / 7Jul23		



CONSTRUCTION SUMMARY

KINGSMEN (THAMES) INC. / Havelock Corners (Kingsmen)

Lot/Unit: 33 Phase/Building: 5B Model/Floor Plan: Arthur (4205) Elev C 4 Bed - 4+1 Bath

EXTRAS AS PER OFFER

5 FREE APPLIANCES ? STAINLESS STEEL FRONT - FRIDGE: STOVE AND DISHWASHER. WHITE WASHER AND DRYER (SUPPLIED ONLY, NOT INSTALLED, FROM BUILDERS STANDARD LINE). AN APPLIANCES VOUCHER WILL BE GIVEN BY OUR DECOR CONSULTANT AT THE TIME OF BOOKING YOUR COLOUR A <i>Worksheet</i> Note:	
VENDOR TO INSTALL CAPPED GAS LINE (ROUGH-IN ONLY) AT REAR OF HOME FOR FUTURE BBQ LOCATION. LOCATION TO BE FINALIZED AT VENDORS SOLE DISCRETION. <i>Worksheet</i> Note:	
VENDOR TO SUPPLY & INSTALL AIR CONDITIONING UNIT, SIZED ACCORDINGLY, FROM VENDORS STANDARD SAMPLES. <i>Worksheet</i> Note:	

Purchaser: IQBAL SINGH KHAKH

Property: 33 of Plan - Draft Approval SB17-03-08

Telephone Res. / Bus: /

Project: KINGSMEN (THAMES) INC.

Decor Advisor: Barbara Coccia

Model and Elevation: Arthur (4205) Elev C 4 Bed - 4+1 Bath

Layout Changes: ☐ Yes ☒ No

Sketch Attached: ☒ Yes ☐ No

Exterior Colour Scheme:

1. Cabinetry

	Style and Colour	Counter Top	Hardware
Kitchen / Breakfast	#3 Charleston 3DL Rain Cloud	#1, C/S # 9141 Ice Snow 3cm.	# 135 Knob
Kitchen Island	#3 Charleston 3DL Rain Cloud	#1, C/S # 9141 Ice Snow 3cm.	# 135 Knob
Laundry Room	/		
Powder Room	#3 Georgian Navy Blue	# 1882K-52 Cippolino Grigio	# 12881 Handle
Main Bathroom	/		
Master Ensuite Bathroom	# 2 Slab LPL Stainless	# 4987K-07 Leche Vesta	# 12881 Handle
Second Ensuite Bathroom (If Applicable)	#3 Trinity LPL Free Spirt L580K	# P-345-LM Inukshuk Taupe	# 12881 Handle
Ens. #3's bathroom	# 2 Slab LPL Stainless	# 4987K-07 Leche Vesta	# 12881 Handle
Ens. #4's bathroom	#3 Trinity LPL Free Spirt L580K	# P-345-LM Inukshuk Taupe	# 12881 Handle

Appliances

Custom Size Fridge
☐ Yes ☒ No

Cooktop / Rangetop
☒ Yes ☐ No

Valance Lighting
☐ Yes ☒ No

Built in Wall Oven
☒ Yes ☐ No

Microwave / Range Hood
☐ Yes ☒ No

Slide-in Range
☐ Yes ☒ No

Comment

/

2. Flooring

	Selection
Foyer	**Upg. 3, 12 x24" Mayfair Volakas Grigio Rec. HD Polished Porclan STACKED)
Main Hall	/
Back Hall	/
Breakfast	**Upg. 3, 12 x24" Mayfair Volakas Grigio Rec. HD Polished Porclan STACKED)
Laundry Room	13x13" Burlingstone White
Kitchen	**Upg. 3, 12 x24" Mayfair Volakas Grigio Rec. HD Polished Porclan STACKED)
Powder Room	13x13" Cinq Black
Main Bathroom	Ens. #2's bathroom: 13x13" Burlingstone Lt. Grey
Master Ensuite	13x13" Burlingstone White
Bathroom (If Applicable)	Ens. #3's bathroom: 13x13" Burlingstone White
Mud Room	13x13" Cinq Black
Master ens. & Ens. #3's	Shower floor: 2x2" Ontario Snow White matte
Living Room	Ens. #4's bathroom: 13x13" Burlingstone Lt. Grey
Dining Room	3 1/2" Elements Oak Sturgeon
Family / Great Room	3 1/2" Elements Oak Sturgeon
Den / Library / Study	3 1/2" Elements Oak Sturgeon
Basement Landing (If Applies)	
Lower Landing (If Applicable)	3 1/2" Elements Oak Sturgeon
Upper Landing	(if applicable) 3 1/2" Elements Oak Sturgeon
Upper Hall	(& computer niche area) ** 3 1/2" Elements Oak Sturgeon
Master Bedroom	Modern Story 1, # 966 Spellbound
Bedroom #2	Modern Story 1, # 966 Spellbound
Bedroom #3	Modern Story 1, # 966 Spellbound
Bedroom #4	Modern Story 1, # 966 Spellbound
Bedroom #5	/
Master ens. & Ens. #3's	Shower jamb: Anatolia Marmilne SNOW

Property: 33 of Plan - Draft Approval SB17-03-08

Project: KINGSMEN (THAMES) INC.

Model and Elevation: Arthur (4205) Elev C 4 Bed - 4+1 Bath

4. Flooring - Continued -

Comment

3. Plumbing Fixtures / Faucets

Comment

Still to install the standard under mount kitchen sink with the standard single hole kitchen faucet NO PLATE.

4. Wall Tile

Comment

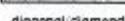
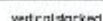
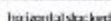

5. Fireplace

Comment

Initial:

Page 2 of 3

Purchaser: IQBAL SINGH KHAKH

Property: 33 of Plan - Draft Approval SB17-03-08

Telephone Res. / Bus: /

Project: KINGSMEN (THAMES) INC.

Decor Advisor: Barbara Coccia

Model and Elevation: Arthur (4205) Elev C 4 Bed - 4+1 Bath

6. Trim Carpentry

Door Hardware Standard Handle

Interior Trim Standard

Comment

/

Interior Doors

☐ 2 Panel Arch Top

☒ 2 Panel Square Top

☐ 6 Panel

Initial for Door Style

JK

7. Railings and Pickets

Railing Package Standard Oak TURNED picket package

Railing Colour Elements Sturgeon

Picket Colour Elements Sturgeon

Wood Stairs ☐ No ☒ Oak

Tread Colour Elements Sturgeon

Comment

/

8. Plaster Mouldings and Medallions

Foyer /

Main Hall /

Living Room /

Dining Room /

Family Room /

Kitchen/Breakfast /

Den/Library /

Lower Landing /

Comment

/

9. Wall Paint

Kingsmen White

Smooth Ceilings

☐ First Floor

☐ First Floor incl. Second Floor Hall

☐ First and Second Floor

☒ Throughout

☐ Not Applicable

Trim Paint Kingsmen White

10. Additional Comments

/

11. Disclaimers and Notes

- Colours of all materials are as close as possible to builder's selection, but not necessarily identical due to variances in manufacturing.
- Any extras listed above are null and void unless accompanied by a separate invoice/amendment. Said invoice must be paid in full.
- The Purchaser acknowledges that after Interior Colour Selection form is signed and dated, no further changes will be permitted other than re-selection due to unavailability.  Purchaser's Initials
- The Purchaser acknowledges reading and accepting the "Kingsmen Group Décor Centre Disclaimers" form. This document contains other miscellaneous disclaimers.

This Interior Colour Selection is final and approved by:

Purchaser:

Signature:  Date: 07/04/2013

Vendor:

KINGSMEN (THAMES) INC.

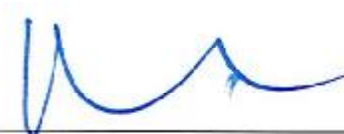

5B-33

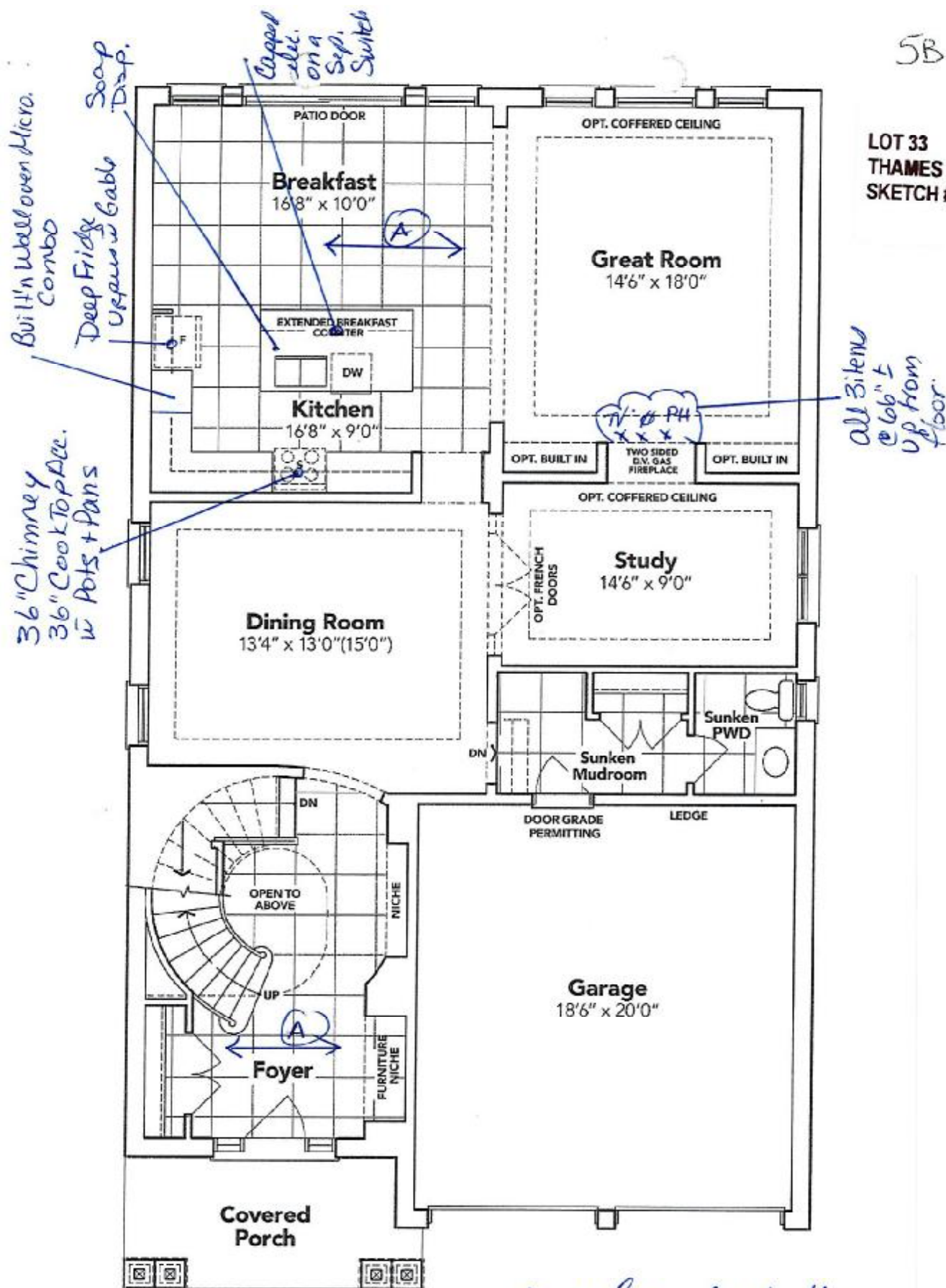
LOT 33
THAMES PH. 5B
SKETCH #1

Arjun Singh Khatt

GROUND FLOOR EL. C

The floor plans and elevations shown are pre-construction plans and may be revised or improved as necessitated by architectural controls and the construction process. The measurements adhere to the rules and regulations of the TARIION Warranty Corporation's official method for the calculation of floor area. Materials, specifications and floor plans are subject to change without notice. All house renderings are artist's concept only. Actual usable floor space may vary from the stated floor area. All options shown are upgrades. E. & O. E.

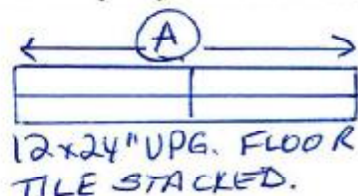

SB-33

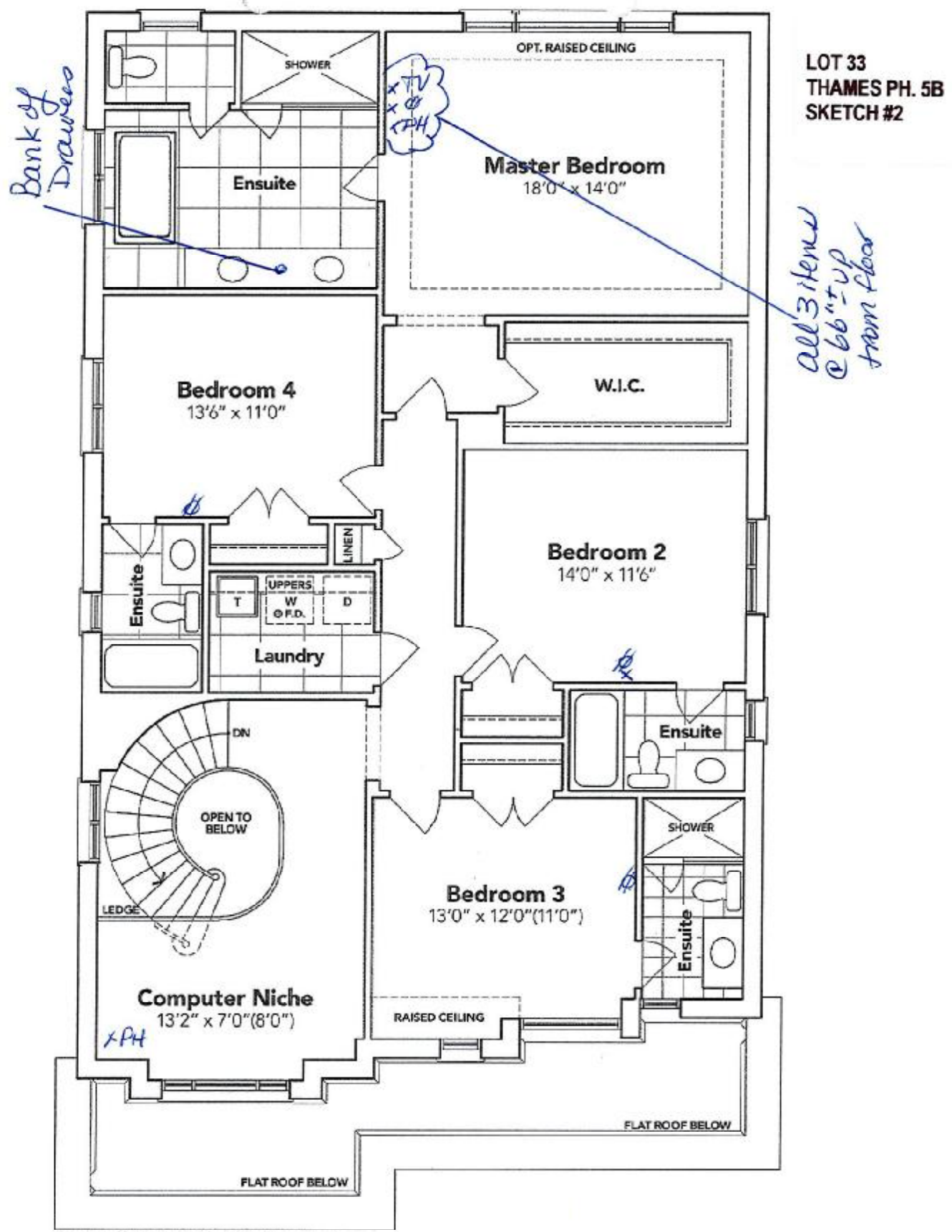

SECOND FLOOR EL. C

X 97601 Singh Khatt

The floor plans and elevations shown are pre-construction plans and may be revised or improved as necessitated by architectural controls and the construction process. The measurements adhere to the rules and regulations of the TARIION Warranty Corporation's official method for the calculation of floor area. Materials, specifications and floor plans are subject to change without notice. All house renderings are artist's concept only. Actual usable floor space may vary from the stated floor area. All options shown are upgrades. E. & O. E.

SCHEDULE "B-1"
Floor Plan

Lot 33
Phase 5B
Model: Arthur (4205) Elev C 4 Bed - 4+1 Bath
Standard

LOT 33
THAMES PH. 5B
SKETCH #3

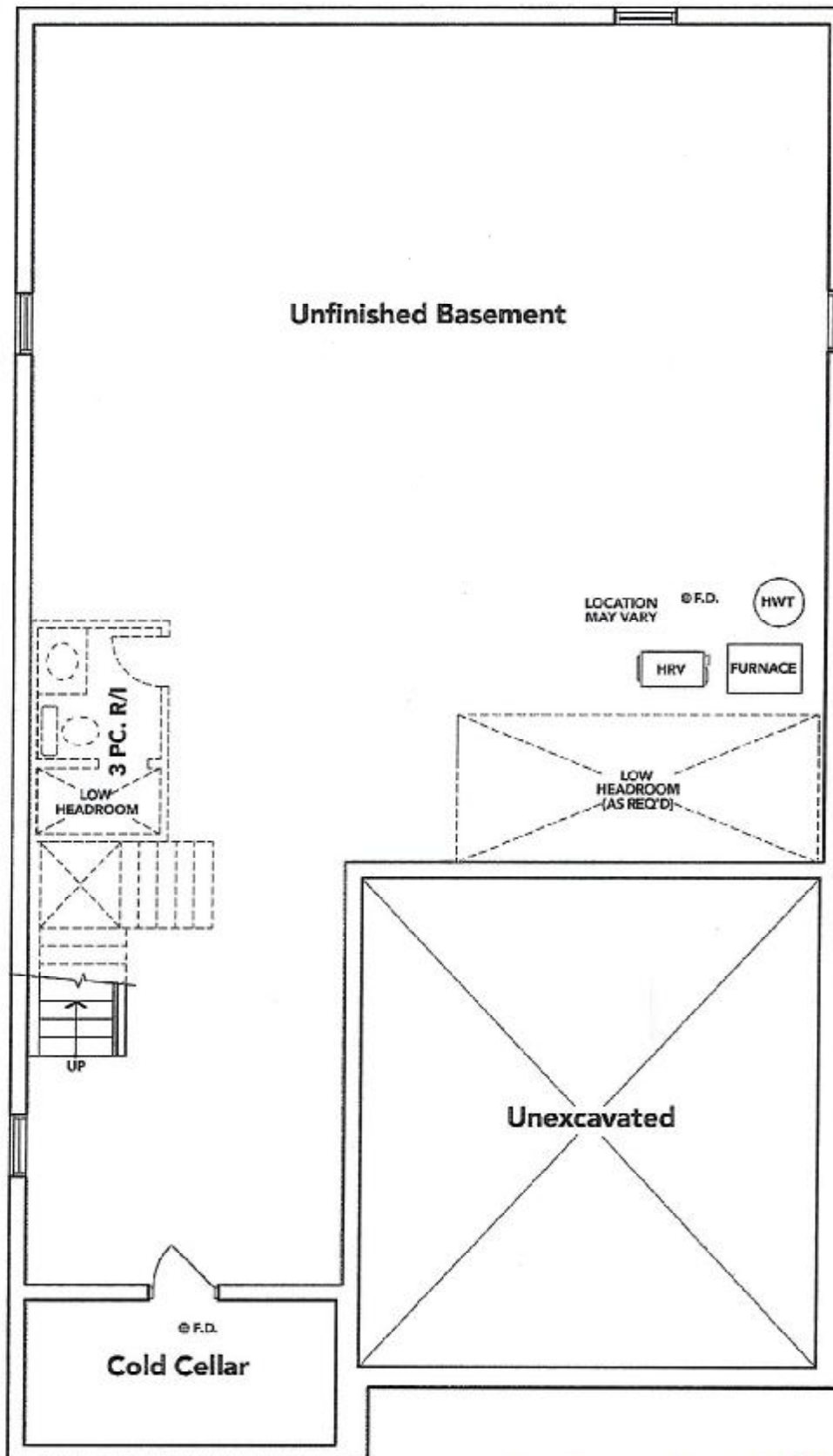

gibson Singh Khatri

BASEMENT EL. C

The floor plans and elevations shown are pre-construction plans and may be revised or improved as necessitated by architectural controls and the construction process. The measurements adhere to the rules and regulations of the TARION Warranty Corporation's official method for the calculation of floor area. Materials, specifications and floor plans are subject to change without notice. All house renderings are artist's concept only. Actual usable floor space may vary from the stated floor area. All options shown are upgrades. E. & O. E.

Specifications

Air Flow Volume: 650 CFM
Electrical Connection: 120V/60Hz
Power Consumption: 240 Watts
Current: 2.0 Amps
Fan Speed: 1599 RPM
Finishes: Stainless Steel
Duct: 6" Round
Knock-out: 6" Round - Top Only
Dimensions: Width: 30"/36"
Height: 44 1/2"
Depth: 19 3/4"
Noise Level: Min. 2 Sones
Max. 7 Sones

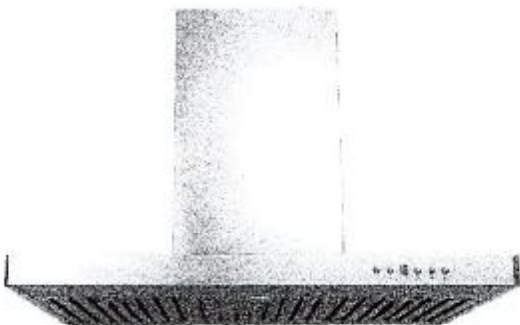

SCB722 - Baffle Filter



Ordering Model Chart

Model	Colour	Knock-out	Duct	Size	Filter	CFM
SCB72230	Stainless Steel	6"	6" Round	30"	Baffle	650
SCB72236	Stainless Steel	6"	6" Round	36"	Baffle	650

Notes

1 326 all 5 with photo



SB-33

LOT 33 THAMES PH. 5B
RE: UPG. SOAP DISPENSER IN KITCHEN

Soap or Lotion Dispensers

Traditional Transitional Modern

*However you define your faucet's style,
you can assure a coordinated look with Moen soap dispensers.*

KITCHEN



**Transitional Soap or
Lotion Dispenser**

Model 3942

Chrome -

Kristal Singh Khattar

SB-33

LOT 33 THAMES PH. 5B
RE: UPG. FREE STANDING TUB IN MASTER ENS.



Brooke™ | 1

Brooke™

Categories: Acrylic Freestanding

DESCRIPTION

68" Freestanding Bath
SKU #: CF2002

FEATURES

- Installation friendly two piece design
- Accepts deck mounted faucet
- Includes a chrome integral pop up drain and rectangular overflow
- ~~• Brushed nickel drain and overflow covers available~~
- Centre drain
- Includes levelling feet
- Available in White Only

DIMENSIONS

68" x 36" x 23"



α Total Singh draft

1326al Single Wall

Prepared by
Michael Lacelle
michaellacelle@hotmail.com (519) 690-1112



36" 5-Burner Gas Cooktop

KCGS556ESS

Available Finishes/Colours

KCGS556ESS
Stainless Steel

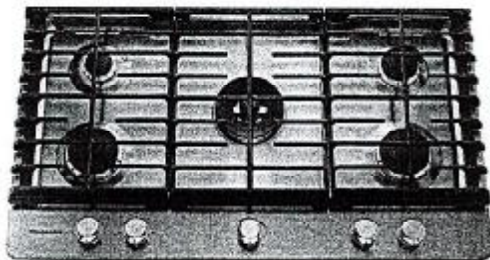

Dimensions	
Depth	21
Height	3 11/16
Width	36

Controls	
Control Location	Front
Control Type	Knobs
Infinite Heat Controls	Yes
Knob Color	Stainless Steel
Knob Type	Metal

Features	
Automatic Pan Detection	No

Features	
Digital Display	No
Downdraft Vent	No
Hot Surface Indicator Light	No
Installs Over Built-In Oven	Yes
Griddle	Optional Accessory
Heating Element On Indicator Light	No
LP Convertible	Yes - Kit Included
Power Boost	No
Power Outage Compatible	Yes
Selection	Simmer

GDS	
isBaseUnit	true

If you love to experiment and push culinary limits, you'll appreciate the power and versatility of this 36-inch cooktop. Five individual burners includes a powerful 20K BTU Dual Ring Burner that is among the most powerful in the industry. The eye-catching design includes Multi-Finish Knobs and the scratch-resistant CookShield Finish help protect the surface against stains that may occur with high-temperature cooking.

- Top Features
- 20K BTU Professional Dual Ring Burner
- CookShield Finish
- Electronic Ignition

- Manuals & Literature:
- [Dimension Guide](#)
 - [Installation Guide](#)
 - [Owner Manual](#)
 - [Warranty Information](#)

2 galsal Smith Hotel

30" (76.2 CM) AND 36" (91.4 CM) GAS BUILT-IN COOKTOP

PRODUCT MODEL NUMBERS

KCGS350E	KCGS950E	MGC9530D	WCG75US0D
KCGS356E	KCGS956E	MGC9536D	WCG97US0D
KCGS550E	MGC7430D	WCG51US0D	WCG97US6D
KCGS556E	MGC7536D	WCG51US6D	

GAS SUPPLY REQUIREMENTS

Type of Gas

Natural Gas:

This cooktop is factory set for use with Natural gas. If converting to LP gas, see the "LP Gas Conversion" instructions provided in the package containing literature. The model/serial rating plate located on the underside of the cooktop base has information on the types of gas that can be used. If the types of gas listed do not include the type of gas available, check with the local gas supplier.

LP Gas Conversion:

Conversion must be done by a qualified service technician.

No attempt shall be made to convert the cooktop from the gas specified on the model/serial rating plate for use with a different gas without consulting the serving gas supplier. See the Gas Conversion instructions provided in the package containing literature.

Gas Supply Line

Provide a gas supply line of 3/4" (1.9 cm) rigid pipe to the cooktop location. A smaller size pipe on longer runs may result in insufficient gas supply. Pipe-joint compounds that resist the action of LP gas must be used. Do not use TEFLON® tape. With LP gas, piping or tubing size should be 1/2" minimum. Usually, LP gas suppliers determine the size and materials used in the system.

Flexible metal appliance connector:

If local codes permit, use a 1/2" or 3/4" I.D. flexible stainless steel tubing gas connector, designed by CSA to connect the cooktop to the rigid gas supply line.



A 1/2" male pipe thread is needed for connection to the female pipe threads of the inlet to the cooktop pressure regulator.
Do not kink or damage the flexible metal tubing when moving the cooktop.

Must include a shutoff valve:

The supply line must be equipped with a manual shutoff valve. This valve should be located in the same room but external to the cooktop opening, such as an adjacent cabinet. It must be accessible without removing the cooktop, and it should be in a location that allows ease of opening and closing. Do not block access to shutoff valve. The valve is for turning on or shutting off gas to the cooktop.

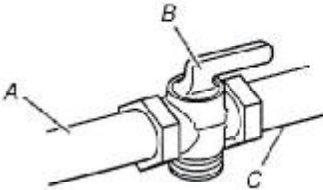

A. Gas supply line
B. Shutoff valve "open" position
C. To cooktop

®TEFLON is a registered trademark of E.I. Du Pont de Nemours and Company.

ELECTRICAL REQUIREMENTS

A 120 volt, 60 Hz, AC only, 15-amp, fused electrical circuit is required. A time-delay fuse or circuit breaker is also recommended. It is recommended that a separate circuit serving only this cooktop be provided.

Electronic ignition systems operate within wide voltage limits, but proper grounding and polarity are necessary. Check that the outlet provides 120-volt power and is correctly grounded.

** Global Supply Hub*

CABINET DIMENSIONS (CONT.)

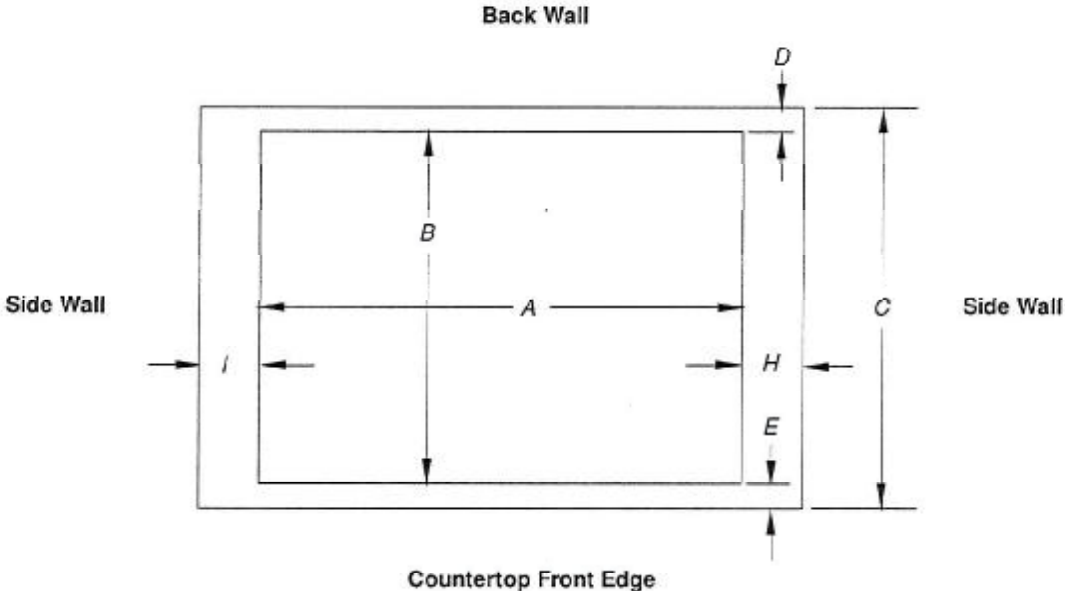

Cutout (Product Opening) Dimensions						
30" (76.2 cm) Models						
Models	A			B		
	Min	Recommended	Max	Min	Recommended	Max
KCGS550 and KCGS950 All Other 30" (76.2 cm) Models	28 1/2" (72.4 cm) 28 1/2" (72.4 cm)	28 7/8" (73.4 cm) 28 7/8" (73.4 cm)	29 1/2" (74.3 cm) 29 1/2" (74.3 cm)	19 1/2" (49.5 cm) 19" (48.3 cm)	19 3/4" (50.2 cm) 19 1/2" (49.5 cm)	20" (50.8 cm) 20" (50.8 cm)
36" (91.4 cm) Models						
KCGS556 and KCGS956 All Other 36" (91.4 cm) Models	34 3/4" (88.4 cm) 33 3/4" (86.0 cm)	35 3/4" (89.4 cm) 34 5/8" (87.0 cm)	35 7/8" (89.3 cm) 35 1/2" (89.5 cm)	19 1/2" (49.5 cm) 19" (48.3 cm)	19 3/4" (50.2 cm) 19 1/2" (49.5 cm)	20" (50.8 cm) 20" (50.8 cm)

Side Walls (Combustible Surfaces)	
Models	H and I
KCGS5 and KCGS9	H and I added together must be at least 48" (122.0 cm), with each side individually being at least 8" (20.3 cm).
KCGS350, KCGS356, MGC9536, WCG97US0, WCG97US6	H and I added together must be at least 48" (122.0 cm), with each side individually being at least 12" (30.5 cm).
All Other Models	Both have to be 8" (20.3 cm) or more.

Back Wall and Countertop Front Dimensions			
Models	C	D	E
KCGS550 and KCGS950	25" (63.5 cm)	2 7/8" (7.3 cm)	2 3/4" (6.9 cm)
All Other Models			3 1/4" (7.9 cm)

NOTES: After making the countertop cutout, some installations may require notching down the base cabinet side walls to clear the cooktop base. To avoid this modification, use a base cabinet with sidewalls wider than the cutout.
If cabinet has a drawer, a 4" (10.2 cm) depth clearance from the countertop to the top of the drawer (or other obstruction) in base cabinet is required. The drawer depth may need to be shortened to avoid interfering with the regulator.
IMPORTANT: If a built-in wall oven is to be installed below this cooktop, the grounded outlet and gas supply piping must be located in an adjacent cabinet.
This cooktop and its gas and electrical supply sources must be installed before the undercounter built-in wall oven is installed.

**gchad singh khatt*

PRODUCT DIMENSIONS

~~KCGS550ESS and KCGS950ESS Models~~

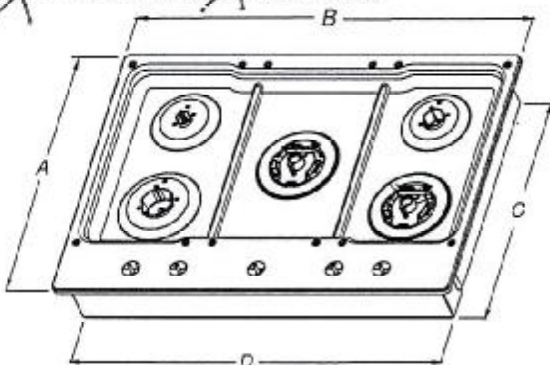

- | | |
|----------------------|---------------------|
| A. 21" (53.3 cm) | E. 3 3/4" (9.2 cm) |
| B. 30" (76.2 cm) | F. 4 1/2" (11.6 cm) |
| C. 19 3/4" (49.2 cm) | G. 1 3/4" (3.4 cm) |
| D. 28 3/4" (72.1 cm) | |

~~KCGS556ESS and KCGS956ESS Models~~

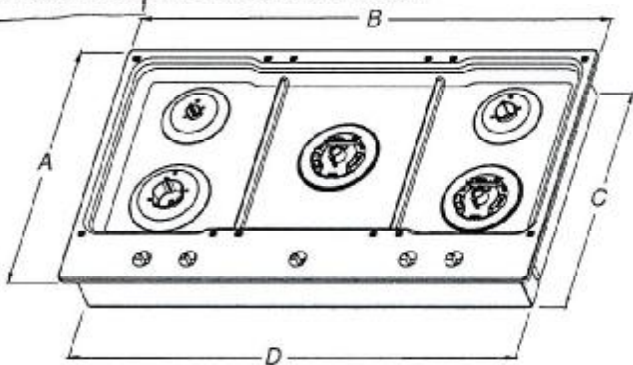

- | | |
|----------------------|---------------------|
| A. 21" (53.3 cm) | E. 3 3/4" (9.2 cm) |
| B. 36 1/2" (92.0 cm) | F. 4 1/2" (11.6 cm) |
| C. 19 3/4" (49.2 cm) | G. 1 3/4" (3.6 cm) |
| D. 34 3/4" (88.1 cm) | |

~~All Other 30" (76.2 cm) Models~~

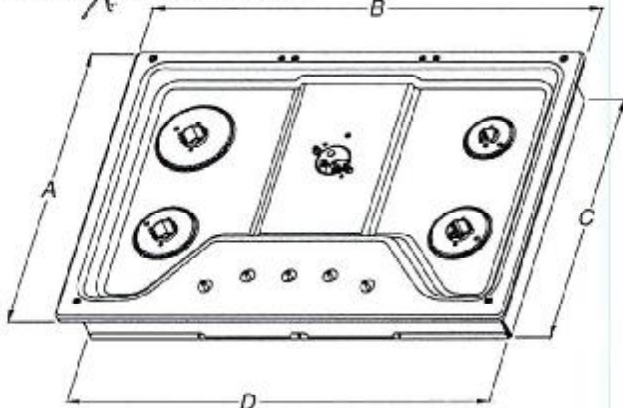

- | | |
|----------------------|---------------------|
| A. 21" (53.3 cm) | E. 3 3/4" (8.6 cm) |
| B. 30" (76.2 cm) | F. 4 1/2" (10.5 cm) |
| C. 18 7/8" (48.0 cm) | G. 1 1/2" (3.8 cm) |
| D. 28 3/4" (72.1 cm) | |

~~All Other 36" (91.4 cm) Models~~

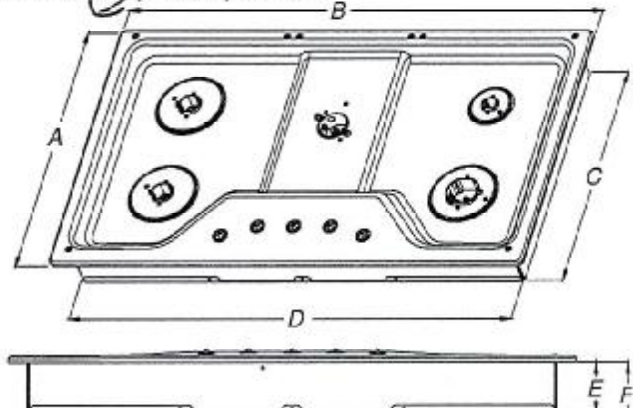

- | | |
|----------------------|---------------------|
| A. 21" (53.3 cm) | E. 3 3/4" (8.6 cm) |
| B. 36" (91.4 cm) | F. 4 1/2" (10.5 cm) |
| C. 18 7/8" (48.0 cm) | G. 1 1/2" (3.8 cm) |
| D. 33 3/4" (85.7 cm) | |

29601 Sany Khad

CABINET DIMENSIONS

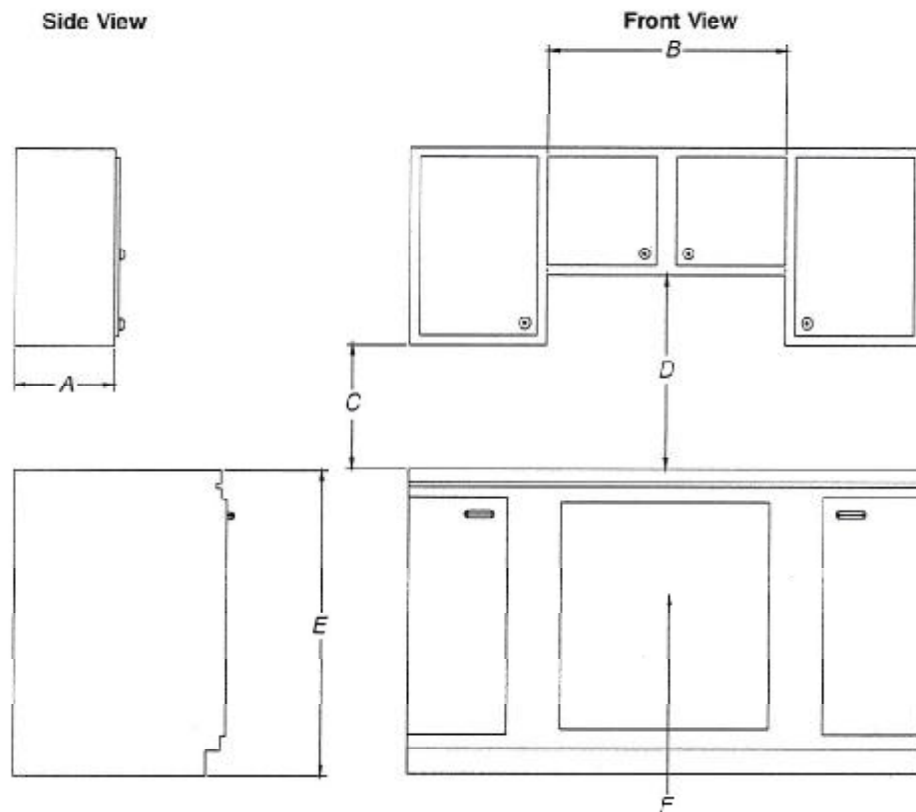

- A. 13" (33.0 cm) recommended upper cabinet depth.
- B. 36" (76.2 cm) for 30" models; 36" (91.4 cm) for 36" models.
- C. 18" (45.7 cm) minimum clearance from upper cabinet to countertop within minimum horizontal clearances to cooktop.
- D. 30" (76.2 cm) minimum clearance between top of cooktop platform and bottom of uncovered wood or metal cabinet. 24" (61 cm) minimum clearance if bottom of wood or metal cabinet is covered by not less than 1/8" (0.6 cm) flame retardant millboard covered with not less than No. 28 MSG sheet steel, 0.015" (0.04 cm) stainless steel, or 0.024" (0.06 cm) aluminum or 0.020" (0.05 cm) copper.
- E. 36" (91.4 cm) top of countertop to floor.
- F. Gas line opening - Wall: anywhere 5" (12.7 cm) below underside of countertop. Cabinet floor: anywhere within 6" (15.2 cm) of rear wall is recommended.

Arbab Singh Khatt

Prepared by
Michael Lacelle
michaellacelle@hotmail.com (519) 690-1112

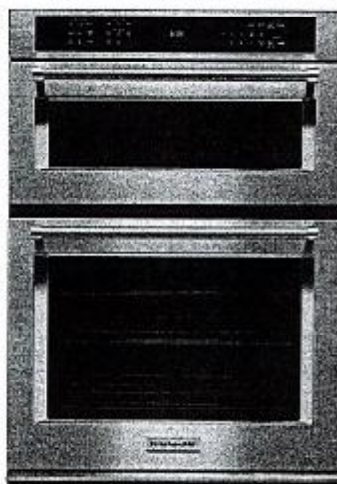

30" Combination Wall Oven with Even-Heat™ True Convection (Lower Oven)

KOCE500ESS

Available Finishes/Colours

KOCE500ESS
Stainless Steel

Dimensions	
Depth	27 1/8
Height	42 1/2
Width	30

Exterior	
Door Removable	Yes
Door Release	Handle
Door Lock	Yes
Door Type	Metal & Glass
Flush-Installation-Approved	Yes <i>NO</i>
Oven Window Size	Extra Large
Handle Color	Stainless Steel
Handle Material	Metal

Misc.	
Home Delivery	Yes
Will Call	Yes

Controls	
Display Color	White
Control Type	Glass Touch Digital Display
Electronic Display Type	Digital

GDS	
isBaseUnit	true
isConsumerUnit	true
isDispatchUnit	
isInvoiceUnit	true
isOrderableUnit	true
Product Type	EA
UDEX	1100400623
GPC Code	10001950

This 30" Combination Wall Oven with Even-Heat™ True Convection provides consistent heating and even cooking. A unique bow-tie shaped design and convection fan helps ensure there are no burnt edges or under cooked centers. Its upper Microwave Convection Cooking Oven combines a 900 watt microwave with a 1600 watt convection element for high speed cooking. Bold design details are the perfect balance of elegance and functionality.

Top Features	
Even-Heat™ True Convection Oven (lower oven)	
Microwave Convection Cooking (upper oven)	
Temperature Probe	

Manuals & Literature:

- [Dimension Guide](#)
- [Installation Guide](#)
- [Owner Manual](#)
- [Warranty Information](#)

Features	
Sensor Cooking	Yes - Microwave

2 tested single block

- Electrical supply junction box should be located 3" (7.6 cm) maximum below the support surface when the oven is installed in a wall cabinet. A 1" (2.5 cm) minimum diameter hole should have been drilled in the left rear corner of the support surface to pass the appliance cable through to the junction box.

- Oven support surface must be solid, level and flush with bottom of cabinet cutout. Floor must be able to support a total weight (microwave and built-in oven) of 208 lbs (95 kg) for 27" (68.6 cm) models or 249 lbs (113 kg) for 30" (76.2 cm) models.

IMPORTANT: To avoid damage to your cabinets, check with your builder or cabinet supplier to make sure that the materials used will not discolor, delaminate or sustain other damage. This oven has been designed in accordance with the requirements of UL and CSA International and complies with the maximum allowable wood cabinet temperatures of 194°F (90°C).

Product Dimensions

27" and 30" (68.6 cm and 76.2 cm) Ovens

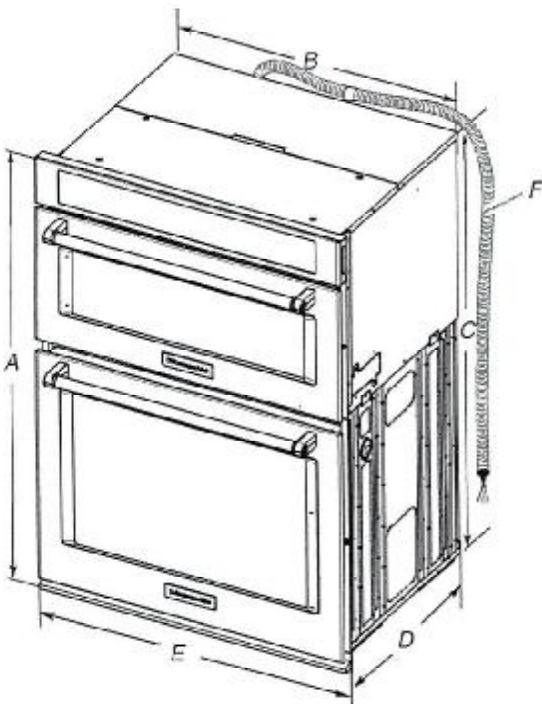

27" (68.6 cm) models

- A. 42 3/8" (108.0 cm) overall height
- B. 25 1/8" (64.6 cm) recessed width
- C. 41" (104.1 cm) recessed height
- D. 23 1/4" (59.1 cm) max. recessed depth
- E. 27" (68.6 cm) overall width
- F. 48" (121.9 cm) flexible conduit length measured from the conduit clamp located at the rear of the oven. Do not remove the conduit clamp.

30" (76.2 cm) models

- A. 42 3/8" (108.0 cm) overall height
- B. 28 1/8" (72.2 cm) recessed width
- C. 41" (104.1 cm) recessed height
- D. 23 1/4" (59.1 cm) max. recessed depth
- E. 30" (76.2 cm) overall width
- F. 48" (121.9 cm) flexible conduit length measured from the conduit clamp located at the rear of the oven. Do not remove the conduit clamp.

Cabinet Dimensions

27" and 30" (68.6 cm and 76.2 cm) Ovens

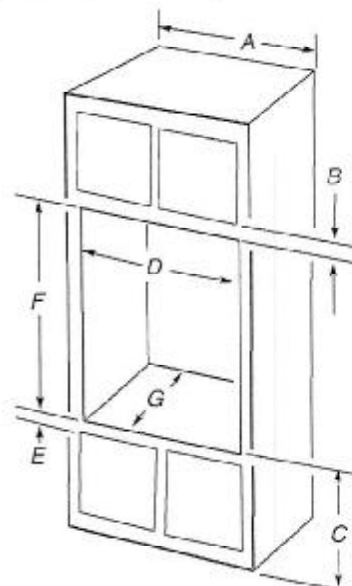

27" (68.6 cm) models

- A. 27" (68.6 cm) min. cabinet width
- B. 1" (2.5 cm) top of cutout to bottom of upper cabinet door
- C. 19 1/4" (48.9 cm) bottom of cutout to floor is recommended. 4"-19 1/4" (10.2-48.9 cm) bottom of cutout to floor is acceptable.
- D. 25 1/8" (64.8 cm) cutout width
- E. 1 1/8" (3.8 cm) min. bottom of cutout to top of cabinet door
- F. 41 3/8" (105 cm)* recommended cutout height
- G. 24" (60.7 cm) cutout depth

30" (76.2 cm) models

- A. 30" (76.2 cm) min. cabinet width
- B. 1" (2.5 cm) top of cutout to bottom of upper cabinet door
- C. 19 1/4" (48.9 cm) bottom of cutout to floor is recommended. 4"-19 1/4" (10.2-48.9 cm) bottom of cutout to floor is acceptable.
- D. 28 1/8" (72.4 cm) cutout width
- E. 1 1/8" (3.8 cm) min. bottom of cutout to top of cabinet door
- F. 41 3/8" (105 cm)* recommended cutout height
- G. 24" (60.7 cm) cutout depth

*NOTE: The cutout height can be between 41" and 41 1/2" (104.1 cm and 105.6 cm) for microwave/oven combination.

Electrical Requirements

If codes permit and a separate ground wire is used, it is recommended that a qualified electrical installer determine that the ground path and wire gauge are in accordance with local codes.

Check with a qualified electrical installer if you are not sure the oven is properly grounded.

This oven must be connected to a grounded metal, permanent wiring system.

Be sure that the electrical connection and wire size are adequate and in conformance with the National Electrical Code, ANSI/NFPA 70-latest edition or CSA Standards C22.1-94, Canadian Electrical Code, Part 1 and C22.2 No. 0-M51-latest edition, and all local codes and ordinances.

A copy of the above code standards can be obtained from:

National Fire Protection Association
1 Batterymarch Park
Quincy, MA 02169-7471

CSA International
8501 East Pleasant Valley Road
Cleveland, OH 44131-5575

Arbab Singh Khanna

Electrical Connection

To properly install your oven, you must determine the type of electrical connection you will be using and follow the instructions provided for it here.

- Oven must be connected to the proper electrical voltage, amperage, and frequency as specified on the model/serial/rating plate. See the following illustration.

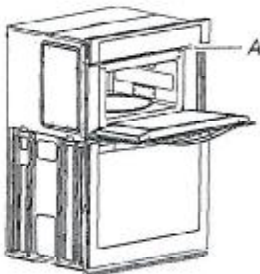

A. Model/serial/rating plate

- Models rated from 7.3 to 9.6 kW at 240 volts (5.4 to 7.4 kW at 208 volts) require a separate 40-amp circuit. Models rated at 4.8 kW and below at 240 volts (3.6 kW and below at 208 volts) require a separate 30-amp circuit.
- A circuit breaker is recommended.
- Connect directly to the fused disconnect (or circuit breaker box) through flexible, armored or nonmetallic sheathed, copper cable (with grounding wire). See "Make Electrical Connection" section.

- Flexible conduit from the oven should be connected directly to the junction box.
 - Do not cut the conduit. The length of conduit provided is for serviceability of the oven.
 - A UL listed or CSA approved conduit connector must be provided.
 - If the house has aluminum wiring, follow the procedure below:
 1. Connect a section of solid copper wire to the ends of the flexible conduit leads.
 2. Connect the aluminum wiring to the added section of copper wire using special connectors and/or tools designed and UL listed for joining copper to aluminum.
- Follow the electrical connector manufacturer's recommended procedure. Aluminum/copper connection must conform with local codes and industry accepted wiring practices.

For power requirements, refer to the following table.

Model	Voltage	Amperage (L1)*	Amperage (L2)*	Rating (W)
KOCE507E/ KOCE500E	120/240	32	30	8000
KOCE507E/ KOCE500E	120/208	30	28	6600

*Amperage values noted above are for information purposes only: The units are rated in watts.

INSTALLATION INSTRUCTIONS

Prepare Built-In Microwave/Oven Combination

1. Decide on the final location for the oven. Locate existing wiring to avoid drilling into or severing wiring during installation.

⚠ WARNING

Excessive Weight Hazard

Use two or more people to move and install oven.
Failure to do so can result in back or other injury.

2. To avoid floor damage, set the oven onto cardboard prior to installation. Do not use handle or any portion of the front frame for lifting.
3. Remember to remove bottom vent from the foam packing on top of oven.
4. Remove the shipping materials and tape from the oven.
5. Remove the hardware package from inside the bag containing literature.
6. Remove and set aside racks and other parts from inside the oven.
7. Move oven and cardboard close to the oven's final location.

Remove Oven Door(s)

IMPORTANT: Use two hands to remove oven door.

1. Prior to removing the oven door, prepare a surface where you will place it. This surface should be flat and covered with a soft blanket, or use the corner posts from your packaging material.
2. Open the oven door.
3. Locate the oven door hinge locks in both corners of the oven door, and then rotate the hinge locks toward the oven door to the unlocked position. If the door hinge lock is not rotated fully (see illustration B), the door will not remove properly.

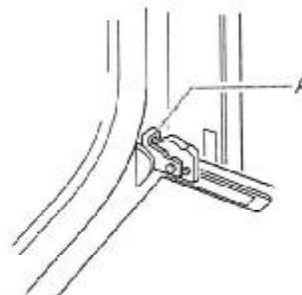

A. Oven door hinge lock in locked position

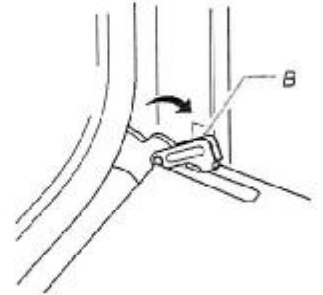

B. Oven door hinge lock in unlocked position