

KINGSMEN (THAMES) INC. / Havelock Corners (Kingsmen)

Lot/Unit: 14    Phase/Building: 5B    Model/Floor Plan: Philip (4202) Elev B 4 Bed - 2+1 Bath

ELECTRICAL

Inv.6329	1 - To supply & install the standard T.V. rough in in the great room and master bedroom... see sketch # 1 & # 2	
Line 79640	Note: Install the standard T.V. rough in at approx. 66" + - up from the floor centered + - to the F/P mantle	
10Jul23 / 10Jul23		
Inv.6329	1 - To supply & install the standard Phone ( CAT5 ) rough in in the great room, master bedroom and bedroom # 4 ... see sketch # 1 & # 2	
Line 79641	Note: Install the standard Phone ( CAT 5 ) rough in at approx. 66" + - up from the floor centered + - to the F/P mantle	
10Jul23 / 10Jul23		
Inv.6329	1 - To SUPPLY AND INSTALL AN ADDITIONAL BASIC RECEPTACLE (NOT DEDICATED) at approx. 66" + - up from the floor centered + - to the F/P	
Line 79644	Note: mantle in the great room...see sketch # 1	
10Jul23 / 10Jul23		
This is for a future wall mount T.V. NO CONDUIT PIPE HAS BEEN PURCHASED.		

HEATING AND AIR CONDITIONING

Inv.6329	1 - As per schedule "PE": Vendor to install capped gas line ( Rough in only ) at rear of home for future BBQ location. Location to be finalized at vendors sole discretion.	
Line 79638	Note:	
10Jul23 / 10Jul23		
Inv.6329	1 - As per schedule "PE": Vendor to supply & install air conditioning unit, sized accordingly, from vendors standard samples.	
Line 79639	Note:	
10Jul23 / 10Jul23		

MISCELLANEOUS

Inv.6329	1 - To supply & install the COFFERED CEILING in the living room as per plan.	
Line 79643	Note:	
10Jul23 / 10Jul23		

PLUMBING

Inv.6329	1 - To supply & install a WATERLINE ROUGH-IN TO THE FRIDGE LOCATION (NO HOOK UP) in the kitchen.	
Line 79645	Note:	
10Jul23 / 10Jul23		
Inv.6329	1 - To supply & instal the standard uner mount servery sink in the service area off the kitchen as per plan.	
Line 79642	Note:	
10Jul23 / 10Jul23		



CONSTRUCTION SUMMARY

KINGSMEN (THAMES) INC. / Havelock Corners (Kingsmen)

Lot/Unit: 14    Phase/Building: 5B    Model/Floor Plan: Philip (4202) Elev B 4 Bed - 2+1 Bath

EXTRAS AS PER OFFER

5 FREE APPLIANCES ? STAINLESS STEEL FRONT - FRIDGE: STOVE AND DISHWASHER. WHITE WASHER AND DRYER (SUPPLIED ONLY, NOT INSTALLED, FROM BUILDERS STANDARD LINE). AN APPLIANCES VOUCHER WILL BE GIVEN BY OUR DECOR CONSULTANT AT THE TIME OF BOOKING YOUR COLOUR A <i>Worksheet</i> Note:	
VENDOR TO INSTALL CAPPED GAS LINE (ROUGH-IN ONLY) AT REAR OF HOME FOR FUTURE BBQ LOCATION.    LOCATION TO BE FINALIZED AT VENDORS SOLE DISCRETION. <i>Worksheet</i> Note:	
VENDOR TO SUPPLY & INSTALL AIR CONDITIONING UNIT, SIZED ACCORDINGLY, FROM VENDORS STANDARD SAMPLES. <i>Worksheet</i> Note:	

Purchaser:PARMJIT KAUR

Property: 14 of Plan - Draft Approval SB17-03-08

Telephone Res. / Bus: /

Project: KINGSMEN (THAMES) INC.

Decor Advisor: Barbara Coccia

Model and Elevation: Philip (4202) Elev B 4 Bed - 2+1 Bath

Layout Changes: ☐ Yes ☒ No

Sketch Attached: ☐ Yes ☒ No

Exterior Colour Scheme:

1. Cabinetry	Style and Colour	Counter Top	Hardware
Kitchen / Breakfast	#3 Muskoka Moonlight	# 1 C/S # 9141 Ice Snow 3cm	# 12881 Handle
Kitchen Island	#3 Muskoka Moonlight	# 1 C/S # 9141 Ice Snow 3cm	# 12881 Handle
Laundry Room	/		
Powder Room	#3 Muskoka Moonlight	# 6696-46 Paloma Polar	# 12881 Handle
Main Bathroom	#3 Muskoka Orchid	# 4925K-07 Calcutta Marble	# 12881 Handle
Master Ensuite Bathroom	#3 Muskoka Orchid	# 4925K-07 Calcutta Marble	# 12881 Handle
Second Ensuite Bathroom (If Applicable)	/		
	/		
	/		

Appliances

Custom Size Fridge  
☐ Yes ☒ No

Cooktop / Rangetop  
☐ Yes ☒ No

Valance Lighting  
☐ Yes ☒ No

Built in Wall Oven  
☐ Yes ☒ No

Microwave / Range Hood  
☐ Yes ☒ No

Slide-in Range  
☐ Yes ☒ No

Comment  
/

2. Flooring

	Selection
Foyer	13x13" Burlingstone White
Main Hall	( Small hallway infront of powder room ) 3 1/2" Elements Oak Sturgeon
Back Hall	/
Breakfast	( Incl. service area ) 13x13" Burlingstone White
Laundry Room	13x13" Piaggio Grey
Kitchen	13x13" Burlingstone White
Powder Room	13x13" Burlingstone White
Main Bathroom	13x13" Piaggio Grey
Master Ensuite	13x13" Piaggio Grey
Bathroom (If Applicable)	/
Mud Room	13x13" Burlingstone White
Master ens. shower floor	2x2" Ontario Snow White Matte
Living Room	3 1/2" Elements Oak Sturgeon
Dining Room	3 1/2" Elements Oak Sturgeon
Family / Great Room	3 1/2" Elements Oak Sturgeon
Den / Library / Study	/
Basement Landing (If Applies)	
Lower Landing (If Applicable)	3 1/2" Elements Oak Sturgeon
Upper Landing	( if applicable ) 3 1/2" Elements Oak Sturgeon
Upper Hall	Modern Story 1, # 966 Spellbound
Master Bedroom	Modern Story 1, # 966 Spellbound
Bedroom #2	Modern Story 1, # 966 Spellbound
Bedroom #3	Modern Story 1, # 966 Spellbound
Bedroom #4	Modern Story 1, # 966 Spellbound
Bedroom #5	/
Master ens. shower jamb	Anatolia Marmiline SNOW

SEE ATTACHED FOR SIGNATURES



Initial: \_\_\_\_\_

Flooring Continued on Page 2

Purchaser: PARMJIT KAUR

Telephone Res. / Bus: /

Decor Advisor: Barbara Coccia

2. Flooring - Continued -

Property: 14 of Plan - Draft Approval SB17-03-08

Project: KINGSMEN (THAMES) INC.

Model and Elevation: Philip (4202) Elev B 4 Bed - 2+1 Bath

Upgrade Underpad	Type	Area
	Standard	2nd. Floor
Carpet on Stairs	Capped	Runner - *Upgrade
Comment	/	/

3. Plumbing Fixtures / Faucets

Kitchen	Standard	Second Ensuite	/	Powder Room	Standard
Master Ensuite	Standard			Other Room	/
Main Bathroom	Standard		/		

Comment

Still to install the standard under mount kitchen sink with the standard single hole kitchen faucet NO PLATE.

4. Wall Tile

	Tile Selection	Listello	Insert	Insert Selection
Main Bathroom	8X10" Weave White	<input type="checkbox"/>	<input type="checkbox"/>	
Master Ensuite				
Tub Deck	/	<input type="checkbox"/>	<input type="checkbox"/>	
Tub Apron	/	<input type="checkbox"/>	<input type="checkbox"/>	
Tub Surround	/	<input type="checkbox"/>		
Shower Stall	8X10" Weave White	<input type="checkbox"/>	<input type="checkbox"/>	
Second Ensuite	/	<input type="checkbox"/>	<input type="checkbox"/>	
	/	<input type="checkbox"/>	<input type="checkbox"/>	
	/	<input type="checkbox"/>	<input type="checkbox"/>	
Kitchen Backsplash	/	<input type="checkbox"/>	<input type="checkbox"/>	
Complete Backsplash	/	<input type="checkbox"/>	<input type="checkbox"/>	

Comment

/

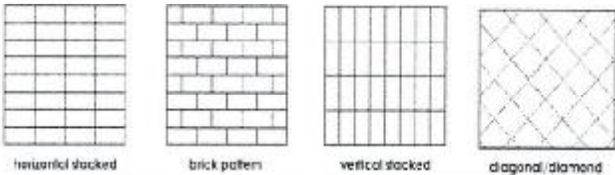

5. Fireplace

	Living Room			Family Room			Other Room - Specify Great Room		
	Purchased	As Per Plan	N/A	Purchased	As Per Plan	N/A	Purchased	As Per Plan	N/A
Fireplace Type	<input type="radio"/>	<input type="radio"/>	<input checked="" type="radio"/>	<input type="radio"/>	<input type="radio"/>	<input checked="" type="radio"/>	<input type="radio"/>	<input checked="" type="radio"/>	<input type="radio"/>
Mantle Type							Front Facing		
Over Mantle							NF-08		
Colour / Stain							/		
Surround							White		
Hearth							/		
Comment							/		

/

SEE ATTACHED FOR SIGNATURES



Initial: \_\_\_\_\_

Purchaser: PARMJIT KAUR

Telephone Res. / Bus: /

Decor Advisor: Barbara Coccia

Property: 14 of Plan - Draft Approval SB17-03-08

Project: KINGSMEN (THAMES) INC.

Model and Elevation: Philip (4202) Elev B 4 Bed - 2+1 Bath

6. Trim Carpentry

Door Hardware

Standard Handle

Interior Trim

Standard

Comment

/

Interior Doors

☐ 2 Panel Arch Top

☒ 2 Panel Square Top

☐ 6 Panel

Initial for Door Style

7. Railings and Pickets

Railing Package

Standard Oak STRAIGHT picket package

Railing Colour

Elements Sturgeon

Wood Stairs

☐ No☒ Oak

Picket Colour

Elements Sturgeon

Tread Colour

Elements Sturgeon

Comment

/

SEE ATTACHED FOR SIGNATURES

8. Plaster Mouldings and Medallions

Foyer

/

Main Hall

/

Living Room

/

Dining Room

/

Family Room

/

Kitchen/Breakfast

/

Den/Library

/

Lower Landing

/

Comment

/

9. Wall Paint

Kingsmen White

Smooth Ceilings

☐ First Floor

☐ First Floor incl. Second Floor Hall

☐ First and Second Floor

☒ Throughout

☐ Not Applicable

Trim Paint

Kingsmen White

10. Additional Comments

/

11. Disclaimers and Notes

1) Colours of all materials are as close as possible to builder's selection, but not necessarily identical due to variances in manufacturing.

2) Any extras listed above are null and void unless accompanied by a separate invoice/amendment. Said invoice must be paid in full.

3) The Purchaser acknowledges that after Interior Colour Selection form is signed and dated, no further changes will be permitted other than re-selection due to unavailability.  Purchaser's Initials

4) The Purchaser acknowledges reading and accepting the "Kingsmen Group Décor Centre Disclaimers" form. This document contains other miscellaneous disclaimers.

SEE ATTACHED FOR SIGNATURES

This Interior Colour Selection is final and approved by:

Purchaser:

Signature: 

SEE ATTACHED FOR SIGNATURES

Vendor:

KINGSMEN (THAMES) INC.

Printed 7/10/2023 12:33:42

Page 3 of 3

SB-14

LOT: 14  
THAMES PH5B  
Sketch #1

all 3 items @  
66" top of floor

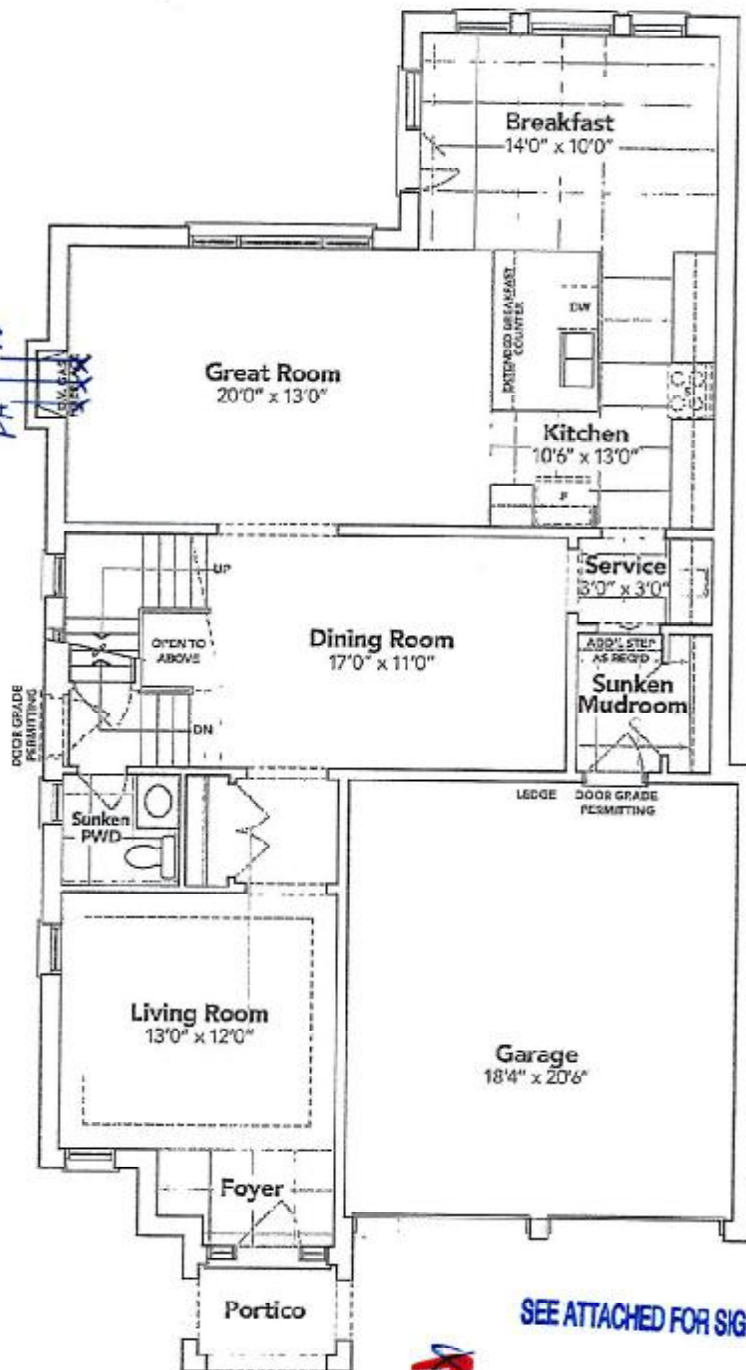

SEE ATTACHED FOR SIGNATURES

### GROUND FLOOR EL. B

The floor plans and elevations shown are pre-construction plans and may be revised or improved as necessitated by architectural controls and the construction process. The measurements adhere to the rules and regulations of the TARIION Warranty Corporation's official method for the calculation of floor area. Materials, specifications and floor plans are subject to change without notice. All house renderings are artist's concept only. Actual usable floor space may vary from the stated floor area. All options shown are upgrades. E. & C. E.

SB-14

LOT: 14  
Thames 5B  
Sketch #2

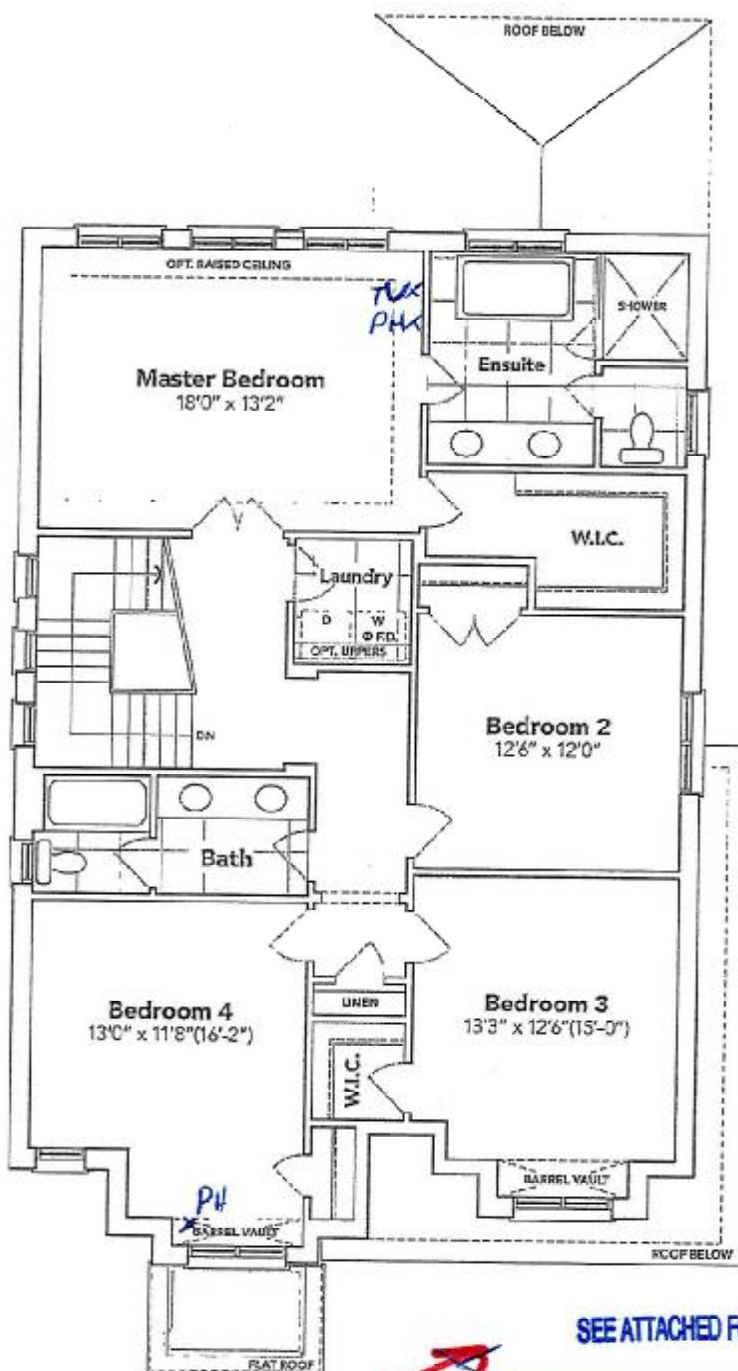

SEE ATTACHED FOR SIGNATURES

## SECOND FLOOR EL. B

The floor plans and elevations shown are pre-construction plans and may be revised or improved as necessitated by architectural controls and the construction process. The measurements adhere to the rules and regulations of the TARIION Warranty Corporation's official method for the calculation of floor area. Materials, specifications and floor plans are subject to change without notice. All house renderings are artist's concept only. Actual usable floor space may vary from the stated floor area. All options shown are upgrades. E. & O. E.

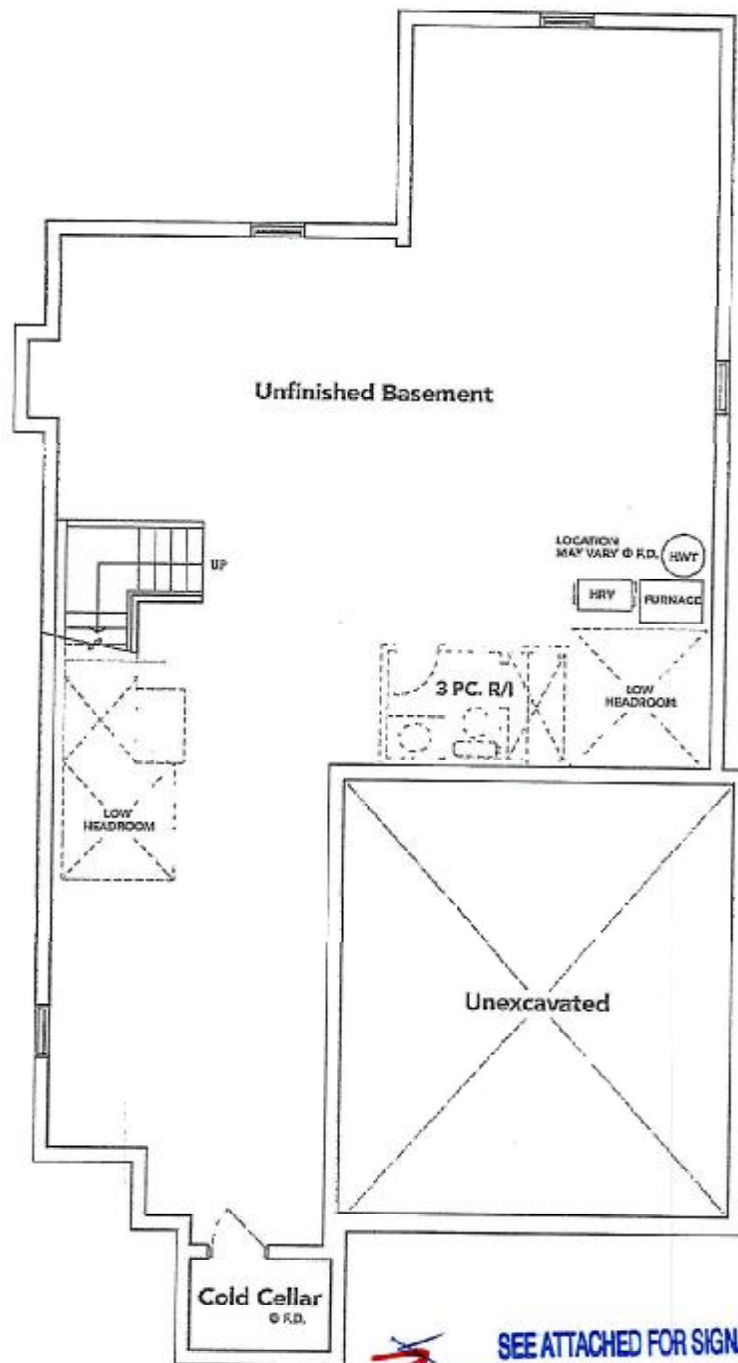

BASEMENT EL. B

The floor plans and elevations shown are pre-construction plans and may be revised or improved as necessitated by architectural controls and the construction process. The measurements adhere to the rules and regulations of the TARION Warranty Corporation's official method for the calculation of floor area. Materials, specifications and floor plans are subject to change without notice. All house renderings are artist's concept only. Actual usable floor space may vary from the stated floor area. All options shown are upgrades. E. & O. E.