

KINGSMEN (THAMES) INC. / Havelock Corners (Kingsmen)

Lot/Unit: 66    Phase/Building: 5B    Model/Floor Plan: James (3601) Elev A 4 Bed - 2+1 Bath

ELECTRICAL

Inv.6347	1 - To supply & install the standard T.V. rough in in the great room and master bedroom... see sketch # 1 & # 2	
Line 79790	Note: Install the standard T.V. rough in at approx. 66" + - up from the floor centered + - to the F/P mantle in the great room.	
26Jul23 / 26Jul23		
Inv.6347	1 - To supply & install the standard Phone ( CAT5 ) rough in in the great room, master bedroom and bedroom #2 ... see sketch # 1 & # 2	
Line 79791	Note: Install the standard Phone (CAT 5) rough in at approx. 66" + - up from the floor centered + - to the F/P mantle in the great room.	
26Jul23 / 26Jul23		
Inv.6347	1 - To SUPPLY AND INSTALL AN ADDITIONAL BASIC RECEPTACLE (NOT DEDICATED) at approx. 66" + - up from the floor centered +- to the F/P mantle	
Line 79797	Note: in the great room... see sketch # 1	
26Jul23 / 26Jul23		
This is for a future wall mount T.V. NO CONDUIT PIPE HAS BEEN PURCHASED.		

HEATING AND AIR CONDITIONING

Inv.6347	1 - As per schedule "PE": Vendor to install capped gas line ( Rough in only ) at rear of home for future BBQ location. Location to be finalized at vendors sole discretion.	
Line 79788	Note:	
26Jul23 / 26Jul23		
Inv.6347	1 - As per schedule "PE": Vendor to supply & install air conditioning unit, sized accordingly, from vendors standard samples.	
Line 79789	Note:	
26Jul23 / 26Jul23		

EXTRAS AS PER OFFER

5 FREE APPLIANCES ? STAINLESS STEEL FRONT - FRIDGE: STOVE AND DISHWASHER. WHITE WASHER AND DRYER (SUPPLIED ONLY, NOT INSTALLED, FROM BUILDERS STANDARD LINE). AN APPLIANCES VOUCHER WILL BE GIVEN BY OUR DECOR CONSULTANT AT THE TIME OF BOOKING YOUR COLOUR A Worksheet Note:	
5 FREE APPLIANCES – STAINLESS STEEL FRONT - FRIDGE; STOVE AND DISHWASHER. WHITE WASHER AND DRYER (SUPPLIED ONLY, NOT INSTALLED, FROM BUILDERS STANDARD LINE). AN APPLIANCES VOUCHER WILL BE GIVEN BY OUR DECOR CONSULTANT AT THE TIME OF BOOKING YOUR COLOUR A Worksheet Note:	
VENDOR TO INSTALL CAPPED GAS LINE (ROUGH-IN ONLY) AT REAR OF HOME FOR FUTURE BBQ LOCATION. LOCATION TO BE FINALIZED AT VENDORS SOLE DISCRETION. Worksheet Note:	
VENDOR TO SUPPLY & INSTALL AIR CONDITIONING UNIT, SIZED ACCORDINGLY, FROM VENDORS STANDARD SAMPLES. Worksheet Note:	

Purchasers:SHIVAM SURI, & RAKSHIT CHHABRA

Telephone Res. / Bus: /

Decor Advisor:Barbara Coccia

Layout Changes: ☐ Yes ☒ No

Property: 66 of Plan - Draft Approval SB17-03-08

Project: KINGSMEN (THAMES) INC.

Model and Elevation: James (3601) Elev A 4 Bed - 2+1 Bath

Sketch Attached: ☒ Yes ☐ No

Exterior Colour Scheme:

1. Cabinetry	Style and Colour	Counter Top	Hardware
Kitchen / Breakfast	#3 Muskoka Orchid	#1. C/S # 6041 Nordic Loft 3cm.	# 12881 Handle
Kitchen Island	#3 Muskoka Orchid	#1. C/S # 6041 Nordic Loft 3cm.	# 12881 Handle
Laundry Room	/		
Powder Room	#3 Muskoka Orchid	# P-344-LM Inukshuk Grey	# 12881 Handle
Main Bathroom	#3 Muskoka Orchid	# P-344-LM Inukshuk Grey	# 9671 Handle
Master Ensuite Bathroom	#3 Muskoka Orchid	# P-344-LM Inukshuk Grey	# 9671 Handle
Second Ensuite Bathroom (If Applicable)	/		
	/		
	/		

Appliances

Custom Size Fridge  
☐ Yes ☒ No

Cooktop / Rangetop  
☐ Yes ☒ No

Valance Lighting  
☐ Yes ☒ No

Built in Wall Oven  
☐ Yes ☒ No

Microwave / Range Hood  
☐ Yes ☒ No

Slide-in Range  
☐ Yes ☒ No

Comment  
/

2. Flooring	Selection
Foyer	13x13" Burlingstone Lt. Grey
Main Hall	13x13" Burlingstone Lt. Grey
Back Hall	/
Breakfast	13x13" Burlingstone Lt. Grey
Laundry Room	13x13" Burlingstone Lt. Grey
Kitchen	13x13" Burlingstone Lt. Grey
Powder Room	13x13" Burlingstone Lt. Grey
Main Bathroom	13x13" Burlingstone Lt. Grey
Master Ensuite	13x13" Burlingstone Lt. Grey
Bathroom (If Applicable)	/
Mud Room	13x13" Burlingstone Lt. Grey
Master ens. shower floor	2x2" Ontario Snow White Matte
Living Room	/
Dining Room	/
Family / Great Room	3 1/2" Elements Oak Natural
Den / Library / Study	/
Basement Landing (If Applies)	
Lower Landing (If Applicable)	3 1/2" Elements Oak Natural
Upper Landing	(if applicable ) 3 1/2" Elements Oak Natural
Upper Hall	Modern Story 1, # 809 Gondola
Master Bedroom	Modern Story 1, # 809 Gondola
Bedroom #2	Modern Story 1, # 809 Gondola
Bedroom #3	Modern Story 1, # 809 Gondola
Bedroom #4	Modern Story 1, # 809 Gondola
Bedroom #5	/
Master ens. shower jamb	Anatolia Mariline SNOW

Flooring Continued on Page 2

RC SS

Initial: \_\_\_\_\_

Purchasers: SHIVAM SURI, & RAKSHIT CHHABRA
Telephone Res. / Bus: /
Decor Advisor: Barbara Coccia
Property: 66 of Plan - Draft Approval SB17-03-08
Project: KINGSMEN (THAMES) INC.
Model and Elevation: James (3601) Elev A 4 Bed - 2+1 Bath
4. Flooring - Continued -

Table with 3 columns: Upgrade Underpad, Type, Area. Rows include Carpet on Stairs, Comment, and empty rows.

3. Plumbing Fixtures / Faucets

Table with 4 columns: Kitchen, Master Ensuite, Main Bathroom, Second Ensuite, Powder Room, Other Room. Includes standard selections and comment area.

4. Wall Tile

Table with 5 columns: Room, Tile Selection, Listello, Insert, Insert Selection. Rows include Main Bathroom, Master Ensuite, Tub Deck, Tub Apron, Tub Surround, Shower Stall, Second Ensuite, Kitchen Backsplash, Complete Backsplash.

Comment: Install the standard 8x10" wall tiles on the 10" side stacked horizontally in the bathrooms where applicable. Includes tile pattern diagrams: horizontal stacked, brick pattern, vertical stacked, diagonal/diamond.

5. Fireplace

Table with 3 main sections: Living Room, Family Room, Other Room - Specify Great Room. Each section has radio buttons for Purchased, As Per Plan, N/A and text fields for Fireplace Type, Mantle Type, Over Mantle, Colour / Stain, Surround, Hearth.

Handwritten initials: RC and SS in red circles.



**Purchasers:** SHIVAM SURI, & RAKSHIT CHHABRA **Property:** 66 of Plan - Draft Approval SB17-03-08  
**Telephone Res. / Bus:** / **Project:** KINGSMEN (THAMES) INC.  
**Decor Advisor:** Barbara Coccia **Model and Elevation:** James (3601) Elev A 4 Bed - 2+1 Bath

### 6. Trim Carpentry

**Door Hardware** Standard Handle

**Interior Trim** Standard

**Comment**

/

#### Interior Doors

☐ 2 Panel Arch Top

☒ 2 Panel Square Top

☐ 6 Panel

Initial for Door Style

RC

SS

### 7. Railings and Pickets

**Railing Package** Standard Oak STRAIGHT picket package

**Railing Colour** Elements Natural

**Wood Stairs** ☐ No ☒ Oak

**Picket Colour** Elements Natural

**Tread Colour** Elements Natural

**Comment**

/

### 8. Plaster Mouldings and Medallions

**Foyer** /

**Main Hall** /

**Living Room** /

**Dining Room** /

**Family Room** /

**Kitchen/Breakfast** /

**Den/Library** /

**Lower Landing** /

**Comment**

/

### 9. Wall Paint

Kingsmen White

**Smooth Ceilings** ☐ First Floor

☐ First Floor incl. Second Floor Hall

☐ First and Second Floor

☒ Throughout

☐ Not Applicable

**Trim Paint** Kingsmen White

### 10. Additional Comments

/

### 11. Disclaimers and Notes

- Colours of all materials are as close as possible to builder's selection, but not necessarily identical due to variances in manufacturing.
- Any extras listed above are null and void unless accompanied by a separate invoice/amendment. Said invoice must be paid in full.
- The Purchaser acknowledges that after Interior Colour Selection form is signed and dated, no further changes will be permitted other than re-selection due to unavailability. RC SS Purchaser's Initials
- The Purchaser acknowledges reading and accepting the "Kingsmen Group Décor Centre Disclaimers" form. This document contains other miscellaneous disclaimers.

This Interior Colour Selection is final and approved by:

**Purchaser:**

Signature: Rakshit Date: 26-07-23

Signature: Shivam Suri Date: 26-07-23

**Vendor:**

KINGSMEN (THAMES) INC.

LOT 66  
THAMES PH.5B  
SKETCH #1

all 31mm  
66" up from  
floor.

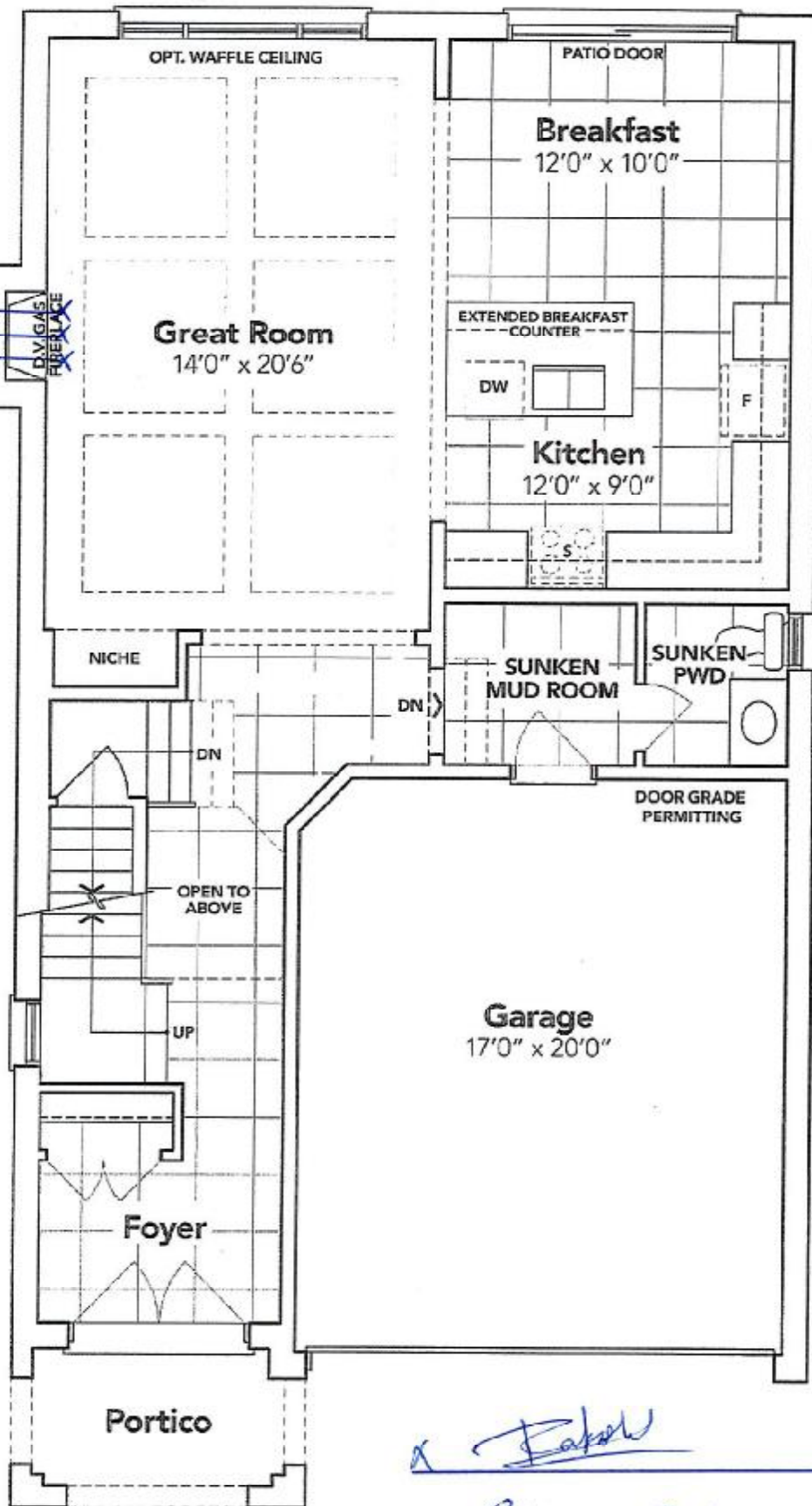

GROUND FLOOR EL. A

The floor plans and elevations shown are pre-construction plans and may be revised or improved as necessitated by architectural controls and the construction process. The measurements adhere to the rules and regulations of the TARIION Warranty Corporation's official method for the calculation of floor area. Materials, specifications and floor plans are subject to change without notice. All house renderings are artist's concept only. Actual usable floor space may vary from the stated floor area. All options shown are upgrades. E. & O. E.

X Isak  
X Shivam Suri

LOT 66  
THAMES PH.5B  
SKETCH #2

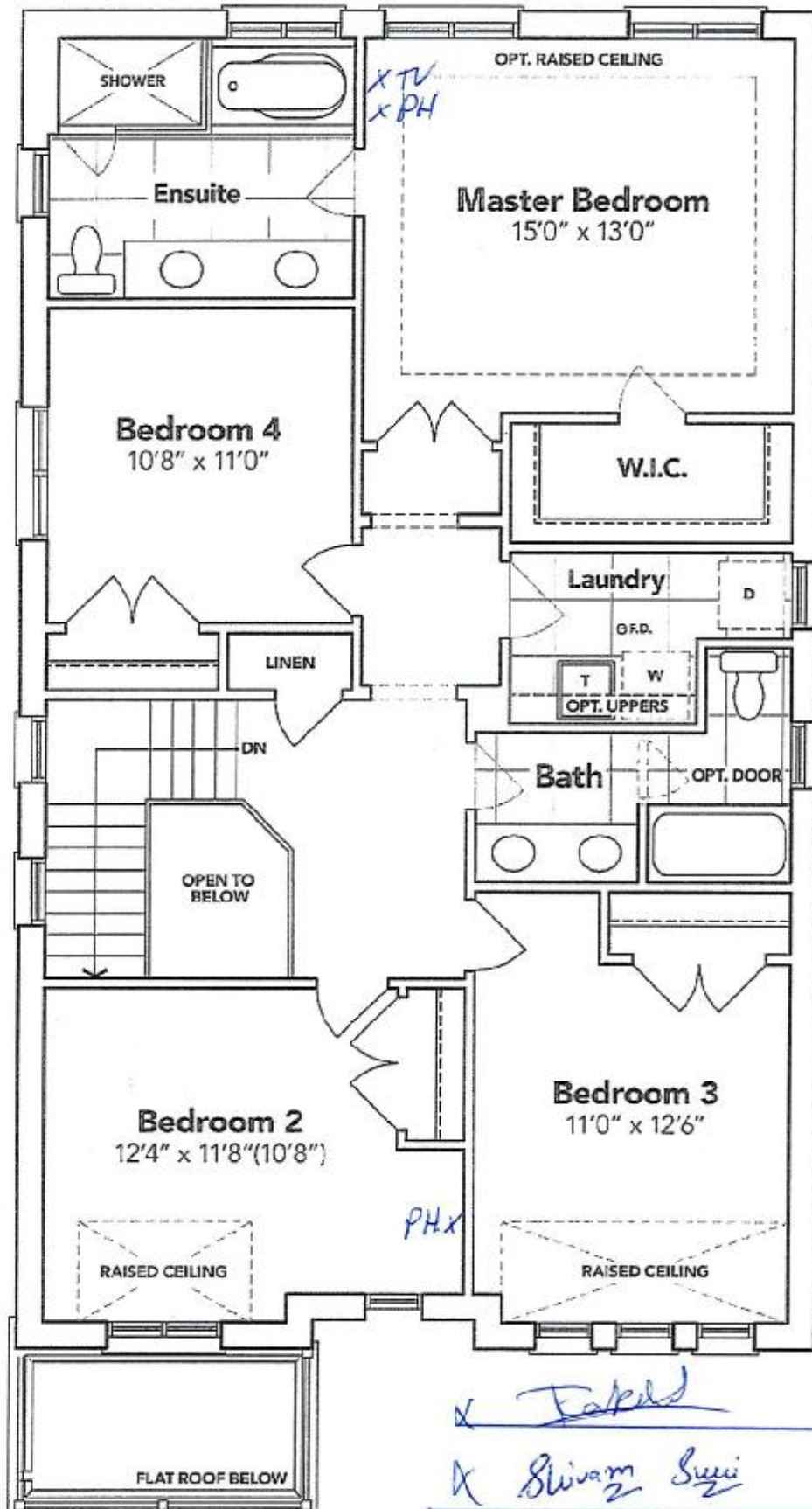

## SECOND FLOOR EL. A

The floor plans and elevations shown are pre-construction plans and may be revised or improved as necessitated by architectural controls and the construction process. The measurements adhere to the rules and regulations of the TARIION Warranty Corporation's official method for the calculation of floor area. Materials, specifications and floor plans are subject to change without notice. All house renderings are artist's concept only. Actual usable floor space may vary from the stated floor area. All options shown are upgrades. E. & O. E.



5B-66

**SCHEDULE "B-1"**  
**Floor Plan**

Lot 66  
Phase 5B  
Model: James (3601) Elev A 4 Bed - 2+1 Bath  
Standard

**LOT 66**  
**THAMES PH.5B**  
**SKETCH #3**

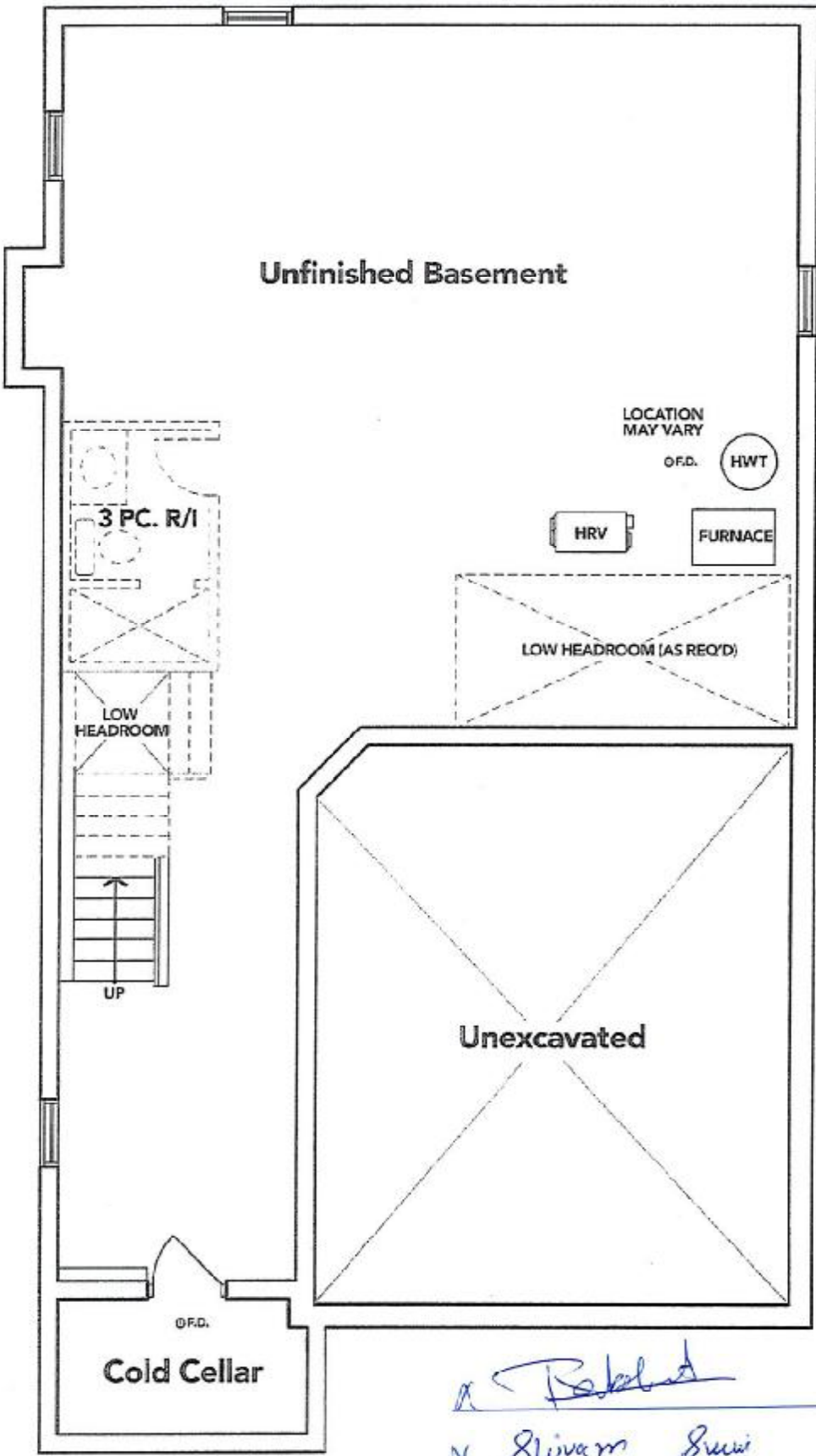

**BASEMENT EL. A**

The floor plans and elevations shown are pre-construction plans and may be revised or improved as necessitated by architectural controls and the construction process. The measurements adhere to the rules and regulations of the TARION Warranty Corporation's official method for the calculation of floor area. Materials, specifications and floor plans are subject to change without notice. All house renderings are artist's concept only. Actual usable floor space may vary from the stated floor area. All options shown are upgrades. E. & O. E.

Initials: RC SS