

KINGSMEN (THAMES) INC. / Havelock Corners (Kingsmen)

Lot/Unit: 40    Phase/Building: 5B    Model/Floor Plan: Spencer (4204) Elev C 4 Bed - 4+1 Bath

CABINETRY

Inv.6345	1 - To supply & install a 36" wide opening at stove location in lieu of the standard 30" wide stove opening in the kitchen.	
Line 79763	Note:	
25Jul23 / 25Jul23		

CABINETRY APPLIANCE - FRIDGE

Inv.6345	1 - To supply & install the 66CM DEEP FRIDGE ENCLOSURE - COUNTER DEPTH WITH - 1 WALL - 1 66CM DEEP GABLE AND 1 66CM DEEP CABINET - THIS IS NOT A ZERO CLEARANCE ENCLOSURE. STANDARD HEIGHTS AND WIDTHS WILL BE USED. - in the kitchen...see sketch # 1	
Line 79766	Note:	
25Jul23 / 25Jul23		

CABINETRY BASE CABINETS

Inv.6345	1 - To supply & install an additional BANK OF DRAWERS CABINET - 40cm + - in the kitchen... see sketch # 1	
Line 79767	Note:	
25Jul23 / 25Jul23		

CABINETRY HOOD FANS

Inv.6345	1 - To supply & install the HOOD FAN - PRO COLLECTION (SCB72236) WALL MOUNT RANGE HOOD WITH 650 CFM FAN - 36 INCH in lieu of the standard 30" stainless steel hood fan... see spec's	
Line 79764	Note:	
25Jul23 / 25Jul23		
Inv.6345	1 - To accomodate for the 36" wide upgraded chimney in the kitchen... see spec's	
Line 79765	Note:	
25Jul23 / 25Jul23		

CABINETRY MICROWAVE OVEN STOVE COOKTOP

Inv.6345	1 - To supply & install the built in tall appliance cabinet with drawers below and two flip up doors above the future microwave with trim kit... see sketch #1 for details.	
Line 79768	Note: To include an elec. outlet.	
25Jul23 / 25Jul23		

CABINETRY VANITY

Inv.6345	1 - To supply & install a VANITY BANK OF DRAWERS in the master ensuite... see sketch # 2	
Line 79769	Note:	
25Jul23 / 25Jul23		

COUNTER TOP

Inv.6345	1 - To supply & install the level 2 quartz 2cm. in the master bathroom in lieu of the standard lamiante countertop... see colour chart for details.	
Line 79782	Note: Purchaser has upgraded to under mount sinks, still to install the standard lav. faucets.	
25Jul23 / 25Jul23		

KINGSMEN (THAMES) INC. / Havelock Corners (Kingsmen)

Lot/Unit: 40    Phase/Building: 5B    Model/Floor Plan: Spencer (4204) Elev C 4 Bed - 4+1 Bath

Inv.6345	1 - To supply & install the level #1 quartz to the kitchen backsplash, to include area around the upgraded 36" chimney hood fan and upto the kitchen bulk head..	
Line 79783	Note: Purchaser is aware that there will be seams.	
25Jul23 / 25Jul23		

COUNTER TOP - VANITY

Inv.6345	1 - To supply & install the level 1 quartz 2cm. in the powder room in lieu of the standard lamiante countertop... see colour chart for details.	
Line 79781	Note: Purchaser has upgraded to under mount sink, still to install the standard lav. faucet.	
25Jul23 / 25Jul23		

ELECTRICAL

Inv.6345	1 - To supply & install the standard T.V. rough in in the great room and master bedroom... see sketch # 1 & # 2	
Line 79746	Note: Install the standard T.V. at approx. 66" +- up from the floor in the great room and master bedroom.	
25Jul23 / 25Jul23		

Inv.6345	1 - To supply & install the standard Phone ( CAT5 ) rough in in the great room, master bedroom and media niche area    ... see sketch # 1 & # 2	
Line 79747	Note: Install the standard Phone ( CAT 5) at approx. 66" +- up from the floor in the great room and master bedroom.	
25Jul23 / 25Jul23		

Inv.6345	1 - To SUPPLY AND INSTALL AN ADDITIONAL BASIC RECEPTACLE (NOT DEDICATED) at approx 66" + - up from the floor	
Line 79749	Note: in the great room... see sketch # 1	
25Jul23 / 25Jul23                      This is for a future wall mount T.V. NO CONDUIT PIPE HAS BEEN PURCHASED.		

Inv.6345	1 - To SUPPLY AND INSTALL AN ADDITIONAL BASIC RECEPTACLE (NOT DEDICATED) at approx. 66" + - up from the floor in the master bedroom	
Line 79750	Note: ... see sketch # 2	
25Jul23 / 25Jul23                      This is for a future wall mount T.V. NO CONDUIT PIPE HAS BEEN PURCHASED		

Inv.6345	1 - To SUPPLY AND INSTALL an additional RG6 CABLE ROUGH IN in the master bedroom at approx. 66" + - up from the floor... see sketch # 2	
Line 79751	Note:	
25Jul23 / 25Jul23		

Inv.6345	1 - To SUPPLY AND INSTALL and additional CAT-6 CABLE ROUGH IN in the master bedroom... see sketch # 2	
Line 79753	Note:	
25Jul23 / 25Jul23		

Inv.6345	1 - To SUPPLY AND INSTALL AN ADDITIONAL BASIC RECEPTACLE (NOT DEDICATED) at 66" + - up from the floor in the master bedroom...see sketch # 2	
Line 79754	Note:	
25Jul23 / 25Jul23		

Inv.6345	3 - To SUPPLY AND INSTALL THREE ADDITIONAL BASIC RECEPTACLE (NOT DEDICATED) at approx. 66" + - up from the floor..One in bedroom #2 and Two in bedroom#3	
Line 79755	Note: see sketch # 2	
25Jul23 / 25Jul23		

**KINGSMEN (THAMES) INC. / Havelock Corners (Kingsmen)**

**Lot/Unit: 40    Phase/Building: 5B    Model/Floor Plan: Spencer (4204) Elev C 4 Bed - 4+1 Bath**

Inv.6345	1 - To SUPPLY AND INSTALL EXTRA CEILING BOX ROUGH IN CAPPED (DOES NOT INCLUDE SWITCH) over the island in the kitchen... see sketch # 1	
Line 79756	Note: This capped elec. will be connected to a sep. switch, switch sold sep.	
25Jul23 / 25Jul23		
Inv.6345	1 - To supply & install AN ADDITIONAL SINGLE POLE SWITCH connected to the upg. capped elec. over the island in the kitchen.	
Line 79757	Note:	
25Jul23 / 25Jul23		
Inv.6345	1 - Relocate the standard ceiling light from the upper stair landing to the O.T.B. area on the second floor... see sketch # 2	
Line 79758	Note:	
25Jul23 / 25Jul23		
Inv.6345	1 - To SUPPLY AND INSTALL REINFORCING FOR A CEILING to the relocated light at the O.T.B. on the second floor... see sketch # 2	
Line 79759	Note:	
25Jul23 / 25Jul23		

**HARDWOOD**

Inv.6345	1 - To supply & install the 7" VINTAGE Northern Solid Sawn Collection Character Pearl Red oak engineered hardwood throughout the house in lieu of the standard hardwood & standard carpet. To include this engineered hardwood to the kitchen and breakfast area.	
Line 79773	Note: see colour chart for details.	
25Jul23 / 25Jul23		

**HEATING AND AIR CONDITIONING**

Inv.6345	1 - To supply & install a capped gas line ( rough in only ) at stove location in the kitchen, to include a 110V elec. outlet, code requirement. ( see stove spec's for details )	
Line 79762	Note:	
25Jul23 / 25Jul23		
Inv.6345	1 - To supply & install a HUMMIDIFIER to the furnace.	
Line 79760	Note:	
25Jul23 / 25Jul23		
Inv.6345	1 - As per schedule "PE": Vendor to install capped gas line ( Rough in only ) at rear of home for future BBQ location. Location to be finalized at vendors sole discretion.	
Line 79744	Note:	
25Jul23 / 25Jul23		
Inv.6345	1 - As per schedule "PE": Vendor to supply & install air conditioning unit, sized accordingly, from vendors standard samples.	
Line 79745	Note:	
25Jul23 / 25Jul23		

**MISCELLANEOUS**

Inv.6345	1 - To supply & install the standard COFFERED CEILING in the dining room as per plan... see sketch # 1	
Line 79748	Note:	
25Jul23 / 25Jul23		

KINGSMEN (THAMES) INC. / Havelock Corners (Kingsmen)

Lot/Unit: 40    Phase/Building: 5B    Model/Floor Plan: Spencer (4204) Elev C 4 Bed - 4+1 Bath

PLUMBING

Inv.6345	3 - To supply & instal the VANITY SINK - CONTRAC CATENA UNDERMOUNT - MODEL 4210CIY in lieu of the standard top mount vanity sink. Install one in the powder room and two in the master ensuite...see spec's	
Line 79779	Note: Still to install the standard lav. faucets.	
25Jul23 / 25Jul23		
Inv.6345	1 - To supply & install the Moen Chateau shower package for the master ensuite shower in lieu of the standard faucet... see spec's	
Line 79770	Note:	
25Jul23 / 25Jul23		
Inv.6345	1 - To supply & install the KITCHEN SINK - BLANCO QUATRUS U2 DBL UNDERMOUNT - MODEL 401247 in the kitchen in lieu of the standard under mount kitchen sink... see spec's	
Line 79771	Note: Still to install the standard single hole kitchen faucet NO PLATE.	
25Jul23 / 25Jul23		
Inv.6345	1 - To supply & install a WATERLINE ROUGH-IN TO THE FRIDGE LOCATION (NO HOOK UP) in the kitchen.	
Line 79761	Note:	
25Jul23 / 25Jul23		

RAILING

Inv.6345	1 - To supply & install the RAILING - UPGRADE 1 - METAL HANDRAIL 3 INCH OVAL IN OAK - PICKETS STEEL ½ INCH SQUARE, PLAIN, WITH SHOES IN FLAT BLACK - POSTS 3½ INCH SQUARE, WITH CAP OAK IN OAK throughout where applicable in lieu of the standard pickets & rails	
Line 79772	Note:	
25Jul23 / 25Jul23		

TILE - FLOOR

Inv.6345	1 - To supply & install the UPGRADE 4 - FLOOR TILE - STACKED - FOYER TILE in lieu of the standard floor tile... see colour chart for details.	
Line 79774	Note:	
25Jul23 / 25Jul23		
Inv.6345	1 - To supply & install the UPGRADE 4 - FLOOR TILE - STACKED - MUD ROOM TILE in lieu of the standard floor tile... see colour chart for details.	
Line 79775	Note:	
25Jul23 / 25Jul23		
Inv.6345	1 - To supply & install the UPGRADE 4 - FLOOR TILE - STACKED - POWDER ROOM TILE in lieu of the standard floor tile... see colour chart for details.	
Line 79776	Note:	
25Jul23 / 25Jul23		
Inv.6345	1 - To supply & install the UPGRADE 4 - FLOOR TILE - STACKED - MASTER ENS. FLOOR TILE in lieu of the standard floor tile... see colour chart for details.	
Line 79777	Note:	
25Jul23 / 25Jul23		

TRIM

KINGSMEN (THAMES) INC. / Havelock Corners (Kingsmen)

Lot/Unit: 40    Phase/Building: 5B    Model/Floor Plan: Spencer (4204) Elev C 4 Bed - 4+1 Bath

Inv.6345	1 - To supply & install the upg. MILAN ROUND handle in MATTE BLACK to include the hinges in MATTE BLACK throughout the house in lieu of the standard handles.	
Line 79778	Note:	
25Jul23 / 25Jul23		

EXTRAS AS PER OFFER

5 FREE APPLIANCES ? STAINLESS STEEL FRONT - FRIDGE: STOVE AND DISHWASHER. WHITE WASHER AND DRYER (SUPPLIED ONLY, NOT INSTALLED, FROM BUILDERS STANDARD LINE). AN APPLIANCES VOUCHER WILL BE GIVEN BY OUR DECOR CONSULTANT AT THE TIME OF BOOKING YOUR COLOUR A <i>Worksheet</i> Note:	
VENDOR TO INSTALL CAPPED GAS LINE (ROUGH-IN ONLY) AT REAR OF HOME FOR FUTURE BBQ LOCATION. LOCATION TO BE FINALIZED AT VENDORS SOLE DISCRETION. <i>Worksheet</i> Note:	
VENDOR TO SUPPLY & INSTALL AIR CONDITIONING UNIT, SIZED ACCORDINGLY, FROM VENDORS STANDARD SAMPLES. <i>Worksheet</i> Note:	



Purchaser: SATNAM KAUR,

Property: 40 of Plan - Draft Approval SB17-03-08

Telephone Res. / Bus: /

Project: KINGSMEN (THAMES) INC.

Decor Advisor: Barbara Coccia

Model and Elevation: Spencer (4204) Elev C 4 Bed - 4+1 Bath

Layout Changes: ☐ Yes ☒ No

Sketch Attached: ☒ Yes ☐ No

Exterior Colour Scheme: \_\_\_\_\_

### 1. Cabinetry

	Style and Colour	Counter Top	Hardware
Kitchen / Breakfast	#3 Simcoe Orchid	# 1 C/S # 9141 Ice Snow 3cm.	# 12881 Handle
Kitchen Island	#3 Simcoe Orchid	# 1 C/S # 9141 Ice Snow 3cm.	# 12881 Handle
Laundry Room	/		
Powder Room	#3 Simcoe Orchid	**# 1 C/S # 9141 Ice Snow 2cm.	# 12881 Handle
Main Bathroom	/		
Master Ensuite Bathroom	#3 Simcoe Orchid	**#2 H/S Whistler 2cm.	# 12881 Handle
Second Ensuite Bathroom (If Applicable)	#3 Simcoe Orchid	# 6698-46 Paloma Polar	# 12881 Handle
Ens.#3's bathroom	#3 Simcoe Orchid	# 6698-46 Paloma Polar	# 12881 Handle
Ens.#4's bathroom	#3 Simcoe Orchid	# 6698-46 Paloma Polar	# 12881 Handle

### Appliances

Custom Size Fridge

☐ Yes ☒ No

Valance Lighting

☐ Yes ☒ No

Microwave / Range Hood

☐ Yes ☒ No

Cooktop / Rangetop

☐ Yes ☒ No

Built in Wall Oven

☐ Yes ☒ No

Slide-in Range

☐ Yes ☒ No

Comment

/

### 2. Flooring

#### Selection

Foyer	**Upg. 4, 24 x 24" Mayair Calacatta Oro Polished Rec. HD porclan STACKED
Main Hall	**7" Vintage Northern Solid Sawn Collection Character Pearl Red Oak engineered " BAJA "
Back Hall	/
Breakfast	**7" Vintage Northern Solid Sawn Collection Character Pearl Red Oak engineered " BAJA "
Laundry Room	13x13" Keaton Ice
Kitchen	**7" Vintage Northern Solid Sawn Collection Character Pearl Red Oak engineered " BAJA "
Powder Room	**Upg. 4, 24 x 24" Mayair Calacatta Oro Polished Rec. HD porclan STACKED
Main Bathroom	Ens. #2's bathroom: 13x13" Keaton Ice
Master Ensuite	**Upg. 4, 24x24" Mayfair Volakas Grigio Polished Rec. HD porclan STACKED
Bathroom (If Applicable)	Ens. #3's bathroom: 13x13" Keaton Ice
Mud Room	**Upg. 4, 24 x 24" Mayair Calacatta Oro Polished Rec. HD porclan STACKED
Master & Ens. #2's	shower floor: 2x2" Ontario Snow White Matte
Living Room	Ens. #4's bathroom: 13x13" Keaton Ice
Dining Room	**7" Vintage Northern Solid Sawn Collection Character Pearl Red Oak engineered " BAJA "
Family / Great Room	**7" Vintage Northern Solid Sawn Collection Character Pearl Red Oak engineered " BAJA "
Den / Library / Study	/
Basement Landing (If Applies)	
Lower Landing (If Applicable)	**7" Vintage Northern Solid Sawn Collection Character Pearl Red Oak engineered " BAJA "
Upper Landing	( if applicable ) **7" Vintage N. Solid Sawn Collection Character Pearl Red Oak engineered " BAJA "
Upper Hall	& Meida Niche area **7" Vintage N. Solid Sawn Collection Character Pearl Red Oak engineered BAJA
Master Bedroom	**7" Vintage Northern Solid Sawn Collection Character Pearl Red Oak engineered " BAJA "
Bedroom #2	**7" Vintage Northern Solid Sawn Collection Character Pearl Red Oak engineered " BAJA "
Bedroom #3	**7" Vintage Northern Solid Sawn Collection Character Pearl Red Oak engineered " BAJA "
Bedroom #4	**7" Vintage Northern Solid Sawn Collection Character Pearl Red Oak engineered " BAJA "
Bedroom #5	/
Master & Ens. #2's	shower jamb: Anatolia Marmiline SNOW

Flooring Continued on Page 2

Initial: \_\_\_\_\_

Page 1 of 3



Purchaser: SATNAM KAUR,

Property: 40 of Plan - Draft Approval SB17-03-08

Telephone Res. / Bus: /

Project: KINGSMEN (THAMES) INC.

Decor Advisor: Barbara Coccia

Model and Elevation: Spencer (4204) Elev C 4 Bed - 4+1 Bath

4. Flooring - Continued -

Upgrade Underpad	Type	Area
	/	/
Carpet on Stairs	Capped	Runner - *Upgrade
	/	/
Comment		
/		

## 3. Plumbing Fixtures / Faucets

Kitchen	Standard	Second Ensuite	Standard	Powder Room	Standard
Master Ensuite	Standard			Other Room	/
Main Bathroom	/	Ens. #3's & #4's bathroom	Standard		

## Comment

Purchaser has upgraded the undermount kitchen sink, still to install the standard single hole kitchen faucet, NO PLATE.  
 Purchaser has upgraded to under mount sinks in the powder room and master ensuite, still to install the standard lav. faucets.  
 Purchaser has upgrade the shower faucet in master ensuite only.

## 4. Wall Tile

	Tile Selection	Listello	Insert	Insert Selection
Main Bathroom	/	<input type="checkbox"/>	<input type="checkbox"/>	
Master Ensuite	/	<input type="checkbox"/>	<input type="checkbox"/>	
Tub Deck	/	<input type="checkbox"/>	<input type="checkbox"/>	
Tub Apron	/	<input type="checkbox"/>	<input type="checkbox"/>	
Tub Surround	/	<input type="checkbox"/>	<input type="checkbox"/>	
Shower Stall	8x10" Weave White	<input type="checkbox"/>	<input type="checkbox"/>	
Second Ensuite	8x10" Keaton Ice	<input type="checkbox"/>	<input type="checkbox"/>	
Ens. #3s' bathroom	8x10" Keaton Ice	<input type="checkbox"/>	<input type="checkbox"/>	
Ens. #34s' bathroom	8x10" Keaton Ice	<input type="checkbox"/>	<input type="checkbox"/>	
Kitchen Backsplash	**#1 C/S # 9141 Ice snow slab ( see invoice for details)	<input type="checkbox"/>	<input type="checkbox"/>	
Complete Backsplash	/	<input type="checkbox"/>	<input type="checkbox"/>	

## Comment

Install the standard 8x10" wall tiles on the 10" side stacked horizontally in ens. #2, #3 & #4's bathroom ONLY where applicable.



horizontal stacked



brick pattern



vertical stacked



diagonal/diamond

## 5. Fireplace

## Living Room

Purchased As Per Plan N/A



## Family Room

Purchased As Per Plan N/A



## Other Room - Specify Great Room

Purchased As Per Plan N/A



Fireplace Type

Mantle Type

Over Mantle

Colour / Stain

Surround

Hearth

Comment

/

Front Facing

NF-08

/

White

/

/

/

/

/

/

/

/

/

/

/

/

/

Initial: \_\_\_\_\_

Page 2 of 3



Purchaser: SATNAM KAUR,  
Telephone Res. / Bus: /  
Decor Advisor: Barbara Coccia

Property: 40 of Plan - Draft Approval SB17-03-08  
Project: KINGSMEN (THAMES) INC.  
Model and Elevation: Spencer (4204) Elev C 4 Bed - 4+1 Bath

### 6. Trim Carpentry

Door Hardware \*\*Milan Round handle MATTE BLACK

Interior Trim Standard

Comment

\*\* HINGES TO BE IN MATTE BLACK AS WELL \*\*

#### Interior Doors

☐ 2 Panel Arch Top

☒ 2 Panel Square Top

☐ 6 Panel

Initial for Door Style

SK

### 7. Railings and Pickets

Railing Package \*\*Upg. #1 Metal Picket Package

Railing Colour Vintage "BAJA"

Wood Stairs ☐ No ☒ Oak

Picket Colour BLACK

Tread Colour Vintage "BAJA"

Comment

/

### 8. Plaster Mouldings and Medallions

Foyer /

Main Hall /

Living Room /

Dining Room /

Family Room /

Kitchen/Breakfast /

Den/Library /

Lower Landing /

Comment

/

### 9. Wall Paint

Kingsmen White

#### Smooth Ceilings

☐ First Floor

☐ First Floor incl. Second Floor Hall

☐ First and Second Floor

☒ Throughout

☐ Not Applicable

Trim Paint Kingsmen White

### 10. Additional Comments

/

### 11. Disclaimers and Notes

- Colours of all materials are as close as possible to builder's selection, but not necessarily identical due to variances in manufacturing.
- Any extras listed above are null and void unless accompanied by a separate invoice/amendment. Said invoice must be paid in full.
- The Purchaser acknowledges that after Interior Colour Selection form is signed and dated, no further changes will be permitted other than re-selection due to unavailability.  Purchaser's Initials
- The Purchaser acknowledges reading and accepting the "Kingsmen Group Décor Centre Disclaimers" form. This document contains other miscellaneous disclaimers.

This Interior Colour Selection is final and approved by:

Purchaser:

Signature:

Satnam Kaur

Date:

July 26, 2023

Vendor:

KINGSMEN (THAMES) INC.



LOT 40  
THAMES PH. 5B  
SKETCH #1

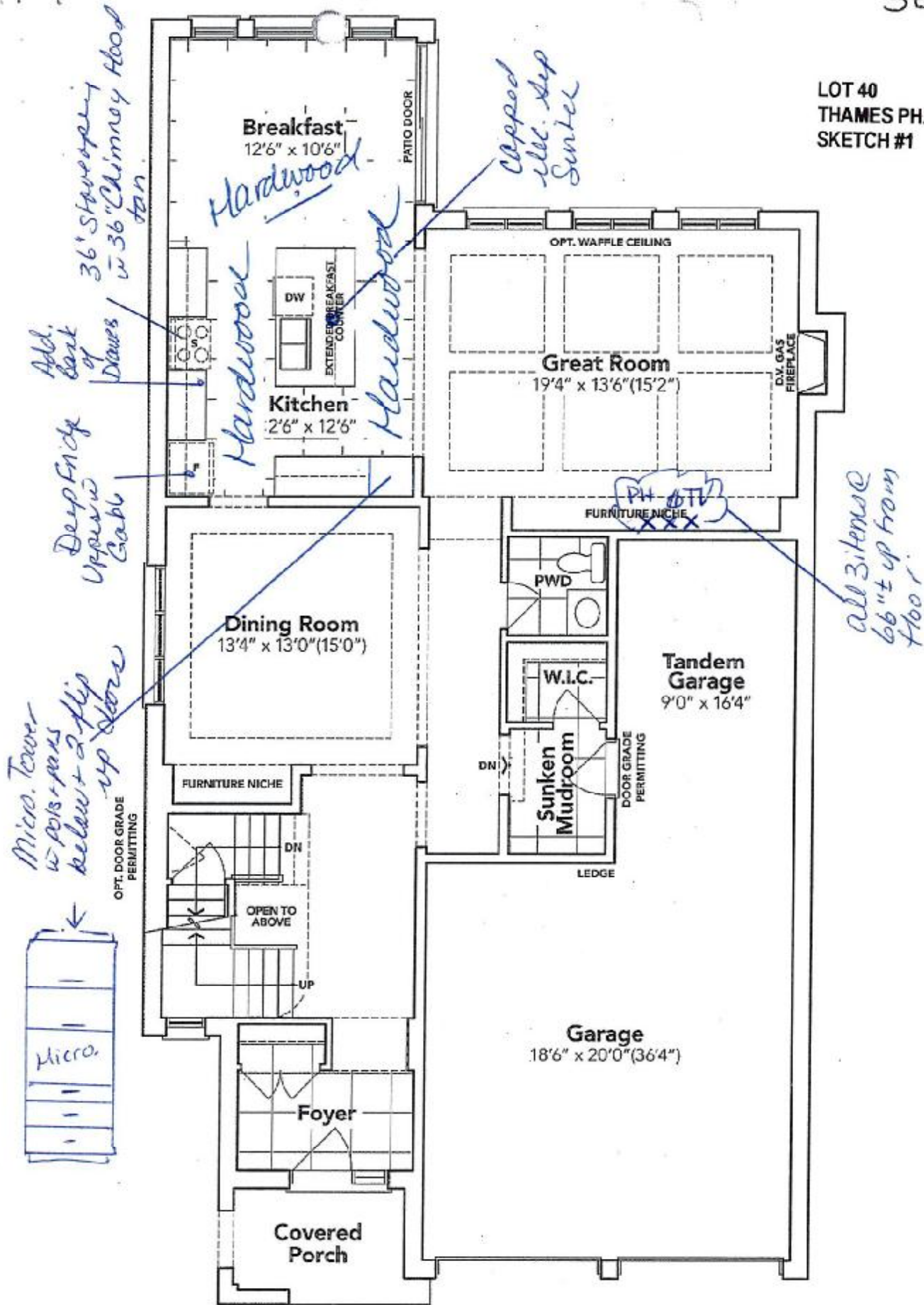

GROUND FLOOR EL. C

→ Satnam Kaur

The floor plans and elevations shown are pre-construction plans and may be revised or improved as necessitated by architectural controls and the construction process. The measurements adhere to the rules and regulations of the TARIION Warranty Corporation's official method for the calculation of floor area. Materials, specifications and floor plans are subject to change without notice. All house renderings are artist's concept only. Actual usable floor space may vary from the stated floor area. All options shown are upgrades. E. & O. E.

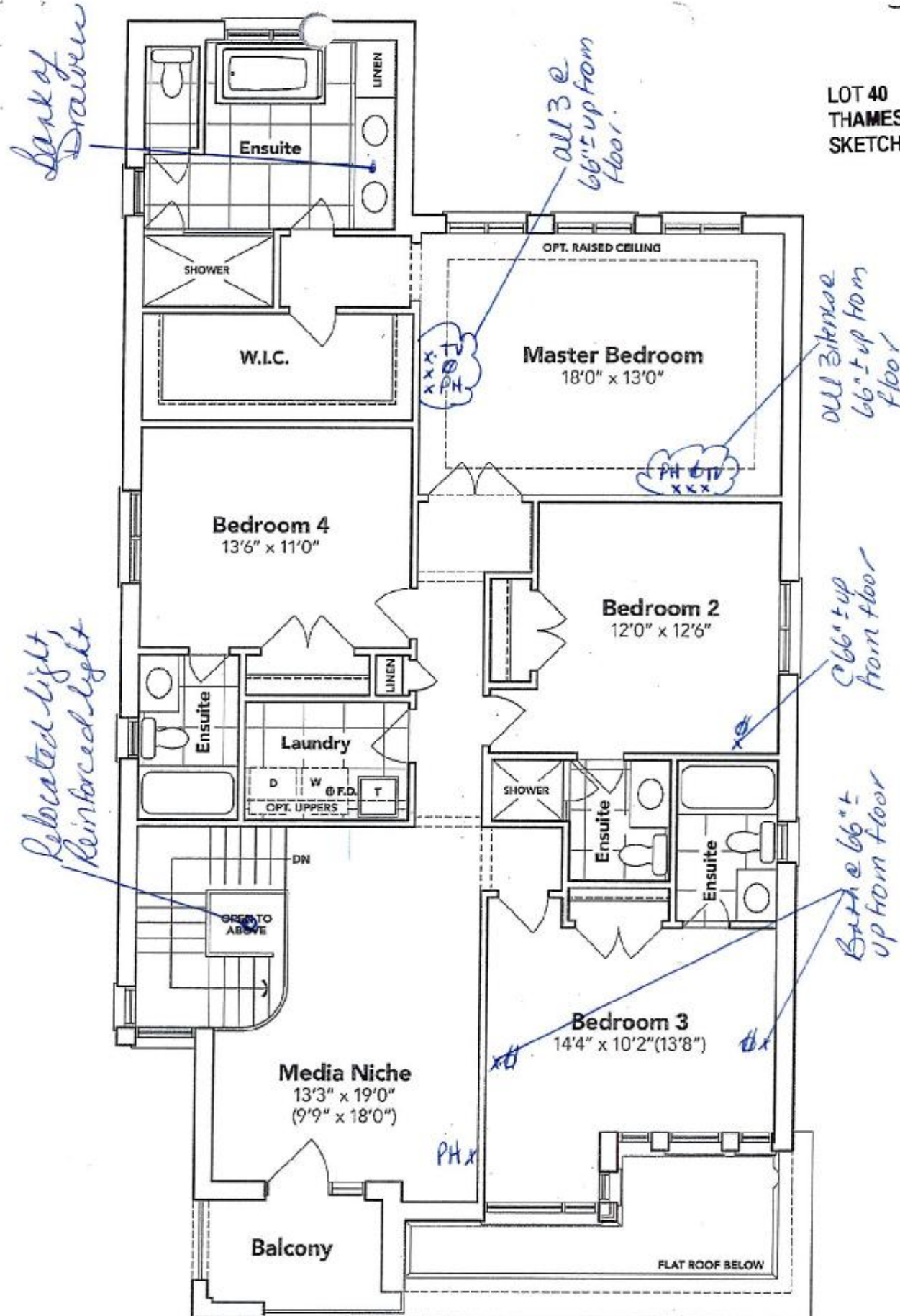

**SECOND FLOOR EL. C**

→ Satnam Kaur

The floor plans and elevations shown are pre-construction plans and may be revised or improved as necessitated by architectural controls and the construction process. The measurements adhere to the rules and regulations of the TARIION Warranty Corporation's official method for the calculation of floor area. Materials, specifications and floor plans are subject to change without notice. All house renderings are artist's concept only. Actual usable floor space may vary from the stated floor area. All options shown are upgrades. E. & O. E.



5B-40

SCHEDULE "B-1"  
Floor Plan

Lot 40  
Phase 5B  
Model: Spencer (4204) Elev C 4 Bed - 4+1 Bath  
Standard

LOT 40  
THAMES PH. 5B  
SKETCH #3

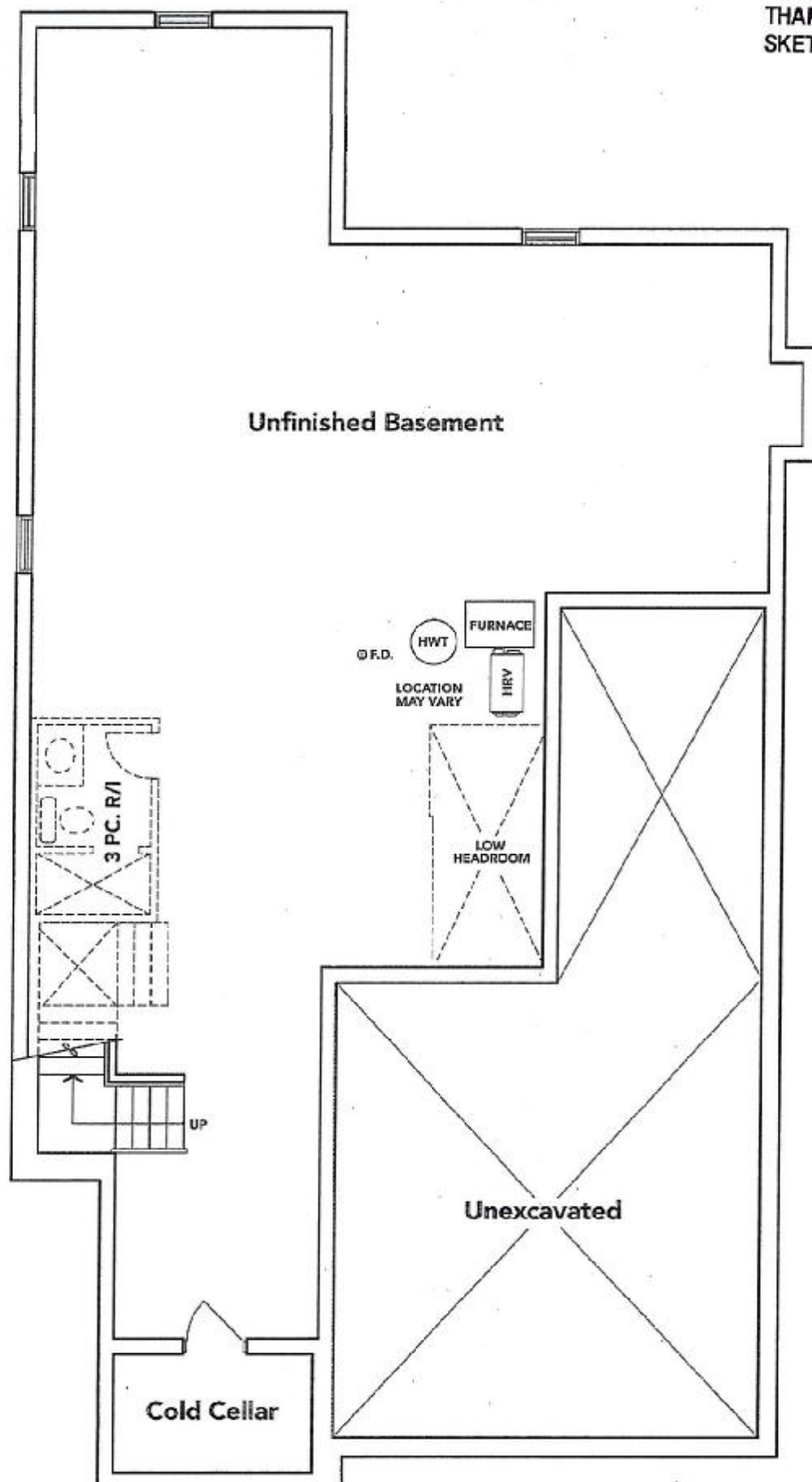

BASEMENT EL. C

*Satnam Kaur*

The floor plans and elevations shown are pre-construction plans and may be revised or improved as necessitated by architectural controls and the construction process. The measurements adhere to the rules and regulations of the TARION Warranty Corporation's official method for the calculation of floor area. Materials, specifications and floor plans are subject to change without notice. All house renderings are artist's concept only. Actual usable floor space may vary from the stated floor area. All options shown are upgrades. E. & O. E.



LOT 40 THAMES PH. 5B  
RE: UPG. 36" CHIMNEY HOOD FAN

## Specifications

Air Flow Volume: 650 CFM  
Electrical Connection: 120V/60Hz  
Power Consumption: 240 Watts  
Current: 2.0 Amps  
Fan Speed: 1599 RPM  
Finishes: Stainless Steel  
Duct: 6" Round  
Knock-out: 6" Round - Top Only  
Dimensions: Width: 30"/36"  
Height: 44 1/2"  
Depth: 19 3/4"  
Noise Level: Min. 2 Sones  
Max. 7 Sones

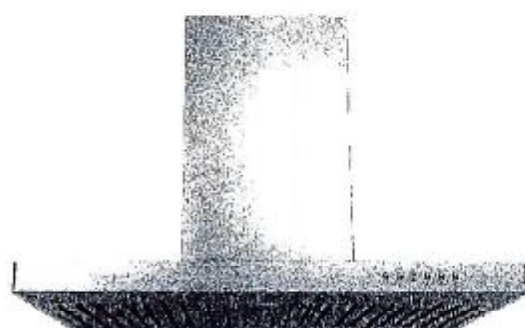

SCB722 - Baffle Filter



## Ordering Model Chart

Model	Colour	Knock-out	Duct	Size	Filter	CFM
SCB72230	Stainless Steel	6"	6" Round	30"	Baffle	650
SCB72236	Stainless Steel	6"	6" Round	36"	Baffle	650

## Notes

→ Satnam Kaur

**Cyclone**®  
Breathe Better



5B-40

LOT 40 THAMES PH. 5B  
RE: UPG. UNDER MOUNT KITCHEN SINK

# BLANCO

## Sink Specifications

Colour	SKU
brushed finish	401247

## Design and planning tips

- Min cabinet size: 36 in ( 915 mm )
- Bowl Depth: 9 in ( 230.0 mm )

### Specifications:

Installation clips, Sink template, Installation instructions, 3  
½" (90 mm) stainless steel strainers

Depending on cabinet construction, a different cabinet  
size may be required. Consult the cabinet manufacturer.

## QUATRUS U 2

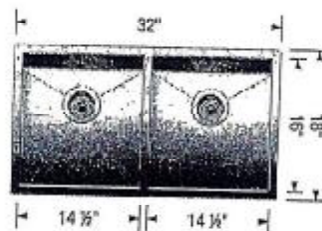

→ X Set nam Kaur

5B-46

LOT 40 THAMES PH. 5B  
RE: UPG. UNDER MOUNT VANITY SINK FOR  
POWDER ROOM AND MASTER ENSUITE  
ONLY

contrac

## CATENA

RECTANGULAR UNDERMOUNT SINK

□ 4210C1Y Undermount Sink

### PRODUCT SPECS:

- Vitreous china
- Front overflow hole
- Template and mounting hardware supplied

### DIMENSIONS:

#### Outer:

510mm W x 390mm D x 190mm H  
20" W x 15½" D x 7½" H

#### Inner:

458mm W x 340mm D x 140mm H  
18" W x 13½" D x 5½" H

### COMPLIANCE CERTIFICATIONS

Meets or exceeds the following:

- IAPMO cUPC
- ASME A112.19.2 / CSA B45.1
- OBC Section 3.8 Barrier Free design and CSA B651 Standard

### SHIPPING

Cube 1.72  
GW 27 lbs

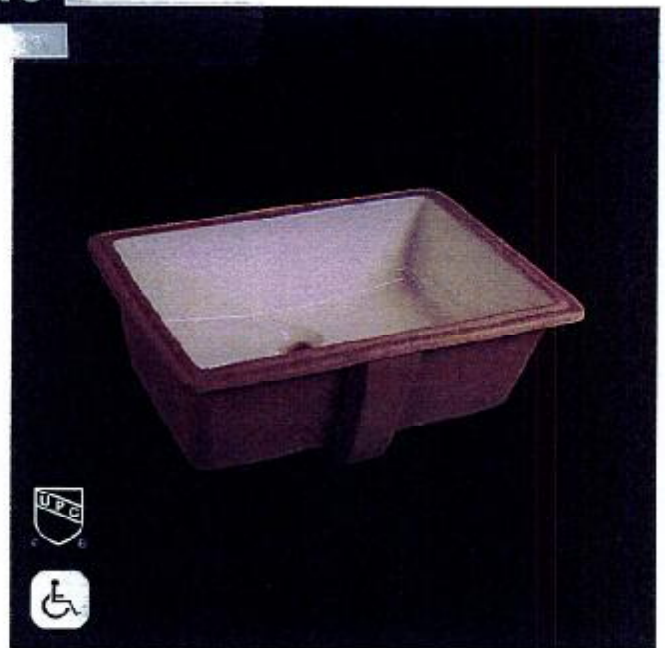

### TO BE SPECIFIED

Colour

■ Soft White

NOTES: Dimensions of fixtures are nominal and may vary within the range of tolerances established by ASME standard A112.19.2. These measurements are subject to change or cancellation. No responsibility is assumed for use of superseded or voided pages. Products are designed to comply with CSA B651 Standard and OBC barrier-free requirements. It shall be the responsibility of the installer to comply with the local disability codes and standards prior to installing the product.

→ Satnam Kaur

LOT 40 THAMES PH. 5B  
RE: UPG. SHOWER COMBO FOR MASTER ENS.  
ONLY



Satnam Kaur

## Shower Faucet

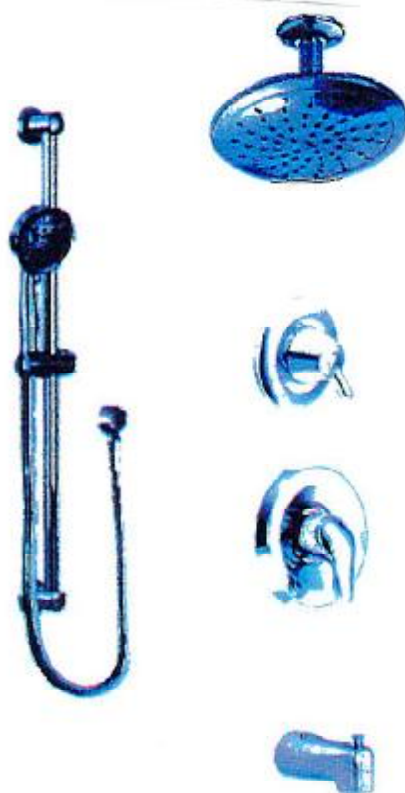

- Moen Chateau Shower Pkg**
- TL181/62320 Single Lever Chrome
  - TL4171/3372 Diverter
  - 3869EP/A725 Bar & Elbow
  - 6345 Rain 8" Head
  - 116651/AT2199 6" Arm & Flange
  - 3931 Toe tester Diverter Spout



LOT 40 THAMES PH. 5B  
RE: 36" WIDE GAS STOVE SPEC'S

HR 1134-3 G AG

36 inch range

All Gas with DirectSelect, Twin convection fans and M Pro dual stacked burners



- Turn dial operation with display – DirectSelect
- Plenty of space for cooking – six powerful burners
- Fast heating time and even heat distribution – TwinPower
- Easy clean-up – Self-cleaning and dishwasher-safe grates
- Easy opening & closing – noise and vibration absorbers

EAN: 4002516486558 / Material number: 11791410 / Old Material Number: 25113481USA

<b>Type of heating</b>	
All gas	•
Gas type	Natural gas
<b>Construction type</b>	
Range	•
Appliance width in inches	36
<b>Operating modes</b>	
Broil	•
Bake	•
Convection Roast	•
<b>Design</b>	
Appliance color	Clean Touch Steel
Oven display	EasyControl
<b>Cooktop features</b>	
Number of gas burners	6
Number of TrueSimmer burners x power in BTU	1 x 8.00
Number of power burners x power in BTU	2 x 9.00
Number of high burners x power in BTU	3 x 19.50
True Simmer function	•
GasStop	•
<b>Control panel</b>	
Precision knobs	•
Automatic switch-off	•
<b>User convenience</b>	
Time of day display	•
Minute minder	•
Programmable cooking time	•
Individual settings	•
<b>Door</b>	
CleanGlass door	•
Door contact switch	•
SoftClose oven door/ SoftOpen	•
<b>Cavity</b>	
Oven cavity volume in cu. ft. (l)	5.76 (163) (1 <sup>3</sup> ft)
Number of oven shelf levels	6
No. of halogen lamps	2
TwinPower hot air fans	•
<b>Cleaning convenience</b>	
Stainless-steel front with partial Clean Touch Steel finish	•
Oven with self-cleaning program	•
ComfortClean dishwasher-safe grates	•
Cooktop surface	Black enamel
<b>Safety</b>	
Appliance cooling system and cool touch front	•
Safety cut-out	•
System lock	•
Door contact switch	•
Door lock during self cleaning	•
<b>Technical data</b>	
Appliance height min in in.(mm)	37 1/8 (942)

→ X Satnam Kaur



LOT 40 THAMES PH. 5B  
RE: 36" WIDE GAS STOVE SPEC'S CONT

HR 1134-3 G AG  
36 inch range  
All Gas with DirectSelect, Twin convection fans and M Pro dual stacked burners



EAN: 4002516486556 / Material number: 11791410 / Old Material Number: 25113481USA

Dimensions (depth) in in. (mm) with bullnose	27 3/4 (702)
Appliance height max in in.(mm)	38 5/8 (980)
Appliance width in in. (mm)	36 1/8 (915)
Power Rating in V	120
Number of phases	1
Fuse rating in A	15
Accessories supplied	
Self Clean ready baking and roasting rack	1
Self clean ready baking and roasting racks with rail system	1
Side racks self clean ready	1

→ A Satnam Kaur

HR 1134-3 G AG  
36 inch range  
All Gas with DirectSelect, Twin convection fans and M Pro dual stacked burners

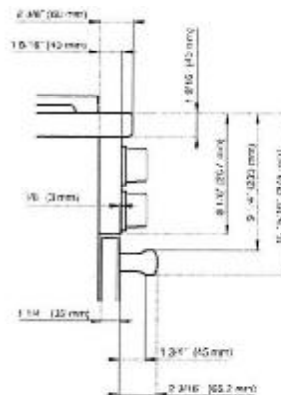
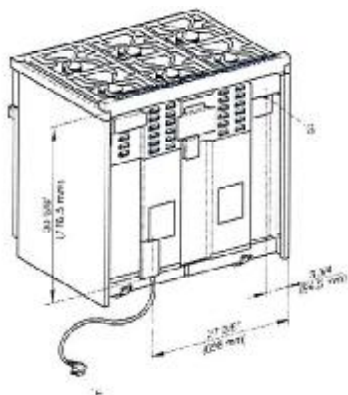

Hilti Inc., Hilti 724 (installation drawing)

E = Electric connection, G = Gas connection

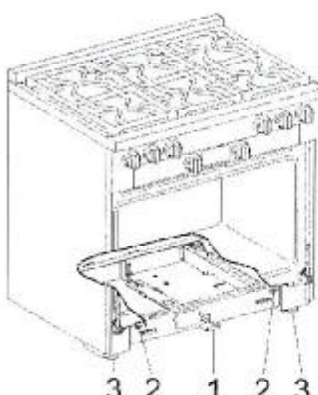
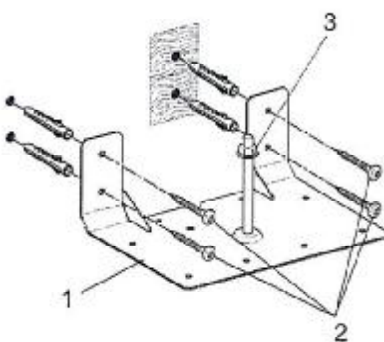
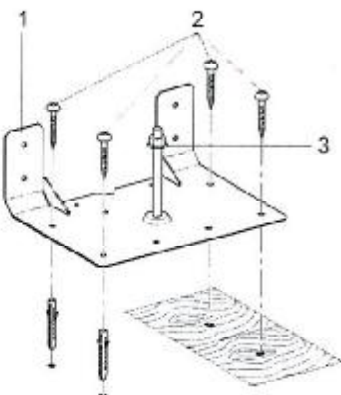

HB14x, HB18x, HB17x – installation required

1 Anti-tip device, 2 Screws, 3 Leading rail

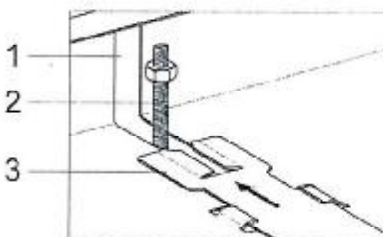
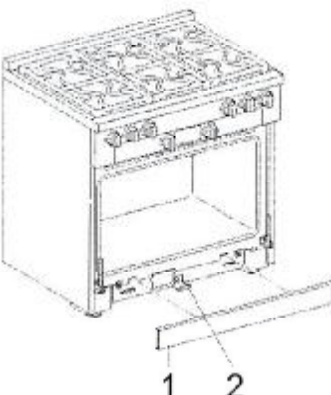
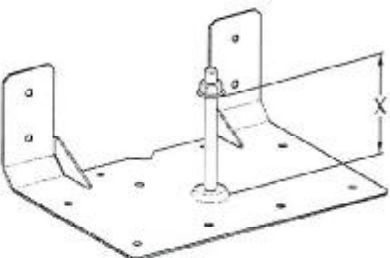

HH17.yx, HH19.yx, HH17.yx – installer drawings

1 Opening in the range housing, 2 Bolt of the anti-tip device, 3 Locking clamp with slot

→ Satnam Kaur

**LOT 40 THAMES PH. 5B**  
**RE: 36" WIDE GAS STOVE SPEC'S CON'T**

HR 1134-3 G AG

36 inch range

All Gas with DirectSelect, Twin convection fans and M Pro dual stacked burners

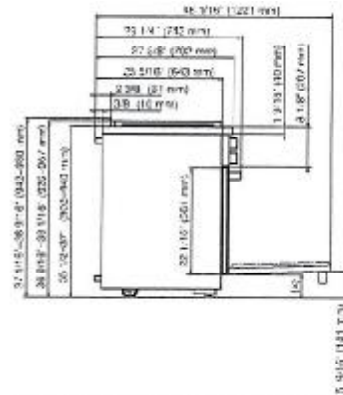
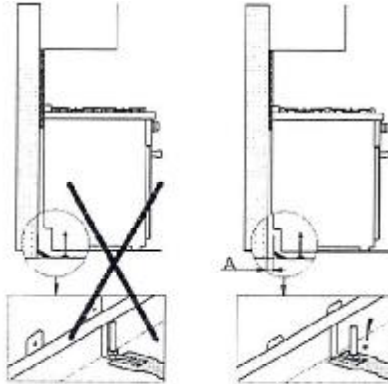
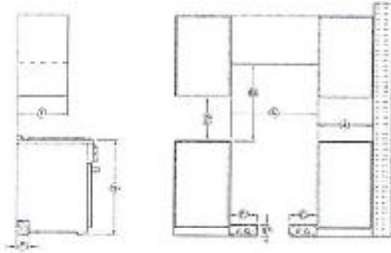

HR1124, HR1134, HR1135, HR1136HR1124-1, HR1134-1, HR1135-1, HR1136-1, HR1124-3, HR1134-3, HR1135-3, HR1136-3 - Installation drawing

HR11xx, HR19xx, HR17xx - Installation drawing

A = Distance between the rear of the range to the supporting wall

HR1124-3, HR1134-3, HR1135-3, HR1136-3, HR1124-3, HR1134-3, HR1135-3, HR1136-3 - Side view, installation drawing

X = Toe-kick height adjustment 5" = 5 1/2" (127 mm = 125.1 mm)

Maximum depth of top cabinet, Minimum distance to bottom edge of top cabinet, Distance from the floor to cooktop surface, Minimum distance to combustible surfaces, E = Blower connection, G = Gas connection, (A) Width of cabinet opening, (B) Minimum distance between the top of the cooking area and the bottom of an unprotected combustible surface, Minimum distance to a protected combustible surface or when a Miele Ventilation Hood is installed, For all other, Hood's please consult the manufacturer's specifications for required distances, (C) Maximum connection width right and left, (D) Maximum connection height, (E) Maximum connection depth

→ X Satnam Kaur

5B-40

LOT 40 THAMES PH. 5B  
RE: MICROWAVE WITH TRIM KIT SPEC'S

Panasonic  
NNSD765S

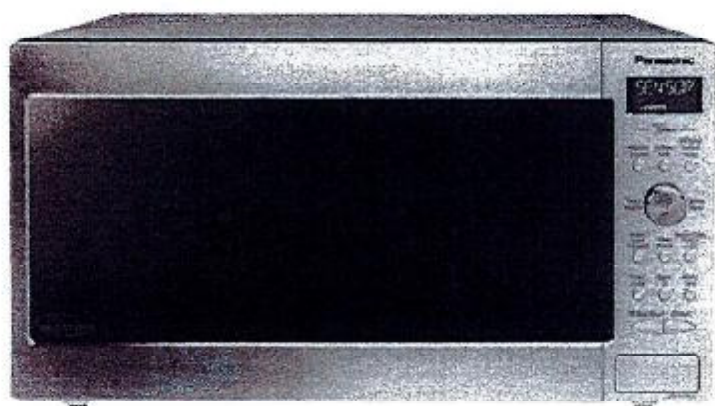

CAS

Panasonic  
NNTK714SS

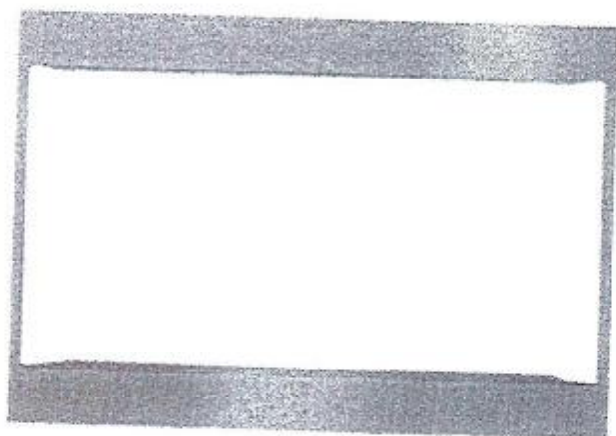

→ x Set nom kaw





Countertop NN-SD765S

LOT 40 THAMES PH. 5B  
RE: MICROWAVE WITH TRIM KIT SPEC'S CONT

MODEL & SIZE	Model Number	NN-SD765S
	Type	Family-size
	Installation	Countertop or built-in
	Oven Capacity	1.6 cu. ft.
	Cooking Power	1200W
	Turntable Diameter	380mm
PANASONIC TECHNOLOGY	Panasonic Inverter	Cyclonic Inverter
	Genius Sensor	Genius®
DESIGN	Color	Stainless Steel
	Control Panel	Solid Dial + Button
	Display Panel	New 6 Digit LCD / Green
STYLE	Door Window	Smoked Glass
	Door Release	Push Open
	Oven Interior	Paint White
PERFORMANCE	Multi-stage Cooking	3 stage
PROGRAMMABLE FEATURES	Sensor Cook	Yes
	Sensor Reheat	Yes
	Auto Cook/Reheat	Yes
	More / Less Control	Yes
	Inverter Turbo Defrost	Yes
	Keep Warm Button	Yes
	Poppcorn Button	Yes

SPECIFICATIONS		Quick Minute	Yes
		Cavity Dimensions (W x D x H)	Approx. 418 x 470 x 228 mm 15.7 x 18.5 x 9.0 inch
		Unit Dimensions (W x D x H)	555 x 506 x 304 mm 21.9 x 19.9 x 12 inch
		Carton Dimensions (W x D x H)	627 x 540 x 360 mm
ACCESSORIES	TRIM KITS	27" Model Number	NN-TK732S
		30" Model Number	NN-TK732S
	Accessory		Glass Tray

→ Satnam Kaur