

Lindsay 2017 Developments Inc. / Sugarwood

Lot/Unit: 17    Phase/Building: 2    Model/Floor Plan: Talbot Lake (3703) Elev B 3Bed 2.5Bath

COUNTER TOP

Inv.6409	1 - TO SUPPLY AND INSTALL UPGRADE #2 COUNTER TOP IN THE PRINCIPAL ENSUITE IN LIEU OF THE STANDARD.. SEE COLOUR CHART FOR DETAILS	
Line 80644	Note:	
26Oct23 / 15Nov23		
Inv.6409	1 - TO SUPPLY AND INSTALL UPGRADE #2 COUNTER TOP IN THE MAIN BATHROOM IN LIEU OF THE STANDARD.. SEE COLOUR CHART	
Line 80645	Note:	
26Oct23 / 15Nov23		

COUNTER TOP - KITCHEN

Inv.6409	1 - TO SUPPLY AND INSTALL COUNTER TOP - KITCHEN - Kitchen - 3 cm Counter Top - UPGRADE 2 IN LIEU OF THE STANDARD.. SEE COLOUR CHART	
Line 80642	Note:	
26Oct23 / 15Nov23		

ELECTRICAL

Inv.6409	1 - TO SUPPLY AND INSTALL THE STANDARD TV ROUGH-IN, IN THE GREATROOM AND PRINCIPAL BEDROOM.. SEE SKETCH #2 AND #3	
Line 80632	Note:	
26Oct23 / 15Nov23		
Inv.6409	1 - TO SUPPLY AND INSTALL THE STANDARD PHONE ROUGH-IN, IN THE GREATROOM AND PRINCIPAL BEDROOM AND BEDROOM #2.. SEE SKETCH #2 AND #3	
Line 80633	Note:	
26Oct23 / 15Nov23		
Inv.6409	1 - TO SUPPLY AND INSTALL EXTRA CEILING BOX ROUGH IN CAPPED (ON A SEP SWITCH) IN THE BREAKFAST BAR AREA.. SEE SKETCH #2	
Line 80635	Note:	
26Oct23 / 15Nov23		
Inv.6409	1 - TO SUPPLY AND INSTALL AN ADDITIONAL BASIC RECEPTACLE (NOT DEDICATED) IN THE GREAT ROOM OVER THE F/P MANTLE AT APPROX. 66" UP FROM THE FLOOR NEXT TO THE STANDARD TV AND PHONE ROUGH-IN.. SEE SKETCH #2	
Line 80636	Note:	
26Oct23 / 15Nov23		

HARDWOOD

Inv.6409	1 - TO SUPPLY AND INSTALL UPGRADE HARDWOOD TO THE MAIN FLOOR.. SEE COLOUR CHART	
Line 80640	Note:	
26Oct23 / 15Nov23		
Inv.6409	1 - TO SUPPLY AND INSTALL STANDARD KENTWOOD PROGRESSIVES OAK 3 1/2INCH - UPPER HALL IN LIEU OF THE STANDARD.. SEE COLOUR CHART	
Line 80648	Note:	
26Oct23 / 15Nov23		

HVAC

Lindsay 2017 Developments Inc. / Sugarwood

Lot/Unit: 17    Phase/Building: 2    Model/Floor Plan: Talbot Lake (3703) Elev B 3Bed 2.5Bath

Inv.6409	1 - TO SUPPLY AND INSTALL GASLINE (ROUGH-IN ONLY) IN THE KITCHEN AT THE STOVE AREA (AS PER PLAN) TO INCLUDE 110V CODE REQUIREMENT	
Line 80638	Note:	
26Oct23 / 15Nov23		

PAINT AND DRYWALL

Inv.6409	1 - TO SUPPLY AND INSTALL A STAIN TO THE STAIRCASE IN LIEU OF THE NATURAL.. SEE COLOUR CHART FOR DETAILS	
Line 80646	Note:	
26Oct23 / 15Nov23		

PLUMBING

Inv.6409	3 - TO SUPPLY AND INSTALL VANITY SINK - CONTRAC CATENA UNDERMOUNT - MODEL 4210CIY THE PRINCIPAL AND MAIN BATHROOM IN LIEU OF THE STANDARD.. SEE SPECLS	
Line 80643	Note:	
26Oct23 / 15Nov23		
Inv.6409	1 - TO SUPPLY AND INSTALL KITCHEN SINK - BLANCO QUATRUS U2- MODEL 401247 IN THE KITCHEN IN LIEU THE STANDARD.. SEE SPEC'S	
Line 80637	Note:	
26Oct23 / 15Nov23		

STAIRS AND RAILINGS

Inv.6409	1 - TO SUPPLY AND INSTALL THE STRAIGHT OAK PICKETS	
Line 80647	Note:	
26Oct23 / 15Nov23		

EXTRAS AS PER OFFER

Purchaser: TANIA HOWLADER

Property: 17 of Plan -

Telephone Res. / Bus: /

Project: Lindsay 2017 Developments Inc.

Decor Advisor: Samantha Castelli

Model and Elevation: Talbot Lake (3703) Elev B 3Bed 2.5Bath

Layout Changes: ☐ Yes ☒ No

Sketch Attached: ☒ Yes ☐ No

Exterior Colour Scheme:

### 1. Cabinetry

	Style and Colour	Counter Top	Hardware
Kitchen / Breakfast	#2 Huron Ontario White	UPG #2 H/S Whistler	12881 Handle
Kitchen Island	#2 Huron Ontario White	UPG #2 H/S Whistler	12881 Handle
Laundry Room	/	/	/
Powder Room	/	/	/
Main Bathroom	#2 Huron Ontario White	UPG #2 H/S Whistler	135 knob
Master Ensuite Bathroom	#2 Huron Ontario White	UPG #2 H/S Whistler	135 knob
Second Ensuite Bathroom (If Applicable)	/	/	/

### Appliances

#### Custom Size Fridge

☐ Yes ☒ No

#### Valance Lighting

☐ Yes ☒ No

#### Microwave / Range Hood

☐ Yes ☒ No

#### Cooktop / Rangetop

☐ Yes ☒ No

#### Built in Wall Oven

☐ Yes ☒ No

#### Slide-in Range

☐ Yes ☒ No

### Comment

REQD/RECEIVED

15-11-2023

### 2. Flooring

#### Selection

Foyer	13x13" Burlingstone White
Main Hall	**3 1/2" Elements Oak Sturgeon
Back Hall	/
Breakfast	**3 1/2" Elements Oak Sturgeon
Laundry Room	13x13" Malena Carbon
Kitchen	13x13" Burlingstone White
Powder Room	13x13" Burlingstone White
Main Bathroom	13x13" Malena Carbon
Master Ensuite	13x13" Malena Carbon
Bathroom (If Applicable)	/
Mud Room	13x13" Burlingstone White
Master Ensuite Shower Floor	2x2" Ontario Snow White Matte
Living Room	/
Dining Room	/
Family / Great Room	**3 1/2" Elements Oak Sturgeon
Den / Library / Study	/
Basement Landing (If Applies)	/
Lower Landing (If Applicable)	**3 1/2" Elements Oak Sturgeon
Upper Landing	**3 1/2" Elements Oak Sturgeon
Upper Hall	**3 1/2" Elements Oak Sturgeon
Master Bedroom	OPENING NIGHT: 03
Bedroom #2	OPENING NIGHT: 03
Bedroom #3	OPENING NIGHT: 03
Bedroom #4	/
Bedroom #5	/
Master Ens. Shower Jamb	Anatolia Marmiline SNOW

Flooring Continued on Page 2

Initial:

*[Signature]*

Page 1 of 3



Purchaser: TANIA HOWLADER

Property: 17 of Plan -

Telephone Res. / Bus: /

Project: Lindsay 2017 Developments Inc.

Decor Advisor: Samantha Castelli

Model and Elevation: Talbot Lake (3703) Elev B 3Bed 2.5Bath

### 2. Flooring - Continued -

Upgrade Underpad	Type STANDARD	Area Principal bedroom, bedroom #2 & #3
Carpet on Stairs	Capped /	Runner - *Upgrade /
Comment		

### 3. Plumbing Fixtures / Faucets

Kitchen	STANDARD	Second Ensuite		Powder Room	STANDARD
Master Ensuite	STANDARD			Other Room	
Main Bathroom	STANDARD				

#### Comment

NOTE: KITCHEN SINK HAS BEEN UPGRADED.. SEE SPEC'S. MASTER AND MAIN BATHROOM SINKS ARE UPGRADED TO UNDERMOUNT... SEE SEPC'S

REC'D / RECEIVED

15-11-2023

### 4. Wall Tile

	Tile Selection	Listello	Insert	Insert Selection
Main Bathroom	8x10" Weave White	<input type="checkbox"/>	<input type="checkbox"/>	
Master Ensuite		<input type="checkbox"/>	<input type="checkbox"/>	
Tub Deck	/	<input type="checkbox"/>	<input type="checkbox"/>	
Tub Apron	/	<input type="checkbox"/>	<input type="checkbox"/>	
Tub Surround	/	<input type="checkbox"/>	<input type="checkbox"/>	
Shower Stall	8x10" Weave White	<input type="checkbox"/>	<input type="checkbox"/>	
Second Ensuite	/	<input type="checkbox"/>	<input type="checkbox"/>	
		<input type="checkbox"/>	<input type="checkbox"/>	
		<input type="checkbox"/>	<input type="checkbox"/>	
Kitchen Backsplash		<input type="checkbox"/>	<input type="checkbox"/>	
Complete Backsplash		<input type="checkbox"/>	<input type="checkbox"/>	

#### Comment

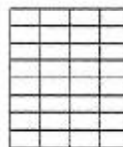

horizontal stacked

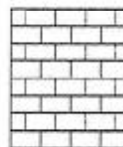

brick pattern



vertical stacked



diagonal/diamond

### 5. Fireplace

	Living Room			Family Room			Other Room - Specify GREAT ROOM		
	Purchased	As Per Plan	N/A	Purchased	As Per Plan	N/A	Purchased	As Per Plan	N/A
Fireplace Type	<input type="radio"/>	<input type="radio"/>	<input checked="" type="radio"/>	<input type="radio"/>	<input type="radio"/>	<input checked="" type="radio"/>	<input type="radio"/>	<input checked="" type="radio"/>	<input type="radio"/>
Mantle Type									
Over Mantle									
Colour / Stain									
Surround									
Hearth									
Comment									

Initial:

TH

Purchaser: TANIA HOWLADER

Property: 17 of Plan -

Telephone Res. / Bus: /

Project: Lindsay 2017 Developments Inc.

Decor Advisor: Samantha Castelli

Model and Elevation: Talbot Lake (3703) Elev B 3Bed 2.5Bath

### 6. Trim Carpentry

Door Hardware STANDARD HANDLE

Interior Trim STANDARD

Comment

#### Interior Doors

☐ 2 Panel Arch Top

☒ 2 Panel Square Top

☐ 6 Panel

Initial for Door Style *TH*

### 7. Railings and Pickets

Railing Package \*STRAIGHT OAK PICKETS

Railing Colour \*ELEMENTS OAK STRUGEON

Picket Colour \*ELEMENTS OAK STRUGEON

Wood Stairs ☐ No ☒ Oak

Tread Colour \*ELEMENTS OAK STRUGEON

Comment

### 8. Plaster Mouldings and Medallions

Foyer

Main Hall

Living Room

Dining Room

Family Room

Kitchen/Breakfast

Den/Library

Lower Landing

Comment

RECU/RECEIVED

15-11-2023

### 9. Wall Paint

#### Smooth Ceilings

☐ First Floor

☐ First Floor incl. Second Floor Hall

☐ First and Second Floor

☒ Throughout

☐ Not Applicable

Trim Paint KINGSMEN WHITE

### 10. Additional Comments

### 11. Disclaimers and Notes

- Colours of all materials are as close as possible to builder's selection, but not necessarily identical due to variances in manufacturing.
- Any extras listed above are null and void unless accompanied by a separate invoice/amendment. Said invoice must be paid in full.
- The Purchaser acknowledges that after Interior Colour Selection form is signed and dated, no further changes will be permitted other than re-selection due to unavailability. *TH* Purchaser's Initials
- The Purchaser acknowledges reading and accepting the "Kingsmen Group Décor Centre Disclaimers" form. This document contains other miscellaneous disclaimers.

This Interior Colour Selection is final and approved by:

Purchaser:

Signature: *Tania Howlader*

Date: *Nov 15/2023*

Vendor:

Lindsay 2017 Developments Inc.

*Nov 15/23*



SCHEDULE "B-1"

Floor Plan

Capped Elec. on  
a sep switch

Lindsay PH. 2 Lot 17  
Lot 17  
Phase 2  
Model: Talbot Lake (3703) Elev B 3Bed 2.5Bath  
Standard

SKETCH #2

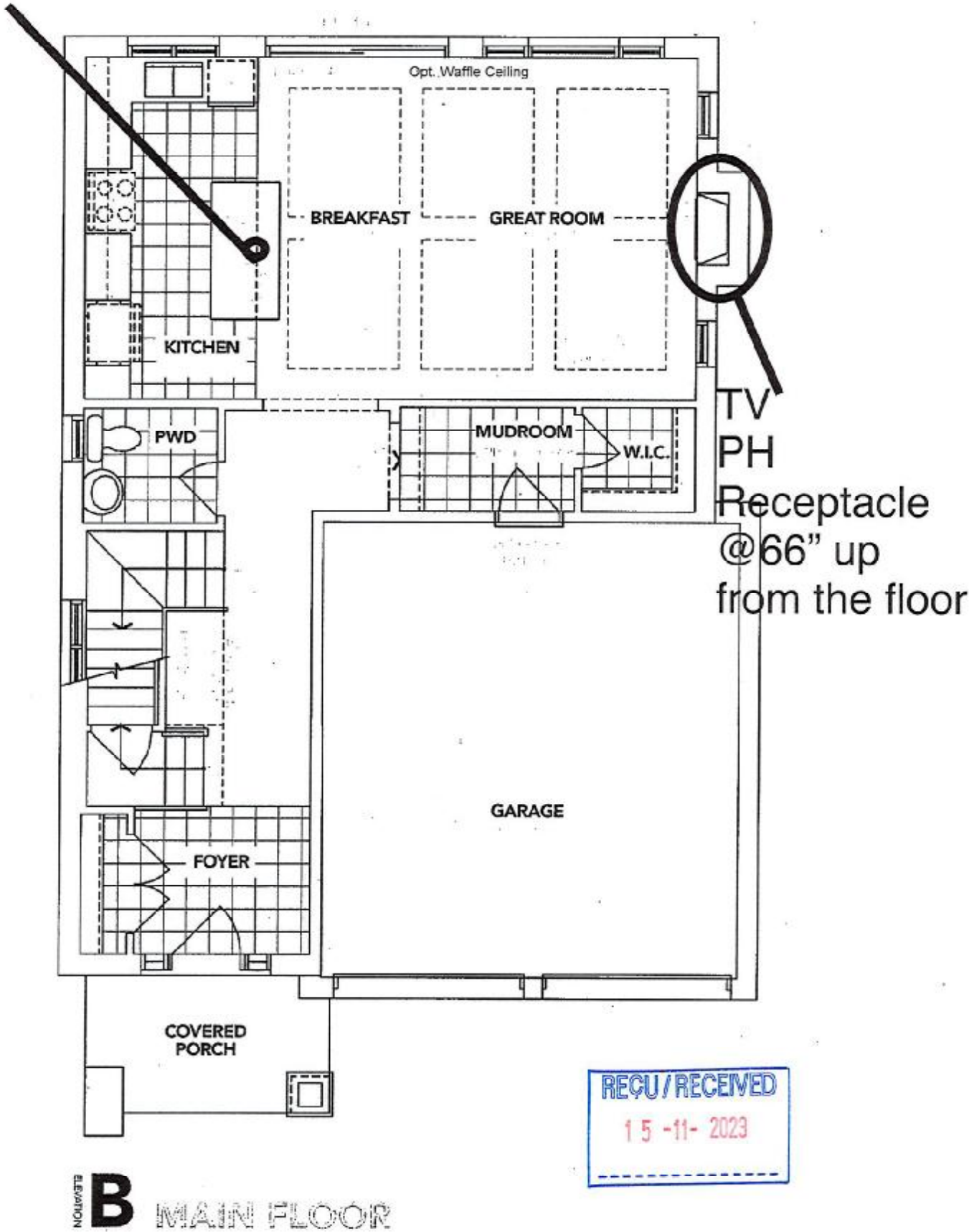

The floor plans and elevations shown are pre-construction plans and may be revised or improved as necessitated by architectural controls and the construction process. The measurements adhere to the rules and regulations of the TARION Warranty Corporation's official method for the calculation of floor area. Materials, specifications and floor plans are subject to change without notice. All house renderings are artist's concept only. Actual usable floor space may vary from the stated floor area. All options shown are upgrades. E. & O. E.

SCHEDULE "B-1"  
Floor Plan

Lindsay PH. 2 Lot 17  
Phase 2  
Model: Talbot Lake (3703) Elev B 3Bed 2.5Bath  
Standard

SKETCH #3

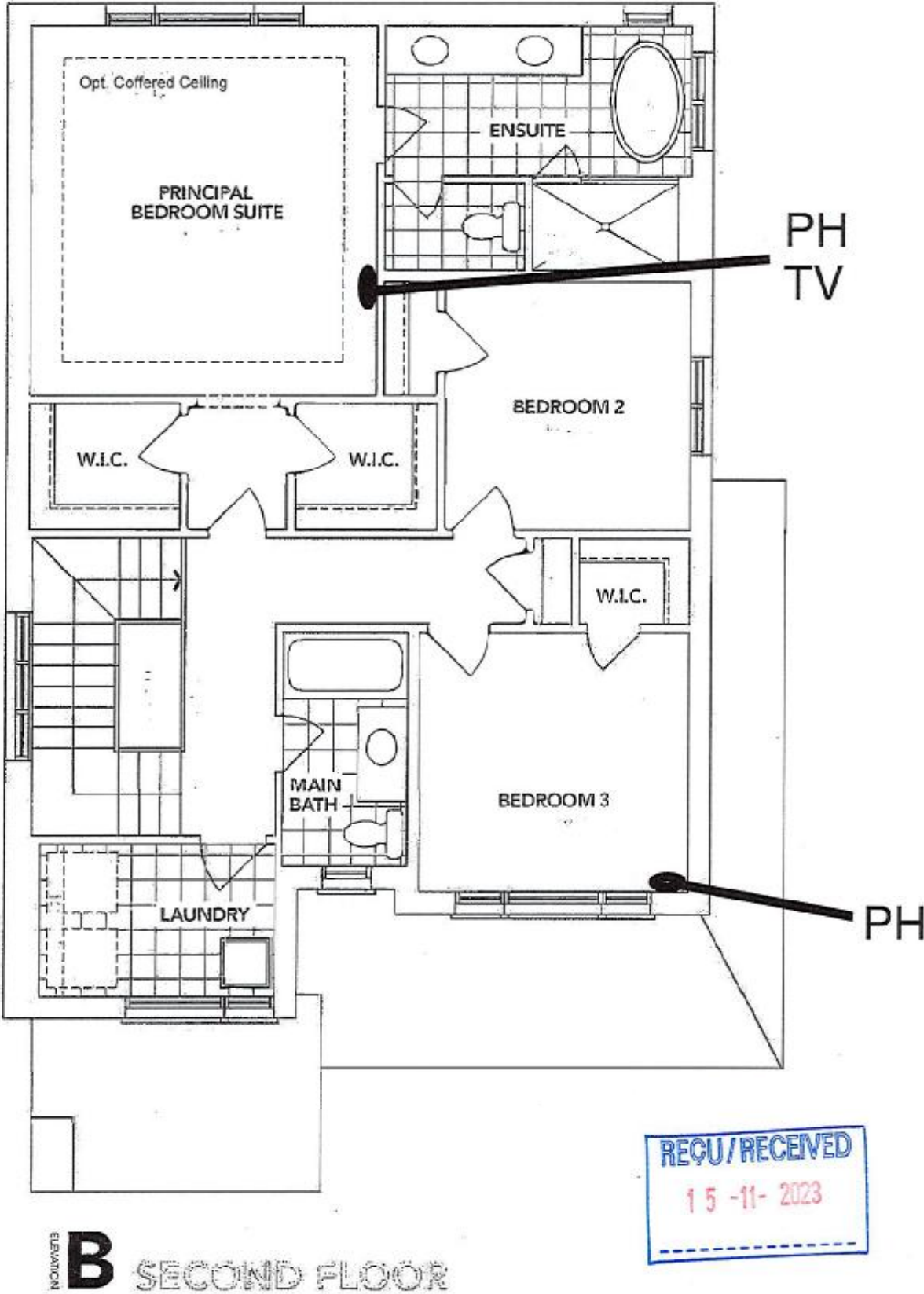

The floor plans and elevations shown are pre-construction plans and may be revised or improved as necessitated by architectural controls and the construction process. The measurements adhere to the rules and regulations of the TARIION Warranty Corporation's official method for the calculation of floor area. Materials, specifications and floor plans are subject to change without notice. All house renderings are artist's concept only. Actual usable floor space may vary from the stated floor area. All options shown are upgrades. E. & O. E.

SCHEDULE "B-1"  
Floor Plan

Lindsay PH. 2 Lot 17  
Lot 17  
Phase 2  
Model: Talbot Lake (3703) Elev B 3Bed 2.5Bath  
Standard

SKETCH #4

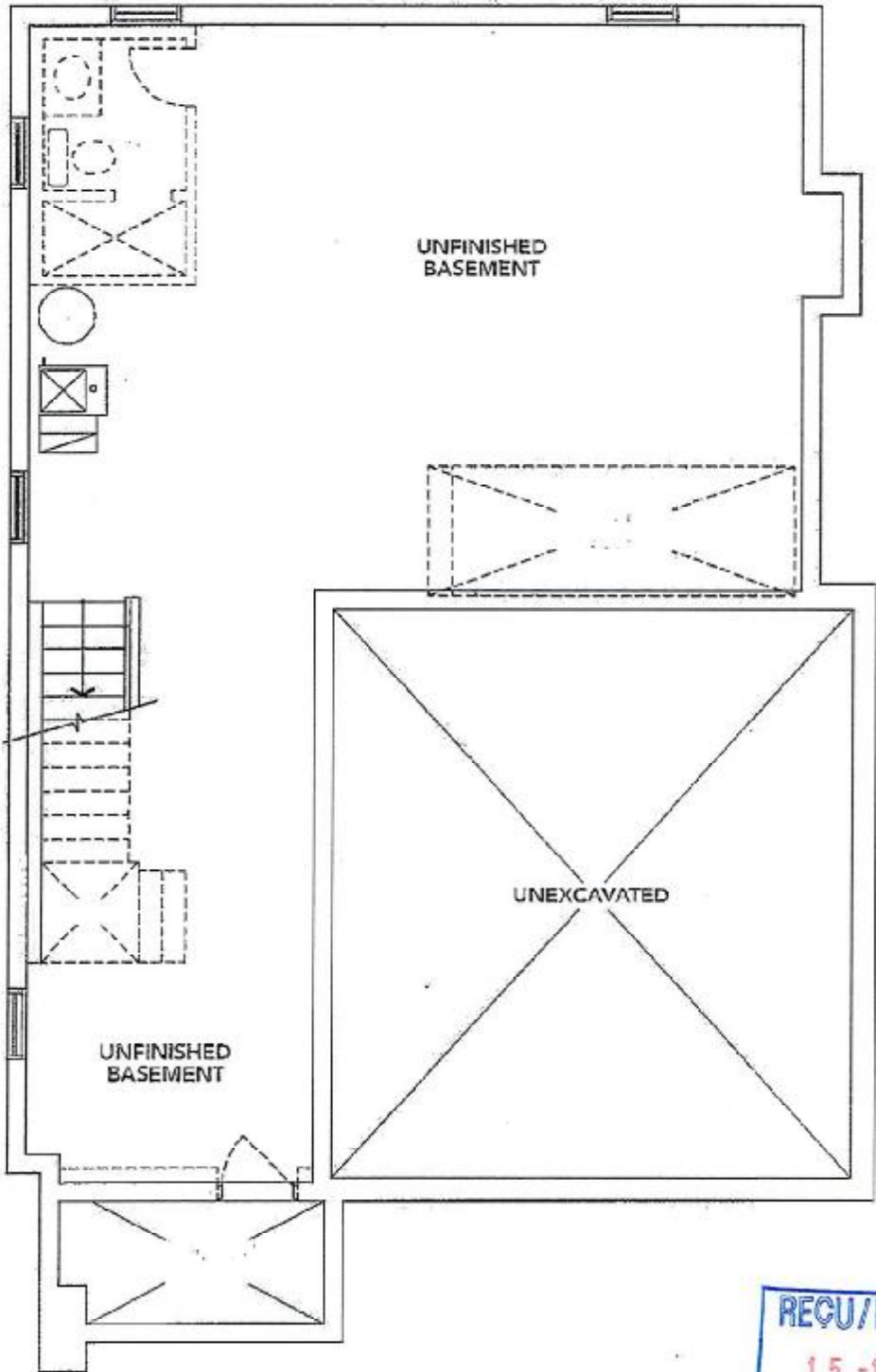

REC'D/RECEIVED  
15 -11- 2023

ELEVATION **B** BASEMENT

The floor plans and elevations shown are pre-construction plans and may be revised or improved as necessitated by architectural controls and the construction process. The measurements adhere to the rules and regulations of the TARIION Warranty Corporation's official method for the calculation of floor area. Materials, specifications and floor plans are subject to change without notice. All house renderings are artist's concept only. Actual usable floor space may vary from the stated floor area. All options shown are upgrades. E. & O. E.



# Lot 17 PH 2 SUGARWOOD UPG KITCHEN SINK

# BLANCO

## Sink Specifications

Colour                      SKU  
brushed finish            401247

### Design and planning tips

- Min cabinet size: 36 in ( 915 mm )

#### Specifications:

3 ½" (90 mm) stainless steel strainer(s)

Installation instructions

Cut-out template

Mounting clips

Limited lifetime warranty

Depending on cabinet construction, a different cabinet size may be required.

### Codes & Standards

ASME A112.19.3-2017/CSA B45.4-17

### Optional Accessories

CapFlow Strainer Cover    517666  
Ash Cutting Board        406345  
Sink Grid                    406349

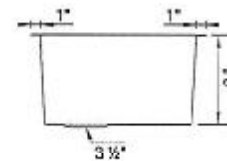
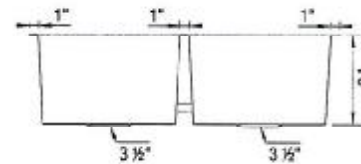
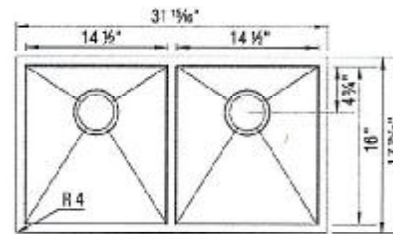

### Warranty

Limited lifetime warranty on all sinks and faucets. One-year warranty on all accessories and soap dispensers.

### Code/Standards Compliance

BLANCO sinks and faucets are third-party tested and certified to CSA, cUPC, ANSI/ASME, IAPMO and NSF standards and listed by applicable certification bodies. For more information on individual product listings, contact our office or listing organization.



Need support? Learn more by watching our sink & faucet How-to videos:  
<https://www.blanco.com/ca-en/support/how-to-videos/how-to-videos-for-sinks/>



BLANCO Canada Inc  
100 Corporation Drive  
Brampton ON L6S 6B5

Tel & Fax  
Tel: 905-494-2400 Toll free: 1-877-425-2626  
Fax: 905-494-2425 Toll free: 1-877-825-2626

While BLANCO strives to provide accurate information, all images and dimensions in this document are intended for reference only and are subject to change at any time without notice. This document is not intended for use as an installation guide. For technical installation details, refer to Installation Instructions provided with the product. BLANCO assumes no responsibility for the use of superseded or voided specifications.



TH

# LOT 17 PH 2 SUGARWOOD MASTER & MAIN SINKS

## CATENA

### RECTANGULAR UNDERMOUNT SINK

4210CIY

Undermount Sink

#### PRODUCT SPECS:

- Vitreous china
- Front overflow hole
- Template and mounting hardware supplied

#### DIMENSIONS:

##### Outer:

510mm W x 390mm D x 190mm H

20" W x 15 1/2" D x 7 1/2" H

##### Inner:

458mm W x 340mm D x 140mm H

18" W x 13 1/4" D x 5 1/4" H

#### COMPLIANCE CERTIFICATIONS

Meets or exceeds the following:

- IAPMO cUPC
- ASME A112.19.2 / CSA B45.1
- OBC Section 3.8 Barrier Free design and CSA B651 Standard

#### SHIPPING

Cube 1.72

GW 27 lbs



#### TO BE SPECIFIED

Colour:

- Soft White

NOTES: Dimensions of fixtures are nominal and may vary within the range of tolerances established by ASME standard A112.19.2. These measurements are subject to change or cancellation. No responsibility is assumed for use of superseded or voided pages.

Products are designed to comply with CSA B651 Standard and OBC barrier-free requirements. It shall be the responsibility of the installer to comply with the local disability codes and standards prior to installing the product.

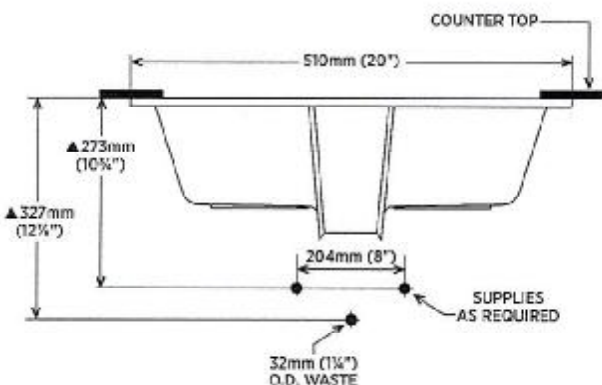
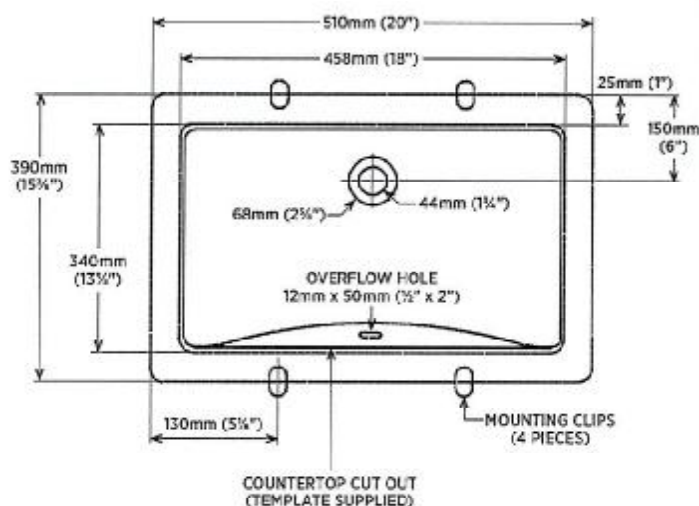

#### DETAIL OF MOUNTING CLIP

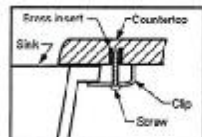

#### Note:

▲ Dimensions shown for location of supplies and "P" trap are suggested.

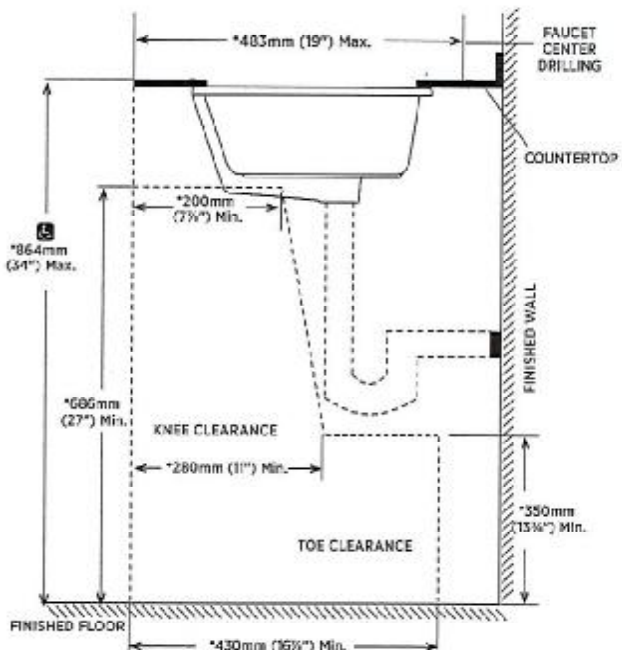
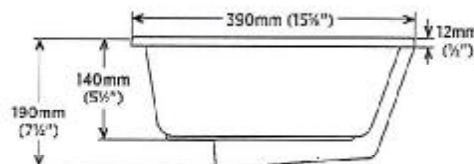

NOTE: \* Stamped measurements comply with CSA B651 and OBC barrier free accessibility requirements.

REVISED MAY 2020

contrac

5970 CHEDWORTH WAY, UNIT B, MISSISSAUGA, ONTARIO, CANADA L5R 4G5 | CONTRAC.CA



TH