



CONSTRUCTION SUMMARY

Lindsay 2017 Developments Inc. / Sugarwood

Lot/Unit: 56 Phase/Building: 2 Model/Floor Plan: Buckhorn Lake (3704) Elev B 4Bed
2.5Bath

CABINETRY APPLIANCE - FRIDGE

Inv.6454	1 - TO SUPPLY AND INSTALL 66CM DEEP FRIDGE ENCLOSURE - COUNTER DEPTH WITH - 1 WALL - 1 66CM DEEP GABLE AND 1 66CM DEEP CABINET - THIS IS NOT A ZERO CLEARANCE ENCLOSURE. STANDARD HEIGHTS AND WIDTHS WILL BE USED. - CLASSIC SERIES.. SEE SKETCH #3	
Line 80983	Note:	
13Nov23 / 13Nov23		

DOORS AND WINDOWS

ELECTRICAL

Inv.6454	1 - TO SUPPLY AND INSTALL THE STANDARD TV ROUGH-IN, IN THE GREATROOM AND MASTER BEDROOM.. SEE SKETCH #3 AND #4	
Line 80980	Note:	
13Nov23 / 13Nov23		
Inv.6454	1 - TO SUPPLY AND INSTALL THE STANDARD PHONE ROUGH-IN, IN THE GREATROOM, BEDROOM #3 AND MASTER BEDROOM.. SEE SKETCH #3 AND #4	
Line 80981	Note:	
13Nov23 / 13Nov23		
Inv.6454	1 - TO SUPPLY AND INSTALL A CAPPED ELEC ON A SEP. SWITCH OVER THE BREAKFAST BAR IN THE KITCHEN.. SEE SKETCH #3	
Line 80982	Note:	
13Nov23 / 13Nov23		

PLUMBING

Inv.6454	1 - TO SUPPLY AND INSTALL KITCHEN SINK - BLANCO QUATRUS U2 DBL UNDERMOUNT - MODEL 401247 IN LIEU OF THE STANDARD.. SEE SPEC'S	
Line 80984	Note:	
13Nov23 / 13Nov23		

RAILING - INTERIOR

Inv.6454	1 - TO SUPPLY AND INSTALL STRAIGHT OAK PICKETS	
Line 80985	Note:	
13Nov23 / 13Nov23		

EXTRAS AS PER OFFER

Purchaser: THARSIGAN PARAMSOTHY

Property: 56 of Plan -

Telephone Res. / Bus: /

Project: Lindsay 2017 Developments Inc.

Decor Advisor: Samantha Castelli

Model and Elevation: Buckhorn Lake (3704) Elev B 4Bed 2.5Bat

Layout Changes: ☒ Yes ☐ NoSketch Attached: ☒ Yes ☐ No

Exterior Colour Scheme:

1. Cabinetry

	Style and Colour	Counter Top	Hardware
Kitchen / Breakfast	#3 Simcoe Orchid	#1 C/S #3040 Cement	12881 HANDLE
Kitchen Island	#3 Simcoe Orchid	#1 C/S #3040 Cement	12881 HANDLE
Laundry Room	/	/	/
Powder Room	/	/	/
Main Bathroom	#3 Simcoe Orchid	Black Alicante 4926-07	135 Knob
Master Ensuite Bathroom	#3 Simcoe Orchid	Black Alicante 4926-07	135 Knob
Second Ensuite Bathroom (If Applicable)	/	/	/

Appliances

Custom Size Fridge

☐ Yes ☒ No

Valance Lighting

☐ Yes ☒ No

Microwave / Range Hood

☐ Yes ☒ No

Cooktop / Rangetop

☐ Yes ☒ No

Built in Wall Oven

☐ Yes ☒ No

Slide-in Range

☐ Yes ☒ No

Comment

RECU/RECEIVED

14-11-2023

2. Flooring

	Selection
Foyer	13x13" Cinq Grey
Main Hall	3 1/2" Elements Oak Natural
Back Hall	/
Breakfast	13x13" Cinq Grey
Laundry Room	/
Kitchen	13x13" Cinq Grey
Powder Room	13x13" Cinq Grey
Main Bathroom	13x13" Cinq Black
Master Ensuite	13x13" Cinq Black
Bathroom (If Applicable)	/
Mud Room	13x13" Cinq Grey
Master Ens. Shower Floor	2x2" Inizio Bianco
Living Room	/
Dining Room	/
Family / Great Room	3 1/2" Elements Oak Natural
Den / Library / Study	/
Basement Landing (If Applies)	
Lower Landing (If Applicable)	3 1/2" Elements Oak Natural
Upper Landing	3 1/2" Elements Oak Natural
Upper Hall	Opening Night: 03
Master Bedroom	Opening Night: 03
Bedroom #2	Opening Night: 03
Bedroom #3	Opening Night: 03
Bedroom #4	Opening Night: 03
Bedroom #5	/
Master Ens. Shower Jamb	Anatolia Marmiline snow

Flooring Continued on Page 2

Initial:

T.P.

Page 1 of 3

Purchaser: THARSIGAN PARAMSOTHY

Property: 56 of Plan -

Telephone Res. / Bus: /

Project: Lindsay 2017 Developments Inc.

Decor Advisor: Samantha Castelli

Model and Elevation: Buckhorn Lake (3704) Elev B 4Bed 2.5Bat

2. Flooring - Continued -

Upgrade Underpad	Type	Area
	STANDARD	2nd floor
Carpet on Stairs	Capped	Runner - *Upgrade
Comment		

3. Plumbing Fixtures / Faucets

Kitchen	STANDARD	Second Ensuite		Powder Room	STANDARD
Master Ensuite	STANDARD			Other Room	
Main Bathroom	STANDARD				

Comment

NOTE: KITCHEN SINK HAS BEEN UPGRADED TO UNDERMOUNT. STILL TO INSTALL THE STANDARD FACUET.
INSTALL ALL STANDARD PLUMBING FIXTURES IN ALL BATHROOMS.

RECU/RECEIVED

14 -11- 2023

4. Wall Tile

	Tile Selection	Listello	Insert	Insert Selection
Main Bathroom	8x10" Weave White	<input type="checkbox"/>	<input type="checkbox"/>	
Master Ensuite		<input type="checkbox"/>	<input type="checkbox"/>	
Tub Deck		<input type="checkbox"/>	<input type="checkbox"/>	
Tub Apron		<input type="checkbox"/>	<input type="checkbox"/>	
Tub Surround		<input type="checkbox"/>	<input type="checkbox"/>	
Shower Stall	8x10" Weave White	<input type="checkbox"/>	<input type="checkbox"/>	
Second Ensuite		<input type="checkbox"/>	<input type="checkbox"/>	
		<input type="checkbox"/>	<input type="checkbox"/>	
Kitchen Backsplash		<input type="checkbox"/>	<input type="checkbox"/>	
Complete Backsplash		<input type="checkbox"/>	<input type="checkbox"/>	

Comment



horizontal stacked

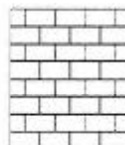

brick pattern



vertical stacked



diagonal diamond

5. Fireplace

Living Room

Purchased ☐ As Per Plan ☐ N/A ☐

Family Room

Purchased ☐ As Per Plan ☐ N/A ☐

Other Room - Specify GREAT ROOM

Purchased ☐ As Per Plan ☒ N/A ☐

Fireplace Type

Mantle Type

Over Mantle

Colour / Stain

Surround

Hearth

Comment

FRONT FACING

NF-08

WHITE

Initial:

T-P

Page 2 of 3

Purchaser: THARSIGAN PARAMSOTHY

Property: 56 of Plan -

Telephone Res. / Bus: /

Project: Lindsay 2017 Developments Inc.

Decor Advisor: Samantha Castelli

Model and Elevation: Buckhorn Lake (3704) Elev B 4Bed 2.5Bath

6. Trim Carpentry

Door Hardware STANDARD HANDLE

Interior Trim STANDARD

Comment

Interior Doors

☐ 2 Panel Arch Top

☒ 2 Panel Square Top

☐ 6 Panel



Initial for Door Style

T.P.

7. Railings and Pickets

Railing Package *STRAIGHT OAK PICKETS

Railing Colour ELEMENTS OAK NATURAL

Wood Stairs ☐ No ☒ Oak

Picket Colour ELEMENTS OAK NATURAL

Tread Colour ELEMENTS OAK NATURAL

Comment

8. Plaster Mouldings and Medallions

Foyer

Main Hall

Living Room

Dining Room

Family Room

Comment

Kitchen/Breakfast

Den/Library

Lower Landing

9. Wall Paint

KINGSMEN WHITE

REQD / RECEIVED

14-11-2023

Smooth Ceilings

☐ First Floor

☐ First Floor incl. Second Floor Hall

☐ First and Second Floor

☒ Throughout

☐ Not Applicable

Trim Paint KINGSMEN WHITE

10. Additional Comments

11. Disclaimers and Notes

- Colours of all materials are as close as possible to builder's selection, but not necessarily identical due to variances in manufacturing.
- Any extras listed above are null and void unless accompanied by a separate invoice/amendment. Said invoice must be paid in full.
- The Purchaser acknowledges that after Interior Colour Selection form is signed and dated, no further changes will be permitted other than re-selection due to unavailability. T.P. Purchaser's Initials
- The Purchaser acknowledges reading and accepting the "Kingsmen Group Décor Centre Disclaimers" form. This document contains other miscellaneous disclaimers.

This Interior Colour Selection is final and approved by:

Purchaser:

Signature: [Signature] Date: 13 Nov 2023

Vendor:

Lindsay 2017 Developments Inc.

Nov 14/23

SCHEDULE "B-1"
Floor Plan

Lot 56
Phase 2
Model: Buckhorn Lake (3704) Elev B 4Bed 2.5Bath
Standard

Capp. Elec on Sep. switch

SKETCH #3

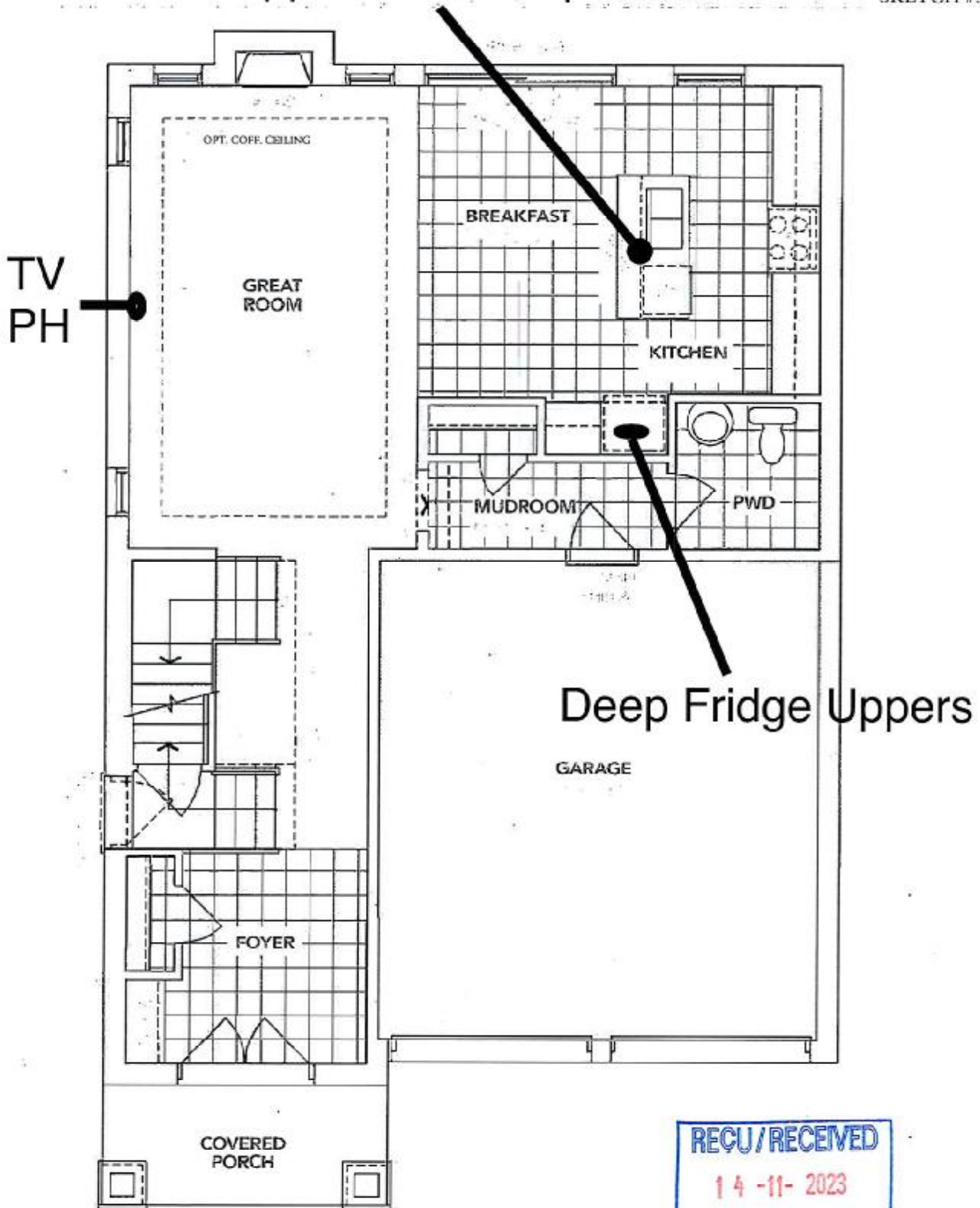

ELEVATION **B** MAIN FLOOR

The floor plans and elevations shown are pre-construction plans and may be revised or improved as necessitated by architectural controls and the construction process. The measurements adhere to the rules and regulations of the TARION Warranty Corporation's official method for the calculation of floor area. Materials, specifications and floor plans are subject to change without notice. All house renderings are artist's concept only. Actual usable floor space may vary from the stated floor area. All options shown are upgrades. E. & O. E.

Lindsay PH > Lot 5b

SCHEDULE "B-1"
Floor Plan

Lot 5b
Phase 2
Model: Buckhorn Lake (3704) Elev B 4Bed 2.5Bath
Standard

SKETCH #4

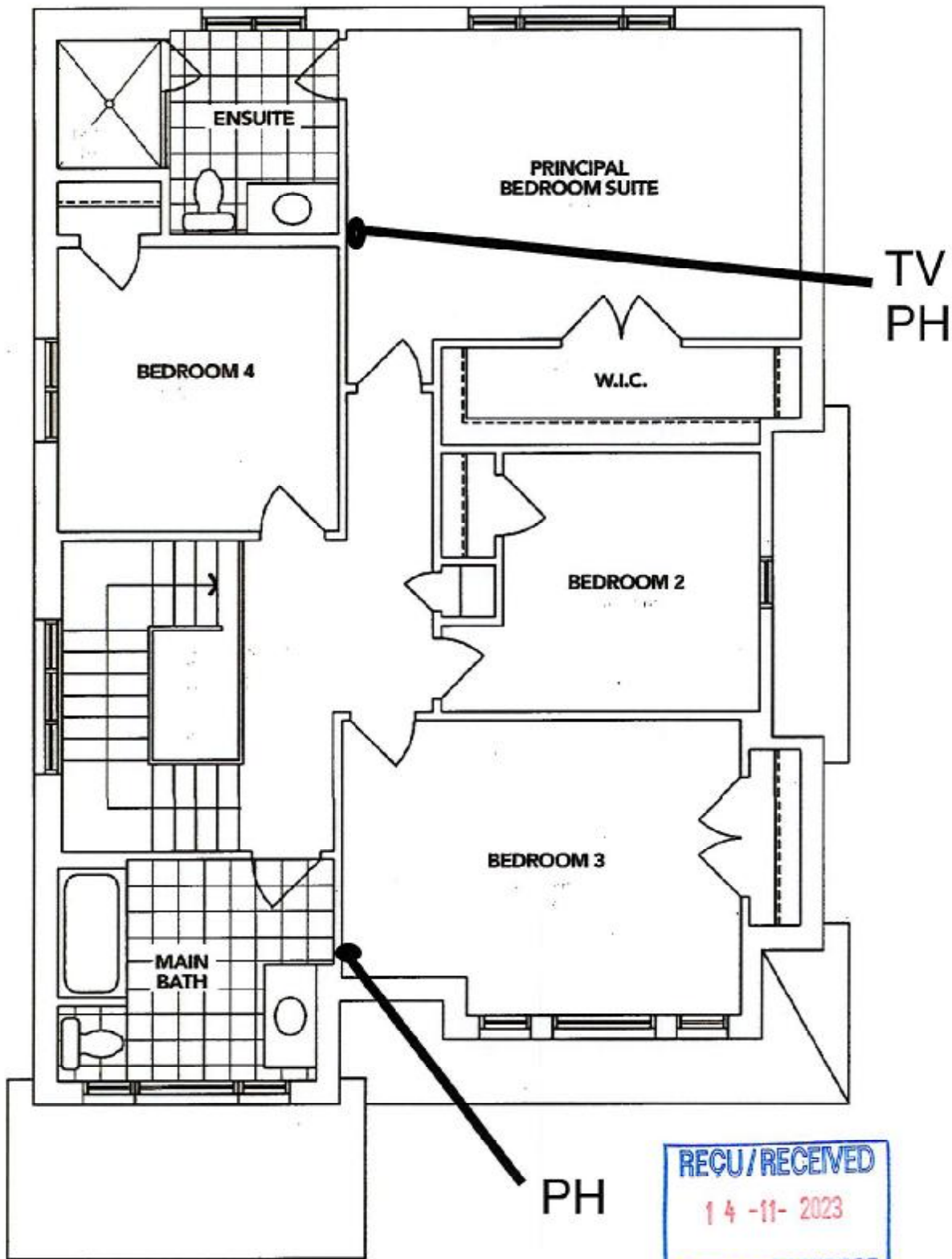

B SECOND FLOOR



The floor plans and elevations shown are pre-construction plans and may be revised or improved as necessitated by architectural controls and the construction process. The measurements adhere to the rules and regulations of the TARION Warranty Corporation's official method for the calculation of floor area. Materials, specifications and floor plans are subject to change without notice. All house renderings are artist's concept only. Actual usable floor space may vary from the stated floor area. All options shown are upgrades. E. & O. E.

SCHEDULE "B-1"
Floor Plan

Lindsay ph. 2 Lot 56

Lot 56
Phase 2
Model: Buckhorn Lake (3704) Elev B 4Bed 2.5Bath
Standard

SKETCH #5

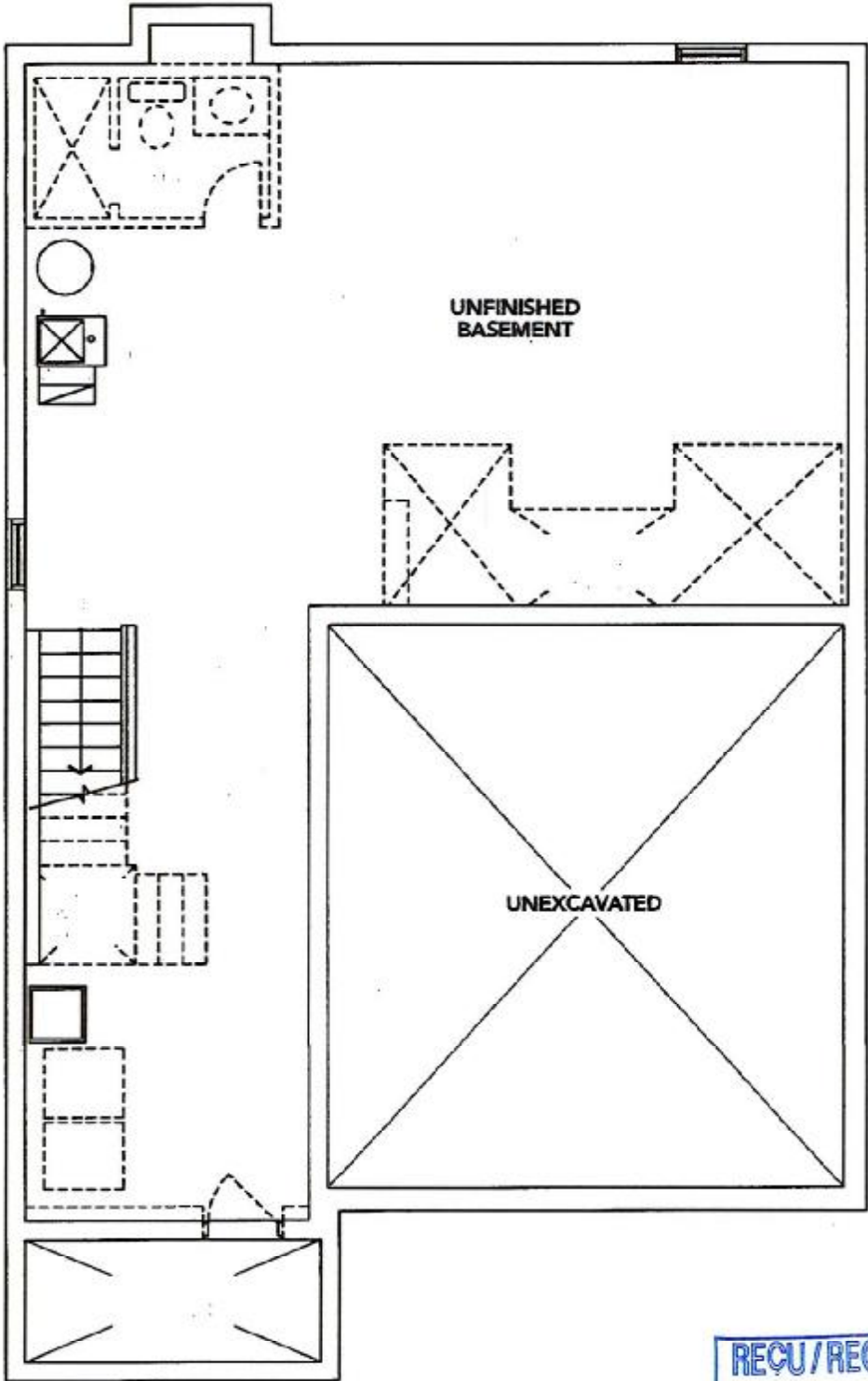

REQ/RECEIVED
14-11-2023

ELEVATION **B** BASEMENT

The floor plans and elevations shown are pre-construction plans and may be revised or improved as necessitated by architectural controls and the construction process. The measurements adhere to the rules and regulations of the TARION Warranty Corporation's official method for the calculation of floor area. Materials, specifications and floor plans are subject to change without notice. All house renderings are artist's concept only. Actual usable floor space may vary from the stated floor area. All options shown are upgrades. E. & O. E.

Initials: TP T.P.

Lot 56 PH 2 SUGARWOOD UPG KITCHEN SINK

BLANCO

Sink Specifications

Colour SKU
brushed finish 401247

Design and planning tips

- Min cabinet size: 36 in (915 mm)

Specifications:

3 ½" (90 mm) stainless steel strainer(s)

Installation instructions

Cut-out template

Mounting clips

Limited lifetime warranty

Depending on cabinet construction, a different cabinet size may be required.

Codes & Standards

ASME A112.19.3-2017/CSA B45.4-17

Optional Accessories

CapFlow Strainer Cover 517666
Ash Cutting Board 406345
Sink Grid 406349

QUATRUS U 2

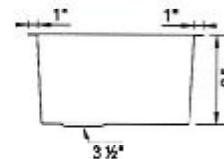
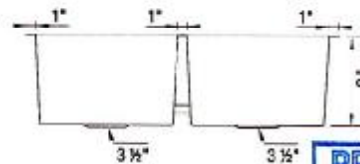
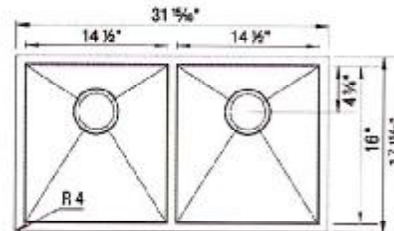

Warranty

Limited lifetime warranty on all sinks and faucets. One-year warranty on all accessories and soap dispensers.

Code/Standards Compliance

BLANCO sinks and faucets are third-party tested and certified to CSA, cUPC, ANSI/ASME, IAPMO and NSF standards and listed by applicable certification bodies. For more information on individual product listings, contact our office or listing organization.



Need support? Learn more by watching our sink & faucet How-to videos:

<https://www.blanco.com/ca-en/support/how-to-videos/how-to-videos-for-sinks/>



BLANCO Canada Inc
100 Corporation Drive
Brampton ON L6S 6B5

Tel & Fax

Tel: 905-494-2400 Toll free: 1-877-425-2626

Fax: 905-494-2425 Toll free: 1-877-825-2626

While BLANCO strives to provide accurate information, all images and dimensions in this document are intended for reference only and are subject to change at any time without notice. This document is not intended for use as an Installation guide. For technical installation details, refer to installation instructions provided with the product. BLANCO assumes no responsibility for the use of superseded or voided specifications.

T.P.