

Lindsay 2017 Developments Inc. / Sugarwood

Lot/Unit: 190 Block 96 Phase/Building: 1 Model/Floor Plan: Sturgeon Lake(2006)Elev B
End 4Bed 2.5Bath

CABINETRY

Inv.6608	1 - To supply and install the OPTIONAL PANTRY	
Line 82466	Note:	
10Jun25 / 20Jun25		

CABINETRY APPLIANCE - FRIDGE

Inv.6608	1 - 66CM DEEP FRIDGE ENCLOSURE - COUNTER DEPTH WITH NO WALLS - 2 66CM DEEP GABLES AND 1 66CM DEEP CABINET - THIS IS NOT A ZERO CLEARANCE ENCLOSURE. STANDARD HEIGHTS AND WIDTHS WILL BE USED. - CLASSIC SERIES	
Line 82376	Note:	
10Jun25 / 20Jun25		

CABINETRY BASE CABINETS

Inv.6608	1 - BANK OF DRAWERS CABINET - 55 CM MAXIMUM - SIZE SUBJECT TO FLOOR PLAN - CLASSIC SERIES	
Line 82464	Note:	
10Jun25 / 20Jun25		
Inv.6608	1 - 45CM WIDE PULL-OUT DOOR BASE CABINET WASTE - RECYCLE CENTRE - 2 35L BINS - AVAILABLE ONLY WITH 45CM WIDE CABINET - CLASSIC SERIES	
Line 82465	Note:	
10Jun25 / 20Jun25		

CABINETRY HOOD FANS

Inv.6608	1 - HOOD FAN - ALITO COLLECTION (SC51930) WALL MOUNT RANGE HOOD WITH 550 CFM FAN - 30 INCH.. SEE SPEC'S	
Line 82377	Note:	
10Jun25 / 20Jun25		

CABINETRY VANITY

Inv.6608	3 - INCREASE VANITY TO KITCHEN HEIGHT - 90CM HIGH - MAINTAINS VANITY DEPTH - CLASSIC SERIES IN THE PWD, MASTER ENSUITE AND MAIN BATHROOM	
Line 82380	Note:	
10Jun25 / 20Jun25		

CABINETRY WALL AND HUTCH

Inv.6608	1 - UPPER ANGLE CORNER PER UNIT - CLASSIC SERIES	
Line 82463	Note:	
10Jun25 / 20Jun25		

ELECTRICAL

Inv.6608	1 - TO SUPPLY AND INSTALL STD TV AND PHONE ROUGH-IN.. SEE SKETCH #2	
Line 82467	Note:	
10Jun25 / 20Jun25		

Lindsay 2017 Developments Inc. / Sugarwood

Lot/Unit: 190 Block 96 Phase/Building: 1 Model/Floor Plan: Sturgeon Lake(2006)Elev B
End 4Bed 2.5Bath

Inv.6608	1 - SUPPLY AND INSTALL AN ADDITIONAL BASIC RECEPTACLE (NOT DEDICATED) AT 66" UP FROM THE F/P MANTLE, SEE SKETCH #2	
Line 82468	Note:	
10Jun25 / 20Jun25		
Inv.6608	1 - TO SUPPLY AND INSTALL THE ELEC REQUIRED FOR THE OPTIONAL FIREPLACE	
Line 82470	Note:	
10Jun25 / 20Jun25		
Inv.6608	1 - TO RELOCATE THE STANDARD KITCHEN LIGHT TO OVER THE KITCHEN ISLAND, SEE SKETCH #2	
Line 82471	Note:	
10Jun25 / 20Jun25		
Inv.6608	3 - DO NOT SUPPLY THE STANDARD MAIN HALLWAY LIGHT, KEEP THE SWITCH AND SUPPLY & INSTALL THREE IC 4 in POT LIGHT C/W PAR 20 BULB AND WHITIE TRIM CONNECTED TO THE STD SWITCH, SEE SKETCH #2	
Line 82472	Note:	
10Jun25 / 20Jun25		
Inv.6608	4 - TO SUPPLY & INSTALL FOUR IC 4 in POT LIGHT C/W PAR 20 BULB AND WHITIE TRIM IN THE KITCHEN CONNECTED TO A SEP SWITCH, SEE SKETCH #2	
Line 82473	Note:	
10Jun25 / 20Jun25		
Inv.6608	1 - SUPPLY & INSTALL IC 4 in POT LIGHT C/W PAR 20 BULB AND WHITIE TRIM	
Line 82474	Note:	
10Jun25 / 20Jun25		
Inv.6608	1 - TO SUPPLY & INSTALL FOUR IC 4 in POT LIGHT C/W PAR 20 BULB AND WHITIE TRIM CONNECTED TO A SEP. SWITCH IN THE GREAT ROOM, SEE SKETCH #2	
Line 82475	Note:	
10Jun25 / 20Jun25		

FIREPLACE

Inv.6608	1 - TO SUPPLY AND INSTALL THE OPTIONAL FIREPLACE	
Line 82469	Note:	
10Jun25 / 20Jun25		

EXTRAS AS PER OFFER

Note:	
-------	--

Sturgeon Lake

2006-END

KINGSILLEN
GROUP INC.

2010 sq. ft. / 4 Bedrooms / 2 1/2 Bathrooms

Lot 190-PH1
SKETCH #1

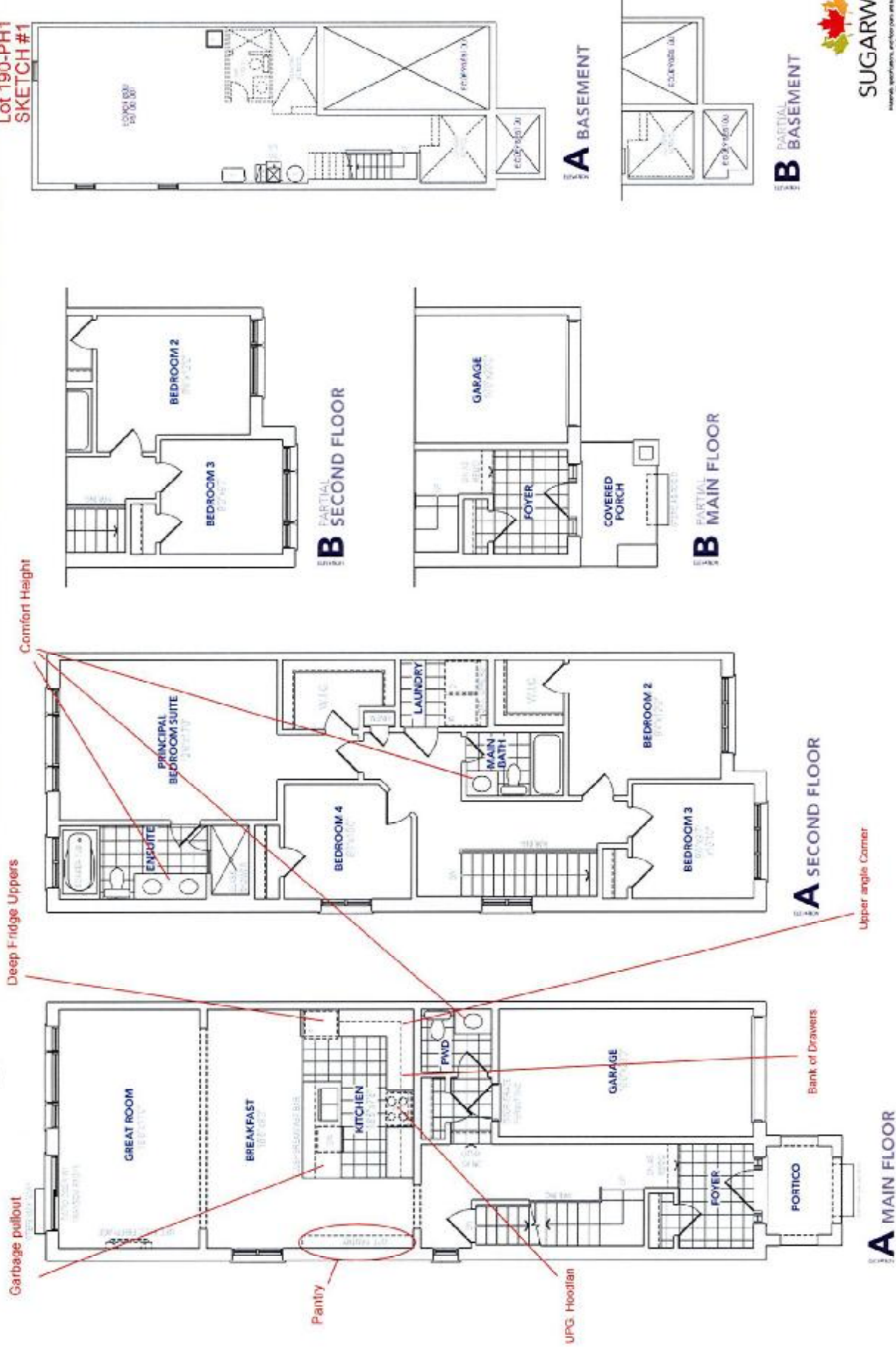

SUGARWOOD

Resale, development and floor plans are subject to change without notice. To view our latest developments, please visit our website at www.sugarwood.ca or call 1-800-361-2000. © 2006 Sugarwood Inc.