



BELLAIRE PROPERTIES INC. (CARSON’S CREEK)  
PURCHASER EXTRAS

**LOT # 135 P.E #010** – Model - MADAWASKA - 3190 - PHASE 1

Attention Trades...

The following items below are Purchaser Extras, please make sure that they are done on time and properly complete. Any outstanding items will be Back Charged. If you have any questions please call Roberto Ruiz. Make sure that you review ALL of the items on the Purchaser Extras.

Please be advised that Purchase Orders will come at a later date.

**\*\*\*Also, it is very important to speak to Roberto Ruiz before starting on site \*\***

TRADE: ITEMS TO BE COMPLETED

Internazionale	#1, #2, #3, #4, #5, #6, #7

Date: Jun.-14-2022  
From: Lormel Homes  
Site Clerk: Jai Fitzgerald  
Site Tel: 905-775-3633  
Site Fax: 905-775-9083

**NOTE:** If more information is needed please call Roberto Ruiz cell-416-688-9324  
If more information needed on quotes or changes, please call Zachary 905-832-2023 ext. 224



Schedule B-3 – Purchaser’s Extras  
forming part of the Agreement of Purchase and Sale

VENDOR: BELLAIRE PROPERTIES INC.

PURCHASER(S): Michael Agyemang-Prempeh  
LOT NUMBER: 135 PHASE: 1  
MODEL: 3190 Madawaska  
P.E.#: 010

It is understood and agreed that no requests for changes, additions or deletions will be accepted by the Vendor for the above extras after the date of acceptance of this order

No.	DESCRIPTION	PRICE
1.	Provide and install two (2) rough-in light with capped enclosure on separate switch for future wall sconce in study. *Note: To be installed approx. 6'ft up from floor and about 7ft apart , standard ceiling light to remain	
2.	Provide and install one (1) rough-in light with capped enclosure on separate switch for future wall sconce in the shared bath between the two mirrors. *Note: In lieu of standard strip lighting provide and install standard ceiling light to be centered.	
3.	Provide and install two (2) rough-in light with capped enclosure on separate switch for future wall sconce in bedroom 4. *Note: To be installed approx. 5ft up from floor and about 7ft apart.	
4.	Provide and install two (2) rough-in light with capped enclosure on separate switch for future wall sconce in bedroom 2. *Note: To be installed approx. 5ft up from floor and about 8ft apart.	
5.	Provide and install one (1) rough-in light with capped enclosure to existing switch for future wall sconce in the living room, as per sketch. *Note: To be installed approx. 6'ft up from floor and approx. 8'ft apart. from existing rough-in light with capped enclosure.	
6.	Provide and install one (1) rough-in light with capped enclosure to existing switch for future wall sconce in the dining room, as per sketch. *Note: To be installed approx. 6'ft up from floor and approx. 8'ft apart to existing rough-in light with rough-in enclosure.	
7.	Provide and install one (1) rough-in light with capped enclosure to existing switch for future wall sconce in the family room, as per sketch. *Note: To be installed approx. 7'ft up from floor and approx. 5'ft 10" inches apart above the fireplace.	
Extra's Subtotal:		
H.S.T.		
New Total:		
Less Bonus Package (if Applicable)		
TOTAL:		
Amount to be Added to the Purchase Price as an Adjustment on Closing		
TOTAL		

The above extras and upgrades are to be included during the construction of the above house for the above named purchaser subject to the following conditions:

- The Vendor will undertake to install the above extras but will not be liable to the purchaser if for any reason the work covered by the extra is not completed. In that event, the price of the extra shall be refunded to the purchaser without any interest.
- It is understood and agreed that if the transaction of Purchase and Sale is not completed for any reason whatsoever, the total cost of this extra shall be refundable.

PAID: \_\_\_\_\_

TERMS: CASH OR CHEQUE IN ADVANCE

Michael Agyemang-Prempeh (Jun 1, 2022 12:47 EDT)  
PURCHASER

PURCHASER

File Copy for  
Construction  
Office  
(Original verified at Head Office)

47'  
DESIGNS

The Madawaska / Elev. A & B  
3190 sq.ft.

## LOT 1-135, INNISFIL, ELECTRICAL ONLY

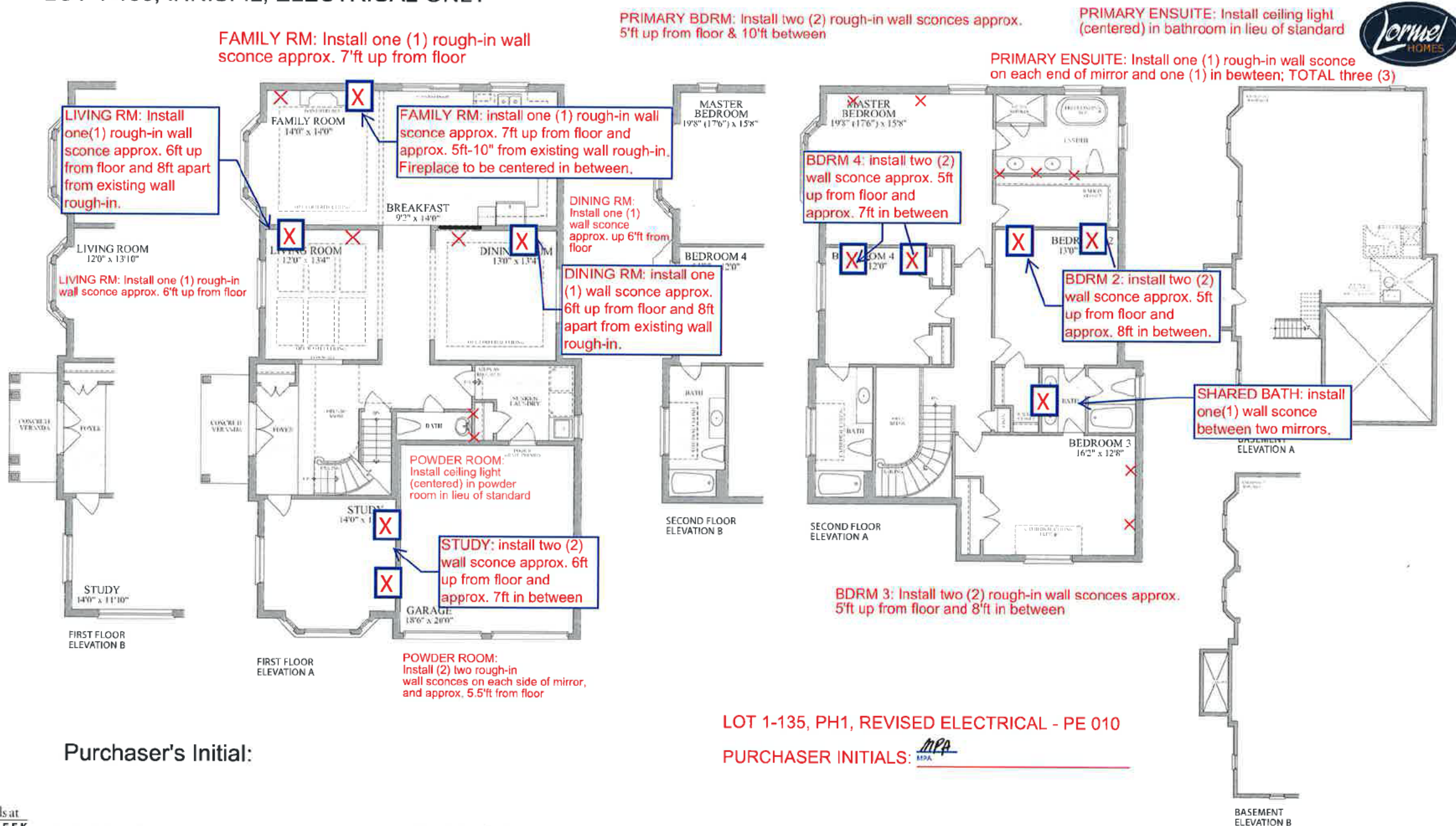



47'  
DESIGNS

The Madawaska / Elev. A & B  
3190 sq.ft.

# LOT 1-135, INNISFIL, ELECTRICAL ONLY

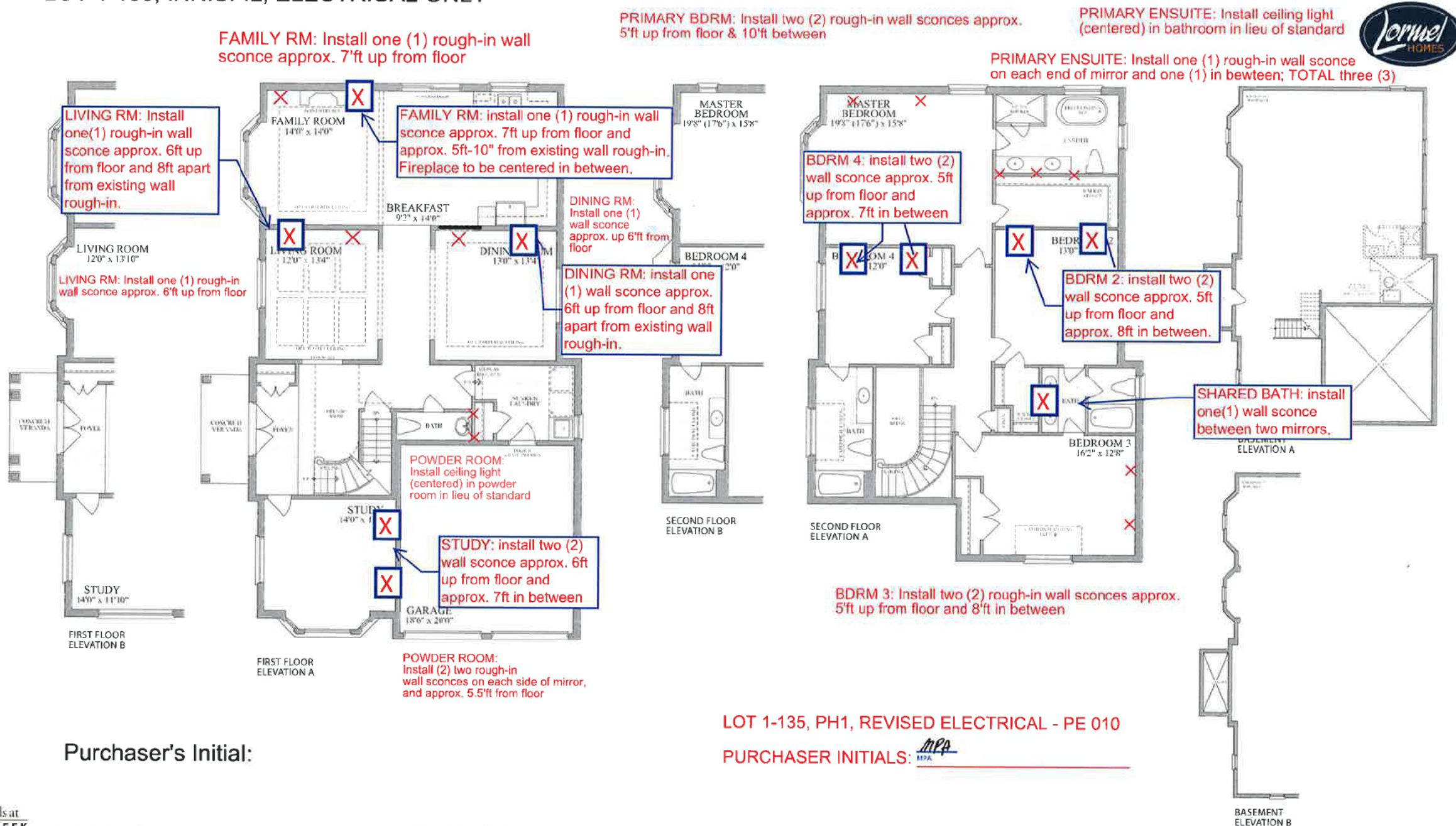

Purchaser's Initial:

LOT 1-135, PH1, REVISED ELECTRICAL - PE 010

PURCHASER INITIALS: MPA