

Consultants Final Lot Grading Certification Letter

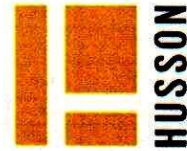

September 15, 2023

File No. 231437

Town of Innisfil

2101 Innisfil Beach Road

Innisfil, ON L9S 1A1

Attention: Fabian Van Romberg, Development Inspector:

Re: Municipal Address: 1580 Stovell Crescent
Lot or Block No.: Lot 74
Registered Plan No.: 2021-0484
Certification of building and final lot grading
Bellaire Properties Inc.

I have inspected the complete lot grading and building elevations on the above lot, and do hereby certify that:

1. The lot grading and building elevations on the above referenced lot are:
 - ☒ In conformity with the approved grading and site plans
 - ☐ Not in conformity with the approved plan, but have been constructed in accordance to sound engineering principles and vary from the approved plan as shown on the attached "as-built" plan, signed and stamped by the undersigned, subject to approval by the Town of Innisfil.
2. The water service "curb-stop" is located in the grassed portion of the front yard, is accessible, and is flush with finished grade.

HUSON Limited

Name of Engineering Firm

Carmen Sframeli, P. Eng.

Professional Engineer's Name



ENGINEERING + MANAGEMENT

P 905.709.5825

200 CACHET WOODS COURT, SUITE 204
MARKHAM, ON L6C 0Z8

HUSON.CA

ZONING INFORMATION

ZONE DESIGNATION	PERMITTED	PROVIDED
R1-26		
LOT AREA (sq m)	420.00	524.14
LOT FRONTAGE (m)	14.300	16.901
FRONT YARD SETBACK TO DWELLING (m)	4.50	6.04
FRONT YARD SETBACK TO GARAGE (m)	6.00	6.00
INTERIOR SIDE YARD SETBACK (m)	1.20	1.25
EXTERIOR SIDE YARD SETBACK (m)	4.20	4.53
REAR YARD SETBACK (m)	6.00	6.05
LOT COVERAGE (%)	40.00	35.56
BUILDING HEIGHT (m)	10.00	8.05
LANDSCAPED OPEN SPACE (%)	30.00	56.71
FRONT YARD LANDSCAPED OPEN SPACE (%)	40.00	63.19

STRUCTURE

MODEL NO.	MADAWASKA 3190A
HOUSE STYLE (i.e. walkout, bungalow etc.)	2 STOREY
EAST	MADAWASKA 3190A
WEST	KAHSHE 3000A
NORTH	N/A
SOUTH	TEMAGAMI 3350A
FIREBREAK LOT	NO

LEGEND

- SINGLE CATCHBASIN
- DOUBLE CATCHBASIN
- SANITARY MH
- STORM MH
- SANITARY SERVICE CONNECTION
- STORM SERVICE CONNECTION
- WATER SERVICE CONNECTION
- FLOW DIRECTION
- ROOF DRAIN
- * ENGINEERED FILL
- 000.00 EXISTING ELEVATION
- 000.00 PROPOSED ELEVATION
- FFF FINISHED 1ST FLOOR
- TW TOP OF FOUNDATION WALL
- FS FINISHED SLAB
- USF U/S FOOTING
- RUSF REAR U/S FOOTING
- TWG TOP OF GARAGE FOUNDATION WALL
- USFG U/S FOOTING GARAGE
- SP SUMP PUMP
- VALVE AND BOX
- HYDRANT AND VALVE
- BELL PEDESTAL
- △ CABLE PEDESTAL
- ★ UNDERGROUND PEDESTAL
- HYDRO TRANSFORMER
- ★ STREETLIGHT
- STREETLIGHT PEDESTAL
- HYDRO SERVICE CONNECTION
- MB SUPER MAILBOX
- 1234 MUNICIPAL ADDRESS
- 1:1 SLOPE 3:1 MAXIMUM
- FOOTINGS LOWERED TO MAINTAIN 1.22m FROST PROTECTION

GENERAL NOTES

ALL SLOPES TO BE 3:1 MAX
THE BUILDER SHALL BE RESPONSIBLE FOR THE VERIFICATION OF HOUSE TYPE AND ELEVATION, PRIOR TO COMMENCEMENT OF CONSTRUCTION

BENCHMARK

ELEVATION: 286.399

ELEVATION IS BASED ON BENCHMARK No. 0011931U463S HAVING AN ELEVATION OF 286.399 METRES. LOCATION: TOWNSHIP OF CHURCHILL UNITED CHURCH, TABLET IN NORTH STONE FOUNDATION WALL OF TOWER, 23cm FROM NORTHWEST CORNER AND 1.62m BELOW BRICKWORK.

ARCHITECTURAL DESIGN INC.



56 PENNSYLVANIA AVE.
UNIT 1
CONCORD, ONTARIO
L4K 3V9
TEL 905 660-9393
FAX 905 660-9419
adci@bellnet.ca

SERVICING CHECK BOX

WATER SERVICE AT P/L		SANITARY SERVICE AT P/L		STORM SERVICE AT P/L	
DEPTH	INVERT	DEPTH	INVERT	DEPTH	INVERT
Min 1.70	Min 241.88	2.785	240.815	2.71	240.90

**THIS IS AN ENGINEERED FILL LOT.
* THE SUITABILITY OF THE FOUNDATION SOIL IS TO BE CONFIRMED BY A GEOTECHNICAL ENGINEER.**

THE UNDERSIGNED HAS REVIEWED AND TAKES RESPONSIBILITY FOR THE ARCHITECTURAL PORTION OF THIS PLAN AND HAS THE QUALIFICATIONS AND MEETS THE REQUIREMENTS SET OUT IN THE ONTARIO BUILDING CODE TO BE A DESIGNER.

QUALIFICATION INFORMATION

LEO ARIEMMA 7561
NAME SIGNATURE LICENCE NUMBER

KEY PLAN

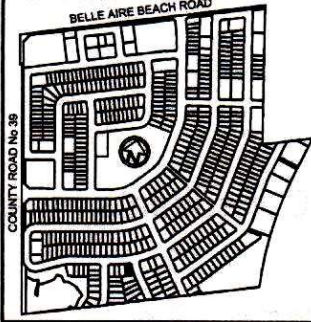

14.3 m
47 foot
LOT

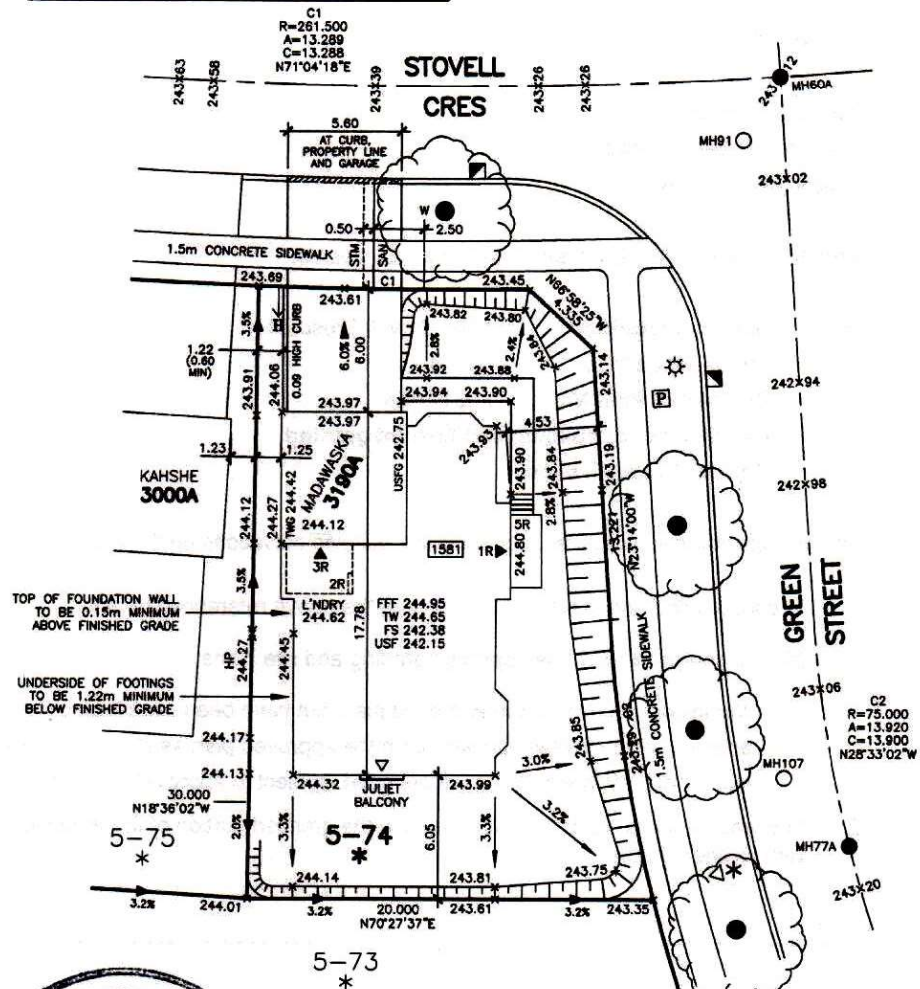

NO.	REVISIONS	DATE	INITIAL
2	AS BUILT	SE 15 23	BJJ
1	REVISED PER IBI GROUP REVIEW	MY 18 21	TP
-	ISSUED	MY 05 21	TP

THE PROPOSED LOT GRADING IS APPROVED AS BEING IN GENERAL CONFORMITY WITH THE OVERALL APPROVED GRADING PLAN FOR THIS SUBDIVISION.

COMPANY NAME: HUSSON ENGINEERING

APPROVED BY: C. SFRAMELI

SIGNATURE:

DATE: SEPTEMBER 15, 2023

1580 STOVELL CRESCENT
LOT 74, PLAN 51M-1169
PHASE 5, STAGE
BELLAIRE PROPERTIES INC.
PARCEL P1 - LEFROY
TOWN OF INNISFIL

SCALE: 1:250
DATE: MAY 2021
DRAWN: T.P.
DESIGNED: T.P.

DRAWING No:
A-1