

SHADOW RIDGE 2
LOT #78
PLATINA (512)

Technical drawing of a door assembly. The door is shown with a handle and a lock. The dimensions are 47 1/4" and 15". The labels are VBD15, DRWRS, V30/4, and VF2.

Technical drawing of a three-compartment sink. The overall width is dimensioned as 83 1/16". The compartments are labeled from left to right: VF2, V33/4, and V33/4. The central compartment is labeled VBD15 and contains a drain assembly. The rightmost compartment is labeled VF2 and contains a drain assembly. The drawing shows the sink's profile and the internal drain structure.

69 11/16"

48 5/8"

49"

VF1

V30/4

V39/4

V15R/4

VBD15

DRWRS

V30/4

2 DOOR
VANITY BASE
(MAKE-UP AREA
DELETED)

MAKE-UP
AREA

MASTER ENSUITE

All dimensions, size designations given are subject to verification on job site and adjustment to fit job conditions.

artier
SPOON



This is an original design and must not be released or copied unless applicable fee has been paid or job order placed.

**DRAWN BY: LD
CARTIER KITCHENS OTTAWA**

DCR PHOENIX - LOT #78 SR2 - PLATINA (512) VANIITES

All

Drawing #: 1	No Scale.
--------------	-----------

I have reviewed these drawings and understand the details of the layout and the Cartier Kitchens specifications.

Signal

Date _____

Designed: 11/25/2012
Printed: 11/25/2012

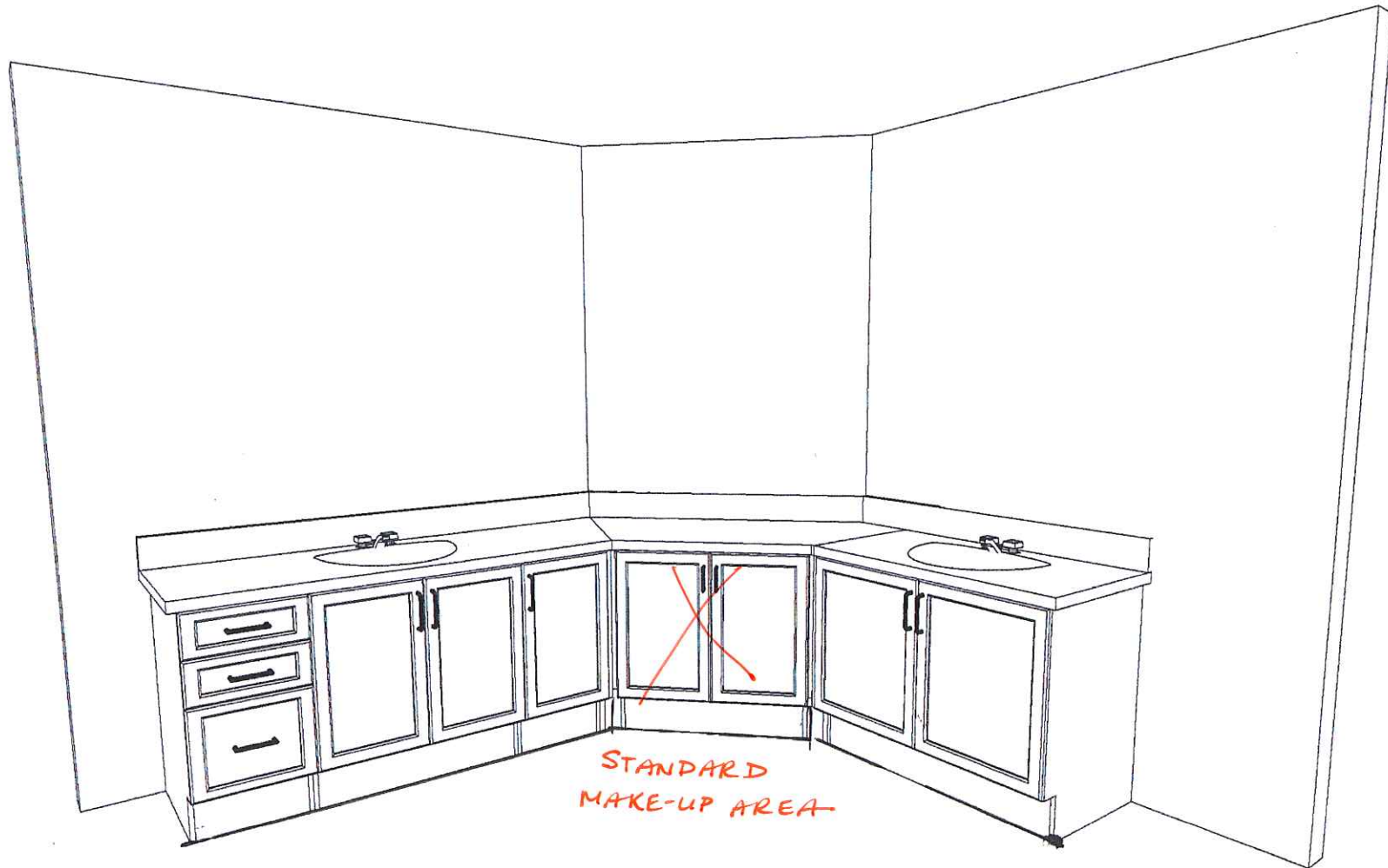

CUSTOMER APPROVAL

I have reviewed these drawings and understand the details of the layout and the Cartier Kitchens specifications.

Signature

[Handwritten Signature]

Date

April 6/13

Master ensuite

Note: This drawing is an artistic interpretation of the general appearance of the design. It is not meant to be an exact rendition.



Designed: 11/25/2012
Printed: 11/25/2012

DESIGNED BY: LORI DISAVERIO.

DCR PHOENIX - LOT #78 SR2 - PLATINA (512)

All

Drawing #: 1

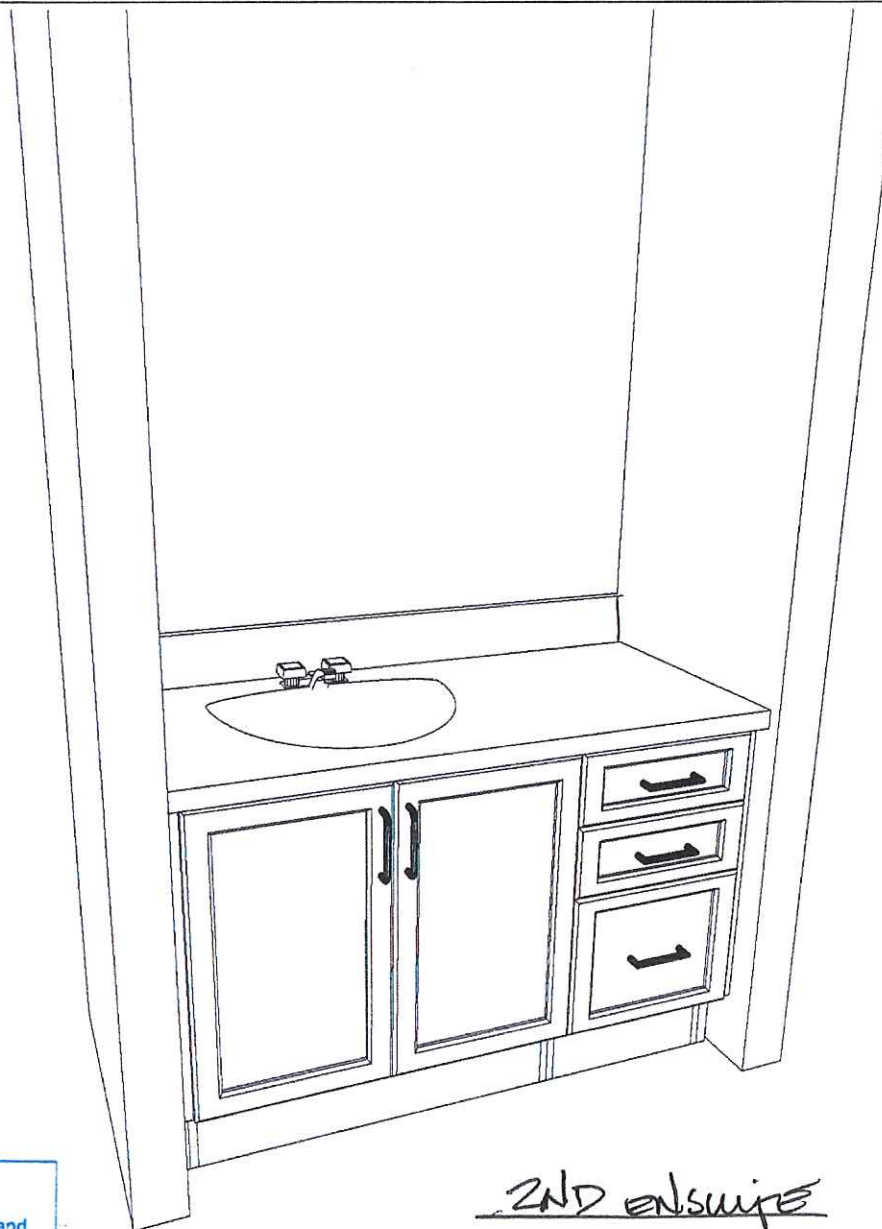

2ND ENSUIVE

CUSTOMER APPROVAL

I have reviewed these drawings and understand the details of the layout and the Cartier Kitchens specifications.

Signature (x) *jl*

Date April 6/13

Note: This drawing is an artistic interpretation of the general appearance of the design. It is not meant to be an exact rendition.



Designed: 11/25/2012
Printed: 11/25/2012



DESIGNED BY: LORI DISAVERIO.

DCR PHOENIX - LOT #78 SR2 - PLATINA (512)

All

Drawing #: 1

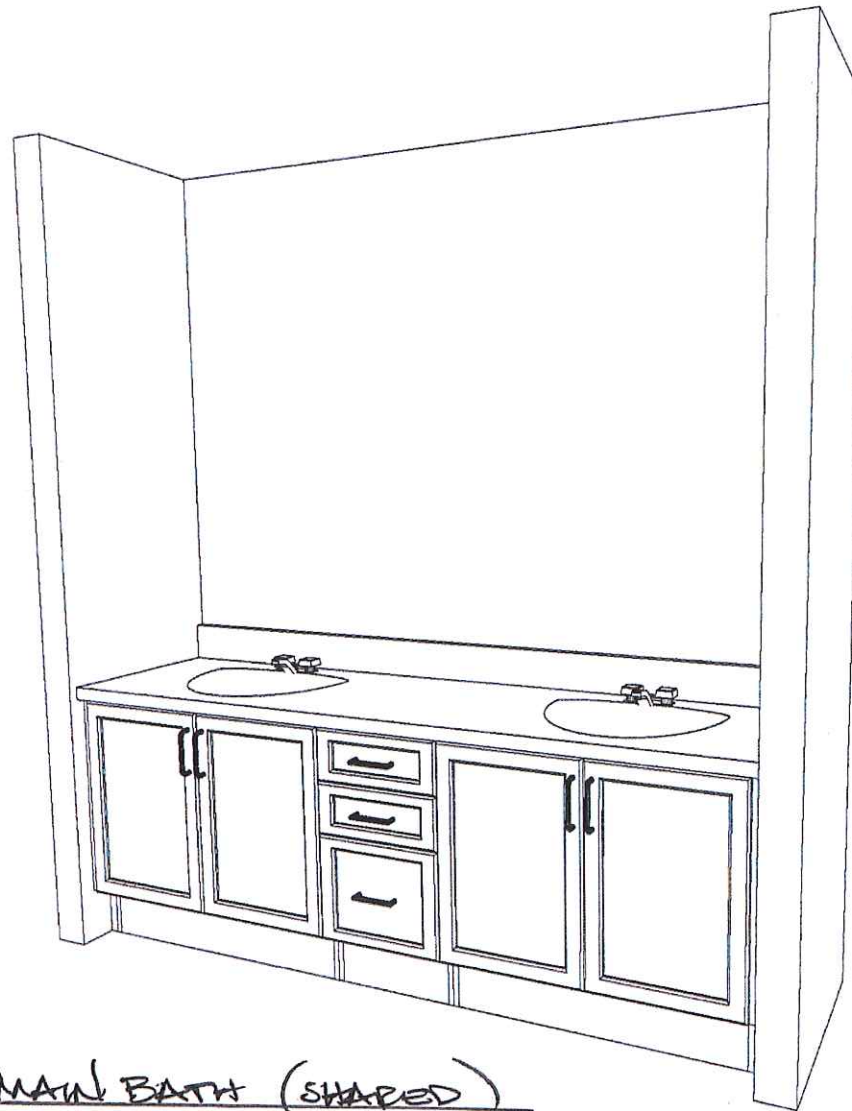

MAIN BATH (SHARED)

CUSTOMER APPROVAL

I have reviewed these drawings and understand the details of the layout and the Cartier Kitchens specifications.

Signature

(Signature)

Date

April 6/13

Note: This drawing is an artistic interpretation of the general appearance of the design. It is not meant to be an exact rendition.



Designed: 11/25/2012
Printed: 11/25/2012

DESIGNED BY: LORI DISAVERIO.

DCR PHOENIX - LOT #78 SR2 - PLATINA (512) | All

Drawing #: 1