

falmec

VULCANO

Version
FPVUL30W3SS / Vulcano Wall
30" (76 cm) 280 CFM

Collection
Potenza

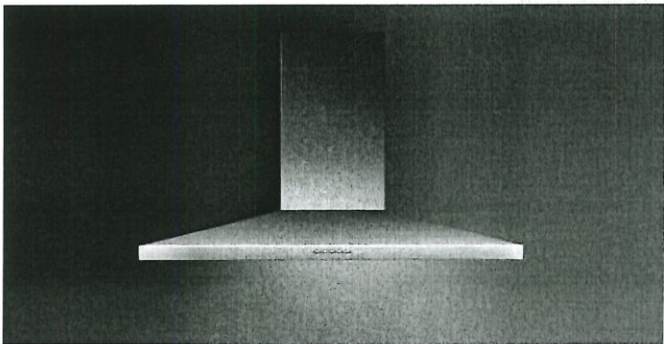

Photograph is for information purposes only
May not correspond to the selected version

FEATURES	TECHNICALFEATURES	PACKAGING:WEIGHTS AND VOLUMES	CONSUMPTION AND CONNECTION FEATURES
<p>Scotch brite stainless steel (AISI 304)</p> <p>Electronic control</p> <p>Metallic grease filter, removable and washable</p> <p>Optional charcoal filter</p> <p>Labyrinth filter</p>	<p>Installation type Wall</p> <p>Dimensions 30 " / 76 cm</p> <p>Finish Scotch brite stainless steel (AISI 304)</p> <p>Motor 280 CFM</p> <p>Type of control Electronic control</p> <p>Speed settings 3</p> <p>Lighting Led 2x1,2 W - 3200 K</p> <p>Charcoal filter Square charcoal filter - Type 3</p> <p>Minimum distance Gas hob: 60 cm Electric hob: 52 cm</p>	<p>Gross weight 20 kg</p> <p>Net weight 15 kg</p> <p>Volume 0,30 m³</p> <p>Packaging size Length 995 mm Height 595 mm Depth 510 mm</p>	<p>Maximum consumption 150 W</p> <p>Current 120V 60Hz</p> <p>Frequency</p> <p>Plug type standard</p>
<p>OPTIONAL ACCESSORIES</p> <p>KACL.510#I Extension H700 - Wall</p> <p>KACL.512#I Extension H960 - Wall</p> <p>KACL.815 Protective cleaning cloths for stainless steel (box 10 pcs)</p> <p>103050107 Square charcoal filter - Type 3</p>			

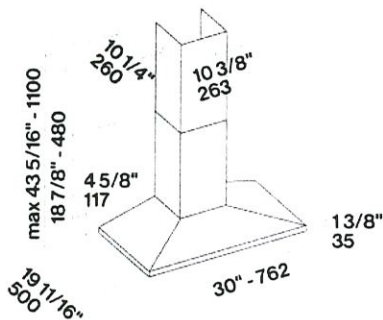

PW 119

Exhibit 6032 IFS

Model number: 105520

Dimensions: 60" x 32" x 18" Installation: Alcove Material: Acrylic

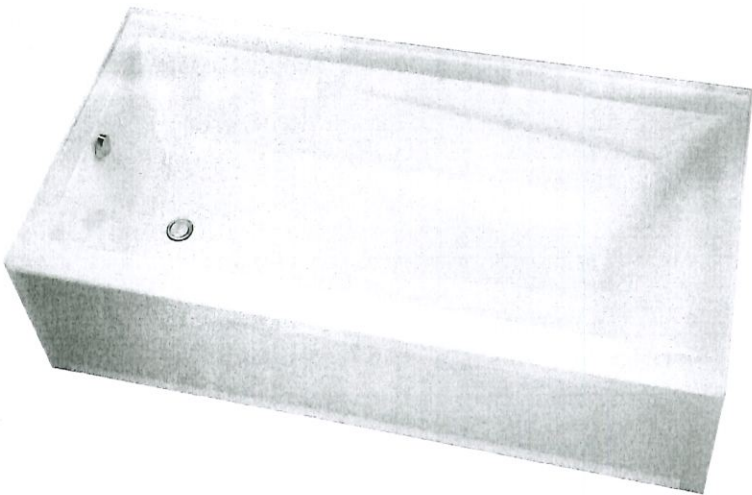

Standard Features:

- Rectangular shape bathtub in alcove installation
- Available in Above-the-Floor Rough (AFR) or not
- Minimalist look with discreet armrests and textured floor
- Integrated tiling flange
- Integrated skirt with access panel when equipped with a system

Product characteristics:

- Made in North America
- Elegant design
- Integrated Tiling Flange and Skirt

Systems:

- Whirlpool
- Combined Whirlpool/Aeroeffect
- Aeroeffect

Warranty:

25 Years

Standard colors:

White (001)

Bone (004)

Biscuit (007)

Certifications

MAAX products adhere to one or more of the following certifications:

UL

ICC
ES
PMG

Recommended products (Visit our website for a complete list of our recommended doors)

No	Description
139398	Halo Sliding Tub Door 56 ½-59 x 59 in. 8 mm
135330	Incognito 57 Shaker Sliding Tub Door 56-59 x 56 ¾ in. 8 mm
139351	Incognito 57 Sliding Tub Door 56-59 x 56 ¾ in. 6 mm

Options (Visit our website for a complete list of our options)

No	Description
<input type="checkbox"/> OPT 10019	Removable access panel
<input type="checkbox"/> OPT 10053	Chromatherapy
<input type="checkbox"/> OPT 10095	Water heater assembly
<input type="checkbox"/> OPT 10106	Metal trim kit for whirlpool and combined systems
<input type="checkbox"/> OPT 20029	Metal trim kit for Air Push Control



PWS 119

Exhibit 6032 IFS

Model number: 105520

Dimensions: 60" x 32" x 18" Installation: Alcove Material: Acrylic

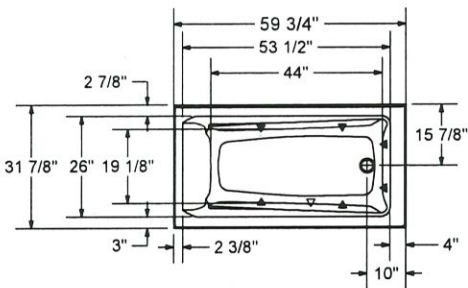

1" Single Integrated tiling flange (shown)
2" Double Integrated tiling flange (not shown)
Drop-in model (Shown)

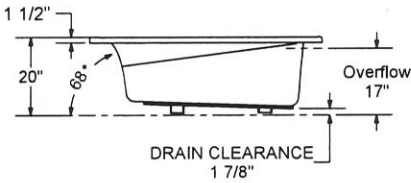

Wood support design may vary.
Single integrated tiling flange: 1" height x 1/4" thickness (shown)
Double integrated tiling flange: 2" height (not shown)
All dimensions are approximate.
Structure measurement must be verified against the unit to ensure proper fit.

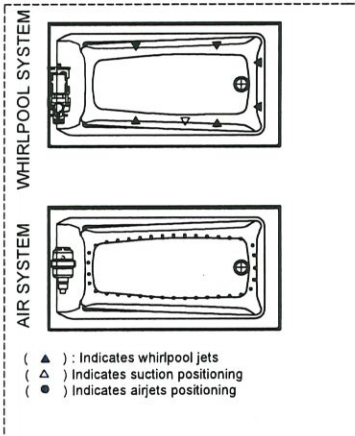

Dimensions:

59 3/4 x 32 x 17 3/4 in.
(1518 x 813 x 451 mm)

Water capacity:

46 gallons - 173 liters

Weight:

78 lbs - 35.37 kg

Bathing well:

53 1/4 X 25 7/8 in.
(1353 X 657 mm)

Deep sump height:

16 1/4 in. - 413 mm

Deck width:

4 1/8 in. - 105 mm

Drain location:

Left

Right

Project: _____

Contractor: _____

Representative: _____

Date: _____

Tel: _____

Notes: _____
