

DCR PHOENIX HOMES**MODEL - ANNAPOLIS (509)****KITCHEN****MOUNTING HEIGHT - 84**

LINE - 1 & 2

HARDWARE - STD & 1ST UPGRADE

STANDARD WHITE INTERIOR

METAL DRAWER BOX

4 PCS - 5/8" KICK - FIN. BOTH ENDS

2 PCS - LOOSE FILLER - 6 x 96

2 PCS - 90 DEG. CORNER MOULD

1 PCS - T-MOULD

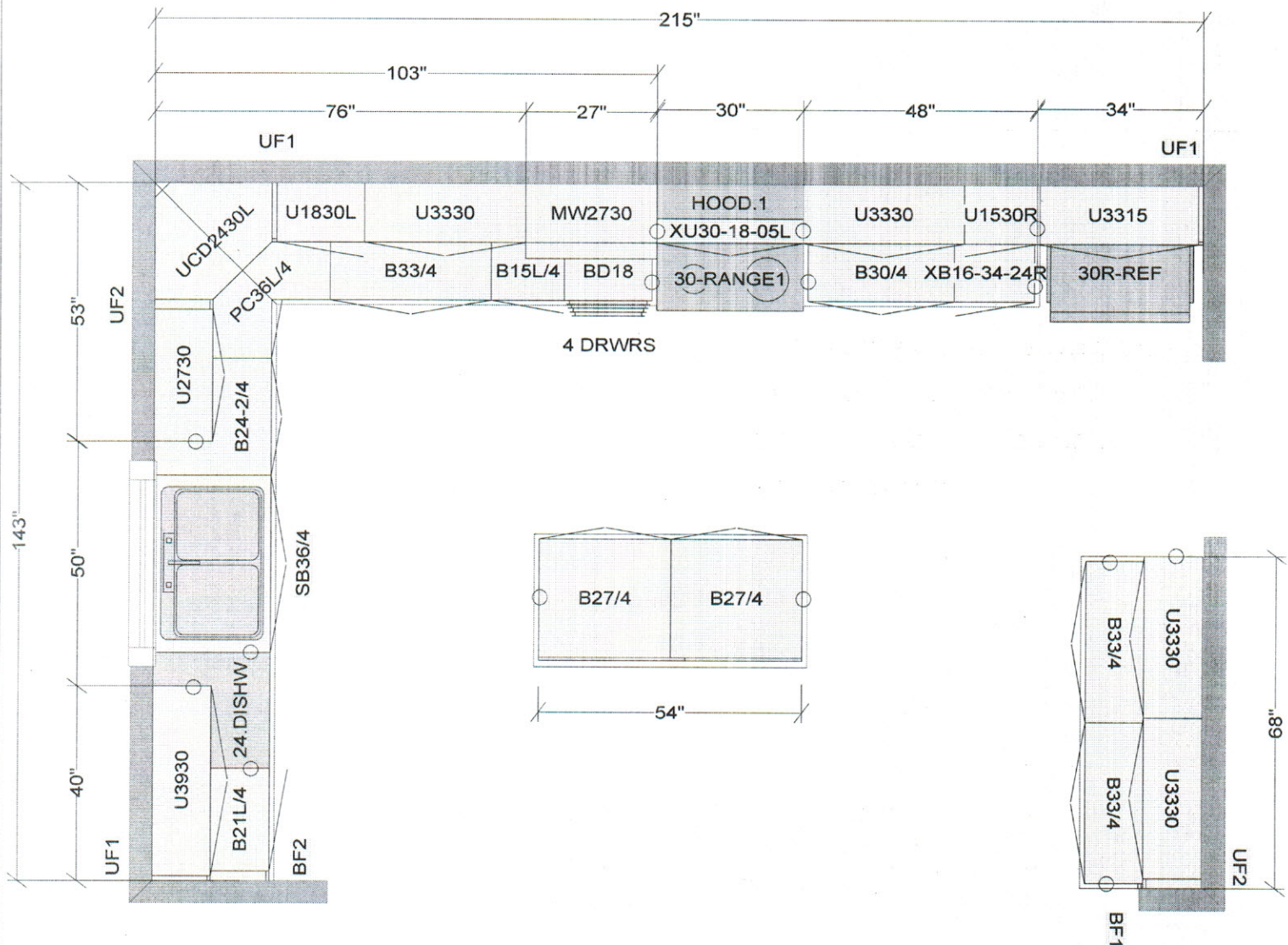
DS
NRDS
XLR

All dimensions size designations
given are subject to verification on
job site and adjustment to fit job
conditions.

CARTIER KITCHENS OTTAWA

509 Annapolis Kit

2020
TECHNOLOGIES

This is an original design and must
not be released or copied unless
applicable fee has been paid or job
order placed.

DRAWN BY: LORI DISAVERIO, B.I.D.
CARTIER KITCHENS OTTAWA

Designed: 3/29/2013
Printed: 6/14/2013

All

Drawing #: 1 No Scale.

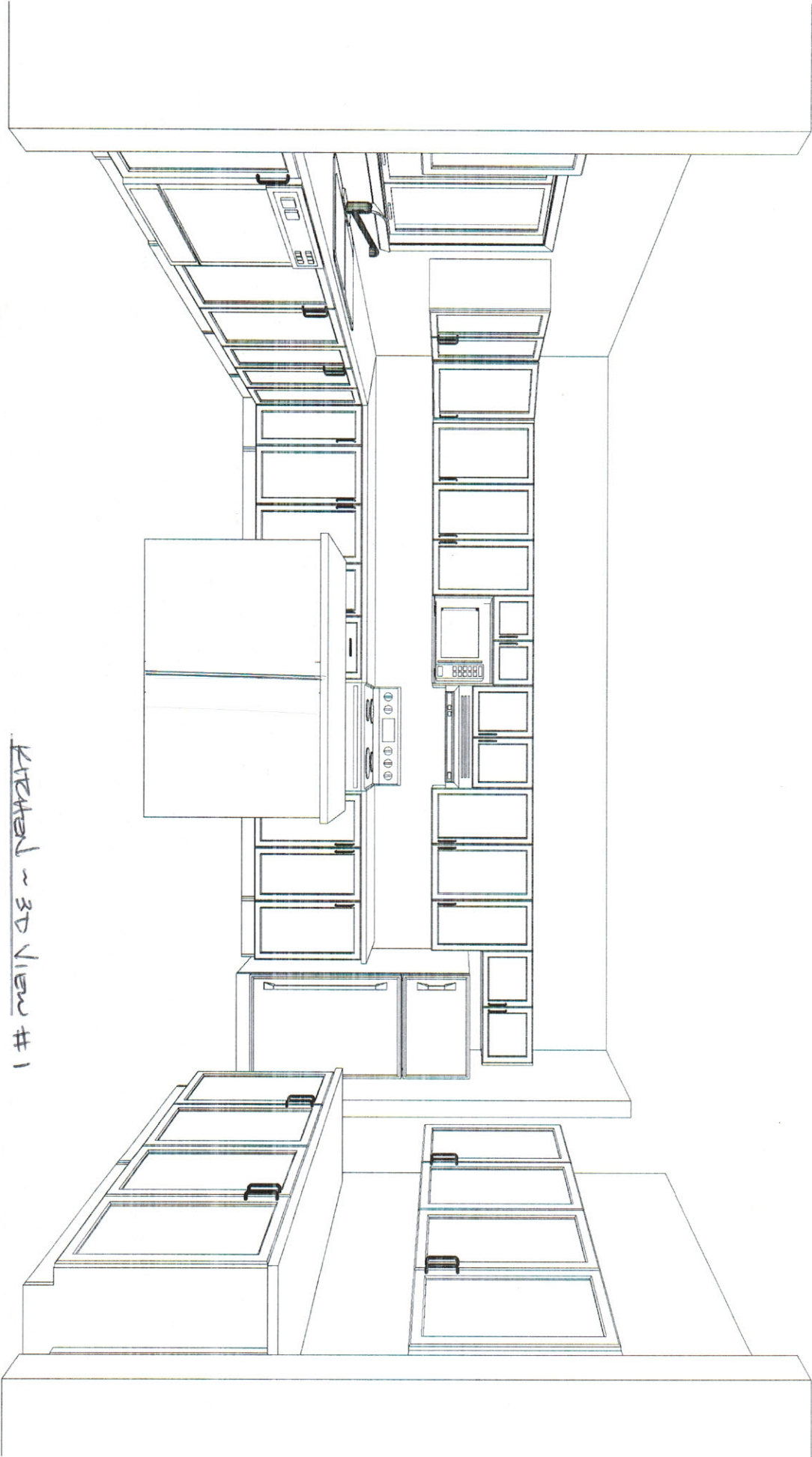

Kitchen ~ 3D View #1

Note: This drawing is an artistic interpretation of the general appearance of the design. It is not meant to be an exact rendition.

DRAWN BY: LORI DISAVERIO, B.I.D.
509 Annapolis Kit



Designed: 3/29/2013
Printed: 6/1/2013

All

Drawing #: 1

DS
NG

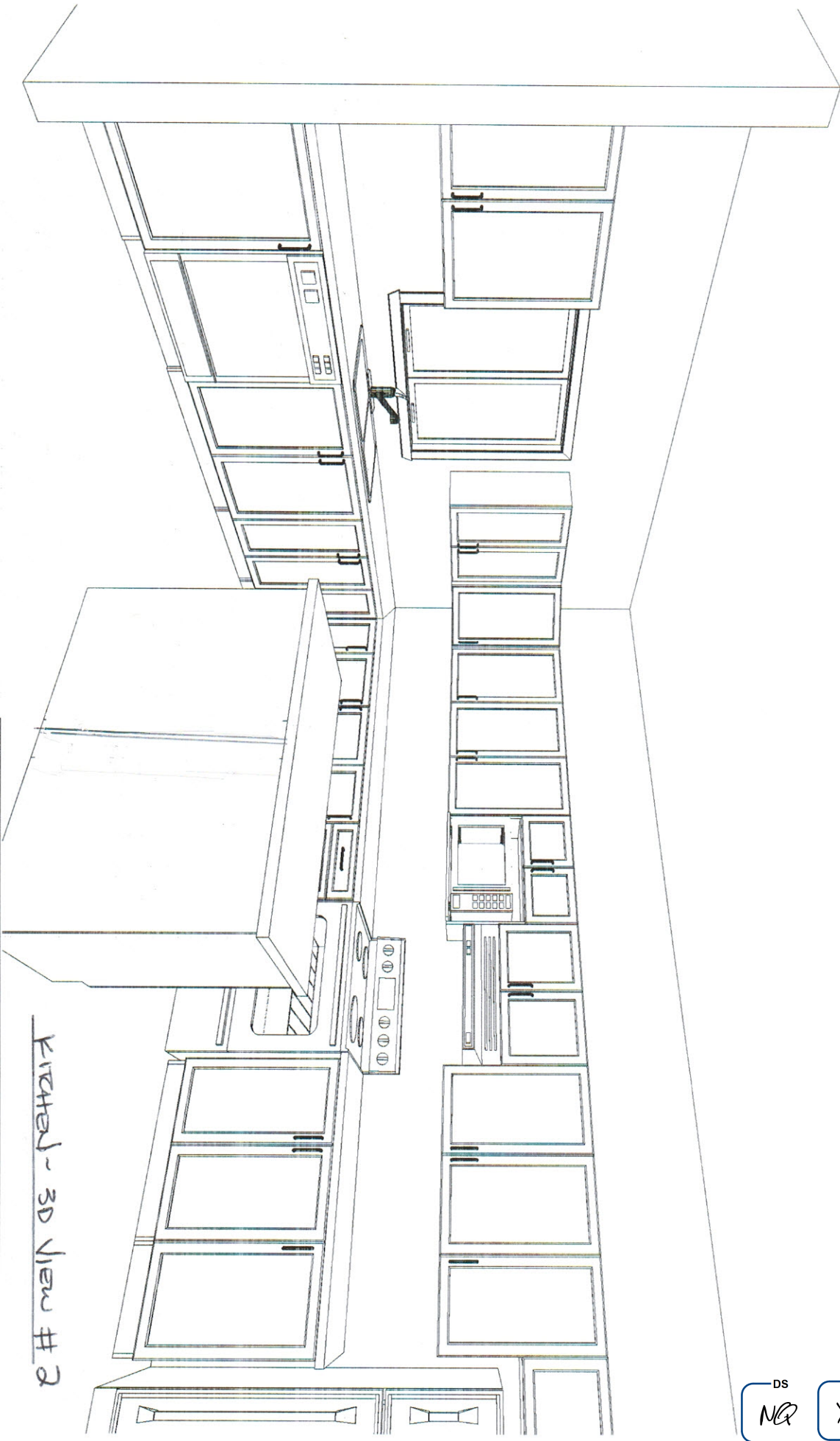

Kitchen - 3D View #2

Note: This drawing is an artistic interpretation of the general appearance of the design. It is not meant to be an exact rendition.

DRAWN BY: LORI DISAVERIO, B.I.D.
509 Annapolis Kit



Designed: 3/29/2013
Printed: 6/14/2013

All

Drawing #: 1

DS
NR

DS
XQ

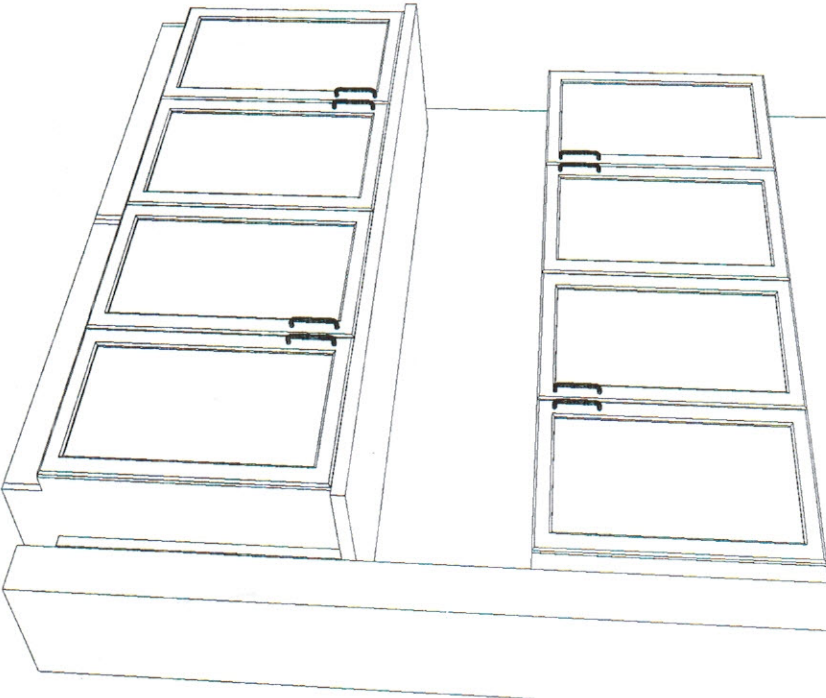
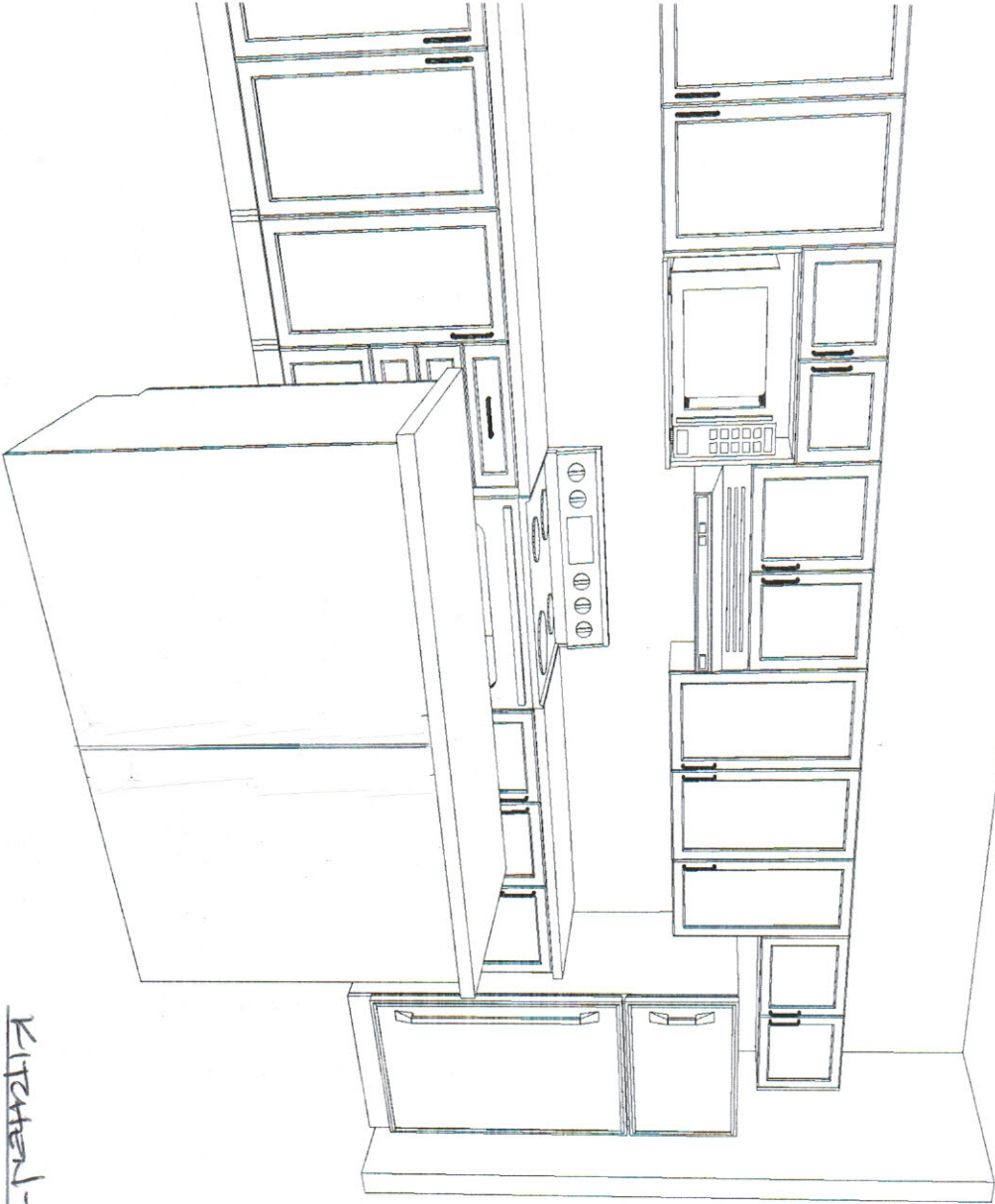

Kitchen - 3D View #3

Note: This drawing is an artistic interpretation of the general appearance of the design. It is not meant to be an exact rendition.

DRAWN BY: LORI DISAVERIO, B.I.D.
509 Annapolis Kit



Designed: 3/29/2013
Printed: 6/14/2013

All

Drawing #: 1

DS
NR

DS
XLR

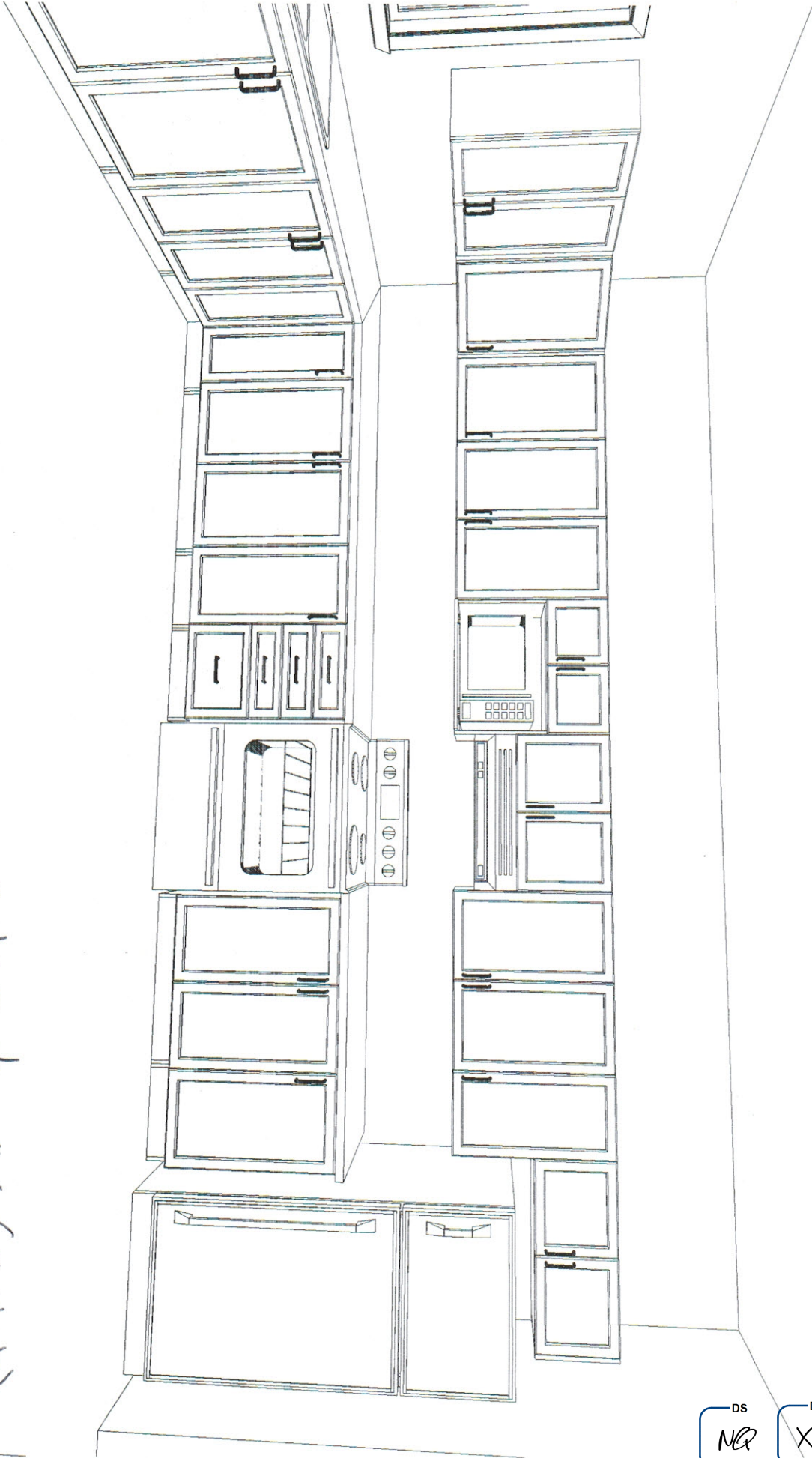

Kitchen - 3D View #4 (w/o island)

Note: This drawing is an artistic interpretation of the general appearance of the design. It is not meant to be an exact rendition.

DRAWN BY: LORI DISAVERIO, B.I.D.
509 Annapolis Kit



Designed: 3/29/2013
Printed: 6/14/2013



All

Drawing #: 1

DS
NR

DS
XQ