



SC300/SCB300

Alito Collection | Wall Mount

Strong and sturdy with attractive lines and an imposing frame, the SC(B)300 is fitted with a time-delay OFF feature up to nine minutes, a 300 CFM fan, bright LED lights and a digital three-speed push button control panel.

[Where To Buy !\[\]\(003082e50e3009141f59bd5df831749f_img.jpg\)](#)[Features](#)[Green Features](#)[Specifications](#)[Options](#)[Parts](#)

Air Flow Volume:	300 CFM
Electrical Connection:	120V/60Hz
Power Consumption:	200 Watts
Current:	1.8 Amps
Fan Speed:	1350 RPM
Fan Type:	Centrifugal Blower
Finishes:	Stainless Steel
Ducting:	6" Round
Dimensions:	Width: 24" / 30" / 36" Height: 46" Depth: 18"
Noise Level	Min. 2 Sones Max. 4 Sones

RF23A9771SR

SAMSUNG

22.5 cu. ft. Smart Counter Depth 4-Door Flex™
Refrigerator featuring Family Hub™ with Beverage Center
and Dual Ice Maker

PWY2- 311- Fridge- Main House



6 Simple Truths

What's for dinner?

Food recognition lets you know what's inside your fridge, quickly plan weekly meals, search for recipes, shop for missing ingredients and preheat your oven, all from the Family Hub™.

I love entertaining friends and family.

Stream your favorite music apps on the Family Hub™ through a premium speaker.

I don't want to miss my favorite show.

Mirror shows, movies, or live sports from your Samsung TV or smartphone on the Family Hub™.

I love getting more done.

Get a notification on the Family Hub™ when the laundry is done.

I want to manage my life with ease.

See who's at the front door, monitor multiple rooms and adjust the thermostat, all from the Family Hub™.

It's the little moments that matter.

Upload pictures or videos remotely, leave handwritten notes and set calendar reminders, all on your Family Hub™.

Available Colors



Fingerprint Resistant
Stainless Steel (shown)



Fingerprint Resistant
Black Stainless Steel

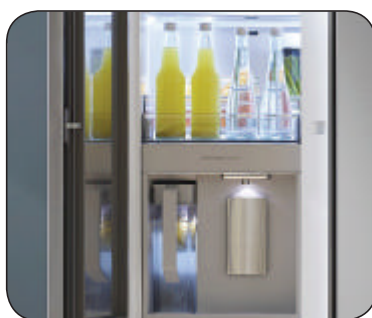

Beverage Center



Dual Ice Maker with Ice Bites

Design

- Beverage Center
- Modern Design
- Built-in Look

Technology

- Family Hub™
- Dual Ice Maker with Ice Bites and Cubed Ice
- UV Deodorizing Filter

Performance

- FlexZone™
- Flex Crisper
- Triple Cooling

Rating



ENERGY STAR® rated:
631 kWh/yr



ADA Compliant

RF23A9771SR

SAMSUNG

PWY2- 311- Fridge- Main House

22.5 cu. ft. Smart Counter Depth 4-Door Flex™ Refrigerator featuring Family Hub™ with Beverage Center and Dual Ice Maker

Installation Specifications

1. Measure the height, width and depth of the opening, making sure to include baseboards, molding tile, countertop overhang, etc. Check to be sure there is enough room to open the door (consider walls, islands or other obstacles when measuring).
2. Refer to illustration below to determine dimensions.
3. Allow 2.5" of clearance on hinge side of refrigerator when installing next to a wall where handle may make contact.
4. Allow 1" minimum clearance at rear for proper air circulation and water/electrical connections. Allow a 3/8" minimum clearance at sides and top for ease of installation.
5. Ensure each door and entryway in the home is wide enough for the refrigerator to be moved through easily.

For optimal usage and ability to open refrigerator doors completely, do not install next to a wall.

Please note: The following dimension and cutout information is for planning purposes only. For complete installation details, consult manual packed with product or download manual online at samsung.com.

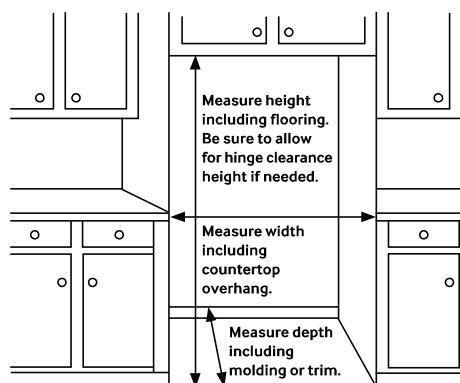

Dimensions

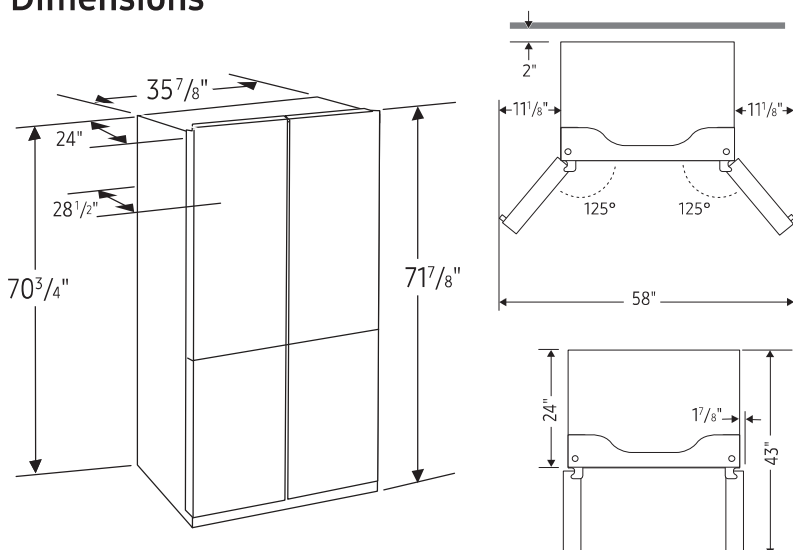

Total Capacity: 22.5 cu. ft.

Refrigerator: 13.7 cu. ft.

- 4 Tempered Glass Spill-Proof Shelves
- 2 Clear Drawers: Flex Crisper and Crisper+
- 6 Door Bins
Right: 1 Gallon Bin, 2 Regular Bins
Left: 1 Gallon Bin, 2 Regular Bins
- LED Lighting

Freezer: 8.8 cu. ft.

- Dual Ice Maker in Freezer (Ice Bites or Cubed Ice)
2 Ice Buckets with Cover and 1 Scoop
- 3 Slide-Out Shelves
- 6 Door Bins
- LED Lighting

Accessories

Water Filter: HAF-QIN

Warranty

One (1) Year Parts and Labor on Refrigerator
Five (5) Years Parts and Labor on Sealed Refrigeration System Only*
Ten (10) Years Parts and Five (5) Years Labor on Digital Inverter Compressor

*Compressor, evaporator, condenser, drier and connecting tubing.

Product Dimensions & Weight

Dimensions (WxHxD with hinges and doors):

35 7/8" x 71 7/8" x 28 1/2"

Dimensions (WxHxD without hinges and doors):

35 7/8" x 70 3/4" x 24"

Weight: 337.3 lbs

Shipping Dimensions & Weight (WxHxD)

Dimensions: 38 1/4" x 77 5/8" x 30 3/5"

Weight: 359.3 lbs

Color

Fingerprint Resistant
Stainless Steel

Fingerprint Resistant
Black Stainless Steel

Model

RF23A9771SR

RF23A9771SG

UPC Code

887276525792

887276524818

NE63T8951SS

SAMSUNG

Samsung Smart Flex Duo™ Front Control Slide-in Induction Range with Smart Dial & Air Fry

PWY2- 311- Range- Main House

6.3 cu. ft. Capacity



Signature Features

Smart Dial

- The new Smart Dial simplifies oven settings in a single dial and intuitively learns based on your cooking preferences.

Air Fry

- Cooking with a crunch just got healthier with Air Fry.* Using little to no oil, you can quickly prepare favorite fried foods right in your oven. No preheating required.

*As compared to deep frying. Air fry tray included with purchase.

Flex Duo™

- The Flex Duo™ range is for the ultimate multi-tasker who wants to be efficient in the kitchen. Use the full oven, or split it into two separate smaller ovens to suit your needs.

Available Colors



Fingerprint Resistant
Stainless Steel (shown)



Fingerprint Resistant
Black Stainless Steel



Smart Dial



Air Fry

Features

- Smart Dial
- Air Fry, Tray Included
- Flex Duo™
- Convection
- Illuminated Knobs
- Fingerprint Resistant Finish
- Virtual Flame™
- Large Oven Capacity – 6.3 cu. ft.
- Ready2Fit™ Guarantee
- Temperature Probe
- Gliding Rack
- Soft Close Door
- Storage Drawer

- Flexible Cooktop:
 - Four Burner Cooktop
 - 11" 2400 W, Boost 4200 W, Virtual Flame™
 - 7" 1800 W, Boost 2300 W (2)
 - 6" 1200 W, Boost 2000 W

Convenience

- Wi-Fi Connectivity
- Voice-Enabled
- Convection Auto Conversion
- Self & Steam Clean
- Hidden Bake Element
- Child Safety Lock
- Delay Start
- Auto Oven Light
- Kitchen Timer
- Sabbath Mode



NE63T8951SS

SAMSUNG

Samsung Smart Flex Duo™ Front Control Slide-in Induction Range with Smart Dial & Air Fry

PWY2- 311- Range- Main House

6.3 cu. ft. Capacity

Installation Specifications

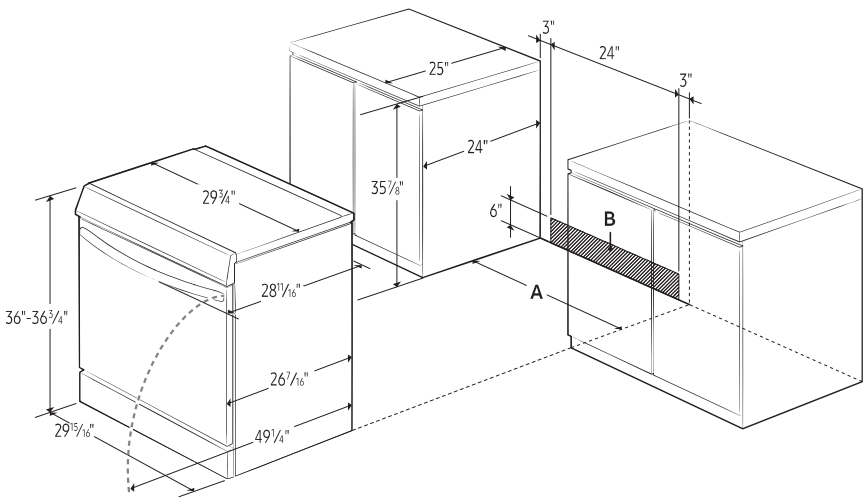

A: Cabinet opening min 30"
B: Acceptable electrical outlet area

IMPORTANT: If your cabinets are over 36 3/4" high, you must install this range on a hard, heat-resistant support that raises the surface of the range so that it is about even with the countertop.

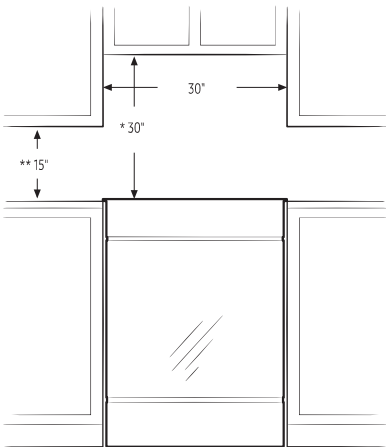

* 30" minimum clearance between the top of the cooking surface and the bottom of an unprotected wood or metal cabinet; or 24" minimum when the bottom of the wood or metal cabinet is protected by not less than 1/4" of flame retardant millboard covered with not less than no.28 MSG sheet steel, 0.015" stainless steel, 0.024" aluminum, or 0.020" copper.

**15" minimum between the countertop and the adjacent cabinet bottom.

IMPORTANT: Consult with Installation Manual for detailed instructions before installing. All ranges must be installed with the Anti-Tip device that is included.

Power Source

240V/208V/60 Hz/40A

Induction Cooktop

- Right Front: 11" 2400 W, Boost 4200 W, Virtual Flame™
- Left Front: 7" 1800 W, Boost 2300 W
- Right Rear: 7" 1800 W, Boost 2300 W
- Left Rear: 6" 1200 W, Boost 2000 W

Dual Oven

- Upper Capacity: 3.4 cu. ft.
- Lower Capacity: 2.7 cu. ft.
- Convection Element/Heater
- Convection Bake
- Convection Roast
- Bake
- Variable Broil: Low/High
- Air Fry
- Bread Proof
- Dehydrate

Warranty

One (1) Year Parts and Labor

Product Dimensions & Weight (WxHxD)

Oven Interior Dimensions:

24 13/16" x 22 7/16" x 19 3/4"

Outside Net Dimensions:

29 15/16" x 36-36 3/4" (Adjustable) x 28 11/16"

Weight: 216 lbs

Shipping Dimensions & Weight (WxHxD)

Dimensions:

33 1/16" x 41 3/4" x 30 5/16"

Weight: 239 lbs

Color

Fingerprint Resistant
Stainless Steel

Model

NE63T8951SS

UPC Code

887276415086

Fingerprint Resistant

Black Stainless Steel

NE63T8951SG

887276415062



DW80R5061

SAMSUNG

Samsung StormWash™ 48 dBA Dishwasher

PWY2- 311- Dishwasher- Main House



Signature Features

StormWash™

- Powerful rotating spray jets that clean at every angle for tough to reach spots.

Quiet Cleaning

- Silent washes for a quieter kitchen at 48 dBA sound level.

AutoRelease™ Door

- At the end of the cycle, the door automatically opens to circulate air and improve drying performance.

Available Colors



Fingerprint Resistant
Stainless Steel (shown)



Fingerprint Resistant
Black Stainless Steel



Fingerprint Resistant
Tuscan Stainless Steel



StormWash™



AutoRelease™ Door

Features

- 3rd Rack
- Fingerprint Resistant Stainless Finish
- One-Touch Adjustable Racking System
- Digital Touch Control
- Sanitize Cycle
- 6 Wash Cycles
- 6 Options
- Half-Load Cycle
- Express Cycle: 60 Minutes
- Full Stainless Steel Interior
- 15 Place Settings
- 3 Spray Wash Arms (Upper, Middle, Lower)
- ENERGY STAR® rated

Convenience

- Control Lock
- Delay Start
- Digital Leak Sensor

Rating

ENERGY STAR®-rated:
265 kWh/yr

DW80R5061

Samsung StormWash™ 48 dBA Dishwasher

SAMSUNG

PWY2- 311- Dishwasher- Main House

Installation Specifications

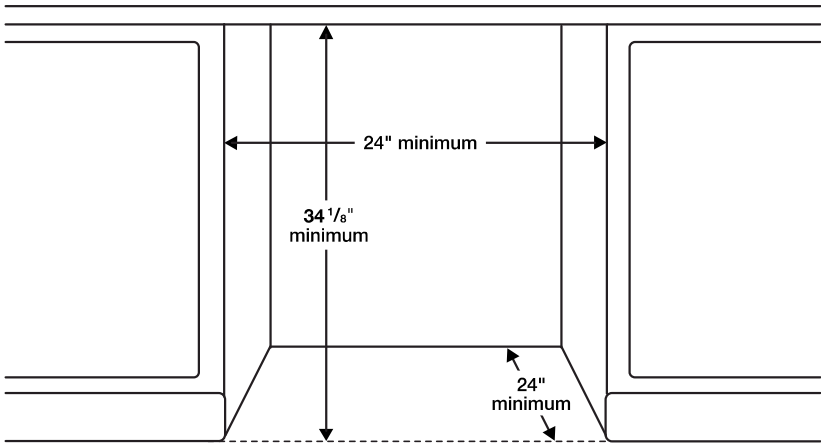

Features

- 6 Wash Cycles: Auto, Normal, Heavy, Delicate, Express 60, Rinse Only
- 6 Options: Half-Load Wash (Lower Rack), StormWash™, Hi-Temp Wash, Sanitize (Anti-bacterial – NSF), Delay Start, Control Lock
- AutoRelease™ Door
- Hidden Heat Element
- Stainless Steel Interior Tub

Convenience

- Control Lock
- Digital Water Leakage Sensor
- 3rd Rack
- One-Touch Adjustable Racking System
- Silverware Basket
- Upper Rack: Foldable Cup Shelves, 2 Adjustable Tines
- Lower Rack: Removable Plate Support

Warranty

One (1) Year All Parts and Labor
Five (5) Year Limited on Printed Circuit Board and Interior Nylon Racks

Dimensions

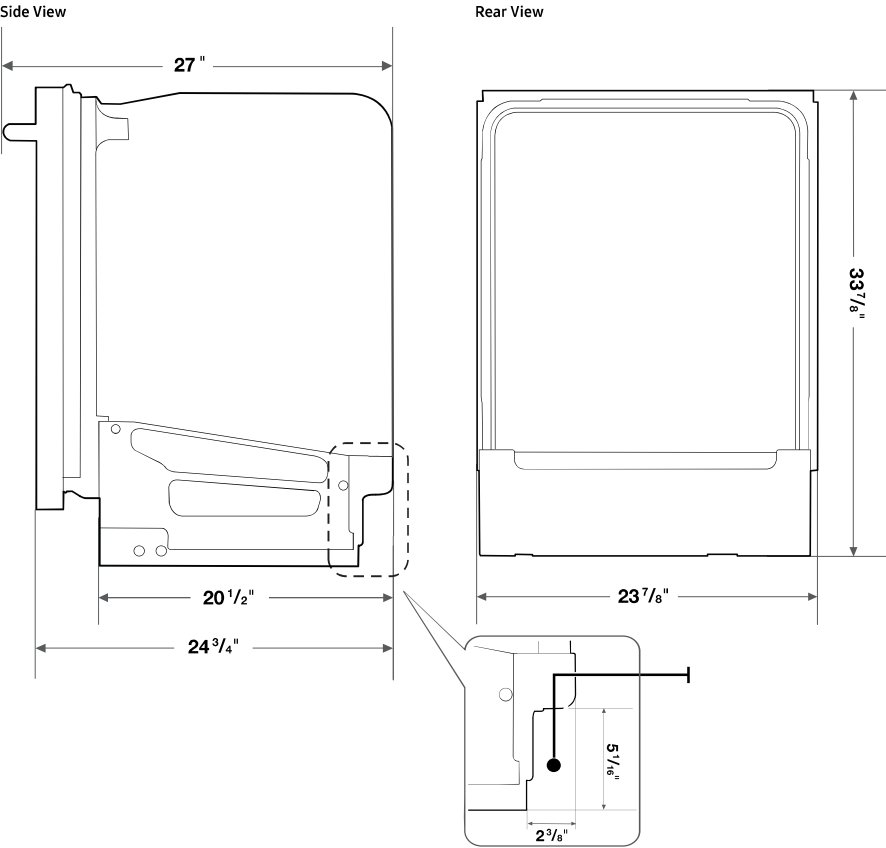

Product Dimensions & Weight (WxHxD)

Dimensions (height is adjustable):

23⁷/₈" x 33⁷/₈" – 35" x 24³/₄"

Weight: 95 lbs

Shipping Dimensions & Weight (WxHxD)

Dimensions:

26" x 35" x 29¹/₂"

Weight: 106 lbs

Color	Model #	UPC Code
Fingerprint Resistant Stainless Steel	DW80R5061US	887276338729
Fingerprint Resistant Black Stainless Steel	DW80R5061UG	887276338712
Fingerprint Resistant Tuscan Stainless Steel	DW80R5061UT	887276338736



Microwave Ovens

Countertop

Microwave Oven NN-ST75LB

PWY2- 311- Microwave- Main House

Capacity		1.6cft
Power Supply		Cyclonic Inverter
Power	Microwave	1200W
Color (Material)	Face of Door/Base	Black
	Cabinet Body	Black
	Dial / Button	-
	Plastic part of Door/Base	Black
Oven Interior	Color (Material)	Paint Grey
Oven Lamp		LED
Door	Door Design	Regular
	Door Open	Push Open
	Screen	Smoke Glass
Display	Type	New 4 Digit+icon
	Color	White
	Back Light	Yes
	Word Prompting	No
Power Level etc.	MW Power Level	11 (P0-P10)
	Cooking Time	99min 99sec
	Kitchen Timer	Yes (99min 99sec)
	Standing Time	Yes (99min 99sec)
	Delay Start	Yes (99min 99sec)
	Clock	12H
	Child Lock	Yes
	Stage Cooking	3 stage

	Turbo Defrost	Yes (0.1-3.0kg)
	Popcorn	Yes (1.5/2.75/3.2oz)
	Keep Warm	Yes in MW power (P0) (up to 30min)
	Steam Clean	No
	Quick Min	Quick 30 (up to 5min)
	Serving/Weight	-
	More/Less	Yes
	Recipe Store	No
	Auto Reheat	Sensor Reheat
	Number of Auto Cook	15
Turntable Size		380mm
Accessory		Glass Tray
Trim Kit		-
Power Consumption	Microwave	1460W
Cooking Power		1200W
Dimensions	Outside (HxWxD)	304 x 555 x 493 mm 11 15/16 x 21 7/8 x 19 7/16 "
	Oven (HxWxD)	210 x 398 x 470 mm 8 1/4 x 15 11/16 x 18 1/2 "
Weight	Net	32.0 lb / 14.3 kg
	Shipping	16.7 kg

Trim Kit Frame Dimensions

PWY2- 311- Microwave Trim Kit-
Main House

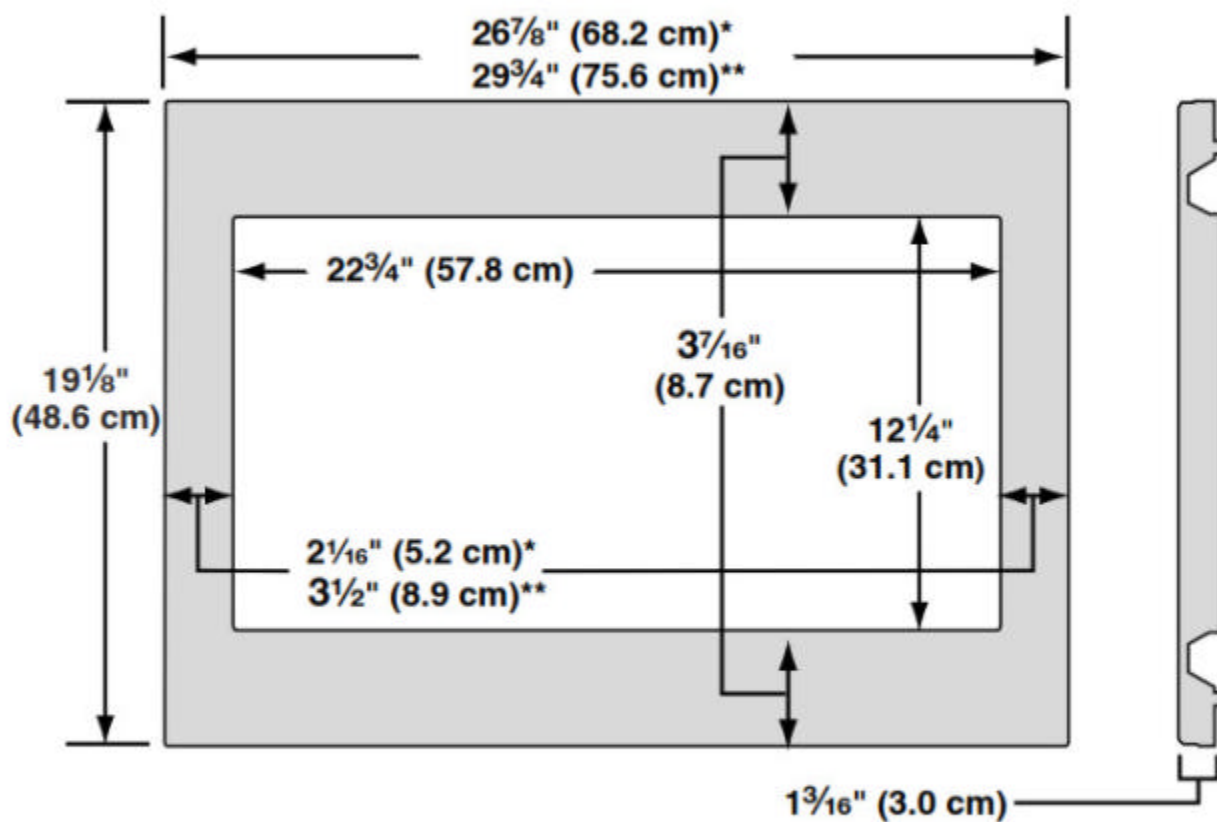

*27" (68.6 cm) trim kit

**30" (76.2 cm) trim kit

د

د



WHIRLPOOL 30" COUNTERTOP MICROWAVE TRIM KIT - MK2160AV

\$ 92.97

SKU: MK2160AV

VSN: MK2160AV

Dimensions

Width: 29.75" (75.6 cm) Height: 19.20" (48.8 cm) Depth: 19.00" (48.3 cm)

Create the custom look you've been longing for with this easy-to-install 30-inch microwave trim kit. Transform your countertop appliance to an elegant built-in addition to your kitchen - you can place your microwave above a standard-sized 30-inch wall oven or in a cabinet on its own. This trim kit offers a streamlined design to instantly enhance the look of your ordinary countertop microwave, and its stainless steel face plate is durable and easy to clean. Please note: all compatible microwaves are sold separately from this kit. Review your user manual to ensure compatibility.

Unique Features

Unique Features

PWY2- 311- Microwave Trim Kit-
Main House

Universal Compatibility:

This is a universal trim kit that is compatible with select 1.6-cubic-foot Maytag, Whirlpool, KitchenAid and Amana brand countertop microwaves. Please see your model's use and care manual to ensure compatibility.

Easy Installation:

All necessary hardware is included for easy installation, giving you the beautiful built-in look you're craving for your microwave.

Sleek Design:

The sleek design of this trim kit and black stainless steel finish keeps your kitchen looking modern – plus, the durable face plate is easy to wipe clean.

Installation Details

Sold Separately	Compatible 30-inch 1.6 Cu. Ft. Countertop Microwave
-----------------	---

General Details

VSN	MK2160AV
UPC/GTIN	883049459042
Finish Colour	Black Stainless Steel
This Product Includes	All hardware needed for standard installation.

Additional Details

Special Tools Required	Measuring tape, pencil, Phillips screwdriver, drill.
Safety Details	See Owner's Guide
Additional Information	This is a universal trim kit that is compatible with select 1.6-cubic-foot Maytag, Whirlpool, KitchenAid and Amana brand countertop microwaves. Please see your model's use and care manual to ensure compatibility.

WF45R6100AP

SAMSUNG

Samsung Front Load Washer with Steam

PWY2- 311- Washer- Main House

4.5 cu. ft. Capacity DOE



Signature Features

Steam

- Powerful stain removal without pretreatment, while still gentle on your clothing.

Self Clean+

- Keeps your washer drum fresh and clean by eliminating 99% of bacteria¹. Will also send a reminder to clean the drum every forty wash cycles.

Smart Care

- Easy troubleshooting from the convenience of your smartphone². Smart Care interacts with your washer and dryer to perform an immediate diagnosis and offer quick solutions.

Available Colors

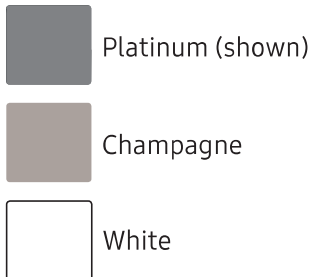

Steam



Self Clean+

Features

- Steam
- Self Clean+
- Smart Care
- VRT Plus™ Technology
- Swirl+ Drum Design
- Closet-Depth Fit³
- Stackability
- Internal Water Heater
- 1200 RPM Maximum Spin Speed
- Direct Drive Motor
- 10 Preset Washing Cycles
- 7 Additional Washing Options
- 5 Temperature Levels
- LED Display: Ice Blue
- 24-Hour Delay End

Convenience

- Child Lock
- Delay End
- Dispenser Trays: Main Wash, Softener, Bleach



ADA Compliant⁴

Rating



ENERGY STAR®-rated
CEE Tier 2
IMEF = 2.92
IWF = 2.9

¹Based on testing by Intertek of the Self Clean+ cycle on the WF6000R.

²Requires Samsung Smart Washer/Dryer App. The Samsung Smart Washer/Dryer app supports Android OS 2.3.6 or later and iOS 3 or later for iPhone models. Smart Washer/Dryer app available in App Store and Play Store.

³Designed to fit a 40" installation depth.

WF45R6100AP

SAMSUNG

Samsung Front Load Washer with Steam

4.5 cu. ft. Capacity DOE

PWY2- 311- Washer- Main House

Installation Specifications

If the washer and dryer are installed together or the dryer alone, the closet front must have two unobstructed air openings for a combined minimum total area of 72-inch² (see stacked build below). Your washer alone does not require a specific air opening.

*Required spacing (External exhaust elbow may require additional space.)

1. Alcove or closet installation

Minimum Clearance for Closet and Alcove Installations:

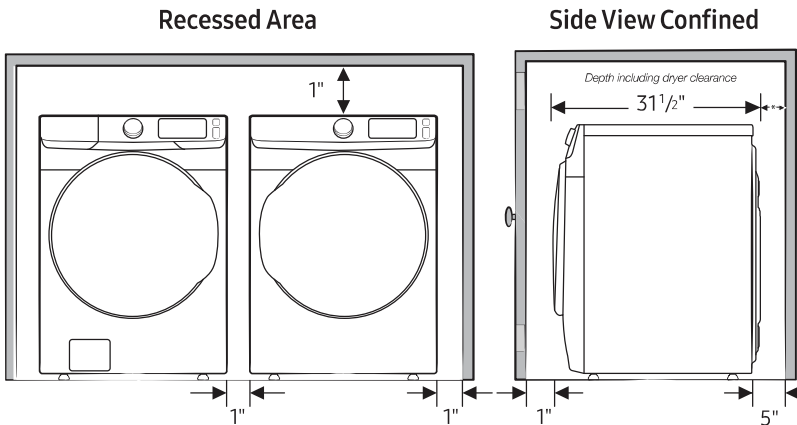

2. With stacked washer and dryer

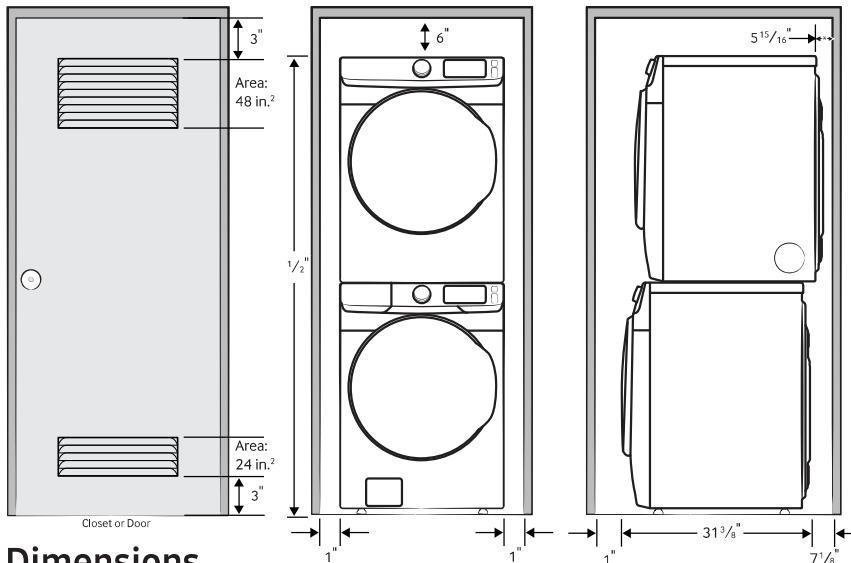

Dimensions

Required Dimensions for Installation with Pedestal:

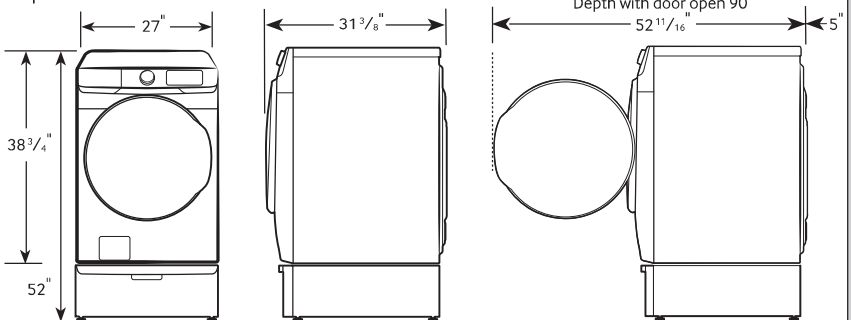

Actual color may vary. Design, specifications, and color availability are subject to change without notice. Non-metric weights and measurements are approximate.

©2019 Samsung Electronics America, Inc., 85 Challenger Road, Ridgefield Park, NJ 07660. Tel: 800-SAMSUNG. samsung.com. Samsung is a registered trademark of Samsung Electronics Co., Ltd.

10 Preset Washing Cycles:

Normal, Heavy Duty, Bedding, Quick Wash, Permanent Press, Delicates, Whites, Sanitize, Rinse and Spin, Self Clean+

7 Additional Washing Options:

Presoak, Steam, Delay End, Alarm Off, Child Lock, Smart Care, Spin Only

5 Temperature Levels:

Hot, Warmer, Warm, Cool, Cold

5 Spin Speeds:

High, Medium High, Medium, Low, No Spin

5 Soil Levels:

Heavy, Medium Heavy, Normal, Medium Low, Light

Dispenser Trays:

Main Wash, Softener, Bleach

Warranty

One (1) Year Parts and Labor

Three (3) Years Stainless Steel Drum (Part Only)

Ten (10) Years Direct Drive Motor (Part Only)

Product Dimensions & Weight (WxHxD)

Dimensions: 27" x 38 3/4" x 31 3/8"

Weight: 201 lbs

Shipping Dimensions & Weight (WxHxD)

Dimensions: 29 3/8" x 42 3/8" x 34 1/8"

Weight: 205 lbs

Color	Model #	UPC Code
Platinum	WF45R6100AP	887276299464
Champagne	WF45R6100AC	887276305295
White	WF45R6100AW	887276299471

Matching Dryer (Electric/Gas)

Platinum	DVE45R6100P	887276300443
Champagne	DVE45R6100C	887276305943
White	DVE45R6100W	887276300450

Platinum	DVG45R6100P	887276300481
Champagne	DVG45R6100C	887276305271
White	DVG45R6100W	887276300498

Pedestal

Platinum	WE402NP	887276310138
Champagne	WE402NC	887276310121
White	WE402NW	887276310152

Accessories

Stacking Kit	SKK-7A	887276146423
--------------	--------	--------------

DVE/G45T6100P

SAMSUNG

Samsung Front Load Electric/Gas Dryer with Steam Sanitize+

7.5 cu. ft. Capacity DOE

PWY2- 311- Dryer- Main House



Signature Features

Steam Sanitize+

- The Steam Sanitize+ cycle removes 99.9% of germs and bacteria, over 95% of pollen, and kills 100% of dust mites¹. Multi-Steam Technology steams away wrinkles, odors, and static.

Sensor Dry

- Automatically optimizes the time and temperature of your drying cycle to protect your clothes from heat damage, while avoiding excess energy use.

Smart Care

- Easy troubleshooting from the convenience of your smartphone². Smart Care interacts with your washer and dryer to perform an immediate diagnosis and offer quick solutions.

Available Colors



Platinum (shown)



Steam Sanitize+



Sensor Dry

Features

- Steam Sanitize+
- Sensor Dry
- Smart Care
- Interior Drum Light
- 10 Preset Drying Cycles
- 9 Additional Drying Options
- 5 Temperature Levels
- 4-Way Venting (Electric)
- 3-Way Venting (Gas)
- Reversible Tinted Door
- LED Display: Ice Blue

Convenience

- Child Lock
- Lint Filter Indicator

Rating



ENERGY STAR®-rated
608 kwh/yr

¹Based on internal testing and independently verified by Intertek. Individual results may vary.

²Requires Samsung Smart Washer/Dryer App. The Samsung Smart Washer/Dryer app supports Android OS 2.3.6 or later and iOS 3 or later for iPhone models. Smart Washer/Dryer app available in App Store and Play Store.

DVE/G45T6100P

SAMSUNG

Samsung Front Load Electric/Gas Dryer with Steam Sanitize+

7.5 cu. ft. Capacity DOE

PWY2- 311- Dryer- Main House

Installation Specifications

If the washer and dryer are installed together or the dryer alone, the closet front must have two unobstructed air openings for a combined minimum total area of 72-inch² (see stacked build below). Your washer alone does not require a specific air opening.

*Required spacing (External exhaust elbow may require additional space.)

1. Alcove or closet installation

Minimum Clearance for Closet and Alcove Installations:

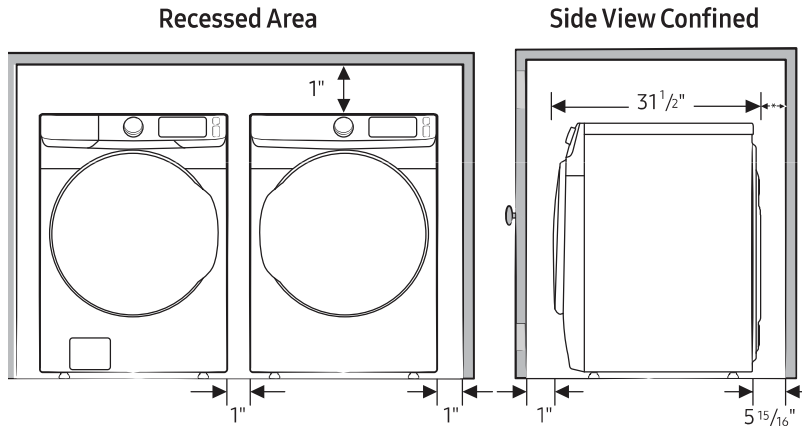

2. With stacked washer and dryer

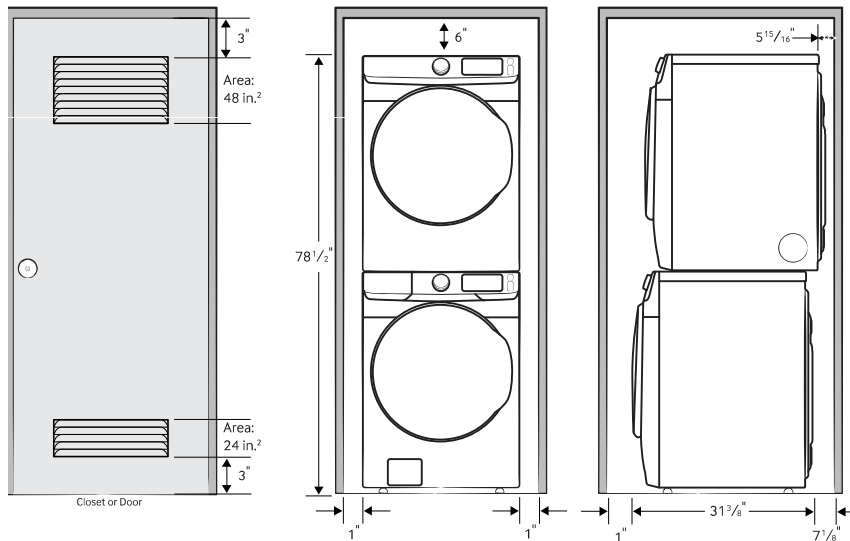

Dimensions

Required Dimensions for Installation with Pedestal:

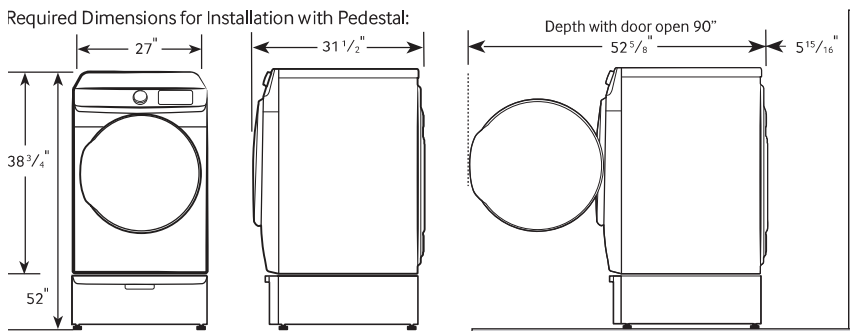

Actual color may vary. Design, specifications, and color availability are subject to change without notice. Non-metric weights and measurements are approximate.

© 2020 Samsung Electronics Canada Inc. All rights reserved. Samsung is a registered trademark of Samsung Electronics Co., Ltd., used with permission.

4-Way Venting (Electric)

3-Way Venting (Gas)

10 Preset Drying Cycles:

Refresh, Steam Sanitize+, Normal, Heavy Duty, Permanent Press, Bedding, Delicates, Time Dry, Air Fluff, Quick Dry

9 Additional Drying Options:

Damp Alert, Wrinkle Prevent, Adjust Time (Up), Adjust Time (Down), Eco Dry, Child Lock, Smart Care, Alarm Off, Drum Light

5 Temperature Levels:

High, Medium High, Medium, Medium Low, Low

5 Dry Levels:

More Dry, Normal-More Dry, Normal Dry, Normal-Less Dry, Less Dry

Warranty

One (1) Year Parts and Labor

Product Dimensions & Weight (WxHxD)

Dimensions: 27" x 38 3/4" x 31 1/2"

Weight: 123 lbs

Shipping Dimensions & Weight (WxHxD)

Dimensions: 29 3/8" x 42 9/16" x 33 1/2"

Weight: 130 lbs

Colour

Platinum

Model

DVE45T6100P

UPC Code

887276390369

Platinum

DVG45T6100P

887276390390

Matching Washer

Platinum

WF45R6100AP

887276299464

Pedestal

Platinum

WE402NP

887276310138

Accessories

Stacking Kit

SKK-8K

887276344034