



DCR/PHOENIX GROUP OF COMPANIES

INTERIOR COLOUR SCHEME

Purchaser:MAHBUB RABBANI CHOWDHURY

Project: The Junction - 1

Telephone Res. / Bus: /

Lot: 187 - 1313 Silhouette Priv

Decor Advisor:Kayleigh Chipman

Model and Elevation: The Luna

Layout Changes:☐ Yes ☐ No

Sketch Attached:☐ Yes ☐ No

1. Cabinetry	Style and Colour	Counter	Hardware
Kitchen / Breakfast	LN 1 - COMO - GRIGIO - MELAMINE	LAMINATE: 5C09-60	HU60
Laundry Room			
Powder Room			
Main Bathroom	LN 1 - COMO 5/8 - WILLOW GREY	LAMINATE: 5C09-60	HU60
Ensuite Bathroom	LN 1 - COMO - BIANCO - MELAMINE	LAMINATE: 5C03-38	HU60

Cabinet Valence

☐ Yes ☒ No

Hood Fan

STD OTR

Valence Electrical

☐ Yes ☒ No

Appliances

Built in Cooktop

Built in Oven

Slide In Stove

Gas Stove

Micro-Hood

☐ Yes ☒ No

☐ Yes ☒ No

☐ Yes ☒ No

☐ Yes ☒ No

☒ Yes ☐ No

Fridge Standard

☐ Yes ☐ No

Opening Standard

☒ Yes ☐ No

Comment

2. Flooring

Selection

Foyer

EURO - STD - 13X13 - PASHA PERCEPT - ICE (GROUT: PEWTER) - STACKED

Main Hall

WESTBORO - 36OZ STD CARPET - OVERCAST

Kitchen / Breakfast

EURO - STD - 13X13 - PASHA PERCEPT - ICE (GROUT: PEWTER) - STACKED

Laundry Room

EURO - STD - 13X13 - PASHA PERCEPT - ICE (GROUT: PEWTER) - STACKED

Powder Room

Main Bathroom

CERATEC- STD - 13X13 - BURLINGSTONE - LIGHT GREY (GROUT: TIMBERWOLF) - STACKED

Master Ensuite Bathroom

CERATEC - STD - 13X13 - CAPRI - WHITE (GROUT: FROST) - STACKED

Finished Basement

Other Room - Specify

Living Room

WESTBORO - 36OZ STD CARPET - OVERCAST

Dining Room

WESTBORO - 36OZ STD CARPET - OVERCAST

Family Room

Den / Library / Study

Basement Stairs

Stairs

Upper Hall

Master Bedroom

WESTBORO - 36OZ STD CARPET - OVERCAST

Bedroom #2

WESTBORO - 36OZ STD CARPET - OVERCAST

Bedroom #3

Bedroom #4

Bedroom #5

Upgrade Underpad

Type: STD 7LB - 9MM

Area: THROUGHOUT

Comment

Initials

DS

MRC



DCR/PHOENIX GROUP OF COMPANIES

INTERIOR COLOUR SCHEME

Purchaser:

Telephone Res. / Bus: /

Decor Advisor: Kayleigh Chipman

Project: The Junction - 1

Lot: 167 - 1313 Silhouette Priv

Model and Elevation: The Luna

3. Railings and Spindles

Railing Package

Railing Colour

Wood Stairs ☐ No ☐ Oak ☐ Maple

Spindle Colour

Tread Colour

Comment

4. Plumbing Fixtures

Main Bathroom	STD	Other Room - Specify		Powder Room
Master Ensuite Bathroom	STD	KITCHEN	STD	Other Washroom

5. Wall Tile

Selection

Main Bathroom CERATEC - STD - 8X10 - BURLINGSTONE - LIGHT GREY (GROUT: PEWTER) STACKED VERTICAL

Listello

Master Ensuite

Tub Deck

Tub Walls

Tub Listello

Shower Walls CERATEC - STD - 8X10 - CAPRI - WHITE (GROUT: FROST) - STACKED VERTICAL

Shower Floor

Shower Listello

Ensuite #2 / Other

Listello

Kitchen Backsplash NO BACKSPLASH INCLUDED

Comment

DS
MRL



DCR/PHOENIX GROUP OF COMPANIES

INTERIOR COLOUR SCHEME

Purchaser:
Telephone Res. / Bus: /
Decor Advisor: Kayleigh Chipman

Project: The Junction - 1
Lot: 167 - 1313 Silhouette Priv

Model and Elevation: The Luna

6. Fireplace

Living Room

Purchased As Per Plan N/A
○ ○ ○

Family Room

Purchased As Per Plan N/A
○ ○ ○

Purchased As Per Plan N/A
○ ○ ○

Fireplace Type
Mantle Type
Colour / Stain
Surround
Hearth
Insert
Comment

7. Trim Carpentry

Interior Doors STD 2-PANEL CARERA
Interior Trim STD CT#10
Comment

Door Handles STD LEVER

8. Paint
STD COLOUR - WHITE

9. Additional Comments

DS
MRC

10. Disclaimers and Notes

- 1) Colours of all materials are as close as possible to builder's selection, but not necessarily identical due to variances in manufacturing.
- 2) Any extras listed above are null and void unless accompanied by a separate invoice/amendment. Said invoice must be paid in full.
- 3) The Purchaser acknowledges that after Interior Colour Selection form is signed and dated, no further changes will be permitted
- 4) The Purchaser acknowledges reading and accepting the "Phoenix Homes Decor Centre Disclaimers" form. This document contains other miscellaneous disclaimers.

This Interior Colour Selection is not final until signed by the Vendor. This form is final and approved by:

Signature: Lisa Filler Date: 8/3/2023 | 11:22 AM EDT

Design Consultant: Kayleigh Chipman Date: 8/2/2023 | 1:56 P

Revised: Jan 2023

DCR PHOENIX HOMES
TERRA FLATS

MODEL - TYPE A (LOWER FLOOR)

KITCHEN / VANITIES

MOUNTING HEIGHT - 84

LINE 1

HARDWARE - U1

STANDARD WHITE INTERIOR

METAL DRAWER BOX

3 PCS - 5/8" KICK - FIN. BOTH ENDS

2 PCS - 90 DEG. CORNER MOULD

1 PCS - T-MOULDING

4 PCS - FLAT MOULDING

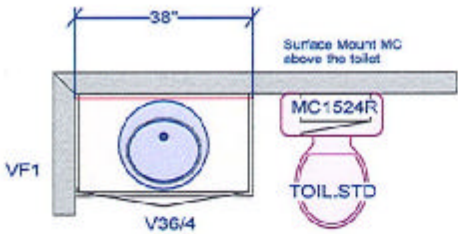
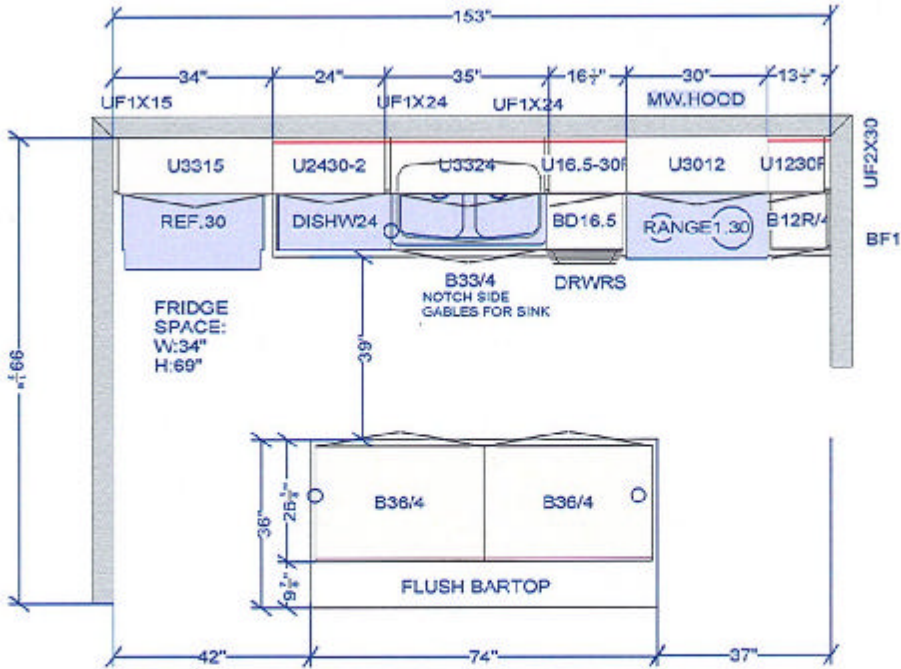

MAIN BATH

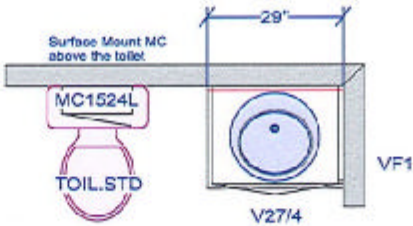

ENSUITE

<p>CUSTOMER APPROVAL</p> <p>I have reviewed these drawings and understand the details of the design and the current contract specifications.</p> <p>Signature _____</p> <p>Date _____</p>	<p>All dimensions, size designations given are subject to verification on job site and adjustment to fit job conditions.</p>	<p>This is an original design and must not be released or copied unless applicable fee has been paid or job order placed.</p>	<p>Designed: 1/3/2023 Printed: 1/5/2023</p>
	<p>Terra Flats TYPE A - 2023</p>	<p>All</p>	<p>Drawing #: 1 No Scale.</p>

DS
MRC