

MARKETING - BUILDING #10 - UNIT 157

CIVIC & CONSTRUCTION ADDRESS - 1015

DocuSign Envelope ID: 94083332-3500-472A-A77E-B83DA982E10F

DCR PHOENIX HOMES

NUVO - BACK TO BACK
STACKED TERRACE HOMES

LOWER UNIT

REVISION: JANUARY 17, 2023

- CABINETS - CARTIER LINE 1
- HARDWARE - STD & 1ST UPGRADE
- STD HINGES
- STD METAL DRWRS
- 5 PCS - 5/8" KICK
- 6 PCS - FLAT SHOE MOULDING

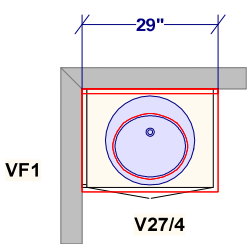
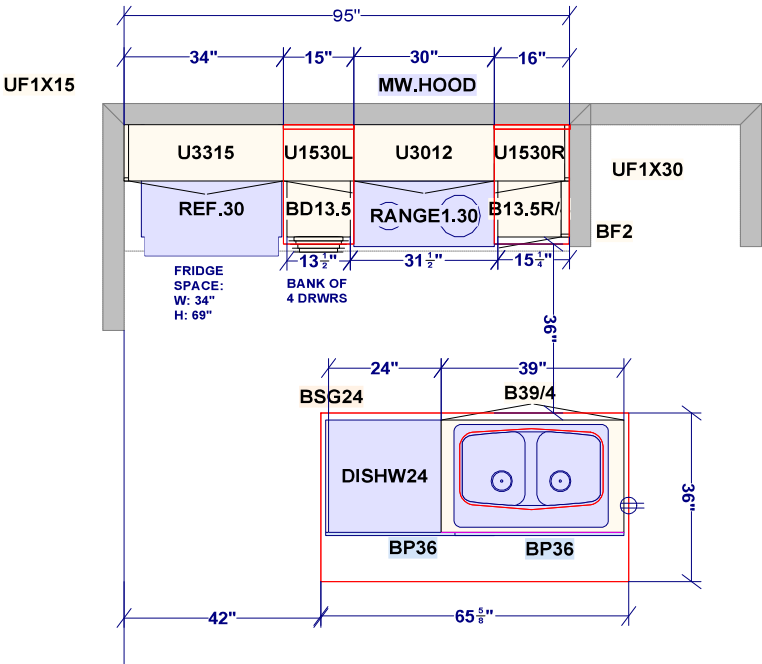

POWDER ROOM

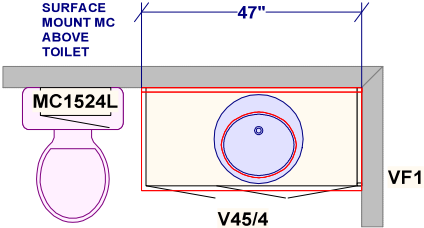

MAIN BATH

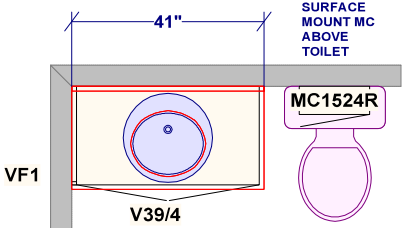

ENSUITE

CUSTOMER APPROVAL

I have reviewed these drawings and understand the details of the design and the Cartier Kitchens specifications

Signature _____

Date _____

All dimensions _size designations given are subject to verification on job site and adjustment to fit job conditions.



This is an original design and must not be released or copied unless applicable fee has been paid or job order placed.

Designed: 1/17/2023
Printed: 1/17/2023

DS
[Signature]

MARKETING - BUILDING #10 - UNIT 157
CIVIC & CONSTRUCTION ADDRESS - 1015

