

MARKETING - BUILDING #10 - UNIT 259  
CIVIC & CONSTRUCTION ADDRESS - 1005

DocuSign Envelope ID: 47EE982B-3C80-4B52-B1DC-869B40B6CE6E

JUNCTION BUILDING #10 UNIT 259

NUVO - BACK TO BACK  
STACKED TERRACE HOMES

UPPER UNIT

REVISED: JANUARY 17, 2023

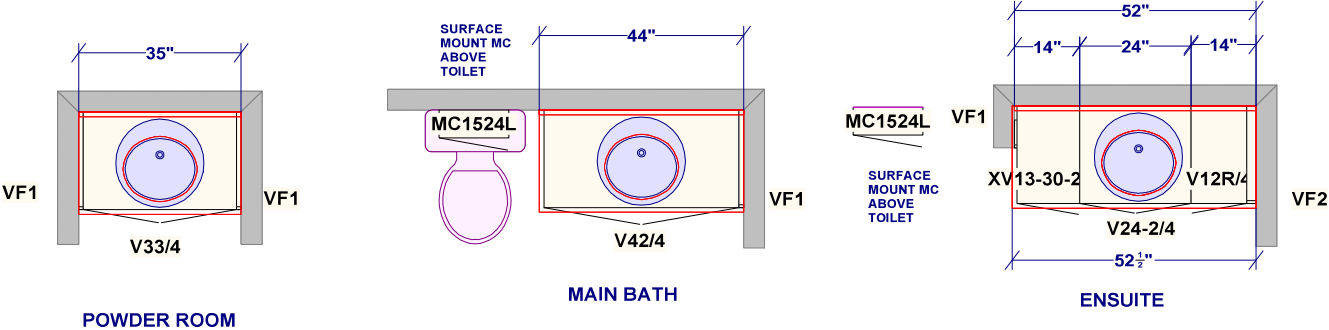
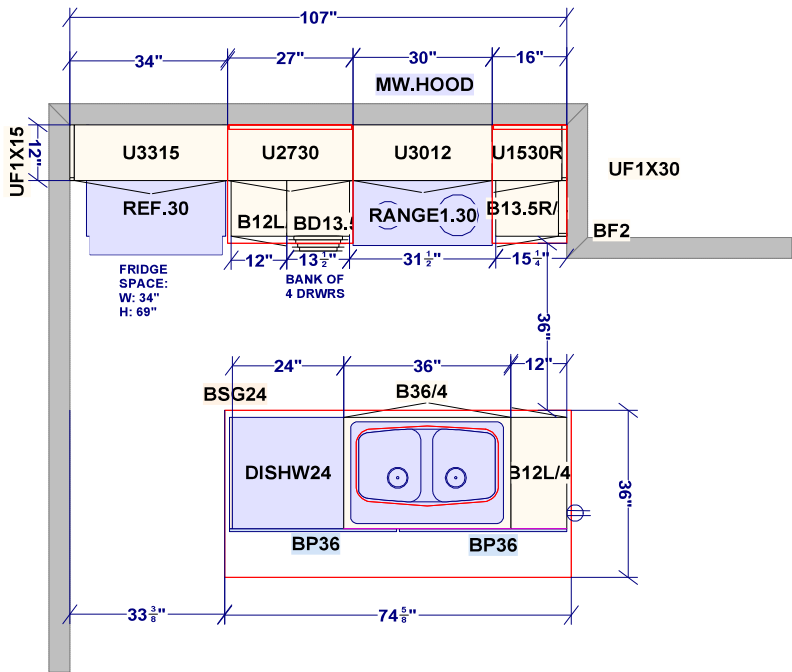

DS  
MN

**CUSTOMER APPROVAL**

I have reviewed these drawings and understand the details of the design and the Cartier Kitchens specifications

Signature \_\_\_\_\_

Date \_\_\_\_\_

All dimensions \_size designations given are subject to verification on job site and adjustment to fit job conditions.



This is an original design and must not be released or copied unless applicable fee has been paid or job order placed.

Designed: 1/17/2023  
Printed: 1/17/2023

MARKETING - BUILDING #10 - UNIT 259  
CIVIC & CONSTRUCTION ADDRESS - 1005

DocuSign Envelope ID: 47EE982B-3C80-4B52-B1DC-869B40B6CE6E

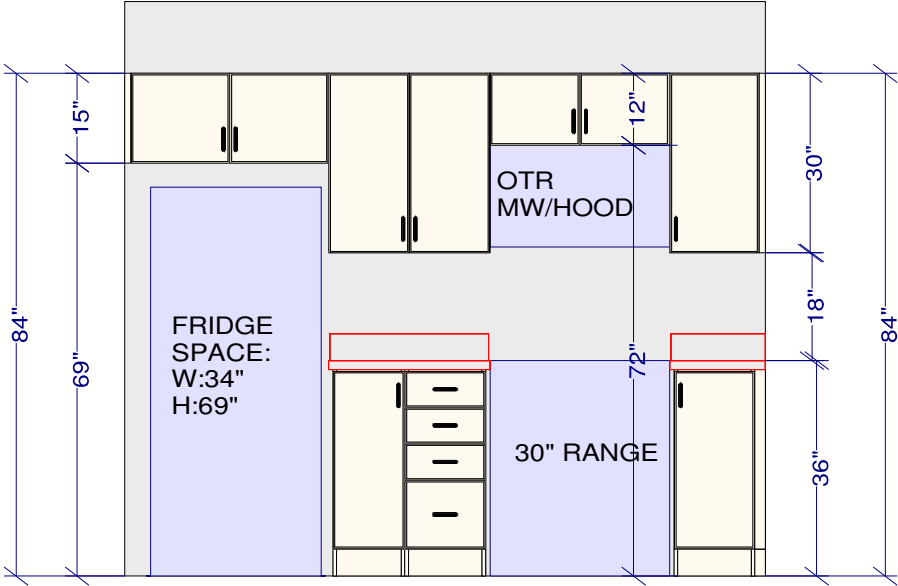

UPPER UNIT

FRIDGE/ RANGE WALL ELEVATION

BS  
MN

CUSTOMER APPROVAL

I have reviewed these drawings and understand the details of the design and the Cartier Kitchens specifications

Signature \_\_\_\_\_

Date \_\_\_\_\_

All dimensions ,size designations given are subject to verification on job site and adjustment to fit job conditions.



This is an original design and must not be released or copied unless applicable fee has been paid or job order placed.

Designed: 2022-06-23  
Printed: 2022-06-23