

MARKETING - BUILDING #10 - UNIT 263
CIVIC & CONSTRUCTION ADDRESS - 1021

DocuSign Envelope ID: FEA83E6F-0680-403D-AFC3-E9155A289765

NUVO - BACK TO BACK STACKED TERRACE HOMES

UPPER UNIT

REVISED: JANUARY 17, 2023

CABINETS - CARTIER LINE 1

HARDWARE - STD & 1ST UPGRADE

STD HINGES

STD METAL DRWRS

5 PCS - 5/8" KICK

6 PCS - FLAT SHOE MOULDING

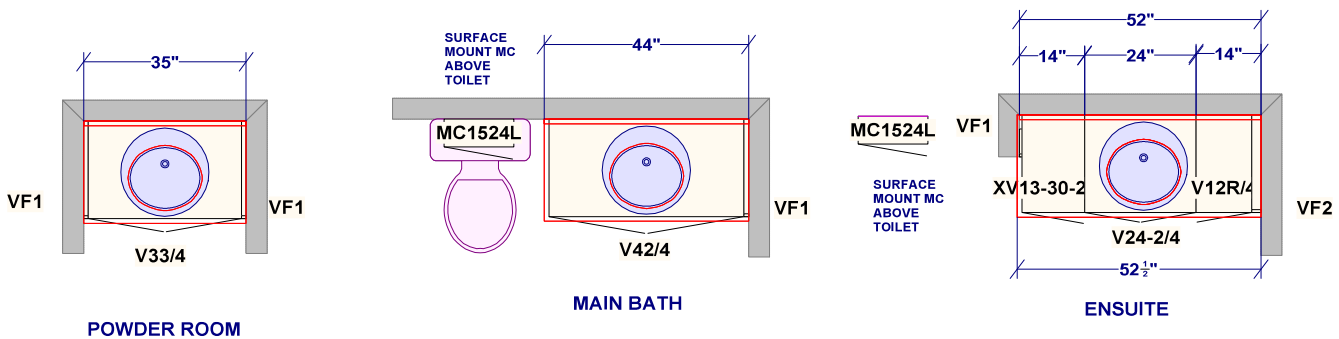
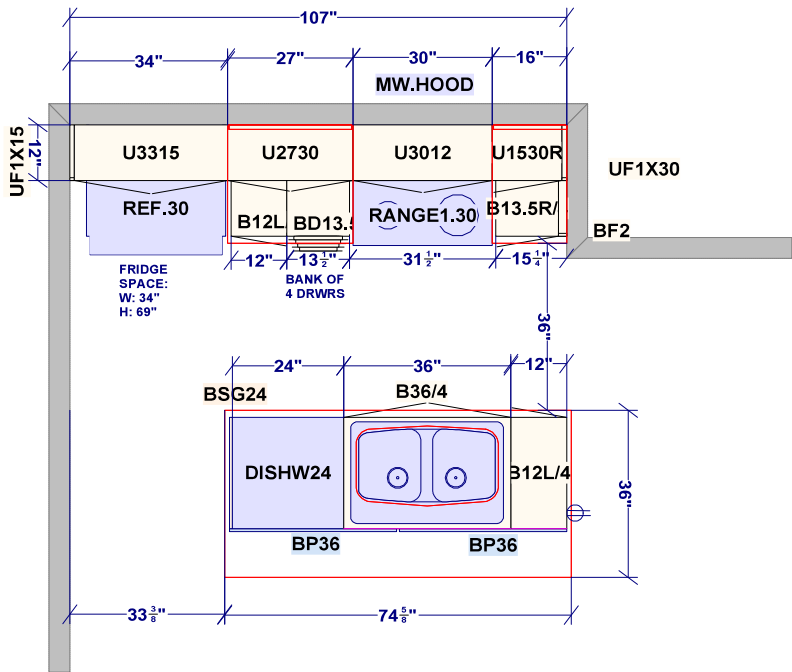

| | | | | | |
|---|--|---|---|---|-----------|
| <p align="center"><u>CUSTOMER APPROVAL</u></p> <p>I have reviewed these drawings and understand the details of the design and the Cartier Kitchens specifications</p> <p>Signature _____</p> <p>Date _____</p> | <p>All dimensions _size designations given are subject to verification on job site and adjustment to fit job conditions.</p> |  | <p>This is an original design and must not be released or copied unless applicable fee has been paid or job order placed.</p> | <p>Designed: 1/17/2023 Printed: 1/17/2023</p> | |
| | | | |  | |
| DCR - NUVO - BACK TO BACK STACKED TERRACE HOMES - UPPER UNIT | | | All | Drawing #: 1 | No Scale. |

MARKETING - BUILDING #10 - UNIT 263
CIVIC & CONSTRUCTION ADDRESS - 1021

DocuSign Envelope ID: FEA83E6F-0680-403D-AFC3-E9155A289765

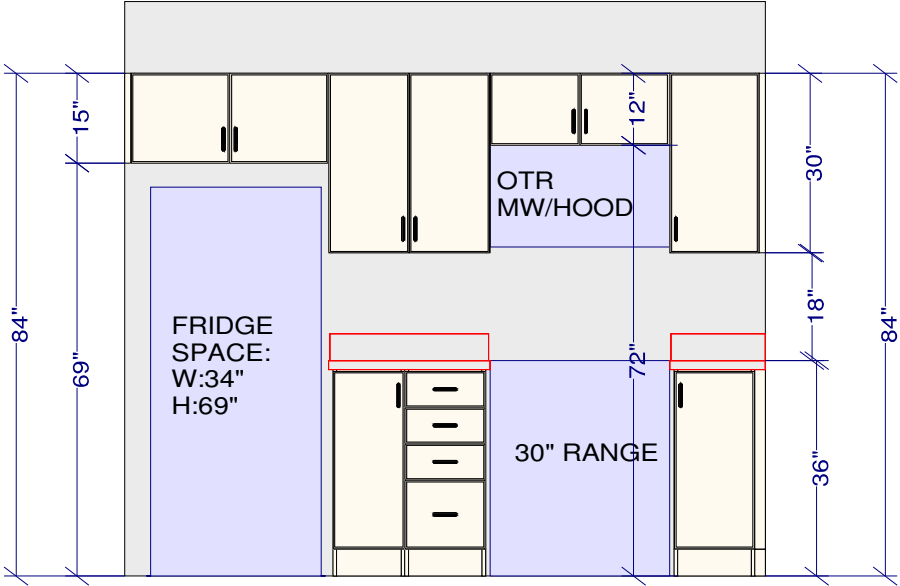

UPPER UNIT

FRIDGE/ RANGE WALL ELEVATION

| | | | | |
|--|---|---|---|-----------|
| <div><div>CUSTOMER APPROVAL</div><div>I have reviewed these drawings and understand the details of the design and the Cartier Kitchens specifications</div><div>Signature _____</div><div>Date _____</div></div> | <div>All dimensions ,size designations given are subject to verification on job site and adjustment to fit job conditions.</div> <div></div> | <div>This is an original design and must not be released or copied unless applicable fee has been paid or job order placed.</div> | Designed: 2022-06-23 Printed: 2022-06-23 | |
| | | |  | |
| | | | DCR - Terrace Homes - Upper unit. | |
| | | El 1 | Drawing #: 1 | No Scale. |