

MARKETING - BUILDING #10 - UNIT 264
CIVIC & CONSTRUCTION ADDRESS - 1019

DocuSign Envelope ID: 8F48D5D9-6B98-4ABF-8F1D-CC0F520E0F73

NUVO - BACK TO BACK
STACKED TERRACE HOMES

UPPER UNIT

REVISED: JANUARY 17, 2023

- CABINETS - CARTIER LINE 1
- HARDWARE - STD & 1ST UPGRADE
- STD HINGES
- STD METAL DRWRS
- 5 PCS - 5/8" KICK
- 6 PCS - FLAT SHOE MOULDING

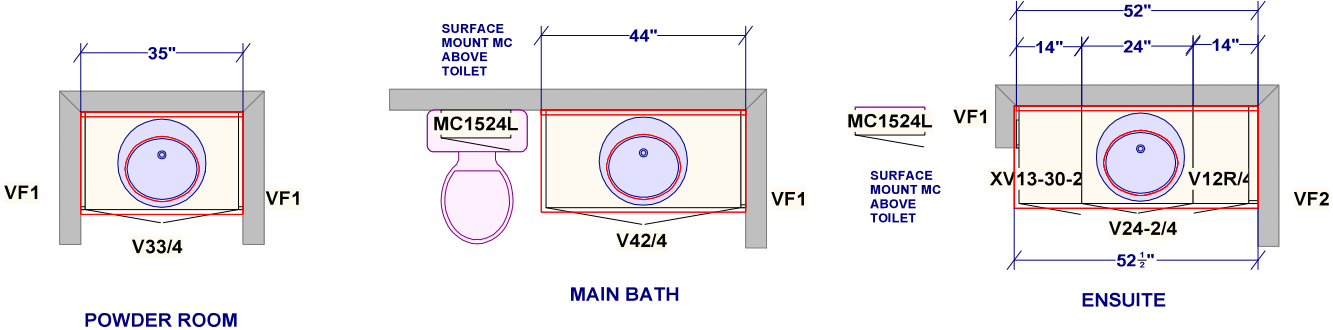
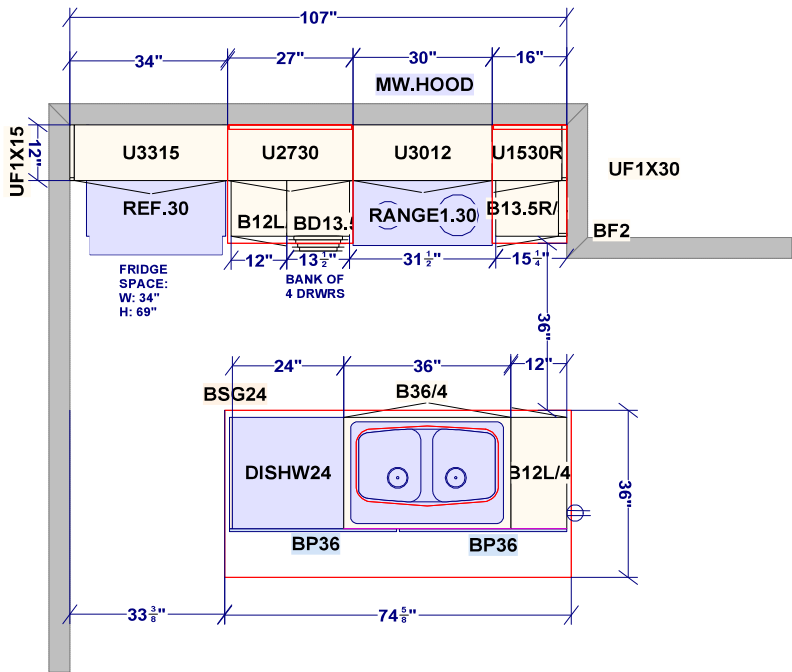

DS
R4

<div>CUSTOMER APPROVAL</div> <div>I have reviewed these drawings and understand the details of the design and the Cartier Kitchens specifications</div> <div>Signature _____</div> <div>Date _____</div>	<div>All dimensions _size designations given are subject to verification on job site and adjustment to fit job conditions.</div> <div></div>	<div>This is an original design and must not be released or copied unless applicable fee has been paid or job order placed.</div>	Designed: 1/17/2023 Printed: 1/17/2023	
DCR - NUVO - BACK TO BACK STACKED TERRACE HOMES - UPPER UNIT		All	Drawing #: 1	No Scale.

MARKETING - BUILDING #10 - UNIT 264
CIVIC & CONSTRUCTION ADDRESS - 1019

DocuSign Envelope ID: 8F48D5D9-6B98-4ABF-8F1D-CC0F520E0F73

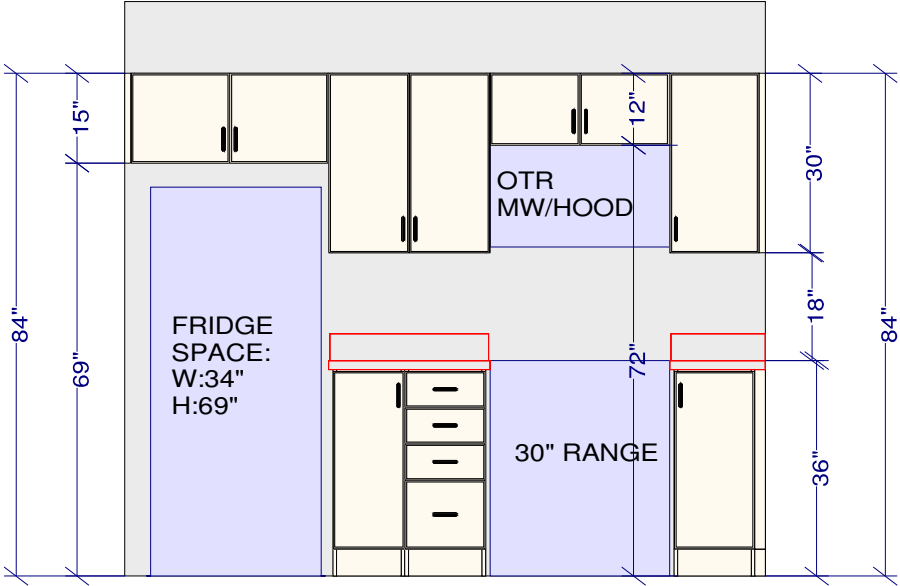

UPPER UNIT

FRIDGE/ RANGE WALL ELEVATION

DS
R4

CUSTOMER APPROVAL

I have reviewed these drawings and understand the details of the design and the Cartier Kitchens specifications

Signature _____

Date _____

All dimensions ,size designations given are subject to verification on job site and adjustment to fit job conditions.



This is an original design and must not be released or copied unless applicable fee has been paid or job order placed.

Designed: 2022-06-23
Printed: 2022-06-23