

SCHEDULE "C"
CONDOMINIUMS

UNIT #: 29

MODEL: Jupiter 1

BUILDING #: 4

PURCHASER: Mathers

PAINT & CLEAN: Yes

OCCUPANCY DATE: November 28, 2008

CLOSE DATE: April 28th, 2009

FEATURES INCLUDED AT NO EXTRA COST:

- Yes 2X6 EXTERIOR CONSTRUCTION
- Yes FORCED AIR H VAC (HIGH EFFICIENCY)
- Yes 800 SERIES DOORS WITH BRASS HARDWARE
- Yes 40 OZ. CARPET WITH 1/2" CHIPFOAM UNDERPAD
- Yes FULL CLAY BRICK WITH STUCCO FAÇADE
- Yes OAK SPINDLES AND HAND RAILS (NATURAL COLOUR)
- Yes 2 TELEPHONE JACKS & 2 CABLE TV JACKS

EXTRAS INCLUDED IN PURCHASE PRICE:

5 appliance pkg

11/1
KM

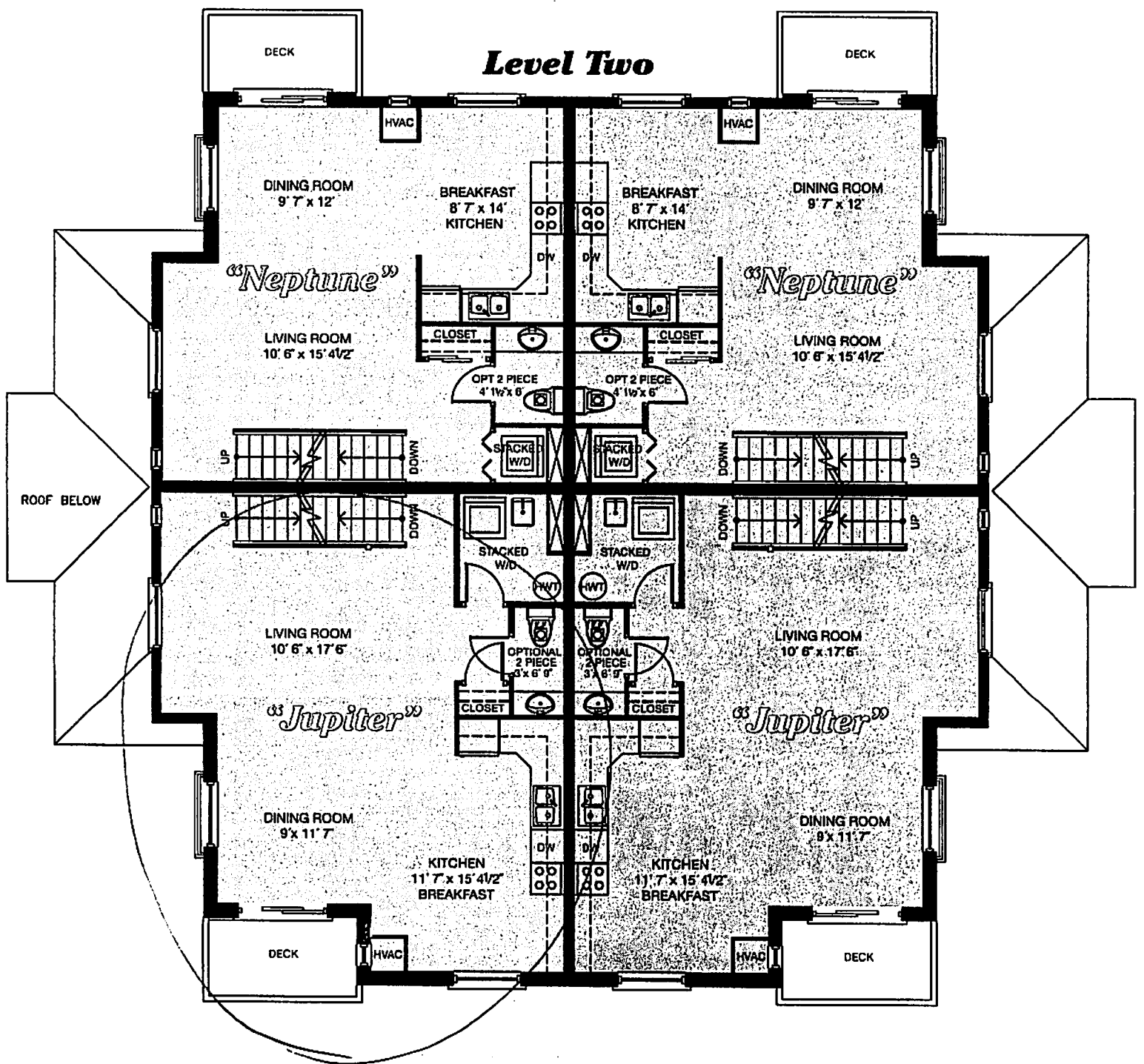

K3

Level Three

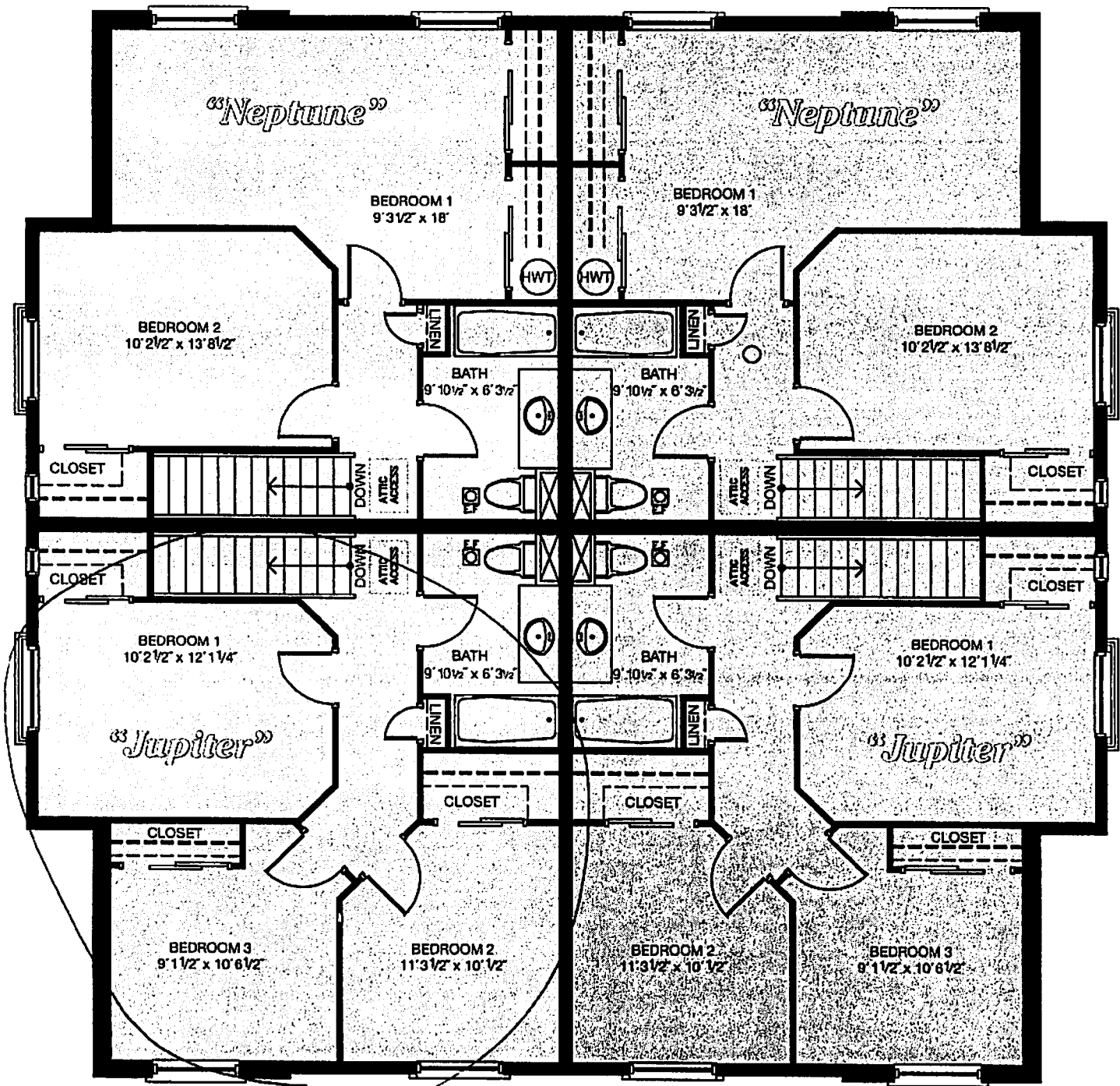

Handwritten signature/initials.