

FORESTSIDE TOWNHOUSES

(Royal Pine Homes)



SITE INSTRUCTION # 1

Instruction Issued By: Kevin Deonarraine

Instruction Issued To: Vince Staffieri

Date: April 8th, 2021

JAP Project No: 19066

Text of Instruction:

The following revisions have been made to the drawing set:

1.1 **Refer to Drawing S-101A & B "P1 UNDERGROUND"**

- a) Updated drawings to unhides F-7 footings

END OF SITE INSTRUCTION # 1

FORESTSIDE TOWNHOUSES

TORONTO, ONTARIO

Project
Number : #19066

Issued for : ISSUED FOR SITE INSTRUCTION # 1

Issued date : APRIL 08, 2021



**JABLONSKY, AST
AND PARTNERS**
CONSULTING ENGINEERS

1129 LESLIE STREET
DON MILLS, ON., M3C 2K5
TEL. 416-447 7405
FAX 416-447 2771
e-mail: jap@astint.on.ca

LIST OF STRUCTURAL DRAWINGS

[illegible]

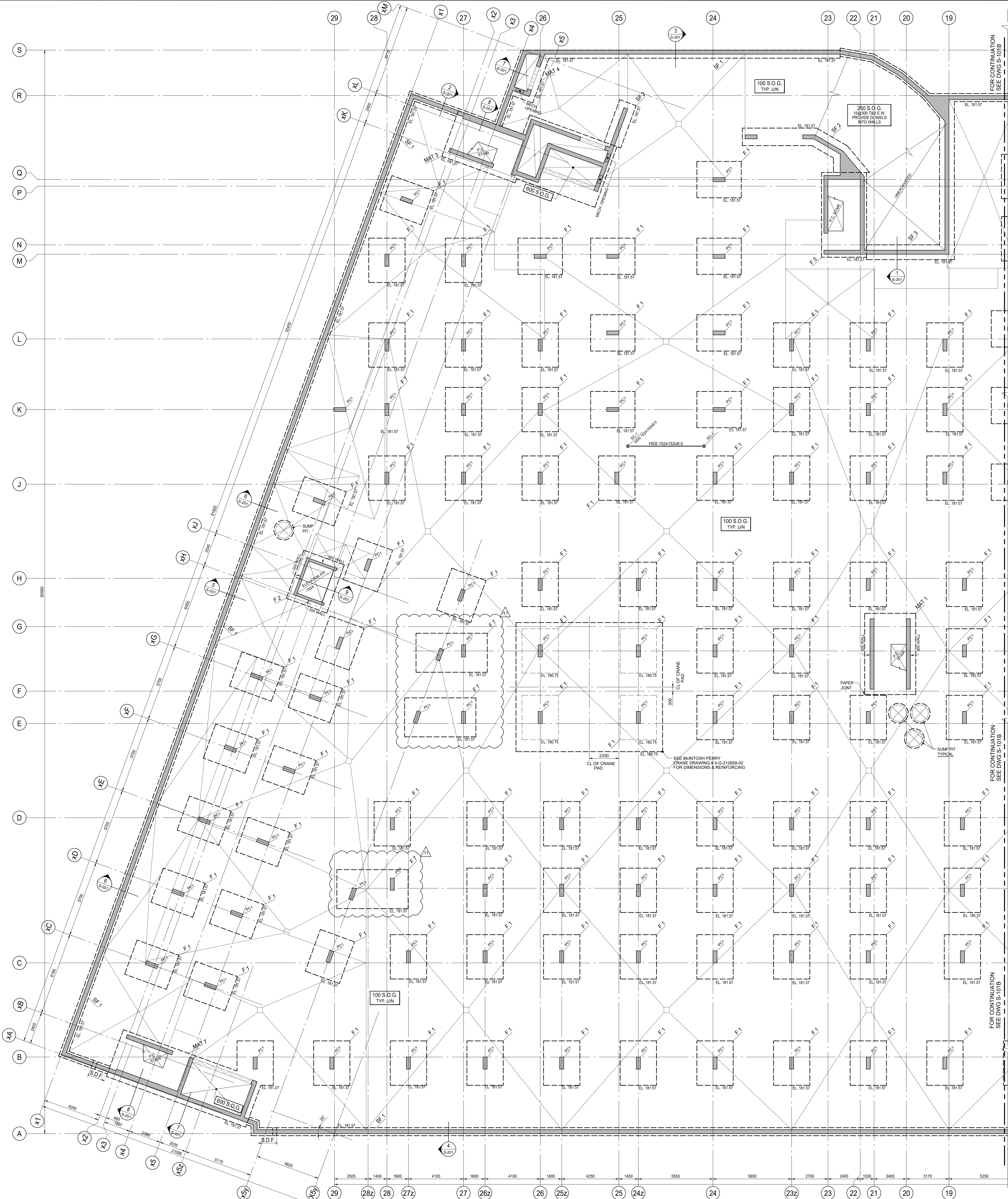

P1 LEVEL FOUNDATION PLAN

SCALE 1:100

- FOOTINGS SHALL BE CARRIED DOWN TO BEAR ON NATURAL UNDISTURBED (SHALE, TILL, SOIL) CAPABLE OF SAFELY SUSTAINING A BEARING CAPACITY OF 300 kPa (SL) & 450 kPa (ULS). UNLESS NOTED ON PLAN, AS PER ON GEOTECHNICAL REPORT 20-065-100 PREPARED BY DS CONSULTANTS LTD. DATED JUNE 16, 2020.
- TOP OF ROUGH SLAB IS 9mm BELOW FINISHED FLOOR (DATUM EL. XXX.XXX) EXCEPT AS CROSSED AND NOTED ON PLAN.
- TOP OF FOOTINGS TO BE 300mm (MIN.) FROM FINISHED SLAB ON GRADE. UNDERSIDE OF FOOTING ELEVATION IS NOTED AS EL.XXX.XXX ON PLAN.
- CONCRETE STRENGTH AT 28 DAYS SHALL BE AS FOLLOWS:
FOR FOOTINGS & FOOTING CAPS 35 MPa, EXCEPT AS NOTED ON PLAN.
FOR PERIMETER FOUNDATION WALLS 35 MPa, EXPOSURE CLASS F2
FOR SLAB ON GRADE 25 MPa, EXPOSURE CLASS C4
FOR COLUMNS & SHEAR WALLS SEE COLUMN & WALL SCHEDULE
- CONCRETE EXPOSED TO DE-ICING CHEMICALS AND OR WEATHER SHALL HAVE 6% TO 8% ENTRAINED AIR.
- MINIMUM YIELD STRESS FOR REINFORCING STEEL SHALL BE 400 MPa.
- SLAB ON GRADE SHALL BE 100mm THICK, REINFORCED WITH FIBRILLATED POLYPROPYLENE FIBRES, UNLESS OTHERWISE NOTED ON PLAN.
- PROVIDE 150mm OF RIGID INSULATION UNDER SLAB ADJACENT TO AIR SHAFTS FOR A DISTANCE OF 1500mm FROM SHAFTS. (TYPICAL).
- S.D.F. - DENOTES STEP DOWN FOOTING.
- SEE GENERAL NOTES ON DRAWING S-001.
- SEE TYPICAL DETAILS ON S-000 SERIES DRAWINGS.
- SEE COLUMN & WALL SCHEDULE ON THIS DRAWING.
- REFER TO ARCH. DRAWINGS FOR EXACT SLOPES OF SLAB AND DRAIN LOCATIONS. SEE ARCHITECTURAL DRAWINGS FOR EXACT SIZE, LOCATION AND EXTENT OF CURBS. SEE TYPICAL DETAILS FOR CURB REINFORCEMENT.
- VERIFY ELEVATOR PIT DEPTH WITH ELEVATOR MANUFACTURER.
- SEE TYPICAL DETAILS FOR FOOTINGS AT PREFAB SUMP PITS.
- SEE MECHANICAL DRAWINGS FOR LOCATION, SIZE AND DEPTHS OF SUMP PITS. LOWER FOOTINGS AS NECESSARY.
- CENTRE LINE OF FOOTING SHALL BE CENTER LINE OF COLUMN OR SHEAR WALL UNLESS OTHERWISE NOTED ON PLAN.
- THE LONGEST DIMENSION OF THE FOOTING IS PARALLEL TO THE LONGEST DIMENSION OF THE COLUMN UNLESS NOTED ON PLAN.
- PROJECT ALL FOOTINGS 300 (MIN.) BEYOND FACE OF COLUMN OR SHEAR WALL UNLESS NOTED ON PLAN.
- BPL-1 - 150x150 DENOTES ELEVATOR DIVIDER BEAM BASE PLATE WITH 2x19mm@ NELSON STUD. x 150LG., EACH END.

15@800V FOR NON-LOAD BEARING BLOCK WALLS & DOWEL INTO SLAB ON GRADE

COLUMN PC1 = 300x800
10-20V
+10@300 TIES

WALLS = 200 THICK
10@400H&V E.F.
+ ADD 2-20H TOP

300 THICK
10@270H&V E.F.
+ ADD 2-20H TOP

ISSUES

No.	DATE	DESCRIPTION
1.	2019-08-02	ISSUED FOR TENDER
2.	2019-09-12	ISSUED FOR TENDER ADDENDUM #2
3.	2020-01-31	ISSUED FOR TENDER ADDENDUM #3
4.	2020-05-07	ISSUED FOR TENDER ADDENDUM #4
5.	2020-09-28	ISSUED FOR PERMIT
6.	2021-01-08	ISSUED FOR TENDER ADDENDUM #5
7.	2021-02-22	ISSUED FOR TENDER ADDENDUM #6
8.	2021-03-03	ISSUED FOR PERMIT BUILDINGS A, B, C, D
9.	2021-03-25	ISSUED FOR PROGRESSIVE CONSTRUCTION
10.	2021-03-25	ISSUED FOR PERMIT BUILDINGS A, B, C, D
11.	2021-04-08	ISSUED FOR SITE INSTRUCTION #1

REVISIONS

CONTRACTOR MUST VERIFY ALL DIMENSIONS AND BE RESPONSIBLE FOR SAME REPORTING ANY DISCREPANCIES TO THE ARCHITECT BEFORE COMMENCING THE WORK.

PRINTS ARE NOT TO BE SCALED.



Jablonsky, Ast and Partners
CONSULTING ENGINEERS
1120 LESLIE STREET
DON MILLS, ON, M3C 2K5
TEL: 416-447-1405
FAX: 416-447-2771

Job Title:
FORETSIDE TOWNHOUSES
TORONTO, ONTARIO

Sheet Title:
P1 UNDERGROUND WEST AREA

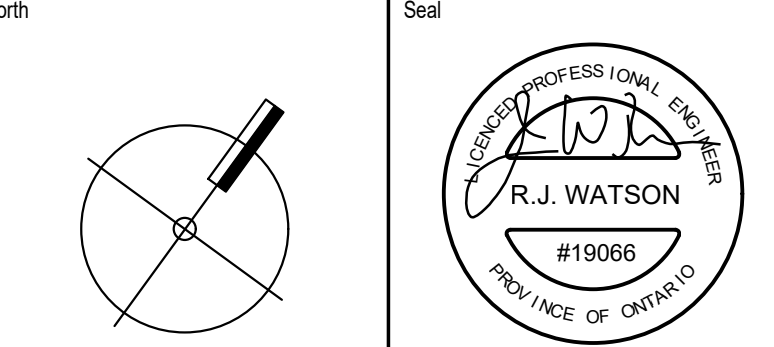

Date Plotted: Apr 07 2021

Drawn By: ND Scale: 1 : 100

Checked By: JW Revision Number:

Job No: 19066 Sheet No: S-101A

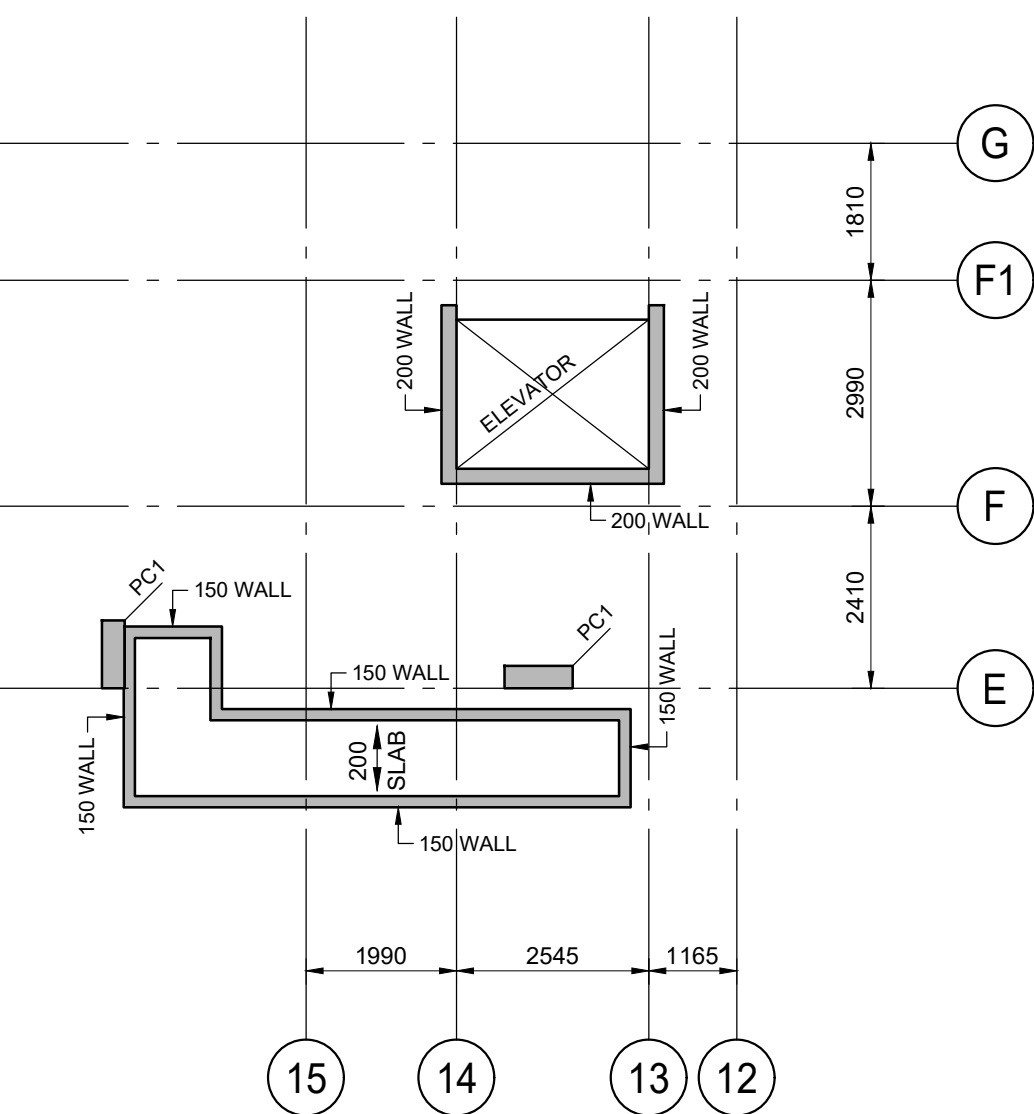

P1 LEVEL PART PLAN

P1 LEVEL FOUNDATION PLAN

1. FOR GENERAL NOTES, SEE DRAWING S-101A

15@800V FOR NON-LOAD
BEARING BLOCK WALLS &
DOWEL INTO SLAB ON GRADE

COLUMN PC1 = 300x900
10-20V
+10@300 TIES

WALLS = 200 THICK
10@400H&V E.F.
+ ADD 2-20H TOP

300 THICK
10@270H&V E.F.
+ ADD 2-20H TOP

ISSUES		
No.	DATE	DESCRIPTION
1.	2019-09-02	ISSUED FOR TENDER
2.	2019-09-12	ISSUED FOR TENDER ADDENDUM # 2
3.	2020-01-31	ISSUED FOR TENDER ADDENDUM # 3
4.	2020-07-07	ISSUED FOR TENDER ADDENDUM # 4
5.	2020-09-28	ISSUED FOR PERMIT
6.	----	
7.	2021-02-22	ISSUED FOR TENDER ADDENDUM # 6
8.	2021-03-03	ISSUED FOR PERMIT BUILDINGS A, B, C, D
9.	2021-03-23	ISSUED FOR PROGRESSIVE CONSTRUCTION
10.	2021-03-25	ISSUED FOR PERMIT BUILDINGS A, B, C, D
11.	2021-04-08	ISSUED FOR SITE INSTRUCTION # 1

No.	DATE	DESCRIPTION
REVISIONS		

CONTRACTOR MUST VERIFY ALL DIMENSIONS AND BE RESPONSIBLE
FOR SAME REPORTING ANY DISCREPANCIES TO THE ARCHITECT
BEFORE COMMENCING THE WORK.

PRINTS ARE NOT TO BE SCALED.



**Jablonsky, Ast
and Partners**
**CONSULTING
ENGINEERS**
1129 LESLIE STREET
DON MILLS, ON., M3C 2K5
TEL 416-447 7405
FAX 416-447 2771

Job Title
FORESTSIDE TOWNHOUSES
TORONTO, ONTARIO

Sheet Title

P1 UNDERGROUND
EAST SIDE

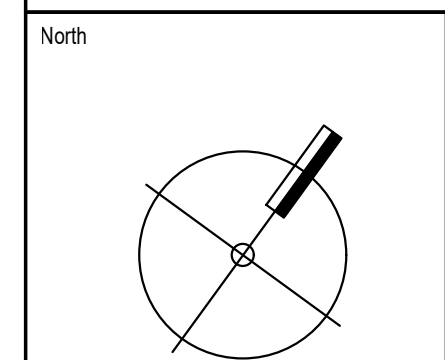

Seal



The seal is circular with the text "LICENSED PROFESSIONAL ENGINEER" around the top and "PROVINCE OF ONTARIO" around the bottom. In the center, it says "R.J. WATSON" and "#19066". There is a signature over the name.

Date Plotted	Date : Apr 07 2021
--------------	-----------------------

Drawn by:	ND	Scale:	1 : 100
Checked By :	IW	Revision Number:	

Job No :	Sheet No:
19066	S-101B