



HONEYSUCKLE

1C

1 BEDROOM | 1 BATH

625 SQ FT

PLUS APPROXIMATELY  
56 SQ FT  
PATIO/ BALCONY AREA

suite 117

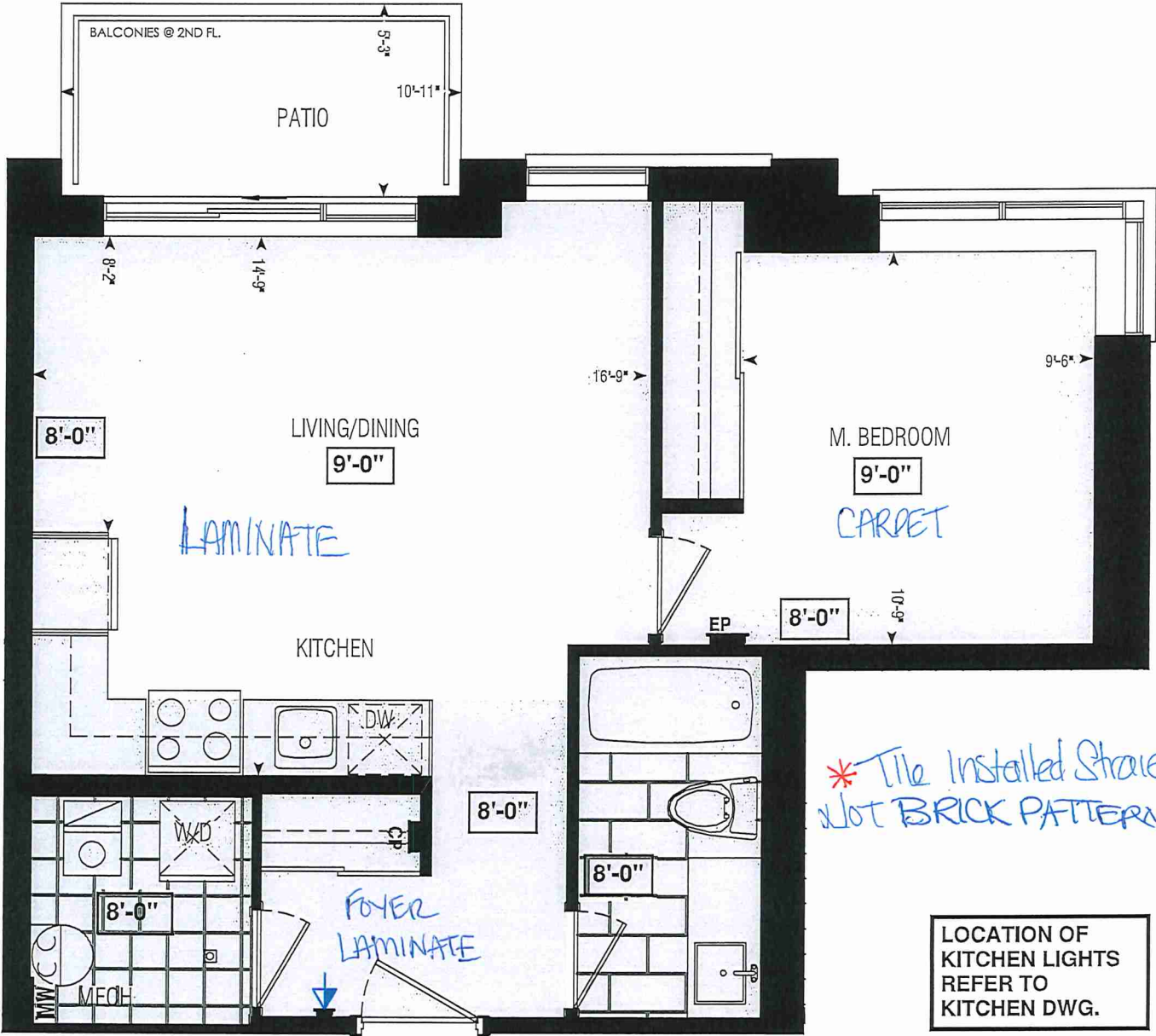

Dimensions, specifications, layouts, window sizes, and materials are approximate only, may vary, and are subject to change as provided in the Agreement of Purchase & Sale. Plans may be reversed. Illustrations are artist's concept. E.&O.E.

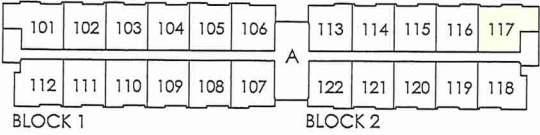

GROUND FL.

RECEIVED  
NOV 22 / 21

LOCATION OF  
KITCHEN LIGHTS  
REFER TO  
KITCHEN DWG.

LEGEND:

	SECURITY PANEL
	ELECTRICAL PANEL
	COMMUNICATION PANEL
	WATER METER
	DROPPED AREA



**\* INTERIOR COLOUR SCHEME \***

 Purchasers	Decor Consultant	Model and Elevation	Telephone Res. / Bus	Project	Closing Date	Property
ILEEN FLORES ESCOLANO & ERIC SISPEREZ ESCOLANO	Laura Di Pede	Honey Suckle 1C	/	Forestside Estates Inc.	04/05/2023	117 BLOCK 2

Page 1 of 3

Page 1 of 3

Flooring		Wall Tile				Plumbing
Description		Main	Accent/Insert	Border / Listello	Pattern	
Main Bathroom	13X13 RUSTIC LIGHT BROWN (STD)	8X10 CARRARA MATT (STD)	N/A	N/A	N/A	WHITE
Kitchen	Highland SUTTON OAK EE-H-289 (STD)	3X6 Subway White Glossy-Stacked-STD	N/A	N/A	N/A	STD
	13X13 RUSTIC LIGHT BROWN (STD)	N/A	N/A	N/A	N/A	N/A
Laundry						
Foyer/Mech Room	Highland SUTTON OAK EE-H-289 (STD)	Railings and Stairs				
Living Room		Railings	N/A	Landing - Upper	N/A	NO
		Pickets	N/A	Landing - Lower	N/A	NO
		Posts	N/A	Ledge - Upper	N/A	NO
	Highland SUTTON OAK EE-H-289 (STD)	Stringers	N/A	Ledge - Lower	N/A	NO
		Treads	N/A			NO
Dining Room	Highland SUTTON OAK EE-H-289 (STD)	Risers	N/A			NO
		Runner	N/A			NO
Master Bedroom		Trim				
		Baseboard & Casing	STANDARD	Knobs	STANDARD	
		Front Door Glass	N/A	Hinges	STANDARD	
		Interior Doors	STANDARD	Grip Set	STANDARD	
	40 OZ Mohawk OPENING, NIGHT 4002-04 (STD)	Notes	Cornice Moulding / Medation			
				Foyer	NO	
				Living Room	NO	
				Dining Room	NO	
				Family Room	NO	
				Main Hall	NO	
				Kitchen	NO	
				2nd Floor Hall	NO	

Page 1 of 3

Page 1 of 3

**Consultant:**

**Purchaser:****Purchasers:**

## Vendors:

Laura DiPede

AILEEN FLORES ESCOLANO

ERIC SISPerez ESCOLANO

Lot: 117 BLOCK 2 Project: Forestside Estates Inc. Model: Honey Suckle 1C

**Forests**

Printed Dec 13, 2021 4:23 pm



\* INTERIOR COLOUR SCHEME \*

Purchasers	Decor Consultant	Model and Elevation	Telephone Res. / Bus	Project	Closing Date	Property
ILEEN FLORES ESCOLANO & ERIC SISPEREZ ESCOLANO	Laura Di Pede	Honey Suckle 1C	/	Forestside Estates Inc.	04/05/2023	117 BLOCK 2

Main Bathroom	Interior Paint	Description	Cabinet			
		Style	Countertop	Counter Edge	Handle / Knob	
		STD- DISTANT GREY	CATEGORY 1 QT1022 FROSTING (SM) L.P LAMINATE (STD)	QS SNOW WHITE (STD)	1A" EDGE (STD)	DH00010
Kitchen	Interior Paint	STD- DISTANT GREY	CATEGORY 1 QT 1022 FROSTING (SM) L.P LAMINATE (STD)	QS 7945 FROST (STD)	1A" (STD)	DH00010
Laundry	Interior Paint	STD- DISTANT GREY	N/A	N/A	N/A	N/A
Foyer	Interior Paint	STD- DISTANT GREY				

Living Room	Appliance Opening/Dimension	Fridge Size	STANDARD	Range	STANDARD	Notes
		Built-ins	None	Microwave	O.T.R. MICRO-STD	
		Hood Fan	O.T.R. MICRO- STD	Exhaust Opening	6" 8"	
Dining Room	Appliance Opening/Dimension	Dishwasher Cabinet	Std 24in Opening			***BUILDERS STANDARD APPLIANCES**
Master Bedroom	Fireplace	Fireplace	N/A	Fireplace	N/A	
		Location Flooring	N/A	Location Flooring	N/A	
		Style	N/A	Style	N/A	
	Fireplace	Finish	N/A	Finish	N/A	
		Marble	N/A	Marble	N/A	
		Hearth	N/A	Hearth	N/A	



SITE COPY

CONSTRUCTION SUMMARY

Forestside Estates Inc.

PURCHASERS: AILEEN FLORES ESCOLANO and ERIC SISPEREZ ESCOLANO

TEL:

LOT NUMBER	PHASE	HOUSE TYPE	CLOSING DATE	
117 BLOCK 2	6-III	Honey Suckle 1C	04-May-23	

Date Added: 08-Feb-22

Invoice Number: 7630

1 - APPLIANCE PACKAGE- Install the Standard Appliance Package throughout the home, where applicable.  
Note:

1 - KITCHEN- Kitchen Faucet STANDARD- DELTA Chrome Pull Down Kitchen Faucet (Single Hole) - Model # 976 LF Chrome  
KITCHEN- Install the builders standard Top mount sink in the kitchen- Install the BLANCO HORIZON 1.0 (7") Top mount Sink- Model # 401125  
Note:

1 - CLARIFICATION-  
MAIN BATH- Install the builders standard Plumbing Fixtures throughout all bathrooms, where applicable.  
Note:

1 - COUNTER TOPS  
  
Purchaser accepts & acknowledges that the Stone slabs vary in size & all seams are visible & the fabricator reserves the right to position the seams as necessary.  
Note:

1 - CLARIFICATION-  
MAIN BATH- Install the Standard 3" Splash throughout all bathroom vanity counter tops, where applicable. To include the Main Bath  
Note:

1 - MAIN BATH- Purchaser accepts & acknowledges that the floor tiles on the Main Bath will be installed stacked NOT brick pattern.  
Note:

1 - PURCHASER HAS ATTENDED A COLOR APPOINTMENT AT THE DECOR CENTRE AND HAS DECLINED ANY ADDITIONAL UPGRADES.  
Note:

1 - PURCHASER AWARE AND ACCEPTS THAT ANY CHANGES MADE TO UPGRADES AFTER SIGNING THIS PURCHASERS EXTRA FORM ARE SUBJECT TO A MINIMUM ADMINISTRATION FEE OF \$1,000 PLUS A 10% HOLDBACK FEE.  
Note:

This Document is Extremely Time Sensitive - Printed 8 Feb 22 at 11:15





# Whirlpool® 30" Wide Top-Freezer Refrigerator with Flexi-Slide™ Bin

WRT318FZDM

There's always a place for fresh and frozen favorites inside the 30" wide top-freezer refrigerator with 18 cu. ft. capacity. To give you more convenient storage options above the refrigerator crisper, the Flexi-Slide™ bin quickly moves side-to-side for convenient storage options.

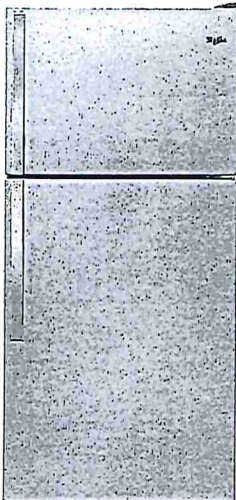

Available Finishes/Colours

- WRT318FZDB  
Black
- WRT318FZDM  
Monochromatic  
Stainless Steel
- WRT318FZDW  
White

Manuals & Literature:

- [Dimension Guide](#)
- [Energy Guide](#)
- [Installation Instructions](#)
- [Use and Care](#)
- [Warranty](#)

Top Features	
Flexi-Slide™ Bin	Make space for tall items with the bin that quickly and easily moves side-to-side for convenient storage options.
Quiet Cooling	Keep noise down in the kitchen with a design that provides quiet cooling.
Electronic Temperature Controls	Choose the ideal temperature for whatever foods you're storing with convenient, up-front controls.
Frameless Glass Shelves	Store more items on each shelf with wall-to-wall frameless glass shelves, which offer greater storage flexibility.
Dimensions	
Depth	33 1/2
Height	65 7/8
Width	29 3/4
AHAM Volumes And Shelf Area	
Freezer Volume (Cu Ft)	5.09
Refrigerator Volume (Cu Ft)	13.06
Controls	
Control Location	Interior
Max-Cool/Fast-Cool	No
Configuration and Overview	
Counter Depth	No
Levelers	2 Black
Misc.	
Accessory Relationships	Yes
Home Delivery	Yes
Will Call	Yes
Details	
Cooling Type	Single Evaporator
Counter Depth	No
Door Style	Flat
Exterior	
Cabinet Color	Grey
Cabinet Finish	Smooth
Door Color	Stainless Steel
Controls	
Control Type	Electronic
Automatic Defrost	Yes



1.7 cu. ft. Microwave Hood Combination with Electronic Touch Controls

YWMH31017HS

This Whirlpool® microwave has convenient features that are easy to use no matter who's doing the cooking. Our microwave with a turntable accommodates various dish sizes while microwave presets deliver the right amount of time and heat. Plus, electronic touch controls are easy to use and clean. From sides to snacks, enjoy the flexibility of fitting cooking into any schedule.

Top Features

**Electronic Touch Controls**  
Navigate through cooking modes and options with controls that are as easy to use as they are to clean.

**900-Watt Cooking Power**  
Cook your favorite foods quickly and thoroughly with high power.

**2-Speed, 300 CFM Motor Class**  
Match the right amount of ventilation to the dish being prepared and quickly get rid of cooking odors with two different fan speed settings.

**Adjustable Cooktop Lighting**  
Keep an eye on what's cooking below the microwave or keep a nightlight on in the kitchen.

Dimensions	
Height	17 1/8
Width	29 15/16



Microwave Details	
Interior Depth	14
Microwave Type	Over-the-Range
Interior Height	9 1/2
Interior Width	21 1/16
Sensor Cooking	No
Work Surface Light	Incandescent
Cooking Power (W,watts)	900
Cooking Power (watts)	900
Cavity Finish	Powder Coat
Turntable Diameter Size (IN, inches)	12

Microwave Details	
Turntable Diameter Size (in.)	12
Convection	No
Turntable	Yes
Interior Light	Incandescent
Number of Racks	0



Configuration and Overview	
Microwave Type	Over-the-Range
Size (IN, inches)	30

Exterior	
Cabinet Color	Stainless
Door Release	Handle
Door Opening	Left
Handle Color	Stainless Steel

Available Finishes/Colours

	YWMH31017HB Black		YWMH31017HS Stainless Steel
	YWMH31017HW White		

Manuals & Literature:

-  [Installation Instructions](#)
-  [Use and Care](#)
-  [Warranty](#)



Because Whirlpool Corporation policy includes a continuous commitment to improve our products, we reserve the right to change materials and specifications without notice. Dimensions are for planning purposes only. For complete details, see Installation Instructions packed with product. Specifications subject to change without notice.



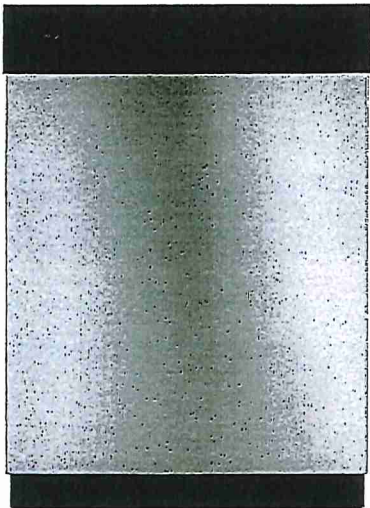

## Heavy-Duty Dishwasher with 1-Hour Wash Cycle

WDF330PAHS

Get the right clean for your dishes with this heavy-duty dishwasher. Finish the job in half the time with the 1-hour wash cycle and rely on the soil sensor to adjust to the soil levels of your dishes for the most thorough clean. Count on this dishwasher, because no one has fewer repairs for over 20 years in a row.

Top Features	
1-Hour Wash Cycle	Clean dishes in half the time so your plates, pans and glasses are thoroughly cleaned up and taken care of in just an hour.
Soil sensor	Determines how dirty dishes are and adjusts the Normal cycle as needed to make sure dishes come out clean.
Normal cycle	Use for normal amounts of food soil to clean up leftover messes from your day-to-day meals.
Heavy Cycle	Take care of heavily-soiled messes and other hard-to-clean dishes without the extra elbow grease by adding extra time to the cycle.

Available Finishes/Colours

	WDF330PAHB Black		WDF330PAHS Stainless Steel
	WDF330PAHW White		WDF330PAHT Biscuit

Manuals & Literature:

	<a href="#">Dimension Guide</a>		<a href="#">Energy Guide</a>
	<a href="#">Installation Instructions</a>		<a href="#">Use and Care</a>
	<a href="#">Warranty</a>		

Dimensions		Controls	
Depth	24 1/2	Control Location	Front
Height	34 1/2	Sensor	Yes
Width	23 7/8	Status Light	White
Configuration and Overview		Compatibility	
Dishwasher Type	Built-In	Connectivity	No
Decibel Level dBA	55	Works With	No
Decibel Level (dBA)	55		
Controls		Misc.	
Automatic Temperature Controls	Yes	Accessory Relationships	Yes
Control Type	Push Button	Home Delivery	Yes
Last Cycle Recall	Yes	Will Call	Yes
		Features	
		Rinse Aid Dispenser Level Indicator	Yes
		Decibel Level (dBA)	55

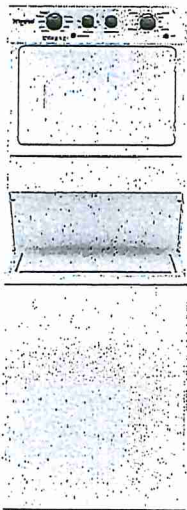

4.0 cu.ft I.E.C. Electric Stacked Laundry Center  
9 Wash cycles and AutoDry™

YWET4027HW

Get the capacity you want and the space you need with an electric stacked washer and dryer combination. The washer with fabric softener dispenser releases fabric softener at just the right time and the dryer automatically senses when clothes are ready and stops the cycle to help prevent overdrying.

Top Features
<b>Dual action Agitator with Fabric Softener Dispenser</b> Get dual action cleaning and convenient fabric softener dispensing at just the right time when you fill this cap with softener before the cycle begins.
<b>White Porcelain Basket</b> Keep your washer looking good thanks to the durable finish that resists scratches, chemicals and rust.
<b>AutoDry™ Drying System</b> Help prevent overdrying with the AutoDry™ drying system that senses when clothes have reached the right moisture content and stops the cycle.
<b>4 Drying Cycles</b> Choose the right setting for each load when you dry with Normal, Delicate, Air Only or Timed Dry cycles.

Available Finishes/Colours

<input type="checkbox"/>	YWET4027HW White
--------------------------	---------------------

Manuals & Literature:

	<a href="#">Energy Guide</a>		<a href="#">Installation Instructions</a>
	<a href="#">Use and Care</a>		

Dimensions	Details
Depth32 7/16	Maximum Spin Speed (RPM)690
Height75 1/2	Washer Capacity (cu. ft.)3.5
Width27 1/4	Hoses IncludedNo
	Motor Drive TypeBelt
	Drum MaterialPowder Coat
Appearance	Misc.
Dryer Door ReversibleNo	Accessory RelationshipsYes
WindowNo	Home DeliveryYes
	Will CallYes
Door	Modifiers
Dryer Door ReversibleNo	Temperature SelectionsHot, Cold, Warm
	Number of Wash/Rinse Temperatures5
Details	
Advanced Vibration Control™Yes	
Dryer Capacity (cu. ft.)5.9	
Automatic Load Size Sensing TechnologyYes	



**BLANCO**

Standard

Sink Specifications

Colour	SKU
refined brushed finish	401125

Design and planning tips

- Min cabinet size: 24 in ( 610 mm )
- Bowl Depth: 7 in ( 178.0 mm )

Specifications:  
Pre-installed foam gaskets, Sink template,  
Installation instructions and clips, 3 ½" (90 mm)  
stainless steel strainer, Limited Lifetime Warranty

Depending on cabinet construction, a different  
cabinet size may be required. Consult the cabinet  
manufacturer.  
Codes/Standards: ASME A112.19.3-2017/ CSA  
B45.4-17

Optional Accessories

Sink Grid	406408
CapFlow Strainer Cover	517666

HORIZON 1.0 (7" deep)  
Stainless steel refined brushed finish

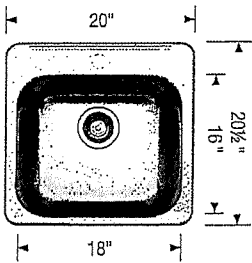

Warranty  
Limited lifetime warranty on all sinks and faucets. One-year warranty on all accessories and soap  
dispensers.

Code/Standards Compliance  
BLANCO sinks and faucets are third-party tested and certified to CSA, cUPC, ANSI/ASME, IAPMO  
and NSF standards and listed by applicable certification bodies. For more information on individual  
product listings, contact our office or listing organization.

 Need support? Learn more by watching our sink & faucet How-to videos:  
<https://www.blanco.com/ca-en/support/how-to-videos/how-to-videos-for-sinks/>

 BLANCO Canada Inc 100 Corporation Drive Brampton ON L6S 6B5	Tel & Fax Tel: 905-494-2400 Toll free: 1-877-425-2626 Fax: 905-494-2425 Toll free: 1-877-825-2626
---	---

While BLANCO strives to provide accurate information, all images and dimensions in this document are intended for reference  
only and are subject to change at any time without notice. This document is not intended for use as an installation guide. For  
technical installation details, refer to installation instructions provided with the product. BLANCO assumes no responsibility for  
the use of superseded or voided specifications.

BS

SUITE 117 BLK 2.

EDGE  
DETAILS

004

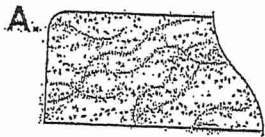

STRAIGHT EDGE  
(STANDARD - 3/4")

\* Kitchen

\* Main Bath

~~\*\* L~~

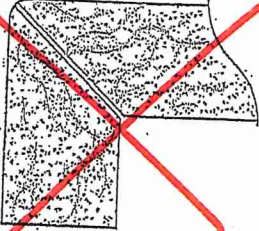

~~MITER WITH SKIRT EDGE  
(MEDIUM - 1 1/2")~~

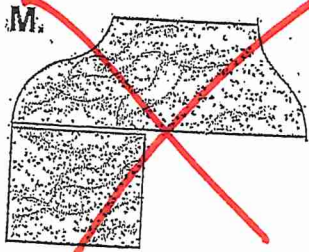

~~OGEES - SQUARE EDGE  
(MED./HIGH - 1 1/2")~~

EDGING UP-GRADE OPTIONS

RECEIVED  
10/25/17