



BUILDING A SUITE 115 BLK 2

AP

HAZEL

1A

1 BEDROOM | 1 BATH

495 - 513 SQ FT

PLUS APPROXIMATELY 56 SQ FT
PATIO/BALCONY AREA

SUITE 115

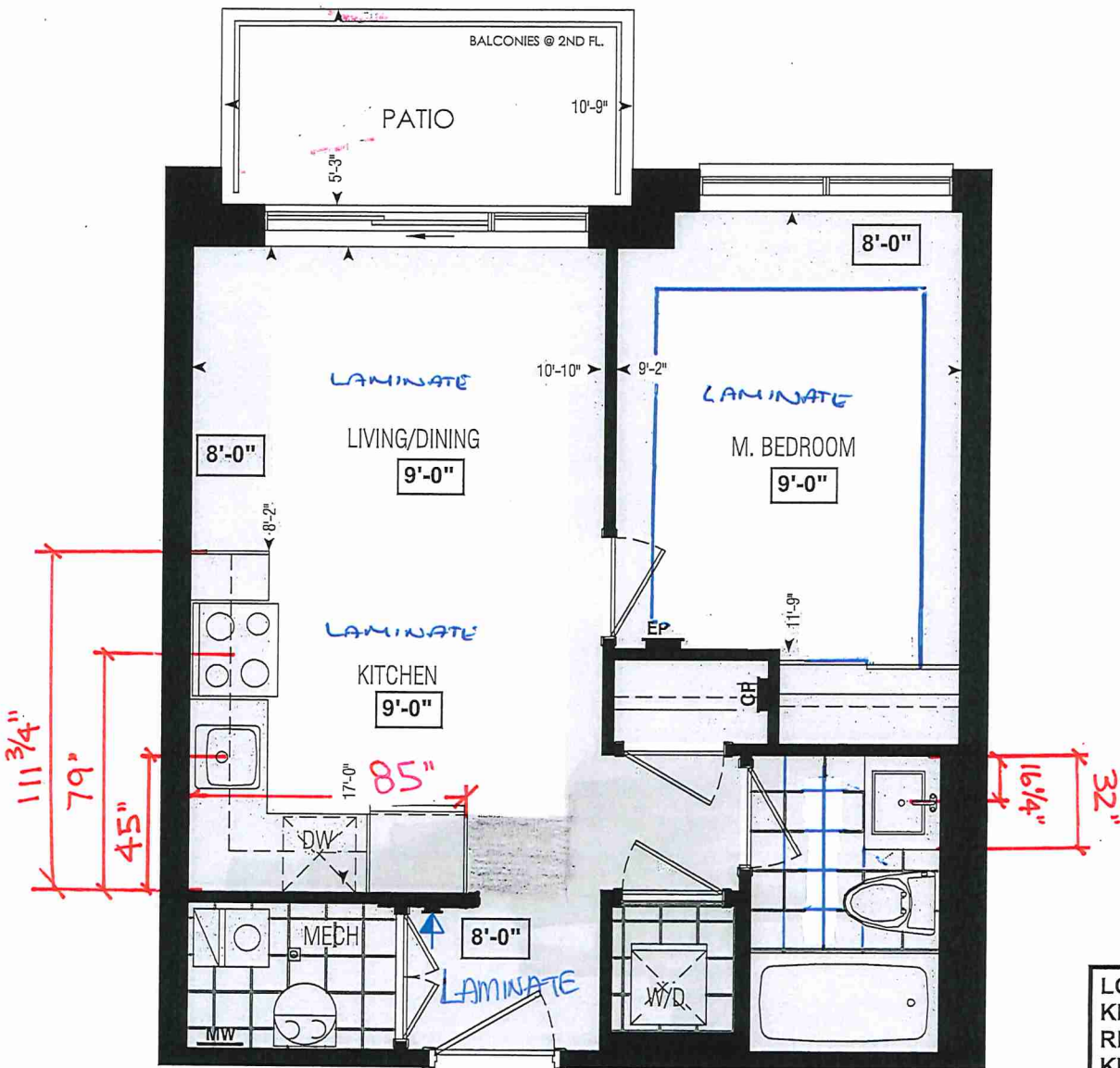

Dimensions, specifications, layouts, window sizes, and materials are approximate only, may vary, and are subject to change as provided in the Agreement of Purchase & Sale. Plans may be reversed. Illustrations are artist's concept. E.&O.E.

LOCATION OF
KITCHEN LIGHTS
REFER TO
KITCHEN DWG.

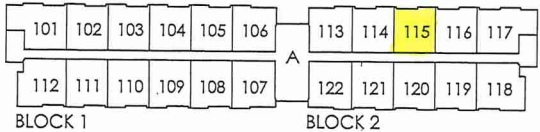

GROUND FL.

RECEIVED
NOV 22/21

LEGEND:

- SECURITY PANEL
- ELECTRICAL PANEL
- COMMUNICATION PANEL
- WATER METER
- DROPPED AREA



SITE COPY

BLDG "A"

CONSTRUCTION SUMMARY
Forestside Estates Inc.

PURCHASER: ALPNA CHAHAL TEL:

LOT NUMBER	PHASE	HOUSE TYPE	CLOSING DATE
115 BLOCK 2	6-III	Hazel 1A	22-May-23

Offer	PURCHASER ACKNOWLEDGES THAT NO UPGRADE ITEMS ARE BEING INCLUDED WITHIN THIS AGREEMENT OF PURCHASE & SALE.
Workshee	Note:

Date Added: 18-Jan-22 Invoice Number: 7668

1 - KITCHEN - APPLIANCE PACKAGE- Install the Standard Appliance Package Note:
1 - MAIN BATH- TILE- Purchaser accepts & acknowledges that the floor tiles In the Main bath will be installed stacked NOT brick pattern. Note:
1 - MAIN BATH- CLARIFICATION- Install the standard Plumbing Fixtures throughout all bathrooms, where applicable. Note:
1 - KITCHEN & BATHROOMS - Purchaser has DECLINED All Upgrades offered during decor appointment at the decor centre for kitchen & bathroom cabinetry. Standard Kitchen Layout & Standard Bathroom Vanities to be installed as per standard plan. (See Sketch) Note:
1 - KITCHEN- PLUMBING - Install UPGRADED SINGLE BOWL SINK in lieu of the builder's standard sink. Install BLANCO QUATRUS U 1 Model#401273. To include cut and polish Note:
1 - PLUMBING KITCHEN- Kitchen Faucet STANDARD- DELTA Chrome Osler Pull Down Kitchen Faucet (Single Hole) - Model # 976 LF Note:
1 - KITCHEN/ MAIN BATH - COUNTERTOP- Stone slabs vary in size & all seams are visible & the fabricator reserves the right to position the seams as necessary. Note:
1 - MAIN BATH- Install the Standard 3" Splash throughout all bathroom vanity counter tops, where applicable. To include the Main Bath Note:
1 - KITCHEN - COUNTERTOP - Install UPGRADED L EDGE throughout the kitchen in lieu of the builder's standard countertop edge. (See sketch) Note:
36 - MASTER BEDROOM - LAMINATE - Install LAMINATE (8" Highland Sutton Oak - EE-H-2891)) throughout the master bedroom in lieu of the builer's standard broadloom (see sketch) Note:
1 - PURCHASER HAS ATTENDED A STRUCTURAL AND COLOR APPOINTMENT AT THE DECOR CENTRE AND HAS DECLINED ANY ADDITIONAL UPGRADES. Note:
1 - PURCHASER AWARE AND ACCEPTS THAT ANY CHANGES MADE TO UPGRADES AFTER SIGNING THIS PURCHASERS EXTRA FORM ARE SUBJECT TO A MINIMUM ADMINISTRATION FEE OF \$1000 PLUS A 10% HOLDBACK FEE. Note:

This Document is Extremely Time Sensitive - Printed 27 Jan 22 at 16:58

Page 1 of 3

Kitchen

Laundry

Foyer

Living Room

Dining Room

Master Bedroom

Page 1 of 3

Consultant:

Purchaser:

Vendor:



* INTERIOR COLOUR SCHEME *

Purchaser	Decor Consultant	Model and Elevation	Telephone Res. / Bus	Project	Closing Date	Property
ALPNA CHAHAL	Laura Di Pede	Hazel 1A	/	Forestside Estates Inc.	22/05/2023	115 BLOCK 2

Page 2 of 3

Main Bath

Interior Paint

Description

Distant Grey (Standard)

Cabinet

Style

CAT.1 - QT 1022 Chiosiro (SM) LP - LAMINATE (STANDARD)

Countertop

QS 7944 Cotton Knit (Standard)

Counter Edge

"A" Edge (STAIN)

Handle / Knob

DH01680(std)

Kitchen

Laundry

Mech. Room

Distant Grey (Std)

Distant Grey (Standard)

Distant Grey (Standard)

CAT.1- QT 1022 Willow Grey (SM) LP - LAMINATE (STANDARD)

N/A

QS 7945 Frost (Standard)

N/A

"L" Edge (UPPER)

N/A

DH09130(std)

N/A

N/A

N/A

N/A

N/A

Foyer

Distant Grey (Standard)

Appliance Opening/Dimension

Fridge Size STANDARD

Range

STANDARD

Built-Ins

None

Microwave

O.T.R Micro (Standard)

Hood Fan

O.T.R Micro (Standard)

Exhaust Opening

6"

8"

Dishwasher Cabinet

Std 24in Opening

Notes

*Standard Appliance package

Living Room

Distant Grey (Standard)

Dining Room

Distant Grey (Standard)

Fireplace

Fireplace

N/A

Fireplace

N/A

Master Bedroom

Distant Grey (Standard)

Location Flooring

N/A

Location Flooring

N/A

Style

N/A

Style

N/A

Finish

N/A

Finish

N/A

Marble

N/A

Marble

N/A

Hearth

N/A

Hearth

N/A

Page 2 of 3

Decor Consultant:

Purchaser:

Vendor:

BUILDING A SUITE 115 BLK 2

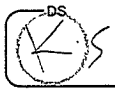

BLANCO

Sink Specifications

Colour	SKU
brushed finish	401273

QUATRUS U 1

Stainless steel brushed finish

Design and planning tips

- Min cabinet size: 24 in (610 mm)
- Bowl Depth: 9 in (230.0 mm)

Specifications:
Installation clips, Sink template, Installation instructions, 3 ½" (90 mm) stainless steel strainer

Depending on cabinet construction, a different cabinet size may be required. Consult the cabinet manufacturer.
Codes/Standards: ASME A112.19.3-2017/ CSA B45.4-17

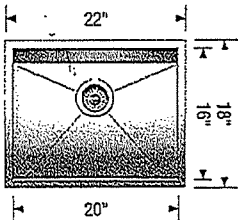



Optional Accessories

CapFlow Strainer Cover	517666
Ash Cutting Board	406345
Workstation	406344
Sink Grid	402126

Warranty
Limited lifetime warranty on all sinks and faucets. One-year warranty on all accessories and so dispensers.

Code/Standards Compliance
BLANCO sinks and faucets are third-party tested and certified to CSA, cUPC, ANSI/ASME, IAPMO and NSF standards and listed by applicable certification bodies. For more information on individual product listings, contact our office or listing organization.

 Need support? Learn more by watching our sink & faucet How-to videos:
<https://www.blanco.com/ca-en/support/how-to-videos/how-to-videos-for-sinks/>

	BLANCO Canada Inc 100 Corporation Drive Brampton ON L6S 6B5	Tel & Fax Tel: 905-494-2400 Toll free: 1-877-425-2626 Fax: 905-494-2425 Toll free: 1-877-825-2626
---	---	---

While BLANCO strives to provide accurate information, all images and dimensions in this document are intended for reference only and are subject to change at any time without notice. This document is not intended for use as an installation guide. For technical installation details, refer to installation instructions provided with the product. BLANCO assumes no responsibility for the use of superseded or voided specifications.

BUILDING A SUITE 115 BLK 2



EDGE
DETAILS

004

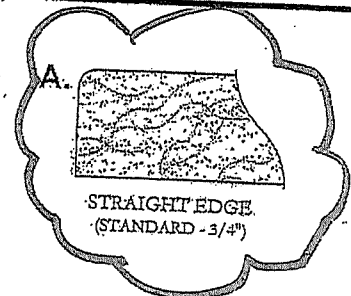

MAIN BATH

STRAIGHT EDGE
(STANDARD - 3/4")

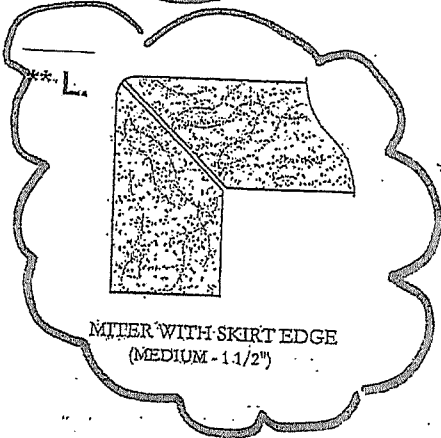

KITCHEN

MITER WITH SKIRT EDGE
(MEDIUM - 1 1/2")

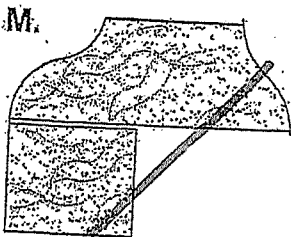

OGEE - SQUARE EDGE
(MED./HIGH - 1 1/2")

EDGING UP-GRADE OPTIONS

RECEIVED
6/15/17

BUILDING A SUITE 115 BLK 2.



Whirlpool® 30" Wide Top-Freezer Refrigerator with Flexi-Slide™ Bin

WRT318FZDM

There's always a place for fresh and frozen favorites inside the 30" wide top-freezer refrigerator with 18 cu. ft. capacity. To give you more convenient storage options above the refrigerator crisper, the Flexi-Slide™ bin quickly moves side-to-side.

Top Features

Flexi-Slide™ Bin

Make space for tall items with the bin that quickly and easily moves side-to-side for convenient storage options.

Quiet Cooling

Keep noise down in the kitchen with a design that provides quiet cooling.

Frameless Glass Shelves

Store more items on each shelf with wall-to-wall frameless glass shelves, which offer greater storage flexibility.

EZ Connect Icemaker Kit

This optional icemaker adds convenient, easily accessible ice without having to worry about refilling ice trays.

Dimensions

Depth	33 1/2
Height	65 7/8
Width	29 3/4

Controls

Control Location	Interior
Max Cool/Fast Cool	No

AHAM Volumes And Shelf Area

Freezer Volume (Cu Ft)	5.09
Refrigerator Volume (Cu Ft)	13.06

Exterior

Cabinet Color	Grey
Cabinet Finish	Smooth
Door Color	Stainless Steel
Door Finish	Smooth
Door Opening	Right
Handle Color	Stainless Steel
Handle Material	Metal
Handle Type	Reach-Through Handle

Details

Cooling Type	Single Evaporator
Counter Depth	No
Door Style	Flat

Controls

Control Type	Electronic
Automatic Defrost	Yes

Available Finishes/Colours



WRT318FZDB
Black

WRT318FZDM
Monochromatic
Stainless Steel



WRT318FZDW
White

Manuals & Literature:



[Dimension Guide](#)



[Energy Guide](#)



[Installation Instructions](#)



[Use and Care](#)



[Warranty](#)



BUILDING A SUITE 115 BLK 2

Whirlpool®

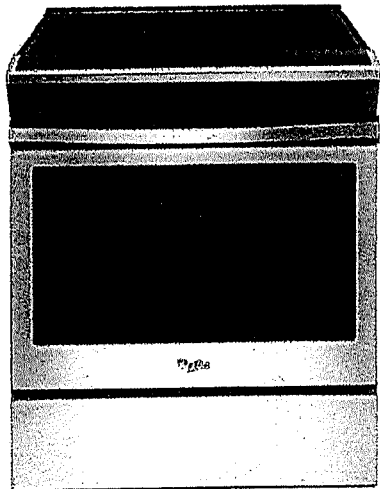

4.8 cu. ft. guided Electric Front Control Range with the easy-wipe ceramic glass cooktop

YWEE510S0FS

Cook for the family, even on a hectic schedule with our 4.8 cu. ft. knobless electric front control range with the easy-wipe ceramic glass cooktop. This cooking range is designed with features that help you get dinner to the table quickly. Skip preheating for favorites like pizza and lasagna with Frozen Bake™ technology.

Top Features

Frozen Bake™ Technology

Frozen Bake™ technology cooks frozen foods faster by eliminating the need to preheat the oven. Just select the food type, temperature and cook time listed on the frozen item's package and the oven will start customizing. Now you can cook frozen pizza 31%.

Guided Cooktop Controls

Control the heat without the guesswork. The knobless design uses up/down arrows to select the temperature you need, while heat level indicators show when you are simmering and melting.

FlexHeat™ Dual Radiant Elements

Get two elements in one with a 6" inner ring that's great for smaller pots and pans and a 9" expandable outer ring that makes room for larger cookware.

Dimensions

Depth	28 15/16
Width	29 7/8

Configuration and Overview

Range Type	Slide-In
------------	----------

Exterior

Door Removable	Yes
Drawer Type	Storage Drawer
Door Type	Metal & Glass
Oven Window Size	Extra Large

Features

Hot Surface Indicator Light	Yes
Heating Element On Indicator Light	Yes
Power On Indicator Light	Yes

Features

Power Outage Compatible	No
-------------------------	----

Configuration

Range Configuration	Slide-In
Oven Configuration	Single Oven





Controls

Display Color	Blue
Electronic Display Type	LED



Cooktop Details

Number of Cooking Element-Burners	4
Right Rear Element-Burner Size	6"

Available Finishes/Colours

 YWEE510S0FB Black	 YWEE510S0FS Black-on-Stainless
 YWEE510S0FV Black Stainless	 YWEE510S0FW White

Manuals & Literature:

 Installation Instructions	 Use and Care
 Warranty	





Heavy-Duty Dishwasher with 1-Hour Wash Cycle

WDF330PAHS

Get the right clean for your dishes with this heavy-duty dishwasher. Finish the job in half the time with the 1-hour wash cycle and rely on the soil sensor to adjust to the soil levels of your dishes for the most thorough clean. Count on this dishwasher, because no one has fewer repairs for over 20 years in a row.

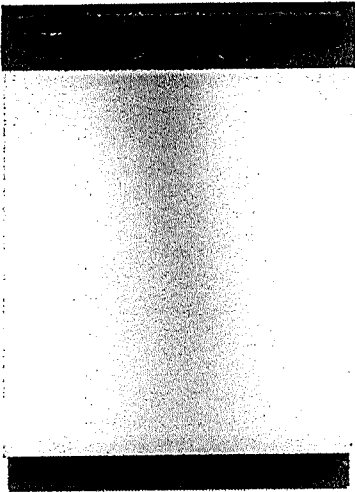

Available Finishes/Colours

- WDF330PAHB
Black
- WDF330PAHS
Stainless Steel
- WDF330PAHW
White
- WDF330PAHT
Biscuit

Manuals & Literature:

- [Dimension Guide](#)
- [Energy Guide](#)
- [Installation Instructions](#)
- [Use and Care](#)
- [Warranty](#)

AL

Top Features

- 1-Hour Wash Cycle**
Clean dishes in half the time so your plates, pans and glasses are thoroughly cleaned up and taken care of in just an hour.
- Soil sensor**
Determines how dirty dishes are and adjusts the Normal cycle as needed to make sure dishes come out clean.
- Normal cycle**
Use for normal amounts of food soil to clean up leftover messes from your day-to-day meals.
- Heavy Cycle**
Takes care of heavily soiled messes and other hard-to-clean dishes without the extra elbow grease by adding extra time to the cycle.

Dimensions	
Depth	24 1/2
Height	34 1/2
Width	23 7/8

Features	
Dispensers	Detergent and Rinse Aid
Sound Package	Yes
Number of Wash Levels	4

Controls	
Automatic Temperature Controls	Yes
Control Type	Push-Button
Control Location	Front
Last Cycle Recall	Yes
Sensor	Yes
Status Light	White

Configuration and Overview	
Decibel Level (dBA)	55

Exterior	
Control Panel Color	Black
Handle Color	Black
Handle Material	Plastic
True Hold Door	Yes
Handle Type	Short Pocket
Toe Panel Color	Black

Compatibility	
Works With	No

Features	
Rinse Aid Dispenser Level Indicator	Yes

BUILDING A SUITE 115 BLK 2

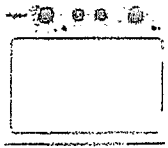

4.0 cu.ft I.E.C. Electric Stacked Laundry Center
9 Wash cycles and AutoDry™

YWET4027HW

Get the capacity you want and the space you need with an electric stacked washer and dryer combination. The washer with fabric softener dispenser releases fabric softener at just the right time and the dryer automatically senses when clothes are ready and stops the cycle to help prevent overdrying.

Top Features

- Dual action Agitator with Fabric Softener Dispenser**
Get dual action cleaning and convenient fabric softener dispensing at just the right time when you fill this cap with softener before the cycle begins.
- White Porcelain Basket**
Keep your washer looking good thanks to the durable finish that resists scratches, chemicals and rust.
- AutoDry™ Drying System**
Help prevent overdrying with the AutoDry™ drying system that senses when clothes have reached the right moisture content and stops the cycle.
- 4 Drying Cycles**
Choose the right setting for each load when you dry with Normal, Delicate, Air-Only or Timed Dry cycles.

Available Finishes/Colours

- ☐ YWET4027HW
White

Manuals & Literature:

- [Energy Guide](#)
- [Installation Instructions](#)
- [Use and Care](#)

AR

Dimensions		Details	
Depth	32 7/16	Washer Capacity (cu. ft.)	3.5
Height	75 1/2	Hoses Included	No
Width	27 1/4	Motor Drive Type	Belt

Appearance		Controls	
Dryer Door Reversible	No	End of Cycle Signal	No
		Control Type	Dials
		LED Color	Green
		Electronic Display Type	No

Details		Exterior	
Advanced Vibration Control™	Yes	Window	No
Dryer Capacity (cu. ft.)	5.9		
Automatic Load Size Sensing Technology	Yes		
Maximum Spin Speed (RPM)	690		

Cycles	
Number of Wash Cycles	9



Because Whirlpool Corporation policy includes a continuous commitment to improve our products, we reserve the right to change materials and specifications without notice. Dimensions are for planning purposes only. For complete details, see Installation Instructions packed with product. Specifications subject to change without notice.



80 Sante Drive, Vaughan, ON L4K 3C4
T 416.746.1811 F 905.761.5901
www.QTK.ca info@qtk.ca

CLIENT: ROYAL PINE HOMES	JOB NAME: 1A, 1Aa HAZEL	ROOM: KITCHEN	DRAWN BY: VGP
SITE: FORESTSIDE ESTATES	DOOR STYLE: QTS 1022	DOOR HANDLE: _	SCALE: 1/2" = 1'-0"
PHONE: _	FINISH: _	DRW HANDLE: _	DATE: DEC 23, 2020
EMAIL: _	SPECIES: LAMINATE	TOP: _	PAGE:

COMMENTS:

Customer Agrees and Accepts the following conditions: 1. The Drawing is a representation only and the installed cabinetry may vary slightly in product size, measurements, handle appearance and location and other details. Although Quality Tops & Kitchens Ltd. (QTK) does it's best to manufacture exactly what is shown here outside factors may prevent that and some variance is to be expected and accepted by the customer. 2. These drawings represent the intellectual property of QTK and as such the customer understands and accepts that all deposits given by the customer to QTK are non-refundable after QTK has supplied drawings (either physically or electronically) to the customer. If the customer decides to cancel the order after QTK has submitted drawings to the customer, the deposit will then be considered a design fee and no money will be returned to the customer.

KITCHEN PLAN 1A, ~~1Aa~~

1A	: 56 nos.
1Aa	: 12 nos.

BUILDING A
SUITE 115 BLK 2

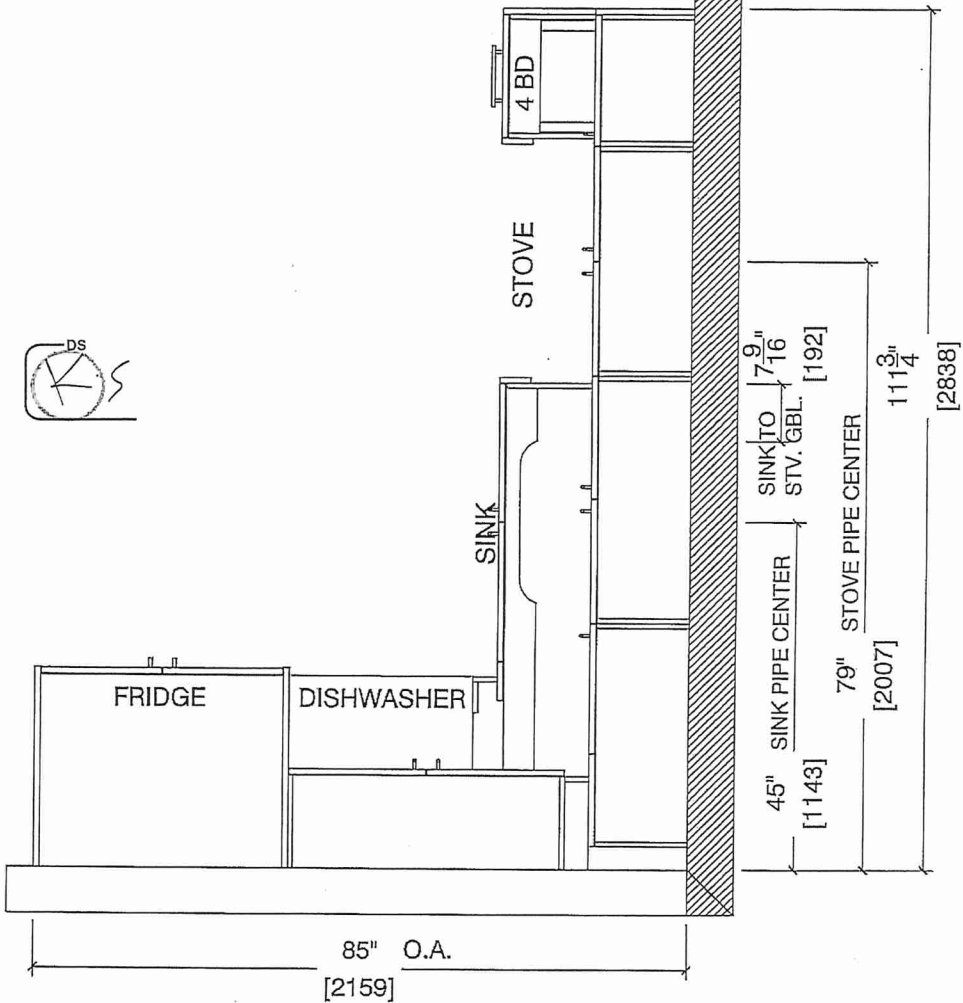



80 Sante Drive, Vaughan, ON L4K 3C4
T 416.746.1811 F 905.761.5901
www.QTK.ca info@qtk.ca

CLIENT: ROYAL PINE HOMES	JOB NAME: 1A, 1Aa HAZEL	ROOM: KITCHEN	DRAWN BY: VGP
SITE: FORESTSIDE ESTATES	DOOR STYLE: QTS 1022	DOOR HANDLE: _	SCALE: 1/2" = 1'-0"
PHONE: _	FINISH: _	DRW HANDLE: _	DATE: DEC 23, 2020
EMAIL: _	SPECIES: LAMINATE	TOP: _	PAGE:

COMMENTS: BUILDING A SUITE 115 Bldg 2

Customer Agrees and Accepts the following conditions: 1. The Drawing is a representation only and the installed cabinetry may vary slightly in product size, measurements, handle appearance and location and other details. Although Quality Tops & Kitchens Ltd. (QTK) does it's best to manufacture exactly what is shown here outside factors may prevent that and some variance is to be expected and accepted by the customer. 2. These drawings represent the intellectual property of QTK and as such the customer understands and accepts that all deposits given by the customer to QTK are non-refundable after QTK has supplied drawings (either physically or electronically) to the customer. If the customer decides to cancel the order after QTK has submitted drawings to the customer, the deposit will then be considered a design fee and no money will be returned to the customer.

FRIDGE WALL ELEVATION 1A, ~~1Aa~~

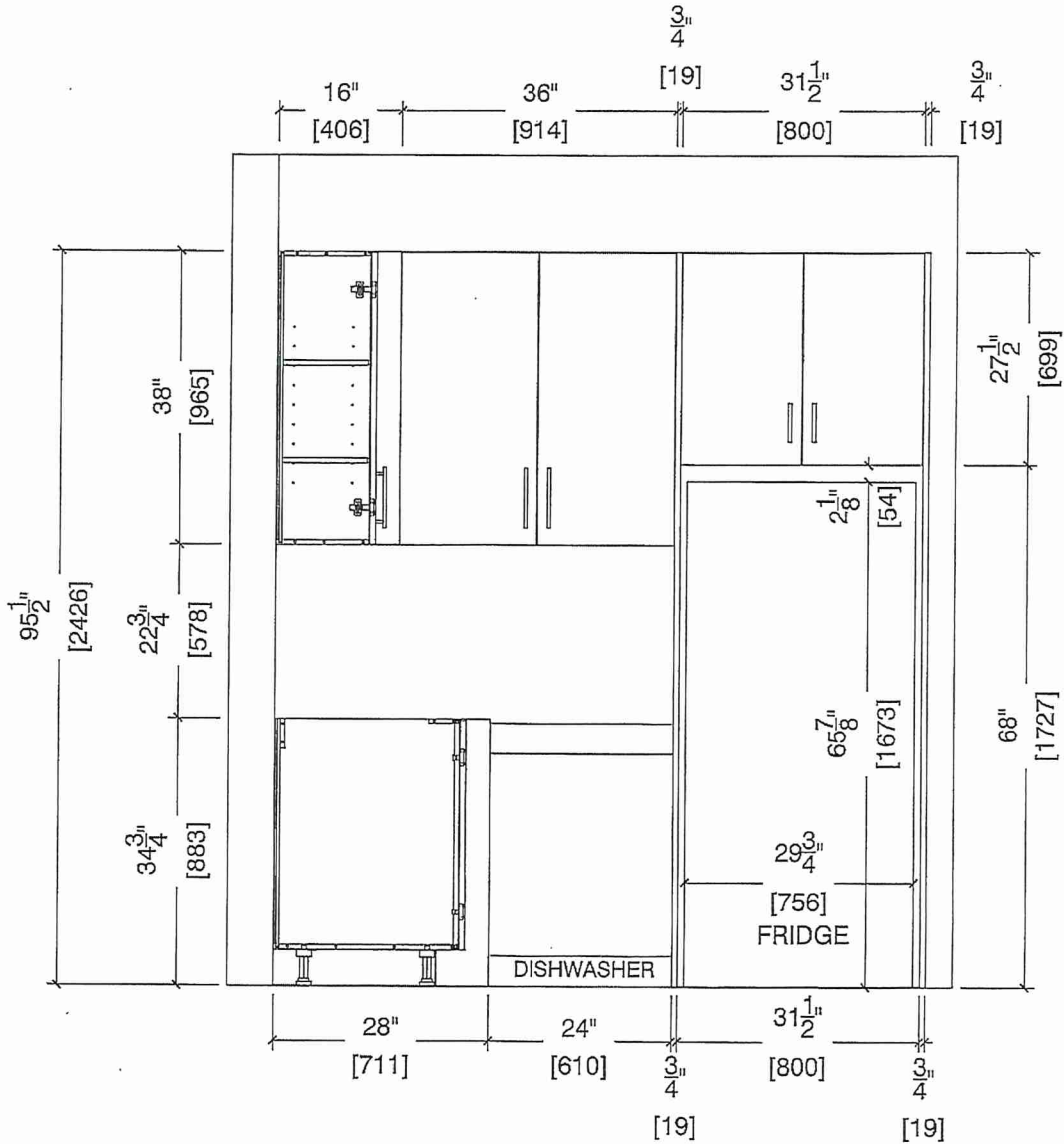
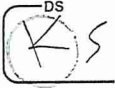



80 Sante Drive, Vaughan, ON L4K 3C4
T 416.746.1811 F 905.761.5901
www.QTK.ca info@qtk.ca

CLIENT: ROYAL PINE HOMES	JOB NAME: 1A,1Aa HAZEL	ROOM: KITCHEN	DRAWN BY: VGP
SITE: FORESTSIDE ESTATES	DOOR STYLE: QTS 1022	DOOR HANDLE: _	SCALE: 1/2" = 1'-0"
PHONE: _	FINISH: _	DRW HANDLE: _	DATE: DEC 23, 2020
EMAIL: _	SPECIES: LAMINATE	TOP: _	PAGE:

COMMENTS: BUILDING A SUITE 115 BUK 2

Customer Agrees and Accepts the following conditions: 1. The Drawing is a representation only and the installed cabinetry may vary slightly in product size, measurements, handle appearance and location and other details. Although Quality Tops & Kitchens Ltd. (QTK) does it's best to manufacture exactly what is shown here outside factors may prevent that and some variance is to be expected and accepted by the customer. 2. These drawings represent the intellectual property of QTK and as such the customer understands and accepts that all deposits given by the customer to QTK are non-refundable after QTK has supplied drawings (either physically or electronically) to the customer. If the customer decides to cancel the order after QTK has submitted drawings to the customer, the deposit will then be considered a design fee and no money will be returned to the customer.

STOVE & SINK WALL ELEVATION 1A, ~~1Aa~~

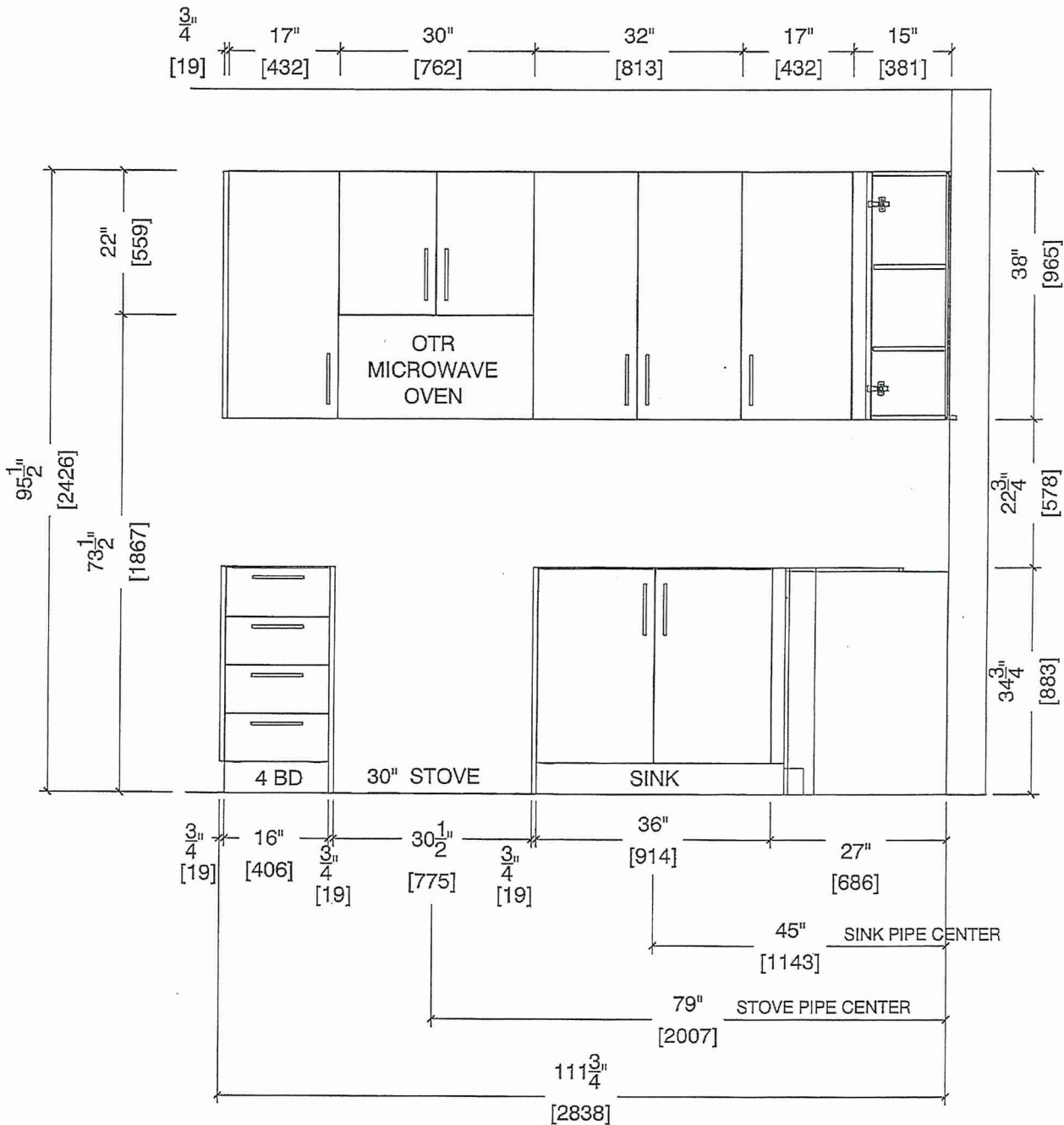
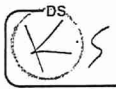





80 Sante Drive, Vaughan, ON L4K 3C4
T 416.746.1811 F 905.761.5901
www.QTK.ca info@qtk.ca

CLIENT: ROYAL PINE HOMES	JOB NAME: 1A, 1A HAZEL	ROOM: KITCHEN	DRAWN BY: VGP
SITE: FORESTSIDE ESTATES	DOOR STYLE: QTS 1022	DOOR HANDLE: __	SCALE: 1/2" = 1'-0"
PHONE: __	FINISH: __	DRW HANDLE: __	DATE: DEC 23, 2020
EMAIL: __	SPECIES: LAMINATE	TOP: __	PAGE:

COMMENTS: BUILDING A SUITE 115 BLK 2

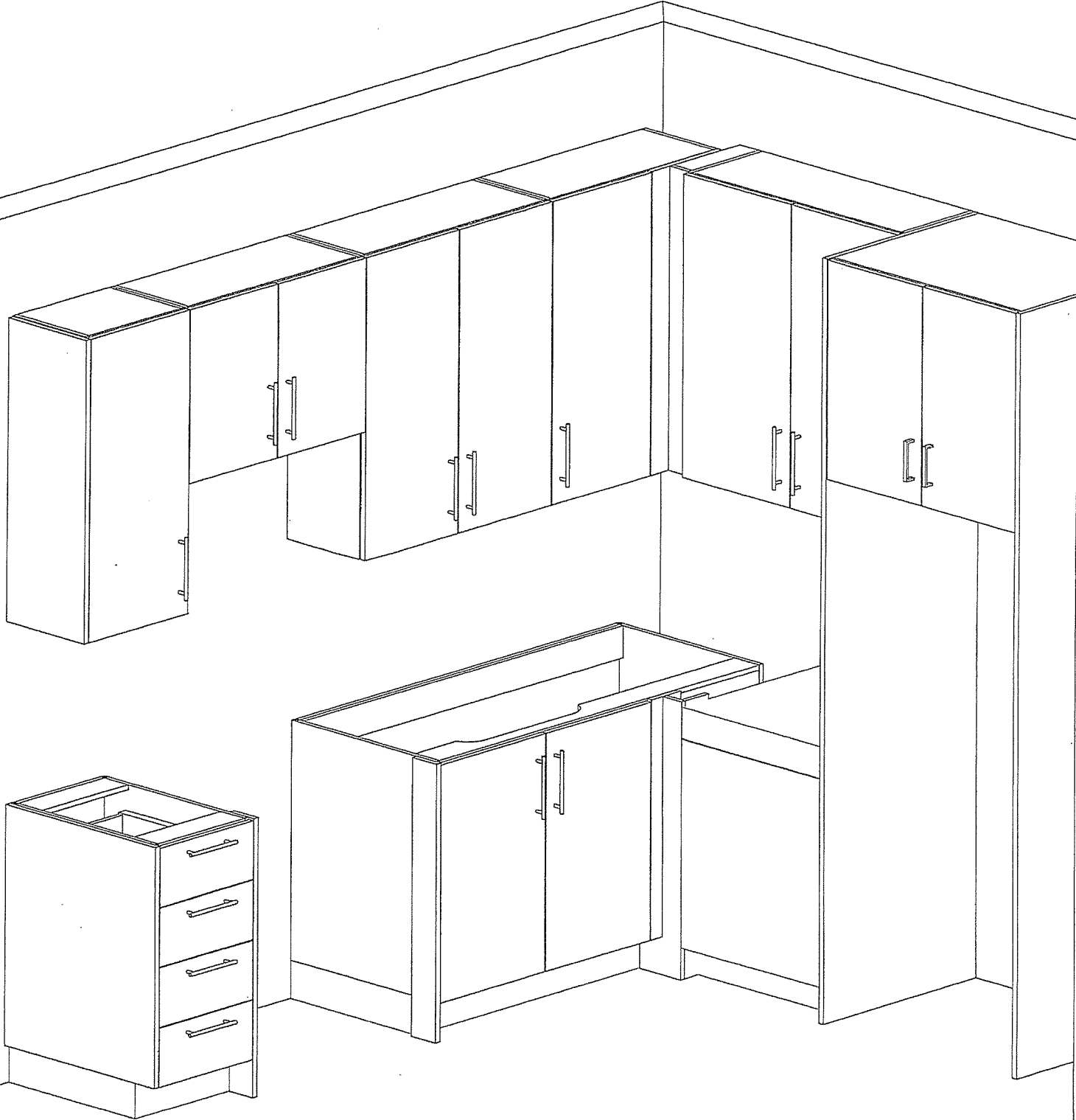
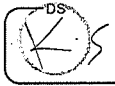
Customer Agrees and Accepts the following conditions: 1. The Drawing is a representation only and the installed cabinetry may vary slightly in product size, measurements, handle appearance and location and other details. Although Quality Tops & Kitchens Ltd. (QTK) does it's best to manufacture exactly what is shown here outside factors may prevent that and some variance is to be expected and accepted by the customer. 2. These drawings represent the intellectual property of QTK and as such the customer understands and accepts that all deposits given by the customer to QTK are non-refundable after QTK has supplied drawings (either physically or electronically) to the customer. If the customer decides to cancel the order after QTK has submitted drawings to the customer, the deposit will then be considered a design fee and no money will be returned to the customer.





your kitchen. your taste.

80 Sante Drive, Vaughan, ON L4K 3C4
T 416.746.1811 F 905.761.5901
www.QTK.ca info@qtk.ca

CLIENT: ROYAL PINE HOMES	JOB NAME: 1A, 1Aa (HAZEL), 1Ba (HAETHER)	ROOM: VANITY	DRAWN BY: GS
SITE: FORESTSIDE ESTATES	DOOR STYLE: QTS 1022	DOOR HANDLE: —	SCALE: 1/2" = 1'-0"
PHONE: —	FINISH: —	DRW HANDLE: —	DATE: JUNE 12, 2020
EMAIL: —	SPECIES: LAMINATE	TOP: —	PAGE:

COMMENTS: BUILDING A SUITE 115 BLK 2

Customer Agrees and Accepts the following conditions: 1. The Drawing is a representation only and the installed cabinetry may vary slightly in product size, measurements, handle appearance and location and other details. Although Quality Tops & Kitchens Ltd. (QTK) does it's best to manufacture exactly what is shown here outside factors may prevent that and some variance is to be expected and accepted by the customer. 2. These drawings represent the intellectual property of QTK and as such the customer understands and accepts that all deposits given by the customer to QTK are non-refundable after QTK has supplied drawings (either physically or electronically) to the customer. If the customer decides to cancel the order after QTK has submitted drawings to the customer, the deposit will then be considered a design fee and no money will be returned to the customer.

