

Lot 10

KitchenAid®
FOR THE WAY IT'S MADE. **Wall-Mount Canopy Range Hood**

PRODUCT MODEL NUMBERS

KVWB400D ~~KVWB406B~~

Electrical: A 120-volt, 60 Hz, AC only, 15-amp, fused electrical circuit is required.

PRODUCT DIMENSIONS

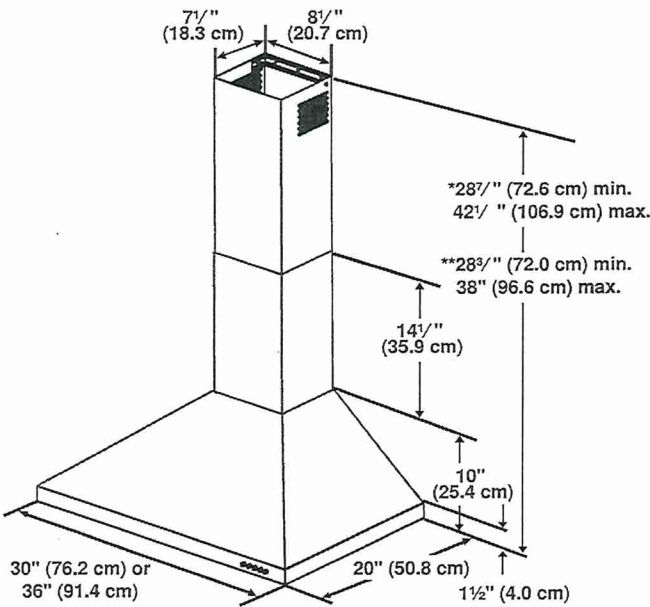

*For non-vented (recirculating) installations
**For vented installations

CABINET DIMENSIONS

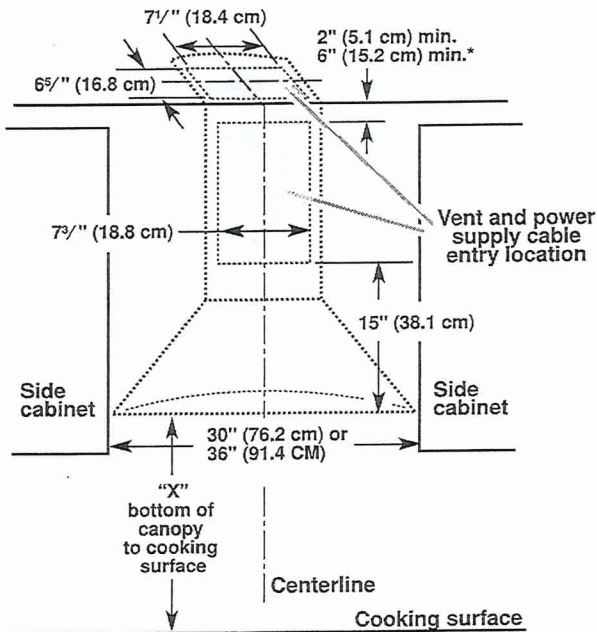

*For non-vented (recirculating) installations

IMPORTANT:

- Minimum distance "X": 24" (61.0 cm) from electric cooking surface.
- Minimum distance "X": 27" (68.6 cm) from gas cooking surfaces.
- Suggested maximum distance "X": 36" (91.4 cm)

The chimneys can be adjusted for different ceiling heights. See the following chart.

Vented Installations		
	Min. ceiling height	Max. ceiling height
Electric cooking surface	7' 5" (2.26 m)	9' 2" (2.79 m)
Gas cooking surface	7' 8" (2.34 m)	9' 2" (2.79 m)
Non-vented (recirculating) Installations		
	Min. ceiling height	Max. ceiling height
Electric cooking surface	7' 5" (2.26 m)	9' 6" (2.9 m)
Gas cooking surface	7' 8" (2.34 m)	9' 6" (2.9 m)

***NOTE:** The range hood chimneys are adjustable and designed to meet varying ceiling or soffit heights depending on the distance "X" between the bottom of the range hood and the cooking surface. For higher ceilings, a Stainless Steel Chimney Extension Kit Part Number W10337357 is available from your dealer or an authorized parts distributor. The chimney extension replaces the upper chimney shipped with the range hood.

VENTING METHODS

This canopy hood is factory set for venting through the roof or wall.
A 6" (15.2 cm) round vent system is needed for installation (not included).
The hood exhaust opening is 6" (15.2 cm) round.
NOTE: Flexible vent is not recommended. Flexible vent creates back pressure and air turbulence that greatly reduce performance.
Vent system can terminate either through the roof or wall. To vent through a wall, a 90° elbow is needed.

Rear discharge
A 90° elbow may be installed immediately above the hood.

For Non-Vented (recirculating) Installations
If it is not possible to vent cooking fumes and vapors to the outside, the hood can be used in the non-vented (recirculating) version, using a Recirculation Kit (which includes charcoal filters and a deflector). To order, see the "Assistance or Service" section.

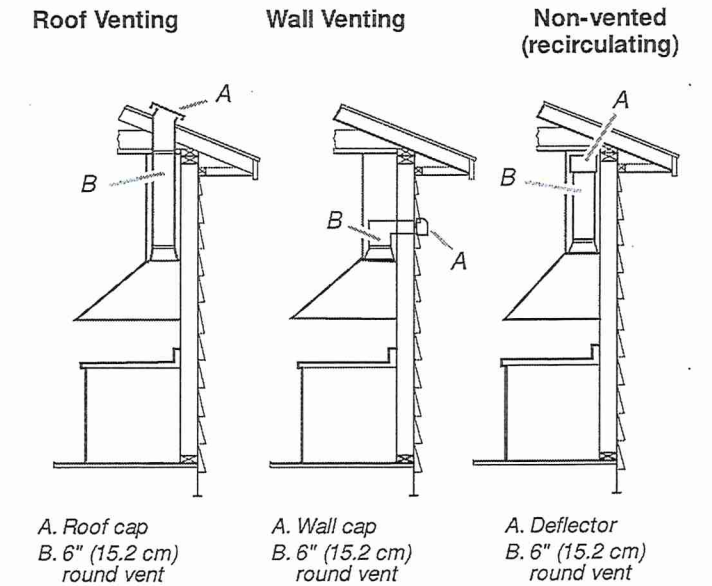

Calculating Vent System Length

To calculate the length of the system you need, add the equivalent feet (meters) for each vent piece used in the system.

Vent Piece	6" (15.2 cm)
45° elbow	2.5 ft (0.8 m)
90° elbow	5.0 ft (1.5 m)

Maximum equivalent vent length is 35 ft (10.7 m).

Example vent system

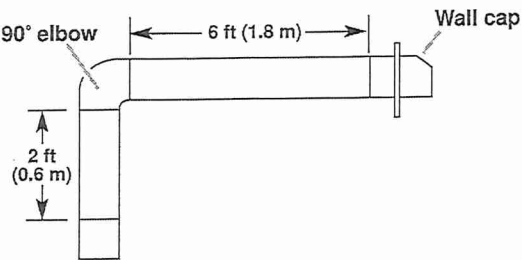

The following example falls within the maximum recommended vent length of 35 ft (10.7 m).

1 - 90° elbow	= 5.0 ft (1.5 m)
1 - wall cap	= 0.0 ft (0.0 m)
8 ft (2.4 m) straight	= 8.0 ft (2.4 m)
Length of system	= 13.0 ft (3.9 m)

LOT 10

INSTALLATION INSTRUCTIONS ~~27" (68.6 CM) AND 30" (76.2 CM) ELECTRIC~~ MICROWAVE/OVEN COMBINATION FLUSH INSTALLATION KIT

INSTRUCTIONS D'INSTALLATION POUR TROUSSE D'INSTALLATION EN AFFLEUREMENT D'UN ENSEMBLE FOUR À MICRO-ONDES ÉLECTRIQUE/FOUR DE 27" (68,6 CM) ET 30" (76,2 CM)

Flush Installation Kit Part Number Ensemble d'installation en affleurement référence	Size and Color Dimensions et couleur	UL Listed for Model Numbers Homologation UL pour les modèles numéro
W10752695	27" (68.6 cm), black 27" (66,6 cm), noir	KOCE507EBL
W10752694	27" (68.6 cm), white 27" (68,6 cm), blanc	KOCE507EWH
W10752696	27" (68.6 cm), stainless steel 27" (68,6 cm), acier inoxydable	KOCE507ESS
W10752688	30" (76.2 cm), black 30" (76,2 cm), noir	KOCE500EBL
W10752691	30" (76.2 cm), black stainless 30" (76,2 cm), noir inoxydable	KOCE500EBS, KOCE900HBS
W10752687	30" (76.2 cm), white 30" (76,2 cm), blanc	KOCE500EWH
W10752693	30" (76.2 cm), stainless steel 30" (76,2 cm), acier inoxydable	KOCE500ESS, KOCE900HSS

Table of Contents/Table des matières

BUILT-IN OVEN SAFETY.....	2	SÉCURITÉ DU FOUR ENCASTRÉ.....	9
INSTALLATION REQUIREMENTS.....	2	EXIGENCES D'INSTALLATION.....	9
Tools and Parts.....	2	Outillage et pièces.....	9
Location Requirements.....	2	Exigences d'emplacement.....	9
INSTALLATION INSTRUCTIONS.....	4	INSTRUCTIONS D'INSTALLATION.....	11
Prepare Built-In Microwave/Oven Combination.....	4	Préparation de l'ensemble des fours encastrés (micro-ondes/our).....	11
Remove Oven Door.....	4	Dépose de la/des porte du four.....	11
Replace Oven Door.....	5	Réinstallation de la/des porte du four.....	11
Positioning Oven Feet.....	5	Positionnement des pieds du four.....	12
Replace Plastic Spacers.....	6	Remplacement des cales d'espacement en plastique.....	13
Install Oven.....	7	Installation du four.....	14
Install Deflector Kit Bracket.....	7	Installation du support de la trousse du déflecteur.....	14
Complete Installation.....	8	Achever l'installation.....	15

IMPORTANT:

Save for local electrical inspector's use.

IMPORTANT :

À conserver pour consultation par l'inspecteur local des installations électriques.

W10720346C

Lot 10

KitchenAid®

27" (68.6 cm) and 30" (76.2 cm) Electric Built-In Microwave/Oven Combination

PRODUCT MODEL NUMBERS

~~KEMS309E~~ KOCE500E ~~KOCE507E~~

ELECTRICAL CONNECTION

If codes permit and a separate ground wire is used, it is recommended that a qualified electrical installer determine that the ground path and the wire gauge are in accordance with local codes.

Check with a qualified electrical installer if you are not sure the oven is properly grounded.

This oven must be connected to a grounded metal, permanent wiring system.

Be sure that the electrical connection and wire size are adequate and in conformance with the National Electrical Code, ANSI/NFPA 70-latest edition or CSA Standards C22.1-94, Canadian Electrical Code, Part 1 and C22.2 No. O-M91-latest edition, and all local codes and ordinances.

To properly install your oven, you must determine the type of electrical connection you will be using and follow the instructions provided for it here.

- Oven must be connected to the proper electrical voltage and frequency as specified on the model/serial/rating plate. See the following illustration.

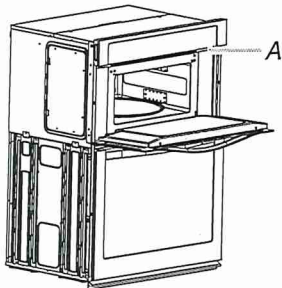

A. Model/serial/rating plate

- Models rated from 7.3 to 9.6 kW at 240 volts (5.4 to 7.4 kW at 208 volts) require a separate 40-amp circuit. Models rated at 4.8 kW and below at 240 volts (3.6 kW and below at 208 volts) require a separate 30-amp circuit.
- A circuit breaker is recommended.
- Connect directly to the fused disconnect (or circuit breaker box) through flexible, armored or nonmetallic sheathed, copper cable (with grounding wire). See "Make Electrical Connection" section.
- Flexible conduit from the oven should be connected directly to the junction box.
- Do not cut the conduit. The length of conduit provided is for serviceability of the oven.
- A UL listed or CSA approved conduit connector must be provided.
- If the house has aluminum wiring, follow the procedure below:
 - Connect a section of solid copper wire to the pigtail leads.
 - Connect the aluminum wiring to the added section of copper wire using special connectors and/or tools designed and UL listed for joining copper to aluminum.

Follow the electrical connector manufacturer's recommended procedure. Aluminum/copper connection must conform with local codes and industry accepted wiring practices.

For power requirements, refer to the following table.

Model	Voltage	Amperage (L1)*	Amperage (L2)*	Rating (W)
KOCE507E /KOCE500E	120/240	32	30	8000
KOCE507E /KOCE500E	120/208	30	28	6600

*Amperage values noted above are for information purposes only: the units are rated in watts.

Because Whirlpool Corporation includes a continues commitment to improve our products, we reserve the right to change materials and specifications without notice.

PRODUCT DIMENSIONS

27" (68.6 cm) M ODELS
A. 42⁵/₁₆" (108.0 cm) overall height
B. 25⁷/₁₆" (64.6 cm) recessed width
C. 41" (104.1 cm) recessed height
D. 23³/₄" (59.1 cm) max. recessed depth
E. 27" (68.6 cm) overall width
F. 48" (121.9 cm) flexible conduit length measured from the conduit clamp located at the rear of the oven. Do not remove the conduit clamp.

30" (76.2 cm) M ODELS
A. 42⁵/₁₆" (108.0 cm) overall height
B. 28⁷/₁₆" (72.3 cm) recessed width
C. 41" (104.1 cm) recessed height
D. 23³/₄" (59.1 cm) max. recessed depth
E. 30" (76.2 cm) overall width
F. 48" (121.9 cm) flexible conduit length measured from the conduit clamp located at the rear of the oven. Do not remove the conduit clamp.

Cabinet Dimensions

27" (68.6 cm) M ODELS
A. 27" (68.6 cm) min. cabinet width
B. 1" (2.5 cm) top of cutout to bottom of upper cabinet door
C. 19¹/₄" (48.9 cm) bottom of cutout to floor is recommended. 4"-19¹/₄" (10.2-48.9 cm) bottom of cutout to floor is acceptable.
D. 25¹/₂" (64.8 cm) cutout width
E. 1¹/₂" (3.8 cm) min. bottom of cutout to top of cabinet door
F. 41⁵/₁₆" (105 cm)* recommended cutout height
G. 24" (60.7 cm) cutout depth

30" (76.2 cm) M ODELS
A. 30" (76.2 cm) min. cabinet width
B. 1" (2.5 cm) top of cutout to bottom
C. 19¹/₄" (48.9 cm) bottom of cutout to floor is recommended. 4"-19¹/₄" (10.2-48.9 cm) bottom of cutout to floor is acceptable.
D. 28¹/₂" (72.4 cm) cutout width
E. 1¹/₂" (3.8 cm) min. bottom of cutout
F. 41⁵/₁₆" (105 cm)* recommended cutout
G. 24" (60.7 cm) cutout depth

* NOTE: The cabinet height can be between 41" (104.1 cm) and 41¹/₂" (105.6 cm) for microwave/oven combination.

Dimensions are for planning purposes only. For complete details, see Installation Instructions packed with product. Specifications subject to change without notice.

Ref. W10725683B
2/10/15

Lot 10

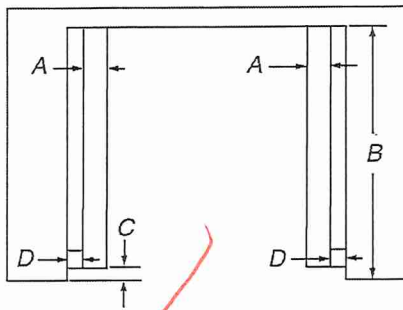

Top View

27" (68.6 cm) models

- A. 2" (5.1 cm) spacer the entire depth of the cutout*
- B. 25" (63.5 cm) depth of cutout
- C. 1½" (3.5 cm) recess from front of cabinet
- D. 11/16" (1.7 cm) side cleat*

30" (76.2 cm) models

- A. 2" (5.1 cm) spacer the entire depth of the cutout*
- B. 25" (63.5 cm) depth of cutout
- C. 1½" (3.5 cm) recess from front of cabinet
- D. 11/16" (1.7 cm) side cleat*

*Cleats and spacers must be recessed 1⅜" (3.5 cm) from the front of the cabinet.

Electrical Requirements

⚠ WARNING

Electrical Shock Hazard
Electrically ground appliance.
Failure to do so could result in death, fire, or electrical shock.

If codes permit and a separate ground wire is used, it is recommended that a qualified electrical installer determine that the ground path and the wire gauge are in accordance with local codes.

Check with a qualified electrical installer if you are not sure the oven is properly grounded.

This oven must be connected to a grounded metal, permanent wiring system.

Be sure that the electrical connection and wire size are adequate and in conformance with the National Electrical Code, ANSI/NFPA 70-latest edition or CSA Standards C22.1-94, Canadian Electrical Code, Part 1 and C22.2 No. O-M91-latest edition, and all local codes and ordinances.

A copy of the above code standards can be obtained from:

National Fire Protection Association
1 Batterymarch Park
Quincy, MA 02169-7471

CSA International
8501 East Pleasant Valley Road
Cleveland, OH 44131-5575

Electrical Connection

To properly install your oven, you must determine the type of electrical connection you will be using and follow the instructions provided for it here.

- Oven must be connected to the proper electrical voltage, amperage, and frequency as specified on the model/serial/rating plate. See the following illustration.

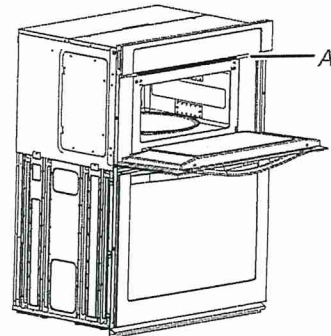

A. Model/serial/rating plate

- Models rated from 7.3 to 9.6 kW at 240 V (6.3 to 8.3 kW at 208 V) require a separate 40 A circuit. Models rated from 4.9 to 7.2 kW at 240 V (4.3 to 6.2 kW at 208 V) require a separate 30 A circuit. Models rated at 4.8 kW and below at 240 V (4.2 kW and below at 208 V) require a separate 20 A circuit.
- A circuit breaker is recommended.
- Connect directly to the fused disconnect (or circuit breaker box) through flexible, armored or nonmetallic sheathed, copper cable (with grounding wire). See the "Make Electrical Connection" section.
- Flexible conduit from the oven should be connected directly to the junction box.
- Do not cut the conduit. The length of conduit provided is for serviceability of the oven.
- A UL listed or CSA approved conduit connector must be provided.
- If the house has aluminum wiring, follow the procedure below:
Connect the aluminum wiring using special connectors and/or tools designed and UL listed for joining copper to aluminum.
Follow the electrical connector manufacturer's recommended procedure. Aluminum/copper connection must conform with local codes and industry accepted wiring practices.
Be sure that the electrical connection and wire size are adequate and in conformance with the National Electrical Code, ANSI/NFPA 70-latest edition or CSA Standards C22.1-94, Canadian Electrical Code, Part 1 and C22.2 No. O-M91-latest edition, and all local codes and ordinances. A copy of the above code standards can be obtained from: National Fire Protection Association 1 Batterymarch Park Quincy, MA 02169-7471 CSA International 8501 East Pleasant Valley Road Cleveland, OH 44131-5575.

LOTIO

Deflector Bracket Dimensions

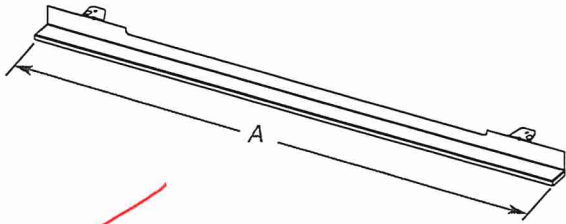

~~27" (68.6 cm) Models~~

~~A. 26¹⁵/₁₆" (68.4 cm) overall width~~

30" (76.2 cm) Models

A. 29¹⁵/₁₆" (76.0 cm) overall width

Cabinet Dimensions - Flush Installations

A 25" (63.5 cm) minimum cutout depth is required.

These dimensions will result in a 1/4" (6 mm) reveal on the top, a 1/4" (6 mm) reveal on the sides, and a 1/8" (3 mm) reveal on the bottom of the wall oven.

The front face of the cleats and platform will be visible and should be treated as a finished surface.

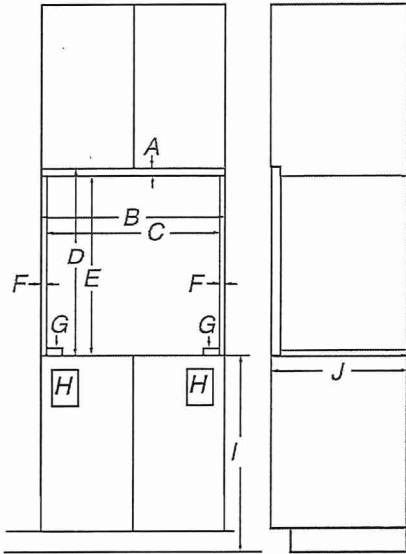

Front View

Side View

~~27" (68.6 cm) Models~~

- ~~A. 5/8" (1.6 cm) top cleat*~~
- ~~B. 27¹/₄" (69.2 cm) minimum width of flush inset cutout~~
- ~~C. 25⁷/₈" (65.7 cm) minimum width of opening~~
- ~~D. 43¹/₈" (109.5 cm) minimum height of flush inset cutout~~
- ~~E. 42¹/₂" (107.9 cm) recommended cutout height~~
- ~~F. 1¹/₁₆" (1.7 cm) side cleat*~~
- ~~G. 1/2" x 2" (1.3 cm x 5.1 cm) spacer the entire depth of the cutout*~~
- ~~H. Recommended junction box location~~
- ~~I. 4⁵/₈" - 19¹/₄" (11.7 - 48.9 cm) bottom of cutout to floor~~
- ~~J. 25" (63.5 cm) minimum depth of cutout~~

30" (76.2 cm) Models

- A. 5/8" (1.6 cm) top cleat*
- B. 30¹/₄" (76.8 cm) minimum width of flush inset cutout
- C. 28⁷/₈" (73.3 cm) minimum width of opening
- D. 43¹/₈" (109.5 cm) minimum height of flush inset cutout
- E. 42¹/₂" (107.9 cm) recommended cutout height
- F. 1¹/₁₆" (17 mm) side cleat*
- G. 1/2" x 2" (1.3 cm x 5.1 cm) spacer the entire depth of the cutout*
- H. Recommended junction box location
- I. 4⁵/₈" - 19¹/₄" (11.7 - 48.9 cm) bottom of cutout to floor
- J. 25" (63.5 cm) minimum depth of cutout

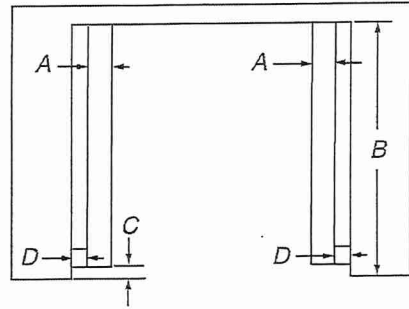

Top View

~~27" (68.6 cm) Models~~

- ~~A. 1/2" x 2" (1.3 cm x 5.1 cm) spacer the entire depth of the cutout*~~
- ~~B. 25" (63.5 cm) depth of cutout~~
- ~~C. 1³/₈" (3.5 cm) recess from front of cabinet~~
- ~~D. 1¹/₁₆" (1.7 cm) side cleat*~~

30" (76.2 cm) Models

- A. 1/2" x 2" (1.3 cm x 5.1 cm) spacer the entire depth of the cutout*
- B. 25" (63.5 cm) depth of cutout
- C. 1³/₈" (3.5 cm) recess from front of cabinet
- D. 1¹/₁₆" (1.7 cm) side cleat*

*Cleats and spacers must be recessed 1³/₈" (3.5 cm) from the front of the cabinet.

*Cleats and spacers must be recessed 1³/₈" (3.5 cm) from the front of the cabinet.

LOT 10

Make Electrical Connection

IMPORTANT: For Flush installation before making electrical connection, the oven feet or spacers need to be installed to allow a microwave/oven combination to be installed in a recommended cutout height. Please contact service for feet to be shipped to you free of charge.

⚠WARNING



Electrical Shock Hazard

Disconnect power before servicing.

Use 8 gauge copper wire.

Electrically ground oven.

Failure to follow these instructions can result in death, fire, or electrical shock.

- This oven is manufactured with a neutral (white) power supply wire and a cabinet-connected green (or bare) ground wire.
1. Disconnect power.
 2. Feed the flexible conduit from the oven through the opening in the cabinet.
 3. Remove junction box cover, if it is present.
 4. Install a UL listed or CSA approved conduit connector to the junction box.

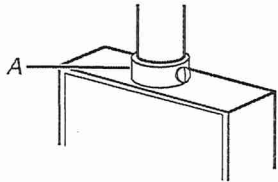

A. UL listed or CSA approved conduit connector

5. Route the flexible conduit from the oven to the junction box through a UL listed or CSA approved conduit connector.
6. Tighten screws on conduit connector.
7. See "Electrical Connection Options Chart" to complete installation for your type of electrical connection.

Electrical Connection Options Chart

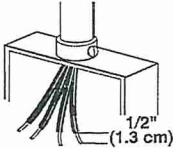
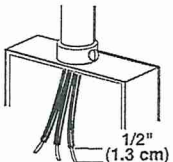
If your home has:	Go to section:
4-wire	4-Wire Cable from Home Power Supply
	
3-wire	3-Wire Cable from Home Power Supply
	

4-Wire Cable from Home Power Supply

IMPORTANT: Use the 4-wire cable from home power supply in the U.S. where local codes do not allow grounding through neutral, New Branch circuit installations (1996 NEC), mobile homes and recreational vehicles, new construction and in Canada.

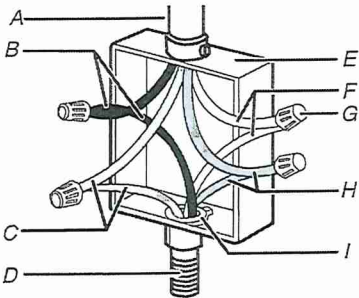

- | | |
|--------------------------------------|--|
| A. Cable from home power supply | F. White wires |
| B. Black wires | G. UL listed wire connectors |
| C. Red wires | H. Green (or bare) ground wires |
| D. 4-wire flexible conduit from oven | I. UL listed or CSA approved conduit connector |
| E. Junction box | |
1. Connect the 2 black wires (B) together using a UL listed wire connector.
 2. Connect the 2 red wires (C) together using a UL listed wire connector.
 3. Connect the 2 white wires (F) together using a UL listed wire connector.
 4. Connect the green (or bare) ground wire (H) from the oven cable to the green (or bare) ground wire (in the junction box) using a UL listed wire connector.
 5. Install junction box cover.

Lot 10

KitchenAid®

24" Dishwasher

DETAILED PLANNING DIMENSIONS GUIDE

Applies to all model numbers starting with;

KDFE104K, KDTE104K, KDFE204K, KDTE204K, KDTE304LPA,
KDFM404K, KDTM404K, KDPM604K, KDTM604K, KDPM704K,
KDTM704K, KDTM704LPA, KDPM804K, KDTM804K, KDFE105P***,
KDTM405P***

PRODUCT DIMENSIONS

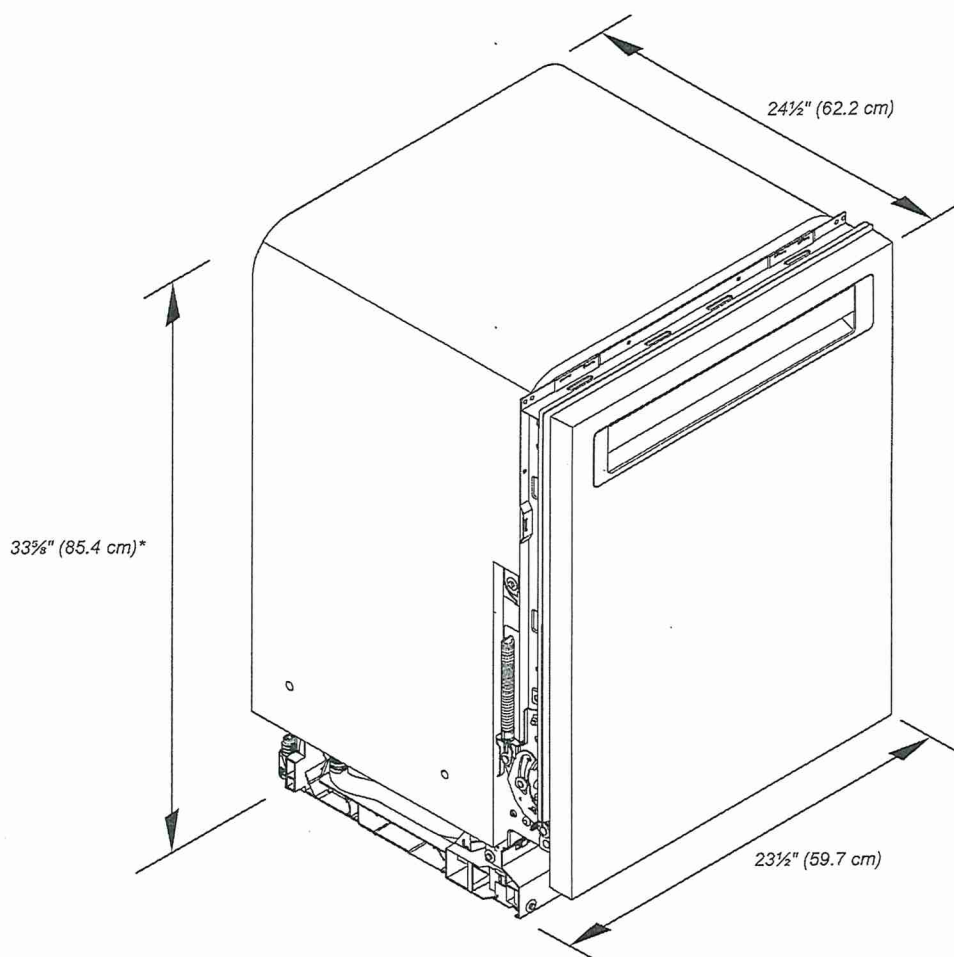

*Dishwasher can be raised 1 7/8" (3.7 cm) with feet fully extended.

Because Whirlpool Corporation policy includes a continuous commitment to improve our products, we reserve the right to change materials and specifications without notice.

W11409323D

Dimensions are for planning purposes only. For complete details, see Installation Instructions packed with product. Specifications subject to change without notice.

Lot 10

KitchenAid®

24" Dishwasher
DETAILED PLANNING DIMENSIONS GUIDE

PRODUCT DIMENSIONS (CONTD.)

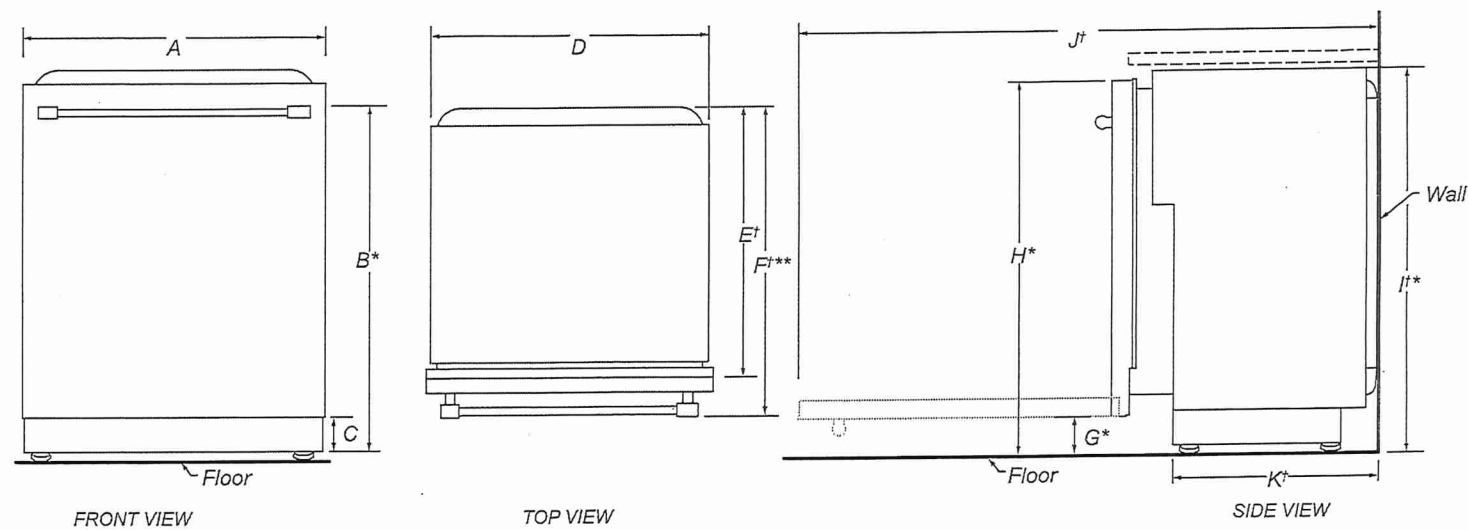

	DESCRIPTION	DIMENSIONS
A	Width of door	23½" (59.7 cm)
B*	Height to top of handle	30⅜" (78.3 cm)
C	Height of adjustable toe kick	3⅝" (8.4 cm) - minimum 4⅞" (11.8 cm) - maximum
D	Width of recessed dishwasher	22⅝" (57.4 cm)
E†	Depth without door	22⅝" (57.5 cm)
F†**	Depth with Towel Bar Handle	26⅞" (68.3 cm)
	Depth with Pocket Handle	24½" (62.6 cm)
	Depth of Panel-Ready Models	24" (61.0 cm)
G*	Height to bottom of door (minimum)	3⅝" (8.4 cm)
H*	Height to top of door (minimum)	33⅞" (84.9 cm)
I†*	Height of recessed dishwasher (minimum)	33⅝" (85.4 cm)
J†	Depth with door fully open (minimum)	50⅜" (127.4 cm)
K†	Depth with toe kick (minimum)	20⅜" (52.9 cm)

†Insulation blanket thickness not included, can be crushed up to 1/8" (0.3 cm), or removed along the top perforate section for additional clearance.

*Dishwasher can be raised 1⅞" (3.7 cm) with feet fully extended.

**For panel-ready models; dishwasher depth is 24" (61.0 cm), not including the ¾" (1.9 cm) custom door panel.

Because Whirlpool Corporation policy includes a continuous commitment to improve our products, we reserve the right to change materials and specifications without notice.

Dimensions are for planning purposes only. For complete details, see Installation Instructions packed with product. Specifications subject to change without notice.

LOT 10

KitchenAid® 24" Dishwasher

DETAILED PLANNING DIMENSIONS GUIDE

OPENING/CLEARANCE DIMENSIONS

IMPORTANT: Check that all surfaces have no protrusions that would prohibit dishwasher installation.

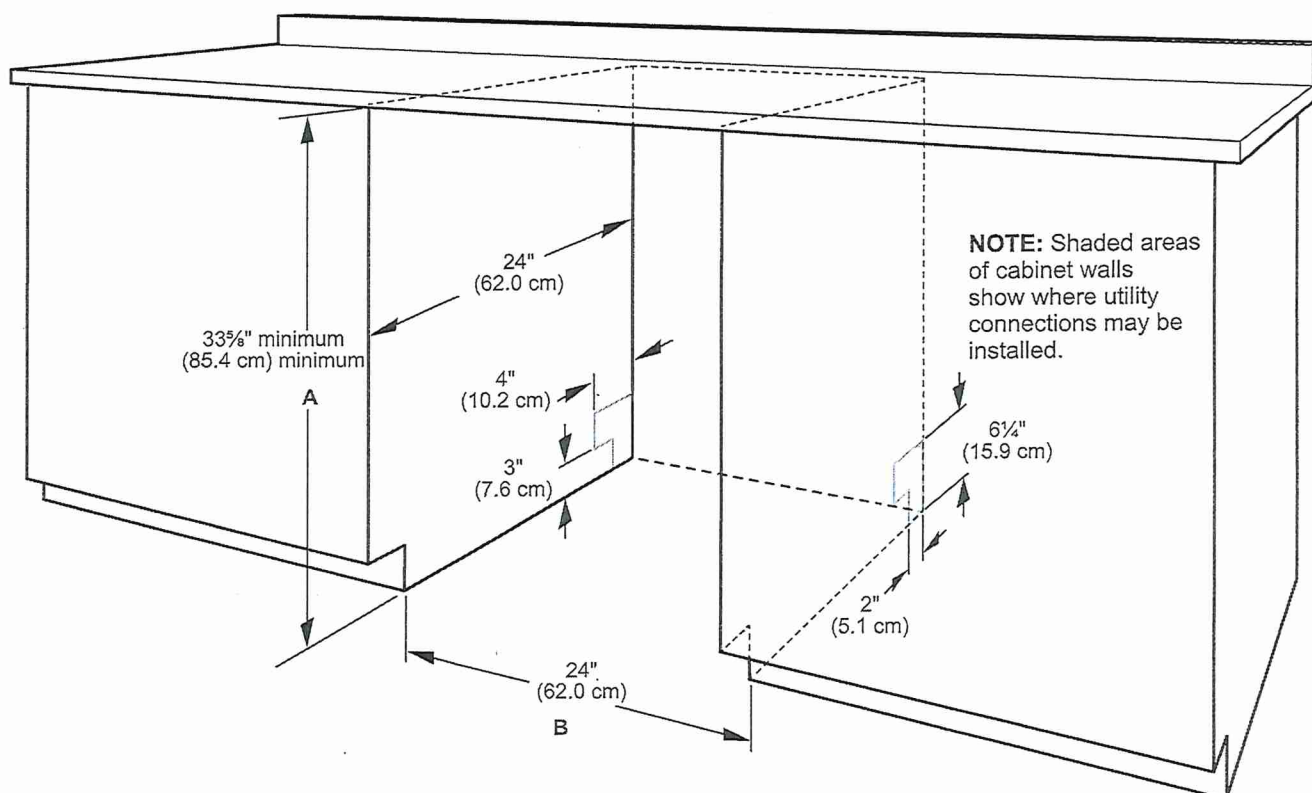

A. Measured from the lowest point on the underside of the countertop. May be reduced to 33 5/8" minimum (85.4 cm) minimum by removing the feet and perforated area of insulation (blanket) on dishwasher.

B. Minimum, measured from narrowest point of opening.

NOTE: Corner locations require a 2" (5.1 cm) minimum clearance between the side of the dishwasher door and the wall or cabinet.

Because Whirlpool Corporation policy includes a continuous commitment to improve our products, we reserve the right to change materials and specifications without notice.

Dimensions are for planning purposes only. For complete details, see Installation Instructions packed with product. Specifications subject to change without notice.

Lot 10.

DIMENSIONS

FREE-STANDING RANGES

PRODUCT DIMENSIONS

MODEL#	30" (76.2 cm) Slide-In Dual Fuel Range YKSDB900E	
Unit of Measurement	in	cm
Overall Width (A)	29 ⁷ / ₈	75.9
Grates Height (B)	2 ³ / ₁₆	5.6
Control Panel Height (C)	5 ⁵ / ₁₆	13.5
Door Height (D)	20 ¹¹ / ₁₆	52.6
Door Bottom to Handle Top (E)	20	50.8
Drawer Height (F)	5 ¹ / ₂	14

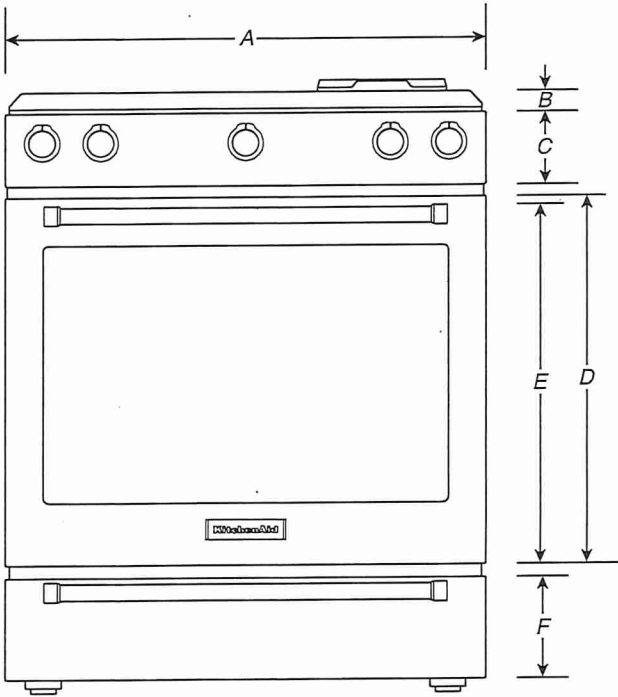

FRONT VIEW

IMPORTANT: Dimensional specifications are provided for planning purposes only.
Do not make any cutouts based on this information. Refer to the Installation Guide before selecting cabinetry, verifying electrical/gas connections, making cutouts or beginning installation.
All KitchenAid® appliances are appropriately UL, CUL or CSA approved.

KitchenAid®

W11405734A

Lot 10

DIMENSIONS

FREE-STANDING RANGES

PRODUCT DIMENSIONS

MODEL #	30" (76.2 cm) Slide-In Dual Fuel Range YKSDB900E	
Unit of Measurement	in	cm
Depth with Control Panel Overhang (G)	27¾	70.5
Depth with Handle (H)	30¼	76.9
Depth with Door Fully Open (I)	46½	118.1

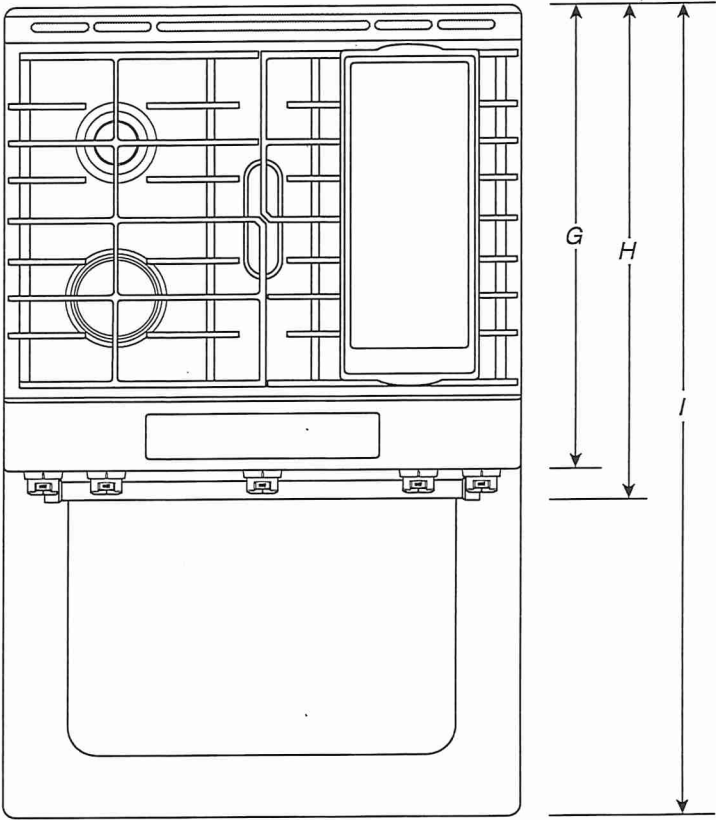

TOP VIEW

IMPORTANT: Dimensional specifications are provided for planning purposes only.
Do not make any cutouts based on this information. Refer to the Installation Guide before
selecting cabinetry, verifying electrical/gas connections, making cutouts or beginning installation.
All KitchenAid® appliances are appropriately UL, CUL or CSA approved.



60710

DIMENSIONS

FREE-STANDING RANGES

PRODUCT DIMENSIONS

MODEL #	30" (76.2 cm) Slide-In Dual Fuel Range YKSDB900E	
Unit of Measurement	in	cm
Griddle Top Height (A)	37 ⁹ / ₁₆	94.5
Cooking Surface Top Height (B)	36	91.4
Door Top Height (C)	27 ⁷ / ₈	70.8
Handle Top Height (D)	27 ¹ / ₈	68.9
Drawer Height (E)	6 ⁵ / ₈	16.9
OTHER DIMENSIONS		
Maximum Feet Extension Height*	1 ¹ / ₂	3.8

* **IMPORTANT:** Minimum height dimensions are at the lowest point of the height adjustment range. When the leveling legs are fully extended, all heights have 1½" (3.8 cm) of added height.

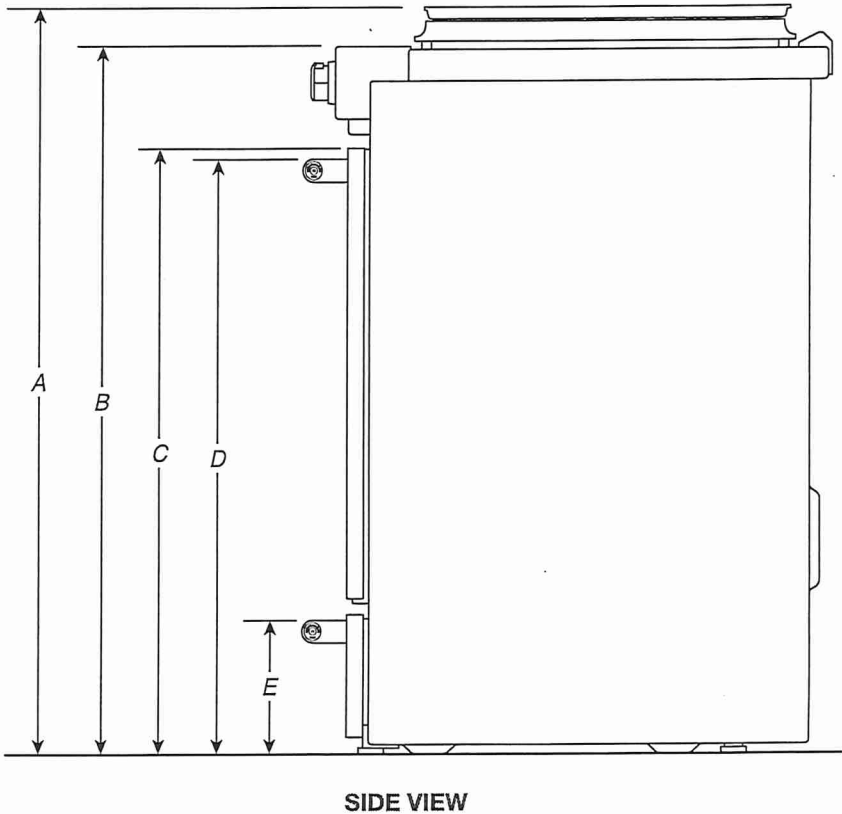

IMPORTANT: Dimensional specifications are provided for planning purposes only. Do not make any cutouts based on this information. Refer to the Installation Guide before selecting cabinetry, verifying electrical/gas connections, making cutouts or beginning installation. All KitchenAid® appliances are appropriately UL, CUL or CSA approved.

KitchenAid®

Lot 10

DIMENSIONS

FREE-STANDING RANGES

PRODUCT DIMENSIONS

MODEL #	30" (76.2 cm) Slide-In Dual Fuel Range YKSDB900E	
Unit of Measurement	in	cm
Depth with Door Fully Open (F)	46½	118.1
Depth with Handle (G)	30¾	76.9
Depth with Control Panel Overhang (H)	27¾	70.5
Depth to Drawer with Door (I)	27	68.6
Depth with Door (J)	27	68.6
Gas Vent Height (K)	39	91.1

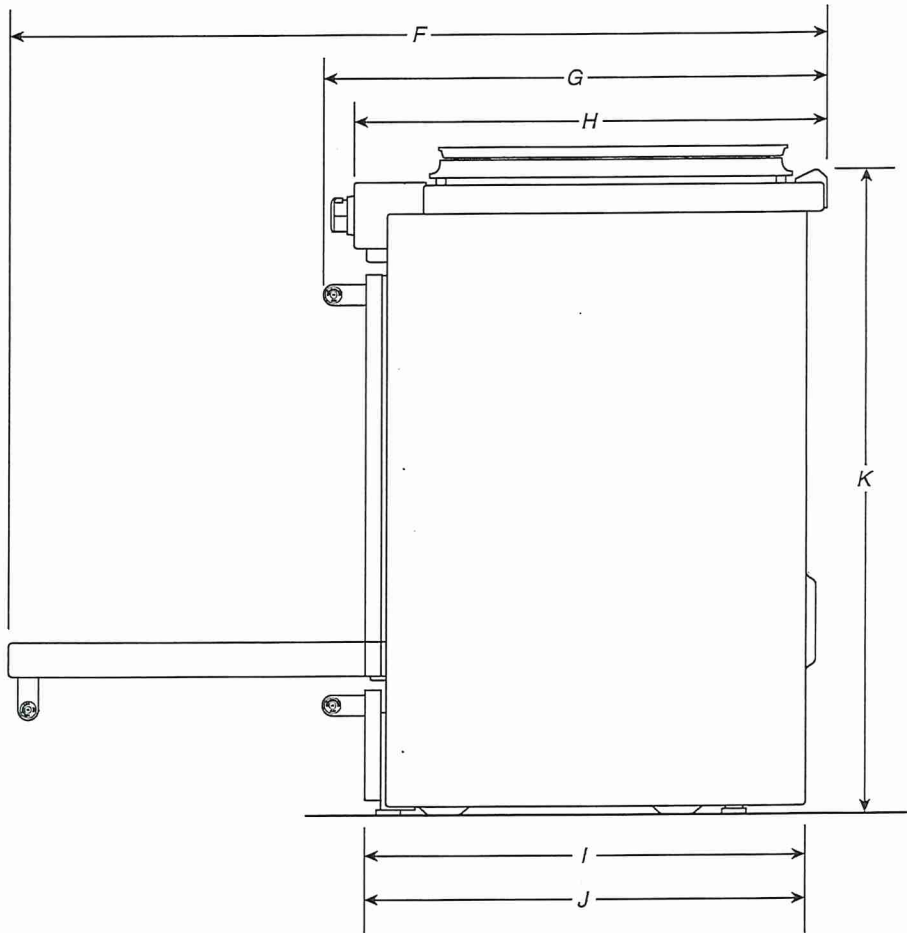

SIDE VIEW

IMPORTANT: Dimensional specifications are provided for planning purposes only.
Do not make any cutouts based on this information. Refer to the Installation Guide before selecting cabinetry, verifying electrical/gas connections, making cutouts or beginning installation.
All KitchenAid® appliances are appropriately UL, CUL or CSA approved.



LOT 10

DIMENSIONS

FREE-STANDING RANGES

OPENING/CLEARANCE DIMENSIONS

MODEL #	30" (76.2 cm) Slide-In Dual Fuel Range YKSDB900E	
Unit of Measurement	in	cm
Combustible Area above Cooking Surface Width (min.) (A)	30	76.2
Bottom of Cabinet Height above Cooking Surface (min.) (B)*	30	76.2
Bottom of Cabinet Height above Countertop (min.) (C)	18	45.7
Distance to Fixed Wall or Combustible Material (min.) (D)	5	12.7
Opening Width (min.) (E)	30	76.2

* If installing a hood or hood liner above the range, follow the hood or hood liner instructions for dimensional clearances above the cooking surface.

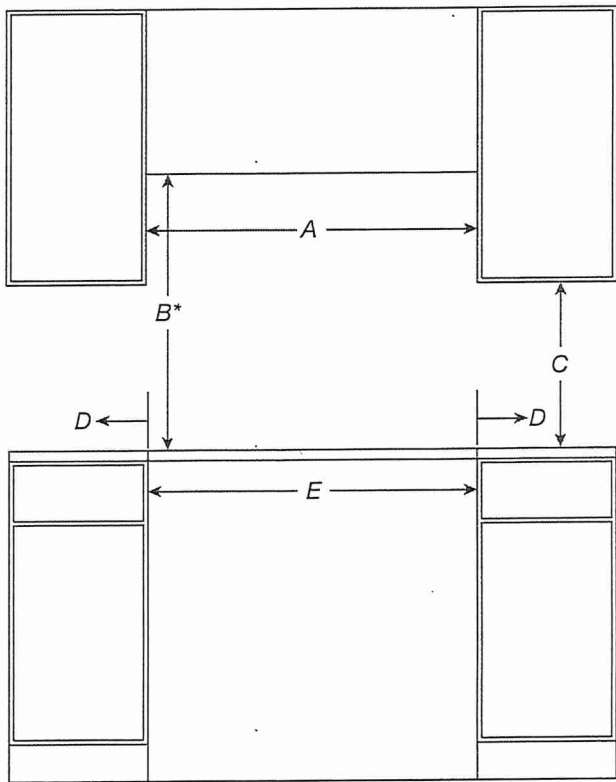

FRONT VIEW

IMPORTANT: Dimensional specifications are provided for planning purposes only. Do not make any cutouts based on this information. Refer to the Installation Guide before selecting cabinetry, verifying electrical/gas connections, making cutouts or beginning installation. All KitchenAid® appliances are appropriately UL, CUL or CSA approved.



LOT 10

DIMENSIONS

FREE-STANDING RANGES

OPENING/CLEARANCE DIMENSIONS

MODEL #	30" (76.2 cm) Slide-In Dual Fuel Range YKSDB900E	
Unit of Measurement	In	cm
Upper Cabinet Depth (max.) (F)	13	33
Distance from Grates to Wall (G)	1½	3.8
Depth from Wall to back of Unit**	0	0

* If the back wall is constructed of a combustible material and a backsplash is not installed a 7½" (19.1 cm) minimum clearance is required.

** If the back wall is constructed of a combustible material and a backsplash is not installed a 6" (15.2 cm) minimum clearance is required.

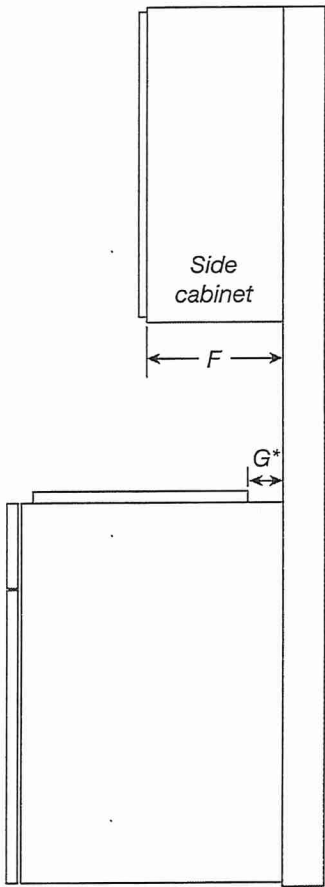

SIDE VIEW

IMPORTANT: Dimensional specifications are provided for planning purposes only.
Do not make any cutouts based on this information. Refer to the Installation Guide before selecting cabinetry, verifying electrical/gas connections, making cutouts or beginning installation.
All KitchenAid® appliances are appropriately UL, CUL or CSA approved.



Lot 10

DIMENSIONS

FREE-STANDING RANGES

GAS REQUIREMENTS

MODEL #	30" (76.2 cm) Slide-In Dual Fuel Range YKSDB900E	
Unit of Measurement	in	cm
Gas Opening Width (A)	11	27.9
Gas Opening Height (B)	17	43.2
Gas Opening Depth (C)	2	5.1
Distance from Side Cabinet to Gas Opening (D)	4½	11.4
Width to Gas Inlet (E)	12¾	32.4

RECOMMENDED GAS ZONE

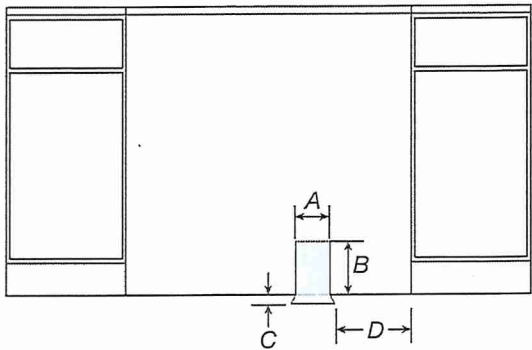

FRONT VIEW

WIDTH TO GAS INLET

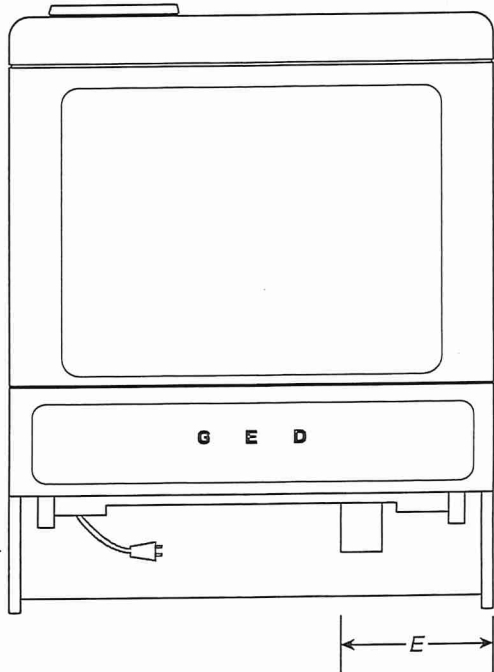

BACK VIEW

NOTE: If you have questions about your gas supply, call a licenced, qualified service technician.

IMPORTANT: Dimensional specifications are provided for planning purposes only.
Do not make any cutouts based on this information. Refer to the Installation Guide before selecting cabinetry, verifying electrical/gas connections, making cutouts or beginning installation.
All KitchenAid® appliances are appropriately UL, CUL or CSA approved.

KitchenAid®

Lot 10

Installation

Step-by-step installation

STEP 1 Select a site

- The site must:
- Have a solid level surface without carpeting or flooring that may obstruct ventilation
 - Be out of direct sunlight
 - Have adequate room for opening and closing the door
 - Be away from any heat source
 - Provide room for maintenance and servicing
 - Have a temperature range between 50 °F (10 °C) and 110 °F (43 °C)

Clearance
See the pictures and table below and on the next page for installation space requirements.

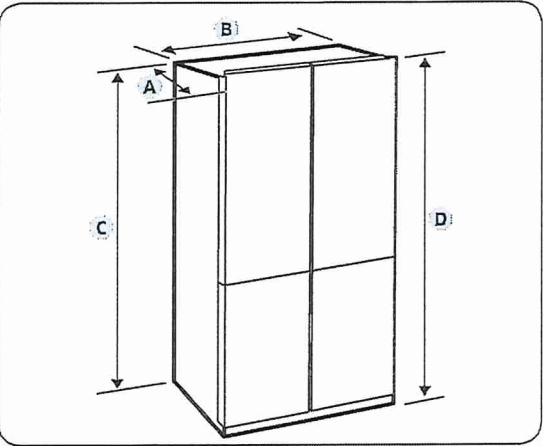

Model	RF29A977***	RF23A977***
Depth "A"	33 7/8" (861 mm)	28 1/2" (723 mm)
Width "B"	35 7/8" (912 mm)	35 7/8" (912 mm)
Height "C"	70 3/4" (1797 mm)	70 3/4" (1797 mm)
Overall Height "D"	71 7/8" (1825 mm)	71 7/8" (1825 mm)

LOT 10

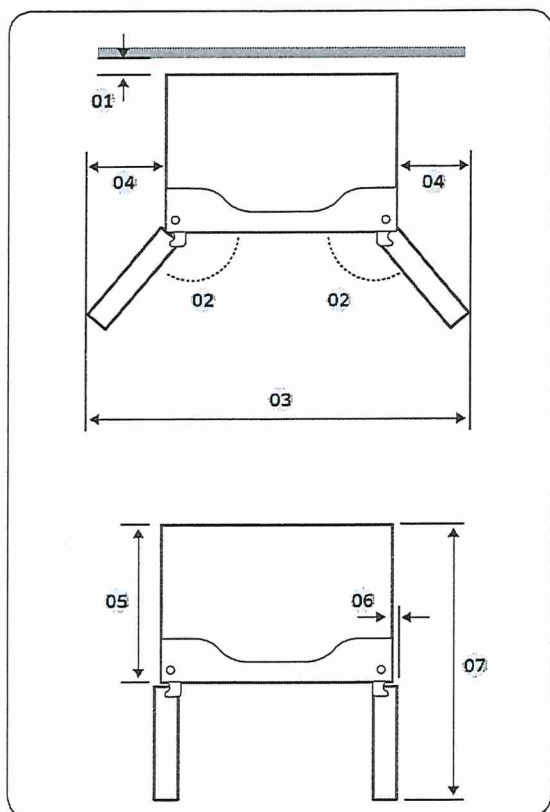

Model	RF29A977***	RF23A977***
01	more than 50 mm recommended	
02	125°	125°
03	58" (1472 mm)	58" (1472 mm)
04	11 1/8" (282 mm)	11 1/8" (282 mm)
05	29 3/8" (748 mm)	24" (610 mm)
06	1 7/8" (47 mm)	1 7/8" (47 mm)
07	48 1/2" (1231 mm)	43" (1093 mm)

NOTE

The measurements of your refrigerator may differ from those listed above, depending on the measuring method.





CONSTRUCTION SUMMARY

Forestside Estates Inc.

PURCHASERS: DALBIR SINGH OTAL and DALBIR ,KAUR OTAL

TEL:

LOT NUMBER	PHASE	HOUSE TYPE	CLOSING DATE
10	8	BLUE ELDER (38-03C) - ELEV C	20-Aug-24

Date Added: 29-Jan-24

Invoice Number: 8590

1 - Install standard Cable / Cat 6, Telephone (See Sketch)

Note:

1 - GARAGE DOOR- Install the builders standard garage door handle with lock

Note:

1 - MAIN FLOOR/UPPER HALL- Install an Upgrade #2 hardwood floor, in lieu of the builders standard. Install the Vintage Red Oak 5"x3/4" TITAN WireBrushed UVF, Installed on /main Hall, Family Room, Living/ Dining Room, Den, Upper Hall and applicable landings

Note:

1 - STAIRS-Stain the Step, Riser, applicable stringer, Railing and Post to Vintage Red Oak TITAN , throughout the staircase, where applicable

Note:

1 - STAIRCASE VS FLOORING STAINING DIFFERENCE: The purchaser accepts and acknowledges that the flooring is prefinished & the staircase is Red Oak with hand-applied finish, along with the unique qualities of natural wood can create an unbalanced look.

Note:

1 - KITCHEN- Install a LEVEL 2 cabinet, throughout the kitchen, where applicable. Install the SLIM SHAKER MDF "CHANTILLY LACE"

Note:

1 - KITCHEN- Install an Upgrade #2 counter top throughout the kitchen, where applicable, in lieu of the builder standard. Install the Emmerstone BORGHINI D'ORO

Note:

1 - KITCHEN- Install an Upgrade "L" Edge for the kitchen

Note:

1 - KITCHEN- Install an upgraded undermount sink for the kitchen. Install the KINDRED "BROOKMOORE" BSU1831-9

Note: **Install standard faucet**

1 - POWDER ROOM- Install an Upgrade #3 cabinet in the Powder Room. Install the SHAKER WIDE RAIL MDF "WROUGHT IRON"

Note:

1 - POWDER ROOM-Install an Upgrade #3 counter top throughout the Powder Room where applicable, in lieu of the builder standard. Install the Emmerstone BORGHINI CLASSIC

Note:

1 - POWDER ROOM- Install an Upgrade "L" Edge for the Powder Room

Note:

1 - POWDER ROOM- Install an undermount sink for teh powder room. Install the CONTRAC "CATENA" Model # 4210CIY (X1 SINK) **Install standard faucet**

Note:

1 - POWDER ROOM- Accomodate the counter top for undermount sink- Cut and Polish Fee (x1 Sink)

Note:

1 - PRIMARY ENSUITE- Install an Upgrade #2 cabinet in the Primary Ensuite Install the SHAKER WIDE RAIL MDF "WROUGHT IRON"

Note:



CONSTRUCTION SUMMARY

Forestside Estates Inc.

PURCHASERS: DALBIR SINGH OTAL and DALBIR ,KAUR OTAL

TEL:

LOT NUMBER	PHASE	HOUSE TYPE	CLOSING DATE
10	8	BLUE ELDER (38-03C) - ELEV C	20-Aug-24

Date Added: 29-Jan-24

Invoice Number: 8590

1 - PRIMARY ENSUITE- Install an Upgrade #3 counter top throughout the Primary Ensuite where applicable, in lieu of the builder standard. Install the Emmerstone BORGHINI CLASSIC Note:
1 - PRIMARY ENSUITE-Install an Upgrade "L" Edge for the Primary Ensuite Note:
2 - PRIMARY ENSUITE- Install an undermount sink for teh Primary Ensuite Install the CONTRAC "CATENA" Model # 4210CIY (X2 SINK) **Install standard faucet** Note:
2 - PRIMARY ENSUITE- Accomodate the counter top for undermount sink- Cut and Polish Fee (x2 Sinks) Note:
1 - PRIMARY ENSUITE- Install an Upgrade #5 floor tile on the floor of the Primary Esnuite. Install the 24x24 ALABASTRO BIANCO Note:
1 - PRIMARY ENSUITE SHOWER STALL- Install an Upgrade #6 floor tile on the walls of the shower stall of the Primary Ensuite. Install the 24x24 ALABASTRO BIANCO Note:
1 - SHARED BATH 2/3- Install an Upgrade #2 cabinet in the Shared Bath 2/3 Install the SHAKER WIDE RAIL MDF "WROUGHT IRON" Note:
1 - SHARED BATH 2/3- Install an Upgrade #3 counter top throughout the Shared Bath 2/3 where applicable, in lieu of the builder standard. Install the Emmerstone BORGHINI CLASSIC Note:
1 - SHARED BATH 2/3-Install an Upgrade "L" Edge for the Shared Bath 2/3 Note:
2 - SHARED BATH 2/3- Install an undermount sink for teh Shared Bath 2/3 Install the CONTRAC "CATENA" Model # 4210CIY (X2 SINK) **Install standard faucet** Note:
2 - SHARED BATH 2/3- Accomodate the counter top for undermount sink- Cut and Polish Fee (X2 Sinks) Note:
1 - SHARED BATH 2/3- Install a set of Bank of darwers in lieu of single top drawer Note:
1 - SHARED BATH 2/3-Install an Upgrade #1 floor tile on the floor of the Shared Bath 2/3. Install the 18x18 LIVORNO GRIS Note:
1 - SHARED BATH 2/3-Install an Upgrade #2 floor tile on the Walls of the Shared Bath 2/3 shower walls. Install the 18x18 LIVORNO GRIS Note:
1 - SHARED BATH 1- Install an Upgrade #2 cabinet in the Shared Bath 1 Install the SHAKER WIDE RAIL MDF "WROUGHT IRON" Note:
1 - SHARED BATH 1- Install an Upgrade #3 counter top throughout the Shared Bath 1 where applicable, in lieu of the builder standard. Install the Emmerstone BORGHINI CLASSIC Note:



CONSTRUCTION SUMMARY

Forestside Estates Inc.

PURCHASERS: DALBIR SINGH OTAL and DALBIR ,KAUR OTAL

TEL:

LOT NUMBER	PHASE	HOUSE TYPE	CLOSING DATE	
10	8	BLUE ELDER (38-03C) - ELEV C	20-Aug-24	

Date Added: 29-Jan-24

Invoice Number: 8590

1 - SHARED BATH 1-Install an Upgrade "L" Edge for the Shared Bath 1 Note:
2 - SHARED BATH 1- Install an undermount sink for teh Shared Bath 1 Install the CONTRAC "CATENA" Model # 4210CIY (X2 SINK) **Install standard faucet** Note:
2 - SHARED BATH 1- Accomodate the counter top for undermount sink- Cut and Polish Fee (X2 Sinks) Note:
1 - SHARED BATH 1-Install an Upgrade #1 floor tile on the floor of the Shared Bath 1 Install the 18x18 LIVORNO GRIS Note:
1 - SHARED BATH 1-Install an Upgrade #2 floor tile on the Walls of the Shared Bath 1 shower walls. Install the 18x18 LIVORNO GRIS Note:
1 - COUNTER TOP CLARIFICATION- Install the Standard 3" Splash throughout all bathroom vanity counter tops, where applicable. Note:
1 - COUNTER TOPS Purchaser accepts & acknowledges that the Stone slabs vary in size & all seams are visible & the fabricator reserves the right to position the seams as necessary. Note:
1 - KITCHEN- Accommodate the cabinetry for Built in Oven/ Micro (See layout for lacion) Note:
1 - KITCHEN- Install Electrical for the Built in Oven/ Micro (See Specs attached) (See layout for location) Note: **Electrical price is approximate and may change once applinace specification are submitted**
1 - KITCHEN- Purchasers request to leave the builder standard opening for a standard stove, the purchaser will not be installing a Cook Top Note:
1 - KITCHEN- Accommodate the electrical for a future Chimney style exhaust fan Note: **Electrical price is approximate and may change once applinace specification are submitted**
1 - KICTHEN- Install deep uppers above the fridge (See Layout) Note:
1 - KITCHEN- Install a Double Bin Pull out Garbage drawer (See Layout) Note:
2 - KITCHEN- Install Plain Clear Glass on upper cabinets doors, on either side of the stove. (See Layout) Note: Does not include matching interior
1 - LAUNDRY ROOM- Install the optional Upper Cabinets in the Laundry Room (See Layout) Note:



CONSTRUCTION SUMMARY

Forestside Estates Inc.

PURCHASERS: DALBIR SINGH OTAL and DALBIR ,KAUR OTAL

TEL:

LOT NUMBER	PHASE	HOUSE TYPE	CLOSING DATE	
10	8	BLUE ELDER (38-03C) - ELEV C	20-Aug-24	

Date Added: 29-Jan-24

Invoice Number: 8590

1 - FAMILY ROOM- Install an Electrical plug above the fireplace for a future TV. To be installed at approx. 60" AFF (See Sketch)

Note:

1 - FAMILY ROOM- Raise teh Conduit pipe to above the fireplace for a future TV. To be installed at approx. 60" AFF (See Sketch)

Note:

1 - PURCHASER AWARE AND ACCEPTS THAT ANY CHANGES MADE TO UPGRADES AFTER SIGNING THIS PURCHASERS EXTRA FORM ARE SUBJECT TO A MINIMUM ADMINISTRATION FEE OF \$1,000

Note:

1 - PURCHASER HAS ATTENDED A COLOUR CHART APPOINTMENT AT THE DESIGN STUDIO AND HAS DECLINED ANY ADDITIONAL UPGRADES

Note:

Date Added: 19-Sep-23

Invoice Number: 8515

1 - BASEMENT- No extended height basement

Note:

1 - BASEMENT- Install ONE (X1) Larger Basement window, 30"x24", in lieu of the builders standard window. (With possible widnow well) (See Sketch)

Note:

1 - MAIN FLOOR- Install Extended height 10'-0" Main Floor ceilings. Includes extended height archways and 8'-0" Standard interior doors (See Sketch)

Note:

1 - FRONT EXTERIOR DOORS- Delete the builders standard single front door and sidelites, and Install Extended height Double Front Doors (See Sketch)

Note:

1 - SIDE EXTERIOR- Install the optional side door with builders standard coach light (If Grade Permites) (See Sketch)

Note:

1 - BASEMENT- AMP- Install 200 Amp Service to the house (See Sketch)

Note:

1 - FRONT EXTERIOR- In addition to the builders standard coach light at the front door, Install an additional Coach Light, to be one the same switch as the standard (See Sketch)

Note:

1 - FRONT EXTERIOR- In addition to the 2 Coach Lights, Install an exterior portico ceiling light. To be on its own switch (See Sketch)

Note:

1 - BACK EXTERIOR- In addition to the builders standard coach light at the back patio sliders, Install an additional Coach Light, to be one the same switch as the standard (See Sketch)

Note:

1 - FRONT EXTERIOR- Install a Festive Soffit Plug on a single Pole (See Sketch)

Note:

1 - KITCHEN- Install an 8" Duct in lieu of the builders standard 6" (See Sketch)

Note:



CONSTRUCTION SUMMARY

Forestside Estates Inc.

PURCHASERS: DALBIR SINGH OTAL and DALBIR ,KAUR OTAL

TEL:

LOT NUMBER	PHASE	HOUSE TYPE	CLOSING DATE
10	8	BLUE ELDER (38-03C) - ELEV C	20-Aug-24

Date Added: 19-Sep-23

Invoice Number: 8515

1 - SHARED BATH 2/3- Delete the builidesr standard Tib/shower and install a shower stall. To include 2x2 mosaic floor, 6" curb with white quartz top, shower pot light and "INCOGNITO" semi frameless sliding doors (See Sketch) Note: **Purchaser will have the option to further upgade the colour of the quartz on the curb at time of colour chart appointment**
1 - SHARED BATH 1- Delete the builidesr standard Tib/shower and install a shower stall. To include 2x2 mosaic floor, 6" curb with white quartz top, shower pot light and "INCOGNITO" semi frameless sliding doors (See Sketch) Note: **Purchaser will have the option to further upgade the colour of the quartz on the curb at time of colour chart appointment**
1 - MASTER ENSUITE SHOWER STALL- Install a shower niche for the master ensuite shower stall. APPROX. 16"x24" (See Sketch) Note: **PLEASE NOTE** Dummy wall to be accommodated if required for the shower niche**
1 - SECOND FLOOR- Install Smooth Ceilings thoroughout the 2nd floor, where applicable. (See Sketch) Note:
1 - BASEMENT- Ina ddition to the laundry room on the first floor, Install an additional Laundry Rough In at teh basement. To include Electrical for washer & dryer and Laundry Tub Rough ONLY Note:
1 - BACK EXTERIOR- Install the BBQ Gas line Rough In (See Sketch) Note:
1 - KITCHEN- Install a Gas line rough in for stove , inlcudes applicable electrical (See Sketch) Note: **Once appliance specs are received applicable additional electrical may eb required** **PLAESE NOTE** standard stove electrical to remain**
1 - KITCHEN- Install a water line rough in for a future fridge (See Sketch) Note:
1 - PURCHASER HAS ATTENDED A STRUCTURAL APPOINTMENT AT THE DESIGN STUDIO AND HAS DECLINED ANY ADDITIONAL UPGRADES Note:
1 - PURCHASER AWARE AND ACCEPTS THAT ANY CHANGES MADE TO UPGRADES AFTER SIGNING THIS PURCHASERS EXTRA FORM ARE SUBJECT TO A MINIMUM ADMINISTRATION FEE OF \$1,000 Note:
1 - BONUS PACKAGE-PURCHASER TO RECEIVE \$20,000 (INCLUSIVE OF TAXES) WORTH OF UPGRADES AT THE DESIGN STUDIO AT TIME OF COLOUR CHART Note:

Date Added:

Invoice Number: 8627

2 - KITCHEN-Install TWO additional upper cabinet doors with Plain Clear Class next to the stove. Refer to the kitchen layout, total of FOUR (X4) upper cabinet doors with Plain Clear Glass. Note:
1 - PURCHASER AWARE AND ACCEPTS THAT ANY CHANGES MADE TO UPGRADES AFTER SIGNING THIS PURCHASERS EXTRA FORM ARE SUBJECT TO A MINIMUM ADMINISTRATION FEE OF \$1,000 Note:

This Document is Extremely Time Sensitive - Printed 31 Jan 24 at 10:22



* INTERIOR COLOUR SCHEME *

Purchasers	Decor Consultant	Model and Elevation	Telephone Res. / Bus	Project	Closing Date	Property
DALBIR SINGH OTAL & DALBIR ,KAUR OTAL	Laura Di Pede	BLUE ELDER (38-03C) - ELEV C	/	Forestside Estates Inc.	20/08/2024	10

Page 1 of 3

	Flooring	Wall Tile	Plumbing
	Description	Main Accent/Insert Border / Listello Pattern	
Primary Ensuite	✓ 24X24 ALABSATRO BIANCO (UPGD)	✓ 24X24 ALABSATRO BIANCO (UPGD) NO NO NO	WHITE
Shared Bath 2/3	✓ 18X18 LIVORNO GRIS (UPGD)	✓ 18X18 LIVORNO GRIS (UPGD) NO NO NO	WHITE
Shared Bath #1	✓ 18X18 LIVORNO GRIS (UPGD)	✓ 18X18 LIVORNO GRIS (UPGD) NO NO NO	WHITE
Powder Room	✓ 18X18 LIVORNO GRIS (UPGD)	NO NO NO NO	WHITE
Kitchen/Dinette	✓ 18X18 LIVORNO GRIS (UPGD)	NO NO NO NO	SeeNotes
Laundry MudRoom	✓ 18X18 LIVORNO GRIS (UPGD)	NO NO NO NO	STD
Foyer	✓ 18X18 LIVORNO GRIS (UPGD)		
Main Hall	✓ Vintage Red Oak 5"x3/4" TITAN WB UVF (UPGD)		
Family Room	✓ Vintage Red Oak 5"x3/4" TITAN WB UVF (UPGD)		
Living Room	✓ Vintage Red Oak 5"x3/4" TITAN WB UVF (UPGD)		
Dining Room	✓ Vintage Red Oak 5"x3/4" TITAN WB UVF (UPGD)		
Den	✓ Vintage Red Oak 5"x3/4" TITAN WB UVF (UPGD)		
Upper Hall	✓ Vintage Red Oak 5"x3/4" TITAN WB UVF (UPGD)		
Master Bedroom	✓ 40 OZ OPENING NIGHT #03 (STD)		
Bedroom 2	✓ 40 OZ OPENING NIGHT #03 (STD)		
Bedroom 3	✓ 40 OZ OPENING NIGHT #03 (STD)		
Bedroom 4	✓ 40 OZ OPENING NIGHT #03 (STD)		
Bedroom 5	✓ 40 OZ OPENING NIGHT #03 (STD)		

Railings and Stairs

Railings	STD-Vintage Red Oak "Titan" (Upgd Stain)	Landing - Upper	5" Vintage Red Oak Titan (Upgd)
Pickets	STD-Plain Flat Black with Shoes	Landing - Lower	18x18 Livorno Gris (STD)
Posts	STD-Vintage Red Oak "Titan" (Upgd Stain)	Ledge - Upper	N/A
Stringers	Vintage Red Oak "Titan" (Upgd Stain)	Ledge - Lower	N/A
Treads	✓ Vintage Red Oak "Titan" (Upgd Stain)		
Risers	✓ Vintage Red Oak "Titan" (Upgd Stain)		
Runner	NO		

Trim

Baseboard & Casing	✓ STANDARD-Colonial	Knobs	✓ STD- LEVER
Front Door Glass	✓ STANDARD	Hinges	✓ STANDARD
Interior Doors	✓ STD- CARRARA SMOOTH	Grip Set	✓ STANDARD

Notes

PRIMARY ENSUITE- 2X2 WHITE SHOWER FLOOR MOSAIC WITH WHITE QUARTZ CURB TOP **SHARED BATH 2/3- 2X2 WHITE SHOWER FLOOR MOSAIC WITH WHITE QUARTZ CURB TOP **SHARED BATH 1- 2X2 WHITE SHOWER FLOOR MOSAIC WITH WHITE QUARTZ CURB TOP **KITCHEN-INSTALL UPGRADED KITCHEN SINK- KINDRED "BROOKMORE" MODEL #BSU1831-9 ** POWDER RM- PRIMARY ENSUITE- SHARED BATH 2/3- SHARED BATH #1-INSTALL UNDEMOUNT SINK CONTRAC "CATENA" MODEL #4210CIY**

Cornice Moulding / Medalion

Foyer	NO
Living Room	NO
Dining Room	NO
Family Room	NO
Main Hall	NO
Kitchen	NO
2nd Floor Hall	NO

Page 1 of 3

Consultant: Laura Di Pede

Purchaser: Dalbir Singh Ota

Purchaser: Dalbir Kaur Ota Vendor:

* INTERIOR COLOUR SCHEME *

Purchasers	Decor Consultant	Model and Elevation	Telephone Res. / Bus	Project	Closing Date	Property
DALBIR SINGH OTAL & DALBIR ,KAUR OTAL	Laura Di Pede	BLUE ELDER (38-03C) - ELEV C	/	Forestside Estates Inc.	20/08/2024	10

Page 2 of 3

	Interior Paint	Cabinet	Countertop	Counter Edge	Handle / Knob
Master Ensuite	STD- SILVER BIRCH	UPGD- SHAKER WIDE RAIL MDF WROUGHT IRON	Emmerstone Broghini Classic(Upgd)	"L" UPGD EDGE	930396BSN
Shared Bath 2/3	STD- SILVER BIRCH	UPGD- SHAKER WIDE RAIL MDF WROUGHT IRON	Emmerstone Broghini Classic(Upgd)	"L" UPGD EDGE	930396BSN
Shared Bath #1	STD- SILVER BIRCH	UPGD- SHAKER WIDE RAIL MDF WROUGHT IRON	Emmerstone Broghini Classic(Upgd)	"L" UPGD EDGE	930396BSN
Powder Room	STD- SILVER BIRCH	UPGD- SHAKER WIDE RAIL MDF WROUGHT IRON	Emmerstone Broghini Classic(Upgd)	"L" UPGD EDGE	935737BSN
Kitchen/Dinette	STD- SILVER BIRCH	UPGD- SLIM SHAKER MDF CHANTILLY LACE	Emmerstone Broghini D'oro (Upgd)	"L" UPGD EDGE	930396BSN
Laundry <i>Mudroom</i>	STD- SILVER BIRCH	STD- EURO WHITE	STD- WHITE LAMINATE	STD	<i>930396BSN</i>
Foyer	STD- SILVER BIRCH				
Main Hall	STD- SILVER BIRCH				
Family Room	STD- SILVER BIRCH				
Living Room	STD- SILVER BIRCH				
Dining Room	STD- SILVER BIRCH				
Den	STD- SILVER BIRCH				
Upper Hall	STD- SILVER BIRCH				
Master Bedroom	STD- SILVER BIRCH				
Bedroom 2	STD- SILVER BIRCH				
Bedroom 3	STD- SILVER BIRCH				
Bedroom 4	STD- SILVER BIRCH				
Bedroom 5	STD- SILVER BIRCH				

Appliance Opening/Dimension

Fridge Size SEE LAYOUT Range SEE LAYOUT

Built-Ins YES- SEE LAYOUT Microwave SEE LAYOUT

Hood Fan SEE LAYOUT Exhaust Opening ☐ 6" ☒ 8"

Dishwasher Cabinet Std 24in Opening

Fireplace

Fireplace	<input checked="" type="checkbox"/> FAMILY ROOM	Fireplace	<input type="text"/> N/A
Location Flooring	<input checked="" type="checkbox"/> HWD	Location Flooring	<input type="text"/> N/A
Style	<input checked="" type="checkbox"/> VILLA NOVA	Style	<input type="text"/> N/A
Finish	<input checked="" type="checkbox"/> STONE	Finish	<input type="text"/> N/A
Marble	<input type="text"/> NO	Marble	<input type="text"/> N/A
Hearth	<input type="text"/> NO	Hearth	<input type="text"/> N/A

Notes



(C) cable (CAT6) (x2)
(T) Telephone (x2)
(E) Electrical (x1)
• Conduit 60" A.F.F.

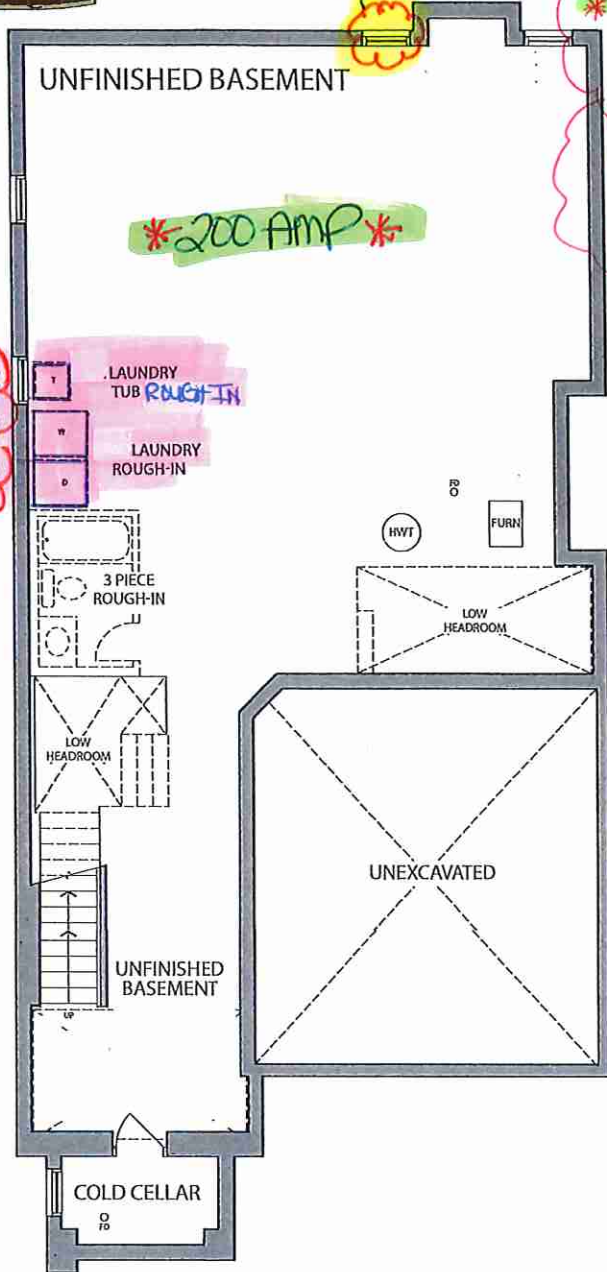

BASEMENT ELEV. C

RECEIVED
08/23/23

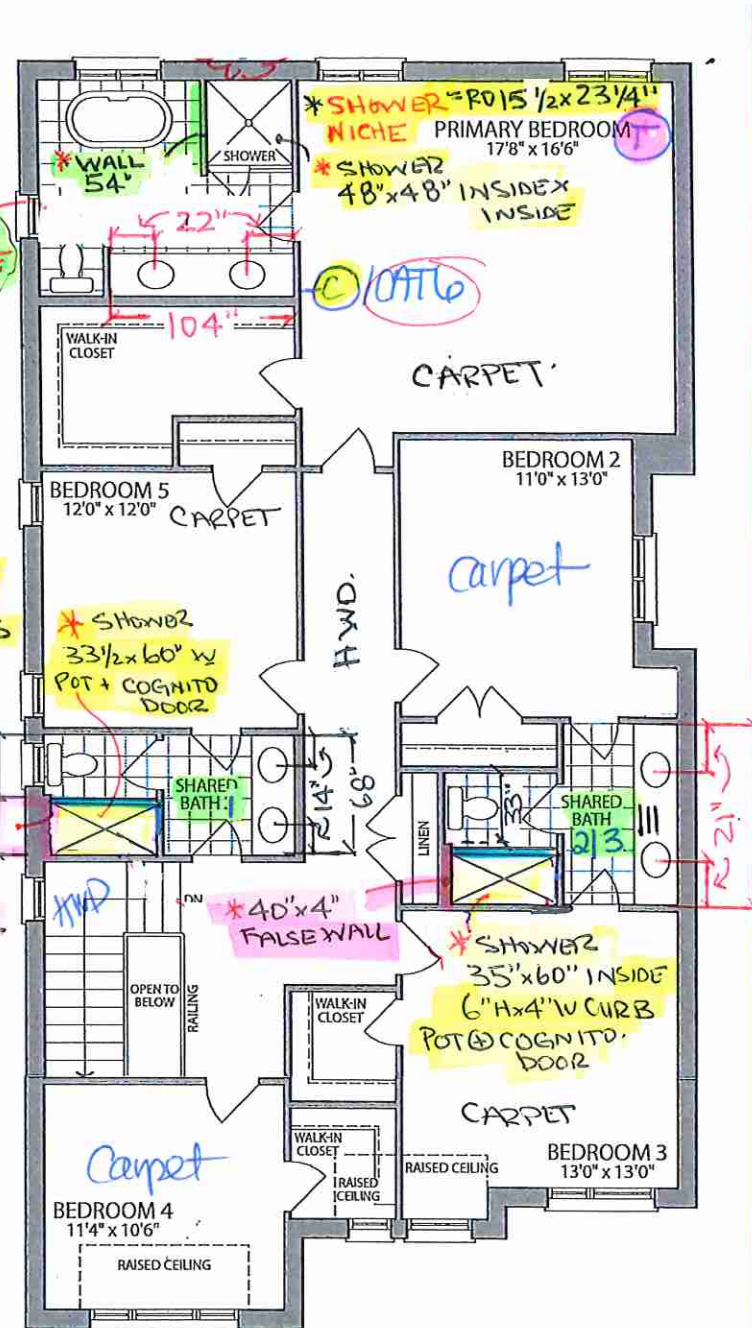
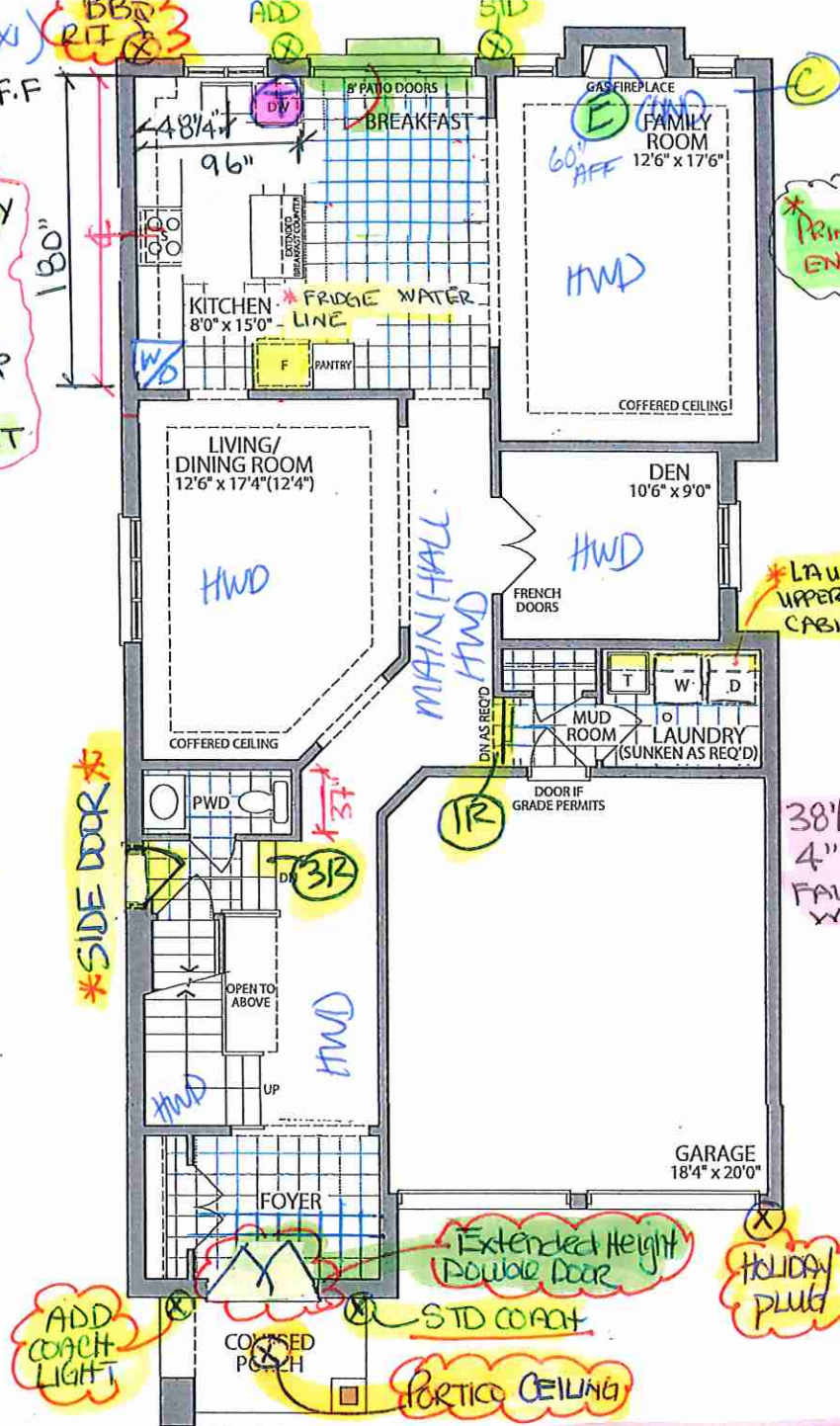

Materials, specifications and floor plans are subject to change without notice. All renderings are artist's concept. All floor plans are approximate dimensions. Actual usable floor space may vary from the stated floor area. E.&O.E.

Lot 10 . 38-03 . The Blue Elder . El. C. 5 Bedroom . 3210 SQ. FT.

Villa

KITCHENS & FINE CABINETS LTD

8111 Jane St. Unit 10
Concord, Ontario L4K 4L7
Tel. (905) 669- 7028
Fax. (905) 669 - 7903
email: designstudio@villakitchens.ca
www.villakitchens.ca

CLIENT: ROYAL PINE

PROJECT: FORESTSIDE PH 8

ADDRESS: RP-FS(8)-LOT 10

MODEL: 38-03--ELEV A B C

KITCHEN

DOOR STYLE: SLIM SHAKER 1/4"
EDGE

DOOR PROFILE: N/A

DOOR THICKNESS: 7/8"

DOOR MATERIAL: MDF

DOOR FINISH: CHANTILLY LACE

INTERIOR: WHITE

CROWN MOLD: STD EURO

PAN MOLD: N/A

LIGHT VALANCE: N/A

INT HW: STANDARD

INSTALL HEIGHT: 95 5/8"

HW:

COUNTERTOP

LOT 10

DRAWN BY: ELISA

DATE: JAN 26, 2024

REVISION:

SCALE:

PAGE: 1 OF 6

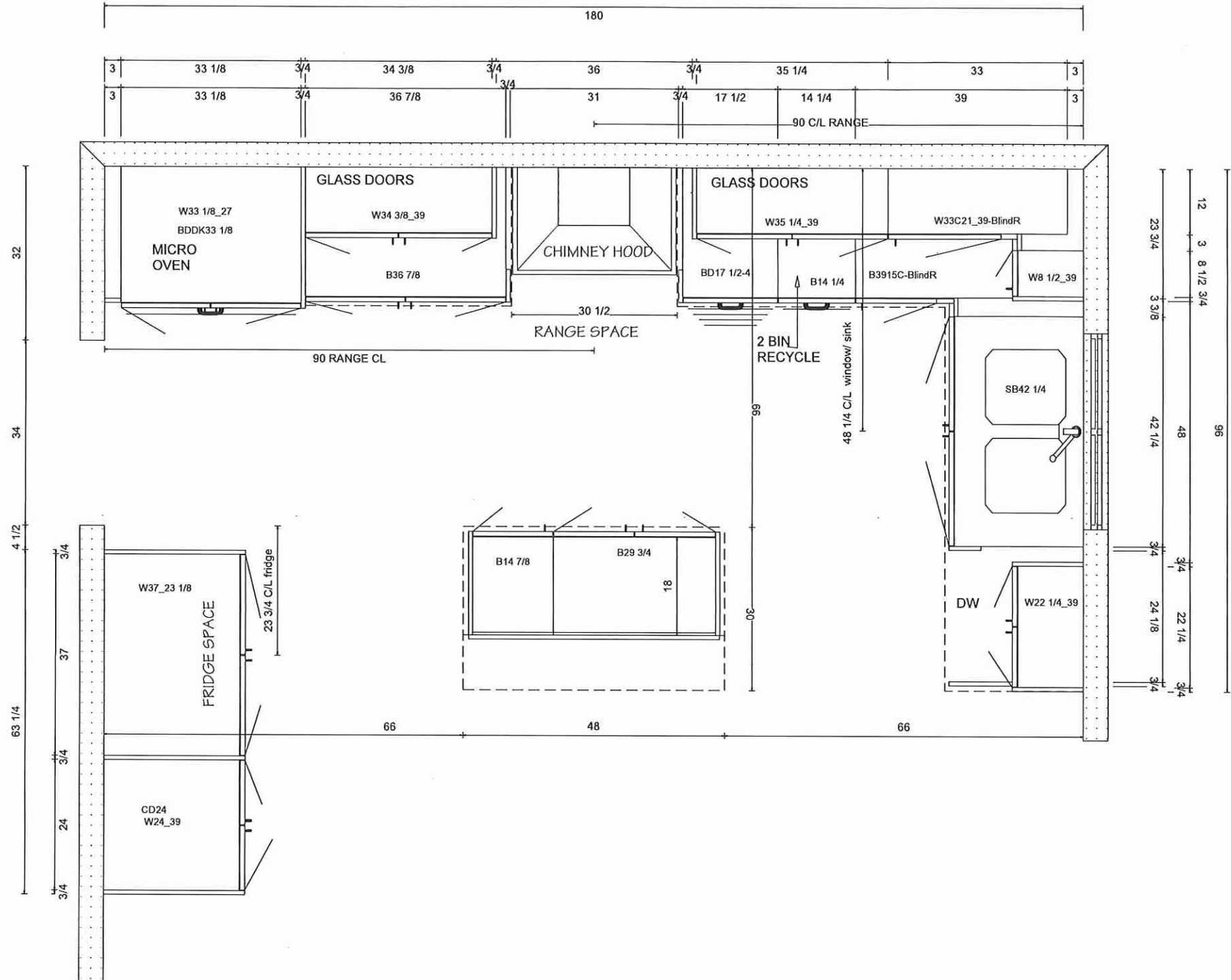

8111 Jane St. Unit 10
Concord, Ontario L4K 4L7
Tel. (905) 669- 7028
Fax. (905) 669 - 7903
email: designstudio@villakitchens.ca
www.villakitchens.ca

CLIENT: ROYAL PINE
PROJECT: FORESTSIDE PH 8
ADDRESS: RP-FS(8)-LOT 10
MODEL: 38-03--ELEV A B C

FRIDGE WALL
DOOR STYLE: SLIM SHAKER 1/4"
EDGE
DOOR PROFILE: N/A
DOOR THICKNESS: 7/8"
DOOR MATERIAL: MDF
DOOR FINISH: CHANTILLY LACE
INTERIOR: WHITE
CROWN MOLD: STD EURO
PAN MOLD: N/A
LIGHT VALANCE: N/A
INT HW: STANDARD
INSTALL HEIGHT: 95 5/8"
HW:
COUNTERTOP

LOT 10

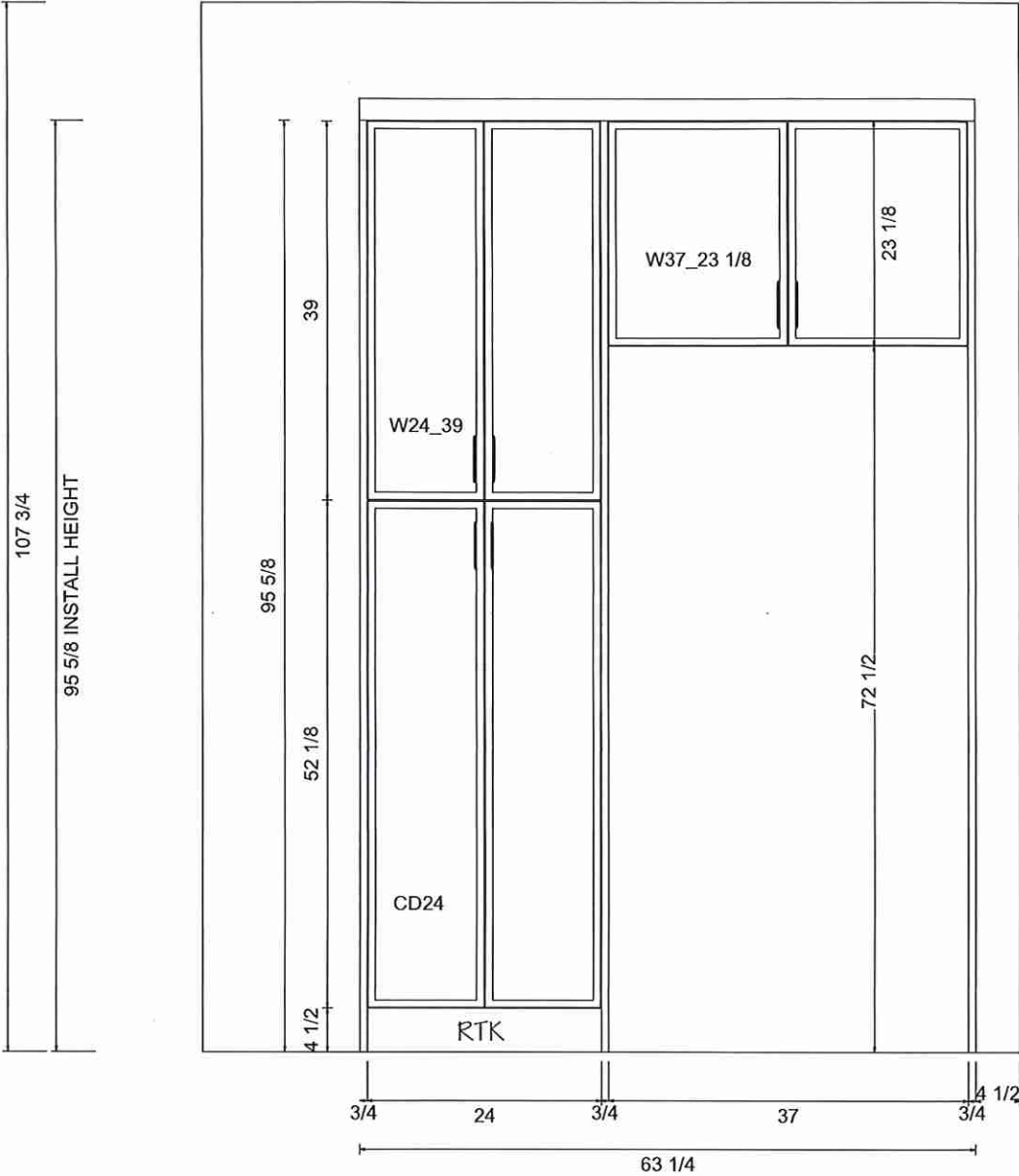

Villa

KITCHENS & FINE CABINETRY LTD

8111 Jane St. Unit 10
Concord, Ontario L4K 4L7
Tel. (905) 669- 7028
Fax. (905) 669 - 7903
email: designstudio@villakitchens.ca
www.villakitchens.ca

CLIENT: ROYAL PINE
PROJECT: FORESTSIDE PH 8
ADDRESS: RP-FS(8)-LOT 10
MODEL: 38-03--ELEV A B C

RANGE WALL

DOOR STYLE: SLIM SHAKER 1/4"
EDGE
DOOR PROFILE: N/A
DOOR THICKNESS: 7/8"
DOOR MATERIAL: MDF
DOOR FINISH: CHANTILLY LACE
INTERIOR: WHITE
CROWN MOLD: STD EURO
PAN MOLD: N/A
LIGHT VALANCE: N/A
INT HW: STANDARD
INSTALL HEIGHT: 95 5/8"
HW:
COUNTERTOP

LOT 10

DRAWN BY: ELISA

DATE: JAN 26, 2024

REVISION:

SCALE:

PAGE: 3 OF 6

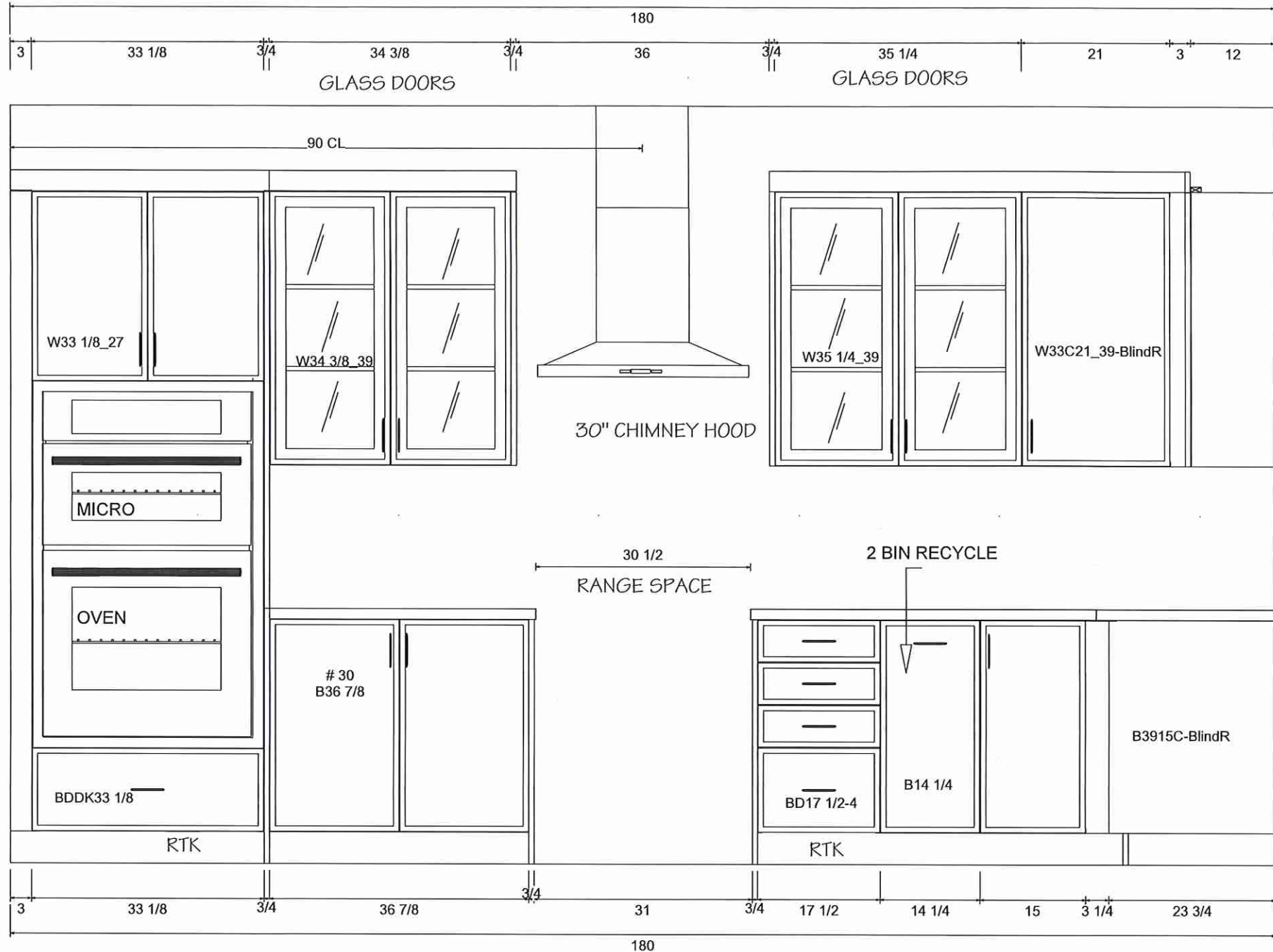

8111 Jane St. Unit 10
Concord, Ontario L4K 4L7
Tel. (905) 669- 7028
Fax. (905) 669 - 7903
email: designstudio@villakitchens.ca
www.villakitchens.ca

CLIENT: ROYAL PINE
PROJECT: FORESTSIDE PH 8
ADDRESS: RP-FS(8)-LOT 10
MODEL: 38-03--ELEV A B C

SINK WALL

DOOR STYLE: SLIM SHAKER 1/4"
EDGE
DOOR PROFILE: N/A
DOOR THICKNESS: 7/8"
DOOR MATERIAL: MDF
DOOR FINISH: CHANTILLY LACE
INTERIOR: WHITE
CROWN MOLD: STD EURO
PAN MOLD: N/A
LIGHT VALANCE: N/A
INT HW: STANDARD
INSTALL HEIGHT: 95 5/8"
HW:
COUNTERTOP

LOT 10

DRAWN BY: ELISA
DATE: JAN 26, 2024
REVISION:
SCALE:
PAGE: 4 OF 6

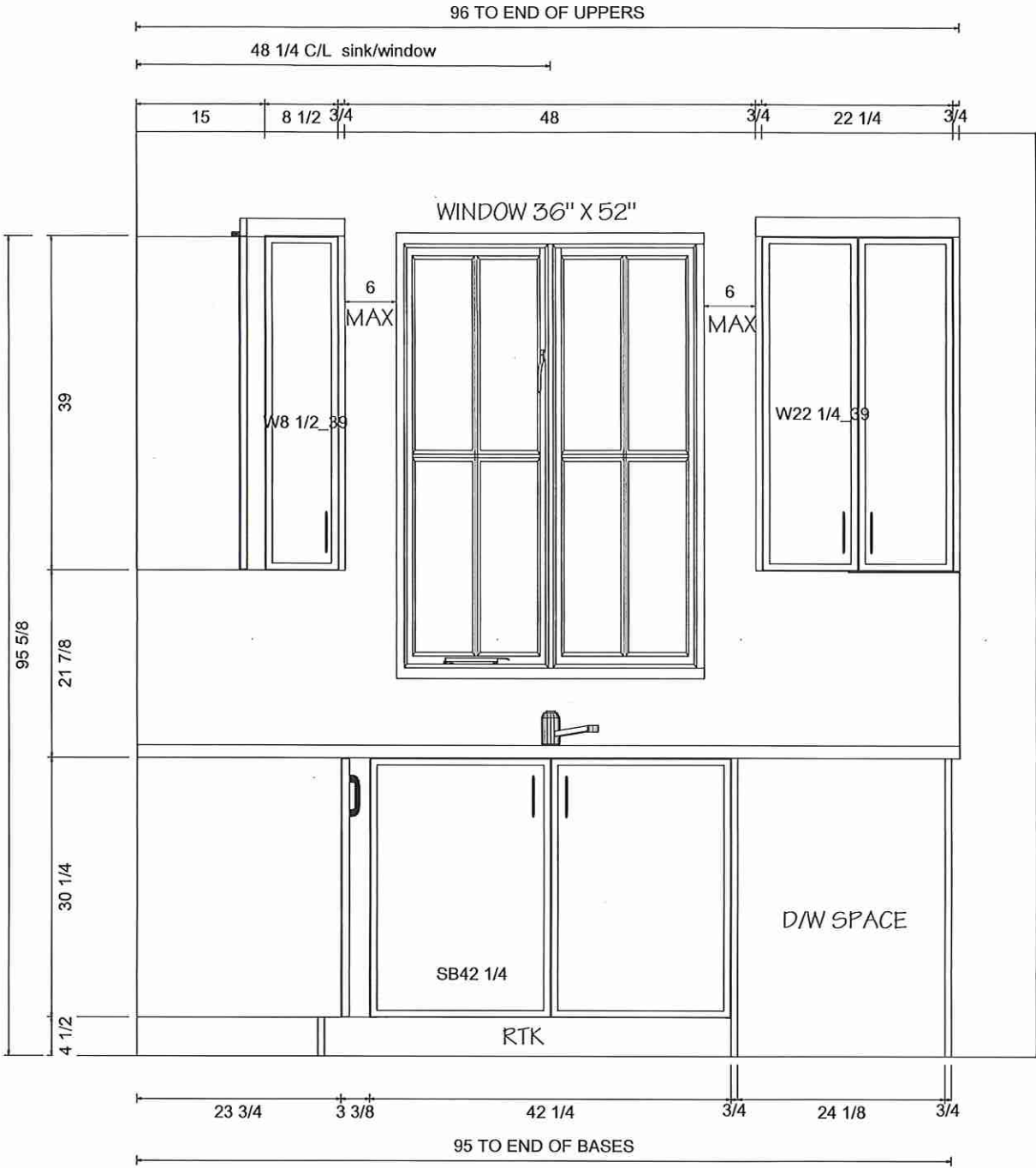

8111 Jane St. Unit 10
Concord, Ontario L4K 4L7
Tel. (905) 669- 7028
Fax. (905) 669 - 7903
email: designstudio@villakitchens.ca
www.villakitchens.ca

CLIENT: ROYAL PINE
PROJECT: FORESTSIDE PH 8
ADDRESS: RP-FS(8)-LOT 10
MODEL: 38-03--ELEV A B C

ISLAND

DOOR STYLE: SLIM SHAKER 1/4"
EDGE
DOOR PROFILE: N/A
DOOR THICKNESS: 7/8"
DOOR MATERIAL: MDF
DOOR FINISH: CHANTILLY LACE
INTERIOR: WHITE
CROWN MOLD: STD EURO
PAN MOLD: N/A
LIGHT VALANCE: N/A
INT HW: STANDARD
INSTALL HEIGHT: 95 5/8"
HW:
COUNTERTOP

LOT 10

DRAWN BY: LAI-YEE
DATE: JULY 6, 2023
REVISION: NOVEMBER 8, 2023
SCALE:
PAGE: 5 OF 8

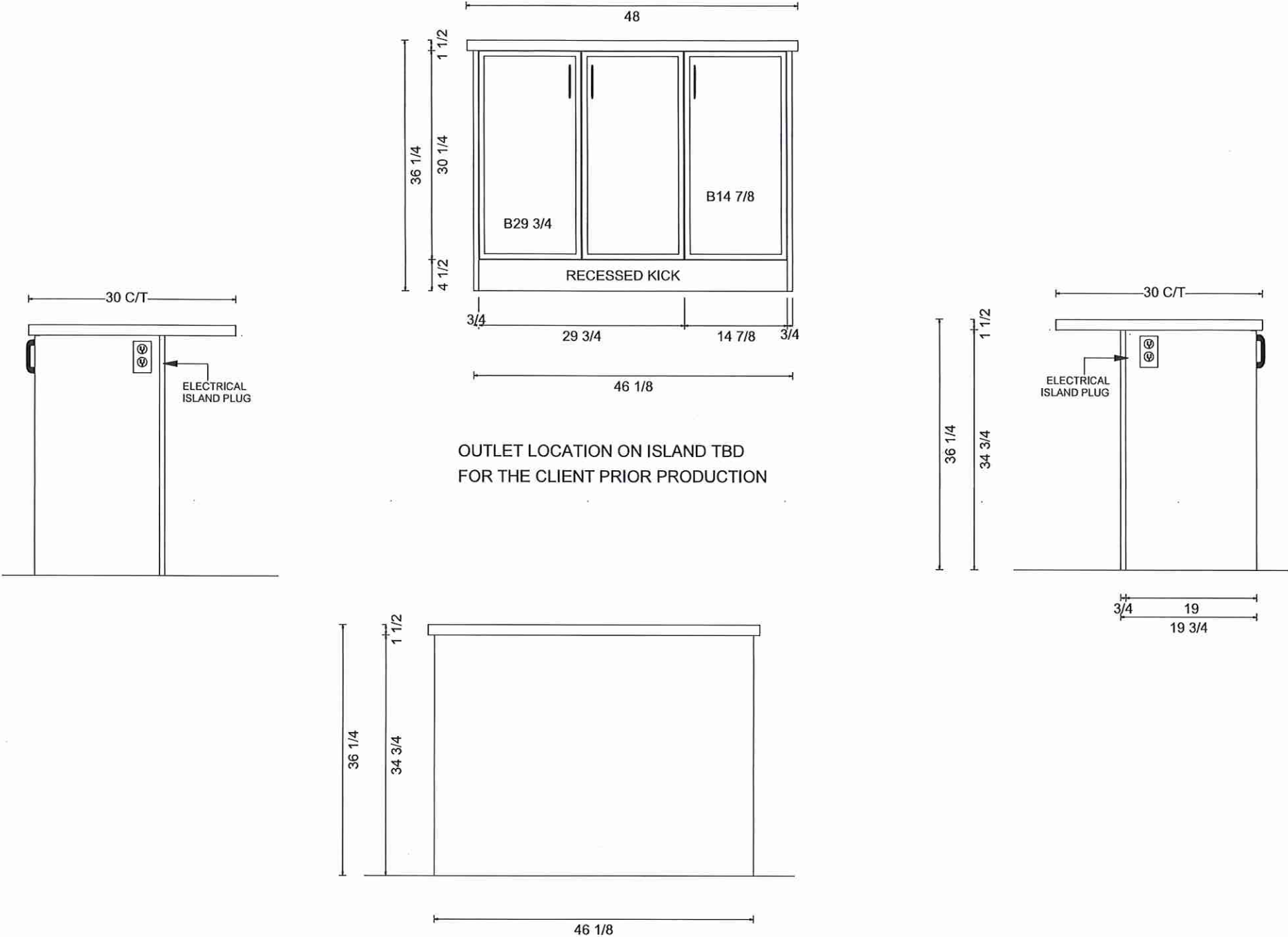



KITCHENS & FINE CABINETRY LTD

8111 Jane St. Unit 10
Concord, Ontario L4K 4L7
Tel. (905) 669- 7028
Fax: (905) 669 - 7903
email: designstudio@villakitchens.ca
www.villakitchens.ca

CLIENT: ROYAL PINE
PROJECT: FORESTSIDE PH 8
ADDRESS: RP-FS(8)-LOT 10
MODEL: 38-03--ELEV A B C

VANITIES

LOT 10 .

DRAWN BY: ELISA
DATE: JULY 6, 2023
REVISION: JAN 29, 2024
SCALE:
PAGE: 7 OF 8

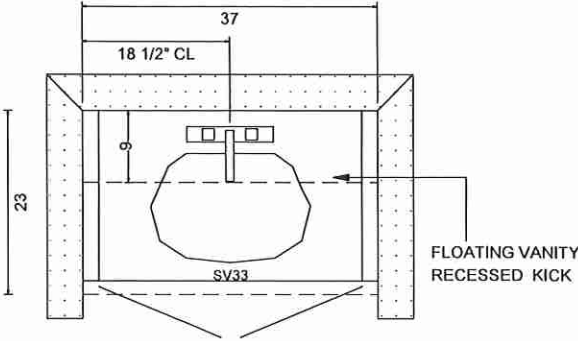

POWDER ROOM

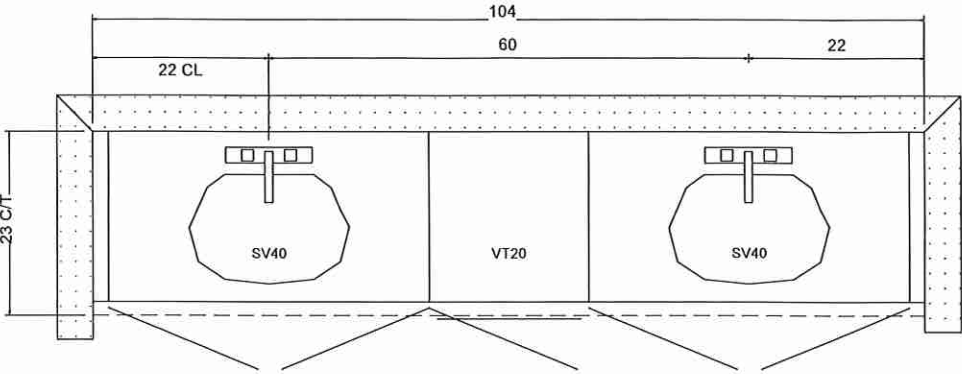
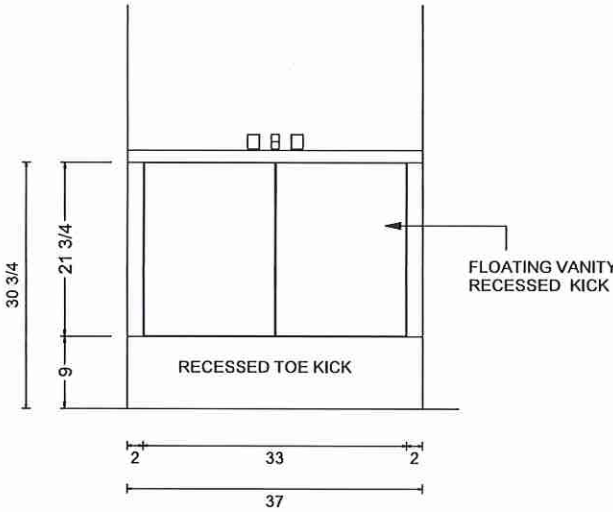

PRIMARY ENSUITE

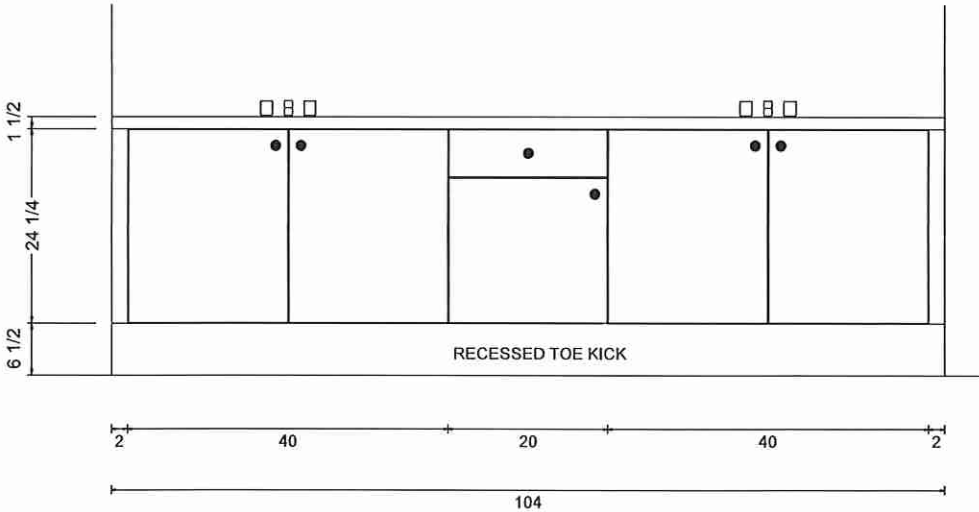

Villa

KITCHENS & FINE CABINETRY LTD

8111 Jane St. Unit 10
 Concord, Ontario L4K 4L7
 Tel. (905) 669- 7028
 Fax. (905) 669 - 7903
 email: designstudio@villakitchens.ca
 www.villakitchens.ca

CLIENT: ROYAL PINE
 PROJECT: FORESTSIDE PH 8
 ADDRESS: RP-FS(8)-LOT 10
 MODEL: 38-03--ELEV A B C

VANITIES

LOT 10

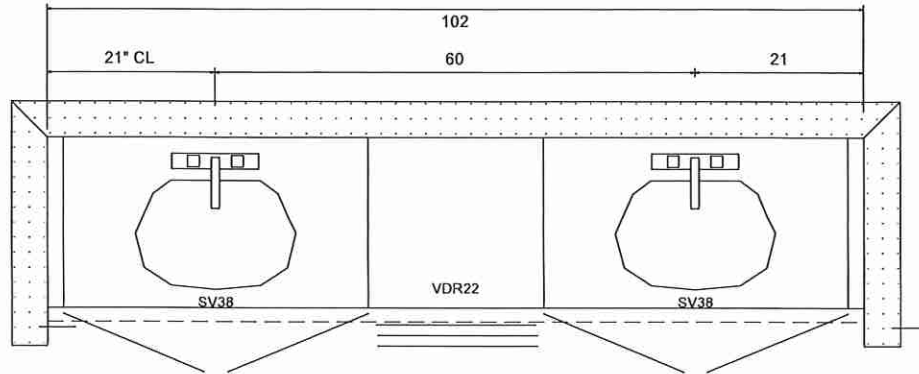

SHARED BATH 1 (BEDROOM 2 & 3)

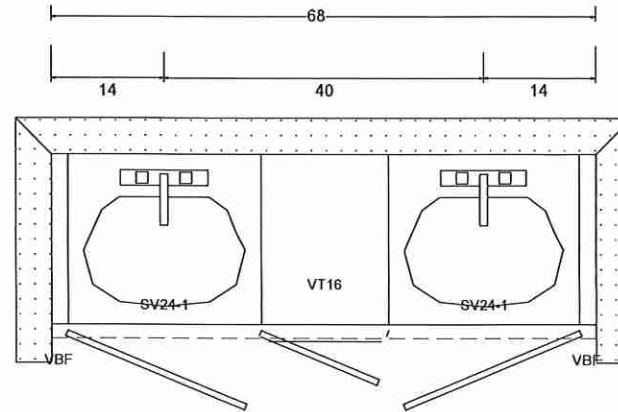
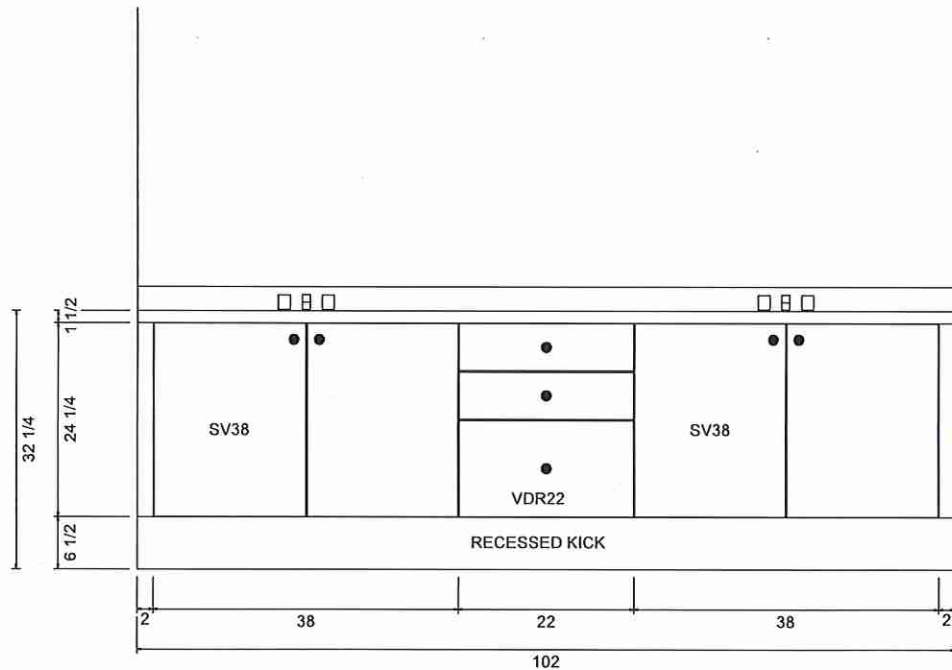

SHARED BATH 2 (BEDROOM 4 & 5)

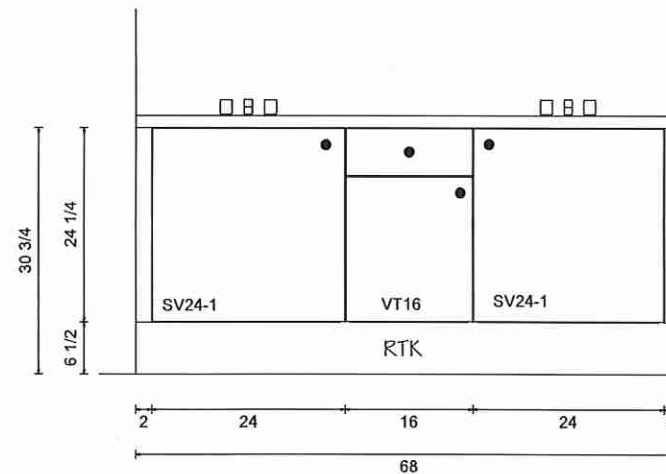



KITCHENS & FINE CABINETRY LTD

8111 Jane St. Unit 10
Concord, Ontario L4K 4L7
Tel. (905) 669- 7028
Fax. (905) 669 - 7903
email: designstudio@villakitchens.ca
www.villakitchens.ca

CLIENT: ROYAL PINE
PROJECT: FORESTSIDE PH 8
ADDRESS: RP-FS(8)-LOT 10
MODEL: 38-03--ELEV A B C

LAUNDRY

LOT 10.

DRAWN BY: ELISA
DATE: JAN 23, 2024
REVISION:
SCALE:
PAGE: 6 OF 6

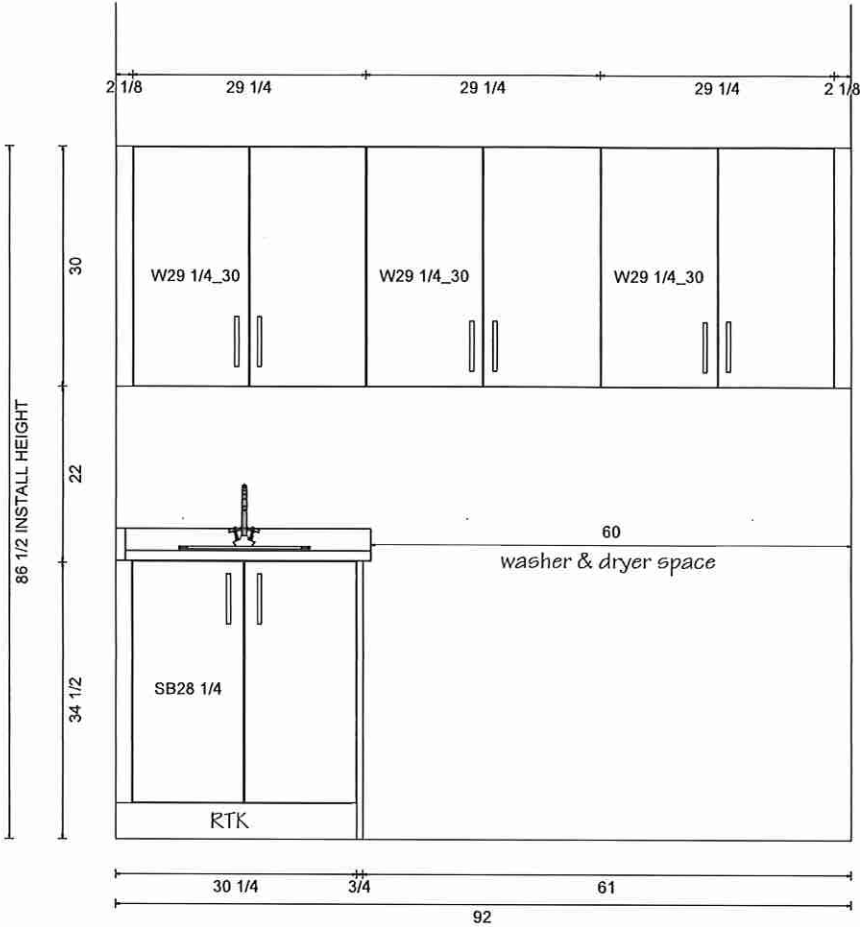
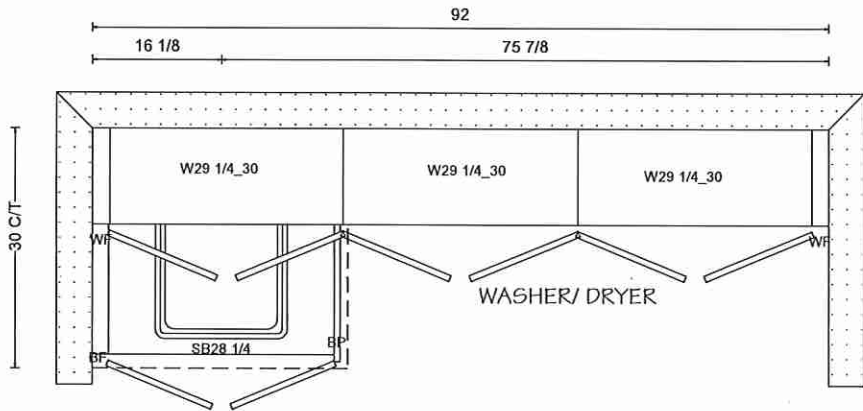

Countertop Edges

LOT 10

CONNOLLY

Marble & Granite Ltd.

EDGE
DETAILS

004

~~A.~~

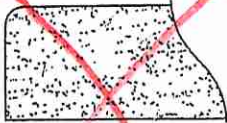

~~STRAIGHT EDGE
(STANDARD - 3/4")~~

I.

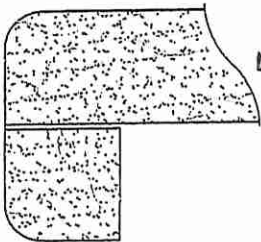

DOUBLE TOP "D" EDGE
(STANDARD - 1 1/2")

✓ Kitchen
✓ Powder Rm
✓ Primary Ensuite

✓ Shared 213
✓ Shared #1

~~M.~~

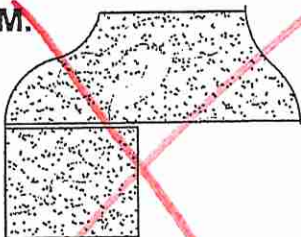

~~OGEE - SQUARE EDGE
(MED./HIGH - 1 1/2")~~

EDGING UP-GRADE OPTIONS

LOT 10

W

Brookmore Undermount Sink - BSU1831-9 | 122.0637.643

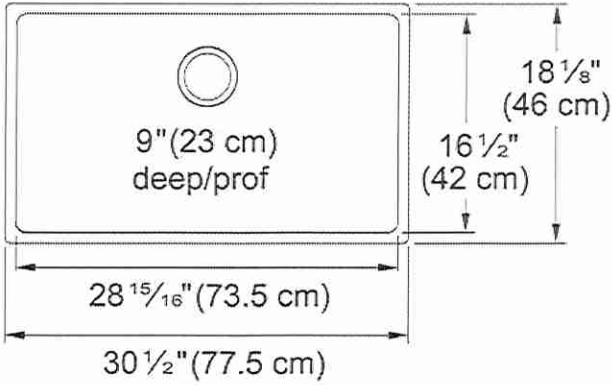
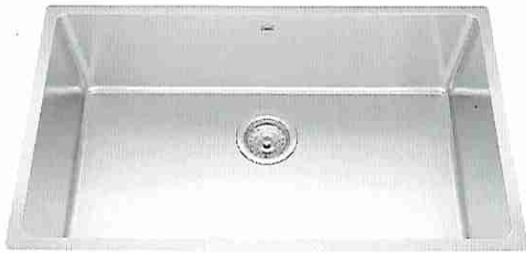

Install Standard Faucet

Technical Data	
Aspect	
Sink type	Sink
Type of material	Stainless steel
Number of bowls	1
Color	Steel
Surface finish	Pearl
Product Dimensions	
Exterior size: right to left	30.512
Exterior size: front to back	18.11
Large bowl size: right to left	28.937
Large bowl size: front to back	16.535
Large bowl: depth	9
Installation	
Minimum cabinet size	33"
Product specifications	
Installation type	Undermount
Drain hole	3 1/2"
Position of drainer	No drainer
Product identification	
Product brand	Kindred
Collection	Brookmore
Certified by	IAPMO
Features	
Drainers number	No drainer
Product reversibility	No
Faucet ledge	No
Strainer assembly included	Yes
Strainer assembly type	Manual

CONTRAC CATENA

Lot 10

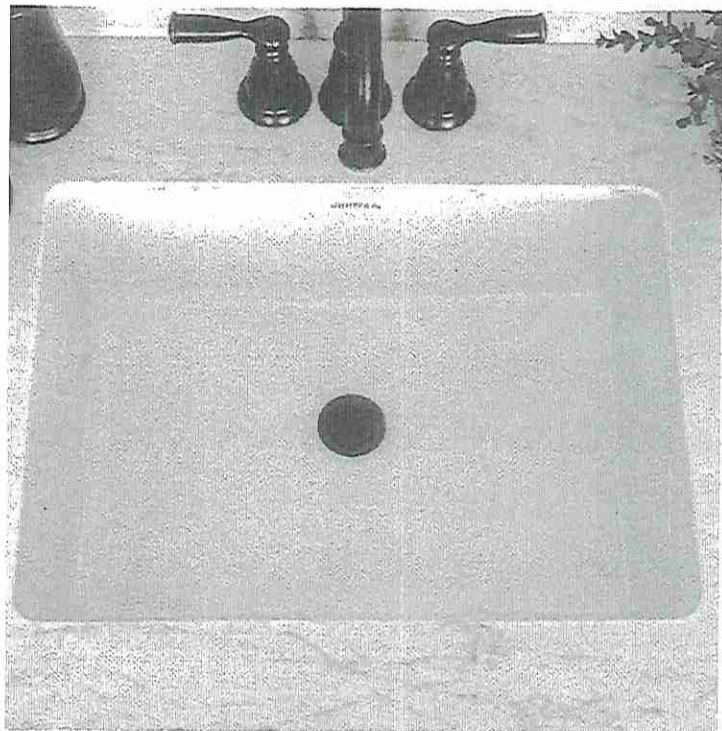

Rectangular Undermount Sink
4210CIY

Vitreous china
Front overflow hole
Template supplied
Faucet not included
Mounting clips not included
20" W x 15³/₈" D x 7¹/₂" H



- ✓ Powder Rm (x1)
- ✓ Primary Ensuite (x2)
- ✓ Shared 2/3 (x2)
- ✓ Shared 1 (x1)

*** Install Standard Faucet ***