

NON STANDARD EXTRAS (680)			
Deerfield 2 - Phase 2			
PURCHASER: Spec Home		Printed: 1-Jun-21 1:04 pm	
LOT NUMBER	PHASE	HOUSE TYPE	CLOSING DATE
M72	2	120 THE HUNTLEY	2-Dec-21
ITEM	QTY	EXTRA / CHANGE	PRICE
*16 104336	1	GARAGE - GARAGE DOOR OPENER - BELT DRIVE 8355 Wifi - EACH - INCLUDES 1 REMOTE CONTROL AND 1 SENSOR KIT	\$ 929.00
32888		Note: Not available through retail outlets/professionally installed to MNF Specs. See items #17 & #18.	Each
17 88300	1	GARAGE - GARAGE DOOR OPENER - KEYLESS ENTRY CONTROL PAD ON GARAGE DOOR FRAME	\$ 90.00
32821		Note: As per floor plan sketch dated June 1, 2021. See items #16 & #18.	Each
18 88293	1	GARAGE - GARAGE DOOR OPENER - SUPPLY EXTRA REMOTE CONTROL(S) TRANSMITTER	\$ 75.00
32822		Note: See items #16 and #17.	Each
19 33722	1	KITCHEN - UPGRADE FROM GRANITE LEVEL 1 IN STANDARD KITCHEN LAYOUT C/W FLUSH B-BAR TO LEVEL 3 QUARTZ, EASED EDGE DETAIL, AS PER COUNTERTOP EDGE PROFILE SKETCH DATED June 1, 2021. REFERENCE #6 IN B1A'S.	\$ 1,569.00
		Note: As per floor plan sketch dated June 1, 2021. See items #12 & #51 for sink and faucet.	Each
20 33723	1	KITCHEN - DELETE ITEM #13 IN B1A'S RE: FRANKE CUBE CUX110-30-CA SINGLE BOWL STAINLESS STEEL 9" DEEP UNDERMOUNT KITCHEN SINK.	-\$855.00
		Note:	Each
21 88290	1	- - FLAT CEILING IN WHOLE HOUSE	\$ 2,245.00
33724		Note: Includes Family Room in Basement	Each
22 33786	1	KITCHEN - HARDWOOD - OAK - LAUZON 6 1/4" WIDE ESTATE NATURAL IN KITCHEN IN LIEU OF STANDARD.	\$ 1,490.00
		Note: As per floor plan sketch dated June 1, 2021.	Each
*23 88877	1	- - RHYTHM COLLECTION - UPGRADE FIXTURES THROUGHOUT	\$ 1,910.00
33726		Note: Price for Standard Layout and 4pc Ensuite. Does not include additional areas or fixtures. As per Rhythm lighting package sketch dated June 1, 2021.	Each
24 33727	1	KITCHEN - SUPPLY AND INSTALL FALSE BOTTOM WITH 5 UNDER CABINET LED PUCK LIGHTS ON UPPER KITCHEN CABINETS IN STANDARD KITCHEN LAYOUT C/W SEPERATE SWITCH	\$ 1,687.00
		Note:	Each
25 87972	1	KITCHEN - OTR - BASIC - 1.7 C/F MICROWAVE WITH HOOD - STAINLESS	\$ 75.00
33728		Note:	Each
26 33729	1	- - SUPPLY AND INSTALL UPGRADED CABINETRY HARDWARE POI-R7040-128-BSAE IN STANDARD KITCHEN LAYOUT, MAIN BATHROOM AND 4 PCE ENSUITE BATHROOM, IN LIEU OF STANDARD.	\$ 620.00
		Note:	Each
27 90835	1	KITCHEN - CABINETRY - EXTEND FRIDGE UPPER TO APPROX. 2FT DEEP (ALL SERIES)	\$ 187.00
33730		Note: Level 1 series cabinets, as per floor plan and Kitchen sketch dated June 1, 2021.	Each

NON STANDARD EXTRAS (680)			
Deerfield 2 - Phase 2			
PURCHASER: Spec Home		Printed: 1-Jun-21 1:04 pm	
LOT NUMBER	PHASE	HOUSE TYPE	CLOSING DATE
M72	2	120 THE HUNTLEY	2-Dec-21
ITEM	QTY	EXTRA / CHANGE	PRICE
*28 87999	2	KITCHEN - LOWER CABINETS - LC POTS & PANS C/W 3 DRAWER FRONTS 6/12/12	*\$ 1,408.00
33731	Note:	To be located on either side of range in standard kitchen layout, As per floor plan and Kitchen sketch dated June 1, 2021.	
*29 89056	1	MAIN BATHROOM - COUNTERTOP - QUARTZ - LEVEL 1 - MAIN BATHROOM	*\$ 668.00
34352	Note:	As per Countertop Edge Profile Sketch and Floorplan dated June 1, 2021	Each
*30 89053	1	ENSUITE BATH - COUNTERTOP - QUARTZ - LEVEL 1 - ENSUITE BATHROOM - OPT 4PC	*\$ 998.00
34353	Note:	As per Countertop Edge Profile Sketch and Floorplan dated June 1, 2021	Each
31 88914	1	MAIN BATHROOM - VANITY - UPGRADE MAIN BATHROOM VANITY CABINETRY TO LEVEL 1	\$ 229.00
34354	Note:	Standard Layout	Each
*32 88912	1	ENSUITE BATH - VANITY - UPGRADE 4PC ENSUITE VANITY CABINETRY LEVEL 1	*\$ 317.00
34355	Note:	Standard Layout	Each
*33 120185	2	ENSUITE BATH - LOWER CABINET BANK OF DRAWERS	*\$ 1,688.00
34359	Note:	One on each side of the sink, as per Bathroom Vanity Sketch and Floorplan dated June 1, 2021.	
34 88288	1	- PAINT ADDITIONAL COLOUR (NON DEEP BASE) BUILDERS STANDARD PAINT. PER COLOUR FOR COMPLETE HOUSE	\$ 1,050.00
33738	Note:		Each
35 111	1	FOYER - TILE - FLOOR - UPGRADE - SILVER - - FOYER / POWDER ROOM - SILVER	\$ 1,131.00
33739	Note:	As per floor plan and Floor tile sketch dated June 1, 2021. See item #36.	Each
36	1	FOYER - RECTANGULAR 1/3 STAGGERED SIDE TO SIDE INSTALLATION ONLY FOR (SILVER LEVEL) FLOOR TILES IN FOYER AND POWDER ROOM.	\$ 323.00
33740	Note:	As per floor tile installation sketch and floorplan dated June 1, 2021. See item #35.	Each
37 111	1	LAUNDRY ROOM - TILE - FLOOR - UPGRADE - SILVER - - LAUNDRY ROOM - SILVER	\$ 173.00
33741	Note:	As per floor plan and Floor Tile sketch dated June 1, 2021.	Each
38 111	1	ENSUITE BATH - TILE - FLOOR - UPGRADE - SILVER - - ENSUITE BATH 4PC - SILVER	\$ 453.00
33742	Note:	As per floor plan and Floor Tiles sketch dated June 1, 2021.	Each
*39 140	*1	ENSUITE BATH - TILE - WALL - UPGRADE - FLOOR TILE IN LIEU OF WALL - SILVER - - SHOWER SURROUND - ENSUITE BATHROOM - OPTIONAL (20) - SILVER	*\$ 1,024.00
33743	Note:	- As per wall Tile Installation sketch dated June 1, 2021.	Each

PREPARED BY: Simon Clarke
LOCKED BY: Tricia Oliver
PE 1,531-2
InvoiceSQL.rpt 05may21

Vendor Initials: _____ Purchaser Initials: _____

CONSTRUCTION SCHEDULING APPROVAL

PER: _____

DATE: _____

NON STANDARD EXTRAS (680)			
Deerfield 2 - Phase 2			
PURCHASER: Spec Home		Printed: 1-Jun-21 1:04 pm	
LOT NUMBER M72	PHASE 2	HOUSE TYPE 120 THE HUNTLEY	CLOSING DATE 2-Dec-21
ITEM	QTY	EXTRA / CHANGE	PRICE
*40 140		*1 - <i>ENSUITE BATH</i> - TILE - WALL - UPGRADE - FLOOR TILE IN LIEU OF WALL - SILVER -- TUB SURROUND - ENSUITE BATHROOM - OPTIONAL (20) - SILVER	*\$ 377.00
33744		Note: -Including Tub deck - As per wall Tile Installation sketch dated June 1, 2021.	Each
41 108		1 - <i>MAIN BATHROOM</i> - TILE - FLOOR - UPGRADE - BRONZE - MAIN BATHROOM - BRONZE	\$ 160.00
33745		Note: - As per Floor Tile sketch and Floorplan dated June 1, 2021.	Each
42 122		1 - <i>MAIN BATHROOM</i> - TILE - WALL - UPGRADE - SILVER - MAIN BATHROOM - SILVER	\$ 546.00
33746		Note: To be installed on Tub/Shower wall. See item #43 for installation. - As per wall Tile Installation sketch dated June 1, 2021.	Each
43		1 - <i>MAIN BATHROOM</i> - HORIZONTAL 1/3 OFFSET INSTALLATION ONLY FOR (SILVER LEVEL) WALL TILES IN MAIN BATHROOM TUB/SHOWER WALL.	\$ 234.00
33747		Note: - As per wall Tile Installation sketch dated June 1, 2021. See item #42.	Each
44 88508		2 - - CERAMIC TILE - GROUT COLOR PER COLOUR	\$ 150.00
33748		Note:	
45		1 - - HARDWOOD - OAK - 6 1/4" WIDE ESTATE SERIES NATURAL IN STANDARD AREAS.	\$ 6,046.00
33787		Note: To be installed in great room, dining room, Lower and upper hallways, as per floor plan sketch dated June 1, 2021.	Each
*46 107		*1 - <i>BASEMENT</i> - UNDERPAD - UPGRADE - LEVEL 1 -- BASEMENT STAIRCASE - LEVEL 1	*\$ 94.00
33750		Note: As per floor plan sketch dated June 1, 2021.	Each
*47 107		*1 - <i>BASEMENT</i> - UNDERPAD - UPGRADE - LEVEL 1 -- FAMILY ROOM - LEVEL 1	*\$ 333.00
33751		Note: As per floor plan sketch dated June 1, 2021.	Each
*48 107		*1 - <i>BEDROOM 2</i> - UNDERPAD - UPGRADE - LEVEL 1 -- BEDROOM 2 - LEVEL 1	*\$ 140.00
33752		Note: As per floor plan sketch dated June 1, 2021.	Each
*49 107		*1 - <i>BEDROOM 3</i> - UNDERPAD - UPGRADE - LEVEL 1 -- BEDROOM 3 - LEVEL 1	*\$ 153.00
33753		Note: As per floor plan sketch dated June 1, 2021.	Each
*50 107		*1 - <i>MASTER BEDROOM</i> - UNDERPAD - UPGRADE - LEVEL 1 -- MASTER BEDROOM / WIC OPT ENSUITE - LEVEL 1	*\$ 213.00
33754		Note: As per floor plan sketch dated June 1, 2021.	Each
51 118342		1 - <i>KITCHEN</i> - KITCHEN SINK - FRANKE CUBE CUX120-CA DOUBLE BOWL STAINLESS STEEL 9" DEEP UNDERMOUNT SINK	\$ 1,140.00
33755		Note: See Item 19 for Solid Surface Countertops.	Each

NON STANDARD EXTRAS (680)			
Deerfield 2 - Phase 2			
PURCHASER: Spec Home		Printed: 1-Jun-21 1:04 pm	
LOT NUMBER	PHASE	HOUSE TYPE	CLOSING DATE
M72	2	120 THE HUNTLEY	2-Dec-21
ITEM	QTY	EXTRA / CHANGE	PRICE INTERNAL USE
52 88571 33756	1	1 - MAIN BATHROOM - BATHROOM SINK - AMERICAN STANDARD BOXE UNDERMOUNT SINK 0315 - 000 Note: See Item 29 for Solid Surface Countertops.	\$ 285.00 Each
53 88571 33757	1	1 - ENSUITE BATH - BATHROOM SINK - AMERICAN STANDARD BOXE UNDERMOUNT SINK 0315 - 000 Note: See Item 30 for Solid Surface Countertops.	\$ 285.00 Each
*54 88217 33758	1	1 - MAIN BATHROOM - BATHROOMS - DELTA TRINSIC SINGLE HANDLE HIGH - ARC LAVATORY FAUCET 559HA - DST Note: See item #29.	*\$ 304.00 Each
*55 88217 33759	1	1 - ENSUITE BATH - BATHROOMS - DELTA TRINSIC SINGLE HANDLE HIGH - ARC LAVATORY FAUCET 559HA - DST Note: See item #30	*\$ 304.00 Each
*56 88217 33760	1	1 - POWDER ROOM - BATHROOMS - DELTA TRINSIC SINGLE HANDLE HIGH - ARC LAVATORY FAUCET 559HA - DST Note:	*\$ 304.00 Each
57 88043 34361	1	1 - ENSUITE BATH - BATHROOMS - DELTA TRINSIC SHOWER FAUCET T14259-R10000-UNBX WITH H2O KINETIC RAINCAN SHOWER HEAD CHROME Note:	\$ 160.00 Each
*58 88562 33762	1	1 - ENSUITE BATH - BATHROOMS - DELTA TRINSIC ROMAN TUB FAUCET T2759 CHROME Note:	*\$ 346.00 Each
59 127 33763	1	1 - KITCHEN - TILE - WALL - BACKSPLASH - UPGRADE - BRONZE - - KITCHEN - BRONZE Note: - See item #60 for installation. - As per Wall Tile Installation sketch dated June 1, 2021.	\$ 152.00 Each
60 126 34425	1	1 - KITCHEN - TILE - WALL - BACKSPLASH - INSTALLED STAGGERED - INSTALLATION ONLY - - KITCHEN - . Note: As per Wall Tile Sketch dated June 1, 2021. See item 59	\$ 114.00 Each
61 33765	1	- - CLARIFICATION TO ITEMS # 7,# 8 & # 9: MODERN POSTS TO BE CAPPED INSTEAD OF BEVELLED. Note:	\$ 0.00 Each
62 33785	1	- - RE: ITEM #10 IN B1A'S OAK STAIRCASE TO BE COMPLETE WITH UPGRADED 6 1/4" WIDE ENGINEERED HARDWOOD LANDINGS (NATURAL) IN LIEU OF STANDARD 3 1/8" WIDE ENGINEERED HARDWOOD LANDINGS. Note: As per floor plan sketch dated June 1, 2021.	\$ 418.00 Each

Sub Total	\$31,742.00
HST	\$0.00
Total	\$31,742.00

NON STANDARD EXTRAS (680)
Deerfield 2 - Phase 2

PURCHASER: Spec Home

Printed: 1-Jun-21 1:04 pm

LOT NUMBER M72	PHASE 2	HOUSE TYPE 120 THE HUNTLEY	CLOSING DATE 2-Dec-21
-------------------	------------	-------------------------------	--------------------------

ITEM	QTY	EXTRA / CHANGE	PRICE	INTERNAL USE
------	-----	----------------	-------	--------------

Payment Summary	
<u>Paid By</u>	<u>Amount</u>
Amendment	\$31,742.00
<u>Total Payment:</u>	<u>\$31,742.00</u>

PURCHASER:

Spec Home

01-Jun-21

DATE

VENDOR:

PER: Valecraft Homes Limited

DATE:

CONSTRUCTION SCHEDULING APPROVAL

PER:

DATE:



Valecraft
Homes Ltd.

Rhythm Collection

All Models
UPGRADE

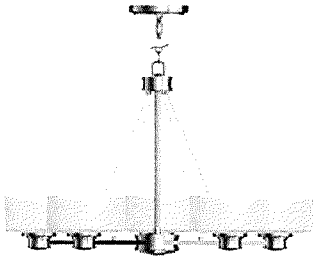

DINING ROOM

SAN-A51065-11
28" Wide x 20" High
Bulbs: 5 x A19 LED Bulb

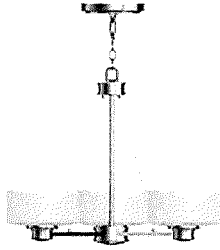

BREAKFAST / DINETTE

SAN-A51063-11
22" Wide x 18" High
Bulbs: 3 x A19 LED Bulb



STAIRWELL / HIGH CEILING (Plan Permitting)

SAN-A51053-11
17" dia. x 23" High
Bulbs: 3 x A19 LED Bulb

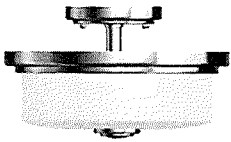

ENTRY

SAN-A51042-11
13" dia. x 10" High
Bulbs: 2 x A19 LED Bulb

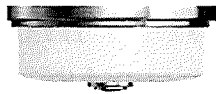

ENTRY / HALL / LAUNDRY / BEDROOMS / BATH CEILING / DEN / STUDY / FINISHED BASEMENT AREAS (Plan Permitting)

SAN-A51032-11
13" dia. x 6" High
Bulbs: 2 x A19 LED Bulb



KITCHEN / MASTER BEDROOM

SAN-A51033-11
19" dia. x 9" High
Bulbs: 3 x A19 LED Bulb

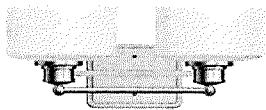

POWDER ROOM VANITY (Plan Permitting)

SAN-A51012-11
16" Wide
Bulbs: 2 x A19 LED Bulb
Can be mounted up or down

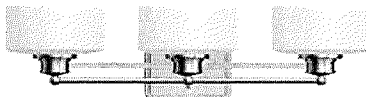

BATHROOM VANITY

SAN-A51013-11
25" Wide
Bulbs: 3 x A19 LED Bulb
Can be mounted up or down

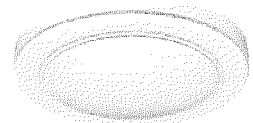

PANTRY / CLOSET

FM-MS60-0510-4K-WH
6" dia.
LED C/W motion sensor
(no wall switch when this fixture is used)



FRONT EXTERIOR (Plan Permitting)

SAN-A1010-6
Bulb: 1 x A19 LED Bulb

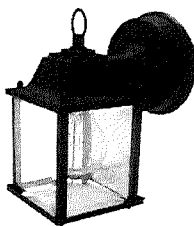

BACK EXTERIOR

SAN-A40455-6
Bulb: 1 x A19 LED Bulb

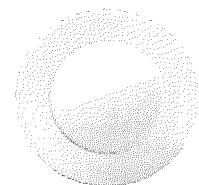

BASEMENT STAIRS / SOFFIT (Plan Permitting)

AFR4-0930-WH
LED Recessed Light
5" dia.

* All dimensions are approximate.

Project: DV2

Purchaser: _____

Plan #: 4M-1290

Purchaser: _____

Lot: M72

Date: _____

Model: 120 Huntley Std.

Upgrade #: 23

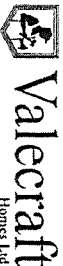

THE HUNTLEY

MODEL 120
2221 sq.ft.
(474 sq.ft. Basement)

Site:	Deerfield Village 2	Purchaser:	
Plan No.:	4M-1290		
Lot:	M72	Purchaser:	
Date:	June 1, 2021		

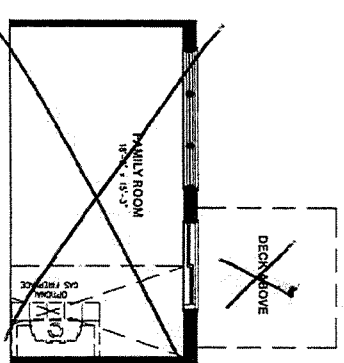
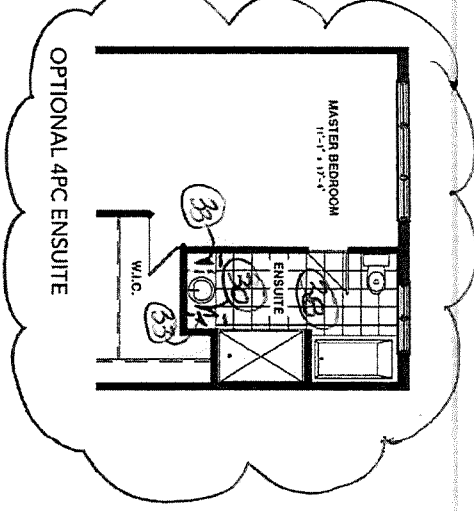
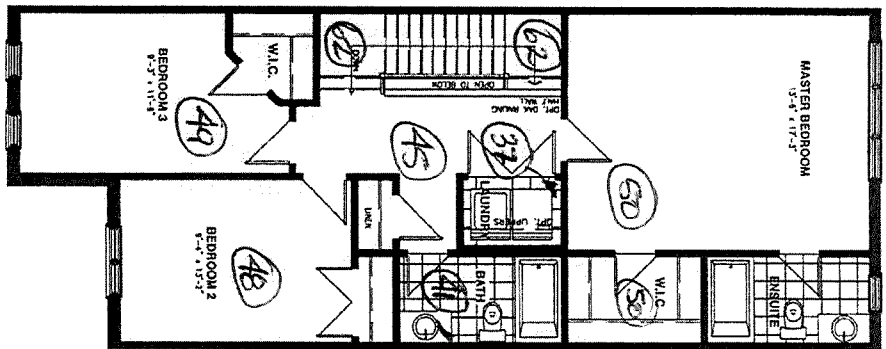
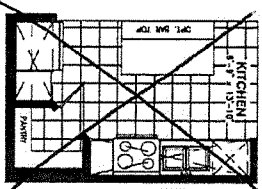
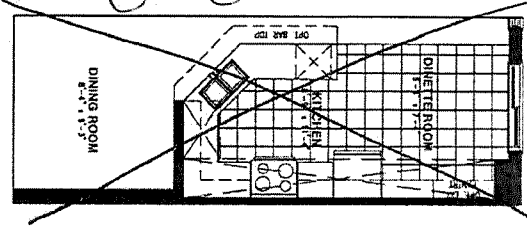
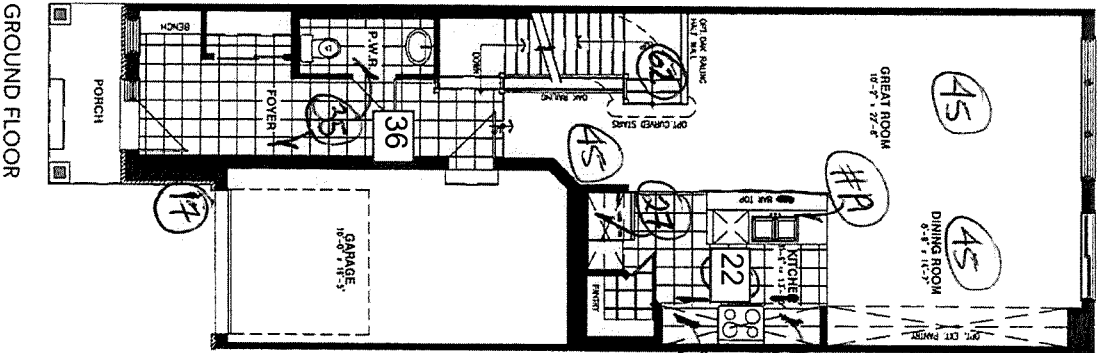
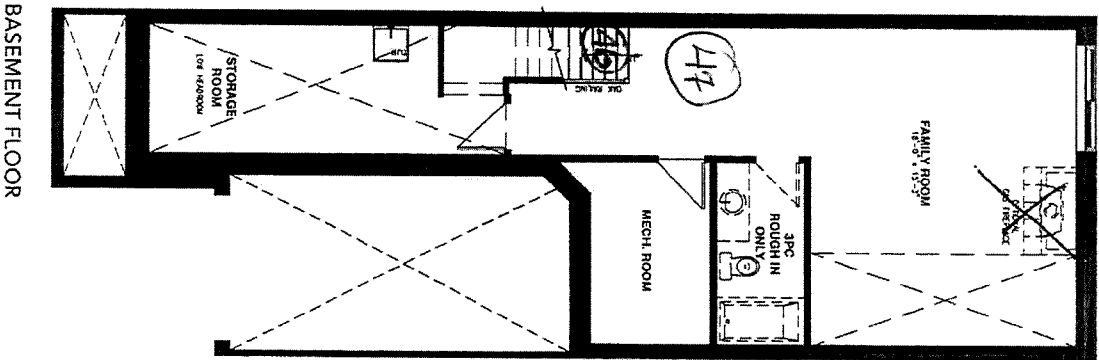

Floor plan sketch



Vertical and/or horizontal bulkheads (chaseways) may be required to contain mechanical piping. All dimensions are approximate. E. & O.E., plans, materials and specifications are subject to change without notice. Actual useable floor space may vary from the stated floor area. *Note: Number of steps varies due to site grading.

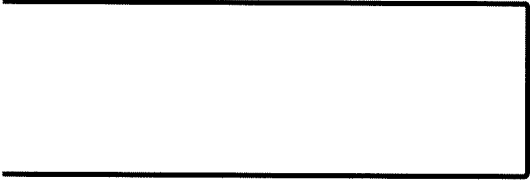
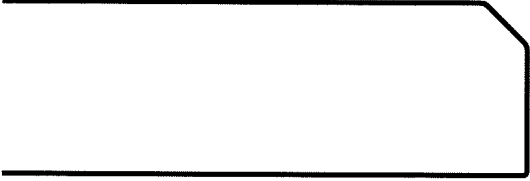
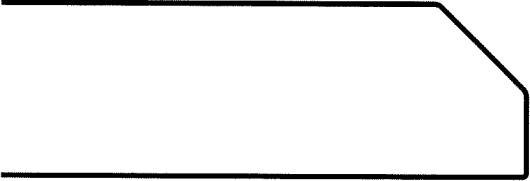
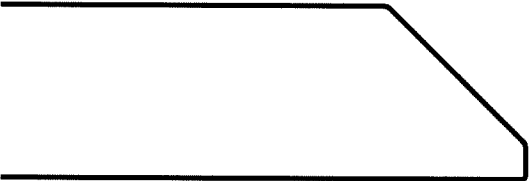
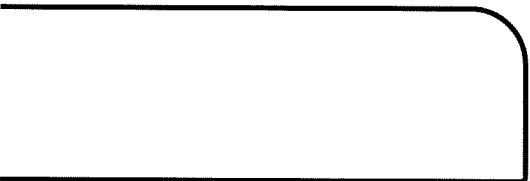
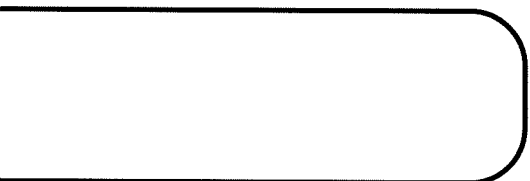
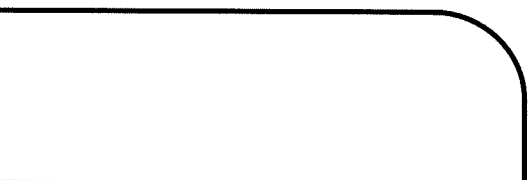
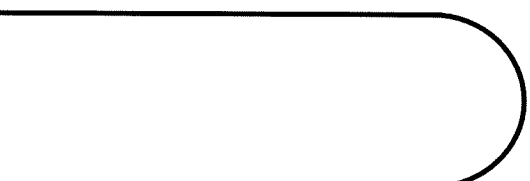

Standard Edge Profiles for Granite & Quartz

	Eased Edge	Kitchen Quartz #19 Main Bathroom Quartz #29 4 Pce Ensuite Quartz #30
	1/4 Bevel	
	1/2 Bevel	
	3/4 Bevel	
	Pencil Top Only with Square Bottom	
	Pencil Top and Bottom	
	1/2 Bullnose	
	Full Bullnose	

Project: DV2

Purchaser: _____

Plan #: 4M-1290

Purchaser: _____

Lot: M72

Date: June 1, 2021

Model: 120 The Huntley

Upgrade #: 19, 29, 30



Tile Installation Options

FLOOR TILE

Standard square

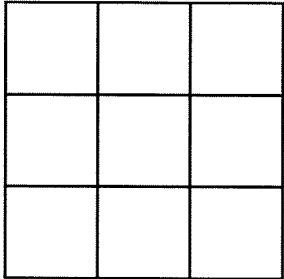

Main Bathroom

Square brick

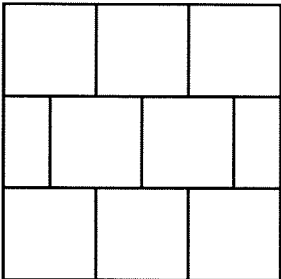

Rectangular
front to back of the house

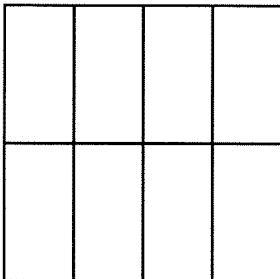

Laundry Area
4pce Ensuite Bathroom

Rectangular
side to side of the house

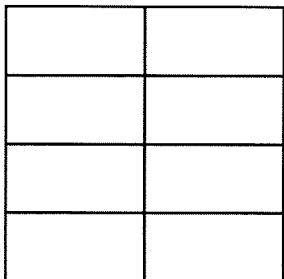

Rectangular 1/3 staggered
front to back of the house

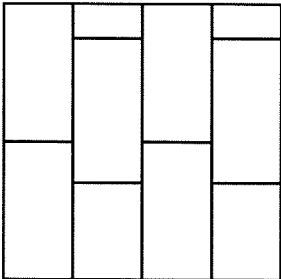

Rectangular 1/3 staggered
side to side of the house

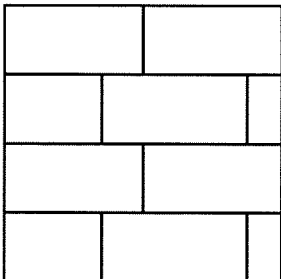

Foyer & Powder Room

45 degree

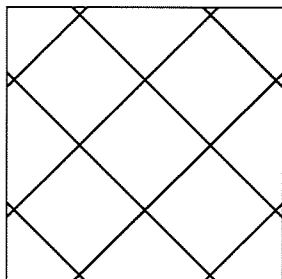

Project: DV2

Plan #: 4M-1290

Lot: M72

Model: 120 The Huntley Std.

Purchaser: _____

Purchaser: _____

Date: June 1, 2021

Upgrade #: 35, 36, 37, 38, 41



Tile Installation Options

WALL TILE

Vertical stacked

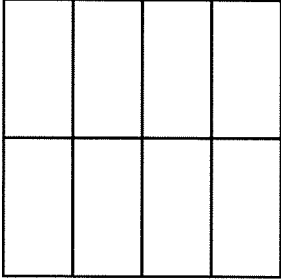

Horizontal stacked

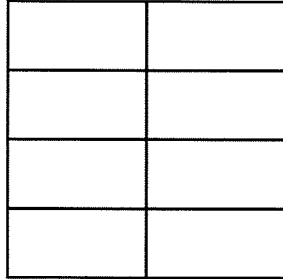

4pce Ensuite Tub Deck
4pce Ensuite Tub
Backsplash
4pce Ensuite Shower
Walls

Vertical 1/3 offset brick

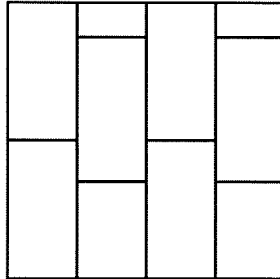

Horizontal 1/3 offset brick

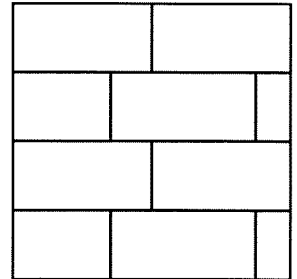

Kitchen Backsplash
Main Bathroom

Vertical brick

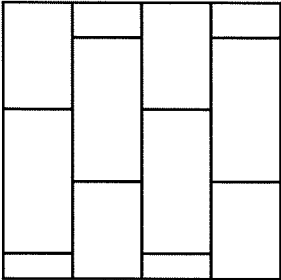

Horizontal brick

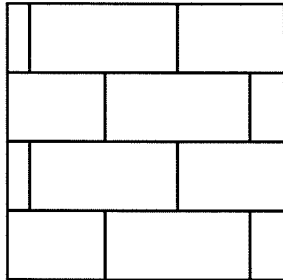

45 degree

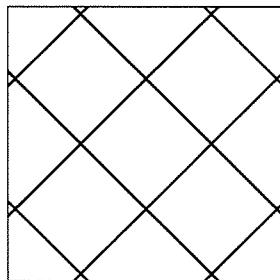

Standard square

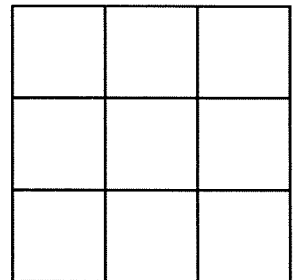

Project: DV2

Plan #: 4M-1290

Lot: M72

Model: 120 The Huntley Std.

Purchaser: _____

Purchaser: _____

Date: June 1, 2021

Upgrade #: 39, 40, 42, 43, 59, 60

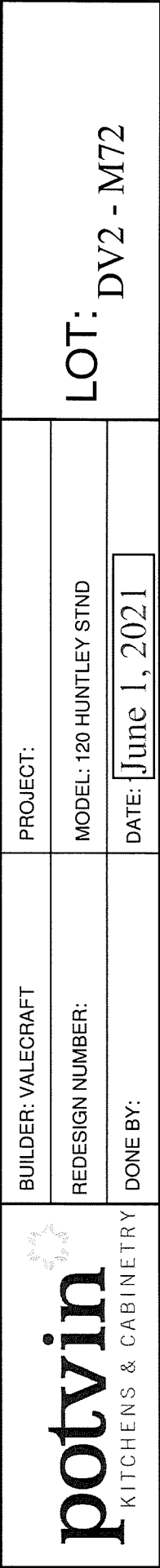

PROJECT:

MODEL: 120 HUNTLEY STND

DATE: June 1, 2021

LOT: DV2 - M72

DIMENSIONS MAY VARY DEPENDING ON SITE MEASURES/CONDITIONS

KITCHEN SKETCH

The sketch illustrates a kitchen layout with the following dimensions and components:

- Overall Dimensions:**
 - Top horizontal: 2769
 - Left vertical segments: 28.5, 1384.5, 28.5
 - Right vertical segments: 28.5, 975, 28.5
 - Bottom horizontal segments: 950, 812, 950
- Component Labels:**
 - 28**: Kitchen 914mm uppers (two units)
 - 27**: Fridge opening: Ø900mm x 1817mm
 - 19**: Kitchen 914mm uppers (lower section)
 - Drawer**: Located below the lower kitchen unit.
 - SHORTER TOP DRAWER FOR PLUG**: Located below the drawer.
- Additional Dimensions:**
 - Top right horizontal: 1315
 - Top right vertical segments: 870, 445
 - Top right horizontal segments: 25, 400, 850, 40
 - Top right vertical segments: 25, 375, 915
 - Bottom right horizontal segments: 525, 850, 616, 84, 392
 - Bottom right vertical segments: 1683, 2075

KITCHEN SKETCH

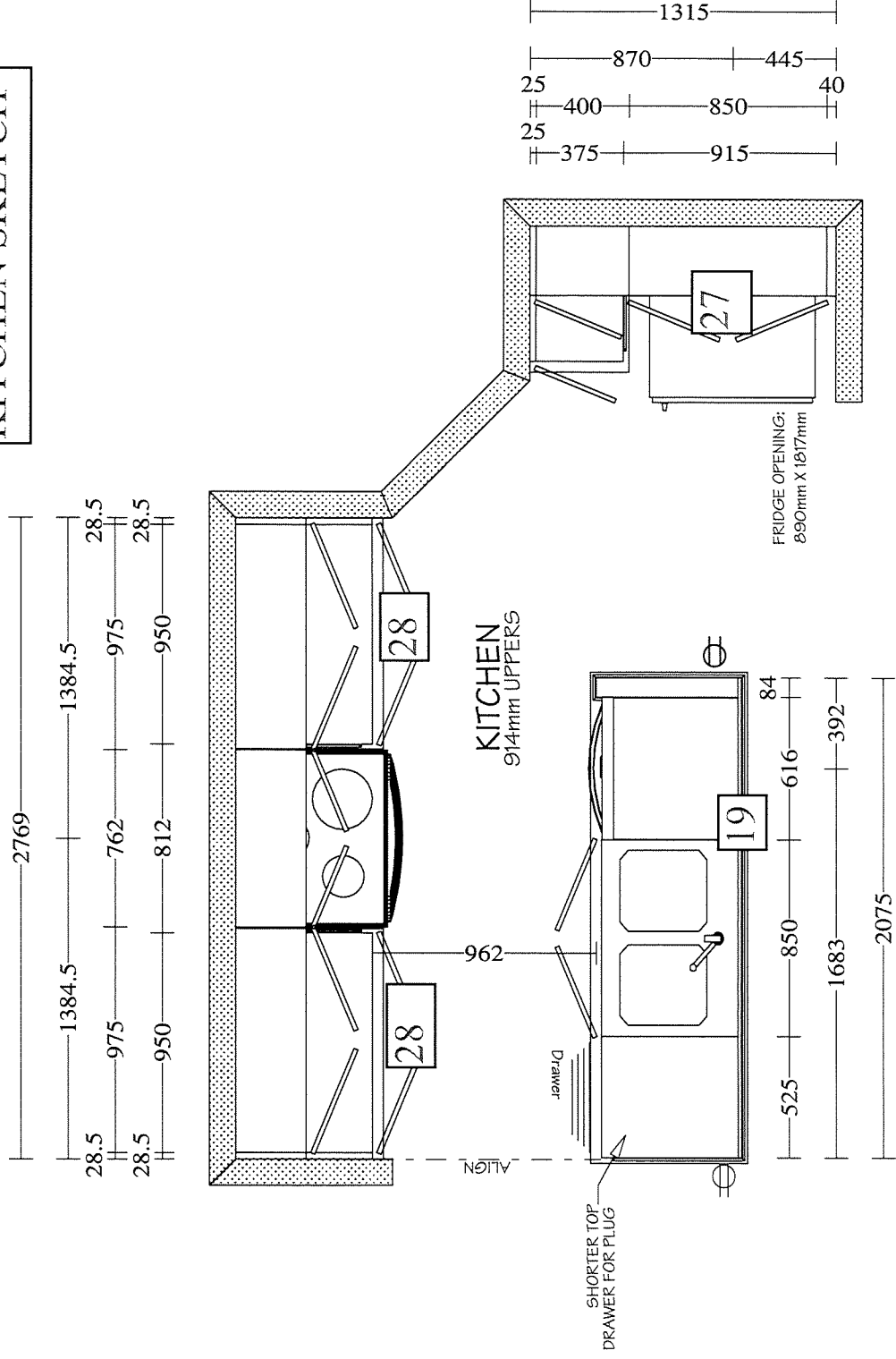



BUILDER: VALECRAFT

PROJECT:

BATHROOM VANITY SKETCH

REDESIGN NUMBER:

MODEL: 120 HUNTLEY STND

LOT: DV2 - M72

DONE BY:

DATE: June 1, 2021

DIMENSIONS MAY VARY DEPENDING ON SITE MEASURES/CONDITIONS

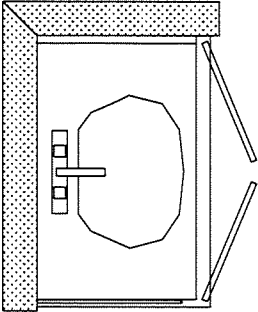
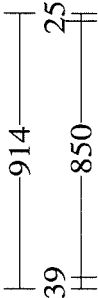

MAIN BATH

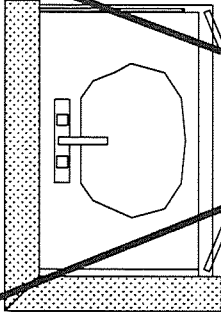
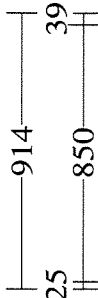

ENSUITE

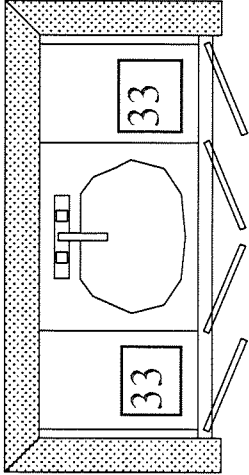
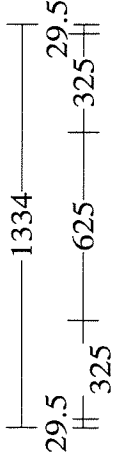

OPT. 4PC ENSUITE

