



NON STANDARD EXTRAS (680)			
Place St. Thomas - Phase 5			
PURCHASERS: Maaz Irfan and Aisha Rahmaan			Printed: 16-Sep-21 10:27 am
LOT NUMBER	PHASE	HOUSE TYPE	CLOSING DATE
5	5	1086 THE STEEL ELEV C	7-Dec-21
ITEM	QTY	EXTRA / CHANGE	PRICE
*44 90924	1	KITCHEN/DINETTE - CABINETRY - UPGRADE TO 2 KITCHEN CABINETRY DOOR COLOURS	* \$0.00
36837	Note:	- As per Kitchen Sketch dated September 16, 2021 - As per Pantry Sketch dated September 16, 2021 - As per Contractor	Each
45	1	KITCHEN/DINETTE - SEE COLOUR REV. #2 DATED SEPTEMBER 16, 2021.	N/C
36836	Note:	- Kitchen Cabinetry (Style & Colour) - Kitchen Hardware Installation (Installed Horizontally on all doors and drawers) as accepted by Contractor	Each

Sub Total	\$0.00
HST	\$0.00
Total	\$0.00

Payment Summary	
Paid By	Amount
Total Payment:	

PURCHASER:

DocuSigned by:

16-Sep-21

DATE

PURCHASER:

DocuSigned by:

16-Sep-21

DATE

VENDOR:

DocuSigned by:

September 16, 2021

DATE:

PREPARED BY: Adam Bowman
LOCKED BY: Tricia Oliver
PE 1,707-1

CONSTRUCTION SCHEDULING APPROVAL

PER: _____

DATE: _____

	BUILDER: VALECRAFT	Place St. Thomas 5	Purchaser: Maaz Irfan Purchaser: Aisha Rahmaan
	Plan: 50M-348	MODEL: 1086 STEEL STND	
	Lot: 5 - Phase 5	Date: September 16, 2021	

PLEASE APPROVE
KITCHEN OPT. 1

Lastra Weekend
Getaway #TA-M2003
(Horizontal Grain Pattern)

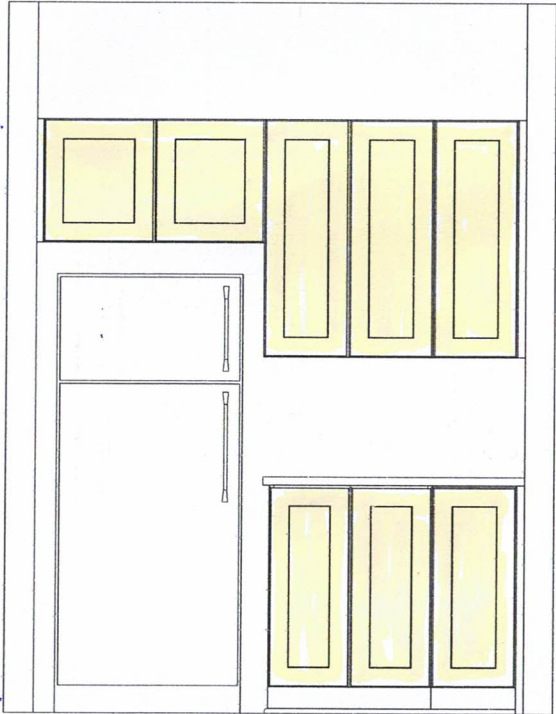

Lastra Weekend
Getaway #TA-M2003
(Horizontal Grain Pattern)

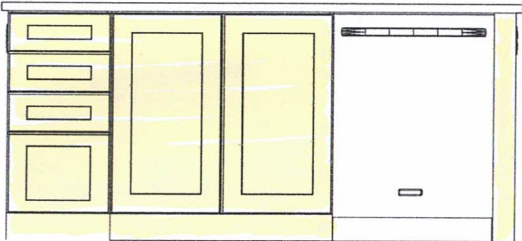

100i-B10R
Thermoplastic

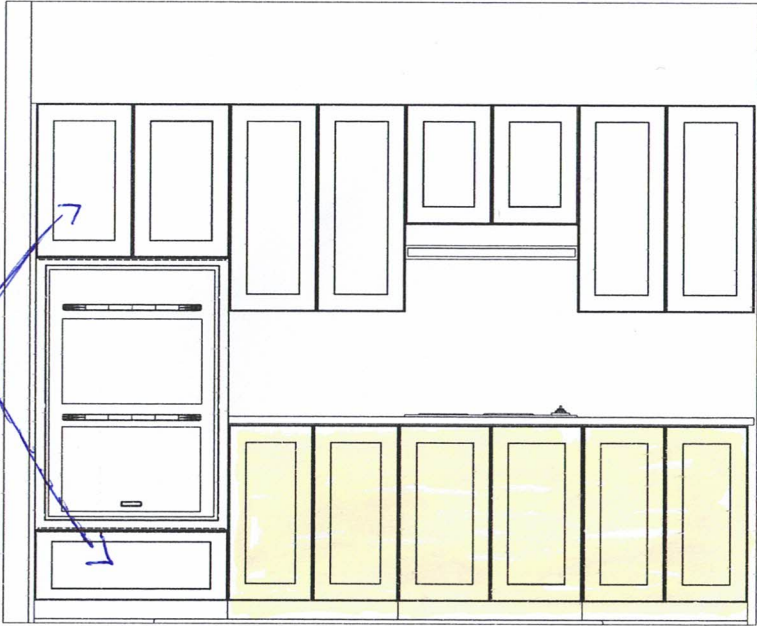

100i-B10R
Thermoplastic

Lastra Weekend
Getaway #TA-M2003
(Horizontal Grain Pattern)



DS
MI

DS
AR

DS
FN

	BUILDER: VALECRAFT	Place St. Thomas 5	Purchaser: Maaz Irfan Purchaser: Aisha Rahmaan
	Plan: 50M-348	MODEL: 1086 STEEL STND	
	Lot: 5 - Phase 5	Date: September 16, 2021	

PLEASE APPROVE

EXTENDED PANTRY OPTION

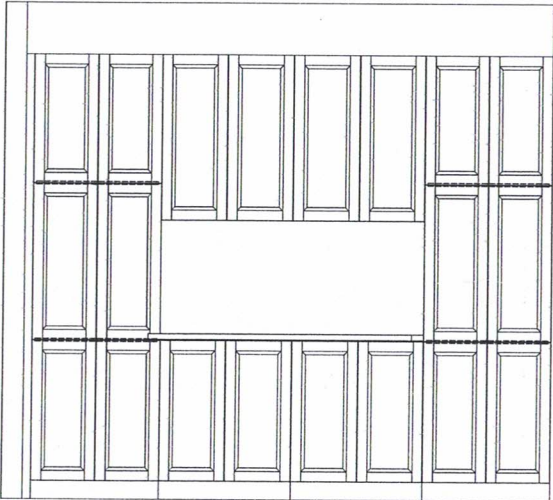
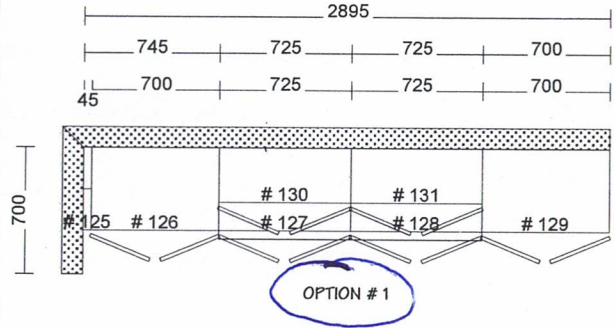

EXTENDED PANTRY OPTION

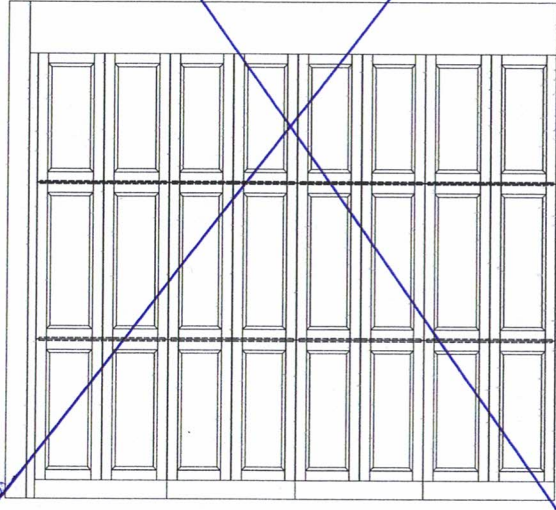
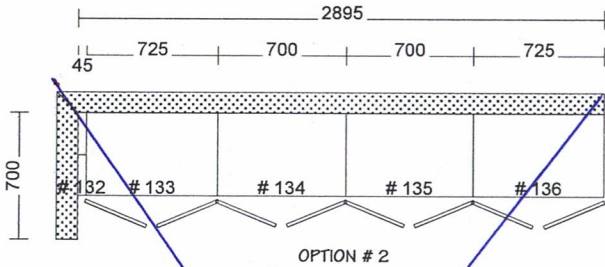

EXTENDED PANTRY OPTION

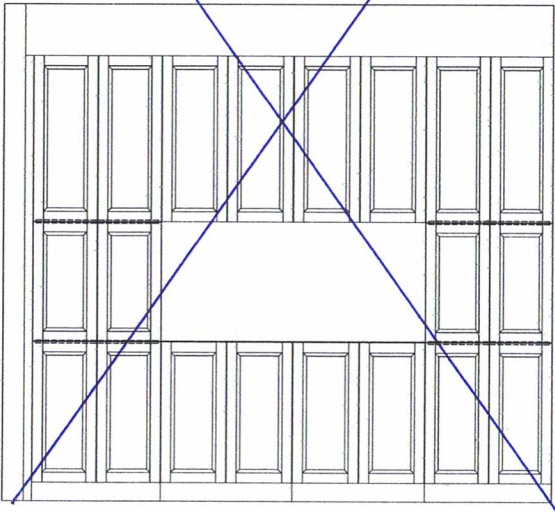
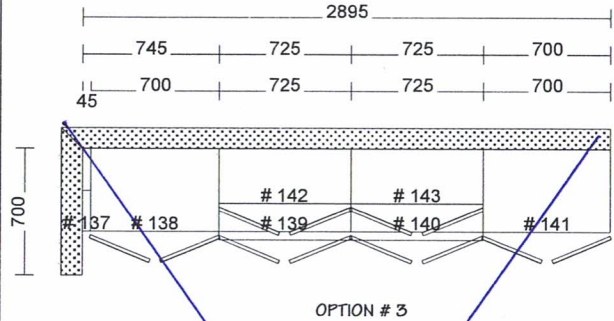

DS
MI

DS
AR

DS
FN

Pantry Sketch - September 20, 2021

	SINGLES AND TOWNS COLOUR CHART - Revision #2					
	Community:	Place St. Thomas 5	Reg'd Plan #:	50M-348	Sales Rep:	A. Bowman
	Lot No:	5 - Phase 5	Civic Address:	932 Lucerne Drive, Embrun ON K0A 1W0		
	Purchaser(s):	Maaz Irfan			Model Name/#:	Steel #1086 "C"
	Purchaser(s):	Aisha Rahmaan			Closing Date:	07-Dec-21
CABINETRY						
ROOM	SELECTION			LEVEL	STD/UPG #	
KITCHEN	STYLE AND COLOUR	Lastra Weekend Getaway #TA-M2003 (Grain Pattern installed horizontally) - Installed on all Fridge Wall cabinetry - Installed on all Kitchen Island cabinetry - Installed on lower cabinetry (stove wall between microwave/wall oven & extended pantry) 100i-B10R Thermoplastic - Installed on microwave/wall oven Cabinetry - Installed on upper cabinetry (stove wall between microwave/wall oven & extended pantry) - Installed on all upper, lower and pantry doors in Extended Pantry Option 1 in Dinette *Please see Kitchen Sketch dated Sep 16-21 *Please see Pantry Sketch dated Sep 16-21		STD	9, 10, 11, 14, 42 44, 45	
	HARDWARE CODE	POI-R20004-192-NM (Installed Horizontally)	TYPE	Handles	UPG	10, 25, 45
	COUNTERTOP		COUNTERTOP EDGE PROFILE			
JACK & JILL BATHROOM	STYLE AND COLOUR					
	HARDWARE CODE		TYPE			
	COUNTERTOP		COUNTERTOP EDGE PROFILE			
ENSUITE BATHROOM	STYLE AND COLOUR					
	HARDWARE CODE		TYPE			
	COUNTERTOP		COUNTERTOP EDGE PROFILE			
POWDER ROOM	STYLE AND COLOUR					
	HARDWARE CODE		TYPE			
	COUNTERTOP		COUNTERTOP EDGE PROFILE			
BEDROM #2 BATHROOM	STYLE AND COLOUR					
	HARDWARE CODE		TYPE			
	COUNTERTOP		COUNTERTOP EDGE PROFILE			
LAUNDRY ROOM	STYLE AND COLOUR					
	HARDWARE CODE		TYPE			
	COUNTERTOP		COUNTERTOP EDGE PROFILE			

DocuSigned by:

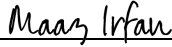

Purchaser's Signature(s) :

DocuSigned by:



Purchaser's Signature(s) :

DocuSigned by:



Approved By :

Date:

September 16, 2021

Date:

September 16, 2021

Date:

September 16, 2021