

Internal B1A
Deerfield 2 - Phase Condo

PURCHASER: Portobello Partnership

Printed: 25-Oct-21 1:41 pm

| | | | |
|-----------------------------------|-----------------------|---------------------------|----------------------------------|
| LOT NUMBER V56 Level: 2 | PHASE Condo | HOUSE TYPE 5207 | CLOSING DATE 21-Jul-22 |
|-----------------------------------|-----------------------|---------------------------|----------------------------------|

| ITEM | QTY | EXTRA / CHANGE | PRICE | INTERNAL USE |
|---------------------------|-----|--|---------------|--------------|
| *7 120204 37199 | 1 | KITCHEN - ADD UPPER AND LOWER CABINERY INCLUDING BACKSPLASH - PER LINEAR FOOT - BUILDER'S STANDARDS Note: Between corner pantry and wall. As per Kitchen Sketch and Schedule H dated October 25, 2021. | * \$ 1,968.00 | Each |
| 8 119625 37201 | 1 | KITCHEN - COUNTERTOP - GRANITE - LEVEL 1 - KITCHEN Note: Countertop edge to be eased edge, as per countertop edge profile sketch, Kitchen Sketch and Schedule H dated October 25, 2021. See items #20 (Kitchen Faucet) & #19 (Kitchen Sink). See item #7 for additional countertop area. | \$ 4,553.00 | Each |
| 9 90835 37452 | 1 | KITCHEN - CABINERY - EXTEND FRIDGE UPPER TO APPROX. 2FT DEEP (ALL SERIES) Note: In standard series cabinetry, as per Kitchen Sketch and Schedule H dated October 25, 2021. | \$ 187.00 | Each |
| 10 87999 37453 | 1 | KITCHEN - LOWER CABINETS - LC POTS & PANS C/W 3 DRAWER FRONTS 6/12/12 Note: In standard series cabinetry & hardware. To be located between range and corner pantry, as per Kitchen Sketch and Schedule H dated October 25, 2021. See item #11 for Bank of Drawers relocation. | \$ 704.00 | Each |
| 11 37454 | 1 | KITCHEN - RELOCATE STANDARD BANK OF DRAWERS IN KITCHEN TO BE RELOCATED IN BETWEEN REFRIGERATOR AND KITCHEN SINK. Note: As per Kitchen Sketch and Schedule H dated October 25, 2021. | \$ 87.00 | Each |
| 12 37455 | 1 | - DELETE ALL BUILDERS STANDARD FLOORING IN ALL ROOMS (CERAMIC FLOORS, HARDWOOD FLOORS, CARPET AND UNDERPAD) AND SUPPLY AND INSTALL TORLYS FLOORING. Note: To be installed (side to side) in Entry/Foyer, Living/Dining Room, Kitchen, Storage Room, Mechanical Room, Laundry Closet, Main Bathroom, Ensuite Bathroom, Bedroom Hallway, Master Bedroom & WIC and Bedroom #2, as per Schedule H dated October 25, 2021. | \$ 4,239.00 | Each |
| 13 88508 37456 | 1 | - CERAMIC TILE - GROUT COLOR PER COLOUR Note: | \$ 75.00 | Each |
| 14 127 37457 | 1 | KITCHEN - TILE - WALL - BACKSPLASH - UPGRADE - BRONZE - - KITCHEN - BRONZE Note: As per wall tile installation sketch dated October 25, 2021. See item #15 for installation pattern. | \$ 163.00 | Each |
| 15 124 37458 | 1 | KITCHEN - TILE - WALL - BACKSPLASH - INSTALLED IN A BRICK PATTERN - INSTALLATION ONLY - - KITCHEN - . Note: As per wall tile installation sketch dated October 25, 2021. See item #14. | \$ 123.00 | Each |
| 16 140 37459 | 1 | ENSUITE BATH - TILE - WALL - UPGRADE - FLOOR TILE IN LIEU OF WALL - SILVER - - ENSUITE BATHROOM - SILVER Note: To be installed in Ensuite Bathroom shower wall, as per wall tile installation sketch dated October 25, 2021. | \$ 1,129.00 | Each |
| 17 122 37460 | 1 | MAIN BATHROOM - TILE - WALL - UPGRADE - SILVER - - MAIN BATHROOM - SILVER Note: To be installed in Main Bathroom tub/shower, as per wall tile installation sketch dated October 25, 2021. See item #18 for installation pattern. | \$ 625.00 | Each |

Vendor Initials: _____ Purchaser Initials: _____

| | |
|---|-------|
| CONSTRUCTION SCHEDULING APPROVAL | |
| PER: _____ | _____ |
| DATE: _____ | _____ |

REPAIRED BY: Nicole Trudel

LOCKED BY: Tricia Oliver

PROJECT: 1,744-1

voiceSQL.rpt 01sept21

Internal B1A
Deerfield 2 - Phase Condo

PURCHASER: Portobello Partnership

Printed: 25-Oct-21 1:41 pm

| | | | |
|-----------------------------------|-----------------------|---------------------------|----------------------------------|
| LOT NUMBER V56 Level: 2 | PHASE Condo | HOUSE TYPE 5207 | CLOSING DATE 21-Jul-22 |
|-----------------------------------|-----------------------|---------------------------|----------------------------------|

| ITEM | QTY | EXTRA / CHANGE | PRICE | INTERNAL USE |
|-------------|-----|--|-----------|--------------|
| 18 116 | 1 | MAIN BATHROOM - TILE - WALL - INSTALLED IN A BRICK PATTERN - INSTALLATION ONLY - - MAIN BATHROOM - . | \$ 175.00 | Each |
| 37462 | | Note: To be installed in Main Bathroom tub/shower, as per wall tile installation sketch dated October 25, 2021. See item #17 for upgraded tiles. | | |
| 19 88544 | 1 | KITCHEN - KITCHEN SINK - REGINOX ND1831UA/9 DOUBLE BOWL UNDERMOUNT SINK | \$ 143.00 | Each |
| 37461 | | Note: See item #8 for solid surface countertops. See item #20 for (Kitchen faucet). | | |
| 20 88428 | 1 | KITCHEN - KITCHEN FAUCET - DELTA MARLEY 986LF - AR ARCTIC STAINLESS | \$ 358.00 | Each |
| 37463 | | Note: See item #8 for solid surface countertops. See item #19 for (Kitchen sink). | | |

| | |
|--------------|--------------------|
| Sub Total | \$14,529.00 |
| HST | \$0.00 |
| Total | \$14,529.00 |

| Payment Summary | |
|------------------------|--------------------|
| <u>Paid By</u> | <u>Amount</u> |
| APS | \$14,529.00 |
| Total Payment: | \$14,529.00 |

PURCHASER: _____ 25-Oct-21
 Portobello Partnership **DATE**
VENDOR: _____
 PER: Valecraft Homes Limited

DATE: _____

REPAIRED BY: Nicole Trudel

BOOKED BY: Tricia Oliver

FILE 1,744-2

voiceSQL.rpt 01sept21

| CONSTRUCTION SCHEDULING APPROVAL | |
|---|-------|
| PER: | _____ |
| DATE: | _____ |

Schedule "W4" Granite & Variegated Quartz Colour Variation

Purchaser's name: Portobello Partnership Lot no: T32
Purchaser's name: Contact: Samar Merhi Project: DEERFIELD VILLAGE 2
Home Phone: _____ Model: 5207
Work Phone: 613-837-2754 Closing Date: June 9th, 2022
E-Mail (1): design@valecraft.com E-Mail (2): _____

Valecraft Homes Ltd. continues to provide the best in class sales and service. We recognize the importance of your home to you, our valued customer.

Granite & Variegated Quartz countertops are an elegant addition to your home. However, there are some things of which you should be aware.

Due to the natural composition of **Granite**, inherent variations in texture, colour and consistency are to be expected and considered as normal.

During the process of manufacturing **Variegated Quartz** to achieve a more natural stone look, variations in the appearance between the sample & the slab are to be expected.

Valecraft Homes Limited strongly suggests that you attend an appointment with our granite/quartz supplier two to three months prior to closing to view the granite/variegated quartz slabs available in the colour you have already chosen. A representative from our supplier will contact you to set up a mutual date & time for the appointment.

I/we, Portobello Partnership

have read and fully understand the aforementioned recommendation set forth by the builder and as such hereby release VALECRAFT HOMES LIMITED from future responsibility with respect to a variation in colour of granite countertops.

We accept this opportunity

We decline this opportunity

Project: DEERFIELD VILLAGE 2 **LOT NO:** T32

Purchaser **Date:** _____

Purchaser **Date:** _____

T. Oliver October 25, 2021
Valecraft Homes Limited **Date:** _____

Appointment date given: _____ Spoke with/left message: _____

Time scheduled: _____ Date & Time: _____



Tile Installation Options

WALL TILE

Vertical stacked

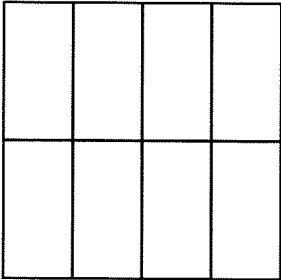

Horizontal stacked

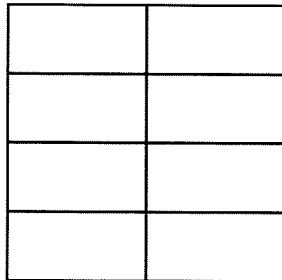

Ensuite Bathroom

Vertical 1/3 staggered

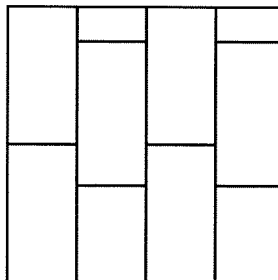

Horizontal 1/3 staggered

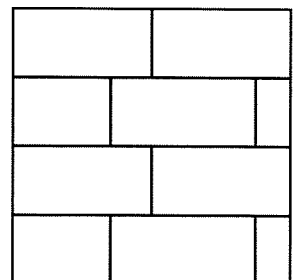

Vertical brick

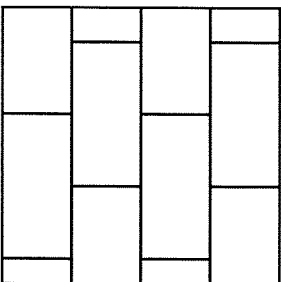

Horizontal brick

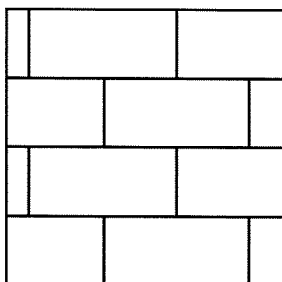

Kitchen Backsplash
Main Bathroom

45 degree

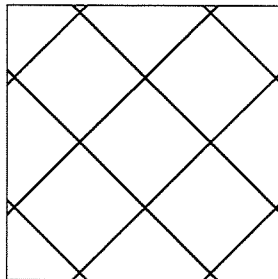

Standard square

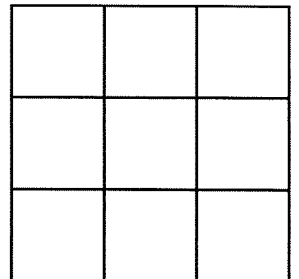

Project: DV2

Purchaser: Portobello Partnership

Plan #: 4M-1290

Purchaser: _____

Lot: V56

Date: October 25, 2021

Model: 5207

Upgrade #: 7, 14, 15, 16, 17, 18

****DIMENSIONS MAY VARY DEPENDING ON SITE MEASURES/CONDITIONS****

Kitchen Sketch

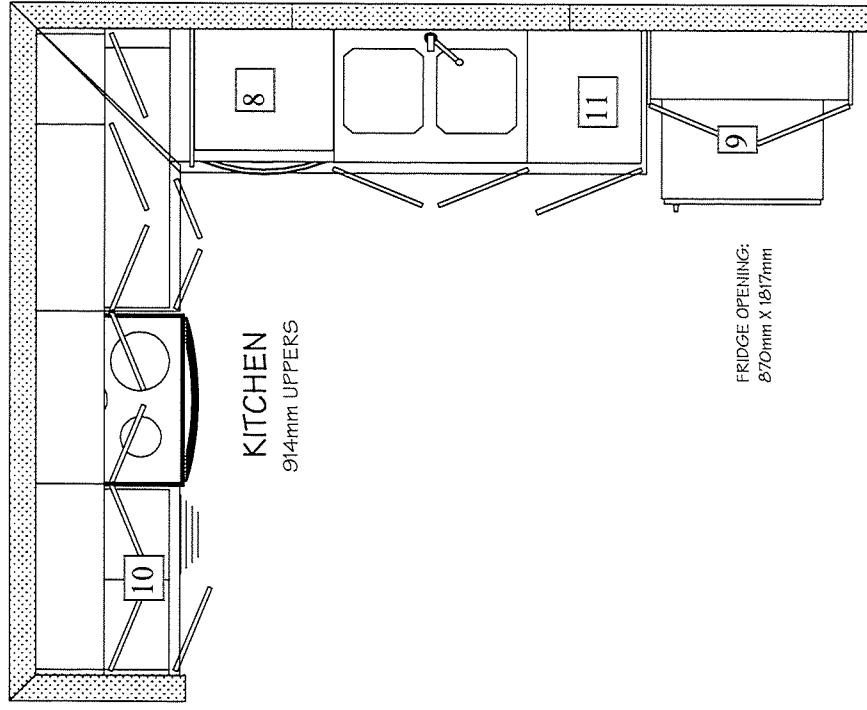
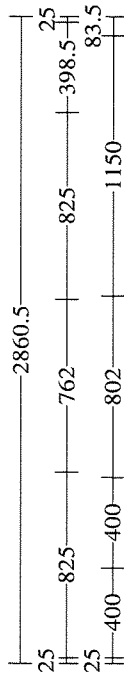

FRIDGE OPENING:
870mm X 1817mm

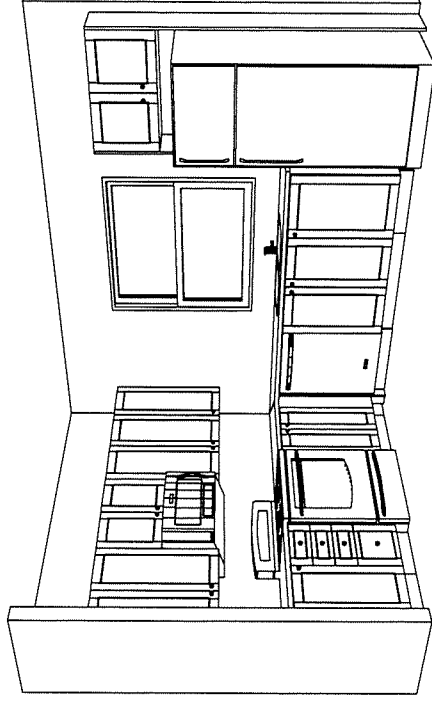
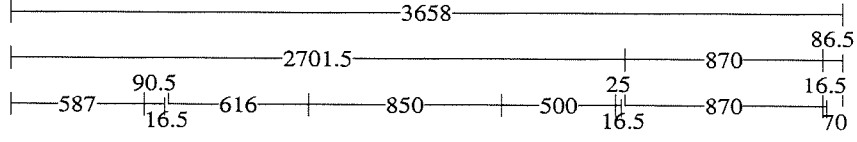

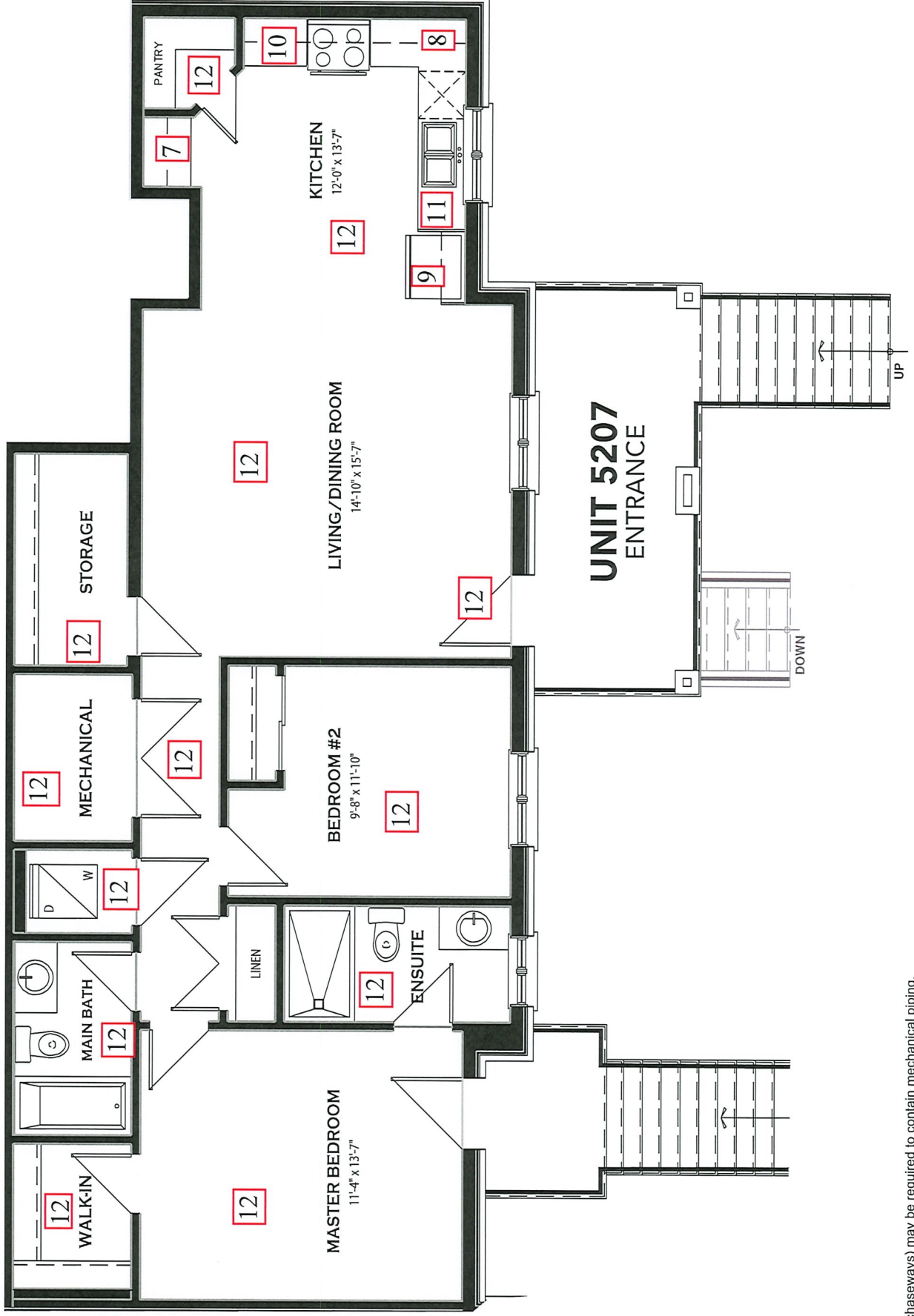



Vertical and/or horizontal bulkheads (chaseways) may be required to contain mechanical piping. All dimensions are approximate. E. & O.E., plans, materials and specifications are subject to change without notice. Actual useable floor space may vary from the stated floor area. *Note: Number of steps varies due to site grading.

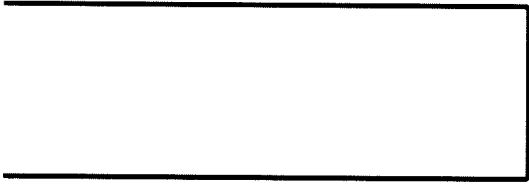
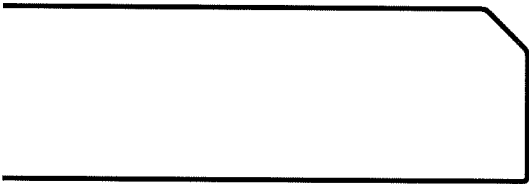
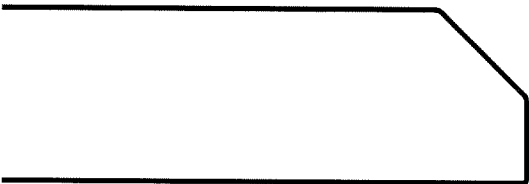
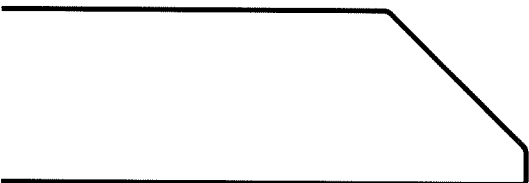
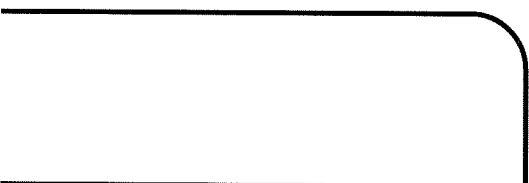

Standard Edge Profiles for Granite & Quartz

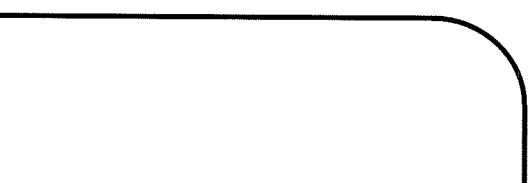
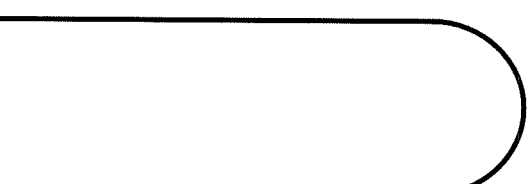
| | | |
|---|---------------------------------------|------------|
|  | Eased Edge | #8 Kitchen |
|  | 1/4 Bevel | |
|  | 1/2 Bevel | |
|  | 3/4 Bevel | |
|  | Pencil Top Only with Square Bottom | |
|  | Pencil Top and Bottom | |
|  | 1/2 Bullnose | |
|  | Full Bullnose | |

Project: DV2

Purchaser: Portobello Partnership

Plan #: 4M-1290

Purchaser: _____

Lot: V56

Date: October 25, 2021

Model: 5207

Upgrade #: 8



Valecraft
Homes Ltd.

CONDOMINIUM HOME COLOUR CHART

| | | | | | |
|---------------|------------------------|----------------|-------------------------------|---------------|---------------|
| Community: | Deerfield Village II | Reg'd Plan #: | 4M-1290 | Sales Rep: | Nicole Trudel |
| Lot No: | V56 | Civic Address: | 615-L Tranquil Stream Private | | |
| Purchaser(s): | Portobello Partnership | | | Model Name/#: | 5207 |
| Purchaser(s): | | | | Closing Date: | July 21-2022 |

CABINETRY

| ROOM | SELECTION | | | | LEVEL | STD/UPG # |
|------------------|------------------|---------------------------------------|-------------------------|------------|-------------------|-----------------|
| KITCHEN | STYLE AND COLOUR | B10R 2164 | | | STD | 5, 7, 9, 10, 11 |
| | HARDWARE CODE | 81091-142 | TYPE | Knobs | STD | 7, 10 |
| | COUNTERTOP | New Caledonia (Slab Viewing Required) | COUNTERTOP EDGE PROFILE | Eased Edge | Granite Level 1 | 7, 8 |
| MAIN BATHROOM | STYLE AND COLOUR | B10R 2164 | | | STD | STD |
| | HARDWARE CODE | 81091-142 | TYPE | Knobs | STD | STD |
| | COUNTERTOP | P394-VL | COUNTERTOP EDGE PROFILE | Standard | Standard Laminate | STD |
| ENSUITE BATHROOM | STYLE AND COLOUR | B10R 2164 | | | STD | STD |
| | HARDWARE CODE | 81091-142 | TYPE | Knobs | STD | STD |
| | COUNTERTOP | P394-VL | COUNTERTOP EDGE PROFILE | Standard | Standard Laminate | STD |
| POWDER ROOM | STYLE AND COLOUR | N/A | | | N/A | N/A |
| | HARDWARE CODE | N/A | TYPE | N/A | N/A | N/A |
| | COUNTERTOP | N/A | COUNTERTOP EDGE PROFILE | N/A | N/A | N/A |

APPLIANCES

| TYPE | SIZE | STD/UPG # | APPLIANCE UPG LEVEL | STD/UPG # |
|---|------------------|-----------|---|-----------|
| FRIDGE <i>(Standard Minimum Opening is 33" x 70.75")</i> | Standard Opening | STD | Basic Stainless Steel | 2 |
| RANGE | Standard Opening | STD | Basic Stainless Steel | 2 |
| DISHWASHER | Standard Opening | STD | Basic Stainless Steel | 2 |
| MICROWAVE / HOODFAN | Standard Opening | STD | OTR - Basic Stainless Steel | 2 |
| WASHING MACHINE/DRYER | Standard Opening | STD | Basic White Stackable Washer/ Dryer with Stacking Kit | 2 |

Purchaser's Signature(s) : _____

Date: _____

Purchaser's Signature(s) : _____

Date: _____

Approved By : T. Oliver

Date: October 25, 2021



Valecraft
Homes Ltd.

CONDOMINIUM HOME COLOUR CHART

| | | | | | |
|---------------|------------------------|----------------|-------------------------------|---------------|---------------|
| Community: | Deerfield Village II | Reg'd Plan #: | 4M-1290 | Sales Rep: | Nicole Trudel |
| Lot No: | V56 | Civic Address: | 615-L Tranquil Stream Private | | |
| Purchaser(s): | Portobello Partnership | | | Model Name/#: | 5207 |
| Purchaser(s): | | | | Closing Date: | July 21-2022 |

CERAMIC / VINYL TILE & GROUT SELECTIONS

| ROOM | AREA | MANUFACTURER/SERIES/ SIZE/COLOUR/CODE | GROUT SELECTION | LEVEL | STD/UPG # |
|------------------|------------------|--|--------------------|--|------------|
| ENTRY - FOYER | FLOOR | See Vinyl EverWood Flooring Selection | N/A | N/A | 12 |
| STORAGE | FLOOR | See Vinyl EverWood Flooring Selection | N/A | N/A | 12 |
| | WALL | N/A | N/A | N/A | N/A |
| | INSERT OR BORDER | N/A | | | |
| MECHANICAL ROOM | FLOOR | See Vinyl EverWood Flooring Selection | N/A | N/A | 12 |
| LAUNDRY CLOSET | FLOOR | See Vinyl EverWood Flooring Selection | N/A | N/A | 12 |
| | WALL | N/A | N/A | N/A | N/A |
| | INSERT OR BORDER | N/A | | | |
| KITCHEN | FLOOR | See Vinyl EverWood Flooring Selection | N/A | N/A | 12 |
| | BACKSPLASH | Euro Pasha Soho 3"x6" Matte White (Horizontal Brick Install) | 931 Standard White | Bronze Wall Tile + UPG install + STD Grout | 7, 14, 15 |
| | INSERT OR BORDER | N/A | | | |
| DINETTE | FLOOR | N/A | N/A | N/A | N/A |
| MAIN BATHROOM | FLOOR | See Vinyl EverWood Flooring Selection | N/A | N/A | 12 |
| | WALL | Euro Pasha Classic 6"x12" Calacatta Glossy (Horizontal brick Install) | 909 Sterling | Silver Wall Tile + UPG Install + UPG Grout | 13, 17, 18 |
| | INSERT OR BORDER | N/A | | | |
| ENSUITE BATHROOM | FLOOR | See Vinyl EverWood Flooring Selection | N/A | N/A | 12 |
| | WALL | Ceratec Stone Glamour 11.6"x23.6" Calacatta Matt (Horizontal Stacked Install) | 909 Sterling | Silver Floor Tile on wall + UPG Grout | 13, 16 |
| | INSERT OR BORDER | N/A | | | |

Purchaser's Signature(s) : _____

Date: _____

Purchaser's Signature(s) : _____

Date: _____

Approved By : T. Oliver

Date: October 25, 2021



Valecraft
Homes Ltd.

CONDOMINIUM HOME COLOUR CHART

| | | | | | |
|---------------|------------------------|----------------|-------------------------------|---------------|---------------|
| Community: | Deerfield Village II | Reg'd Plan #: | 4M-1290 | Sales Rep: | Nicole Trudel |
| Lot No: | V56 | Civic Address: | 615-L Tranquil Stream Private | | |
| Purchaser(s): | Portobello Partnership | | | Model Name/#: | 5207 |
| Purchaser(s): | | | | Closing Date: | July 21-2022 |

FLOORING SELECTIONS

| ROOM | CARPET/UNDERPAD / HARDWOOD / VINYL EVERWOOD | LEVEL | STD/UPG # |
|--------------------------|---|-------|-----------|
| MAIN FLOOR ENTRY - FOYER | Torlys Everwood Premier EW23001 Beach House 4-7/8" Wide x 48-3/8" Long Plank (Side to Side Install) | Quote | 12 |
| KITCHEN | Torlys Everwood Premier EW23001 Beach House 4-7/8" Wide x 48-3/8" Long Plank (Side to Side Install) | Quote | 12 |
| MECHANICAL ROOM | Torlys Everwood Premier EW23001 Beach House 4-7/8" Wide x 48-3/8" Long Plank (Side to Side Install) | Quote | 12 |
| STORAGE | Torlys Everwood Premier EW23001 Beach House 4-7/8" Wide x 48-3/8" Long Plank (Side to Side Install) | Quote | 12 |
| LIVING ROOM/ DINING ROOM | Torlys Everwood Premier EW23001 Beach House 4-7/8" Wide x 48-3/8" Long Plank (Side to Side Install) | Quote | 12 |
| MAIN BATHROOM FLOOR | Torlys Everwood Premier EW23001 Beach House 4-7/8" Wide x 48-3/8" Long Plank (Side to Side Install) | Quote | 12 |
| ENSUITE BATHROOM FLOOR | Torlys Everwood Premier EW23001 Beach House 4-7/8" Wide x 48-3/8" Long Plank (Side to Side Install) | Quote | 12 |
| LAUNDRY CLOSET | Torlys Everwood Premier EW23001 Beach House 4-7/8" Wide x 48-3/8" Long Plank (Side to Side Install) | Quote | 12 |
| BEDROOM HALLWAY | Torlys Everwood Premier EW23001 Beach House 4-7/8" Wide x 48-3/8" Long Plank (Side to Side Install) | Quote | 12 |
| MASTER BEDROOM & WIC | Torlys Everwood Premier EW23001 Beach House 4-7/8" Wide x 48-3/8" Long Plank (Side to Side Install) | Quote | 12 |
| BEDROOM # 2 | Torlys Everwood Premier EW23001 Beach House 4-7/8" Wide x 48-3/8" Long Plank (Side to Side Install) | Quote | 12 |
| STAIRS FROM FOYER | N/A | N/A | N/A |

Purchaser's Signature(s) : _____ Date: _____

Purchaser's Signature(s) : _____ Date: _____

Approved By : T. Oliver Date: October 25, 2021



Valecraft
Homes Ltd.

CONDOMINIUM HOME COLOUR CHART

| | | | | | |
|---------------|------------------------|----------------|-------------------------------|---------------|---------------|
| Community: | Deerfield Village II | Reg'd Plan #: | 4M-1290 | Sales Rep: | Nicole Trudel |
| Lot No: | V56 | Civic Address: | 615-L Tranquil Stream Private | | |
| Purchaser(s): | Portobello Partnership | | | Model Name/#: | 5207 |
| Purchaser(s): | | | | Closing Date: | July 21-2022 |

PLUMBING FIXTURES

| ROOM | FIXTURE | STYLE | FINISH | STD/UPG# |
|------------------|-------------------|--|--|----------|
| KITCHEN | SINK | Reginox Kitchen Sink Undermount Double Bowl ND1831UA/9 | Stainless Steel | 19 |
| | FAUCET | Delta Kitchen Faucet Single Handle Pull-Down Marley 986LF-AR | Arctic Stainless | 20 |
| ENSUITE BATHROOM | SINK | Standard | White | STD |
| | VANITY FAUCET | Standard | Chrome | STD |
| | WATER CLOSET | Standard | White | STD |
| | SHOWER | Standard with Zitta Niche 12 x 12 (Installed on short wall opposing shower head, approx. centered and the top of niche approx. 5ft from shower base) | White/Chrome/ Clear Glass/ Stainless Steel | 6 |
| | SHOWER FAUCET | Standard | Chrome | STD |
| MAIN BATHROOM | SINK | Standard | White | STD |
| | VANITY FAUCET | Standard | Chrome | STD |
| | WATER CLOSET | Standard | White | STD |
| | TUB/SHOWER | Standard | White | STD |
| | TUB/SHOWER FAUCET | Standard | Chrome | STD |
| POWDER ROOM | PEDESTAL | N/A | N/A | N/A |
| | SINK FAUCET | N/A | N/A | N/A |
| | WATER CLOSET | N/A | N/A | N/A |

NOTE: All fixtures are white as standard

Purchaser's Signature(s) : _____

Date: _____

Purchaser's Signature(s) : _____

Date: _____

Approved By : T. Oliver

Date: October 25, 2021