

**Internal B1A
Deerfield 2 - Phase Condo**

PURCHASER: Portobello Partnership

Printed: 25-Oct-21 2:51 pm

LOT NUMBER V57 Level: 3	PHASE Condo	HOUSE TYPE 5311	CLOSING DATE 26-Jul-22
-----------------------------------	-----------------------	---------------------------	----------------------------------

ITEM	QTY	EXTRA / CHANGE	PRICE	INTERNAL USE
------	-----	----------------	-------	--------------

*9 118442	1	<i>KITCHEN</i> - COUNTERTOP - GRANITE - LEVEL 1 - KITCHEN C/W FLUSH BREAKFAST BAR	*\$ 5,689.00	Each
37191		Note: Countertop edge to be eased edge, as per countertop edge profile sketch and Schedule H dated October 25, 2021. See items #5 (Kitchen Design) #21 (Kitchen sink) & #22 (Kitchen faucet).		
10 90835	1	<i>KITCHEN</i> - CABINETS - EXTEND FRIDGE UPPER TO APPROX. 2FT DEEP (ALL SERIES)	\$ 187.00	Each
37483		Note: In standard series cabinetry, as per Schedule H dated October 25, 2021.		
11 87999	1	<i>KITCHEN</i> - LOWER CABINETS - LC POTS & PANS C/W 3 DRAWER FRONTS 6/12/12	\$ 704.00	Each
37484		Note: In standard series cabinetry. To be located in between wall and range, as per Schedule H dated October 25, 2021. Standard cabinetry hardware.		
12 37488	1	- DELETE ALL BUILDER'S STANDARD FLOORING IN ALL ROOMS (CERAMIC FLOORS, HARDWOOD FLOORING, CARPET AND UNDERPAD) AND SUPPLY AND INSTALL TORLYS FLOORING.	\$ 4,359.00	Each
		Note: To be installed (side to side) in Kitchen, Dinette, Living Room, Storage Room, Mechanical Room, Laundry closet, Bedroom Hallway, Master Bedroom & WIC, Bedroom #2, Ensuite Bathroom and Main Bathroom. To be installed (1/2 brick front to back) in Entry/Foyer, as per floor tile installation sketch and as per Schedule H dated October 25, 2021. Includes stain on the railing system.		
13 37491	1	- UPGRADE STANDARD CARPET TO BEAULIEU SILEX II ON STAIRS TO ENTRY.	\$ 308.00	Each
		Note: As per Schedule H dated October 25, 2021.		
*14 107	*1	- UNDERPAD - UPGRADE - LEVEL 1 - - STAIRCASE - LEVEL 1	*\$ 160.00	Each
37492		Note: As per Schedule H dated October 25, 2021.		
15 127	1	<i>KITCHEN</i> - TILE - WALL - BACKSPLASH - UPGRADE - BRONZE - - KITCHEN - BRONZE	\$ 135.00	Each
37493		Note: As per wall tile installation sketch dated October 25, 2021. See item #5 (Kitchen Design) and #16 for pattern installation.		
16 124	1	<i>KITCHEN</i> - TILE - WALL - BACKSPLASH - INSTALLED IN A BRICK PATTERN - INSTALLATION ONLY - - KITCHEN - .	\$ 55.00	Each
37494		Note: As per wall tile installation sketch dated October 25, 2021. See items #5 (Kitchen Design) and #15 (Kitchen backsplash).		
17 122	1	<i>MAIN BATHROOM</i> - TILE - WALL - UPGRADE - SILVER - - MAIN BATHROOM - SILVER	\$ 625.00	Each
37495		Note: To be installed in Main Bathroom tub/shower combo, as per wall tile installation sketch dated October 25, 2021. See item #18 for pattern installation.		
18 116	1	<i>MAIN BATHROOM</i> - TILE - WALL - INSTALLED IN A BRICK PATTERN - INSTALLATION ONLY - - MAIN BATHROOM - .	\$ 268.00	Each
37496		Note: As per wall tile installation sketch dated October 25, 2021. See item #17 for upgraded tile.		
19 140	1	<i>ENSUITE BATH</i> - TILE - WALL - UPGRADE - FLOOR TILE IN LIEU OF WALL - SILVER - - ENSUITE BATHROOM - SILVER	\$ 1,129.00	Each
37497		Note: To be installed in Ensuite Bathroom shower walls, as per wall tile installation sketch dated October 25, 2021.		

Vendor Initials: _____ Purchaser Initials: _____

CONSTRUCTION SCHEDULING APPROVAL	
PER:	_____
DATE:	_____

PREPARED BY: Nicole Trudel

LOCKED BY: Tricia Oliver

PE 1.736-1

**Internal B1A
Deerfield 2 - Phase Condo**

PURCHASER: Portobello Partnership

Printed: 25-Oct-21 2:51 pm

LOT NUMBER V57 Level: 3	PHASE Condo	HOUSE TYPE 5311	CLOSING DATE 26-Jul-22
-----------------------------------	-----------------------	---------------------------	----------------------------------

ITEM	QTY	EXTRA / CHANGE	PRICE	INTERNAL USE
20 88508 37498	1	- CERAMIC TILE - GROUT COLOR PER COLOUR Note:	\$ 75.00	Each
21 88544 37499	1	- <i>KITCHEN</i> - KITCHEN SINK - REGINOX ND1831UA/9 DOUBLE BOWL UNDERMOUNT SINK Note: See item #9 for solid surface countertops. See item #22 for kitchen faucet.	\$ 143.00	Each
22 88428 37500	1	- <i>KITCHEN</i> - KITCHEN FAUCET - DELTA MARLEY 986LF - AR ARCTIC STAINLESS Note: See item #9 for solid surface countertops. See item #21 for kitchen sink.	\$ 358.00	Each
23 37501	1	- - SUPPLY AND INSTALL STAINED RED OAK 3-1/2" WIDE MODERN BEVELLED POSTS, CONTEMPORARY RAILINGS & SQUARE METAL GUNN METAL GREY SPINDLES, C/W METAL BRACKETS, IN ALL STANDARD AREAS. Note: As per Schedule H dated October 25, 2021.	\$ 2,776.00	Each

Sub Total	\$16,971.00
HST	\$0.00
Total	\$16,971.00

Payment Summary	
<u>Paid By</u>	<u>Amount</u>
APS	\$16,971.00
Total Payment:	\$16,971.00

PURCHASER: _____
Portobello Partnership

25-Oct-21
DATE

VENDOR: _____
PER: Valecraft Homes Limited

DATE: _____

PREPARED BY: Nicole Trudel

LOCKED BY: Tricia Oliver

PE 1,736-2

voiceSQL.rpt 01sept21

CONSTRUCTION SCHEDULING APPROVAL	
PER:	_____
DATE:	_____

Schedule "W4" Granite & Variegated Quartz Colour Variation

Purchaser's name: Portobello Partnership Lot no: V57
Purchaser's name: Contact: Samar Merhi Project: DEERFIELD VILLAGE 2
Home Phone: _____ Model: 5311
Work Phone: 613-837-2754 Closing Date: July 26th, 2022
E-Mail (1): design@valecraft.com E-Mail (2): _____

Valecraft Homes Ltd. continues to provide the best in class sales and service. We recognize the importance of your home to you, our valued customer.

Granite & Variegated Quartz countertops are an elegant addition to your home. However, there are some things of which you should be aware.

Due to the natural composition of **Granite**, inherent variations in texture, colour and consistency are to be expected and considered as normal.

During the process of manufacturing **Variegated Quartz** to achieve a more natural stone look, variations in the appearance between the sample & the slab are to be expected.

Valecraft Homes Limited strongly suggests that you attend an appointment with our granite/quartz supplier two to three months prior to closing to view the granite/variegated quartz slabs available in the colour you have already chosen. A representative from our supplier will contact you to set up a mutual date & time for the appointment.

I/we, Portobello Partnership

have read and fully understand the aforementioned recommendation set forth by the builder and as such hereby release VALECRAFT HOMES LIMITED from future responsibility with respect to a variation in colour of granite countertops.

We accept this opportunity

We decline this opportunity

Project: DEERFIELD VILLAGE 2 **LOT NO:** V57

Purchaser **Date:** _____

Purchaser **Date:** _____

T. Oliver October 25, 2021
Valecraft Homes Limited **Date:** _____

Appointment date given: _____ Spoke with/left message: _____

Time scheduled: _____ Date & Time: _____



MODEL 5311
BLOCKS T - U - V
 1253 SQ.FT

THIRD FLOOR

Site: DV2

Plan No.: 4M-1290

Unit: V57

Date: October 25, 2021

Purchaser: Portobello Partnership

Purchaser:

Schedule H

UNIT 5312
ENTRANCE

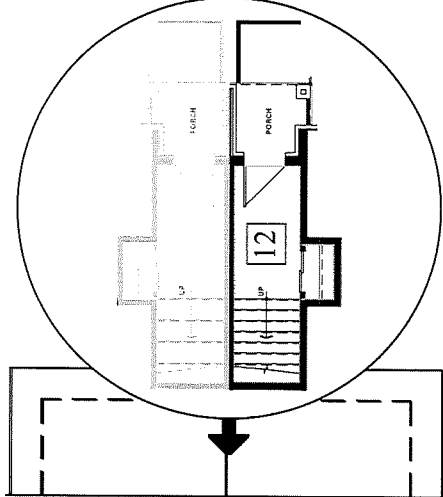

UNIT 5311
ENTRANCE

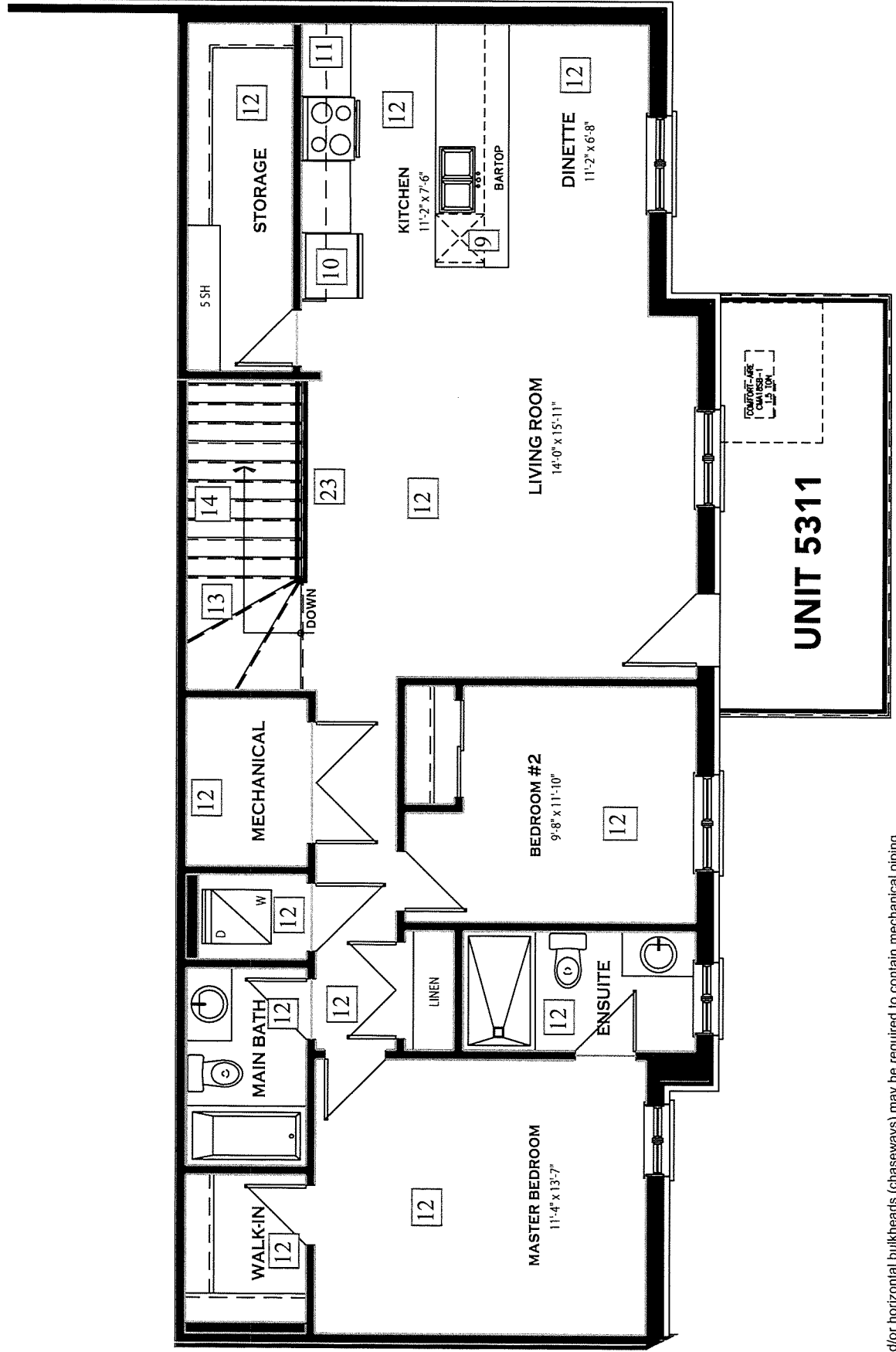

Vertical and/or horizontal bulkheads (chaseways) may be required to contain mechanical piping.

All dimensions are approximate. E. & O.E., plans, materials and specifications are subject to change without notice. Actual useable floor space may vary from the stated floor area. *Note: Number of steps varies due to site grading.



Standard Edge Profiles for Granite & Quartz

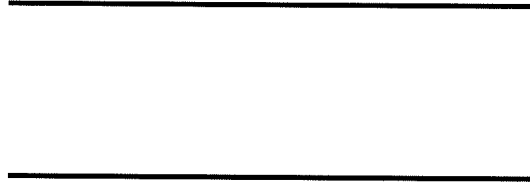

Eased Edge

#9 Kitchen

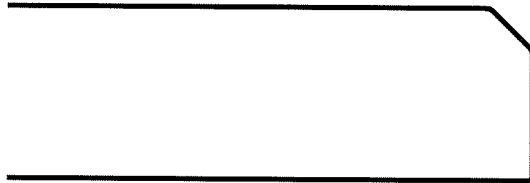

1/4 Bevel

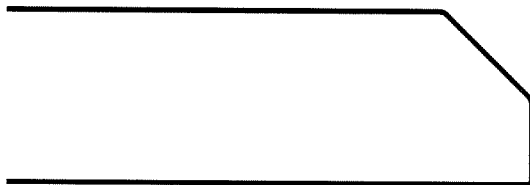

1/2 Bevel

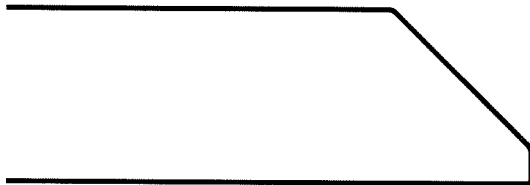

3/4 Bevel

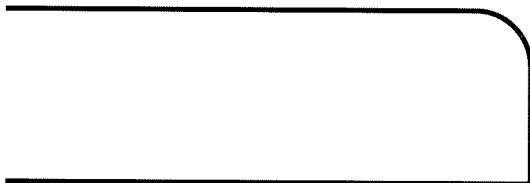

Pencil Top Only
with Square Bottom

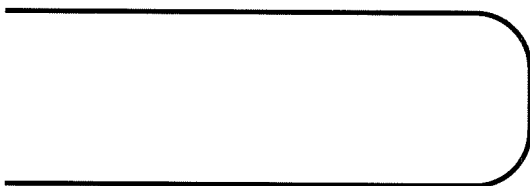

Pencil Top and Bottom

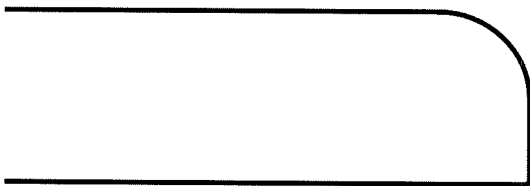

1/2 Bullnose

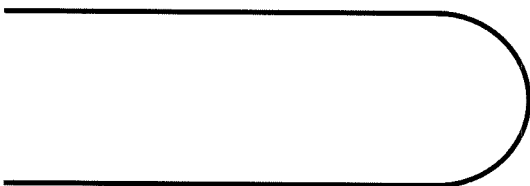

Full Bullnose

Project: DV2

Purchaser: Portobello Partnership

Plan #: 4M-1290

Purchaser: _____

Lot: V57

Date: October 25, 2021

Model: 5311

Upgrade #: 5, 9



Tile Installation Options

WALL TILE

Vertical stacked

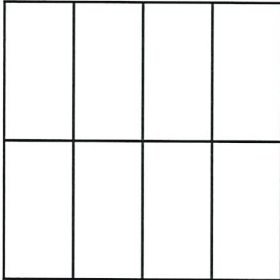

Horizontal stacked

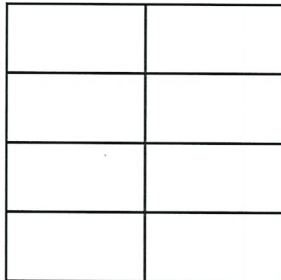

Ensuite Bathroom

Vertical 1/3 staggered

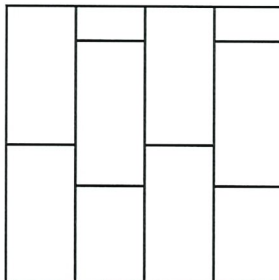

Horizontal 1/3 staggered

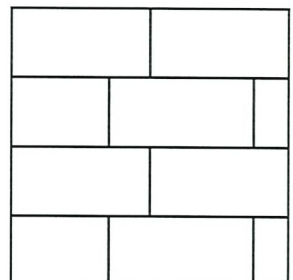

Vertical brick

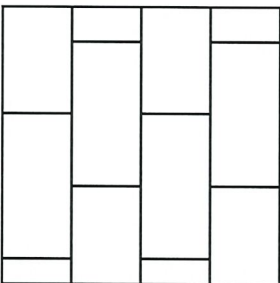

Horizontal brick

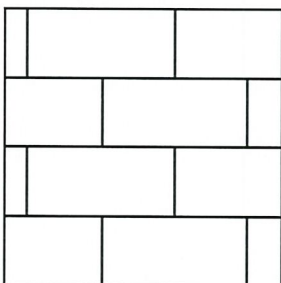

Kitchen Backsplash
Main Bathroom

45 degree

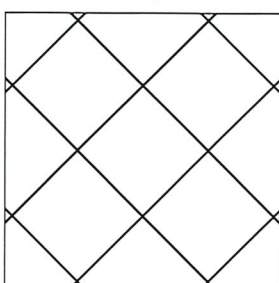

Standard square

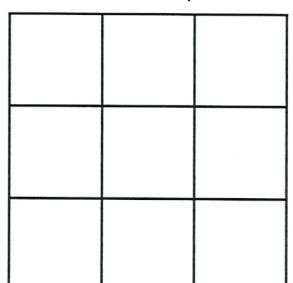

Project: DV2

Purchaser: Portobello Partnership

Plan #: 4M-1290

Purchaser: _____

Lot: V57

Date: October 25, 2021

Model: 5311

Upgrade #: 5, 15, 16, 17, 18, 19



Tile Installation Options

FLOOR TILE

Standard square

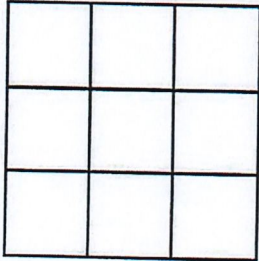

Square brick

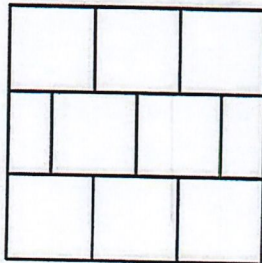

Rectangular
front to back of the house

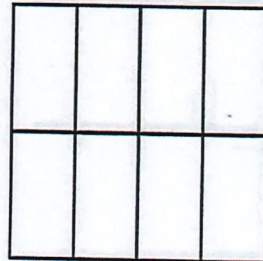

Rectangular
side to side of the house

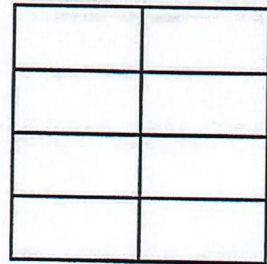

1/2 brick front to back
of the house

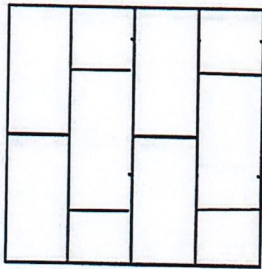

Entry/ Foyer

1/2 brick side to side of
house



45 degree

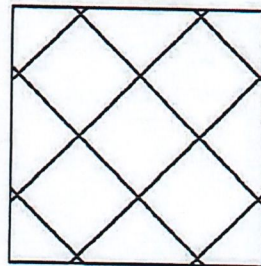

Project: DV2

Plan #: 4M-1290

Lot: V57

Model: 5311

Purchaser: Portobello Partnership

Purchaser: _____

Date: October 25, 2021

Upgrade #: 12



CONDOMINIUM HOME COLOUR CHART

Community:	Deerfield Village II	Reg'd Plan #:	4M-1290	Sales Rep:	Nicole Trudel
Lot No:	V57	Civic Address:	615-A Tranquil Stream Private		
Purchaser(s):	Portobello Partnership			Model Name/#:	5311
Purchaser(s):				Closing Date:	July 26-2022

CABINETRY

ROOM	SELECTION			LEVEL	STD/UPG #	
KITCHEN	STYLE AND COLOUR	B10R 2164			STD	5, 7, 10, 11
	HARDWARE CODE	81091-142	TYPE	Knobs	STD	5, 11
	COUNTERTOP	New Caledonia (Slab Viewing Required)	COUNTERTOP EDGE PROFILE	Eased Edge	Granite Level 1	5, 12
MAIN BATHROOM	STYLE AND COLOUR	B10R 2164			STD	STD
	HARDWARE CODE	81091-142	TYPE	Knobs	STD	STD
	COUNTERTOP	P394-VL	COUNTERTOP EDGE PROFILE	Standard	Standard Laminate	STD
ENSUITE BATHROOM	STYLE AND COLOUR	B10R 2164			STD	STD
	HARDWARE CODE	81091-142	TYPE	Knobs	STD	STD
	COUNTERTOP	P394-VL	COUNTERTOP EDGE PROFILE	Standard	Standard Laminate	STD
POWDER ROOM	STYLE AND COLOUR	N/A			N/A	N/A
	HARDWARE CODE	N/A	TYPE	N/A	N/A	N/A
	COUNTERTOP	N/A	COUNTERTOP EDGE PROFILE	N/A	N/A	N/A

APPLIANCES

TYPE	SIZE	STD/UPG #	APPLIANCE UPG LEVEL	STD/UPG #
FRIDGE <i>(Standard Minimum Opening is 33" x 70.75")</i>	Standard Opening	STD	Basic Stainless	2
RANGE	Standard Opening	STD	Basic Stainless	2
DISHWASHER	Standard Opening	STD	Basic Stainless	2
MICROWAVE / HOODFAN	Standard Opening	STD	OTR - Basic Stainless	2
WASHING MACHINE/DRYER	Standard Opening	STD	Basic White Stackable with Stacking Kit	2

Purchaser's Signature(s) : _____

Date: _____

Purchaser's Signature(s) : _____

Date: _____

Approved By : _____
T. Oliver

Date: October 25, 2021



Valecraft
Homes Ltd.

CONDOMINIUM HOME COLOUR CHART

Community:	Deerfield Village II	Reg'd Plan #:	4M-1290	Sales Rep:	Nicole Trudel
Lot No:	V57	Civic Address:	615-A Tranquil Stream Private		
Purchaser(s):	Portobello Partnership			Model Name/#:	5311
Purchaser(s):				Closing Date:	July 26-2022

FLOORING SELECTIONS

ROOM	CARPET/UNDERPAD / HARDWOOD / VINYL EVERWOOD	LEVEL	STD/UPG #
MAIN FLOOR HALLWAY	N/A	N/A	N/A
KITCHEN /DINETTE	Torlys Everwood Premier EW23001 Beach House 4-7/8" Wide x 48-3/8" Long Plank (Side to Side Install)	Quote	5, 12
MECHANICAL ROOM	Torlys Everwood Premier EW23001 Beach House 4-7/8" Wide x 48-3/8" Long Plank (Side to Side Install)	Quote	12
STORAGE	Torlys Everwood Premier EW23001 Beach House 4-7/8" Wide x 48-3/8" Long Plank (Side to Side Install)	Quote	6, 12
LIVING ROOM	Torlys Everwood Premier EW23001 Beach House 4-7/8" Wide x 48-3/8" Long Plank (Side to Side Install)	Quote	12
MAIN BATHROOM FLOOR	Torlys Everwood Premier EW23001 Beach House 4-7/8" Wide x 48-3/8" Long Plank (Side to Side Install)	Quote	12
ENSUITE BATHROOM FLOOR	Torlys Everwood Premier EW23001 Beach House 4-7/8" Wide x 48-3/8" Long Plank (Side to Side Install)	Quote	12
LAUNDRY CLOSET	Torlys Everwood Premier EW23001 Beach House 4-7/8" Wide x 48-3/8" Long Plank (Side to Side Install)	Quote	12
BEDROOM HALLWAY	Torlys Everwood Premier EW23001 Beach House 4-7/8" Wide x 48-3/8" Long Plank (Side to Side Install)	Quote	12
MASTER BEDROOM & WIC	Torlys Everwood Premier EW23001 Beach House 4-7/8" Wide x 48-3/8" Long Plank (Side to Side Install)	Quote	12
BEDROOM # 2	Torlys Everwood Premier EW23001 Beach House 4-7/8" Wide x 48-3/8" Long Plank (Side to Side Install)	Quote	12
STAIRS FROM FOYER	Beaulieu Silex II Broadloom Carpet Pampa Beige 16320 + Upgraded Underpad	Quote Carpet + L1 Underpad	13, 14

Purchaser's Signature(s) : _____

Date: _____

Purchaser's Signature(s) : _____

Date: _____

Approved By : T. Oliver

Date: October 25, 2021



CONDOMINIUM HOME COLOUR CHART

Community:	Deerfield Village II	Reg'd Plan #:	4M-1290	Sales Rep:	Nicole Trudel
Lot No:	V57	Civic Address:	615-A Tranquil Stream Private		
Purchaser(s):	Portobello Partnership			Model Name/#:	5311
Purchaser(s):				Closing Date:	July 26-2022

PLUMBING FIXTURES

ROOM	FIXTURE	STYLE	FINISH	STD/UPG#
KITCHEN	SINK	Reginox Kitchen Sink Undermount Double Bowl ND1831UA/9	Stainless Steel	21
	FAUCET	Delta Kitchen Faucet Single Handle Pull-Down Marley 986LF-AR	Arctic Stainless	22
ENSUITE BATHROOM	SINK	Standard	White	STD
	VANITY FAUCET	Standard	Chrome	STD
	WATER CLOSET	Standard	White	STD
	SHOWER	Standard with Zitta Niche 12 x 12 (Installed on short wall opposing shower head, approx. centered and the top of niche approx. 5ft from shower base)	White/Chrome/ Clear Glass/ Stainless Steel	8
	SHOWER FAUCET	Standard	Chrome	STD
MAIN BATHROOM	SINK	Standard	White	STD
	VANITY FAUCET	Standard	Chrome	STD
	WATER CLOSET	Standard	White	STD
	TUB/SHOWER	Standard	White	STD
	TUB/SHOWER FAUCET	Standard	Chrome	STD

NOTE: All fixtures are white as standard

INTERIOR HANDRAILS AND SPINDLES

	WOOD	STYLE	STAIN/COLOUR	STD/UPG #
HANDRAIL	Red Oak	Contemporary	SB 200	12, 23
BRACKET (if applicable)	Metal	Metal	Gunn Metal Grey	23
SPINDLES	Metal	Square Metal	Gunn Metal Grey	23
POSTS	Red Oak	3-1/2" wide Modern Beveled	SB 200	12, 23
NOSINGS	Red Oak	N/A	SB 200	12
HARDWOOD STAIRCASE <i>(WHERE APPLICABLE)</i>	N/A	N/A	N/A	N/A

Purchaser's Signature(s) : _____

Date: _____

Purchaser's Signature(s) : _____

Date: _____

Approved By : _____ **T. Oliver**

Date: **October 25, 2021**