

Internal B1A				
Deerfield 2 - Phase Condo				
PURCHASER: Portobello Partnership		Printed: 26-Oct-21 12:36 pm		
LOT NUMBER V59 Level: 2	PHASE Condo	HOUSE TYPE 5208	CLOSING DATE 2-Aug-22	
ITEM	QTY	EXTRA / CHANGE	PRICE	INTERNAL USE
7 120204	3	KITCHEN - ADD UPPER AND LOWER CABINETRY INCLUDING BACKSPLASH - PER LINEAR FOOT - BUILDER'S STANDARDS	\$ 1,968.00	
37202	Note:	Between corner pantry and wall. As per Schedule H dated October 27, 2021		
*8 119665	1	KITCHEN - COUNTERTOP - GRANITE - LEVEL 1 - KITCHEN	*\$ 5,271.00	Each
37203	Note:	Countertop edge to be eased edge as per countertop edge profile sketch and Schedule H dated October 27, 2021. See items #22 (Kitchen sink) & #21(Kitchen faucet). See item #7 for extended upper and lower cabinets.		
9 90835	1	KITCHEN - CABINETRY - EXTEND FRIDGE UPPER TO APPROX. 2FT DEEP (ALL SERIES)	\$ 187.00	Each
37563	Note:	In standard series cabinetry, as per Schedule H dated October 27, 2021		
10 87999	1	KITCHEN - LOWER CABINETS - LC POTS & PANS C/W 3 DRAWER FRONTS 6/12/12	\$ 704.00	Each
37564	Note:	In standard series cabinetry. To be located between range and corner pantry, directly next to range, as per Schedule H dated October 27, 2021		
11	1	KITCHEN - SUPPLY AND INSTALL KITCHEN CABINETRY HARDWARE POI-R7040-128-BSAE. INCLUDING POTS & PANS 3 DRAWERS.	\$ 546.00	Each
37565	Note:	To be installed in Kitchen. See item #10 (pots & pans). See item #7 for added upper & lower cabinets.		
12	1	MAIN BATHROOM - SUPPLY AND INSTALL CABINETRY HARDWARE POI-R7040-128-BSAE.	\$ 42.00	Each
37566	Note:	To be installed in main Bathroom.		
13	1	ENSUITE BATH - SUPPLY AND INSTALL CABINETRY HARDWARE POI-R7040-128-BSAE.	\$ 63.00	Each
37567	Note:	To be installed in Ensuite Bathroom.		
14	1	- DELETE ALL BUILDERS STANDARD FLOORING IN ALL ROOMS (CERAMIC FLOORS, HARDWOOD FLOORS, CARPET AND UNDERPAD) AND SUPPLY AND INSTALL TORLYS FLOORING.	\$ 5,130.00	Each
37568	Note:	To be installed (side to side) in Kitchen, Living Room/Dining Room, Storage Room, Laundry Closet, Mechanical Room, Bedroom Hallway, Master Bedroom and WIC, Bedroom #2, Ensuite Bathroom, Main Bathroom and Entry/Foyer, as per floor tile installation sketch and Schedule H dated October 27, 2021		
15 88508	1	- CERAMIC TILE - GROUT COLOR PER COLOUR	\$ 75.00	Each
37569	Note:			
16 127	1	KITCHEN - TILE - WALL - BACKSPLASH - UPGRADE - BRONZE - - KITCHEN - BRONZE	\$ 183.00	Each
37570	Note:	As per wall tile installation sketch dated October 27, 2021. See item #7 for extended upper & lower cabinets including standard backsplash. See item #17 for installation pattern.		
17 126	1	KITCHEN - TILE - WALL - BACKSPLASH - INSTALLED STAGGERED - INSTALLATION ONLY - - KITCHEN - .	\$ 137.00	Each
37571	Note:	As per wall tile installation sketch dated October 27, 2021. See item #16 for upgraded tile. See item #7 for extended upper & lower cabinets including standard backsplash.		

Vendor Initials: _____ Purchaser Initials: _____

PREPARED BY: Nicole Trudel
LOCKED BY: Lisa Ballard
PE 1,745-1
InvoiceSQL.rpt 05may21

CONSTRUCTION SCHEDULING APPROVAL

PER: _____

DATE: _____

Internal B1A Deerfield 2 - Phase Condo				
PURCHASER: Portobello Partnership			Printed: 26-Oct-21 12:36 pm	
LOT NUMBER V59 Level: 2		PHASE Condo	HOUSE TYPE 5208	CLOSING DATE 2-Aug-22
ITEM	QTY	EXTRA / CHANGE	PRICE	INTERNAL USE
18 140	1	ENSUITE BATH - TILE - WALL - UPGRADE - FLOOR TILE IN LIEU OF WALL - SILVER - - ENSUITE BATHROOM - SILVER	\$ 1,129.00	Each
37573	Note: To be installed in Ensuite Bathroom shower walls, as per wall tile installation sketch dated October 27, 2021			
19 122	1	MAIN BATHROOM - TILE - WALL - UPGRADE - SILVER - - MAIN BATHROOM - SILVER	\$ 625.00	Each
37574	Note: To be installed in Main Bathroom tub/shower combo, as per wall tile installation sketch dated October 27, 2021. See item #20 for installation pattern.			
20 118	1	MAIN BATHROOM - TILE - WALL - INSTALLED STAGGERED - INSTALLATION ONLY - - MAIN BATHROOM - .	\$ 268.00	Each
37575	Note: To be installed in Main Bathroom, as per wall tile installation sketch dated October 27, 2021. See item #19.			
21 88428	1	KITCHEN FAUCET - DELTA MARLEY 986LF - AR ARCTIC STAINLESS	\$ 358.00	Each
37577	Note: See item #8 for solid surface countertops. See item #22 for kitchen sink.			
22 88544	1	KITCHEN SINK - REGINOX ND1831UA/9 DOUBLE BOWL UNDERMOUNT SINK	\$ 143.00	Each
37578	Note: See item #8 for solid surface countertops. See item #21 for kitchen faucet.			

Sub Total	\$16,829.00
HST	\$0.00
Total	\$16,829.00

Payment Summary	
<u>Paid By</u>	<u>Amount</u>
Total Payment: _____	

PURCHASER: _____
Portobello Partnership

26-Oct-21
DATE

VENDOR: _____
PER: Valecraft Homes Limited

DATE: _____

PREPARED BY: Nicole Trudel

LOCKED BY: Lisa Ballard

PE 1,745-2

InvoiceSQL.rpt 05may21

CONSTRUCTION SCHEDULING APPROVAL	
PER:	_____
DATE:	_____



MODEL 5208
BLOCKS T - U - V

1218 SQ.FT

SECOND FLOOR

Site: DV2

Plan No.: 4M-1290

Unit: V59

Date: October 27, 2021

Purchaser: Portobello Partnership

Purchaser:

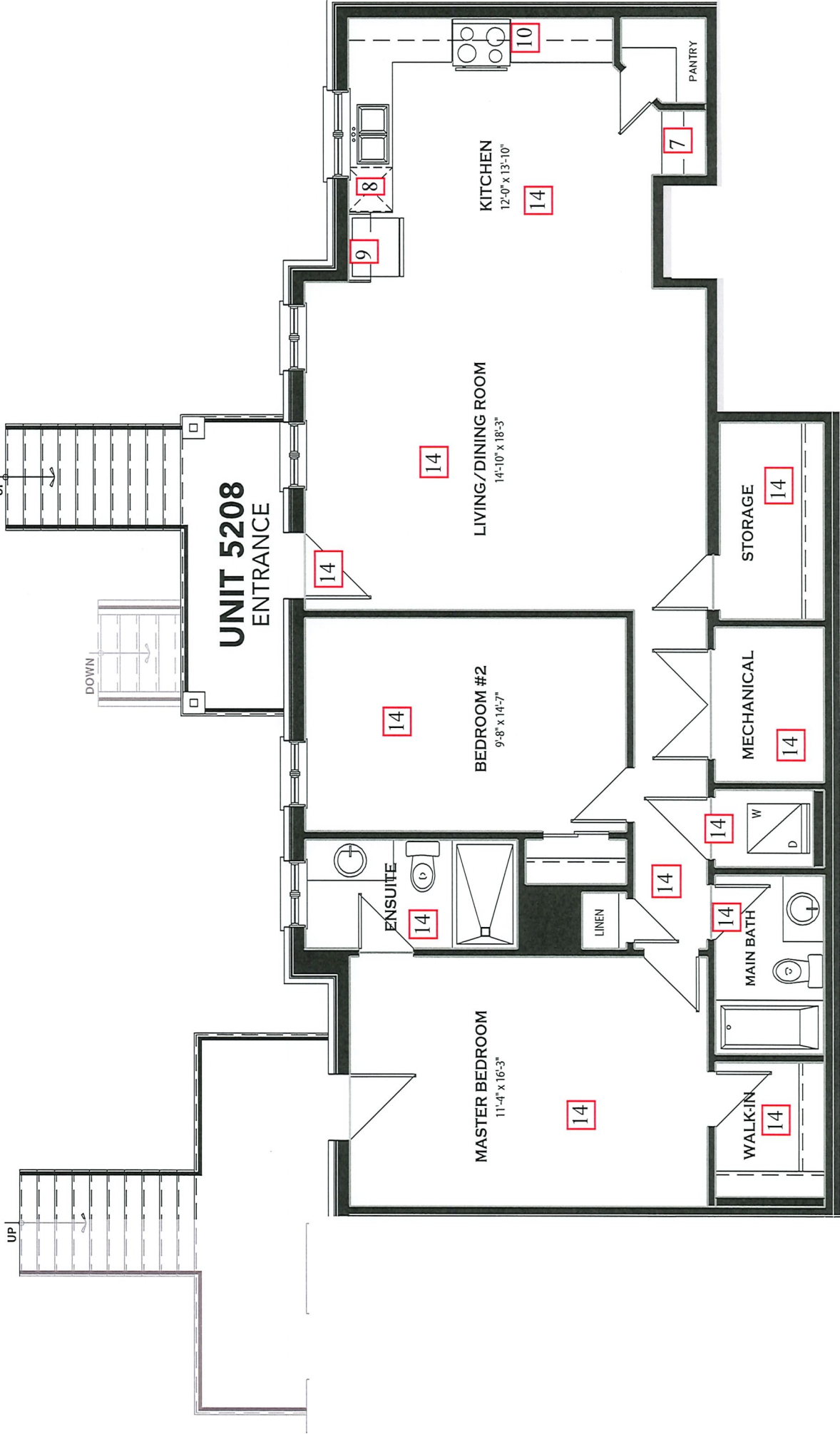

Schedule H

Vertical and/or horizontal bulkheads (chaseways) may be required to contain mechanical piping. All dimensions are approximate. E. & O.E., plans, materials and specifications are subject to change without notice. Actual useable floor space may vary from the stated floor area. *Note: Number of steps varies due to site grading.



Standard Edge Profiles for Granite & Quartz



Eased Edge

#8 Kitchen



1/4 Bevel

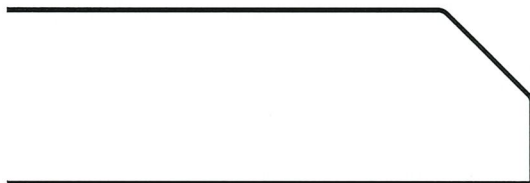

1/2 Bevel



3/4 Bevel



Pencil Top Only
with Square Bottom



Pencil Top and Bottom



1/2 Bullnose



Full Bullnose

Project: DV2

Purchaser: Portobello Partnership

Plan #: 4M-1290

Purchaser: _____

Lot: V59

Date: October 27, 2021

Model: 5208

Upgrade #: 8



Tile Installation Options

WALL TILE

Vertical stacked

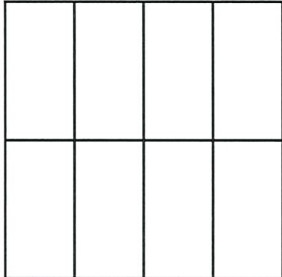

Horizontal stacked

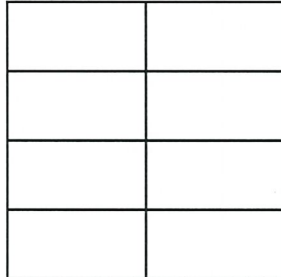

Ensuite Bathroom

Vertical 1/3 staggered

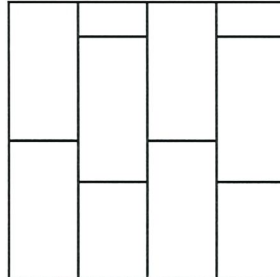

Horizontal 1/3 staggered

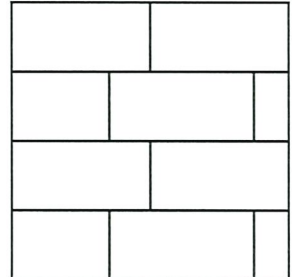

Kitchen Backsplash

Main Bathroom

Vertical brick

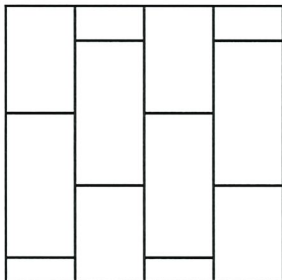

Horizontal brick

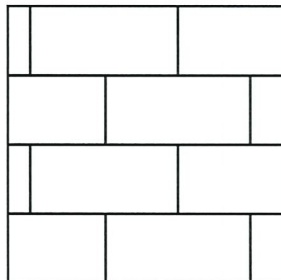

45 degree

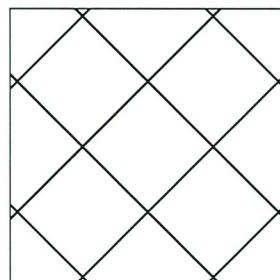

Standard square

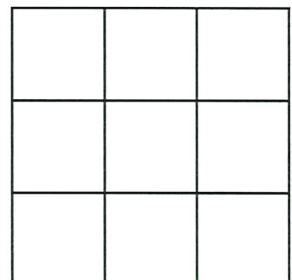

Project: DV2

Plan #: 4M-1290

Lot: V59

Model: 5208

Purchaser: Portobello Partnership

Purchaser: _____

Date: October 27, 2021

Upgrade #: 7, 16, 17, 18, 19, 20

Schedule "W4"
Granite & Variegated Quartz Colour Variation

Purchaser's name:	<u>Portobello Partnership</u>	Lot no:	<u>V59</u>
Purchaser's name:	<u>Contact: Samar Merhi</u>	Project:	<u>DEERFIELD VILLAGE 2</u>
Home Phone:	<u></u>	Model:	<u>5208</u>
Work Phone:	<u>613-837-2754</u>	Closing Date:	<u>August 2nd, 2022</u>
E-Mail (1):	<u>design@valecraft.com</u>	E-Mail (2):	<u></u>

Valecraft Homes Ltd. continues to provide the best in class sales and service. We recognize the importance of your home to you, our valued customer.

Granite & Variegated Quartz countertops are an elegant addition to your home. However, there are some things of which you should be aware.

Due to the natural composition of **Granite**, inherent variations in texture, colour and consistency are to be expected and considered as normal.

During the process of manufacturing **Variegated Quartz** to achieve a more natural stone look, variations in the appearance between the sample & the slab are to be expected.

Valecraft Homes Limited strongly suggests that you attend an appointment with our granite/quartz supplier two to three months prior to closing to view the granite/variegated quartz slabs available in the colour you have already chosen. A representative from our supplier will contact you to set up a mutual date & time for the appointment.

I/we, Portobello Partnership
have read and fully understand the aforementioned recommendation set forth by the builder and as such hereby release VALECRAFT HOMES LIMITED from future responsibility with respect to a variation in colour of granite countertops.

<input checked="" type="checkbox"/>	We <u>accept</u> this opportunity
<input type="checkbox"/>	We <u>decline</u> this opportunity

Project:	<u>DEERFIELD VILLAGE 2</u>	LOT NO:	<u>V59</u>
----------	----------------------------	---------	------------

<u>Purchaser</u>	<u>Date:</u>
------------------	--------------

<u>Purchaser</u>	<u>Date:</u>
------------------	--------------

<u>T. Oliver</u>	<u>October 27, 2021</u>
Valecraft Homes Limited	Date:

Appointment date given: Spoke with/left message:

Time scheduled: Date & Time:

 Valecraft <small>Homes Ltd.</small>	CONDOMINIUM HOME COLOUR CHART					
	Community:	Deerfield Village II	Reg'd Plan #:	4M-1290	Sales Rep:	Nicole Trudel
	Lot No:	V59	Civic Address:	615-C Tranquil Stream Private		
	Purchaser(s):	Portobello Partnership			Model Name/#:	5208
	Purchaser(s):				Closing Date:	Aug 2-2022

INTERIOR FINISHES		
DESCRIPTION		STD/UPG #
TRIM STYLE	Standard Nivaga Baseboards and Casings	STD
DOOR STYLE	Standard Cambridge Style Passage Doors	STD
INTERIOR HARDWARE	Standard Satin Chrome	STD
INTERIOR LIGHTING PACKAGE	Roma Lighting Package	4
BATHROOM ACCESSORIES	Standard Infinity Series in Chrome	STD

PAINT COLOUR(S)				
ROOM	MAIN COLOUR	STD/UPG #	ACCENT WALL	STD/UPG #
TRIM	Semi Gloss OC-117 simply white	STD	N/A	N/A
ENTRANCE	N/A	N/A	N/A	N/A
STORAGE ROOM	Low Lustre OC-30 Gray Mist	STD	N/A	N/A
LAUNDRY CLOSET	Low Lustre OC-30 Gray Mist	STD	N/A	N/A
LIVING ROOM / DINING ROOM	Low Lustre OC-30 Gray Mist	STD	N/A	N/A
KITCHEN	Semi Gloss OC-30 Gray Mist	STD	N/A	N/A
MECHANICAL ROOM	Low Lustre OC-30 Gray Mist	STD	N/A	N/A
BEDROOM HALLWAY	Low Lustre OC-30 Gray Mist	STD	N/A	N/A
MASTER BEDROOM & WIC	Low Lustre OC-30 Gray Mist	STD	N/A	N/A
BEDROOM #2	Low Lustre OC-30 Gray Mist	STD	N/A	N/A
ENSUITE BATHROOM	Semi Gloss OC-30 Gray Mist	STD	N/A	N/A
MAIN BATHROOM	Semi Gloss OC-30 Gray Mist	STD	N/A	N/A
NOTES:				

Purchaser's Signature(s) : _____
Date: _____

Purchaser's Signature(s) : _____
Date: _____

Approved By :

T. OLIVER

Date: October 27, 2021

Subject to change by Valecraft Homes in the event of unavailability of materials.
 Prices, terms and specifications are subject to change without notice E/O.E
 K:\Sales\Sales Legal Docs\Site - Deerfield\Block V\V59\DC\DV2 V59 Colour Sheet (Simon) OCT 10-21

	CONDOMINIUM HOME COLOUR CHART					
	Community:	Deerfield Village II	Reg'd Plan #:	4M-1290	Sales Rep:	Nicole Trudel
	Lot No:	V59	Civic Address:	615-C Tranquil Stream Private		
	Purchaser(s):	Portobello Partnership			Model Name/#:	5208
	Purchaser(s):				Closing Date:	Aug 2-2022

CABINETRY						
ROOM	SELECTION				LEVEL	STD/UPG #
KITCHEN	STYLE AND COLOUR	V202S 2164			STD	5, 7, 9, 10
	HARDWARE CODE	POI-R7040-128-BSAE	TYPE	Pulls	UPG	7, 10, 11
	COUNTERTOP	Black Pearl (Slab Viewing Required)	COUNTERTOP EDGE PROFILE	Eased Edge	Granite Level 1	7, 8
MAIN BATHROOM	STYLE AND COLOUR	V202S 2164			STD	STD
	HARDWARE CODE	POI-R7040-128-BSAE	TYPE	Pulls	UPG	12
	COUNTERTOP	P394-VL	COUNTERTOP EDGE PROFILE	Standard	STD Laminate	STD
ENSUITE BATHROOM	STYLE AND COLOUR	V202S 2164			STD	STD
	HARDWARE CODE	POI-R7040-128-BSAE	TYPE	Pulls	UPG	13
	COUNTERTOP	P394-VL	COUNTERTOP EDGE PROFILE	Standard	STD Laminate	STD
POWDER ROOM	STYLE AND COLOUR	N/A			N/A	N/A
	HARDWARE CODE	N/A	TYPE	N/A	N/A	N/A
	COUNTERTOP	N/A	COUNTERTOP EDGE PROFILE	N/A	N/A	N/A

APPLIANCES				
TYPE	SIZE	STD/UPG #	APPLIANCE UPG LEVEL	STD/UPG #
FRIDGE <small>(Standard Minimum Opening is 33" x 70.75")</small>	Standard Opening	STD	Basic Stainless Steel	2
RANGE	Standard Opening	STD	Basic Stainless Steel	2
DISHWASHER	Standard Opening	STD	Basic Stainless Steel	2
MICROWAVE / HOODFAN	Standard Opening	STD	Basic Stainless Steel	2
WASHING MACHINE/DRYER	Standard Opening	STD	Basic White Stackable Washer/ Dryer with Stacking Kit	2

Purchaser's Signature(s) :	<div></div>	Date:	<div></div>
Purchaser's Signature(s) :	<div></div>	Date:	<div></div>
Approved By :	<div>T. OLIVER</div>	Date:	<div>October 27, 2021</div>

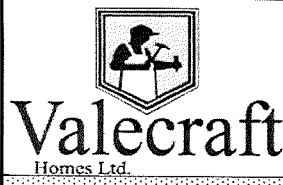
	CONDOMINIUM HOME COLOUR CHART					
	Community:	Deerfield Village II	Reg'd Plan #:	4M-1290	Sales Rep:	Nicole Trudel
	Lot No:	V59	Civic Address:	615-C Tranquil Stream Private		
	Purchaser(s):	Portobello Partnership			Model Name/#:	5208
	Purchaser(s):				Closing Date:	Aug 2-2022

FLOORING SELECTIONS			
ROOM	CARPET/UNDERPAD / HARDWOOD / VINYL EVERWOOD	LEVEL	STD/UPG #
ENTRY - FOYER	Torlys EverWood Premier EW-23022 Branchport 4-7/8" Wide x 48-3/8" Long Plank (Side to Side Install)	Quote	14
KITCHEN	Torlys EverWood Premier EW-23022 Branchport 4-7/8" Wide x 48-3/8" Long Plank (Side to Side Install)	Quote	14
STORAGE	Torlys EverWood Premier EW-23022 Branchport 4-7/8" Wide x 48-3/8" Long Plank (Side to Side Install)	Quote	14
MECHANICAL ROOM	Torlys EverWood Premier EW-23022 Branchport 4-7/8" Wide x 48-3/8" Long Plank (Side to Side Install)	Quote	14
LAUNDRY CLOSET	Torlys EverWood Premier EW-23022 Branchport 4-7/8" Wide x 48-3/8" Long Plank (Side to Side Install)	Quote	14
LIVING ROOM / DINING ROOM	Torlys EverWood Premier EW-23022 Branchport 4-7/8" Wide x 48-3/8" Long Plank (Side to Side Install)	Quote	14
MAIN BATHROOM FLOOR	Torlys EverWood Premier EW-23022 Branchport 4-7/8" Wide x 48-3/8" Long Plank (Side to Side Install)	Quote	14
ENSUITE BATHROOM FLOOR	Torlys EverWood Premier EW-23022 Branchport 4-7/8" Wide x 48-3/8" Long Plank (Side to Side Install)	Quote	14
BEDROOM HALLWAY	Torlys EverWood Premier EW-23022 Branchport 4-7/8" Wide x 48-3/8" Long Plank (Side to Side Install)	Quote	14
MASTER BEDROOM & WIC	Torlys EverWood Premier EW-23022 Branchport 4-7/8" Wide x 48-3/8" Long Plank (Side to Side Install)	Quote	14
BEDROOM # 2	Torlys EverWood Premier EW-23022 Branchport 4-7/8" Wide x 48-3/8" Long Plank (Side to Side Install)	Quote	14
STAIRS FROM FOYER	N/A	N/A	N/A

Purchaser's Signature(s) :

Date:

Purchaser's Signature(s) :

Date:

Approved By :

T. OLIVER

Date:

October 27, 2021

	CONDOMINIUM HOME COLOUR CHART					
	Community:	Deerfield Village II	Reg'd Plan #:	4M-1290	Sales Rep:	Nicole Trudel
	Lot No:	V59	Civic Address:	615-C Tranquil Stream Private		
	Purchaser(s):	Portobello Partnership			Model Name/#:	5208
	Purchaser(s):				Closing Date:	Aug 2-2022
PLUMBING FIXTURES						
ROOM	FIXTURE	STYLE		FINISH	STD/UPG#	
KITCHEN	SINK	Reginox Kitchen SinkUndermount Double Bowl ND1831UA/9		Stainless Steel	22	
	FAUCET	Delta Kitchen Faucet Single Handle Pull-Down Marley 986LF-AR		Arctic Stainless	21	
ENSUITE BATHROOM	SINK	Standard		White	STD	
	VANITY FAUCET	Standard		Chrome	STD	
	WATER CLOSET	Standard		White	STD	
	SHOWER	Standard with Zitta Niche 12 x 12 (Installed on short wall opposing shower head, approx. centered and the top of niche approx. 5ft from shower base)		White/Chrome/ Clear Glass/ Stainless Steel	6	
	SHOWER FAUCET	Standard		Chrome	STD	
MAIN BATHROOM	SINK	Standard		White	STD	
	VANITY FAUCET	Standard		Chrome	STD	
	WATER CLOSET	Standard		White	STD	
	TUB/SHOWER	Standard		White	STD	
	TUB/SHOWER FAUCET	Standard		Chrome	STD	
POWDER ROOM	PEDESTAL	N/A		N/A	N/A	
	SINK FAUCET	N/A		N/A	N/A	
	WATER CLOSET	N/A		N/A	N/A	
NOTE: All fixtures are white as standard						

Purchaser's Signature(s) : _____

Purchaser's Signature(s) : _____

Approved By : _____

Date: _____

Date: _____

Date: October 27, 2021