

AMENDMENT TO AGREEMENT OF PURCHASE AND SALE
BETWEEN THE UNDERSIGNED PARTIES HERETO SIGNED
ON THE 8 DAY OF November , 20 21 .

REGARDING PROPERTY KNOWN AS: BUILDER'S LOT : D20
LOT: D20 BLOCK :
50M-352 PLACE ST THOMAS 6
CIVIC ADDRESS: 739 Namur Street

PURCHASERS: Anna Luiza Scheffer Sinhorin, Gilmar Sinhorin & Edileia Sinhorin

VENDORS: VALECRAFT HOMES (2019) LIMITED

DATE OF ACCEPTANCE: November 9, 2021

It is hereby understood and agreed between the undersigned parties hereto that the following changes shall be made to the above mentioned Agreement of Purchase and Sale and except for such changes noted below all other terms and conditions in the Agreement shall remain as stated therein and time shall remain of the essence.

DELETE: PURCHASE PRICE: \$502,632.23
BALANCE AT CLOSING: \$472,632.23
LESS H.S.T. AMOUNT: \$466,046.22
SCHEDULE "G" DATED: November 8, 2021
TARION SCHEDULE "B" DATED: November 22, 2021

INSERT: 680 dated: December 3, 2021 in the amount of: \$3,782.00
NEW PURCHASE PRICE: \$506,414.23
NEW BALANCE AT CLOSING: \$476,414.23
NEW LESS H.S.T. AMOUNT: \$469,393.12
SCHEDULE "G" DATED: December 3, 2021
TARION SCHEDULE "B" DATED: December 3, 2021

Dated at Ottawa, ON this 3rd day of December , 2021

In the presence of:

WITNESS

DocuSigned by:
Anna Luiza Scheffer Sinhorin
PURCHASER
2AAA49C56F834F5...

WITNESS

DocuSigned by:
Edileia Sinhorin
PURCHASER
B9736C05554C4GC...

Dated at Ottawa, ON this 3rd day of December , 2021

VALECRAFT HOMES (2019) LIMITED

Per: Frank Nieuwkoop
A04F827301214EE...

Name: Frank Nieuwkoop

Title: Vice President

I HAVE THE AUTHORITY TO BIND THE CORPORATION
REV: September 17, 2020



Limited Use Freehold Form
(Tentative Occupancy Date – POTL/CEC)

SCHEDULE B

Adjustments to Purchase Price or Balance Due on Closing

PART I Stipulated Amounts/Adjustments

These are additional charges, fees or other anticipated adjustments to the final purchase price or balance due on Closing, the dollar value of which is stipulated in the Purchase Agreement and set out below.

- 1. Preparation of transfer fee by Builder’s solicitor as stated in Clause #22 of the Agreement of Purchase & Sale. \$275.00 + HST= \$310.75

Part II All Other Adjustments – to be determined in accordance with the terms of the Purchase Agreement

These are additional charges, fees or other anticipated adjustments to the final purchase price or balance due on Closing, which will be determined after signing the Purchase Agreement, all in accordance with the terms of the Purchase Agreement.

- 1. Land Transfer Tax based on final purchase price less HST as stated in Clause #17 of the Agreement of Purchase & Sale.
- 2. Property Taxes as per final statement of adjustments as stated in Clause #7 of the Agreement of Purchase & Sale.
- 3. Maximum GST/HST rebate based on final purchase price less HST as stated in Schedule “G” Clause # 8 of the Agreement of Purchase & Sale.
- 4. Tarion Enrolment Fee based on final purchase price less HST as stated in Clause #7 of the Agreement of Purchase & Sale. Tarion Enrolment Calculation Table can be viewed on-line at tarion.com. See chart on page 12 as a guide.
- 5. Additional upgrades/deletions contained in the attached Amendment to the Agreement of Purchase and Sale dated December 3, 2021.
- 6. Any increase in existing or newly imposed levies, development charges, education development any impost or other charges imposed by an approving authority or public utility corporation as stated in Clause # 33 of the Agreement of Purchase & Sale.

Signed at Ottawa, ON, this 3 day of December, 2021.

DocuSigned by:
Anna Luiza Schuffer Sinhorin
Purchaser
DocuSigned by:
Gilmar Sinhorin
Purchaser
DocuSigned by:
Edna Sinhorin
Purchaser

Valecraft Homes Limited
DocuSigned by:
Frank Nieuwkoop
Per:

December 12, 2021 | 6:09 PM PST

Date:

Lot #: D20 - Phase 6

Project: Place St Thomas 6

SCHEDULE "G"

HARMONIZED SALES TAX AND NEW HOUSING REBATE

1. The parties acknowledge that as at the date of this Agreement, Harmonized Sales Tax ("HST") is applicable to this transaction pursuant to the Excise Tax Act (Canada) (the "Legislation") and that, the Purchaser may qualify for the GST/HST new housing rebate (as is authorized by the Legislation from time to time) (the "New Housing Rebate") in respect of this transaction.
2. The Purchaser is hereby advised that the Purchase Price listed in "Purchase Price" Section of this Agreement includes all HST and the New Housing Rebate applicable to this transaction (refer to maximum rebate allowance in Clause 8) as at the date this Agreement is signed by the parties. All sales taxes applicable to the transaction (including any applicable New Housing Rebate) will be calculated as of the closing of the subject transaction and will be applied in accordance with the Legislation. In the event that there is a change to the Legislation after the execution of this Agreement but prior to the closing of this transaction, the Vendor shall make all applicable adjustments to the sales taxes payable in this transaction in accordance with all applicable Legislation.
3. The Purchaser hereby irrevocably assigns to the Vendor the benefit of the New Housing Rebate, if applicable to this transaction.
4. The Purchaser hereby warrants and agrees that:

(a) The Real Property is being purchased as the Purchaser's primary place of residence and that the Purchaser will take possession and occupy the Dwelling forthwith upon closing and will not allow occupancy of the Dwelling by any other individual (other than the Purchaser's immediate family) as a place of residence prior to occupancy by the Purchaser;

(b) Purchaser will execute and deliver on closing such documents as the Vendor may require to confirm the warranties and agreements contained in this Schedule; and

(c) Purchaser will submit to the Vendor on closing, prior to or after closing at the Vendor's request, an application or applications in the manner and in the form prescribed containing prescribed information required by the Legislation for the New Housing Rebate
5. The Purchaser acknowledges that the Vendor has calculated the Purchase Price on the assumption that the New Housing Rebate will be applicable to this transaction. If for any reason the Purchaser does not qualify for the New Housing Rebate, then the Purchaser shall be fully responsible for paying to the Vendor the amount of such New Housing Rebate plus interest at the Bank of Montreal prime rate from the date the statement of adjustments is calculated plus any fees, penalties or damages imposed on the Vendor under the Legislation. For greater certainty, the Purchaser acknowledges that the New Housing Rebate described above is for individuals buying a new house or residential condominium as a primary place of residence for themselves or a relation. It does not include the rebate for HST which may be available to investors buying a new house or residential condominium as a rental property (the GST/HST "New Residential Rental Property Rebate"). If the Property is being purchased for investment purposes, the Purchaser will not qualify for the New Housing Rebate and the Purchaser shall be responsible for paying to the Vendor an amount equal to the New Housing Rebate which has been included in the Purchase Price hereunder. All Purchasers buying a new house or residential condominium as a rental property are responsible for applying for the New Residential Rental Property Rebate after the closing of the subject transaction.

DS

ALSS

Purchaser

DS

GS

DS

ESS

Purchaser

DS

FN

Vendor

6. The Purchaser acknowledges and agrees that the Purchase Price set forth in this Agreement has been arrived at on the basis that the Purchase Price includes all Extras, premiums and bonuses and excludes any Extras ordered pursuant to a Change Order following the date of execution of this Agreement. The Purchaser acknowledges that the purchase of additional Extras following the date of execution of this Agreement may push the Purchase Price of the Real Property into a different sales tax category for the purposes of determining the amount of the New Housing Rebate, and that this may lower the amount of said New Housing Rebate applicable to the transaction. If a reduced New Housing Rebate is applicable under the Legislation due to the purchase of Extras following the date of execution of this Agreement, the Purchaser agrees to compensate the Vendor for the, amount by which the New Housing Rebate used to calculate the Purchase Price listed in the "Purchase Price" section herein exceeds the actual applicable New Housing Rebate, such amount to be credited to the Vendor as an adjustment on closing.
7. The Parties acknowledge that for purposes of Land Transfer Tax, the total consideration to be inserted in the Transfer/Deed of Land for this transaction shall be the total Purchase Price including Extras excluding HST and the New Housing Rebate, namely the amount of \$469,393.12 . The Purchaser is responsible for payment in full of the Land Transfer Tax and the cost of registration of the transfer.
8. The Purchaser agrees to execute all further documents required by the Vendor after closing to give effect to this Schedule.

Dated at Ottawa, ON this 3rd day of December , 2021

DocuSigned by:

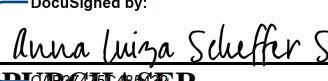

DocuSigned by:

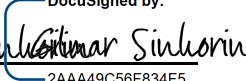

PURCHASER

2AAA49C56F834F5...

VALECRAFT HOMES (2019) LIMITED

DocuSigned by:

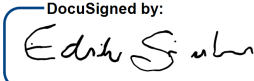

PURCHASER

89736C05554C4CC...

DocuSigned by:



PER:

A04F827301214EE...

December 3, 2021
DATE:

PROJECT: PLACE ST THOMAS 6 LOT: D20



OPTIONAL KITCHEN CABINET CROWN MOULDING, FILLER &
STANDARD BULKHEAD DETAILS

UPC9-2A Upgrade #: 21

- Includes upgrade to 42" uppers with filler detail on upper kitchen cabinetry to standard bulkhead.

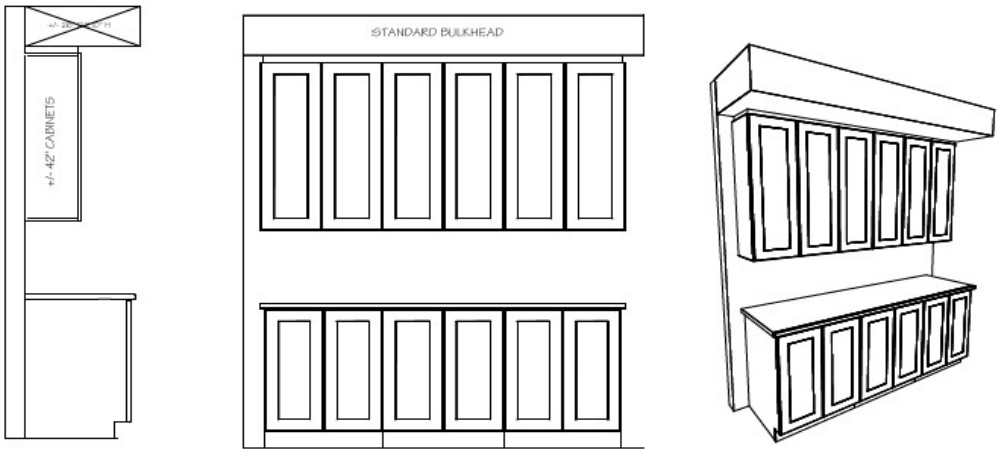

DS
ALSS

DS
GS

DS
ESS

DS
FN

Site: Place St. Thomas 6

Purchaser: Anna Luiza Scheffer Sinhorin

Plan No: 50M-352

Lot: D20

Purchaser: Gilmar Sinhorin & Edileia Sinhorin

Date: December 3, 2021



Valecraft
Homes (2019) Limited

Standard Edge Profiles for Granite & Quartz



Eased Edge

Kitchen Countertop:
Eased Edge(Item #13)

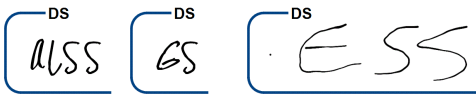

Project: Place St. Thomas 6

Purchaser: Anna Luiza Scheffer Sinhorin

Plan #: 50M-352

Purchaser: Gilmar Sinhorin & Edileia Sinhorin

Lot: D20

Date: December 3, 2021

Model: #140, Green, Rev

Upgrade #: 13



Valecraft
Homes (2019) Limited

Tile Installation Options

WALL TILE

Vertical stacked

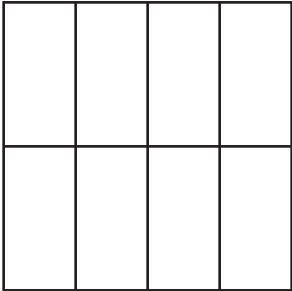

Horizontal stacked

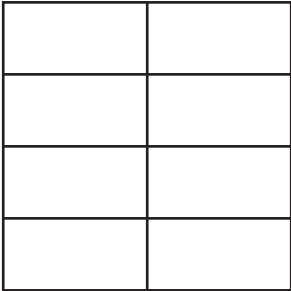

Main Bathroom,
Ensuite Bathroom,

Vertical 1/3 offset staggered

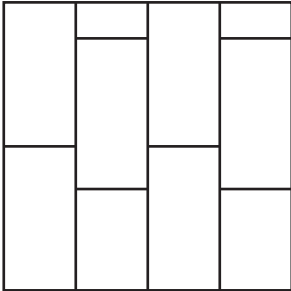

Horizontal 1/3 offset staggered

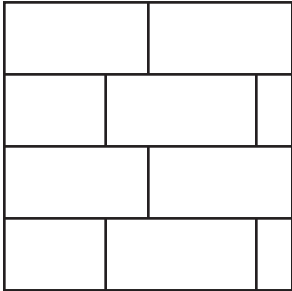

Vertical brick

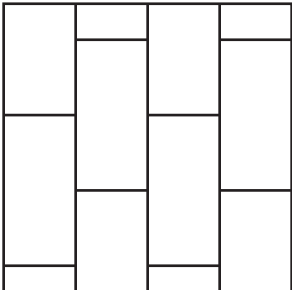

Horizontal brick

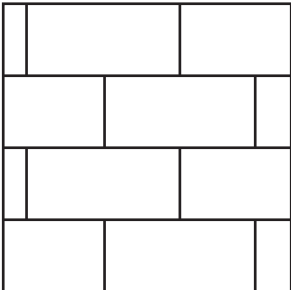

Kitchen Backsplash,

45 degree

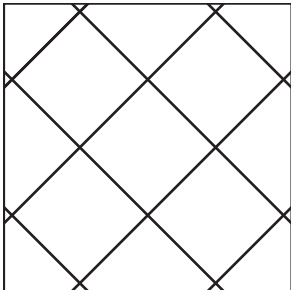

Standard square

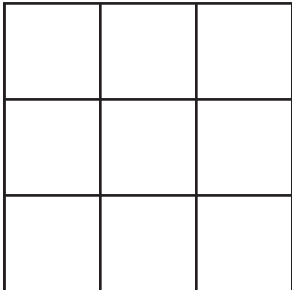

Fireplace

^{DS}
USS

^{DS}
GS

^{DS}
ESS

^{DS}
FN

Project: Place St. Thomas 6

Plan #: 50M-352

Lot: D20

Model: #140, Green, Rev

Purchaser: Anna Luiza Scheffer Sinhorin

Purchaser: Gilmar Sinhorin & Edileia Sinhorin

Date: December 3, 2021

Upgrade #: 4, 10, 15, 23



Tile Installation Options

FLOOR TILE

Standard square

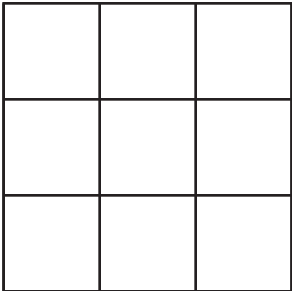

Foyer, Powder Room,
Laundry,
Kitchen/Dinette,
Main Bathroom,
Ensuite Bathroom

Square brick

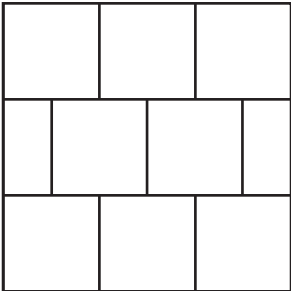

Rectangular
front to back of the house

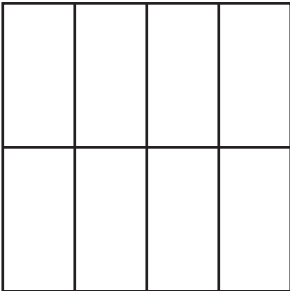

Rectangular
side to side of the house

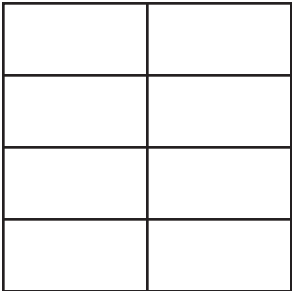

Rectangular 1/3 staggered
front to back of the house

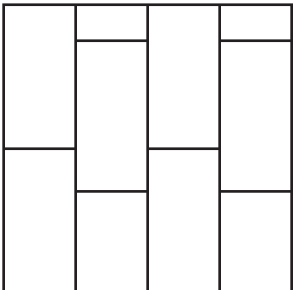

Rectangular 1/3 staggered
side to side of the house

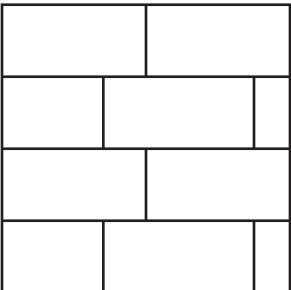

45 degree

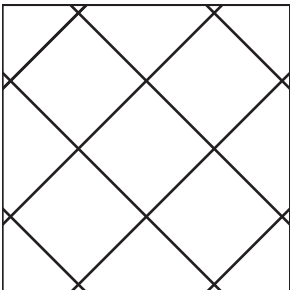

DS
ALSS

DS
GS

DS
ESS

DS
FN

Project: Place St. Thomas 6
Plan #: 50M-352
Lot: D20
Model: #140, Green, Rev

Purchaser: Anna Luiza Scheffer Sinhorin
Purchaser: Gilmar Sinhorin & Edileia Sinhorin
Date: December 3, 2021
Upgrade #: 4, 10, 15, 23



THE GREEN

MODEL 140

2140 sq.ft
(475 sq.ft. finished basement)

Site: Place St. Thomas 6

Plan No.: 50M-352

Lot: D20

Date: December 3, 2021

Purchaser: Anna Luiza Scheffer Sinhorin

Purchaser: Gilmar Sinhorin & Edileia Sinhorin

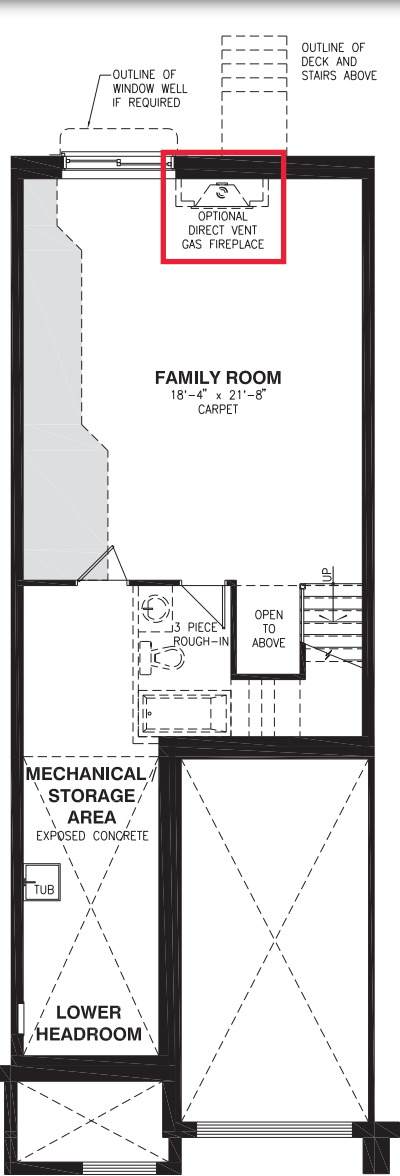

BASEMENT FLOOR

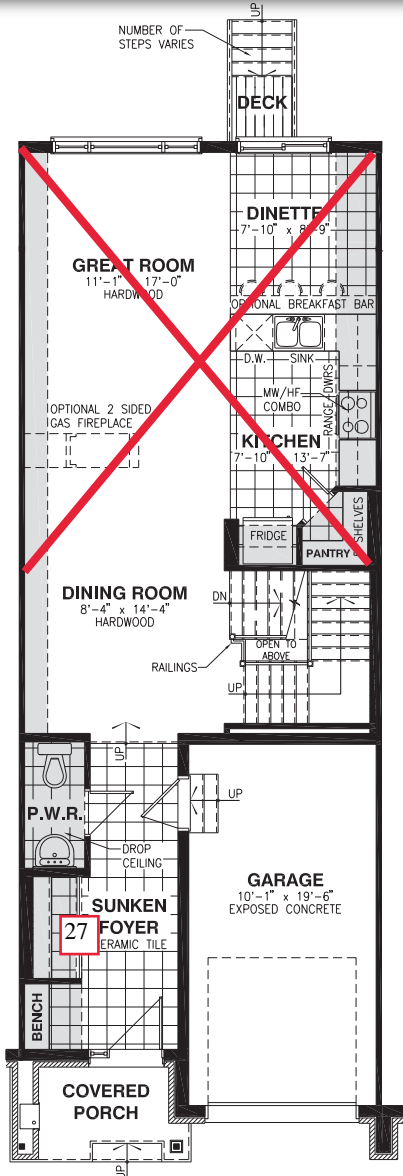

GROUND FLOOR

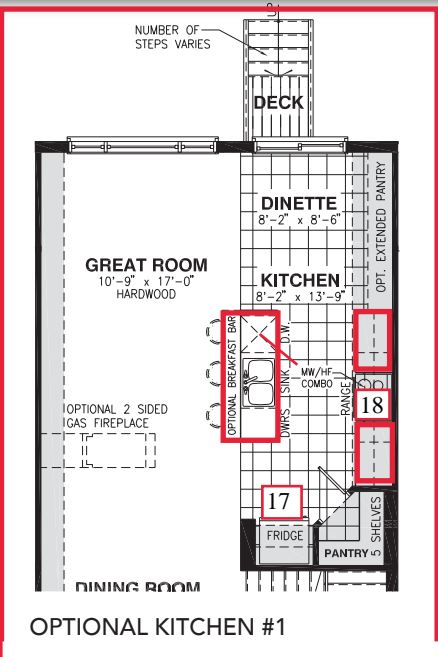

OPTIONAL KITCHEN #1

Flooplan Sketch

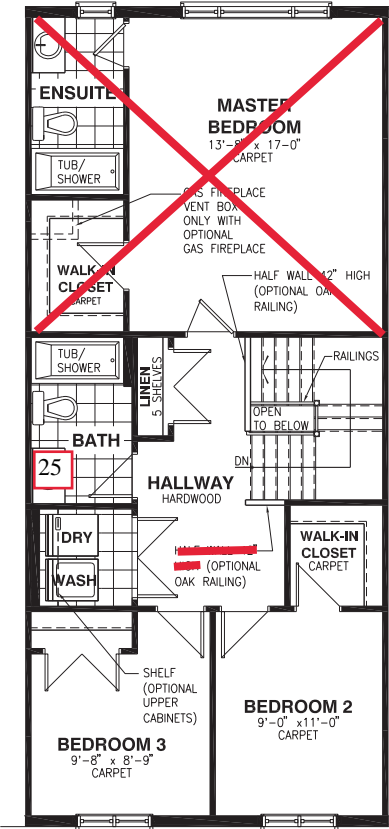

SECOND FLOOR

DS
ALSS

DS
GS

DS
ALSS

DS
FN

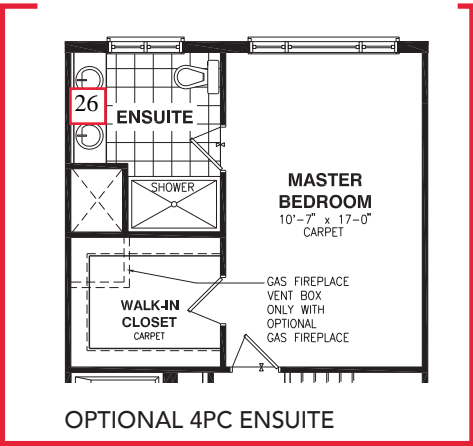

OPTIONAL 4PC ENSUITE



Vertical and/or horizontal bulkheads (chaseways) may be required to contain mechanical piping. Bulkhead shown in grey areas.
All dimensions are approximate. E. & O.E., plans, materials and specifications are subject to change without notice. Actual useable floor space may vary from the stated floor area. *Note: Number of steps varies due to site grading.

|  | SINGLES AND TOWNS COLOUR CHART | | | | | |
|--|--|------------------------------------|----------------|-------------------------------------|---------------|------------|
| | Community: | Place St. Thomas 6 | Reg'd Plan #: | 50M-352 | Sales Rep: | A. Bowman |
| | Lot No: | D20 - Phase 6 | Civic Address: | 739 Namur Street, Embrun ON K0A 1W0 | | |
| | Purchaser(s): | Anna Luiza Scheffer Sinhorin | | | Model Name/#: | Green #140 |
| | Purchaser(s): | Gilmar Sinhorin & Edileia Sinhorin | | | Closing Date: | 1-Sep-22 |
| | | | | | | |
| INTERIOR FINISHES | | | | | | |
| DESCRIPTION | | | | | | STD/UPG # |
| TRIM STYLE | Standard | | | | | STD |
| DOOR STYLE | Standard + Foyer Closet Double interior swing doors in lieu of standard white sliders | | | | | 26 |
| INTERIOR HARDWARE | Standard | | | | | 26 |
| INTERIOR LIGHTING PACKAGE | Standard Roma Collection | | | | | 10, 12 |
| BATHROOM ACCESSORIES | Standard | | | | | 10 |
| FIREPLACE MANTLE | MDF Modern Type 1 Mantle Painted White | | | | | 4 |

| INTERIOR HANDRAILS AND SPINDLES | | | | |
|---|---------|----------|--------------|-----------|
| | WOOD | STYLE | STAIN/COLOUR | STD/UPG # |
| HANDRAIL | Red Oak | Colonial | SB 200 | 7, 14 |
| BRACKET | Red Oak | Colonial | SB 200 | 7, 14 |
| SPINDLES | Red Oak | Colonial | SB 200 | 7, 14 |
| POSTS | Red Oak | Colonial | SB 200 | 7, 14 |
| NOSINGS | Red Oak | N/A | SB 200 | 6, 7, 14 |
| HARDWOOD STAIRCASE <i>(WHERE APPLICABLE)</i> | Red Oak | N/A | SB 200 | 6, 14 |

| APPLIANCES | | | | |
|---|------------------|-----------|-----------------------|-----------|
| TYPE | SIZE | STD/UPG # | APPLIANCE UPG LEVEL | STD/UPG # |
| FRIDGE <i>(Standard Minimum Opening is 33" x 70.75")</i> | Standard Opening | STD | Water line rough-in | 17 |
| RANGE | Standard Opening | STD | \ | \ |
| DISHWASHER | Standard Opening | STD | \ | \ |
| MICROWAVE/ HOODFAN <i>(Specify if convection)</i> | Standard Opening | STD | basic stainless steel | 18 |
| WASHING MACHINE/DRYER | Standard Opening | STD | \ | \ |

Purchaser's Signature(s) :

DocuSigned by:

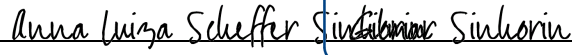

CAE37475C485432

Purchaser's Signature(s) :

DocuSigned by:



2AAA49C56F834F5...

Approved By :

DocuSigned by:

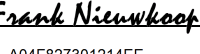

A04F827301214EE...

Date: December 3, 2021

Date: December 3, 2021

Date: December 3, 2021

| | | | | | | |
|--|--------------------------------|---------------------------------------|-------------------------|-------------------------------------|----------------|---------------|
|  | SINGLES AND TOWNS COLOUR CHART | | | | | |
| | Community: | Place St. Thomas 6 | Reg'd Plan #: | 50M-352 | Sales Rep: | A. Bowman |
| | Lot No: | D20 - Phase 6 | Civic Address: | 739 Namur Street, Embrun ON K0A 1W0 | | |
| | Purchaser(s): | Anna Luiza Scheffer Sinhorin | | | Model Name/#: | Green #140 |
| | Purchaser(s): | Gilmar Sinhorin & Edileia Sinhorin | | | Closing Date: | 1-Sep-22 |
| CABINETRY | | | | | | |
| ROOM | SELECTION | | | | LEVEL | STD/UPG # |
| KITCHEN | STYLE AND COLOUR | Shaker 5PCS TF-179 | | | Level 1 | 8, 13, 19, 21 |
| | HARDWARE CODE | Doors: 81091-195 & Drawers: 81092-195 | TYPE | Doors: Knobs & Drawers: Handles | STD | 8 |
| | COUNTERTOP | Silestone Quartz Blanco Maple | COUNTERTOP EDGE PROFILE | Eased Edge | Level 1 Quartz | 8, 13 |
| MAIN BATHROOM | STYLE AND COLOUR | Lastra Winter Fun TA-M2004 | | | STD | STD |
| | HARDWARE CODE | 5923-195 | TYPE | Knobs | STD | STD |
| | COUNTERTOP | P394-VL (without 4" backspalsh) | COUNTERTOP EDGE PROFILE | Standard | STD | 25 |
| ENSUITE BATHROOM | STYLE AND COLOUR | Lastra Winter Fun TA-M2004 | | | STD | 10 |
| | HARDWARE CODE | 5923-195 | TYPE | Knobs | STD | 10 |
| | COUNTERTOP | P394-VL (without 4" backspalsh) | COUNTERTOP EDGE PROFILE | Standard | STD | 26, 10 |
| POWDER ROOM | STYLE AND COLOUR | PEDESTAL | | | STD | STD |
| | HARDWARE CODE | / | TYPE | / | / | / |
| | COUNTERTOP | / | COUNTERTOP EDGE PROFILE | / | / | / |
| BASEMENT/OTHER BATHROOM | STYLE AND COLOUR | / | | | / | / |
| | HARDWARE CODE | / | TYPE | / | / | / |
| | COUNTERTOP | / | COUNTERTOP EDGE PROFILE | / | / | / |
| LAUNDRY ROOM | STYLE AND COLOUR | / | | | / | / |
| | HARDWARE CODE | / | TYPE | / | / | / |
| | COUNTERTOP | / | COUNTERTOP EDGE PROFILE | / | / | / |

DocuSigned by:



CAE37475C485432

DocuSigned by:

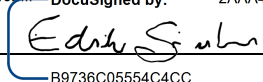

B9736C05554C4CC...

Purchaser's Signature(s) :

Purchaser's Signature(s) :

Approved By :

Date: December 3, 2021

Date: December 3, 2021

Date: December 3, 2021

| | | | | | | |
|--|--------------------------------|------------------------------------|----------------|-------------------------------------|---------------|------------|
|  | SINGLES AND TOWNS COLOUR CHART | | | | | |
| | Community: | Place St. Thomas 6 | Reg'd Plan #: | 50M-352 | Sales Rep: | A. Bowman |
| | Lot No: | D20 - Phase 6 | Civic Address: | 739 Namur Street, Embrun ON K0A 1W0 | | |
| | Purchaser(s): | Anna Luiza Scheffer Sinhorin | | | Model Name/#: | Green #140 |
| | Purchaser(s): | Gilmar Sinhorin & Edileia Sinhorin | | | Closing Date: | 1-Sep-22 |
| PAINT COLOUR(S) | | | | | | |
| ROOM | MAIN COLOUR | | STD/UPG # | ACCENT WALL | | STD/UPG # |
| TRIM | Semi Gloss OC-117 simply white | | STD | / | | / |
| FOYER | Low Luster OC-30 Gray Mist | | STD | / | | / |
| POWDER ROOM | Semi Gloss OC-30 Gray Mist | | STD | / | | / |
| MAIN FLOOR HALLWAY | Low Luster OC-30 Gray Mist | | STD | / | | / |
| DINING ROOM | Low Luster OC-30 Gray Mist | | STD | / | | / |
| FLEX ROOM | / | | / | / | | / |
| GREAT ROOM | Low Luster OC-30 Gray Mist | | STD | / | | / |
| FAMILY ROOM | Low Luster OC-30 Gray Mist | | STD | / | | / |
| DEN/STUDY/HOME OFFICE | / | | / | / | | / |
| KITCHEN/DINETTE/BREAKFAST | Semi Gloss OC-30 Gray Mist | | STD | / | | / |
| LAUNDRY CLOSET | Low Luster OC-30 Gray Mist | | STD | / | | / |
| 2nd FLOOR HALLWAY | Low Luster OC-30 Gray Mist | | STD | / | | / |
| MAIN BATH | Semi Gloss OC-30 Gray Mist | | STD | / | | / |
| BEDROOM #2 | Low Luster OC-30 Gray Mist | | STD | / | | / |
| BEDROOM #3 | Low Luster OC-30 Gray Mist | | STD | / | | / |
| BEDROOM #4 | / | | / | / | | / |
| MASTER BEDROOM | Low Luster OC-30 Gray Mist | | STD | / | | / |
| MASTER BEDROOM WALK-IN CLOSET | Low Luster OC-30 Gray Mist | | STD | / | | / |
| MASTER BEDROOM ENSUITE | Semi Gloss OC-30 Gray Mist | | STD | / | | / |
| FINISHED BASEMENT RECREATION ROOM | / | | / | / | | / |
| BASEMENT BATHROOM | / | | / | / | | / |

Purchaser's Signature(s) :

DocuSigned by:



CAE37475C485432

Purchaser's Signature(s) :

DocuSigned by:

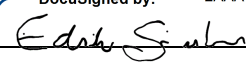

2AAA49C56F834F5...

Approved By :

DocuSigned by:



A04F827301214EE...

Date:

December 3, 2021

Date:

December 3, 2021

Date:

December 3, 2021

| | | | | | | |
|--|--------------------------------|--|----------------|-------------------------------------|-------------------------------------|---------------|
|  | SINGLES AND TOWNS COLOUR CHART | | | | | |
| | Community: | Place St. Thomas 6 | Reg'd Plan #: | 50M-352 | Sales Rep: | A. Bowman |
| | Lot No: | D20 - Phase 6 | Civic Address: | 739 Namur Street, Embrun ON K0A 1W0 | | |
| | Purchaser(s): | Anna Luiza Scheffer Sinhorin | | | Model Name/#: | Green #140 |
| | Purchaser(s): | Gilmar Sinhorin & Edileia Sinhorin | | | Closing Date: | 1-Sep-22 |
| CERAMIC & GROUT SELECTIONS (1) | | | | | | |
| ROOM | AREA | MANUFACTURER/SERIES/SIZE/ COLOUR/CODE | | GROUT SELECTION | LEVEL | STD/UPG # |
| FOYER | FLOOR | Centura Vitra Linen Series 13"x13" Cream K939574 (Standard Square Install) | | 949 Silverado | STD + UPG Grout | 22 |
| POWDER ROOM | FLOOR | Centura Vitra Linen Series 13"x13" Cream K939574 (Standard Square Install) | | 949 Silverado | STD + UPG Grout | 22 |
| | WALL | / | | / | / | / |
| | INSERT OR BORDER | / | | | | |
| MUDROOM | FLOOR | / | | / | / | / |
| | WALL | / | | | | |
| | INSERT OR BORDER | / | | | | |
| LAUNDRY CLOSET | FLOOR | Ceratec Graniser Kafka 13"x13" Grey (Standard Square Install) | | 949 Silverado | STD + UPG Grout | 22 |
| | WALL | / | | / | / | / |
| | INSERT OR BORDER | / | | | | |
| KITCHEN | FLOOR | Centura Vitra Linen Series 13"x13" Cream K939574 (Standard Square Install) | | 949 Silverado | STD + UPG Grout | 8, 22 |
| | BACKSPLASH | Euro Pasha Soho 3"x6" Glossy White Wall (Horizontal 1/2 brick install) | | 910 Bright White | Bronze + UPG Grout + UPG install | 8, 15, 22, 23 |
| | INSERT OR BORDER | / | | | | |
| BREAKFAST AREA/DINETTE | FLOOR | Centura Vitra Linen Series 13"x13" Cream K939574 (Standard Square Install) | | 949 Silverado | STD + UPG Grout | 8, 22 |
| FIREPLACE | HEARTH | / | | / | / | / |
| | SURROUND | Olympia Regal 12"x12" Polished Grey NY.RG.GRY.1212.PL (Standard Square Install) | | 949 Silverado | STD + UPG Grout | 4, 22 |
| ADDITIONAL FIREPLACE | HEARTH | / | | / | / | / |
| | SURROUND | / | | / | / | / |

Purchaser's Signature(s) :

DocuSigned by:

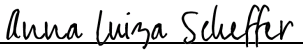

CAE37475C485432...

DocuSigned by:

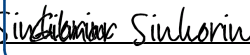

2AAA49C56F834F5...

Purchaser's Signature(s) :

DocuSigned by:

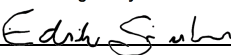

B9736C05554C4CC...

Approved By :

DocuSigned by:



A04F827301214EE...

Date:

December 3, 2021

Date:

December 3, 2021

Date:

December 3, 2021

Subject to change by Valecraft Homes in the event of unavailability of materials.
Prices, terms and specifications are subject to change without notice E/O.E
K:\Sales\Sales Legal Docs\Site - Place-St Thomas\PST PH6 - Towns\Block D\D20 - Anna Gilmar & Edi

| | | | | | | |
|--|--------------------------------|---|----------------|-------------------------------------|-----------------|------------|
|  | SINGLES AND TOWNS COLOUR CHART | | | | | |
| | Community: | Place St. Thomas 6 | Reg'd Plan #: | 50M-352 | Sales Rep: | A. Bowman |
| | Lot No: | D20 - Phase 6 | Civic Address: | 739 Namur Street, Embrun ON K0A 1W0 | | |
| | Purchaser(s): | Anna Luiza Scheffer Sinhorin | | | Model Name/#: | Green #140 |
| | Purchaser(s): | Gilmar Sinhorin & Edileia Sinhorin | | | Closing Date: | 1-Sep-22 |
| CERAMIC & GROUT SELECTIONS (2) | | | | | | |
| ROOM | AREA | MANUFACTURER/SERIES/SIZE/ COLOUR/CODE | | GROUT SELECTION | LEVEL | STD/UPG # |
| MAIN BATHROOM | FLOOR | Ceratec Graniser Kafka 13"x13" Grey (Standard Square Install) | | 949 Silverado | STD + UPG Grout | 22 |
| | WALL | Olympia Construct 8"x12" Glossy White TH.CT.WHT.0812.GL (Horizontal Stacked Install) | | 949 Silverado | STD + UPG Grout | 22 |
| | INSERT OR BORDER | / | | | | |
| 3PC ENSUITE BATHROOM | FLOOR | / | | / | / | / |
| | WALL | / | | / | / | / |
| | INSERT OR BORDER | / | | | | |
| 4PC ENSUITE BATHROOM | FLOOR | Ceratec Bien Pietra Moda 13"x13" Silver (Standard Square Install) | | 949 Silverado | STD + UPG Grout | 10, 22 |
| | TUB DECK | / | | / | / | / |
| | TUB BACKSPLASH | / | | / | / | / |
| | INSERT OR BORDER | / | | | | |
| | SHOWER WALLS | Olympia Venus Serie 10"x16" Grey GE.VN.GRY.1016 (Horizontal Stacked Install) | | 949 Silverado | STD + UPG Grout | 10, 22 |
| BASEMENT/OTHER BATHROOM | FLOOR | / | | / | / | / |
| | WALL | / | | / | / | / |
| | INSERT OR BORDER | / | | | | |

Purchaser's Signature(s) :

DocuSigned by:

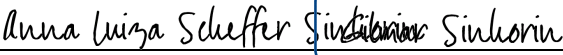

C AE37475C485432

Purchaser's Signature(s) :

DocuSigned by:



B 9736C05554C4CC...

Approved By :

DocuSigned by:

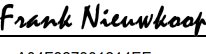

A 04F827301214EE...

Date:

December 3, 2021

Date:

December 3, 2021

Date:

December 3, 2021

| | | | | | | |
|--|--|------------------------------------|----------------|-------------------------------------|---------------|------------|
|  | SINGLES AND TOWNS COLOUR CHART | | | | | |
| | Community: | Place St. Thomas 6 | Reg'd Plan #: | 50M-352 | Sales Rep: | A. Bowman |
| | Lot No: | D20 - Phase 6 | Civic Address: | 739 Namur Street, Embrun ON K0A 1W0 | | |
| | Purchaser(s): | Anna Luiza Scheffer Sinhorin | | | Model Name/#: | Green #140 |
| | Purchaser(s): | Gilmar Sinhorin & Edileia Sinhorin | | | Closing Date: | 1-Sep-22 |
| FLOORING SELECTIONS | | | | | | |
| ROOM | CARPET/UNDERPAD OR HARDWOOD | | | LEVEL | STD/UPG # | |
| MAIN FLOOR HALLWAY | Smoky Grey - Lauzon Essential Collection Tradition Grade Matte Engineered expert Red Oak 3-1/8" | | | UPG | 14 | |
| DINING ROOM | Smoky Grey - Lauzon Essential Collection Tradition Grade Matte Engineered expert Red Oak 3-1/8" | | | UPG | 14 | |
| FLEX ROOM | / | | | / | / | |
| FAMILY ROOM | Beaulieu Spartacus A4531 Overcast 87354 + STD Underpad | | | STD, STD | STD, STD | |
| GREAT ROOM | Smoky Grey - Lauzon Essential Collection Tradition Grade Matte Engineered expert Red Oak 3-1/8" | | | UPG | 14 | |
| DEN/HOME OFFICE | / | | | / | / | |
| REAR HALLWAY | / | | | / | / | |
| KITCHEN | / | | | / | / | |
| BREAKFAST AREA/DINETTE | / | | | / | / | |
| MAIN STAIRS TO BEDROOMS | Red Oak stained SB 200 | | | UPG | 6 | |
| UPPER HALLWAY | Smoky Grey - Lauzon Essential Collection Tradition Grade Matte Engineered expert Red Oak 3-1/8" | | | UPG | 14 | |
| BEDROOM # 2 | Beaulieu Spartacus A4531 Overcast 87354 + STD Underpad | | | STD, STD | STD, STD | |
| BEDROOM # 3 | Beaulieu Spartacus A4531 Overcast 87354 + STD Underpad | | | STD, STD | STD, STD | |
| BEDROOM # 4 | / | | | / | / | |
| MASTER BEDROOM | Beaulieu Spartacus A4531 Overcast 87354 + STD Underpad | | | STD, STD | STD, STD | |
| MASTER BEDROOM WALK-IN CLOSET | Beaulieu Spartacus A4531 Overcast 87354 + STD Underpad | | | STD, STD | STD, STD | |
| STAIRS TO BASEMENT | Beaulieu Spartacus A4531 Overcast 87354 + STD Underpad | | | STD, STD | STD, STD | |
| FINISHED BASEMENT RECREATION ROOM | / | | | / | / | |

Purchaser's Signature(s) :

DocuSigned by:

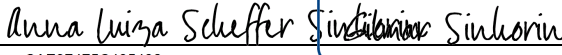

CAE37475C485432

Purchaser's Signature(s) :

DocuSigned by:

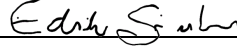

B9736C05554C4CC...

Approved By :

DocuSigned by:

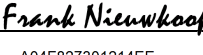

A04F827301214EE...

Date:

December 3, 2021

Date:

December 3, 2021

Date:

December 3, 2021

Subject to change by Valecraft Homes in the event of unavailability of materials.
Prices, terms and specifications are subject to change without notice E/O.E
K:\Sales\Sales Legal Docs\Site - Place-St Thomas\PST PH6 - Towns\Block D/D20 - Anna Gilmar & Edi

| | | | | | | |
|--|--------------------------------|--|----------------|-------------------------------------|---------------|------------|
|  | SINGLES AND TOWNS COLOUR CHART | | | | | |
| | Community: | Place St. Thomas 6 | Reg'd Plan #: | 50M-352 | Sales Rep: | A. Bowman |
| | Lot No: | D20 - Phase 6 | Civic Address: | 739 Namur Street, Embrun ON K0A 1W0 | | |
| | Purchaser(s): | Anna Luiza Scheffer Sinhoro | | | Model Name/#: | Green #140 |
| | Purchaser(s): | Gilmar Sinhoro & Edileia Sinhoro | | | Closing Date: | 1-Sep-22 |
| PLUMBING FIXTURES | | | | | | |
| ROOM | FIXTURE | STYLE | | FINISH | STD/UPG# | |
| KITCHEN | SINK | Reginox Kitchen Sink undermount double bowl ND1831UA/9 | | Stainless Steel | 16, 13 | |
| | FAUCET | Delta Marley Kitchen Faucet Single Handle Pull-Down 986LF-AR | | Arctic Stainless | 24, 13 | |
| MAIN BATHROOM | SINK | Standard | | White | STD | |
| | VANITY FAUCET | Standard | | Chrome | STD | |
| | WATER CLOSET | Standard | | White | STD | |
| | TUB/SHOWER | Standard | | White | STD | |
| | TUB/SHOWER FAUCET | Standard | | Chrome | STD | |
| ENSUITE BATHROOM | SINK(S) | Standard | | White | STD, 10 | |
| | VANITY FAUCET(S) | Standard | | Chrome | STD, 10 | |
| | WATER CLOSET | Standard | | White | STD, 10 | |
| | SHOWER | Standard | | White / Clear Glass/ Chrome | STD, 10 | |
| | SHOWER FAUCET | Standard | | Chrome | STD, 10 | |
| | BATHTUB | / | | / | / | |
| | BATHTUB FAUCET | / | | / | / | |
| POWDER ROOM | PEDESTAL | Standard | | White | STD | |
| | SINK FAUCET | Standard | | Chrome | STD | |
| | WATER CLOSET | Standard | | White | STD | |
| BASEMENT/OTHER BATHROOM | SINK | / | | / | / | |
| | VANITY FAUCET | / | | / | / | |
| | WATER CLOSET | / | | / | / | |
| | TUB/SHOWER | / | | / | / | |
| | TUB/SHOWER FAUCET | / | | / | / | |
| NOTE: All fixtures are white as standard | | | | | | |

Purchaser's Signature(s) :

DocuSigned by:

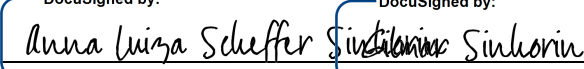

CAE37475C485432

Purchaser's Signature(s) :

DocuSigned by:

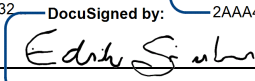

B9736C05554C4CC...

Approved By :

DocuSigned by:



A04F827301214EE...

Date:

December 3, 2021

Date:

December 3, 2021

Date:

December 3, 2021

Subject to change by Valecraft Homes in the event of unavailability of materials.
Prices, terms and specifications are subject to change without notice E/O.E
K:\Sales\Sales Legal Docs\Site - Place-St Thomas\PST PH6 - Towns\Block D\D20 - Anna Gilmar & Edi



Valecraft Homes Décor Disclaimers

Lot#: D20 Model:140 THE GREEN in Place St. Thomas - Valecraft Homes (2019) Limited

PURCHASERS: Anna Luiza Scheffer Sinhorin and Gilmar Sinhorin & Edileia Sinhorin

TEL:

Through years of doing business, we at Valecraft Homes have encountered issues beyond our control. The following disclaimers apply to all instances of Schedule B1A and 680 forms and all Colour Chart forms.

HOUSE EXTERIORS

The Vendor has the right to exercise full architectural control over exterior finishes and as such, the Vendor shall have final approval of all colour selections. This includes but is not limited to additional brick to external side yard walls to enhance the streetscape and/or to comply to municipal agreements.

Variations in subcontractors across different sites and varying site conditions may result in house exteriors that differ from the artist renderings. The Builder cannot be responsible for results which differ from the artists renderings of elevations.

ADDITIONAL WINDOWS

Additional windows to side elevations are subject to limiting distance as per Current Ontario Building Code and Municipal Zoning.

MULTI-MEDIA

The Purchaser understands that all Multi Media locations are approximate and vary from chosen locations.

IN-WALL CONDUIT FOR AUDIO/VIDEO CABLES

The Purchaser acknowledges and accepts that due to the variation in framing requirements in different parts of the Purchaser's home, conduit lengths and routing can vary. In virtually all instances of ground floor installation (i.e. above a fireplace), conduit will first travel down into the basement below the floor joists, over to the termination point and back up into the main floor. As a result, it is best to measure the length of the conduit after occupancy with a "pull wire" before purchasing The Purchaser's cables. For above fireplace installations, the conduit wall plate will be installed approximately 10" above the Fireplace Mantle, unless otherwise specified in the Client Upgrades.

PLANS

Plans are subject to change without notice. Actual usable floor space may vary from the stated floor area. Layout for the services, kitchen, furnace, HWT and laundry tub may vary from plan. Vertical and horizontal bulkhead, which are not shown on plan, may be required for plumbing and heating runs. E.& O.E.

For townhomes, Purchasers Agree to sign an exterior block plan layout when available. Purchaser(s) acknowledge that rooflines may be altered at this time from the brochure due to block assembly.

INVENTORY AND MODEL HOMES:

Purchaser(s) Acknowledge And Accept That All Interior Colours And Wiring Have Been Selected And Installed By The Vendor And Will Remain As Installed. (Ie: Cabinetry, Flooring And Paint Colours But Not Limited To.)

SELECTIONS AND APPOINTMENTS:

All colour and material selections are to be made from Vendor's standard samples unless otherwise paid for as an upgrade.

In the event the work on the house has progressed beyond the point where the items covered by these invoices cannot be installed without entailing any unusual expense, then this order is to be cancelled and any deposit paid in connection with the same is to be refunded to the Purchaser.

The vendor will undertake to incorporate the work covered by the sales extra in the construction of the house but will not be liable to the Purchaser in any way, if for any reason the work covered by the extra is not carried out. In that event, any monies paid in connection with the same shall be returned to the Purchaser.

DS DS DS
[Signature] [Signature] [Signature]



Valecraft Homes Décor Disclaimers

Lot#: D20 Model:140 THE GREEN in Place St. Thomas - Valecraft Homes (2019) Limited

PURCHASERS: Anna Luiza Scheffer Sinhorin and Gilmar Sinhorin & Edileia Sinhorin

TEL:

It is understood and agreed that if for any reason whatsoever the transaction of Purchase and Sale is not completed, the total cost of extras ordered are not refundable to the Purchaser(s). Extras or changes will not be processed unless signed by the Vendor. These extras may not be amended without the written consent of Valecraft Homes.

The Purchaser(s) acknowledge and accept that failure to finalize the structural or colour selections by their cut-off date may result in a delay in construction and the builder has the right to extend the closing date. Due to failure to complete the above-mentioned selections and at no fault of us, the builder reserves the right to hold The Purchaser responsible for a delayed closing, including charging extra administration cost and interest on the balance due on closing.

ADMINISTRATION FEES

Purchaser(s) Acknowledge That An Administration Fee Will Be Charged For All Change Orders Received Later Than 14 Days After Firm Up. No estimates or orders will be accepted once construction has commenced.

Should a refund be requested on any extras purchased, an 80% reimbursement of the purchase price will be given. (a \$50.00 minimum charge and a maximum \$250.00 charge will apply)

Prices and specifications which do not form part of this Agreement are subject to change without notice at the sole discretion of the vendor. Should a change in price occur, Valecraft Homes reserves the right to request from the Purchaser an adjustment of the price or a refund limited to that item.

The Purchaser acknowledges and accepts that ANY changes made to upgrades after signing the 680's are subject to a minimum administration fee of \$150. PLUS a 10% holdback fee.

Purchasers are aware that any request to add a percentage of upgrades from the 680's will be processed only after the builder receives approval letter from the bank.

GENERAL:

The Purchaser understands that all decorator items: furnishings, appliances, draperies, painted colour walls, floors, wallpaper, panelling, alarm system, central air conditioning and eavestroughing found inside the model homes are for display purposes only and do not constitute standard items in the purchase price. Service location of hot water tanks and furnaces, basement wall height, specifications and material finishes may vary from model homes/plans.

The number of steps required at entrances into the home and the garage entrance may vary from the model home/plans depending on individual lot grading requirements. Due to these steps, exterior railings may be required. Purchaser(s) acknowledge the requirement to install an approximate 3' x 3' landing with stairs at the garage entrance to the house as a result of the 2006 Building Code Requirement OBC 9.8.6.2. if 3 or more risers are required as a result of grading.

Basement window wells may or may not be required depending upon individual lot grading requirements.

Zoning bylaws specify maximum driveway widths which are based upon frontages. A tapering of The Purchaser's driveway may be required depending upon the frontage and specifically if the frontage is less than average as in the case of a pie-shaped lot.

The grading and drainage of The Purchaser's lot has been designed and engineered to ensure that surface water is directed away from The Purchaser's home and into swales. These swales run at the side and rear of The Purchaser's property lines. Swales generally have more aggressive slopes relative to the general lot and will always occupy a portion of the useable space of The Purchaser's lot to serve their function properly.

Purchaser(s) acknowledge that kitchen and bathroom ceramic wall border and or decorator insert tiles selected by the Purchaser(s) are installed at the discretion of the installation contractor unless specified otherwise by the Purchaser(s).

STAIRCASE VS FLOORING
WOOD SPECIES DIFFERENCE

The Purchaser acknowledges and accepts that the wood species of the staircase and flooring chosen do not match. This difference might result in an undesirable colour variance. The Purchaser acknowledges and accepts that though the flooring is of the same species as the staircase the difference in product finishing may result in a stain colour variance. The Purchaser agrees that the vendor is to be exempt from any and all claims by the Purchaser regarding this colour variance.

DS DS DS
[Signature] [Signature] [Signature]



Valecraft Homes Décor Disclaimers

Lot#: D20 Model:140 THE GREEN in Place St. Thomas - Valecraft Homes (2019) Limited

PURCHASERS: Anna Luiza Scheffer Sinhorin and Gilmar Sinhorin & Edileia Sinhorin

TEL:

RAILINGS

All railings, spindles, posts, nosing’s and stairs come from solid wood and veneered wood materials sourced from multiple locations and suppliers. As such there will be variations in grains and shades between the various natural components beyond our control. Due to this variance in material, all components will stain with colour or natural finish differently. Iron spindles are wrought in nature and depending on the manufacturing process will have differences from spindle to spindle which is normal. Also the finish of the iron spindles is of a powder coated nature. This process can produce minor colour variations or tones. Furthermore, the assembly of the metal spindles can develop a natural rattle over time from vibration in the railing. Minor rattling is normal and is a part of the wrought iron spindle assembly.

FIREPLACE MANTLE

Due To Extremely High Heat Temperatures Exiting The Top Vent Of The Fireplace And The Potential For Damages To Heat Sensitive Electronics And/OR Wall Décor Installed Above The Fireplace, The Purchaser(s) Acknowledge(s) That The Builder Recommends Installing A Fireplace Fan Kit As well As Maintaining The Mantle Installed Above The Fireplace.

STAIN COLOURS

Due to the many variables that can affect the outcome of a stain colour on wood, staircases, railings, and fireplace mantles, the colour may not be identical to samples. Factors such as density, age, humidity, air temperature, and the uniqueness of each piece of wood can result in wide variations in darkness or lightness. The builder will make every attempt to come as close to the sample as possible, but cannot be responsible for results which differ from the samples. Stain on pre-finished hardwood floors will not be an exact match to the stain colours available on stairs, spindles and rails. The Purchaser is to choose from the builder’s stain samples for these areas to their satisfaction.

APPLIANCE SPECIFICATIONS

All appliance openings are set to the builder's standard openings. Please advise the Sales Representative at time of the structural appointment if custom sizing of cabinets is required for any built - in appliances. The Purchaser is responsible for costs and fees associated with changes to pre-manufactured kitchens made subsequent to colour appointments.

The Purchaser acknowledges and accepts that in order to accommodate upgraded appliances, all appliance specifications should be provided at the time of their structural appointment. Should this not occur they must be provided to the Décor Center within one (1) week of completion of structural chart. Failure to do so, may result in the need to revert to the standard appliance openings or in a delay in construction of The Purchaser’s dwelling, as a cost of \$150 to re-open The Purchaser’s structural file should changes be required. As a result, the builder may be forced to extend the closing of The Purchaser’s transaction. Due to failure to complete the above-mentioned selections and at no fault of our own, the builder reserves the right to hold The Purchaser responsible for this delayed closing, including charging extra administration cost and interest on the balance due on closing.

Purchaser(s) acknowledge that High Efficiency Washing machines have the potential to create vibrations due to the tub spinning at very high speeds.

Purchasers Accept Standard Appliance Openings (unless otherwise specified):
Fridge - 33"W x 70.75" High Approx.
Range - 30-1/2"D x 31-1/2"W Approx.
Dishwasher - 24" W Approx.

GRANITE, MARBLE ENGINEERED SURFACES WAIVER

Due to the natural composition of such materials as Granite and Marble, inherent variations in texture, colour and consistency are to be expected and considered normal. As such, the client is given an opportunity to view the slab prior to installation (W4) and the Purchaser agrees not to hold the Vendor liable for such variations. All countertop surfaces which may have seams, the product pattern & shades can change in these areas.

CERAMIC BACKSPLASHES:

The Purchaser(s) Acknowledge & Accept That The Vendor Does Not Recommend The Deletion Of The Ceramic Kitchen Backsplash & That The Vendor Will Not Be Liable For Any Damage To The Drywall, Paint, Cabinets Or Countertops Resulting From The Deletion Of The Backsplash.

FILE COMPLETION:

Purchaser has attended a Colour appointment at the Decor Centre & has DECLINED any additional upgrades and accepts and acknowledges that there will be no further structural changes/additions/deletions to be made upon signing.

RESELECTIONS

It is not uncommon for flooring, such as tile, to become discontinued prior to its installation. Therefore, it may be necessary to make a reselection of certain materials sometime during the building process. The builder cannot assure The Purchaser that another choice approximating The Purchaser’s selection will be available.

DS
ALSS GS E SS



Valecraft Homes Décor Disclaimers

Lot#: D20 Model:140 THE GREEN in Place St. Thomas - Valecraft Homes (2019) Limited

PURCHASERS: Anna Luiza Scheffer Sinhorin and Gilmar Sinhorin & Edileia Sinhorin

TEL:

GENERAL:

The vendor may substitute materials of equal or greater value without consent.

The Purchaser understands that all decorator items: furnishings, appliances, draperies, painted colour walls, floors, wallpaper, panelling, alarm system, central air conditioning and eavestroughing found inside the model homes are for display purposes only and do not constitute standard items in the purchase price. Service location of hot water tanks and furnaces, basement wall height, specifications and material finishes may vary from model homes/plans.

The Purchaser understands that due to normal manufacturing production, materials which are installed in the home may vary slightly in colour from the vendor's samples and/or model homes.

The wood used in the finishing products of The Purchaser’s home such as wood flooring, cabinetry and railings exhibit natural variations in colour tone, graining pattern and consistency. As no two pieces of wood are identical, these natural variations will create colour variations upon staining thereby making it virtually impossible to achieve true colour consistency.

Any hardwood flooring installed in the Real Property is made of kiln-dried natural material which is subject to natural shrinkage (typically in winter when humidity levels tend to be low) and expansion (typically in summer when humidity levels tend to be high) for which the Purchaser(s) agrees is not the responsibility of the Vendor and agrees that the Vendor shall not be liable in respect of such issues. The Purchaser(s) also acknowledges being advised by the Vendor that ceramic tile rather than hardwood flooring is recommended at entry points to the home due to the possibility of water exposure. The Purchaser(s) is advised that the Ontario Building Code recommends against the installation of wood flooring in kitchens, bathrooms, entrance halls, laundry, and general storage areas (the "Designated Areas"). Wood flooring is water permeable and over time such flooring and sub-flooring beneath it could deteriorate if moisture persists. Should the Purchaser(s) selections for materials for the dwelling include wood flooring in the designated areas, the Purchaser(s) assumes the risks described herein voluntarily.

Purchaser(s) acknowledge that kitchen and bathroom ceramic wall border and or decorator insert tiles selected by the Purchaser(s) are installed at the discretion of the installation contractor unless specified otherwise by the Purchaser(s).

I hereby acknowledge reading and understanding the above copy and will not hold Valecraft Homes responsible for any issues in relation to above.

Purchaser's Signatures

| | | | |
|--|--|------|------------------|
| <div>DocuSigned by:</div> <div>Anna Luiza Scheffer Sinhorin</div> <div>CAE37475C4B568...</div> | <div>DocuSigned by:</div> <div>Gilmar Sinhorin</div> <div>2AAA49C56F834F5...</div> | Date | December 3, 2021 |
| <div>DocuSigned by:</div> <div>Edileia Sinhorin</div> <div>B9736C05554C4CC...</div> | | Date | December 3, 2021 |



CONFIRMATION OF FILE COMPLETION

PROJECT: Place St. Thomas 6 PURCHASER #1: Anna Luiza Scheffer Sinhorin
LOT: D20 PURCHASER #2: Gilmar Sinhorin & Edileia Sinhorin
MODEL: Model: #140 Green Rev FIRM UP DATE: Nov 22, 2021

CLOSING DATE: Sep 1, 2022

I/WE HEREBY CONFIRM THAT ALL OF OUR COLOUR SELECTIONS, MULTI MEDIA & ELECTRICAL SELECTIONS AND ALL UPGRADES (680'S) ARE NOW FULLY COMPLETED:

DocuSigned by:
Anna Luiza Scheffer Sinhorin
CAE37475C485432
PURCHASER'S SIGNATURE

December 3, 2021
DATE

DocuSigned by:
Edileia Sinhorin
B9736C05554C4CC...
PURCHASER'S SIGNATURE

December 3, 2021
DATE

ITEMS THAT MUST BE COMPLETED AND SENT TO HEAD OFFICE:

APS: Nov 8, 2021 INTERIOR COLOURS: Dec 3, 2021
FIRM UP: Nov 22, 2021 EXTERIOR COLOURS (if applicable): N/A
BANK LETTER: Nov 22, 2021 ORBITAL/S&S/KITCHENCRAFT (if applicable): Nov 8, 2021
SOLICITOR INFO: Nov 22, 2021 680 & AMENDMENT: Dec 3, 2021

ALL PAGES SENT FOR INITIALS RETURNED TO HEAD OFFICE:

Sales Consultant's Signature

Dec 3, 2021
Date

Sales Assistant's Signature

Date

Approved by:
Frank Nieuwkoop
A04F827301214EE...

December 3, 2021
Date



| NON STANDARD EXTRAS (680) | | | |
|---|--------|--|----------------------------|
| Place St. Thomas - Phase 6 | | | |
| PURCHASERS: Anna Luiza Scheffer Sinhorin and Gilmar Sinhorin & Edileia Sinhorin | | | Printed: 3-Dec-21 11:57 am |
| LOT NUMBER | PHASE | HOUSE TYPE | CLOSING DATE |
| D20 | 6 | 140 THE GREEN | 1-Sep-22 |
| ITEM | QTY | EXTRA / CHANGE | PRICE |
| 17 | 617 | 1 - KITCHEN - WATER LINE ROUGH - IN TO FRIDGE, DOES NOT INCLUDE CONNECTION | \$285.00 |
| 37855 | | Note: As per floorplan sketch dated December 3, 2021 | Each |
| 18 | 120125 | 1 - KITCHEN - OTR - BASIC - 1.7 C/F MICROWAVE WITH HOOD - UPGRADE TO STAINLESS STEEL | \$75.00 |
| 37821 | | Note: As per floorplan sketch dated December 3, 2021 | Each |
| *19 | 113006 | 1 - KITCHEN - CABINETRY - UPGRADE KITCHEN CABINETRY TO LEVEL 1 | * \$2,138.00 |
| 37795 | | Note: - See item # 8 (Kitchen Layout #1) | Each |
| 20 | | 1 - KITCHEN - DELETE ITEM # 9 (RE: UPC9-2A - BUILDER'S STANDARD CABINETRY - OPTIONAL KITCHEN 1) | -\$470.00 |
| 37864 | | Note: | Each |
| 21 | 114876 | 1 - KITCHEN - CABINETRY - UPC9-2A - LEVEL 1 CABINETRY - OPTIONAL KITCHEN 1. INCLUDES UPGRADE TO 42IN UPPIERS WITH FILLER DETAIL ON UPPER KITCHEN CABINETRY TO STANDARD BULKHEAD | \$626.00 |
| 37866 | | Note: - See item 8 for Optional KitchenLayout 1 and 19 for Upgraded Cabinetry - As per UPC sketch dated December 3, 2021 - Purchaser Acknowledges and accepts that Upper Kitchen cabinetry upgraded wood doors will have center style. | Each |
| 22 | 704 | 2 - - CERAMIC TILE - GROUT COLOR PER COLOUR | \$150.00 |
| 37867 | | Note: | |
| 23 | 162 | 1 - KITCHEN - TILE - WALL - BACKSPLASH - INSTALLATION - BRICK PATTERN - - KITCHEN - . | \$38.00 |
| 37868 | | Note: - See item #15 (bronze level backsplash tile) - As per wall tile installation sketch dated December 3, 2021 | Each |
| 24 | 635 | 1 - KITCHEN - KITCHEN FAUCET - DELTA MARLEY 986LF-AR ARCTIC STAINLESS | \$358.00 |
| 37869 | | Note: - See item #13 (quartz countertop) - See item #16 (kitchen sink) | Each |
| 25 | 102389 | 1 - MAIN BATHROOM - REMOVE 4" BACK SPLASH ON STANDARD LAMINATE COUNTERTOP | \$87.00 |
| 37872 | | Note: -As per floorplan sketch dated December 3, 2021 | Each |
| 26 | 102389 | 1 - ENSUITE BATH - REMOVE 4" BACK SPLASH ON STANDARD LAMINATE COUNTERTOP | \$87.00 |
| 37905 | | Note: As per floorplan sketch dated December 3, 2021 | Each |
| 27 | 115520 | 1 - FOYER - DOOR - INTERIOR - DOUBLE - 24 INCH TO 72 INCH OPENING - FOYER - IN LIEU OF SLIDERS | \$408.00 |
| 37881 | | Note: - As per floorplan sketch dated December 3, 2021 | Each |

PREPARED BY: Adam Bowman
LOCKED BY: Lisa Ballard
PE 1,777-1

DS

FN

Vendor Initials:

DS

ALSS

Purchaser Initials

DS

GS

CONSTRUCTION SCHEDULING APPROVAL

PER: _____

DATE: _____



NON STANDARD EXTRAS (680)

Place St. Thomas - Phase 6

PURCHASERS: Anna Luiza Scheffer Sinhorin and Gilmar Sinhorin & Edileia Sinhorin

Printed: 3-Dec-21 11:57 am

| | | | |
|------------|-------|---------------|--------------|
| LOT NUMBER | PHASE | HOUSE TYPE | CLOSING DATE |
| D20 | 6 | 140 THE GREEN | 1-Sep-22 |

| | | | | |
|------|-----|----------------|-------|--------------|
| ITEM | QTY | EXTRA / CHANGE | PRICE | INTERNAL USE |
|------|-----|----------------|-------|--------------|

| | |
|-----------|------------|
| Sub Total | \$3,782.00 |
| HST | \$0.00 |
| Total | \$3,782.00 |

Payment Summary

Paid By Amount

Total Payment:

PURCHASER:

DocuSigned by:
Anna Luiza Scheffer Sinhorin

03-Dec-21

DATE

CAE37475C485432...

Anna Luiza Scheffer Sinhorin

VENDOR:

DocuSigned by:
Frank Nieuwkoop

December 12, 2021 | 6:09 PM PST

DATE:

A04F827301214FF

PER: Valecraft Homes (2019) Limited

PURCHASER:

DocuSigned by:
Gilmar Sinhorin

03-Dec-21

DATE

B9736C05554C4CC...

Gilmar Sinhorin & Edileia Sinhorin

DocuSigned by:
Edna Sinhorin

December 8, 2021 | 12:00 PM EST

B9736C05554C4CC...

PREPARED BY: Adam Bowman

LOCKED BY: Lisa Ballard

PE 1,777-2

InvoiceSQL.rpt 05may21

CONSTRUCTION SCHEDULING APPROVAL

PER: _____

DATE: _____