



NON STANDARD EXTRAS (680)			
Place St. Thomas - Phase 7			
PURCHASERS: Francis Owens and Wendy Lynn Owens			Printed: 12-Dec-23 1:43 pm

LOT NUMBER	PHASE	HOUSE TYPE	CLOSING DATE
4	7	826 THE BRADLEY 3 BED ELEV B	30-Apr-24

ITEM	QTY	EXTRA / CHANGE	PRICE	INTERNAL USE
142	1	ENSUITE BATH - DELETE ENSUITE BATHROOM SKETCH DATED AUGUST 23, 2023.	\$0.00	Each
42498		Note:		
143	1	ENSUITE BATH - REVISION TO ENSUITE BATHROOM SKETCH. REVISED SWING OF DOOR IN THE ENSUITE BATHROOM SHOWER. SEE ENSUITE SKETCH REV. 02 DATED DECEMBER 12, 2023.	\$0.00	Each
42499		Note: Purchaser acknowledges that the door is subject to hitting the vanity with installation of a right-hand swing on the glass shower door in the ensuite bathroom. Valecraft is not responsible for replacing or repairing the glass shower door or vanity if broken by coming in contact with the bathroom vanity / shower door.		

Sub Total	\$0.00
HST	\$0.00
Total	\$0.00

Payment Summary

Paid By Amount

Total Payment:

PURCHASER: Francis Owens 12-Dec-23 DATE

VENDOR: Frank Nieuwkoop PER: Valecraft Homes (2019) Limited

PURCHASER: Wendy Lynn Owens 12-Dec-23 DATE

DATE: December 12, 2023

PREPARED BY: Adam Bowman

LOCKED BY: Lisa Ballard

PE 2,050-1

InvoiceSQL.rpt 01sept21

CONSTRUCTION SCHEDULING APPROVAL

PER:

DATE:

DECEMBER 12, 2023
(Direction of door swing revised)
ITEM #143

Project: Place St. Thomas 7
Plan No: 50M-361
Lot No: 4 - Phase 7
Model: #826 "B" cust. Rev
Date: December 12, 2023

Purchaser: Francis Owens
Purchaser: Wendy Lynn Owens

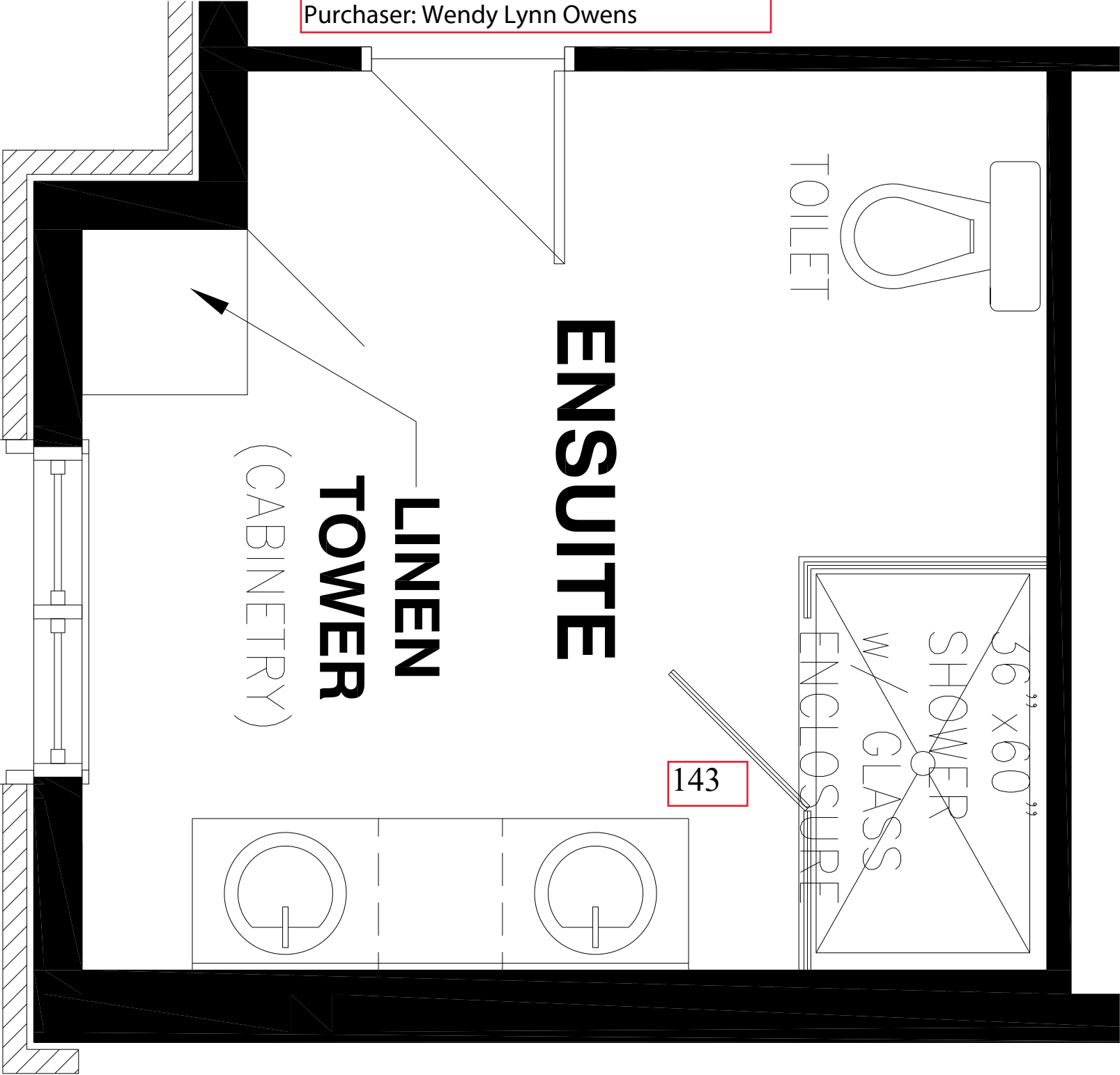

DS
FO

DS
WLO

DS
FN