



Valecraft

Homes (2019) Limited

210-1455 Youville Drive
Ottawa, On K1C 6Z7
Phone: 613-837-1104

Purchase Order PO0003049

Vendor:
S & S BOLTON ELECTRIC INC.
5411 CANOTEK ROAD
OTTAWA, ONTARIO K1J 9M3

Ship To:
Site: PLACE ST. THOMAS PHASE 7
Lot/Unit: BLOCK E20
Model: 120 REVERSED
Civic: 939 COLOGNE STREET

tel: 613-748-0432
fax:
contact:

ORDER DATE	CHG. ORDER DT.	CANCEL DATE	RESPONSIBILITY	VENDOR #	TERMS
Aug 27, 2024			ARIEL	S02	NET 30 DAYS
Comments/Special Instructions: REVISED ITEM #19,20,21,22,23					REFERENCE

JOB/LOT/COST	REFERENCE	Description	QTY ORDERED	UNIT PRICE	EXTENSION
067-E20-680	#01	REFER CONSTR. SUMMARY ITEM #1 BASEMENT OPTIONAL FIREPLACE	1.0000	116.000000	116.00
067-E20-680	#03	REFER CONSTR. SUMMARY ITEM #3 ENSUITE 4PC. BATHROOM	1.0000	100.000000	100.00
067-E20-680	#12	REFER CONSTR. SUMMARY ITEM #12 QUOTE SS6690 DATE JUL 16-24	1.0000	2,140.000000	2,140.00
067-E20-680	#19 ADDED	REFER CONSTR. SUMMARY ITEM #19 POWDER ROOM LIGHT FIXTURE	1.0000	241.000000	241.00
067-E20-680	#20 ADDED	REFER CONSTR. SUMMARY ITEM #20 MAIN BATHROOM LIGHT FIXTURE	1.0000	222.000000	222.00
067-E20-680	#21 ADDED	REFER CONSTR. SUMMARY ITEM #21 ENSUITE BATHRM LIGHT FIXTURE	1.0000	222.000000	222.00
067-E20-680	#22 ADDED	REFER CONSTR. SUMMARY ITEM #22 KITCHEN LIGHT FIXTURE	2.0000	201.000000	402.00
067-E20-680	#23 ADDED	REFER CONSTR. SUMMARY ITEM #23 DINING ROOM LIGHT FIXTURE	1.0000	326.000000	326.00

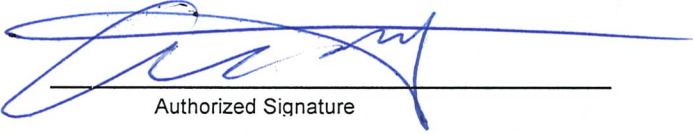
 Authorized Signature	Subtotal	3,769.00
	HST	489.97
	Total Order Value	4,258.97

ORDER TERMS AND CONDITIONS

- 1. INVOICES must bear exact same prices and terms or authorization for changes must be received from our company in writing prior to shipping.
- 2. The right is reserved to cancel all or part of this order if not delivered within the time specified.
- 3. Packing slips must accompany all shipments.
- 4. In the event of interruption of our business in whole or in part by reason of fire, flood, windstorm, earthquake, war, strike, embargo, acts of God, governmental action, or any causes beyond our control, we shall have the option of cancelling undelivered orders in whole or in part.
- 5. Acceptance of this purchase order, or shipment of it will constitute an agreement to all of its specifications as to terms, delivery and prices.
- 6. No deliveries accepted after 4:00 pm or on weekends.

WHITE - ORIGINAL CANARY - ACCOUNTS PAYABLE PINK - DEPARTMENT



ELECTRIC - ÉLECTRIQUE

Tel: (613) 748-0432
Fax: (613) 748-0355

A Division of the S&S Bolton Group
www.ssbolton.com

Estimate No#: SS6690

Builder Copy

Customer:

PST PH7 E20 - Spec

Builder: VALECRAFT HOMES (2019) LTD.
Project: PST Towns Ph7
Lot: PST PH7 Lot E20
Closing Date: -

Salesperson: Kyle Takman
Date: 07/16/2024

Location	Qty	Product / Installation Details	Plan Code	Unit Price	Customer Total	Builder Total
Family Room	1.00	15 Amp Standard Plug Add 15 AMP plug approx 60 inches from floor beside conduit	A	175.00 \$	175.00 \$	93.00 \$
Kitchen	1.00	Standard Light Outlet (Keyless) Add (1) Standard Light Outlet (Keyless) on existing switch	B	160.00 \$	160.00 \$	85.00 \$
Kitchen	4.00	4" LED slim Pot Light White (AFR4C-0930-WH) Add 4 LED Halo pot lights (AFR4-0930-WH) on added switch	E	245.00 \$	980.00 \$	520.00 \$
Kitchen	1.00	Misc. Product Relocate Standard Fixture and leave as keyless	B	\$	0.00 \$	0.00 \$
Great Room	6.00	4" LED slim Pot Light White (AFR4C-0930-WH) Add 6 LED Halo pot lights (AFR4-0930-WH) - using control plug switch (sever control to plug)	C	245.00 \$	1,470.00 \$	780.00 \$
Kitchen	1.00	Single Pole Switch Switch for added pot lights	E	136.00 \$	136.00 \$	72.00 \$
Kitchen	2.00	Misc. Product USB Charger Receptacle in kitchen and master bedroom (standard items)	D	\$	0.00 \$	0.00 \$
Ensuite Bath	1.00	4" LED slim Pot Light White (AFR4C-0930-WH) Add 1 LED Halo potlight (AFR4-0930-WH) on added switch	F	245.00 \$	245.00 \$	130.00 \$
Ensuite Bath	1.00	Single Pole Switch Switch for added pot lights	F	136.00 \$	136.00 \$	72.00 \$
Main Bath	1.00	4" LED slim Pot Light White (AFR4C-0930-WH) Add 1 LED Halo potlight (AFR4-0930-WH) on added switch	G	245.00 \$	245.00 \$	130.00 \$
Main Bath	1.00	Single Pole Switch Switch for added pot lights	G	136.00 \$	136.00 \$	72.00 \$

Phone: (613) 748-0432 | Fax: (613) 748-0355 | Email: info@sandselectric.ca | Website: www.sandselectric.ca

5411 Canotek Road, Ottawa, Ontario K1J 9M3

Printed By: Kyle Takman - Page: 2



ELECTRIC - ÉLECTRIQUE

Tel: (613) 748-0432
Fax: (613) 748-0355

A Division of the S&S Bolton Group
www.ssbolton.com

Location	Qty	Product / Installation Details	Plan Code	Unit Price	Customer Total	Builder Total
Hall	3.00	4" LED slim Pot Light White (AFR4C-0930-WH) Delete standard fixtures and add 3 LED Halo potlight (AFR4-0930-WH) on existing switch	H	245.00 \$	735.00 \$	390.00 \$
Hall	3.00	Misc. Product Credit for deleted Fixtures	H	-128.00 \$	-384.00 \$	-204.00 \$

*** Total price does not include any applicable taxes.

Customer Total: 4,034.00 \$

Builder Total: 2,140.00 \$

Customer Signature

Date

RECEIVED
AUG 23 2014

Model Name: The Huntley Model #: 120 Plan #: 50M-361
Site: Place St. Thomas 7 Purchaser: _____
Lot: PST PH7 E20
Date: July 16, 2024 Purchaser: _____

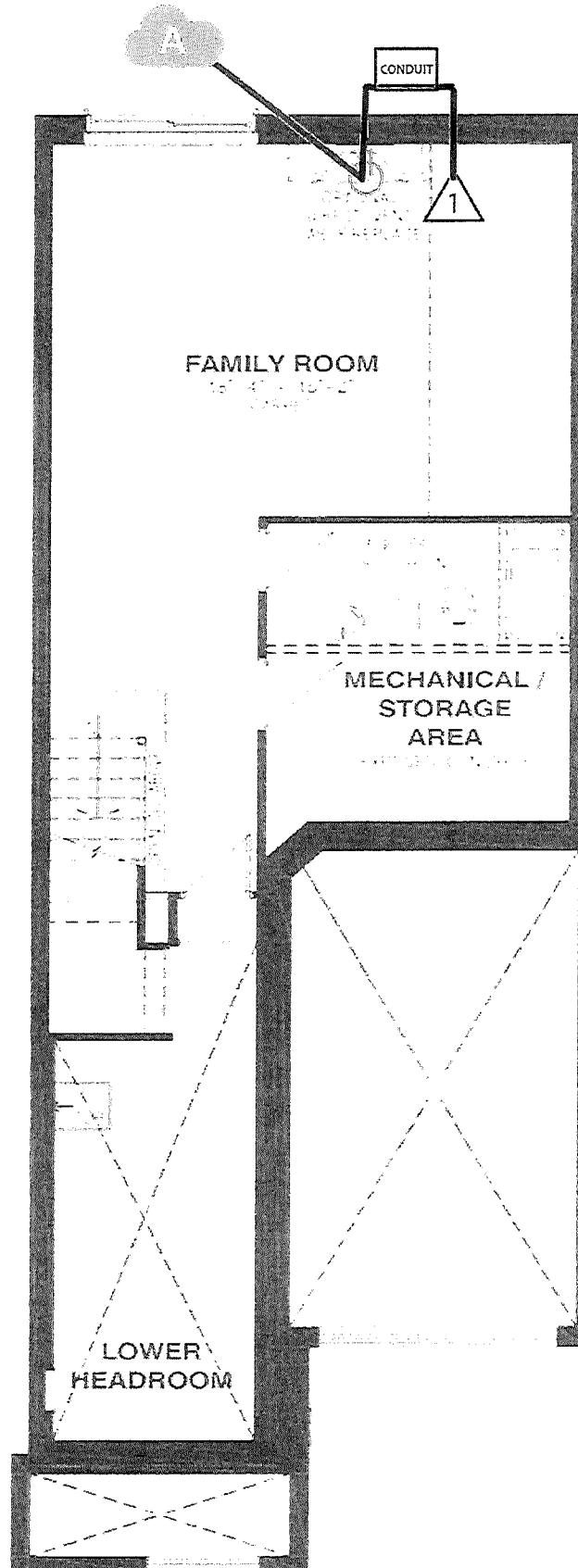

BASEMENT FLOOR

AB-23-213

Model Name: The Huntley

Model #: 120

Plan #: 50M-361

Site: Place St. Thomas 7

Purchaser: _____

Lot: PST PH7 E20

Date: July 16, 2024

Purchaser: _____

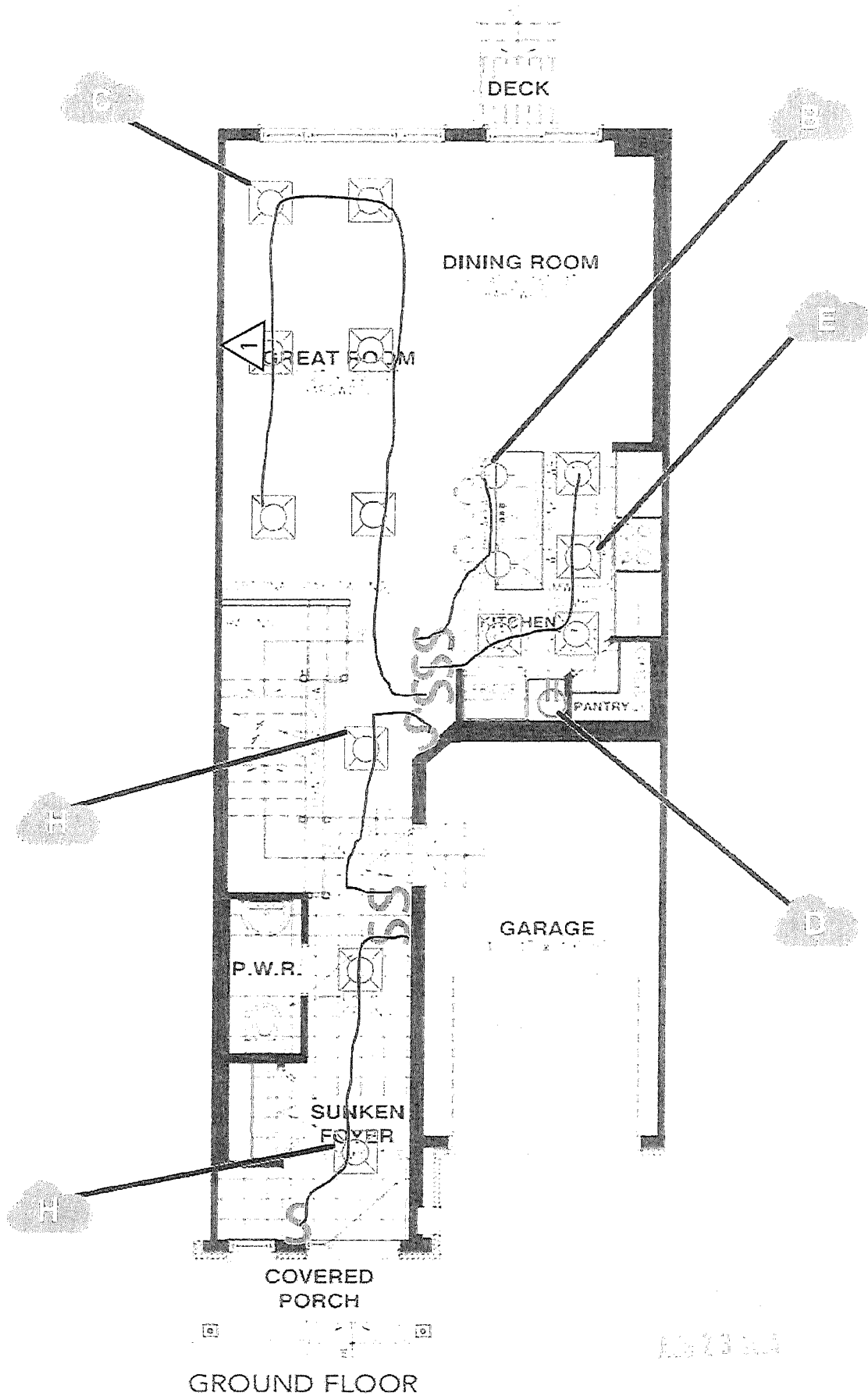

Model Name: The Huntley

Model #: 120

Plan #: 50M-361

Site: Place St. Thomas 7

Purchaser: _____

Lot: PST PH7 E20

Date: July 16, 2024

Purchaser: _____

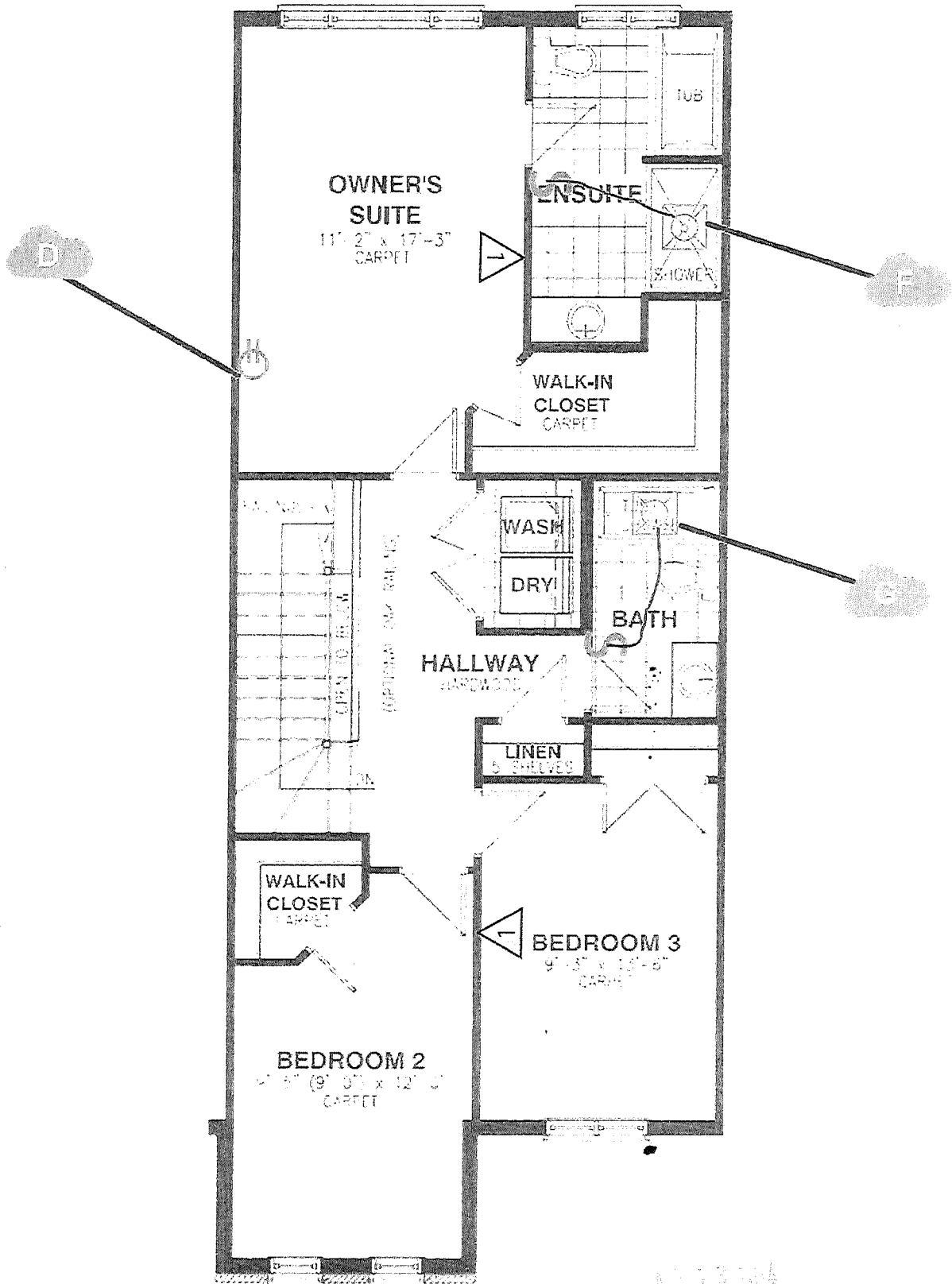

SECOND FLOOR