

ID-30RP



FEATURES

- Rigorously tested to ensure decades of use
- Exceptional support from Madison, WI-based Customer Care team
- Ready to be fitted with custom panels and handles to blend with cabinetry
- Soft-on LED lights for varying degrees of brightness
- Smart-touch controls for streamlined access to more settings
- Soft-close doors and drawers
- Crispers and deli drawers in low-temp, high-humidity zones for optimum freshness
- Air purification system fights spoilage, odors

ACCESSORIES

- Air Purification Cartridge
- Crisper Cover
- Dual Installation Kit
- Egg Container
- Reduced Toekick Divider
- Stainless Steel 30" Drawer Panels with Pro Handles
- Stainless Steel 30" Drawer Panels with Tubular Handles
- Stainless Steel Pro Handles
- Stainless Steel Tubular Handles
- Stainless Steel Dual Installation Kickplates

Accessories are available through an authorized dealer.
For local dealer information, visit subzero-wolf.com/locator.

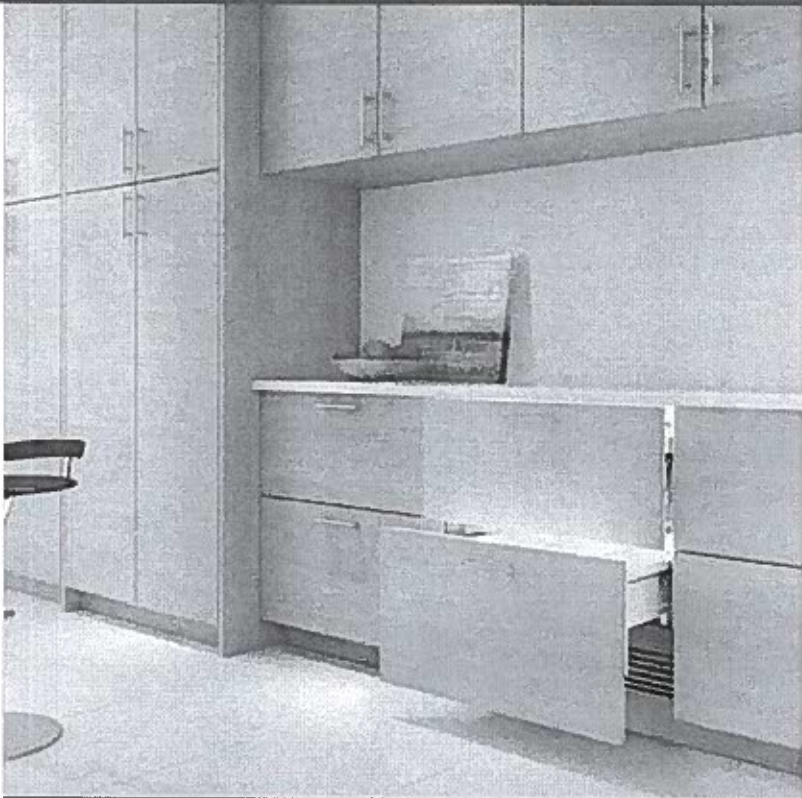

HANDLE ACCESSORIES

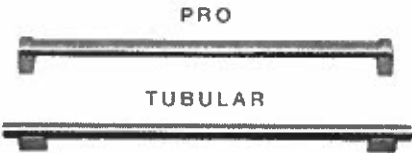

PRODUCT DETAILS

REFRIGERATOR

- Adjustable drawer dividers
- 1 Sliding Crisper Cover

Lot 68 
Dec. 13, 22

PRODUCT SPECIFICATIONS

Model	ID-30RP
Dimensions	30"W x 34 1/2"H x 24"D
Drawer Clearance	18 3/8"
Weight	210 in.
Refrigerator Capacity	5.3 cu. ft.
Electrical Supply	115 VAC, 60 Hz
Electrical Service	15 amp dedicated circuit
Receptacle	3-prong grounding-type

ELECTRICAL

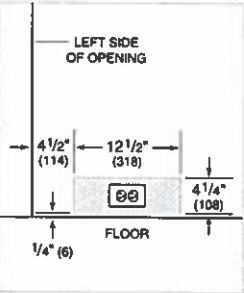

PANEL SPECIFICATIONS For complete panels specifications including width/height, weight requirements and thickness requirements visit subzero-wolf.com/reveal.

NOTE: Dimensions in parenthesis are in millimeters unless otherwise specified

INTERIOR VIEW

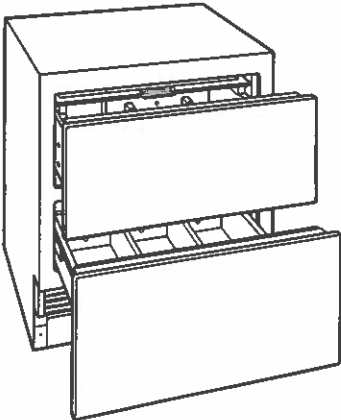

This illustration is intended for interior reference only and may not represent the exterior of the model being specified.

DIMENSIONS

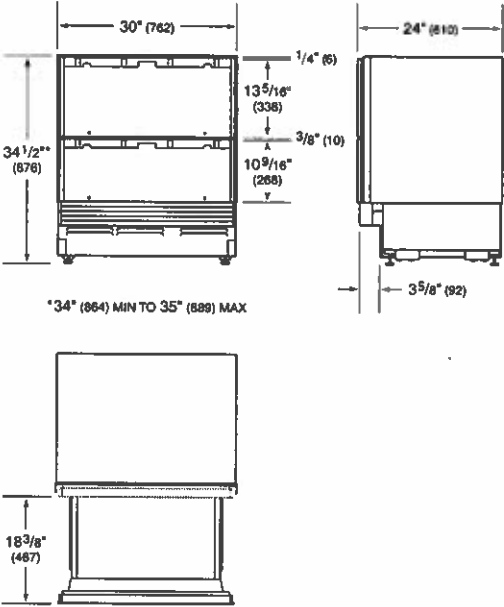

STANDARD INSTALLATION

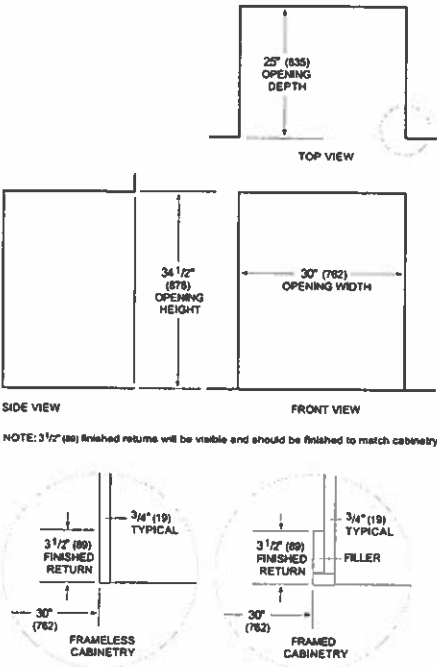

NOTE: 3/16" (80) finished returns will be visible and should be finished to match cabinetry

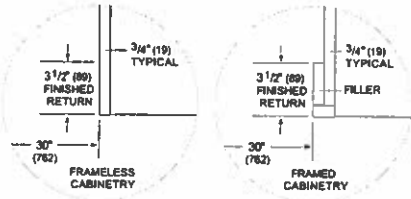

Lot 68 77

PRO3650G



FEATURES

- Advanced Air Purification Technology
- Install directly within surrounding cabinetry for built-in, or add accessory panels for freestanding
- Makes an iconic stainless-steel statement, inside and out
- Dual refrigeration technology preserves refrigerated foods with cool, moist air and frozen foods with frigid, dry air
- Easy access to food with full-extension slide-out glass shelf with adjustable gates
- Locks in temperature and humidity with soft-close door hinge and magnetic seal on doors and drawers
- Controls temperature within one degree of setpoint via intuitive exterior touch control panel
- Automatic ice maker with advanced water filtration system
- Control brightness with soft-on LED lighting that fully illuminates the cavity, making food more visible and less likely to hide
- Protects food from spoilage through triple-pane, UV-resistant glass door

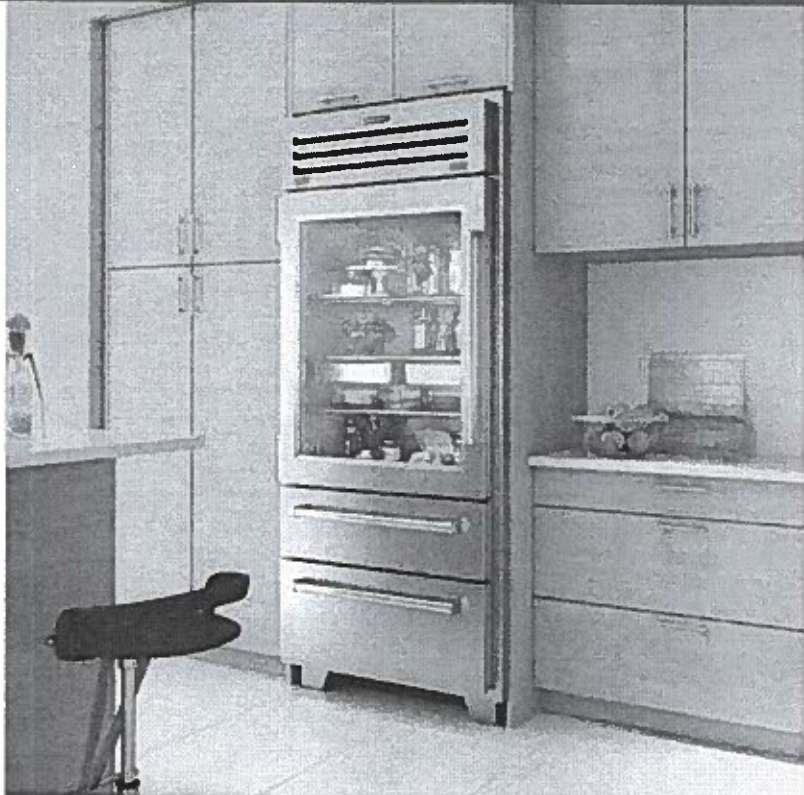

PRODUCT DETAILS

REFRIGERATOR

- LED refrigerator and freezer lights
- 4 glass refrigerator shelves (3 adjustable; 1 full-extension slide-out)
- 1 high-humidity crisper drawer with adjustable dividers
- 2 stainless-steel slide-out bins
- Air purification system

FREEZER

- 1 full-extension roll-out freezer drawer with automatic ice maker and removable ice container

Lot 68 

Dec 13, 22

PRODUCT SPECIFICATIONS

Model	PRO3650G
Dimensions	36"W x 84"H x 24"D
Door Clearance	37 3/8"
Drawer Clearance	26"
Weight	650 lbs
Refrigerator Capacity	18.4 cu. ft.
Freezer Capacity	4.3 cu. ft.
Electrical Supply	115 VAC, 60 Hz
Electrical Service	15 amp dedicated circuit
Plumbing Supply	1/4" OD copper, braided stainless steel or PEX tubing
Plumbing Pressure	35 - 120 psi

ELECTRICAL

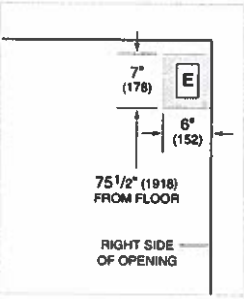

PLUMBING

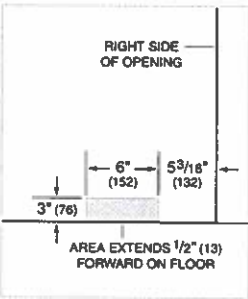

NOTE: Dimensions in parenthesis are in millimeters unless otherwise specified

INTERIOR VIEW

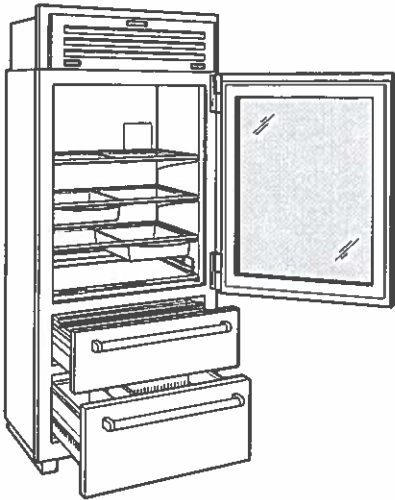

This illustration is intended for interior reference only and may not represent the exterior of the model being specified.

DIMENSIONS

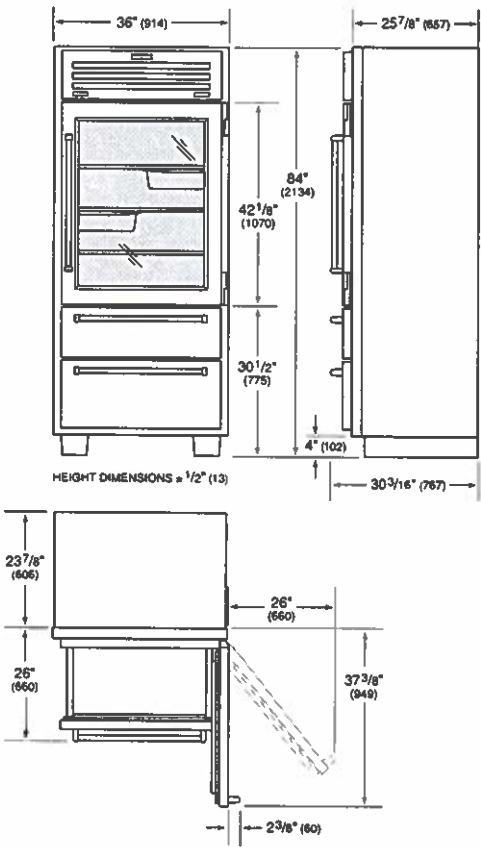

STANDARD INSTALLATION

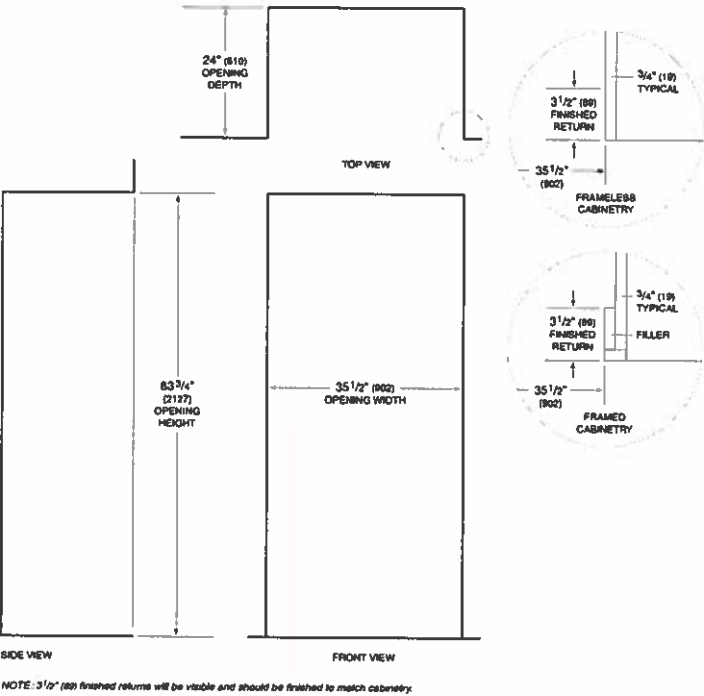

Lot 68



DW2450WS

FEATURES

- Rigorously tested in our U.S. manufacturing facilities to ensure decades of use
- Exceptional support from Madison, WI-based Customer Care team
- Custom wash and dry options and three separate spray arms to ensure optimal cleaning performance
- Height-adjustable middle rack and fold-down tines adjust to any size or combination of dishes
- Accepts cabinet panels for a custom look or stainless panels and handles to match Sub-Zero and Wolf products
- Near-silent operation never interrupts the conversation
- Easy-to-use, touch controls and display are hidden to maintain clean lines and a status floor light indicates cycle status
- Built-in water softener to reduce hard water spots on dishes and ensure optimal performance

ACCESSORIES

- 24" Door Panels
- 24" Door Panels
- 4" Stainless Kickplate - 24" Opening
- 4" Stainless Kickplate - 60cm Opening
- 60cm Door Panels
- 60cm Door Panels
- Pro Handle
- Tubular Handle

Accessories are available through an authorized dealer. For local dealer information, visit subzero-wolf.com/locator.



HANDLE ACCESSORIES

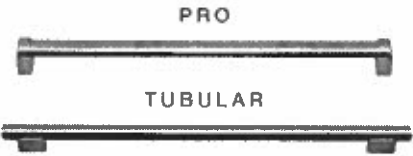

Lot 68 
Dec. 13, 22

PRODUCT SPECIFICATIONS

Model	DW2450WS
Dimensions	23 5/8"W x 34 1/2"H x 23 1/4"D
Door Clearance	26 3/4"
Electrical Supply	115 VAC, 60 Hz
Electrical Service	15 amp dedicated circuit
Receptacle	3-prong grounding-type
Cord Length	3'
Water Connection	5' braided tubing with 3/8" female compression fitting
Drain Connection	5' (1.5 m) corrugated tubing
Plumbing Pressure	30–140 psi

ELECTRICAL

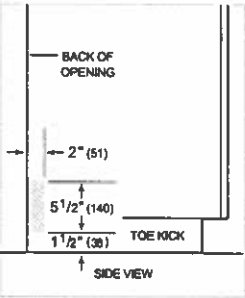

PLUMBING

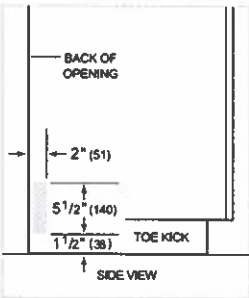

PANEL SPECIFICATIONS For complete panels specifications including width/height, weight requirements and thickness requirements visit subzero-wolf.com/reveal.

INTERIOR VIEW

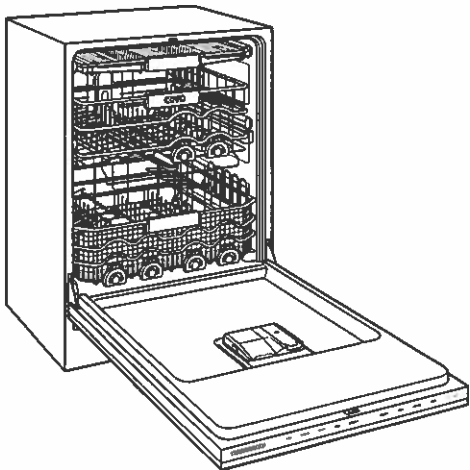

This illustration is intended for interior reference only and may not represent the exterior of the model being specified.

DIMENSIONS

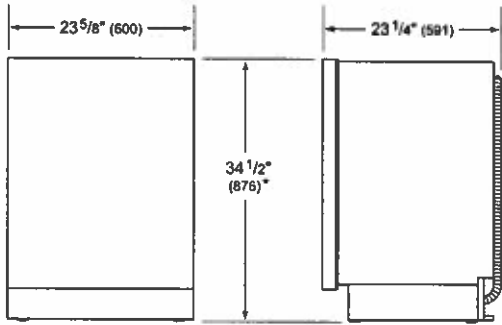

*34" (864) MIN TO 34 5/8" (880) MAX

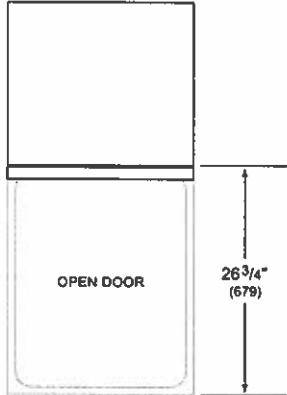

STANDARD INSTALLATION 24" INSTALLATION

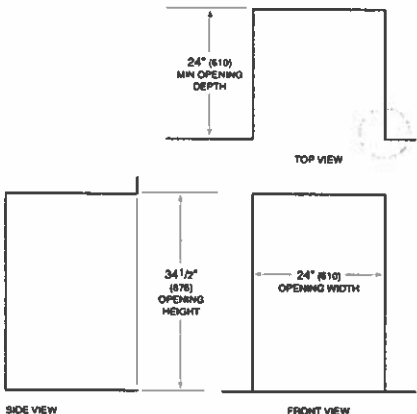

NOTE: 3/2" (89) finished returns will be visible and should be finished to match cabinetry.

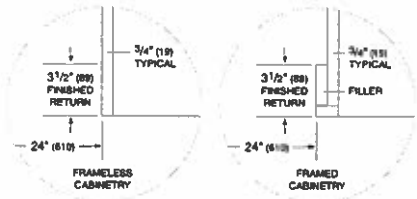

Lot 68

K

36" GAS RANGE - 6 BURNERS

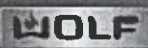

GR366



FEATURES

- Rigorously tested for decades of use
- Exceptional support from our Customer Care team in Madison
- Dual-stacked, sealed burners for higher highs, lower lows
- Heavy-gauge stainless steel
- Signature red infinite control knobs
- Continuous cast-iron grates for easy movement of pots and pans
- Spark ignition system re-ignites if flame goes out
- Adjustable legs for stability, plus rear casters
- Convection oven for faster, more consistent cooking
- Infrared broiler inside oven sears quickly and evenly
- 6 dual-stacked, sealed burners

ACCESSORIES

- 2-Burner Wok Grate
- Bake Stone Kit
- Filler Trim
- Front Leg Covers
- Full-Extension Ball Bearing Rack
- S-Grates
- Stainless steel, brass or chrome bezels
- High altitude conversion kit
- Signature red, black or stainless steel control knobs
- 5" and 10" stainless steel risers, and 20" riser with shelf

Accessories available through an authorized dealer.
For local dealer information, visit subzero-wolf.com/locator



KNOB OPTIONS



TOP CONFIGURATION

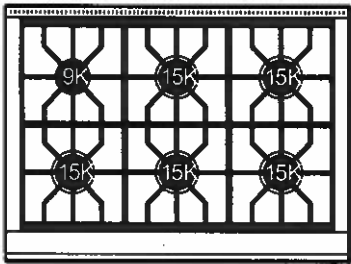

RANGETOP SPECIFICATIONS

- 1 - 9,200 Btu Burner
- 5 - 15,000 Btu Burners

Specifications are subject to change without notice. This information was generated on December 13, 2022. Verify specifications prior to finalizing your cabinetry/enclosures.

Lot 68 
Dec. 13, 22

PRODUCT SPECIFICATIONS

Model	GR366
Dimensions	35 7/8"W x 37"H x 28 3/8"D
Oven 1 Interior Dimensions	30"W x 18 5/8"H x 17"D
Oven 1 Usable Capacity	3.7 cu. ft.
Oven 1 Overall Capacity	5.5 cu. ft.
Door Clearance	19 1/2"
Weight	470 lbs
Electrical Supply	110/120 VAC, 50/60 Hz
Electrical Service	15 amp dedicated circuit
Gas Supply	3/4" ID line
Gas Inlet	1/2" NPT female
Receptacle	3-prong grounding-type

ELECTRICAL

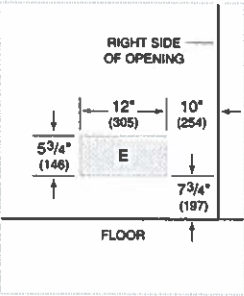

GAS

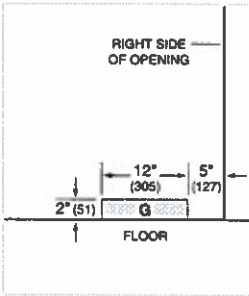

NOTE: Dimensions in parenthesis are in millimeters unless otherwise specified

DIMENSIONS

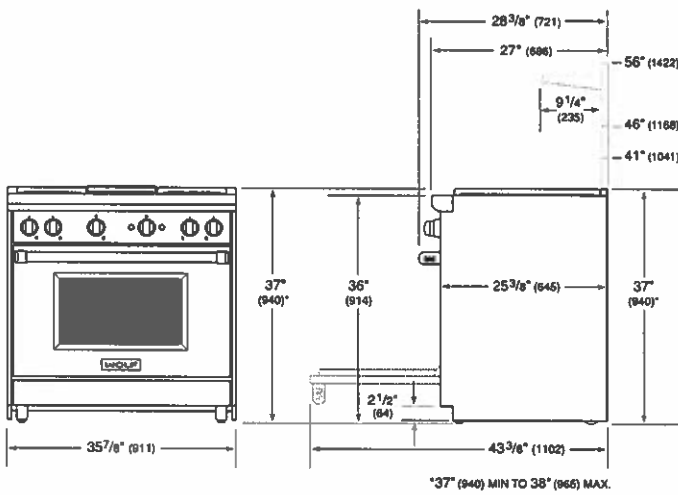

STANDARD INSTALLATION

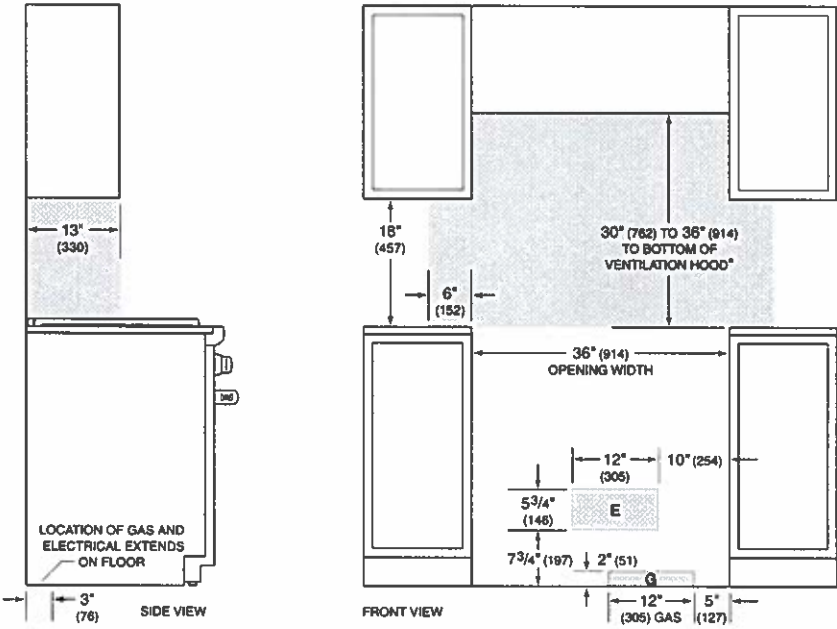

*Without ventilation hood, 42" (1067) minimum clearance countertop to combustible materials, charbroiler and GR488 require non-combustible materials.
NOTE: Shaded area above countertop indicates minimum clearance to combustible surfaces, combustible materials cannot be located within this area.
For island installation, 12" (305) minimum clearance back of range to combustible rear wall above countertop.

Lot 68

PWC362418

FEATURES

- Rigorously tested for decades of use
- Exceptional support from our Customer Care team in Madison
- Heavy-duty stainless steel construction
- Blower required (internal, in-line or remote blowers available)
- Bright halogen lighting
- Heat sentry for safety
- Recessed controls for sleeker look
- Transition with backdraft minimizes backward flow of cold air
- Infinite speed blower control
- Install with accessory duct cover for chimney-style hood
- Handfinished with hemmed edges and welded seams

ACCESSORIES

- 1100 CFM Inline Blower
- 12" Duct Cover
- 1200 CFM Internal Blower
- 1200 CFM Remote Blower
- 1500 CFM Remote Blower
- 18" Duct Cover
- 24" Duct Cover
- 30" Duct Cover
- 300 CFM Internal Blower
- 36" Duct Cover
- 400 CFM Internal Blower
- 6" Duct Cover
- 600 CFM Inline Blower
- 600 CFM Internal Blower
- 600 CFM Remote Blower
- 800 CFM Internal Blower
- 900 CFM Remote Blower
- Backsplash
- Backsplash with Warming Racks
- Make-Up Air Damper
- 38" high stainless steel backsplash with or without warming racks

Accessories available through an authorized dealer.
For local dealer information, visit subzero-wolf.com/locator.

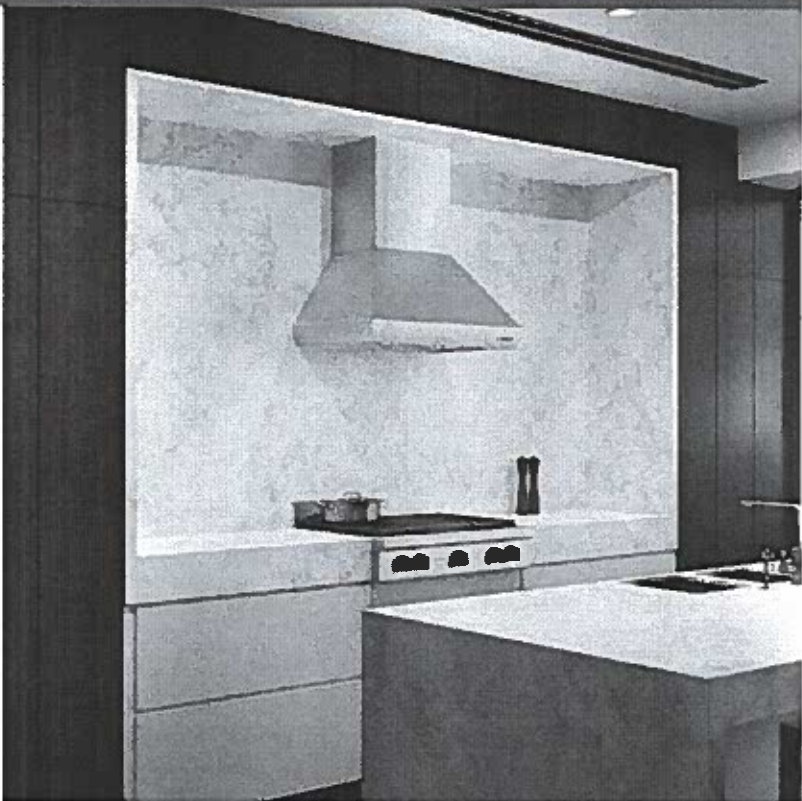

BLOWER OPTIONS

- 300 CFM Internal
- 400 CFM Internal
- 600 CFM Internal
- 800 CFM Internal
- 1200 CFM Internal
- 600 CFM Inline
- 1100 CFM Inline
- 600 CFM Remote
- 900 CFM Remote
- 1200 CFM Remote
- 1500 CFM Remote

Lot 68 @m

Dec. 13, 22

PRODUCT SPECIFICATIONS

Model	PWC362418
Dimensions	36"W x 18"H x 24"D
Weight	78 lbs
Electrical Supply	110/120 VAC, 60 Hz
Electrical Service	15 amp dedicated circuit
Discharge Location	Vertical
Discharge Dimensions	10" Round
Bottom of Hood to Countertop	30" to 36"

ELECTRICAL

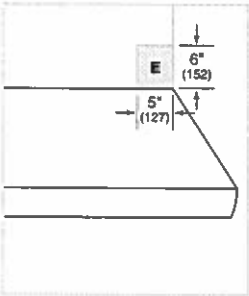

NOTE: Dimensions in parenthesis are in millimeters unless otherwise specified

DIMENSIONS

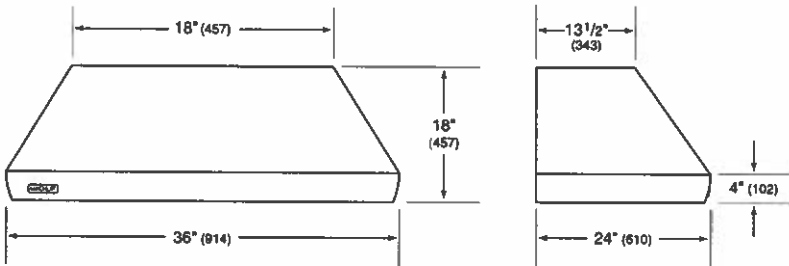

Lot 68

Dec. 13, 22

MDD30PM/S/PH

FEATURES

- Rigorously tested for decades of use
- Exceptional support from our Customer Care team in Madison
- 900 watts of power
- Gourmet mode cooks automatically from preset recipes
- Quick-start controls for popular items
- "Keep Warm" mode
- Integrates into any kitchen
- Generous 1.6 cu. ft. capacity
- Matches M series ovens, coffee systems, convection steam oven



Lot 68 ~~DM~~

Dec. 13, 22

PRODUCT SPECIFICATIONS

Model	MDD30PM/S/PH
Dimensions	29 7/8"W x 17 7/8"H x 20"D
Capacity	1.6 cu. ft.
Door Clearance	14 3/16"
Weight	80 lbs
Electrical Supply	120 VAC, 60 Hz
Electrical Service	15 amp dedicated circuit
Power Cord Length	4 Feet
Receptacle	3-prong grounding-type

ELECTRICAL

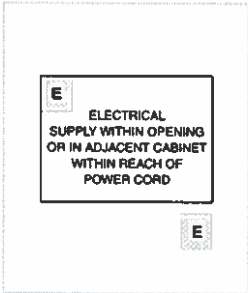

NOTE: Dimensions in parenthesis are in millimeters unless otherwise specified

DIMENSIONS

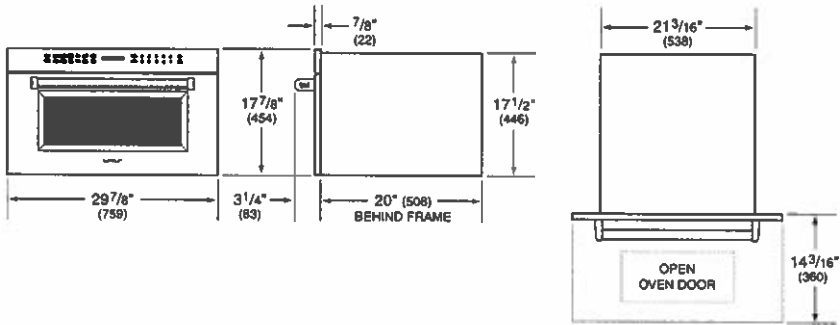

FLUSH INSTALLATION

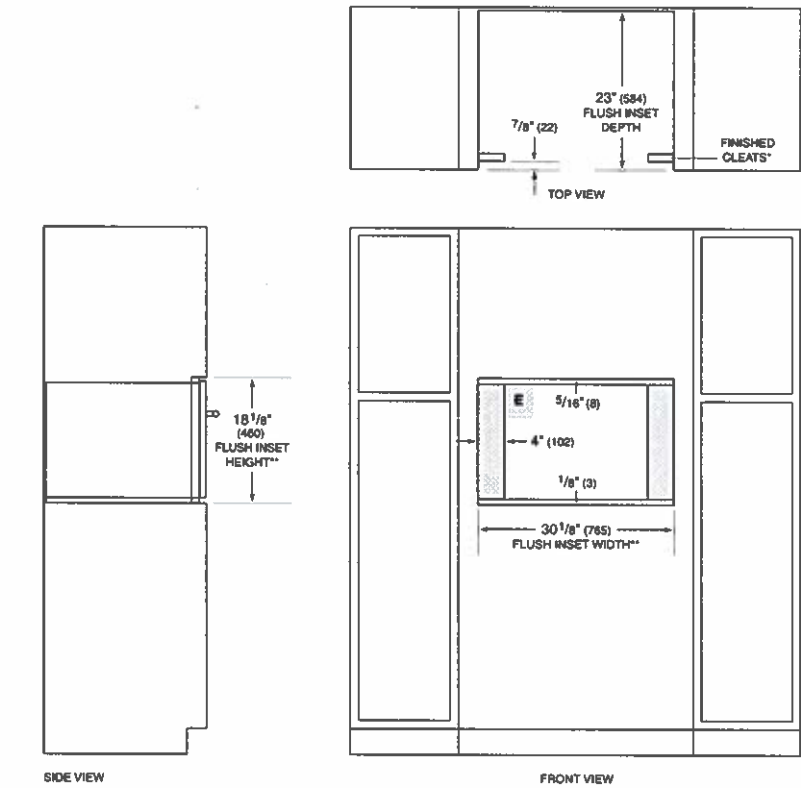

SIDE VIEW
FRONT VIEW
*Will be visible and should be finished to match cabinetry.
**Dimension provides minimum reveals.

Lot 68
Dec. 13, 22

DEU2450BG



FEATURES

Fully customizable exterior, accepting custom panels for an integrated look within cabinetry or stainless steel accessory panels and handles to coordinate with other Sub-Zero, Wolf, and Cove appliances

Seamlessly integrating anywhere, an undercounter beverage center adds comfort to your master suite, creates a corner for libations in the study—the options are endless

Patented, full-extension upright beverage shelf features adjustable gates that anchor contents upright and in place and fold down flat to make room for bulky items

Full-extension, multipurpose shelf offers ample storage space for bottles, soft drinks, and food

Intuitive, on-door touch control panel offers ergonomic, convenient access to settings

Cleanup is simple with nano-coated, spill-proof shelves

UV-resistant glass door protects food and beverages from harmful light that hastens spoilage

Magnetic door seals lock in cold air to ensure freshness and provide superior energy efficiency

Offers precise temperature control within one degree of setpoint, preserving wine, craft beer, dairy, produce, and other perishables at their optimal temperature

Soft-on LED lighting fully illuminates the interior when the door is open and can be adjusted to four unique stand-by accent lighting settings

Wi-Fi enabled features allow for remote temperature control, provide important door-ajar notifications, and assist with remote service diagnostics—all from your mobile device

ACCESSORIES

Custom Panel Lock Kit

Dual Install Kit - Handle-to-Drawer

Dual Install Kit - Handle-to-Handle

Pro Handle

Stainless Steel Dual Kickplate - 39"

Stainless Steel Dual Kickplate - 48"

Stainless Steel Glass Door Panel - Pro Handle, Left Hinge

Stainless Steel Glass Door Panel - Pro Handle, Right Hinge

Stainless Steel Glass Door Panel - Tubular Handle, Left Hinge

Stainless Steel Glass Door Panel - Tubular Handle, Right Hinge

Stainless Steel Glass Door Panel With Lock - Pro Handle, Left Hinge

Stainless Steel Glass Door Panel With Lock - Pro Handle, Right Hinge

Stainless Steel Glass Door Panel With Lock - Tubular Handle, Left Hinge

Stainless Steel Glass Door Panel With Lock - Tubular Handle, Right Hinge

Tubular Handle

Undercounter Solid Overlay Door - Left Hinge

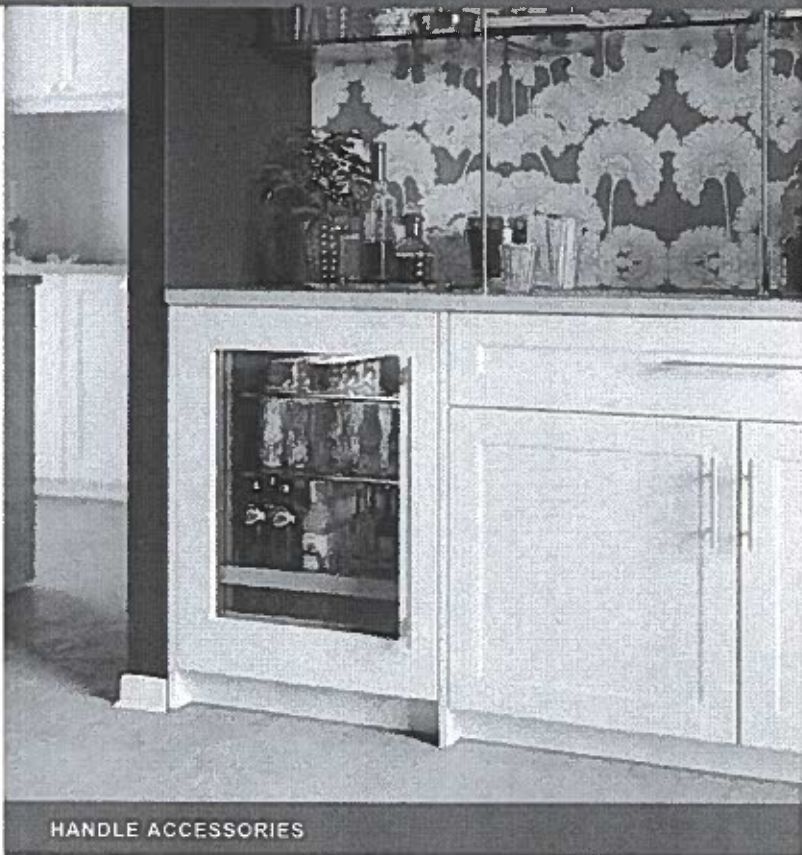

HANDLE ACCESSORIES

PRO



TUBULAR



PRODUCT DETAILS

REFRIGERATOR

- 1 full-extension upright beverage shelf
- 1 full-extension multipurpose shelf
- 2 Adjustable glass shelves

Lot 68



Dec 13, 22

PRODUCT SPECIFICATIONS

Model	DEU2450BG
Dimensions	24"W x 34 1/2"H x 23 1/8"D
Door Clearance	26 1/2"
Refrigerator Capacity	5.5 cu. ft.
Electrical Supply	115 VAC, 60 Hz
Electrical Service	15 amp dedicated circuit
Wine Storage Capacity	8 Bottles
Receptacle	3-prong grounding-type

ELECTRICAL

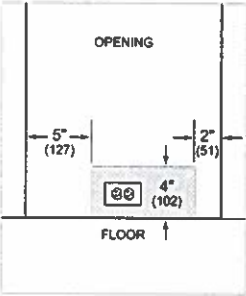

NOTE: Dimensions in parenthesis are in millimeters unless otherwise specified

INTERIOR VIEW

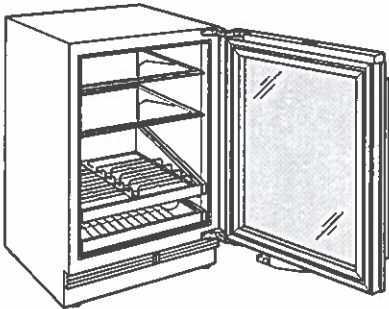

This illustration is intended for interior reference only and may not represent the exterior of the model being specified.

DIMENSIONS

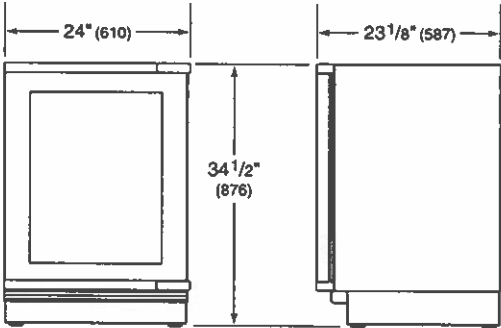

HEIGHT DIMENSIONS ± 1/2" (13)

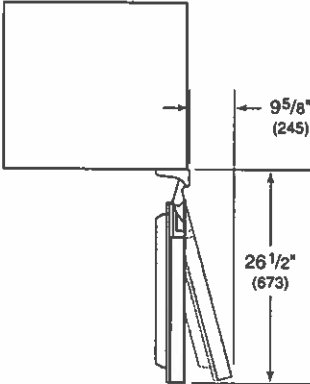

STANDARD INSTALLATION

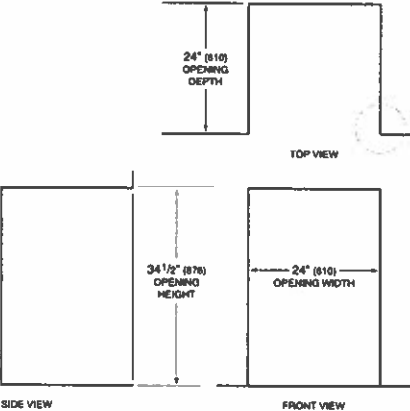

NOTE: 3/2" (80) finished returns will be visible and should be finished to match cabinetry.

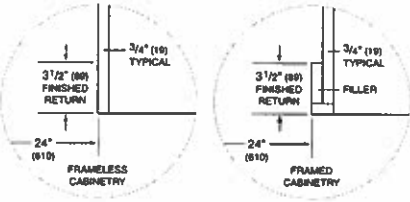

Lot 68