



CONSTRUCTION SUMMARY

Joshua Creek - 68 - 1 - BAYSHIRE (44-03) B

Registere Plan Number: Municipal Address: Closing: 20-Oct-23

BONUS

Inv.488 30 Line 9906 13Dec22 / 30Dec22	1 - BONUS PACKAGE: \$5,000.00 WORTH OF UPGRADES FROM VALERY HOMES DÉCOR CENTRE IS BEING APPLIED TOWARD THE STRUCTURAL APPOINTMENT Note:
---	--

CABINETRY

Inv.573 132 Line 11586 28Feb24 / 1Mar24	1 - KITCHEN/ VANITY HARDWARE: UPGRADE 2 HARDWARE THROUGHOUT HOUSE. INCLUDES STACKED AND WET BAR AREAS HARDWARE ON MAIN FLOOR- INCL. POWDER RM AND MUDROOM, KITCHEN, SERVERY AND WET BAR: 12817SB GOLD BASMNT BATH, MASTER, ENSUITE 2, 5 AND SHARED: 12817BN Note: LAUNDRY ALSO IN BRUSHED NICKEL
--	---

Inv.597 138 Line 11999 11Apr24 / 12Apr24	1 - KITCHEN: CORRECTION: ITEM 115 ON PE 573 THERE ARE ONLY 4 BANKS OF POT AND PAN DRAWERS IN THE KITCHEN, NOT 5 Note:
---	--

Inv.597 139 Line 12000 11Apr24 / 12Apr24	38 - KITCHEN: INSTALL SOFT-CLOSE DRAWERS THROUGHOUT KITCHEN (15 DRAWERS), SERVERY (9 DRAWERS), AND WET BAR AREA (14 DRAWERS) THERE WILL BE A TOTAL OF 38 DRAWERS TO BE CHANGED TO SOFT CLOSE Note:
---	--

Inv.573 106 Line 11558 28Feb24 / 1Mar24	40 - KITCHEN - SERVERY - WET BAR: INSTALL STACKED CABINETS THROUGHOUT. (A03) Note:
--	---

Inv.573 107 Line 11559 28Feb24 / 1Mar24	1 - KITCHEN: INSTALL DEEP STACKED CABINETS (A04) Note:
--	---

Inv.573 108 Line 11560 28Feb24 / 1Mar24	37 - KITCHEN: INSTALL 37 CLEAR GLASS CABINETS THROUOUGHT STACKED CABINETS, INCLUDING 4 DOORS IN KITCHEN, 4 DOORS IN SERVERY, 4 DOORS IN WET BAR. SEE SKETCH Note: **NOTE, THERE IS A CHANCE THAT WE WILL NOT BE ABLE TO GET THE STACKED CABINETS ABOVE THE WINDOW, DUE TO A BULKHEAD. WE WILL REFUND THE PURCHASER SHOULD THIS BE AN ISSUE. WE WILL KNOW BY MID APRIL
--	--



CONSTRUCTION SUMMARY

Joshua Creek - 68 - 1 - BAYSHIRE (44-03) B

Registere Plan Number: Municipal Address: Closing: 20-Oct-23

Inv.573 70 Line 11520 28Feb24 / 1Mar24	1 - POWDER ROOM: INSTALL OPTIONAL CABINETS IN LEVEL 6 IN POWDER ROOM Note:
Inv.573 71 Line 11521 28Feb24 / 1Mar24	1 - SHARED BATH: INSTALL LEVEL 6 CABINETS THROUGHOUT Note:
Inv.573 72 Line 11522 28Feb24 / 1Mar24	1 - MASTER ENSUITE: INSTALL LEVEL 6 CABINETS THROUGHOUT Note:
Inv.573 73 Line 11523 28Feb24 / 1Mar24	1 - ENSUITE 2: INSTALL LEVEL 6 CABINETS THROUGHOUT Note:
Inv.573 74 Line 11524 28Feb24 / 1Mar24	1 - ENSUITE 5: INSTALL LEVEL 6 CABINETS THROUGHOUT Note:
Inv.573 75 Line 11525 28Feb24 / 1Mar24	1 - MUDROOM BENCH: INSTALL LEVEL 6 CABINETS THROUGHOUT Note:
Inv.573 76 Line 11526 28Feb24 / 1Mar24	1 - BASEMENT BATH: INSTALL LEVEL 6 CABINETS THROUGHOUT Note:

CEILING

Inv.597 140 Line 12003 11Apr24 / 12Apr24	1 - CLARIFICATION: CROWN MOULDING LOCATIONS: CROWN (A-120, 8x8), WILL BE INSTALLED THROUGHOUT ENTIRE MAIN FLOOR: FOYER, MAIN HALL, POWDER ROOM, DEN, DINING ROOM, SERVERY, KITCHEN AND WET BAR AREAS, MUDROOM AND FAMILY ROOM. Note: ALSO TO BE ADDED TO THE INSIDE OF THE COFFERED IN MAIN HALL, DINING AND WAFFLES IN FAMILY ROOMS. 2ND FLOOR: CROWN (A-120, 7X7), WILL BE ADDED TO STAIRCASE, MASTER BEDROOM (ALSO IN MASTER WAFFLE), MASTER ENSUITE- NOTE HUTCHES ON VANITY, UPPER HALLWAY. PLEASE ASK IF THERE ARE ANY QUESTIONS
---	---



CONSTRUCTION SUMMARY

Joshua Creek - 68 - 1 - BAYSHIRE (44-03) B

Registere Plan Number: Municipal Address: Closing: 20-Oct-23

Inv.573	1 - ***DELETE*** PE488, ITEM #4
133	
	MASTER BEDROOM: INSTALL TRAY CEILING
Line 11587	Note:
28Feb24 / 1Mar24	

CEILING

Inv.573	1 - MASTER BEDROOM: INSTALL WAFFLE CEILING, 4 SQUARES
134	
	STANDARD LIGHT TO GO IN THE CENTRE OF THE 4 SQUARES
Line 11588	Note:
28Feb24 / 1Mar24	
Inv.488	1 - PRIMARY ENSUITE: COFFERED - TRAY CEILING - MASTER BEDROOM - TRAY CEILING
4	
Line 9879	Note:
13Dec22 / 30Dec22	

CERAMIC TILE

Inv.597	1 - ENSUITE 5: INSTALL UPG. 6 TILES, 2X2 MOSAIC, ON SHOWER FLOOR
141	
Line 12001	Note:
11Apr24 / 12Apr24	
Inv.573	1 - MAIN FLOOR TILED AREAS: FOYER, POWDER ROOM, MUDROOM AND KITCHEN/
90	BREAKFAST AREA:
	INSTALL UPGRADE 6 TILES
Line 11541	Note:
28Feb24 / 1Mar24	
Inv.573	1 - MAIN HALL: INSTALL UPGRADE 6 TILES, IN LIUE OF STANDARD HARDWOOD IN MAIN
91	HALL
Line 11542	Note:
28Feb24 / 1Mar24	
Inv.573	1 - LAUNDRY ROOM: INSTALL UPGRADE 6 TILES
92	
Line 11543	Note:
28Feb24 / 1Mar24	
Inv.573	1 - SHARED BATH: INSTALL UPGRADE 6 TILES ON FLOOR AND SHOWER WALLS
93	
Line 11544	Note:
28Feb24 / 1Mar24	



F R E N D E L
K I T C H E N ' S L I M I T E D
1300 Newton Drive, Midway, ON L1W 1L3

VALERY HOMES
JOSHUA CREEK
LOT 68

Feb. 29, 24

(D.A.) (K.V.)

Apr. 11, 24



Drawn By:
Date: February 29, 2024
Scale: Not To Scale

Approved By Builder:

Date:

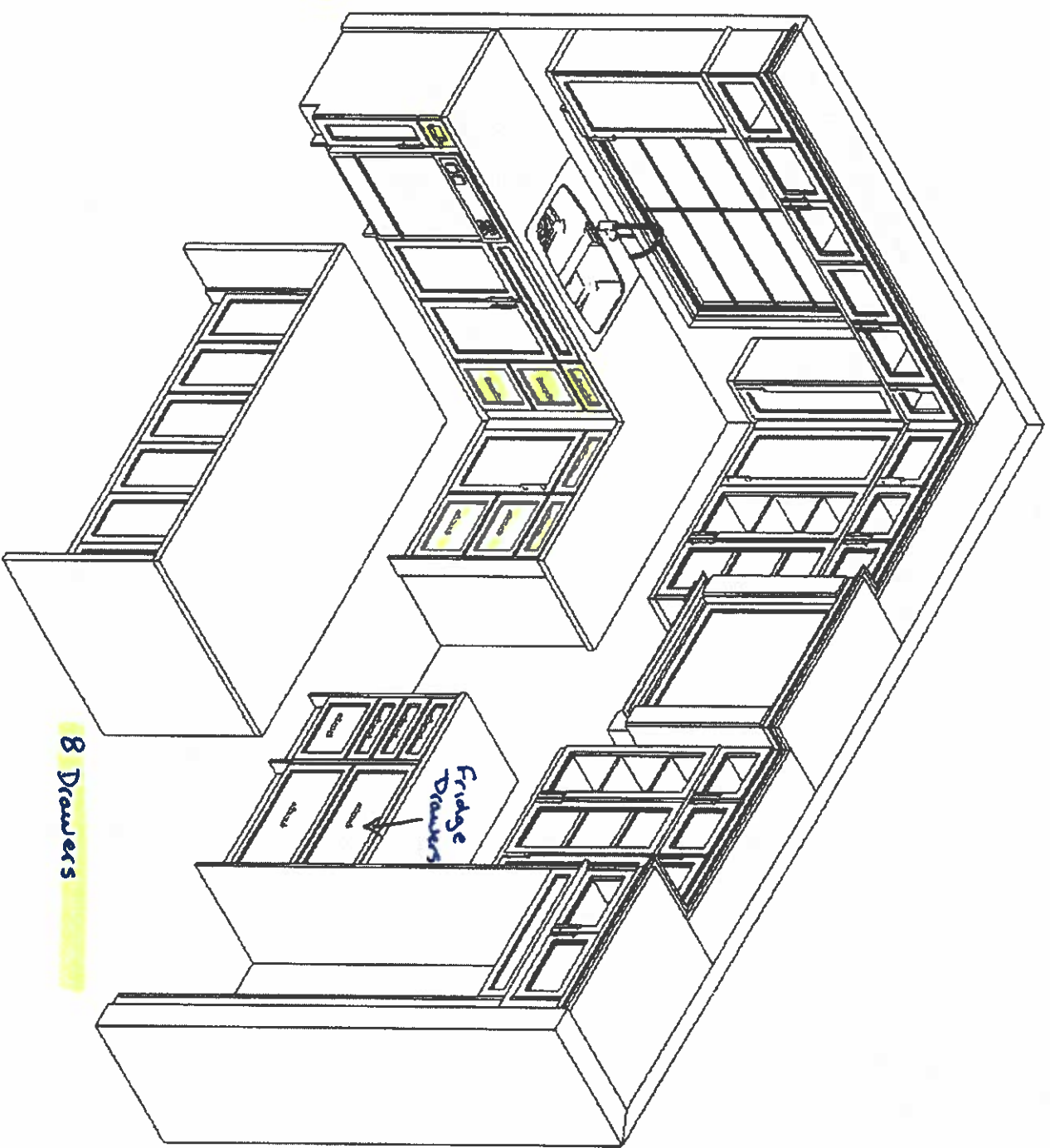

8 Drawers

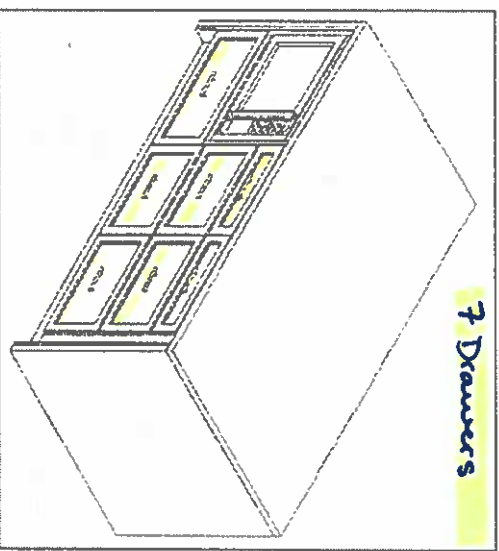

7 Drawers

15 Drawers in Kitchen

This sketch is for DESIGN PURPOSES ONLY – It is not meant to be an exact rendition.

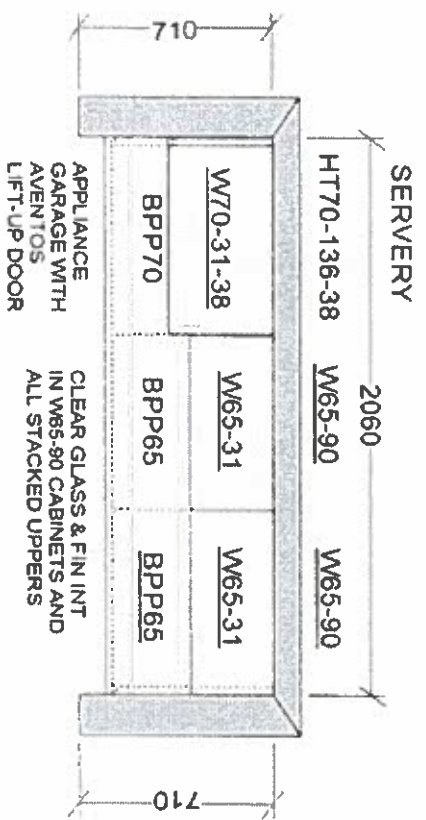

9 Drawers
in Servery

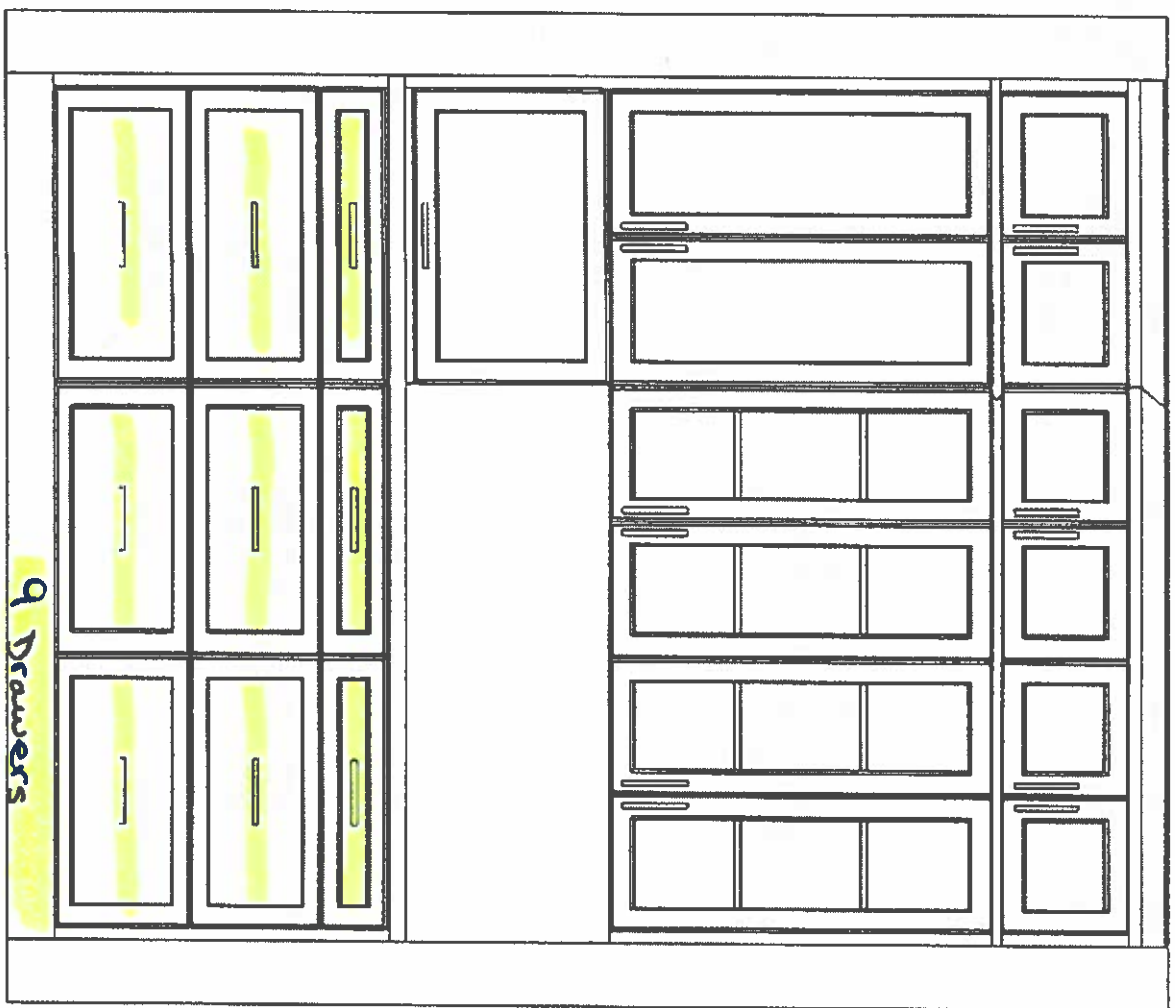

This sketch is for DESIGN PURPOSES ONLY -- It is not meant to be an exact rendition.

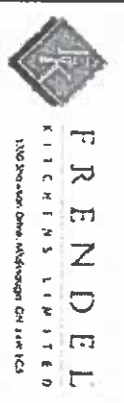

VALERY HOMES
JOSHUA CREEK
LOT 68

Feb 29, 24

D.A. (M)

Apr. 11, 24



Drawn By:
Date: February 29, 2024
Scale: Not To Scale

Approved By Builder:

Date:

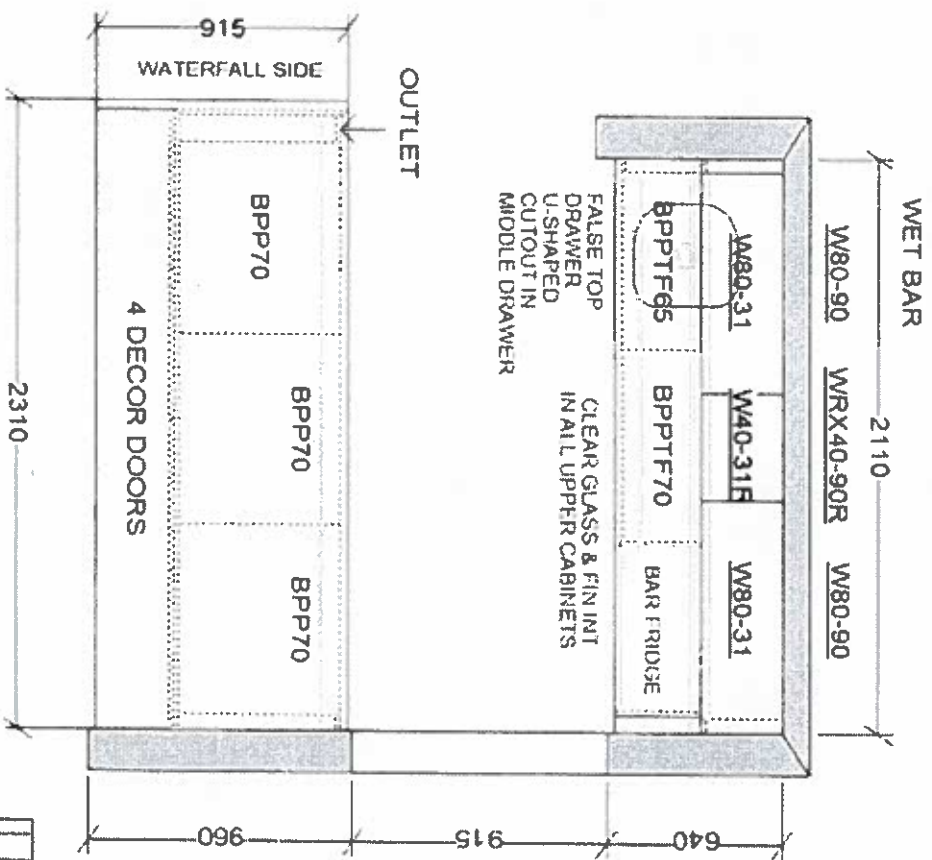

14 Drawers in Wet Bar

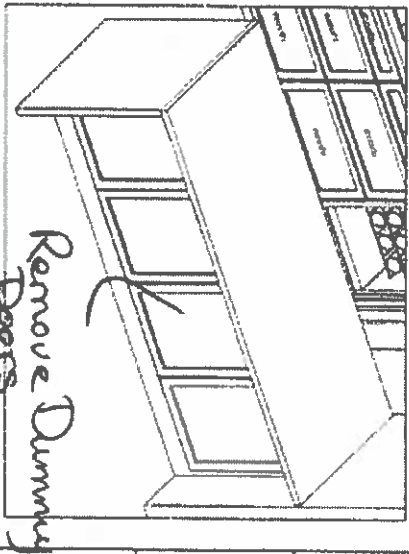
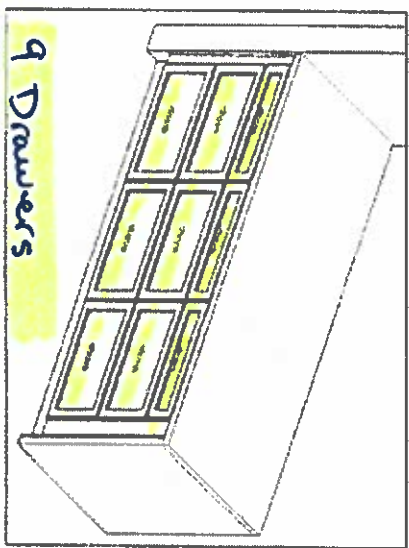
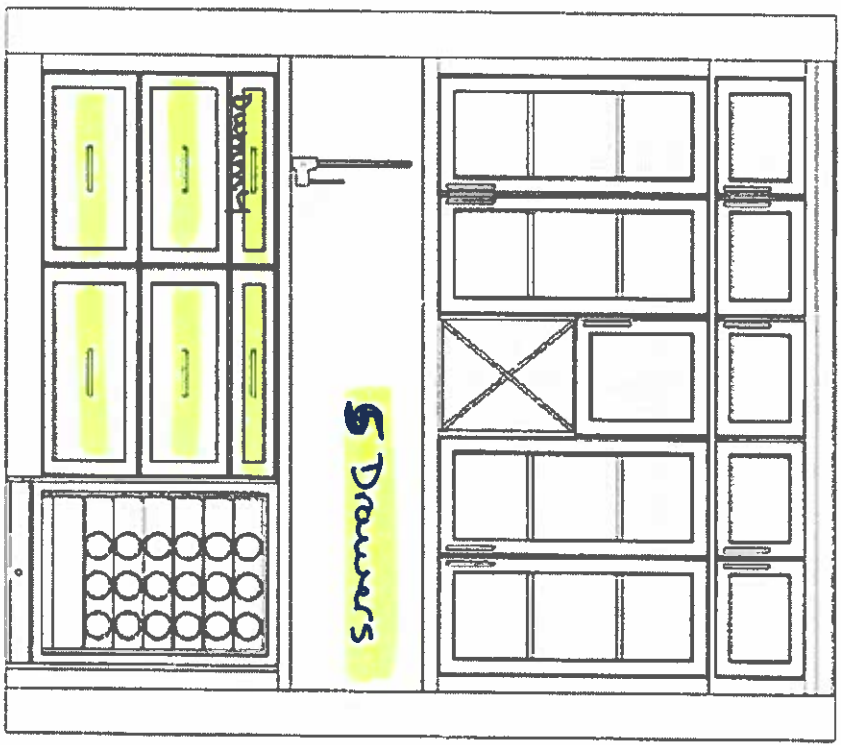

Remove Dummy Doors

This sketch is for DESIGN PURPOSES ONLY – It is not meant to be an exact rendition.

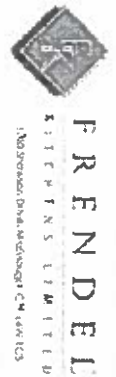

VALERY HOMES
JOSHUA CREEK
LOT 68

07.02.29, 24

D.A. 1/4

Apr. 11, 24



Drawn By:
Date: February 29, 2024
Scale: Not To Scale

Approved By Builder:

Date: