



CONSTRUCTION SUMMARY

Joshua Creek - 41 LIBERTY (42-03) C

Registere Plan Number: Municipal Address: Closing: 15-Aug-23

BONUS

Inv.401 57 Line 8160	1 - BONUS PACKAGE: \$5000.00 WORTH OF UPGRADES FROM VALERY HOMES DECOR CENTRE IS BEING APPLIED TOWARD THE STRUCTURAL APPOINTMENT Note:
11May22 / 25May22	
Inv.592 74 Line 12405	1 - CREDIT: \$9500.00 WORTH OF UPGRADES FROM VALERY HOMES IS BEING APPLIED TOWARD THE COLOUR APPOINTMENT FOR DELAYED CLOSING. Note:
3Apr24 / 29May24	

CABINETRY

Inv.417 62 Line 8467	1 - KITCHEN: NOTE THAT FRIDGE SPECS AND HOOD FAN SPECS HAVE BEEN UPDATED. THEY WILL HAVE THE DATE OF JUNE 23, 2022 ON THEM. THE FRIDGE IS NOW PANELLED AND THE HOOD FAN IS AN INSERT Note:
23Jun22 / 30Jun22	
Inv.592 68 Line 12403	1 - **NOTE: PLEASE DISREGARD ALL PREVIOUS CABINETRY REVISIONS AND APPLIANCE SPECS. PURCHASER IS NOT UPGRADING THE CABINETRY OR APPLIANCES** PURCHASER WILL REVERT TO THE STANDARD 42-3 PLANS Note:
3Apr24 / 29May24	

CEILING

Inv.401 3 Line 8019	1 - SECOND FLOOR: INSTALL SMOOTH CEILING THROUGHOUT 2ND FLOOR Note:
11May22 / 25May22	
Inv.401 4 Line 8020	1 - BASEMENT: INSTALL SMOOTH CEILING THROUGHOUT BASEMENT Note:
11May22 / 25May22	
Inv.401 5 Line 8021	1 - DINING ROOM: INSTALL WAFFLE CEILING - DINING ROOM- 6 SQUARES Note:
11May22 / 25May22	
Inv.401 6 Line 8022	1 - DEN: INSTALL WAFFLE CEILING - DEN, 4 SQUARES Note:
11May22 / 25May22	



CONSTRUCTION SUMMARY

Joshua Creek - 41 LIBERTY (42-03) C

Registere Plan Number: Municipal Address: Closing: 15-Aug-23

ELECTRICAL

Inv.401 31 Line 8051 11May22 / 25May22	1 - KITCHEN: INSTALL VALANCE LIGHTING - UNDER CABINET - DOES NOT INCLUDE VALANCE. VALANCE MUST BE PURCHASED AT COLOUR APPOINTMENT Note:
Inv.401 13 Line 8029 11May22 / 25May22	1 - KITCHEN: INSTALL ONE (1) ADDITIONAL RECEPTACLE ON KITCHEN ISLAND - DEDICATED 15 AMP 120 VOLT . THERE WILL BE A TOTAL OF TWO (2) ON THE ISLAND, ONE AT EACH END Note:
Inv.401 14 Line 8030 11May22 / 25May22	2 - FRONT DOOR COACH LIGHT - GARAGE COACH LIGHTS: INSTALL TIMER - TWO (2) TIMERS FOR EXTERIOR LIGHTING, FRONT DOOR AND GARAGE LIGHTS Note:
Inv.401 15 Line 8031 11May22 / 25May22	6 - DINING ROOM: INSTALL SIX (6) POT LIGHTS - 4" LED NON-INSULATED CEILINGS, ONE IN EACH WAFFLE. DELETE STANDARD LIGHT. Note:
Inv.401 16 Line 8032 11May22 / 25May22	4 - DEN: INSTALL FOUR (4) POT LIGHTS - 4" LED NON-INSULATED CEILINGS, ONE IN EACH WAFFLE. DELETE STANDARD LIGHT. Note:
Inv.401 17 Line 8033 11May22 / 25May22	6 - FAMILY ROOM: INSTALL SIX (6) POT LIGHTS - 4" LED NON-INSULATED CEILINGS, ONE IN EACH WAFFLE. DELETE STANDARD LIGHT. Note:
Inv.401 18 Line 8034 11May22 / 25May22	8 - MAIN HALL: INSTALL EIGHT (8) POT LIGHTS - 4" LED NON-INSULATED CEILINGS, ONE IN EACH WAFFLE, EXCEPT WAFFLE IN FRONT OF DINING ROOM TO GET 2. DELETE STANDARD LIGHTS. *3 ON ONE SWITCH, 5 ON ONE SWITCH Note:
Inv.401 19 Line 8035 11May22 / 25May22	6 - KITCHEN: INSTALL SIX (6) POT LIGHTS - 4" LED NON-INSULATED CEILINGS. KEEP STANDARD LIGHT, BUT TO BE RELOCATED. LOCATIONS MAY VARY SLIGHTLY DUE TO JOIST LOCATIONS Note:



CONSTRUCTION SUMMARY

Joshua Creek - 41 LIBERTY (42-03) C

Registere Plan Number: Municipal Address: Closing: 15-Aug-23

Inv.401 20 Line 8036	8 - BREAKFAST AREA: INSTALL EIGHT (8) POT LIGHTS - 4" LED NON-INSULATED CEILINGS, DELETE STANDARD LIGHT. LOCATIONS MAY VARY SLIGHTLY DUE TO JOIST LOCATIONS Note:
11May22 / 25May22	
Inv.401 21 Line 8038	6 - UPPER HALL: INSTALL SIX (6) POT LIGHTS - 4" LED - INSULATED CEILINGS. DELETE STANDARD LIGHTS. LOCATIONS MAY VARY SLIGHTLY DUE TO JOIST LOCATIONS Note:
11May22 / 25May22	
Inv.401 22 Line 8039	1 - KITCHEN: CEILING FIXTURE - RELOCATE STANDARD CEILING FIXTURE TO GO ABOVE THE ISLAND. SEE SKETCH. LOCATIONS MAY VARY SLIGHTLY DUE TO JOIST LOCATIONS Note:
11May22 / 25May22	
Inv.401 23 Line 8040	1 - KITCHEN: CEILING LIGHT ROUGH IN - FOR 1 CEILING LIGHT - ON SAME SWITCH AS THE STANDARD LIGHT (DOES NOT INCLUDE FIXTURE) TO GO ABOVE THE ISLAND. SEE SKETCH. LOCATIONS MAY VARY SLIGHTLY DUE TO JOIST LOCATIONS Note:
11May22 / 25May22	
Inv.401 24 Line 8041	1 - PRIMARY ENSUITE: INSTALL CEILING LIGHT ROUGH IN - FOR 1 CEILING LIGHT, COMPLETE WITH 1 SWITCH. (ROUGH-IN ONLY) SEE SKETCH. LOCATIONS MAY VARY SLIGHTLY DUE TO JOIST LOCATIONS Note:
11May22 / 25May22	
Inv.401 25 Line 8042	1 - PRIMARY ENSUITE: INSTALL ONE CEILING LIGHT ROUGH IN - FOR 1 CEILING LIGHT - ON SAME SWITCH AS NEW ROUGH-IN (DOES NOT INCLUDE FIXTURE) SEE SKETCH. LOCATIONS MAY VARY SLIGHTLY DUE TO JOIST LOCATIONS Note:
11May22 / 25May22	
Inv.401 26 Line 8043	1 - PRIMARY ENSUITE: INSTALL HEATED FLOOR - PRICE PER SQ FEET INCLUDES MAIN ENSUITE AND TOILET ROOM Note:
11May22 / 25May22	
Inv.401 27 Line 8046	1 - POWDER ROOM: INSTALL HEATED FLOOR - PRICE PER SQ FEET Note:
11May22 / 25May22	
Inv.401 28 Line 8047	1 - FOYER: INSTALL HEATED FLOOR - PRICE PER SQ FEET Note:
11May22 / 25May22	



CONSTRUCTION SUMMARY

Joshua Creek - 41 LIBERTY (42-03) C

Registere Plan Number: Municipal Address: Closing: 15-Aug-23

Inv.401 29 Line 8049 11May22 / 25May22	1 - PRIMARY ENSUITE: INSTALL BATHROOM FAN - SWITCH - 80 CFM WHISPER VALVE PANASONIC BATHROOM FAN COMPLETE WITH SWITCH Note:
Inv.592 69 Line 12404 3Apr24 / 29May24	1 - **NOTE: PLEASE DISREGARD ALL PREVIOUS CABINETRY REVISIONS AND APPLIANCE SPECS. PURCHASER IS NOT UPGRADING THE CABINETRY OR APPLIANCES** **All electrical purchased at the time of structural will remain, although standard kitchen may cover them Note:
Inv.417 63 Line 8461 23Jun22 / 30Jun22	2 - KITCHEN: INSTALL TWO (2) POT LIGHTS - 4" LED - UNINSULATED CEILINGS, ABOVE SINK, ON SEPARATE SWITCH. LOCATIONS MAY VARY SLIGHTLY DUE TO JOIST LOCATIONS Note:
Inv.417 64 Line 8462 23Jun22 / 30Jun22	2 - KITCHEN: INSTALL TWO (2) CABINET LIGHTING - PUCK LIGHT FOR GLASS SHELVES (EACH). ONE IN EACH DOOR IN THE REVISED PANTRY AREA. SEE KITCHEN SKETCH FOR LOCATIONS Note:
Inv.417 65 Line 8463 23Jun22 / 30Jun22	1 - KITCHEN: INSTALL CABINET LIGHTING - UNDERMOUNT T-5 LED VALANCE LIGHT IN THE REVISED PANTRY AREA. SEE KITCHEN SKETCH FOR LOCATIONS Note:
Inv.417 66 Line 8464 23Jun22 / 30Jun22	1 - KITCHEN: INSTALL ONE (1) ELECTRICAL - ROUGH-IN FOR DEDICATED 15 AMP 120 V FOR BACKSPLASH AREA IN THE REVISED PANTRY AREA. SEE KITCHEN SKETCH FOR LOCATIONS Note:
Inv.417 60 Line 8465 23Jun22 / 30Jun22	1 - **DELETE** THE FOLLOWING ITEM FROM PE 401, ITEM #55 KITCHEN: INSTALL UPGRADE STOVE VENT FROM 6" TO 10", THAT REQUIRED A DEDICATED LINE Note:
Inv.401 56 Line 8236 11May22 / 25May22	1 - KITCHEN: INSTALL RECEPTACLES - DEDICATED 15 AMP 120 VOLT RECEPTABLE, FOR BEVERAGE CENTRE Note:



CONSTRUCTION SUMMARY

Joshua Creek - 41 LIBERTY (42-03) C

Registere Plan Number: Municipal Address: Closing: 15-Aug-23

Inv.401 42 Line 8069 11May22 / 25May22	1 - FAMILY ROOM: INSTALL RECEPTACLES - DEDICATED 15 AMP 120 VOLT RECEPTACLE, FOR ELECTRIC FIREPLACE Note:
Inv.401 50 Line 8071 11May22 / 25May22	1 - KITCHEN: INSTALL RECEPTACLES - DEDICATED 15 AMP 120 VOLT RECEPTACLE FOR DISHWASHER Note:
Inv.401 52 Line 8072 11May22 / 25May22	1 - KITCHEN: INSTALL RECEPTACLES - DEDICATED 15 AMP 120 VOLT RECEPTACLE FOR RANGE TOP Note:
Inv.401 53 Line 8074 11May22 / 25May22	1 - KITCHEN: INSTALL ELECTRICAL - ROUGH-IN FOR 20 AMP 240 VOLT RECEPTACLE FOR BUILT-IN WALL OVEN Note:
Inv.401 54 Line 8075 11May22 / 25May22	1 - KITCHEN: INSTALL ELECTRICAL - ROUGH-IN FOR 20 AMP 240 VOLT RECEPTACLE FOR BUILT-IN MICRO/ WALL OVEN Note:
Inv.401 45 Line 8065 11May22 / 25May22	1 - FAMILY ROOM: INSTALL RECEPTACLES - DEDICATED 15 AMP 120 VOLT RECEPTACLE, ABOVE FIREPLACE FOR TV Note:

FIREPLACE

Inv.401 41 Line 8061 11May22 / 25May22	1 - FAMILY ROOM: INSTALL FIREPLACE - ALLURAVISION 50 INCH DEEP DEPTH ELECTRIC FIREPLACE - GLASS FRONT - BLACK - INCLUDES SOUTH BEACH LOG SET - NEFL50CHD. Note: *TO REPLACE STANDARD GAS FIREPLACE
---	---

HARDWOOD FLOORING

Inv.592 70 Line 12296 3Apr24 / 29May24	1 - MAIN FLOOR & UPPER HALL: INSTALL NOUVEAU 7 HARDWOOD THROUGHOUT STANDARD HARDWOOD AREAS Note:
---	---

HVAC



CONSTRUCTION SUMMARY

Joshua Creek - 41 LIBERTY (42-03) C

Registere Plan Number: Municipal Address: Closing: 15-Aug-23

Inv.417 61	1 - **DELETE** THE FOLLOWING ITEM FROM PE 401, ITEM #55
Line 8466	KITCHEN: INSTALL UPGRADE STOVE VENT FROM 6" TO 10", THAT REQUIRED A DEDICATED LINE
	Note:
23Jun22 / 30Jun22	
Inv.401 1	1 - CAT 6-A LOCATION SKETCH. LOCATIONS MAY VARY SLIGHTLY DUE TO JOIST LOCATIONS.
Line 8017	
	Note:
11May22 / 25May22	
Inv.401 55	1 - KITCHEN: INSTALL UPGRADE STOVE VENT FROM 6 INCH TO 10 INCHES
Line 8076	*NOTE: REQUIRES A DEDICATED LINE
	Note:
11May22 / 25May22	
Inv.401 51	1 - KITCHEN: INSTALL GAS PIPING AND OTHER - GAS LINE R/I FOR STOVE
Line 8078	
	Note:
11May22 / 25May22	
Inv.401 30	1 - AIR CONDITIONER ROUGH-IN, INCLUDES ELECTRICAL AND VENTING
Line 8050	
	Note:
11May22 / 25May22	

INTERIOR DOORS & TRIM

Inv.401 9	28 - ALL DOORS: UPGRADE HARDWARE ON INTERIOR DOORS TO ARC DECO IN MATTE BLACK
Line 8025	
	Note:
11May22 / 25May22	
Inv.401 10	1 - FRONT DOOR: UPGRADE GRIP SET AND HARDWARE ON FRONT DOOR. GRIP SET TO BE CENTINEL 1 ELECTRONIC DEADBOLT IN MATTE BLACK WITH ARC DECO HANDLES, MATTE BLACK
Line 8026	
	Note:
11May22 / 25May22	
Inv.401 11	26 - MAIN FLOOR/ SECOND FLOOR: UPGRADE INTERIOR DOOR STYLES TO CONMORE, EXTENDED HEIGHT 96", TOTAL 26 DOORS
Line 8027	
	Note:
11May22 / 25May22	



CONSTRUCTION SUMMARY

Joshua Creek - 41 LIBERTY (42-03) C

Registere Plan Number: Municipal Address: Closing: 15-Aug-23

Inv.401 12	2 - BASEMENT: UPGRADE INTERIOR DOOR STYLES TO CONMORE, STANDARD HEIGHT 84", TWO DOORS
Line 8028	Note:
11May22 / 25May22	

INTERIOR DOORS & TRIM

Inv.401 8	21 - SECOND FLOOR: INTERIOR DOOR & TRIM - INSTALL (TWENTY-ONE 21) EXTENDED HEIGHT DOOR 96 INCH - 2ND FLOOR
Line 8024	Note:
11May22 / 25May22	

MISCELLANEOUS

Inv.401 48	1 - DEPOSIT FOR REDESIGNED KITCHEN. AMOUNT TO BE DEDUCTED FROM KITCHEN DESIGN AT COLOUR APPOINTMENT. MUST BE USED TOWARDS KITCHEN CABINET UPGRADES. FULL AMOUNT IS NON-REFUNDABLE IF PURCHASER DOES NOT UPGRADE THE KITCHEN.
Line 8068	Note:
11May22 / 25May22	

Inv.401 58	1 - Purchaser has attended a Structural appointment at the Decor Centre & has DECLINED any additional upgrades and accepts and acknowledges that there will be no further structural changes/additions/deletions to be made upon signing
Line 8126	Note:
11May22 / 25May22	

Inv.417 59	1 - REOPEN FILE FOR ADDITIONAL STRUCTURAL UPGRADES
Line 8460	Note:
23Jun22 / 30Jun22	

Inv.417 67	1 - Purchaser has attended a Structural appointment at the Decor Centre & has DECLINED any additional upgrades and accepts and acknowledges that there will be no further structural changes/additions/deletions to be made upon signing
Line 8468	Note:
23Jun22 / 30Jun22	

Inv.592 75	1 - Purchaser has attended a Colour appointment at the Decor Centre & has DECLINED any additional upgrades and accepts and acknowledges that there will be no further structural changes/additions/deletions to be made
Line 12406	Note: Purchasers are aware & accept that ANY changes made to upgrades after signing this Purchasers Extra Form are subject to a minimum administration fee
3Apr24 / 29May24	

PAINT



CONSTRUCTION SUMMARY

Joshua Creek - 41 - LIBERTY (42-03) C

Registere Plan Number: Municipal Address: Closing: 15-Aug-23

Inv.592	2 - STAIRCASE: STAIN OPEN STAIRCASE
71	
Line 12301	Note:
3Apr24 / 29May24	

PLUMBING

Inv.592	1 - MASTER ENSUITE: INSTALL UPGRADED SHOWER FAUCETS
72	
	GENTA LX POSI-TEMP SHOWER ONLY WITH 3 FUNCTION TRANSFER VALVE/ TRIM AND SLIDE BAR WITH HAND SHOWER T2472EP/ UT2401/ 3887EP/ A721/ 62320/ U361CI MATTE BLACK (BL)
Line 12337	Note: **NOTE THAT ALL OTHER FAUCETS IN THE MASTER ENSUITE WILL BE STANDARD CHROME
3Apr24 / 29May24	

Inv.592	1 - MASTER ENSUITE: ADDITIONAL PLUMBING-WATER CONNECTION WHEN ADDING HAND-HELD SHOWER
73	
	*UPGRADE TO BE APPROVED BY HEAD OFFICE, BASED ON THE STAGE OF CONSTRUCTION
Line 12338	Note:
3Apr24 / 29May24	

Inv.401	1 - KITCHEN: INSTALL EXTRA ROUGH-IN LINE FOR FRIDGE ICE MAKER WITH SHUT-OFF
49	
Line 8070	Note:
11May22 / 25May22	

Inv.401	1 - ENSUITE 4: CONVERT TUB TO SHOWER. INCLUDES 1 SIDE FRAMELESS GLASS, MATTE BLACK ENCLOSURE
32	
Line 8052	Note:
11May22 / 25May22	

Inv.401	1 - PRIMARY ENSUITE: INSTALL SHOWER SEAT
34	
Line 8053	Note:
11May22 / 25May22	

Inv.401	1 - PRIMARY ENSUITE: SHOWER NICHE
35	
Line 8054	Note:
11May22 / 25May22	

Inv.401	1 - PRIMARY ENSUITE: INSTALL PLUMBING FROM CEILING FOR RAINSHOWER HEAD
36	
Line 8055	Note:
11May22 / 25May22	



CONSTRUCTION SUMMARY

Joshua Creek - 41 LIBERTY (42-03) C

Registere Plan Number: Municipal Address: Closing: 15-Aug-23

Inv.401 37	1 - PRIMARY ENSUITE: SHOWER HEAD - INSTALL RAINSHOWER HEAD
Line 8056	MOEN S112 WR 10" RAINSHOWER
	Note:
11May22 / 25May22	
Inv.401 38	1 - PRIMARY ENSUITE: KEEP STANDARD SHOWER HEAD - (IN ADDITION TO RAINSHOWER HEAD)
Line 8057	Note:
11May22 / 25May22	
Inv.401 33	1 - PRIMARY ENSUITE: UPGRADE GLASS SHOWER TO MATTE BLACK FRAMED
Line 8058	Note:
11May22 / 25May22	
Inv.401 39	1 - GARAGE: INSTALL EXTRA HOT FAUCET IN GARAGE
Line 8059	Note:
11May22 / 25May22	
Inv.401 40	1 - BACKFLOW PREVENTER VALVE
Line 8060	Note:
11May22 / 25May22	

STAIRS

Inv.401 7	2 - OPEN STAIRCASE: INSTALL 2 SETS OF OPEN STAIRS. MAIN TO SECOND FLOOR AND MAIN TO BASEMENT
Line 8023	Note:
11May22 / 25May22	

VACCUM/BELL

Inv.401 46	1 - SEVEN (7) ZONE HOME AUDIO ROUGH-IN SPEAKER WIRES (X14), CAT-5E CABLES (X2), 6.5 INCH SPEAKER BRACKETS (X7 PAIRS). LOCATIONS MAY VARY SLIGHTLY DUE TO JOIST LOCATIONS
Line 8066	TO GO IN FAMILY ROOM, KITCHEN/BREAKFAST AREA, DINING ROOM, DEN, PRIMARY BEDROOM, PRIMARY
	Note: TO GO IN FAMILY ROOM, KITCHEN/BREAKFAST AREA, DINING ROOM, DEN, PRIMARY BEDROOM, PRIMARY ENSUITE AND BASEMENT
11May22 / 25May22	
Inv.401 47	1 - MAIN HALL CEILING: INSTALL WIRELESS ACCESS POINT PACKAGE - 1-UBIQUITI AC LITE ACCESS POINTS WITH 1 CAT6 NETWORK CABLE
Line 8067	Note:
11May22 / 25May22	



CONSTRUCTION SUMMARY

Joshua Creek - 41 LIBERTY (42-03) C

Registere Plan Number: Municipal Address: Closing: 15-Aug-23

Inv.401	1 - CANAVAC PREMIUM CANISTER WITH RUG AND FLOOR HOSE KIT - INCLUDES C-VAC
43	INLET VALVES AND INSTALLATION
Line 8063	Note:
11May22 / 25May22	

Inv.401	1 - FAMILY ROOM: INSTALL CONDUIT - 1 1/4" ORANGE FLEX CONDUIT APPROX. 35FT FOR
44	FIREPLACE, FOR TV
Line 8064	Note:
11May22 / 25May22	

WINDOWS

Inv.401	4 - BASEMENT: ENLARGE FOUR (4) BASEMENT WINDOWS - ENLARGE STANDARD WINDOW
2	- 36 X 30
Line 8018	Note:
11May22 / 25May22	

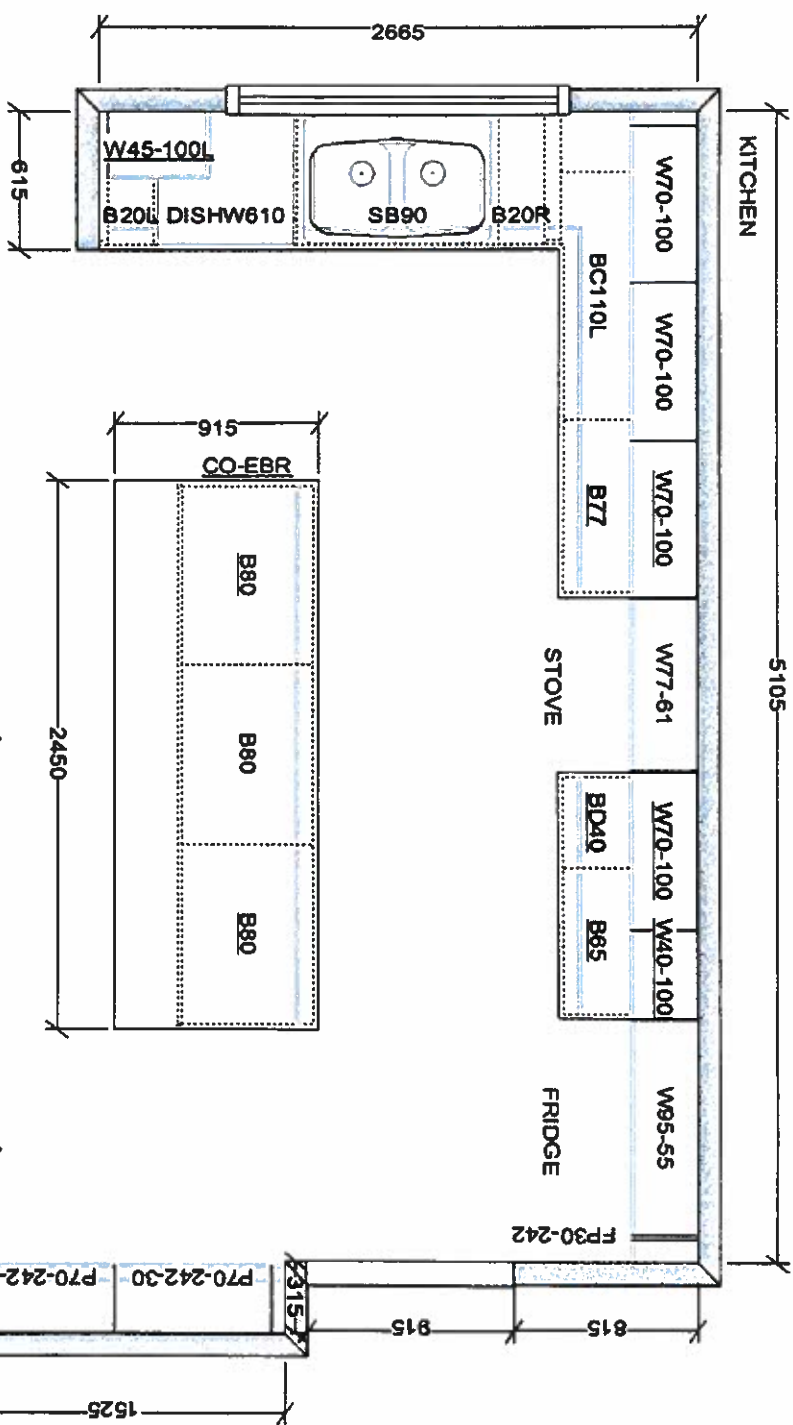

* Build as standard Kitchen Plan. Disregard all other Plans

* Structural - electric/plumbing/hvac to remain as upgraded

 FRIENDS KITCHENS LIMITED <small>1225 Brimley Drive, Scarborough, ON M1V 1C3</small>	VALERY HOMES JOSHUA CREEK 42-3	STANDARD FEATURES: <ul style="list-style-type: none">• 100cm Upper cabinets• Backing on Kitchen and Bath cabinets except sinks• Kitchen & Bath countertops by others• Post-form laminate countertops in Laundry	Lot 41	May 28, 24
Drawn By: _____				
Date: November 27, 2023				
Scale: Not To Scale				
Approved By Builder: _____				

42-3

* See raised kitchen plan

⑤—Electricity

② - speaker knowledge

2041

May 28, 24

JOSHUA CREEK

MONTAGE

GROUND FLOOR ELEV.

- Open Stairs.
main to 2nd & PARTIAL GROUND FLOOR ELEV. @
main to Basement

PARTIAL GROUND FLOOR ELEV. C

5

VALERY

RECEIVED

MAY 30 2024

42-3



A detailed floor plan of a building, possibly a school or office, with various rooms labeled. A large, bold 'X' is drawn across the central part of the plan, indicating a restricted or unsafe area. The plan includes rooms such as 'CLASSROOM', 'OFFICE', 'RESTROOM', and 'KITCHEN'. There are also labels for 'EXIT' and 'DOOR'. The 'X' is drawn over a central corridor and several rooms, suggesting a high-risk or restricted zone.

Floor

S - 21 total

Exposed R/I

Speaker R/I

R/I for ceiling light on square switch

R/I for ceiling light on same switch as other Rough-in.

Harded Floors

6 pcts. Delete std. lights

install Shroud, Frameloss glass, Matte Black Enclosure

KITCHEN

BATH

SECOND FLOOR FIF A

PARTIAL SECOND FLOOR ELEV C

MONTAGE

2. $\partial \text{supp}(\mu) \cap \partial \text{supp}(\nu) \neq \emptyset$ implies that μ and ν are not disjoint. In fact, if μ and ν are disjoint, then $\text{supp}(\mu) \cap \text{supp}(\nu) = \emptyset$ and $\partial \text{supp}(\mu) \cap \partial \text{supp}(\nu) = \emptyset$. Conversely, if $\partial \text{supp}(\mu) \cap \partial \text{supp}(\nu) \neq \emptyset$, then μ and ν are not disjoint. In fact, if μ and ν are not disjoint, then $\text{supp}(\mu) \cap \text{supp}(\nu) \neq \emptyset$ and $\partial \text{supp}(\mu) \cap \partial \text{supp}(\nu) \neq \emptyset$. Therefore, $\partial \text{supp}(\mu) \cap \partial \text{supp}(\nu) \neq \emptyset$ implies that μ and ν are not disjoint.

VALERY

RECEIVED
MAY 30 2024

42-3

36x 30in

36x 30in

Snake
RVI

Smooth Ceiling

⑤

30" 30"

36x30" L

FINISHED BASEMENT ELEV. A & B

UNFINISHED BASEMENT ELEV A & B

PARTIAL BASEMENT PLAN ELEV. C

PARTIAL FINISHED BASEMENT FLOOR ELEV C

JOSHUA CREEK
MONTAGE

MONTAGE

2. A 2000 Census Bureau study of 10,000 households found that 10% of households had a computer. The study also found that 10% of households had a computer. The study also found that 10% of households had a computer.

VALERY

80 + 41

July 18, 2022

418

May 28, 24

RECEIVED
MAY 30 2024