

Lot 36
Phase 2
Model Genevieve (43-3) Elev A

Colours Upgrade Report
Brooklin Print Date:14-Feb-13

DELPHIS P. HICKE and ZONIA A. HICKE

PE With Agreement

- KOHLER PLUMBING FIXTURES THROUGHOUT
- ENERGY STAR QUALIFIED HOMES
- NO HIDDEN CLOSING COSTS
- HARDWOOD 2 1/4 IN. X 3/4 IN. PRE-FINISHED NATURAL OAK THROUGHOUT (EXCEPT TILED AREAS AND BEDROOMS)
- ENERGY STAR GAS FIREPLACE
- NATURAL FINISH OAK STAIRS FROM MAIN TO SECOND FLOOR
- PURCHASER REQUEST FOR EXTRAS DATED AUGUST 12, 2012
- PURCHASER IS AWARE THAT THEY ARE NOT ENTITLED TO ANY FURTHER PROMOTIONS BY THE BUILDER.
- TEN THOUSAND DOLLARS (\$10,000) OF UPGRADES TO BE CHOSEN FROM BUILDERS SAMPLES AT TIME OF COLOUR SELECTION

ID	Group	Description	Invoice	Date Ordered	
2694	3TR	Optional breakfast bar included *as per Nick from oaskdale	406		
2695		Laundry door: Do not install laundry room door	406		
2696		Laundry room: Washing machine to be installed on the left. Dryer to be installed on the right. Venting and electrical to be done accordingly. *Client is aware of new location for washer dryer *See skecth for details	406		
2697		Kitchen: Electrical: install junction box center to island. To be on seperate switch from kitchen	406		
2698		Living Room/Dining Room: Install std light center to room	406		
2699		Living Room/Dining Room: Install 4 junction boxes in corner of Living/Dining Room. To be installed on one switch. Seperate from std. STD to remain.	406		
2702		Family Room: upgrading to cathedral ceiling with feature window and smooth ceilings *To be as the model with windows low to the floor. window base to be 18 inch from floor	406		
2703		Main Floor: smooth ceilings on main floor. Including living room/Dining Room, upper hallway *Discount for having ceiling application in fam rm	406		
2704		Change for item #5: Basement door location changed. See sketch for new location.	406		
2705		Basement landing: std outlet to be installed in the middle of the rear wall. See sketch for approx. location	406		
2707		All bathrooms: Do not install mirrors or bathroom accessories	406		
2708		Master Bedroom main door: Change swing on door. Swing towards closet wall and not into master bedroom main area. *Move doorway down 12 inch into the master bedroom *See sketch for further details	406		
2709		Master Bedroom closet: DO NOT INSTALL trim or shelving on rear of WIC. *Stop shelving 24 inch from rear wall of WIC *Move STD shelving to other side of closet wall *See sketch	406		
3167		Kitchen: Adjust cabinets for OTR. Upgrade 1	406		
3168		Kitchen: 20 amp for OTR	406		
3169	✓	Kitchen: Junction box center to sink on same switch as std kitchen light *See plan	406		

DELPHIS P. HICKE and ZONIA A. HICKE

3170		Kitchen: STD light to be centered in front of stove. *on the same switch as junction box over sink	406		
3171		Breakfast Room: STD light to be center to graden doors. *See plan	406		
3172		Kitchen: Junction box center over the island. *Sep Switch *See plan	406		
3173		Kitchen/Framing: Client would like bulkheads tight to cabinets	406		
3174		All bathrooms:Do not install bathroom accessories	406		
3177		Kitchen to Family Room: Delete archways, decorative columns and nib walls. *To look like the model home	406		
3281		Front hallway: Do not istall nib walls or trim in this area *See sketch	406		
3282		Kitchen: delete lip on countertop	406		
3283		Master Ensuite: Door swing to be change *swing away from countertop	406		
3517	Included in Offer	Delete half walls decorative columns and arch between breakfast area and family room	482		
3518	Included in Offer	Door to laundry room to open into room as shown (hall) revised	482		
3519	Included in Offer	Door from garage to laundry room to swing as shown (revised)	482		
3520	Included in Offer	Relocate door in basement finished area as shown	482		
3572	Included in Offer	Oakstairs from main to 2nd floor and main to basement	406		
3938	COLOURS	Kitchen: upgrade 1 cabinets CARA MAPLE WHITE ✓	531		
3939	COLOURS	Kitchen: Deep upper with 2 gables ✓	531		
3940	COLOURS	Kitchen: base corner folding cabinet ✓	531		
3941	COLOURS	Kitchen: 2 top drawers in island ✓	531		
3942	COLOURS	Kitchen: upper corner diaginal cabinet ✓	531		
3944	COLOURS	Kitchen: hardware upgrade HR510 ✓	531		
3945	COLOURS	Family Room, Living Room, Dining, Main Hall, Kitchen, upper hallway and all landings: Hardwood: Upgrade 1 Wickham Walnut OAK ✓	531		
3946	COLOURS	Master Ensuite: STD tile to be installed on tub deck/face and wall ✓	531		
3947	COLOURS	Master Bedroom: upgrade 1 underpad ✓ *Standard underpad in all other bedrooms	531		

Lot 36
Phase 2
Model Genevieve (43-3) Elev A

Colours Upgrade Report
Brooklin Print Date:14-Feb-13

DELPHIS P. HICKE and ZONIA A. HICKE

3948	COLOURS	Main to 2nd: main to basement: Upgrade 3 railings Alpa # 12 handrail: wrough iron;posts 1/2 inch square single collar alternating 1/2 inch square single collar , 3 1/2 inch sq post with chamfered edges	531		
3949	COLOURS	Main to 2nd: main to basement: Stain to match walnut	531		
3951	COLOURS	Master Bedroom: light switch to be installed as per sketch *Install so purchaser can open door and turn on the light. Do not install light behind door	531		
3955	COLOURS	Kitchen: pot and pan drawers	531		
4068	COLOURS	Master Bedroom: Foyer: Additional hardwood (does not include WIC)	531		
4069	COLOURS	Railings: Custom order Alpa # 12 handrail: wrough iron;posts 1/2 inch square single collar alternating 1/2 inch square single collar , 3 1/2 inch sq post with chamfered edges	531		

ZANCOR HOMES COLOUR CHART

CABINETRY		HARDWARE		ZANCOR APPLIANCE PACKAGE		
Kitchen	Up 1 Cara Maple White	HR 510	Appliance Package	No		
Servery	N/A	N/A	Gas Line to Stove	No	Waterline	NO
Island	Up 1 Cara Maple White	HR 510	PLUMBING	STANDARD	NOTES	
Master Ensuite	STD 1/4 inch shaker Espresso	HR 04	Kitchen	STD		
Main/Twin	STD Arctic Thermal White	HR 04	Powder Room	STD		
2nd Ensuite	N/A	N/A	Master Ensuite	STD		
3rd Ensuite	N/A	N/A	Main/Twin	STD		
Laundry	STD	STD	2nd Ensuite	N/A		
Basement Bath	N/A	N/A	3rd Ensuite	N/A		
Other	N/A	N/A	Other	N/A		
COUNTERTOPS		EDGE	MIRRORS & ACCESSORIES			
Kitchen	3522-58 Granite Perlato	N/A	Mirrors	No		
Servery	N/A	N/A	Bathroom Accessories	No		
Island	3522-58 Granite Perlato	N/A	TRIM			
Master Ensuite	Tan Soap stone 4887-38	N/A	Casing/Baseboards	STD		
Main/Twin	Green SoapStone 4885-38	N/A	Interior Doors	STD		
2nd Ensuite	N/A	N/A	Interior Door Hardware	STD		
3rd Ensuite	N/A	N/A	Exterior Door Hardware	STD		
Laundry	STD	STD	PLASTER MOULDING			
Basement Bath	N/A	N/A	Crown Moulding	N/A		
FLOOR & WALL TILES		WALL TILE INSERT	THRESHOLDS			
Kitchen Floor	Hardwood	No	Living Room	HARDWOOD/CARPET		
Breakfast Floor	Hardwood	No	Dining Room	Up 1 Wickham Oak Walnut		
Kitchen Bk.Splash	N/A	No	Family/Great Room	Up 1 Wickham Oak Walnut		
Main Foyer	12 x 12 Arizona Noce	No	Den/Study	Up 1 Wickham Oak Walnut		
Main Hall	Hardwood	No	Kitchen *(Waiver)	Up 1 Wickham Oak Walnut		
Powder Room	12 x 12 Arizona Noce	No	Main Foyer *(Waiver)	TILE		
Laundry	12 x 12 Arizona Noce	No	Main Hall	Up 1 Wickham Oak Walnut		
Mstr Ensuite Floor	13 x 13 Greco Beige	No	Upper Hall	Up 1 Wickham Oak Walnut		
Mstr Ensuite Shower	8 x 10 Splendour Taupe	No	Master Bedroom	Performa 3 6304 Canvas		
Mstr Ensuite Tub Wall	13 x 13 Greco Beige	No	Bedroom 2	Performa 3 6304 Canvas		
Mstr Ensuite Tub Deck	13 x 13 Greco Beige	No	Bedroom 3	Performa 3 6304 Canvas		
Master Shower Floor	2x2 Bone	No	Bedroom 4	N/A		
Main Bath/Twin Floor	12 x 12 Reflection Olive	No	Carpet Underpad	Up1 in MB STD in all other bedrooms		
Main Bath/Twin Wall	8 x 10 Reflection Olive	No	Basement Landing	N/A		
Main Bath/Twin Shower	8 x 10 Reflection Olive	No	Other	N/A		
2nd Ensuite Floor	N/A	No	STAIRS, RAILING & PICKETS			
2nd Ensuite Wall	N/A	No	Main Flr. to 2nd Flr. Stair Finish/Stain:			
2nd Ensuite Shower	N/A	No	Main Flr. to 2nd Flr. Railing Details:			
Basement Landing	12 x 12 Arizona Noce	No	Alpha # 12 handrail: wrought iron/posts 1/2 inch square single collar alternating 1/2 inch square single collar , 3 1/2 inch sq post with chamfered edges			
Other	N/A	No	Alpha # 12 handrail: wrought iron/posts 1/2 inch square single collar alternating 1/2 inch square single collar , 3 1/2 inch sq post with chamfered edges			
FIREPLACE		Mantle	NF 23			
Location	Family Room	Hearth	No			
Insert & 4 PC Surround	STD and No					
PAINT						
Kitchen/Breakfast	Alpha # 12 handrail: wrought iron/posts 1/2 inch square single collar alternating 1/2 inch square single collar , 3 1/2 inch sq post with chamfered edges					
Living Room	White Paint Req'd					
Dining Room	No					
Family/Great room	Where to Paint					
Den/Study	No					
Mainly/Upper Hall	No					
Master Bedroom	No					
Bedroom 2	No					
Bedroom 3	No					
Bedroom 4	No					
Ensuite	No					
Main/Twin	No					
2nd Ensuite	No					
3rd Ensuite	No					
Laundry	No					
Powder Room	No					
SITES						
SITE:	Brooklin Forest	LOT:	36			
PURCHASER(S):						
Hicke						
HOME #:						
CELL #:						
EMAIL:						
MODEL:						
WOB/LOB:						

* ITS THE RESPONSIBILITY OF ALL TRADES TO INFORM THE BUILDER OF ANY
DESCREPANCIES ON SKETCHES, PES AND/OR COLOUR CHART

ZANCOR
HOMES

DISCLAIMER

Colours of all materials are as close as possible to Builders selection but not necessarily identical due to dye lot variances in manufacturing/manufacturers. Due to construction progress some items may have been pre-selected or installed. In this event the Vendor's selection must be accepted by the purchaser

Any changes to the colour chart after signing are subject to a \$5000 administration fee plus costs (Not incl. paint)

Purchaser has checked and acknowledged accuracy of colour and selections before signing.

INITIALS

Purchaser Signature

Date

Purchaser Signature

Date

Décor Consultant Signature

Date

Vendor Signature

Date

Genevieve

Elev. A 2520 sq. ft.

Elev. C 2578 sq. ft.

Lot 36

SEPT 24/12

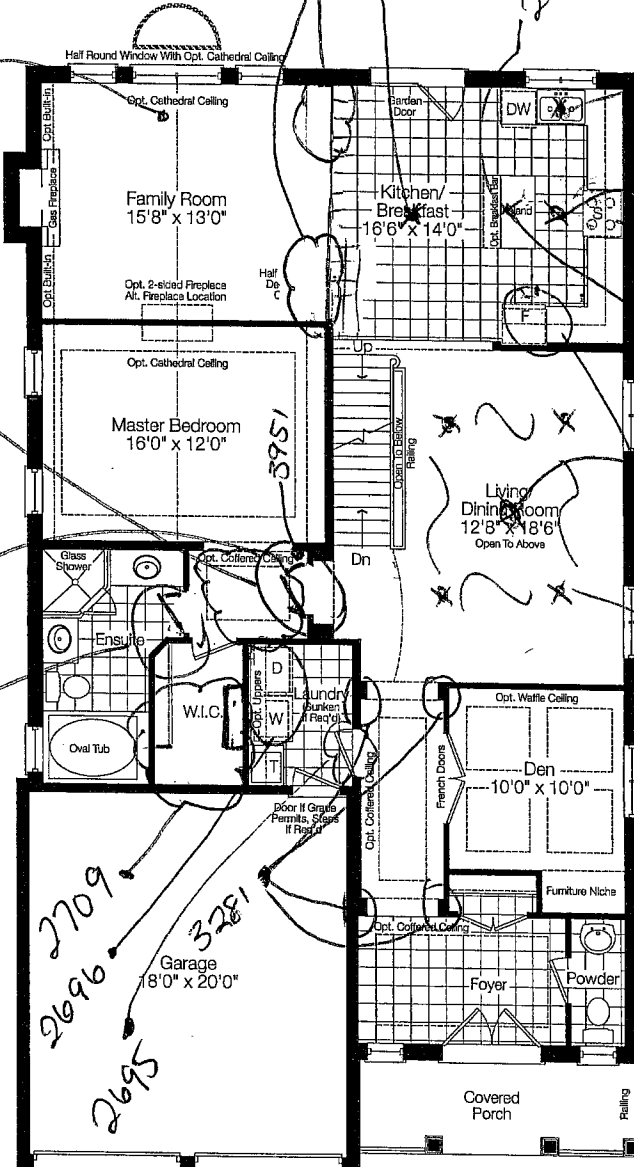

Ground Floor Elev. 'A'

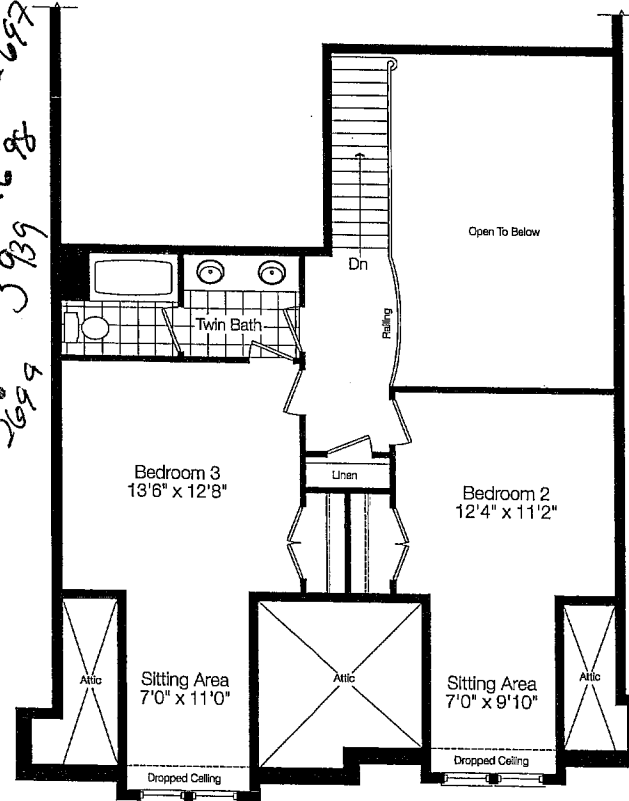

Loft Floor Elev. 'A'

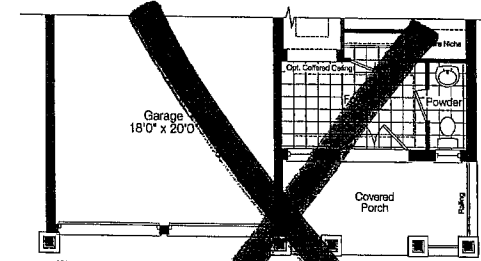

Partial Ground Floor Elev. 'C'

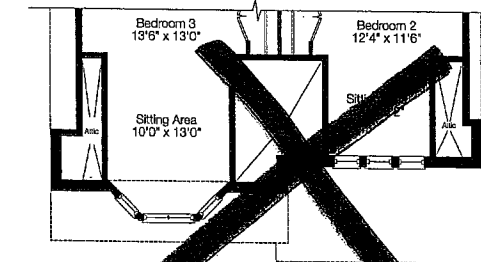

Partial Loft Floor Elev. 'C'

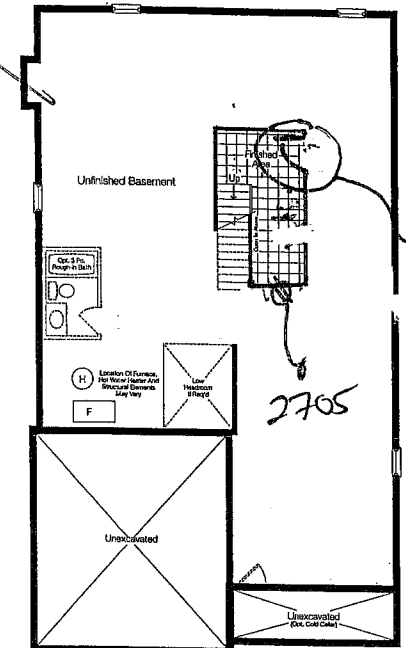

Basement Floor Elev. 'A'

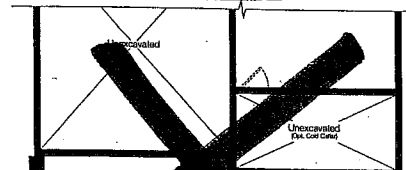

Partial Basement Floor Elev. 'C'

Z
ZANCOR
HOMES

LOCAL, LEGENDARY & LASTING™

Prices and specifications are subject to change without notice. E & O.E. Tile patterns may vary. Window size and location may vary. Approx. location of furnace and water tank. Actual usable floor space may vary from the stated floor area. All stated dimensions are approximate. All renderings are artist's concept.

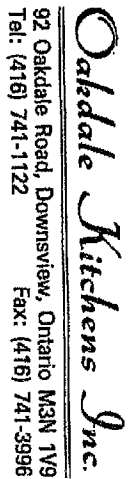

DATE: 04/1/12
JOB NO.

SHIP TO: 67 36 MORTIN

INSTALLATION:
☐ WITH
☐ WITHOUT

REMARKS:

HARDWARE:

COUNTERTOP:

INSTALLATION:

43.02

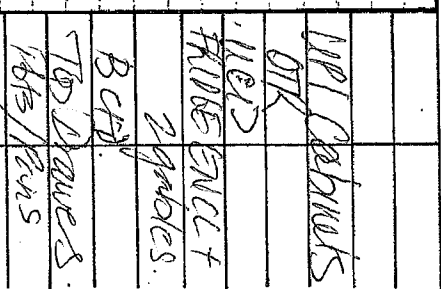

**All agreements are contingent upon strikes, accidents, and delays beyond our control.
Please provide our installer with template for sinkholes or \$100.00 will be charged for callback.**

TERMS:

TOTAL \$

SALESMAN'S SIGNATURE



SEARCH

francisco

GO

- VIRTUAL KITCHEN
- COMPACTS
- WALL Ovens
- RANGES
- INDUCTION
- ELECTRIC
- GAS
- BUILT-IN
- WHAT IS INDUCTION?
- WARMER RESOURCES
- VENTILATION
- MICROWAVES
- DISHWASHERS
- REFRIGERATION
- WINE STORAGE
- COMPACTORS

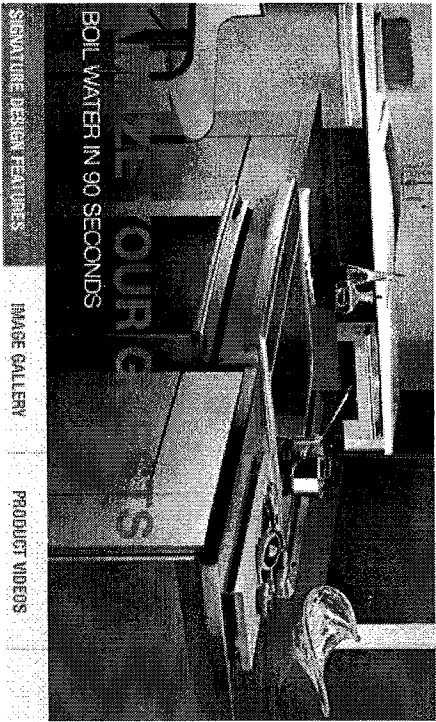

BOIL WATER IN 90 SECONDS



SIGNATURE DESIGN FEATURES

IMAGE GALLERY

PRODUCT VIDEOS

PRODUCT OVERVIEW

SPECIFICATIONS & GUIDES

30" INDUCTION BUILT-IN RANGE WITH WAVE-TOUCH® CONTROLS

EW30IS6CJS

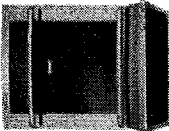

Guides

- ☐ Complete Owner's Guide (English)
- ☐ Complete Owner's Guide (Français)
- ☐ Wiring Diagram (English Español Français)
- ☐ Installation Instructions (All Languages)
- ☐ Product Specifications Sheet (English)



ENLARGE IMAGE



- ☐ PRINT PAGE
- ☐ VIRTUAL KITCHEN
- ☐ WHAT IS INDUCTION?

Specifications

Product Code	EW30IS6CJS
Product Type	Ranges
Power Type	Induction
Size	30"
Installation Type	Slide-In
UPC Code	0-57112-10461-4
UPC Code	0-57112-10461-4
Colour	Stainless Steel
Certifications & Approvals	
Sabbath Mode (Star-K® Certified)	Yes
Agency Approval	CSA
Exterior Specifications	
Control Panel Finish	Stainless Steel
Cooktop Finish	Stainless Steel
Door Finish	Stainless Steel
Handle Colour	Stainless Steel
Drawer Finish	Stainless Steel

SLIDE-IN

Lot 39 BK
01/29/13

Cooking Controls	
Bake	Both Ovens
Broil	Variable
Convection Bake	Yes
Convection Broil	Yes
Convection Conversion	Yes
Convection Roast	Yes
Keep Warm	Both Ovens
Preheat	Integrated with Bake Functions
Slow Cook	Both Ovens
Self Clean	Lite, Med, Heavy
Oven Light	Yes
Defrost	Yes
My Favourite	Yes
Temperature Probe	Yes
Proof	Yes
Timer	Yes
Controls	Wave-Touch®
Dehydrate	Yes
Multi-Stage Cooking	Yes
Cook Duration	Yes
Cook Duration with End Time	Yes
Rapid Preheat	Yes
Control Lock	Yes
User Preferences	Yes
Keypad Entry of Time & Temperature Numerical	
Cooktop Specifications	
Cooking Surface	Black Ceramic Glass
Right Front	10" - 2,500/3,400 Watts (induction)
Right Rear	6" - 1,500/1,900 Watts (induction)
Left Front	8" - 2,400/3,400 Watts (induction)
Left Rear	7" - 1,900/2,600 Watts (induction)
Hot-Surface Indicator Light	4 (Integrated in display)
Electrical Specifications	
Power Supply Connection Location	Right Rear Bottom
Voltage Rating	240V / 208V, 60Hz
Connected Load (kW Rating) @ 240V	13.3 / 10.9
Amps @ 240 Volts	55.4 / 52.4
Minimum Circuit Required (Amps) 40A	
Capacities	
Oven 1 Capacity	4.2
Oven 2 Capacity	1.4
Oven Specifications	
Oven 1 Type	Main
Oven 1 Bake	8 pass 2,500 Watts
Oven 1 Baking System	True Hidden
Oven 1 Broil	8 pass 4,000 Watts

161 mto PK

Oven 1 Broiling System	Variable (300°F to 550°F)
Oven 1 Convection	2,500 Watts
Oven 1 Convection System	Variable 2-Speed Fan
Oven 1 Interior Height	16-1/2"
Interior Lighting	2 Halogen
Oven 1 Interior Width	24-1/8"
Oven 1 Rack Configuration 2 HD handle (glide), 1 Handle (fixed)	
Oven 1 Interior Depth	18-1/32"
Oven 1 Rack Positions	7 positions
Oven 1 Interior Height	16-1/2"
Oven 1 Interior Colour	Cobalt Blue
Oven 1 Interior Width	24-1/8"
Oven 1 Interior Depth	18-1/32"
Oven 1 Interior Colour	Cobalt Blue
Oven 1 Cleaning System	Self-Clean
Oven Window	Large
Oven 2 Specifications	
Oven 2 Type	Drawer
Oven 2 Bake	1,500 Watts
Oven 2 Interior Lighting	Incandescent
Oven 2 Rack Configuration	1 Rack
Oven 2 Interior Colour	Cobalt Blue
Oven 2 Window (Size)	Large
General Specifications	
Product Weight (lbs)	238
Shipping Weight (lbs)	258
Exterior Dimensions	
Height	35-5/8" - 36-5/8"
Width	30"
Depth (with 90° Door Open)	45-1/2"
Accessories	
Cleaning Sponge	Included
Porcelain Broiler Pan and Insert	Included

visit our blog

¹Select models only.

10/2/10 Rk

LOT 36 BR
01/29/13

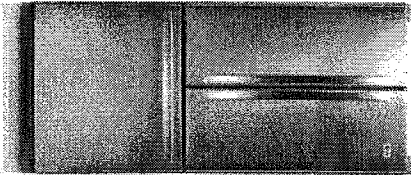

ENLARGE



Discontinued Product

French Door Styling In A 30" Space

3-DOOR FRENCH DOOR REFRIGERATOR (19.7CU.FT.)

LFC20745ST

MULTI-AIR FLOW COOLING
FRENCH DOOR STYLING
SOPHISTICATED DESIGN, INSIDE & OUT
ENVIRONMENTALLY FRIENDLY

0/5

WHERE TO BUY

Based on 0 user reviews

ADD TO COMPARE

TECHNICAL SPECIFICATIONS

REVIEWS

PRODUCT SUPPORT

3-DOOR FRENCH DOOR REFRIGERATOR (19.7CU.FT.)

LFC20745ST

GENERAL

Capacity	19.7 cu.ft.
Refrigerator Capacity	13.4 cu.ft.
Freezer Capacity	6.3 cu.ft.

FEATURE

Freezer Door Type	Drawer
MultiAir Flow System	Yes
Digital Temperature Controls	Internal LED Membrane
Door Alarm	Yes
LoDecibel Operation	Yes

REFRIGERATOR

No. of Shelves	4 Split
Shelf Style	4 Fixed
Canilevered Shelves	Yes
Shelf Construction	Tempered Glass
Bins	2 Humidity Crisper
Refrigerator Light	Reveal (2x60W)

REFRIGERATOR DOOR

No. of Door Bin	6
Door Bin Material	2 Piece Clear
Dairy Bin	Yes

FREEZER

Upper Drawer	Wire
Lower Drawer	Durabase Solid
Ice Maker	Optional
Divider	Yes
Express Freeze / Ice Plus	Ice Plus
Ice Bin	Yes
Freezer Light	40W

MATERIAL AND FINISHES

Foam Door Insulation	Cyclo Pentane (No CFC, No HCFC)
Door Style	Contour
Bio Shield Anti Bacterial Door Shield	Yes
Toe Grille	Yes
Back	Flush & Metal cover over mechanical parts
Handles	Matching Commercial Handles
Color	Stainless Steel
Cabinet Color	Grey

DIMENSIONS AND WEIGHT

Depth w/ Handles	34 1/2"
Depth w/o Handles	32"
Depth w/o Door	28 1/4"
Depth (Total with Door Open)	44"
Height to Top of Case	67 7/16"
Height to Top of Door Hinge	66 5/8"
Width	29 3/4"
Width (door open 90 deg. w/ handle)	37 1/2"
Width (door open 90 deg. w/o handle)	32 1/2"
Door Edge Clearance w/Handle	3 7/8"
Door Edge Clearance w/o Handle	1 3/8"
Installation Clearance	Sides 1/8" x Top 1" x Back 2"
Carton Dimensions (WxHxD)	32 1/8" x 72 5/8" x 36"
Weight (lbs.) Unit/Carton	245/271

COLLAPSE ALL SPECS

ENERGY USAGE

Energy Consumption (kWh/per yr)	454 kWh/ per yr
---------------------------------	-----------------

UPC CODE	772464026638
UPC Code	

WARRANTY

Warranty	1 Year parts and Labour, 7 Years on the Sealed System
----------	---

BACK TO TOP

This French Door refrigerator looks stunning inside and out. Stylish, contoured French doors open to display the foods you reach for most, while its 30"-wide design, easily fits most kitchens.

RECENTLY VIEWED

Lot 36 BR
01/29/13

Canadian Appliance Source

Search by Model #

Lowest Prices in Home & Kitchen Appliances. Guaranteed!
You have (0) items in your cart!

Sales: (416)-782-5900 Tuesday: 10:00am - 7:00pm
(877)-374-3439

Delivery/ Tuesday: 10:00am - 5:00pm
Order Status: (416)-782-5911

Home	Refrigerators	Freezers	Ranges	Cooktops	Wall Ovens	Microwaves	Hoods	Dishwashers	Washers	Dryers	Disposals	Brands
------	---------------	----------	--------	----------	------------	------------	-------	-------------	---------	--------	-----------	--------

Showroom Hours & Directions
Showroom Gallery - 120 Carviewhich Ave, Toronto, ON

Kitchen Suite Package Deal

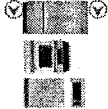

Washer & Dryer Package Deal



- Dimensions
- Height: 16 16/32"
- Width: 29 7/8"
- Depth: 15 1/4"
- Interior Height: 9 1/2"
- Interior Width: 21 29/32"
- Interior Depth: 14 19/32"
- Capacity (Cu. Ft.): 1.8
- Weight: 68
- Appearance
- Type: Over-the Range
- Control Type: Touchpad
- Optional Trim Kit: No
- Features
- Auto Defrost: Yes
- Child Lock: Yes
- Convection: No
- Cooktop Light: Halogen
- Fan Speeds: 3
- Hood: Yes
- Power Levels: 10
- Sensor Cook: Yes
- Speed Cook: Yes
- Stainless Steel Interior: No
- Turn Tables: Yes
- Turntable Size: 14 1/4"
- Venting Type: Optional Recirculating
- Technical Details
- Volts: 110 Volts
- Amps: 15
- Watts: 1000
- CFM: 300

LOT 36
01/29/13

GE Profile PVM1870SRC Over-the-Range Microwave, 30in, 1.8 cu. ft. with 1100 Cooking Watts, CircuWave Cooking System, Recessed Turntable, Full-Width Active Hidden Vent, 300 CFM Venting

Brand: GE Profile
Model: PVM1870SRC



Authorized Dealer

- **Printer Friendly**
- **Email A Friend**
- **Extended Warranty**

PVM1870SRC
Regular Price: **\$699.00**
13% Off: **-\$90.00**
Ends Jan. 29

Add to Cart

Today's Price: **\$609.00**

*We'll beat the difference by 10% on any competitor's advertised price!**

Call Now To Order!

(416)-782-5900

Tuesday Hours: 10:00 AM - 7:00 PM

[Showroom Location](#)

289/3
10/29/13

[+ Enlarge Picture](#)
Conditions: Brand new. In original manufacturer packaging.

[Click here to be the first to review it!](#)

Manufacturer Warranty	
Product covered with full Canadian manufacturer warranty. Minimum 1 year in home repair, parts & labor included.	
Extended Warranty For This Product	
2 Years Extended Warranty: \$89.99	
4 Years Extended Warranty: \$159.99	
Extended Warranty Information (PDF)	

Delivery Rate	
Pickup at Store: No Charge	
Enter Postal Code: <input type="text"/>	Calculate Shipping
Estimated Delivery Time (ETA): 2-5 Business Days	

DescriptionFeaturesSpecificationsLiteratureAccessoriesRebatesHow We ShipAbout Us

Specifications

Capacity	1.8
Oven Cavity (cu. ft.)	
Features	
Electronic Touch Controls	Yes
Style	Over-The-Range
Watts IEC-705 Test	1000
Procedure	
Display On/Off	Yes (Bilingual, English/Spanish)
Add 30 Seconds	Yes
Cooking System	Circuwave™ 1100
Defrost Type	Auto / Time / 1 lb Quick Defrost
Delay Start	Yes
Express Cook	1-6 Minutes
Instant On Controls	Yes
Micro / Time Cook	I & II
Power Levels	10
Program Cooking	Custom Pads
Rack Type	2 Wire Oven Racks
Cooktop Lighting	Halogen
Demo Mode	Yes
Interior Oven Light	Halogen
Night Light	Programmable
Child Lockout	Yes
Easy Mount Installation	Yes
Exhaust Fan	3 Speed Plus Boost (300 CFM) /
Reminders / Signals / Timers	
Cooking Complete Reminder	Yes.
Kitchen Timer / Timer (On/Off)	No / Yes
Reminder (24 hr)	Yes
Sound Volume Control	Yes
Sensor Controls	
Beverage	Yes
Chicken	Yes
Fish	Yes

Meats	Instant-on (Ground meats)
Popcorn	Yes
Potatoes	Yes
Reheat	Yes
Sensor Controls	Yes
Vegetables	Instant-on, 3 pads (canned, frozen, fresh)
SmartControl System	
Clock	Plus AM/PM Pad and Clocksaver
Concurrent Programming	Yes
Electronic Scrolling Digital Display	Yes
Help Pad	Yes
Variable Scroll Speed	Yes
Turntable	
Turntable	Glass
Turntable On / Off	Yes
Turntable Size (in.)	14.2
Appearance	
Case Colour	Black
Colour Appearance	SS
Designer-Style Handle	Sculptured (true stainless)
Door Colour	Stainless Steel
Hidden Vent	Yes
Other Colours Available	BB/WW
Weights & Dimensions	
Approximate Shipping Weight (lbs)	68
Cavity (W x H x D)	21-29/32 x 9-1/2 x 14-19/32
Overall Depth (excluding handle)	15 1/4
Overall Height	16-13/32
Overall Width	29-7/8
Electrical Requirements	
Electrical Input @ 120V Amperage	15
Electrical Input @ 120V Watts	1480
Frequency (MHz)	2450
Accessories	
Optional Side Filter Panel Kit	JX52
Recirculating Charcoal Filter Kit	JX81B
Warranty	
Limited Four-Year Magnetron Warranty (5 yrs Total)	Magnetron Tube; Part Only; In-Home
One-Year Warranty	Full ; Entire Appliance; Parts & Labour; In-Home

LOT 36 BK
01/29/13

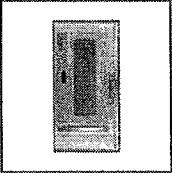

Frigidaire Professional
CPBNA189KF Over the Range
Microwave, 1.8 Cu. Ft.

Hot Deal!

Quick Ship ~~\$399.99 CAD~~
\$299.00 CAD

15amp



ZANCOR HOMES

WAIVER FOR STAINING OF STAIRS

Purchaser is aware that the hardwood flooring is a pre-finished product. It is finished in a factory, in a controlled environment and that the stairs in the home are finished on site. The Purchaser understands and accepts that although the Vendor will do their best to match the finish between the floors and the stairs, it is not possible to have an identical match, and that there MAY be shade differences between the two products.

I/We understand and fully accept the Terms as outlined by the Vendor, and authorize the Vendor to proceed as required.

Purchaser Signature: Jessica M. Steele

Date: _____

Purchaser Signature: William P. Steele

Date: _____

Site: BROOKLYN FOREST Lot Number: 36