

Lot 65 ✓
Phase 2
Model Messara (42-2) Elev A ✓

Colours Upgrade Report
Kings Ridge Print Date:08-Feb-13

GIUSEPPE FIDALE and ROSALIA FIDALE

FE With Agreement

- 1.LOT PREMIUM INCLUDES: - View Premium
 - ✓ 2.1ST UPGRADE OAK STAINED 3 1/4 INCH X 3/4 INCH HARDWOOD FLOORS TO MAIN HALL,DINING ROOM,LIBRARY,FAMILY ROOM, UPPER HALL.
 - ✓ 3.STAIN OAK STAIRS.
 - ✓ 4.UPGRADE # 3 RAILINGS AND PICKETS.
- PURCHASER IS AWARE THEY ARE NOT ENTITLED TO ANY FURTHER PROMOTIONS BY THE BUILDER.

ID	Group	Description	Invoice	Date Ordered	
7105	STRUCTURAL	Enlarge (4) basment windows to 24 inches high x 30 inches wide ✓	1387		
7909	DECOR	Install garage man door to rear of house as per drawing. *Purchaser has confirmed location with site super.	1511		
8117	COLOURS	STAIN - MAIN TO 2ND: Stain GRAPHITE to match stairs as close as possible *No charge as per Schedule E ✓	1545		
8118	COLOURS	HARDWOOD - FAMILY, MAIN HALL, UPPER HALL, DINING, LIBRARY: Install Upgrade 1 Wickham 3-1/4 inch OAK GRAPHITE *No charge as per Schedule E ✓	1545		
8119	COLOURS	RAILINGS - MAIN TO 2ND: Intall Upgrade 3 railings and pickets #683 Collar Alt. w/ 1/2 inch Plain Picket (Black) 2 3/4 INCH Grooved Oak Handrail 3 1/4 INCH Square Plain Oak Post w/Fancy Cap *No charge as per Schedule E ✓	1545		
8120	COLOURS	HVAC - KITCHEN: Gas line to stove ✓	1545		
8121	COLOURS	INTERSTONE QUOTE: *Slide in stove ✓	1545		
8122	COLOURS	QTK QUOTE:	1545		
8123	COLOURS	PLUMBING - MASTER ENSUITE: Delete diverter spout ✓	1545		
8124	COLOURS	Plumbing - Kitchen Client will be installing waterline after closing ✓	1545		

Colours.

STANDARD MouldING

Jan 28/13
 10165 PC

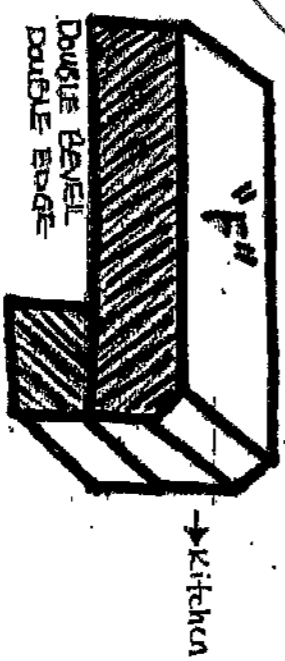
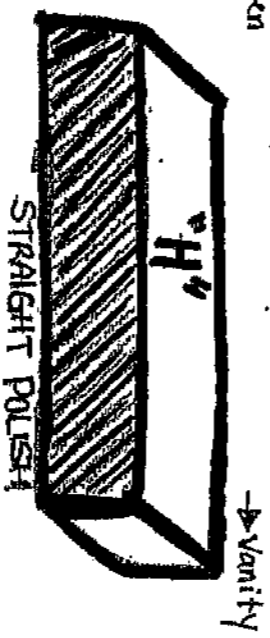
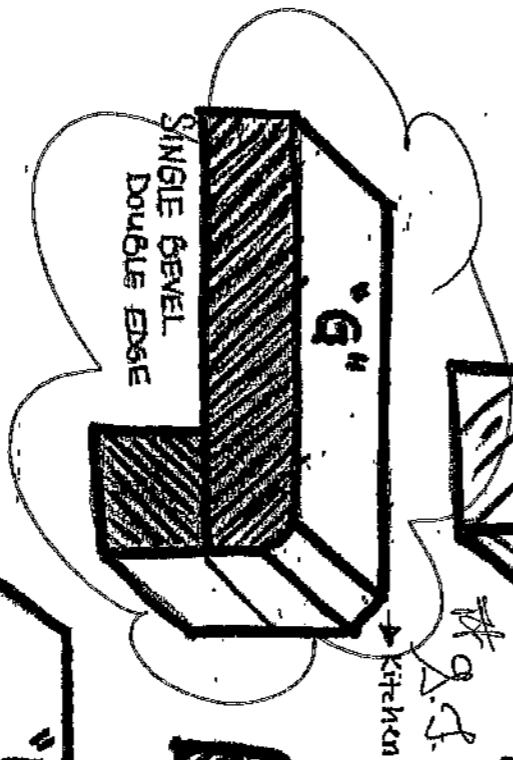
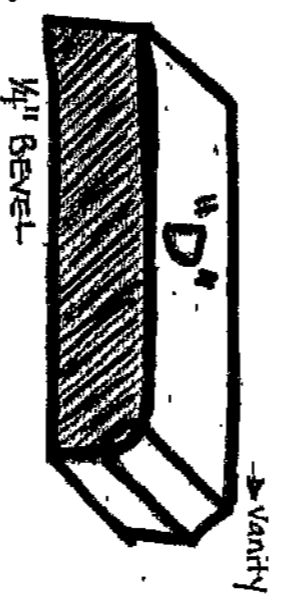
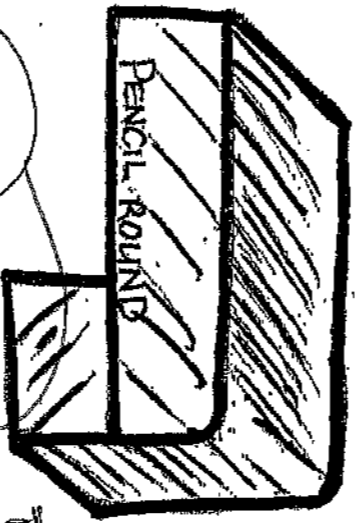
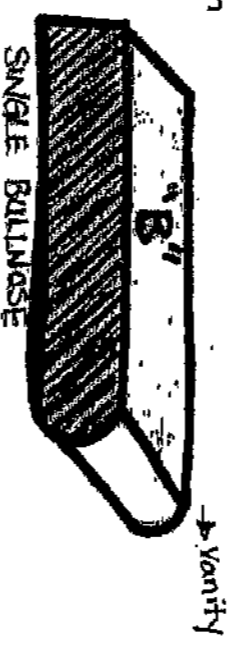
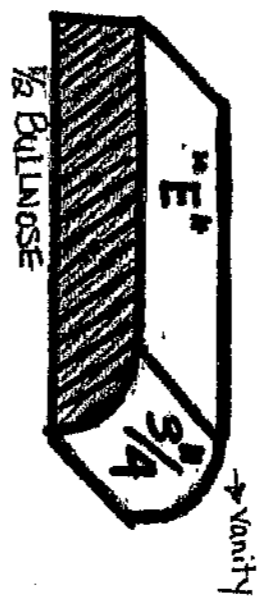
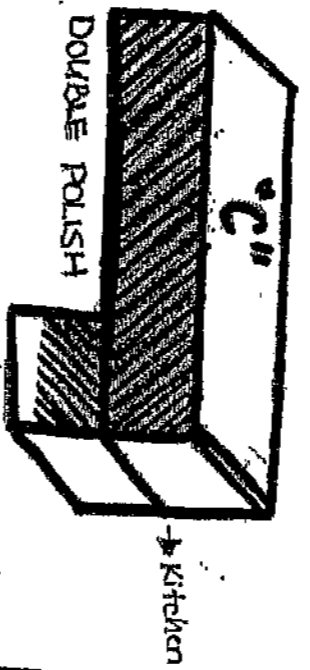
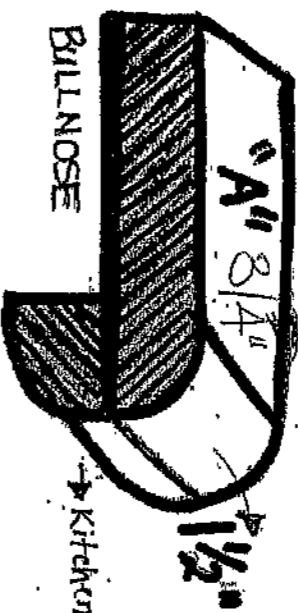

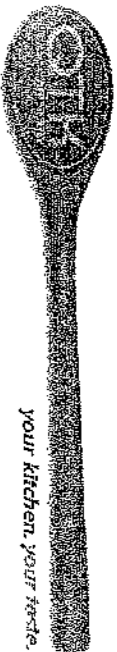

your kitchen, your needs.

QUALITY TOPS & KITCHENS LTD.
80 SANTE DRIVE, VAUGHAN, ON L4K 3C4
T 416.746.1811 F 905.761.5901
QTK.ca info@qtk.ca

PURCHASER:	GIUSEPPE & ROSALIA FIDALE	CONTRACTOR:	ZANCOR HOMES
ADDRESS:		SITE:	KING'S RIDGE
EMAIL:		MODEL TYPE	MESSARA (42-2) ELEV A
PHONE #:	905-669-2668	LOT #:	65
PHONE #:	416-271-3504 (CELL)	DATE:	October 30, 2012

The purchaser agrees to buy and Quality Tops & Kitchens Ltd. (QTK) agrees to sell and provide for the purchaser the following articles listed herein and with attached drawing in accordance to the terms and conditions described on the reverse of this agreement form.

ITEM #	QTY	DESCRIPTION	ROOM	PRICE
56	1	FRIDGE GABLE - 26" DEEP x 95 1/2"H	KITCHEN	
59	1	FRIDGE CABINET - 26" DEEP x 23"H	KITCHEN	
41	1	UPPER DIAGONAL CORNER CABINET 24" x 24" x 39 1/2" - 12" DEEP	KITCHEN	
	1	DELETE UPPER ABOVE STOVE	KITCHEN	N/C
Customers please note all garbage bins, spice baskets, magic corner baskets and other accessories will only be delivered AFTER you move in the house. Please call us to request delivery of these items after you move in. Thank you.				

GLASS TYPE (IF APPLICABLE):		
MESH TYPE (IF APPLICABLE):		SUB-TOTAL:
MIRROR TYPE (IF APPLICABLE):		

ALL CHANGES FINAL UPON SIGNING		
PLEASE READ ALL THE TERMS AND CONDITIONS ON THE REVERSE		
BY SIGNING BELOW YOU AGREE TO RECEIVE THE ITEMS LISTED HEREIN AND PAY (ACCORDING TO QTK'S		
PAYMENT POLICY), AND HAVE READ AND UNDERSTOOD THE TERMS & CONDITIONS AS OUTLINED ON		
THE REVERSE OF THIS DOCUMENT		
(THIS AGREEMENT IS NOT BINDING UNTIL SIGNED IN THE QTK AUTHORIZED SIGNATURE LINE BELOW)		
TOTAL		
13% H.S.T.		
GRAND TOTAL:		

BALANCE TO BE PAID IN FULL BY DUE DATE:	CUSTOMER INITIAL(S):
---	----------------------

CUSTOMER SIGNATURE: *Giuseppe Fidale* DATE: *Jan 28/13*
CUSTOMER SIGNATURE: *Rosalie Fidale* DATE: *Jan 28/13*

SALES REP NAME: GIOVANNI TOTO QTK AUTHORIZED SIGNATURE: _____
PAGE ____ OF ____ WHITE - CUSTOMER | YELLOW - FILE | GREEN - QTK ACCOUNTING

of 2.5.

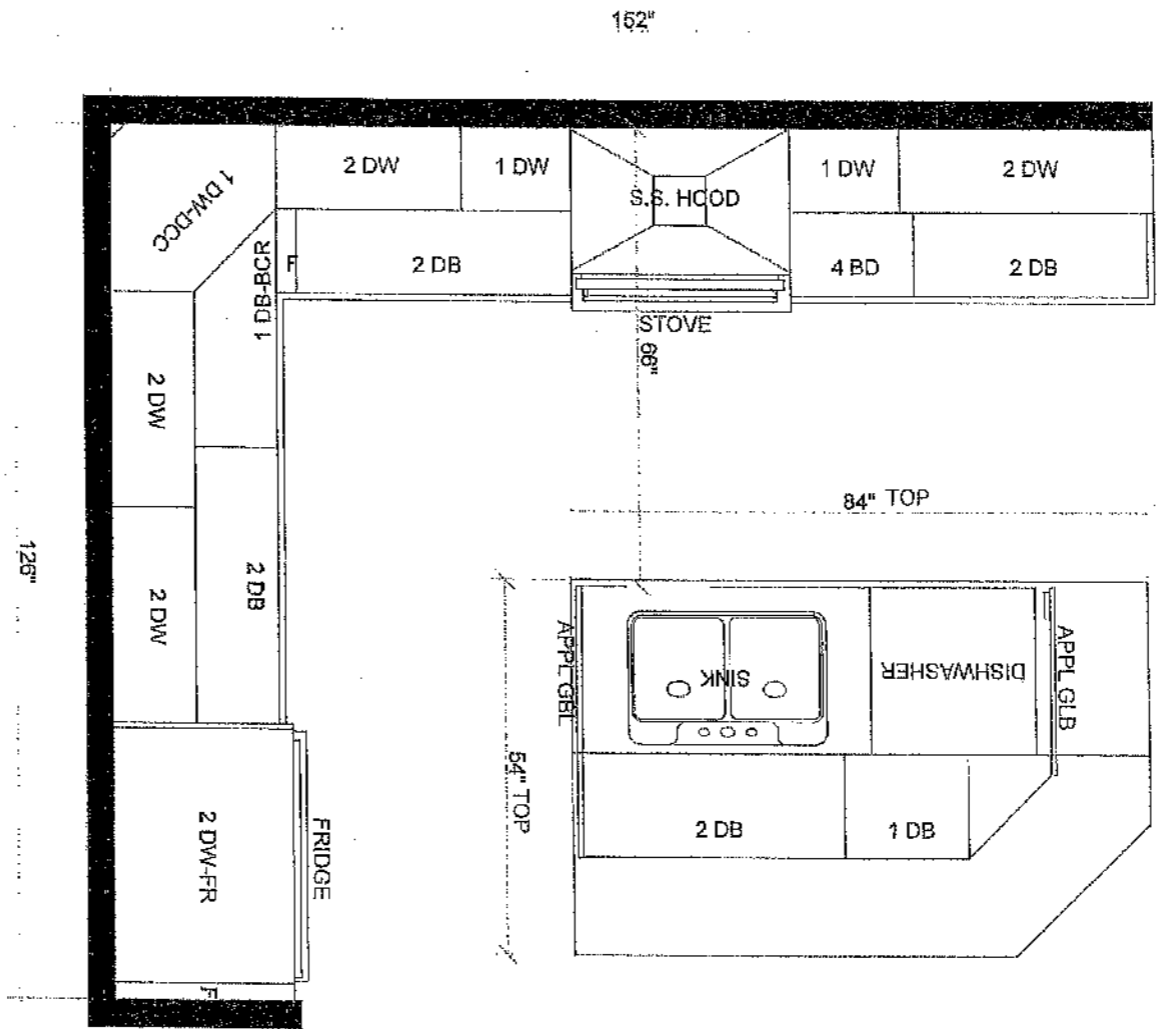

Let to 5 K/L
Jan 18/13

All dimensions given are subject to on-site verification and may be adjusted to suit job conditions. QTK reserves the right to modify the drawings or cabinet sizes as we deem fit. Customer acknowledges this drawing is to be used as a guide and should not order stone tops based solely on these dimensions.



This drawing is the intellectual property of QTK Fine Cabinetry and must not be released or copied unless applicable fee has been paid or job order placed.

Designed: 10.30.12
Printed: 10.30.12

ZANCOR HOMES, KINGS RIDGE
Design: LOT 65 KR
Drawing #: 1

Rev. 2.5

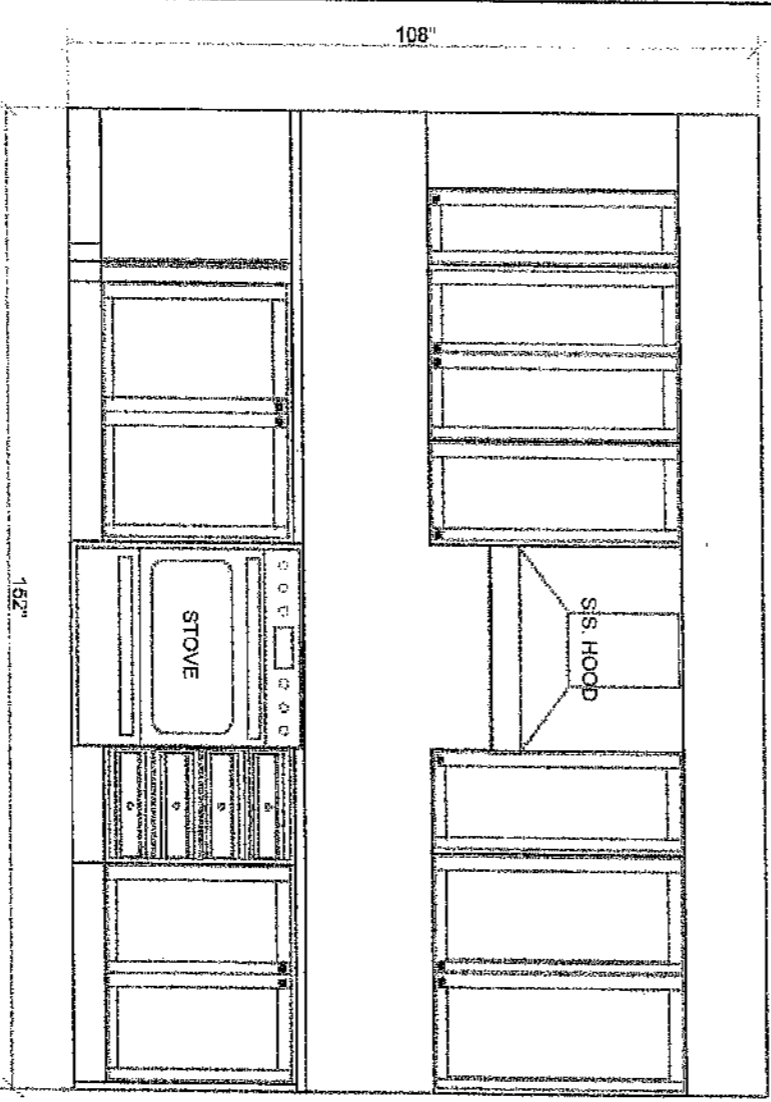
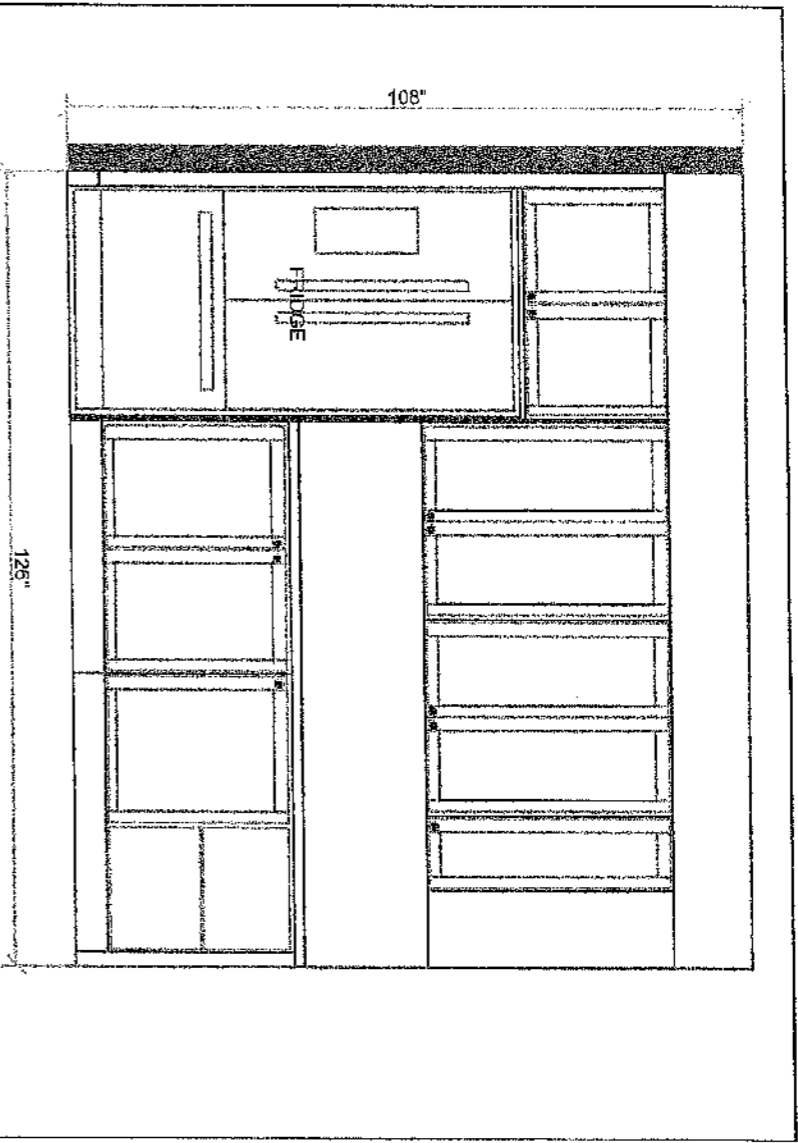

All dimensions given are subject to on-site verification and may be adjusted to suit job conditions. QTKA reserves the right to modify the drawings or cabinet sizes as we deem fit. Customer acknowledges this drawing is to be used as a guide and should not order stone tops based solely on these dimensions.



This drawing is the intellectual property of QTKA Fine Cabinetry and must not be released or copied unless applicable fee has been paid or job order placed.

Designed: 10.30.12
Printed: 10.30.12

ZANCOR HOMES, KINGS RIDGE
Design: LOT 65 KR

Drawing #: 1

1665 KR
Jan 28/13

Ref. 2.5.

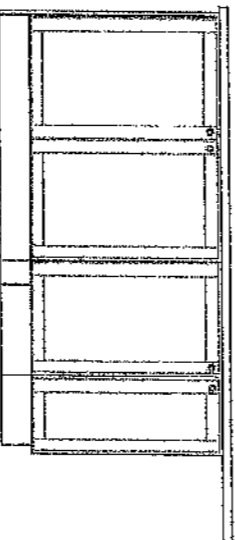
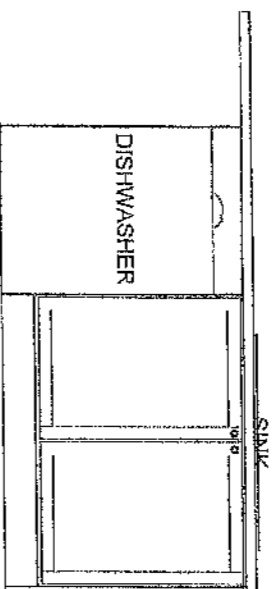

10/5/13
Jan 28/13

All dimensions given are subject to on-site verification and may be adjusted to suit job conditions. QTK reserves the right to modify the drawings or cabinet sizes as we deem fit. Customer acknowledges this drawing is to be used as a guide and should not order stone tops based solely on these dimensions.



This drawing is the Intellectual property of QTK Fine Cabinetry and must not be released or copied unless applicable fee has been paid or job order placed.

Designed: 10.30.12
Printed: 10.30.12

ZANCOR HOMES, KINGS RIDGE

Design: LOT 65 KR

Drawing #: 1

Standard Mantles

Hand 28/13

Vol 165 pp
Hand 28/13

