

- PE With Agreement

- LOOK OUT BASEMENT - LARGER BASEMENT WINDOW AT REAR OF HOME AND 5 FOOT X 7 FOOT DECK, CONSERVATION AND PREMIUM LOT

- KOHLER PLUMBING FIXTURES THROUGHOUT

- ENERGY STAR QUALIFIED HOMES

- NO HIDDEN CLOSING COSTS

- NATURAL FINISH OAK STAIRS FROM MAIN TO SECOND FLOOR

ENERGY STAR GAS FIREPLACE

HARDWOOD THROUGHOUT- (2/14 in X ¾ in NATURAL OAK PRE-FINISHED EXCEPT TILED AREAS AND BEDROOMS)

SPA RAIN SHOWERHEAD AND HANDHELD ON SHOWER SLIDE BAR, FRAMELESS GLASS SHOWER ENCLOSURE AND INDULGENT MARBLE COUNTERTOPS IN MASTER ENSUITE

- PURCHASER IS AWARE THAT THEY ARE NOT ENTITLED TO ANY FURTHER PROMOTIONS BY THE BUILDER.

Colours

ID	Group	Description	Invoice	Date Ordered	
✓ 2181	STRUCTURALS	Master Bedroom: Client request to have window by washroom to be standard operable window	357		
✓ 2182	STRUCTURALS	Family Room: Additional operable window	357	*	SEE ITEM #5146
✓ 2198	STRUCTURALS	8 See plan for location			
	STRUCTURALS	200 amp service	357		
✓ 5135	COLOURS	Hardwood: Family Room, Dining Room main hall and upper hall: Upgrade 1 Wickham OAK 3 1/4	699		
	COLOURS	Main to 2nd level: Stain stairs to match hardwood ✓	699		
	COLOURS	Tile: Breakfast, Kitchen, Foyer & Powder Room: Upgrade 1- 13 x 13 La Reserva- Grey 18990 ✓	699		
	COLOURS	Backsplash: Kitchen: Upgrade 1 Easy Ivory 4x4 ✓	699		
	COLOURS	Hardware: Upgrade cabinet hardware throughout. HR 06 ✓	699		
	COLOURS	Kitchen: Add breakfast bar ✓	699		
	COLOURS	AC Unit: R410A Refrigerant 14 SEER 2.0 Ton ✓	699		
		*Purchaser request to mount AC unit on wall bracket above ground. NOT TO BE installed on ground			
5142	COLOURS	Electrical: Kitchen- Move standard light centred over island ✓	699		
		* See sketch			
5143	COLOURS	Electrical: Main floor: 15 STD potlights	699		
		Family room: 4 potlights as per sketch, different switch from std switch			
		Dining Room: 4 potlights as per sketch, different switch from std switch ✓			
		Kitchen: 4 potlights as per sketch, different switch from std switch			
		Main hall: 3 potlights as per sketch ***DELETE STD light			
5144	COLOURS	Kitchen: upgrade STD hood fan to stainless steel ✓	699		
5145	COLOURS	Kitchen: waterline: Purchaser will install after closing ✓	699		
5146	COLOURS	Credit for family room opp window ✓	699		
		*STD as per black line			

ZANCOR HOMES COLOUR CHART

CABINETRY		HARDWARE		ZANCOR APPLIANCE PACKAGE			
Kitchen	Standard 1/4" Shaker Oak-Espresso ✓	HR 409 ✓		Appliance Package	No		
Servery	N/A	N/A		Gas Line to Stove	No	Waterline	No
Island	Standard 1/4" Shaker Oak-Espresso ✓	HR 409 ✓		PLUMBING	STANDARD	NOTES	
Master Ensuite	Standard Artic Thermal- White ✓	HR 06 ✓		Kitchen	STD		
Main/Twin	Standard Artic Thermal- White ✓	HR 06 ✓		Powder Room	STD		
2nd Ensuite	N/A	N/A		Master Ensuite	STD		
3rd Ensuite	N/A	N/A		Main/Twin	STD		
Laundry	STD	STD		2nd Ensuite	N/A		
Basement Bath	N/A	N/A		3rd Ensuite	N/A		
Other	N/A	N/A		Other	N/A		
COUNTERTOPS		EDGE		MIRRORS & ACCESSORIES			
Kitchen	7267-58 Concrete Stone	N/A		Mirrors	YES ✓		
Servery	N/A	N/A		Bathroom Accessories	YES ✓		
Island	7267-58 Concrete Stone	N/A		TRIM			
Master Ensuite	Bianco Carrara ✓	"D"		Casing/Baseboards	STD ✓		
Main/Twin	3522-58 Perlato Granite	N/A		Interior Doors	STD ✓		
2nd Ensuite	N/A	N/A		Interior Door Hardware	STD ✓		
3rd Ensuite	N/A	N/A		Exterior Door Hardware	STD ✓		
Laundry	Standard	N/A		PLASTER MOULDING			
Basement Bath	N/A	N/A		Crown Moulding	N/A ✓		
FLOOR & WALL TILES		WALL TILE INSERT	THRESHOLDS	HARDWOOD/CARPET			
Kitchen Floor	13 x 13 La Riserva- Grey 18990 ✓	No	Bianco	Living Room	N/A		
Breakfast Floor	13 x 13 La Riserva- Grey 18990 ✓	No	Bianco	Dining Room	Up 1 Wickham Oak 3 1/4 Walnut ✓		
Kitchen Bk.Splash	4 x 4 Easy Ivory ✓	No	Bianco	Family/Great Room	Up 1 Wickham Oak 3 1/4 Walnut ✓		
Main Foyer	13 x 13 La Riserva- Grey 18990 ✓	No	Bianco	Den/Study	N/A		
Main Hall	Hardwood	No	Bianco	Kitchen *(Waiver)	TILE		
Powder Room	13 x 13 La Riserva- Grey 18990 ✓	No	Bianco	Main Foyer *(Waiver)	TILE		
Laundry	13 x 13 Corte Milia- Grey 15040 ✓	No	Bianco	Main Hall	Up 1 Wickham Oak 3 1/4 Walnut ✓		
Mstr Ensuite Floor	13 x 13 New Albion- Grey ALN-03 ✓	No	Bianco	Upper Hall	Up 1 Wickham Oak 3 1/4 Walnut ✓		
Mstr Ensuite Shower	8 x 10 New Albion- Grey ALN-03 ✓	No	Bianco	Master Bedroom	Performa III 6304 Canvas ✓		
Mstr Ensuite Tub Wall	13 x 13 New Albion- Grey ALN-03 ✓	No	Bianco	Bedroom 2	Performa III 6304 Canvas ✓		
Mstr Ensuite Tub Deck	13 x 13 New Albion- Grey ALN-03 ✓	No	Bianco	Bedroom 3	Performa III 6304 Canvas ✓		
Master Shower Floor	2 x 2 White ✓	No	Bianco	Bedroom 4	Performa III 6304 Canvas ✓		
Main Bath/Twin Floor	12 x 12 Reflection- Olive ✓	No	Bianco	Carpet Underpad	STD		
Main Bath/Twin Wall	8 x 10 Reflection- Olive ✓	No	Bianco	Basement Foyer	N/A		
Main Bath/Twin Shower	n/A	No	Bianco	Other	N/A		
2nd Ensuite Floor	N/A	No	Bianco	STAIRS, RAILING & PICKETS			
2nd Ensuite Wall	N/A	No	Bianco	Main Flr. to 2nd Flr. Stair Finish/Stain:	Stain to match hardwood ✓		
2nd Ensuite Shower	N/A	No	Bianco	Main Flr. to 2nd Flr. Railing Details:	STD		
Basement Foyer	N/A	No	Bianco				
Other		No	Bianco				
FIREPLACE							
Location	Family Room ✓	Mantle	NF 23 ✓				
Insert & 4 PC Surround	STD and no surround ✓	Hearth	No	Main to Basement Railing Details: STD			
PAINT							
Kitchen/Breakfast	Warm Grey 22			White Paint Req'd	NO	Where to Paint	NO
Living Room	Warm Grey 22			NOTES			
Dining Room	Warm Grey 22						
Family/Great room	Warm Grey 22						
Den/Study	Warm Grey 22 ✓						
Main/Upper Hall	Warm Grey 22						
Master Bedroom	Warm Grey 22						
Bedroom 2	Warm Grey 22			DISCLAIMER			
Bedroom 3	Warm Grey 22			INITIALS			
Bedroom 4	Warm Grey 22			Colours of all materials are as close as possible to Builders selection but not necessarily identical due to dye lot variances in manufacturing/manufacturers. Due to construction progress some items may have been pre-selected or installed. In this event the Vendors's selection must be accepted by the purchaser			
Ensuite	Warm Grey 22			Any changes to the colour chart after signing are subject to a \$5000 administration fee plus costs			
Main/Twin	Warm Grey 22			Purchaser has checked and acknowledged accuracy of colour and selections before signing.			
2nd Ensuite	Warm Grey 22						
3rd Ensuite	Warm Grey 22						
Laundry	Warm Grey 22						
Powder Room	Warm Grey 22						
SITE:	Annex	LOT:	8A ✓				
PURCHASER(S):	ROGER & ELKE MORRIS ✓						
HOME #:	905-576-7088						
CELL #:	905-905-2948 / ELKE-905-447-7398						
EMAIL:	reesmorr@sogors.com						
MODEL:	Beila 40-03						
WOB/LOB:	402						
 * ITS THE RESPONSIBILITY OF ALL TRADES TO INFORM THE BUILDER OF ANY DESCREANCIES ON SKETCHES, PES AND/OR COLOUR CHART				Purchaser Signature			
				Date			
				Purchaser Signature			
				Date			
				Décor Consultant Signature			
				Date			
				Vendor Signature			
				Date			

Lot 8A

1812#

STDOPEABLE
WINDOW
6442
1644T OVER ISLAND
6442

2204 sq. ft.
STANDARD
1

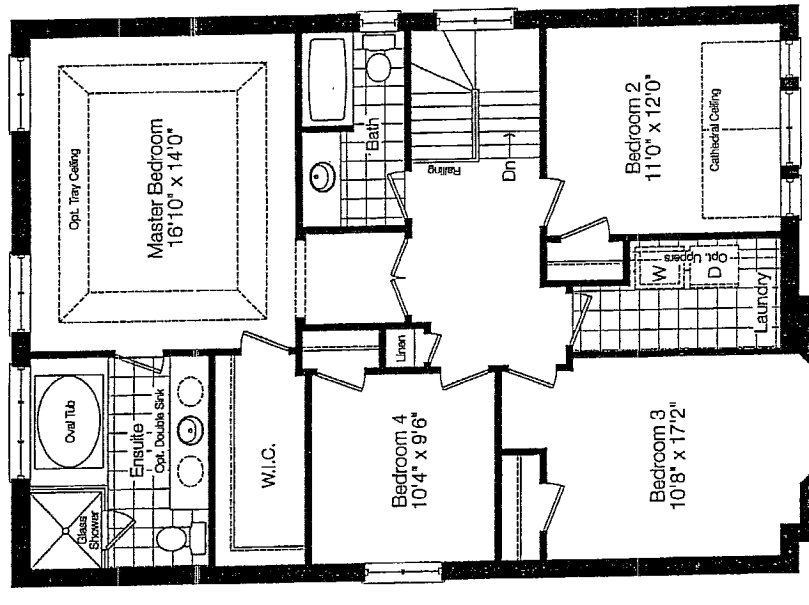
[illegible]

Ground Floor Elevator

Second Floor Elevator A'

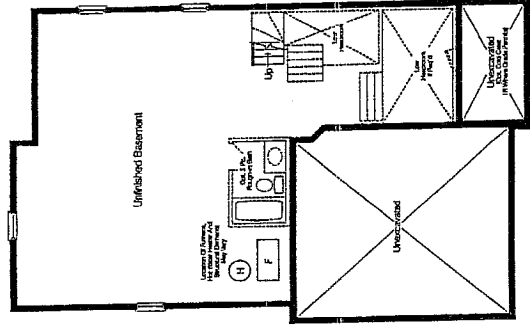

Basement Floor Elev. **A & X**

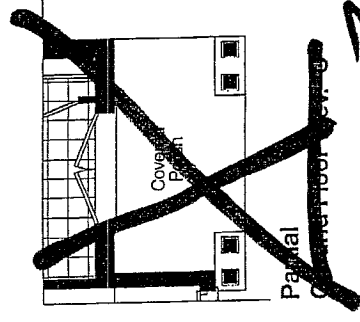

Second Floor Elevator

ZANCOR
HOMES

LOCAL, LEGENDARY & LASTING®

Presented (2006) at the 10th Annual Meeting of the American Psychological Association, Washington, DC, USA. Copyright 2006 by the author(s). All rights reserved. No part of this publication may be reproduced, stored in a retrieval system, or transmitted, in any form or by any means, electronic, mechanical, photocopying, recording, or by any information storage or retrieval system, without the prior written permission of the author(s).



ACKNOWLEDGEMENT OF RECEIPT FOR GRANITE AND MARBLE INFORMATION

Purchaser acknowledges receipt, understanding and acceptance of the following information as provided by the Vendor for Granite and Marble finishes.

- **GRANITE IS A 100% NATURAL PRODUCT** – Every stone has its own unique qualities and characteristics. These range from natural pitting to areas of crystal deposits embedded within the stone as well as the stone's unique motion and patterns. Being a natural product that is quarried right from the earth, it also possesses excellent wear, resistance and heat exposure qualities.
- **STONE HAS THE ABILITY TO REFLECT LIGHT DIFFERENTLY** – The same stone may appear to be different when viewed in various lighting conditions and different angles. The stone may also vary in colour or wave motion from one side to another depending on the concentration of minerals and crystals embedded within that stone. Thus, it is not always possible to book match the pieces of stone across joint or corner areas.
- **EDGE FINISHES ARE NOT ALWAYS EQUIVALENT TO THE TOP FINISH** – The difference is often due to the stone's physical properties, colour and with the finished edge bias being different than that of the top surface. The finish is also affected by the type of edge profile, which is chosen.
- **STONE IS A NATURAL PRODUCT THAT HAS MANY TINY PORES** – Liquids such as oils and red wine if left on the surface, may leave a ring. When using oil and red wines, it is best to wipe up the spills as soon as possible and leave the top to air dry.
- **VIEW AND PICK YOUR SLAB FROM OUR SUPPLIER'S INVENTORY** – The Vendor will arrange for the Purchaser to view and select the slab of stone that the countertop will be made from, prior to it being templated. This will provide the Purchaser the opportunity to confirm that the counter will meet the Purchaser's expectations, as much as possible.
- **PLEASE LOOK AT YOUR STONE CAREFULLY** – The Purchaser needs to be aware that the surface finish will have fissures, pits and pores. These naturally occurring features will vary in frequency and intensity depending on the type of stone chosen by the Purchaser.
- **GRANITE IS AN IGNEOUS ROCK** – Meaning the stone was formed by the cooling and solidification of magma deep within the earth. Granite is composed of grains or crystals of Quartz, Feldspar and Mica.
- **GRANITE IS A VERY HARD ROCK** – It is highly resistant to being scratched. On a scale of 1 to 10, Talc and Gypsum is at 1 and 2; Corundum and Diamond is at 9 and 10; and GRANITE is at 5 to 7. It withstands extreme temperatures, and is not nearly as prone to staining as marble is.
- **GRANITE COUNTER TOPS WILL HAVE JOINTS** – Purchaser aware one joint will be at each corner and on either side of slide-in-range (if applicable). It will also be where the length of the counter top exceeds the length of a stone slab. Slabs are usually approximately 5'x8'. A ¾" countertop weighs approximately 15 lbs., and a 1 ¾" counter top weighs as much as 23 lbs. per square foot.

MARBLE

- **MARBLE IS A METAMORPHIC ROCK** – This means it was formed with limestone. Calcite/Dolomite was put under pressure and high temperatures deep within the earth's crust. The heat and pressure altered its crystalline structure and introduced other minerals that produced the colours and veining that marble is commonly known for.
- **MARBLE IS VERY SOFT** – It can be scratched easily. On a scale of 1 to 10, Talc and Gypsum at 1 and 2; and Corundum and Diamond at 9 and 10; Marble is a 3 on that scale.
- **MARBLE IS VERY SUSCEPTIBLE TO STAINING AND ETCHING** – Marble is NOT recommended for use as a counter top in kitchens. Marble is often used in bathroom counter top – however is very porous and may show water stains.
- **MARBLE SHOULD NEVER BE CLEANED WITH SCOURING PADS** – Abrasive cleaners should NOT be used either, as they WILL scratch and damage the marble. Use the proper dedicated cleaners for marble counter tops.
- **CLEANING PRODUCTS** – Solutions containing lemon oil or vinegar should NOT be used.
- **COASTERS SHOULD BE USED** – Use under all glasses, particularly those containing alcohol or citrus juice.

Purchaser Signature: _____

Date: _____

Purchaser Signature: _____

Date: _____

Site: _____

Lot Number: _____



WAIVER FOR STAINING OF STAIRS

Purchaser is aware that the hardwood flooring is a pre-finished product. It is finished in a factory, in a controlled environment and that the stairs in the home are finished on site. The Purchaser understands and accepts that although the Vendor will do their best to match the finish between the floors and the stairs, it is not possible to have an identical match, and that there MAY be shade differences between the two products.

I/We understand and fully accept the Terms as outlined by the Vendor, and authorize the Vendor to proceed as required.

Purchaser Signature: _____

Date: _____

Purchaser Signature: _____

Date: _____

Site: _____

Lot Number: _____

STANDARD MOULDING

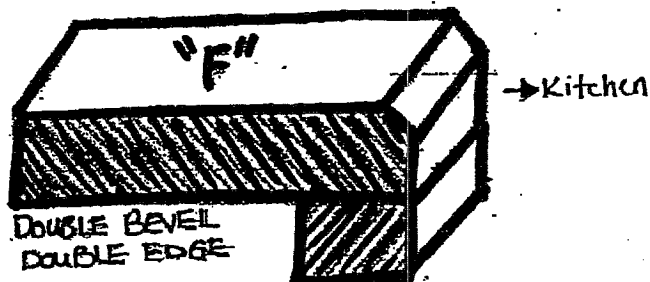
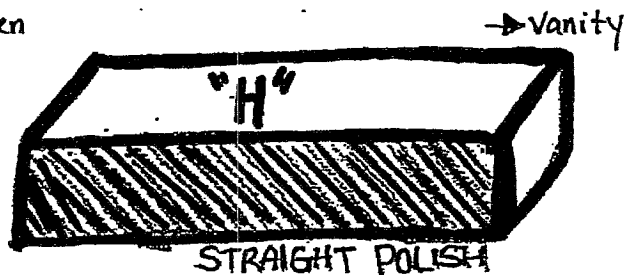
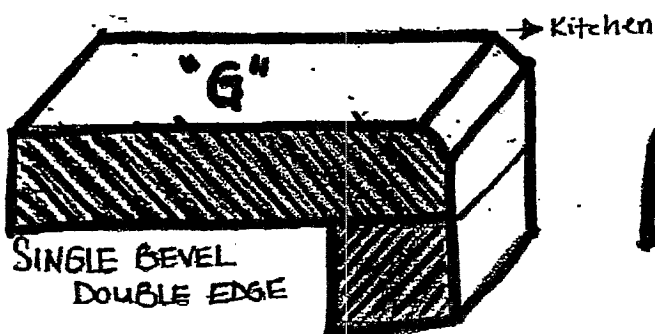
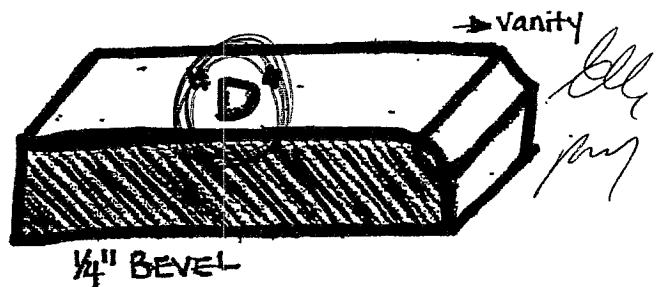
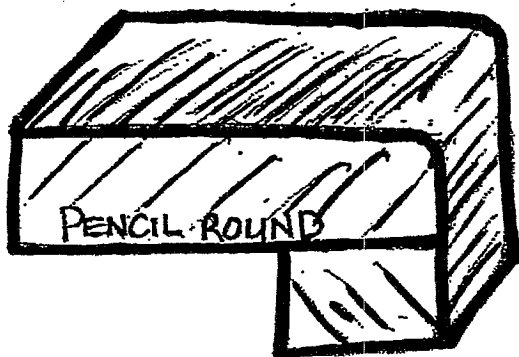
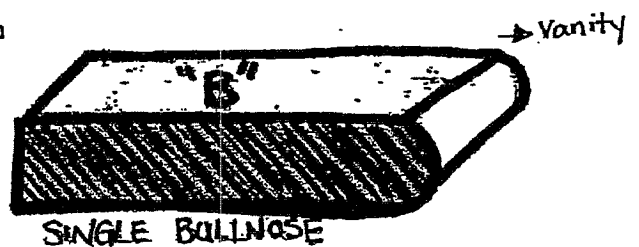
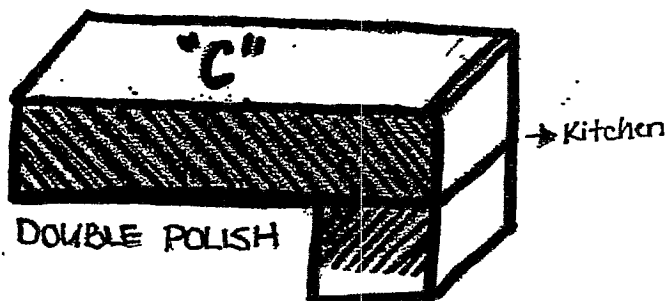
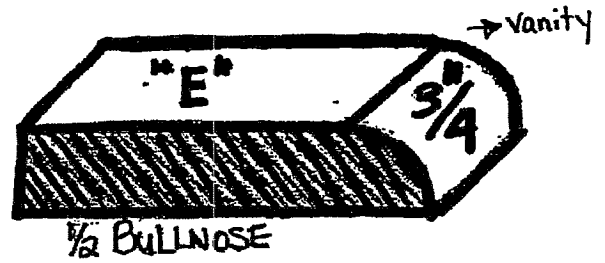
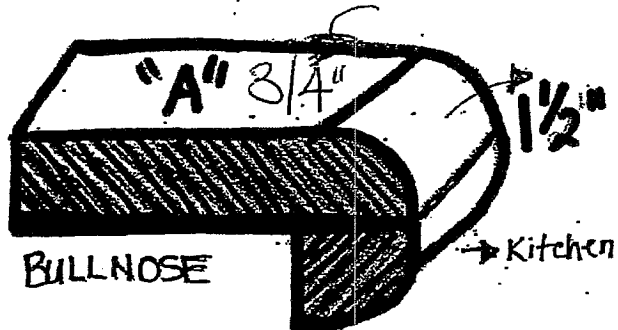

LOT 8A
5-14-13

LOT 8A

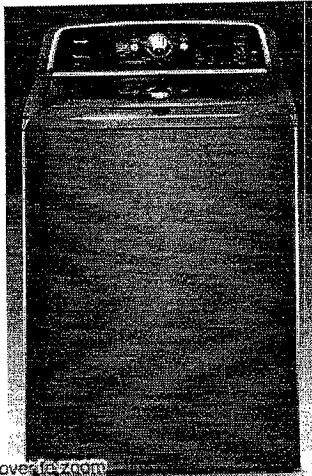

Mouse over to zoom

SKU: 20252700 Online ID: 1576679 | 1576679
Click to change image.



SHARE

Maytag Washer (4.1 Cu. Ft. IEC)
MVWX700AG

Featured value through Tuesday, May 28, 2013

Description Dimensions

Clean Machine. Our 4.1 cubic foot Maytag top load washer is both tough on dirt and gentle yet environmentally friendly. To get your clothes cleaner, this washer is equipped with a PowerWash cycle that supplies vigorous motion and an extra-deep rinse. Another feature, EcoConserve, uses low water volume for a better clean through targeted wash action, allowing detergent to reach laundry and pretreat stains better. Hoses must be purchased separately.

- | | |
|------------------|--|
| Finish: | Granite Grey |
| Material: | Mixed Materials |
| Unique Features: | PowerWash™ cycle provides extra cleaning action and a deep rinse that tackles your dirtiest loads.

Low Water Wash with EcoConserve uses less water and gets better cleaning performance through concentrated wash action, as it enables the detergent to penetrate better and pretreat soils with a concentrated mix.

Advanced Vibration Control provides better off-balance load movement control.

This washer uses the IntelliClean™ impeller rather than an agitator, delivering increased |

This Item:	Item Name	Finish	Price	Add
	Maytag Washer (4.1 Cu. Ft. IEC) MVWX700AG	Granite Grey		

- Find more
- Show more Washers from Maytag
 - Show me all Washers

- Find out more
- Ask a question about this item
 - Find a store where I can see this item
 - E-mail this item to a friend



Sign up to receive Special Offers! Enter your email address here



8A BROOKLIN
May 14/13

LOT 8A



Select a product



Product Search



[Advice & Ideas](#) [Customer Service](#) [Ads & Promos](#) [Where to Shop](#) [Français](#)

[RANGES](#) [BUILT-IN WALL OVENS](#) [COOKTOPS](#) [MICROWAVES](#) [KITCHEN HOODS AND VENTS](#)

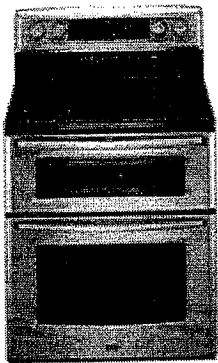

Maytag® Gemini® Double Oven Freestanding Electric Range

Dimensions

Dimension	inches (cm) / lbs (kg)
Height	47 1/8" (119.7 cm)
Width	29 15/16" (76.04 cm)
Depth	28 1/2" (72.39 cm)

Dimensions shown are for planning purposes only. For complete information, see installation instructions packed with product.

Stainless Steel | YMET8665XS

®Registered trade-mark/™ Trade-mark of Maytag Corporation or its related companies. Used under license by Maytag Limited in Canada

Brooklin
SA May 14/13

Lot 8A

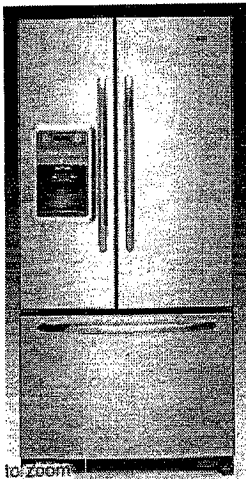

Mouse over to zoom

SKU: 20222694 Online ID: 1587531 | 1587531
Click to change image.



SHARE

Maytag Refrigerator (21.8 Cu. Ft.)
MFI2269VEM

Featured Value through Tuesday, May 28, 2013

Description Dimensions



- Refrigerator (21.8 Cu. Ft.)
- Width: 32.6"
 - Height: 70.1"
 - Depth: 31.9"
 - Other Dimensions: Depth with handles: 34.8"

This Item:	Item Name	Finish	Price	Add
	Maytag Refrigerator (21.8 Cu. Ft.) MFI2269VEM	Stainless Steel		

- Find more
- ▶ Show more Refrigerators from Maytag
 - ▶ Show me all Refrigerators

- Find out more
- ▶ Ask a question about this item
 - ▶ Find a store where I can see this item
 - ▶ E-mail this item to a friend



Sign up to receive Special Offers! Enter your email address here



8A Brooklyn
May 14/13

LOT 8A

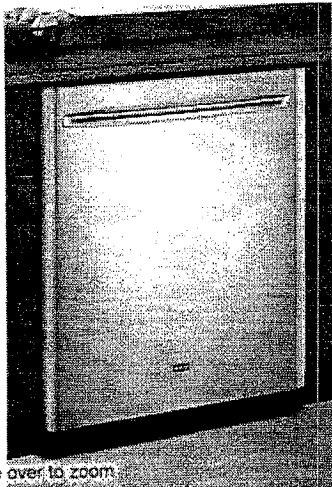

Mouse over to zoom

SKU: 20277594 Online ID: 1587538 | 1587538
Click to change image.



SHARE

Maytag Dishwasher MDB7759SAS

Featured Value through Tuesday, May 28, 2013

Description Dimensions



- Dishwasher
- Width: 24"
 - Height: 34.5"
 - Depth: 27.5"

This Item:	Item Name	Finish	Price	Add
	Maytag Dishwasher MDB7759SAS	Stainless Steel		

- Find more
- ▶ Show more Dishwashers from Maytag
 - ▶ Show me all Dishwashers

- Find out more
- ▶ Ask a question about this item
 - ▶ Find a store where I can see this item
 - ▶ E-mail this item to a friend



Sign up to receive Special Offers! Enter your email address here

8A May 14/13
Brooklyn

Lot 8A

Washers & Dryers Refrigerators Freezers Ranges Microwaves Dishwashers

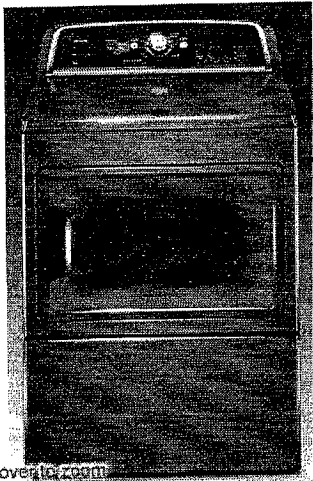

Mouse over to zoom

SKU: 20251700 Online ID: 1576673 | 1576673
Click to change image.



SHARE

Maytag Dryer YMEDX700AG

~~Featured Value~~ through Tuesday, May 28, 2013

Description Dimensions



- Dryer
- Width: 27"
 - Height: 43"
 - Depth: 29.5"

This Item:	Item Name	Finish	Price	Add
	Maytag Dryer YMEDX700AG	Granite Grey	<div>Click here to view the price of this item.</div>	<div>Add to Shopping Cart</div>

- Find more
- ▶ Show more Dryers from Maytag
 - ▶ Show me all Dryers

- Find out more
- ▶ Ask a question about this item
 - ▶ Find a store where I can see this item
 - ▶ E-mail this item to a friend



Sign up to receive Special Offers! Enter your email address here



Broken 8A
May 14/13.