

Lot Unit 23 Block E
Phase Parkview
Model Sussex (T5) Elev B

Colours Upgrade Report
Brooklin Print Date:23-Dec-14

KATHY GURR and STEVEN GURR

PE With Agreement

- 1. BONUS: FIVE THOUSAND DOLLARS (\$5000) TOWARDS UPGRADES FROM BUILDERS SAMPLES
- PURCHASER IS AWARE THAT THEY ARE NOT ENTITLED TO ANY FURTHER PROMOTIONS BY THE BUILDER.
- 2. PURCHASER REQUEST FOR EXTRAS DATED JULY 10TH 2014

STRUCTURES / COLOURS

ID	Group	Description	Invoice	Date Ordered	
7361	INCLUDED IN OFFER	1. OPTIONAL FIREPLACE TO FAMILY ROOM	1034		
7847	STRUCTURALS	Master ensuite - frameless glass shower	1133		
7950	STRUCTURALS	Master bedroom - additional operable window	1133		
7951	STRUCTURALS	Main Bath - frameless glass shower	1133		
7952	STRUCTURALS	Gas line to stove	1133		
7953	STRUCTURALS	Main floor, upper hall and master bedroom - smooth ceilings	1133		
7954	STRUCTURALS	2ND FLOOR CHANGE - 1. standard main bath ro be converted to laundry room with tub and linen shelves. 2. Bathroom with glass shower to be added as per sketch with seat & half wall 3. bathroom window to be operable 4. NOTE*****New dimensions for laundry, master walk in closet and master ensuite 5. NOTE****operable winodows in master bed 6. NOTE****swap closet locations for bed 2 & 3	1133		
7989	STRUCTURALS	CLARIFICATION - 1. Main bathroom only has ONE entry door 2. Main bathroom to have operable window	1146		
8100	COLOURS	Kitchen - Extended cabinets	1167		
8101	COLOURS	Kitchen - 4 inch crown moulding with furring panel. (installed to ceiling)	1167		
8102	COLOURS	Kitchen - upgrade 2 cabinets	1167		
8103	COLOURS	Valance in kitchen - electrical installed after closing	1167		
8104	COLOURS	Deep uppers above fridge	1167		
8105	COLOURS	Kitchen - upper corner cabinet with glass and stain	1167		
8106	COLOURS	Kitchen - base corner cabinet with lazy suzan	1167		
8107	COLOURS	built-in oven micro with pots pans drawers - New Image to confirm amount of pot and pan drawers underneath	1167		
8108	COLOURS	Kitchen - sink drawer with plastic insert	1167		
8109	COLOURS	Waterline to be installed after closing	1167		
8110	COLOURS	Steam oven - 20 amp, no charge in lieu of 40 amp	1167		
8111	COLOURS	Wolf range - 30 amp (granite installed after closing by purchaser, no cut out charge)	1167		
8112	COLOURS	2 door pantry beside built-in oven microwave with 4 pull out drawers	1167		
8113	COLOURS	Kitchen cabiinet upgrade hardware	1167		
8114	COLOURS	Kitchen and foyer - hardwood upgrade 4	1167		
8115	COLOURS	Main floor - standard hardwood areas upgrade 4	1167		
8116	COLOURS	stain stairs	1167		

Lot Unit 23 Block E
Phase Parkview
Model Sussex (T5) Elev B
KATHY GURR and STEVEN GURR

Colours Upgrade Report
Brooklin Print Date:23-Dec-14

8117	COLOURS	all bedrooms - 1st upgrade underpad	1167		
8118	COLOURS	Master ensuite - bank of drawers	1167		
8119	COLOURS	Master ensuite - upgrade 1 cabinets	1167		
8120	COLOURS	Master ensuite - upgrade 5 tiles (surround tub deck and wall)	1167		
8121	COLOURS	Master ensuite - upgrade 5 shower wall tile STACKED	1167		
8122	COLOURS	Main bathroom - upgrade 4 floor tile	1167		
8123	COLOURS	Main bathroom - upgrade 1 wall tiles	1167		
8124	COLOURS	Main bath - upgrade 1 cabinets	1167		
8125	COLOURS	Main bath - bank of draers installed as per sketch	1167		
8126	COLOURS	Launddry room - Travertino Bianco	1167		
8127	COLOURS	No mirror in powder room	1167		
8128	COLOURS	no bathroom accessories	1167		
8129	COLOURS	Kitchen - move standard light over island sep switch from 5 potlights	1167		
8130	COLOURS	Family - delete standard, install 6 potlights. 2 on one switch 4 on other switch	1167		
8131	COLOURS	***STRCUTRAL NOTE- DRAIN IN LAUNDRY ROOM OT BE INSTALLED	1167		
8132	COLOURS	Living - 2 standsard potlights sep switch	1167		
8133	COLOURS	Foyer - install standasrsd light 4 ft from door centre to door	1167		
8134	COLOURS	Foyer - intsall 2 std potlights as per sketch sep switch	1167		

7ANCOR HOMES COLOUR CHART

CABINETRY / COUNTERTOPS						
	DOOR STYLE	HARDWARE	COUNTERTOP	EDGE		
Kitchen	Venetian Maple Espresso	H800 BC	White Laminate	N/A		
Island	Venetian Maple Espresso	H800 BC	White Laminate	N/A		
Servery	N/A	N/A	N/A	N/A		
Master Ensuite	Mosaic Mayflower Brown Stain Maple	K300BC	7022-58	N/A		
Main/Twin	Cambridge White MDF	K300BC	TBD	N/A		
2nd Ensuite	N/A	N/A	N/A	N/A		
3rd Ensuite	N/A	N/A	N/A	N/A		
Laundry	N/A	N/A	N/A	N/A		
Basement Bath	N/A	N/A	N/A	N/A		
TILES				INSERTS	THRESHOLDS	
Kitchen Floor	N/A		No	wood		
Breakfast Floor	N/A		No	wood		
Kitchen Bk.Splash	N/A		No	wood		
Main Foyer	N/A		No	wood		
Main Hall	N/A		No	wood		
Powder Room	13 x 13 Corte Milia Beige		No	wood		
Laundry	18 x 18 Travertino Bianco		No	wood		
Mud Room	13 x 13 Corte Milia Beige		No	wood		
Basement Foyer	N/A		No	wood		
Mstr Ensuite Floor	12 x 24 Stone Rain White		No	Perlato		
Mstr Ensuite Shower	4 x 16 colour and Dimention collections Bone		No	Perlato		
Mstr Ensuite Tub Wall	12 x 24 Stone Rain White		No	Perlato		
Mstr Ensuite Tub Deck	12 x 24 Stone Rain White		No	Perlato		
Master Shower Floor	2 x 2 White		No	wood		
Main Bath/Twin Floor	18 x 18 Travertino Bianco		No	Perlato		
Main Bath/Twin Wall	9 x 18 Travertino Bianco		No	Perlato		
Main Bath/Twin Shower flr	2 x 2 White		No	wood		
Basement Ensuite Floor	N/A		No	wood		
2nd Ensuite Wall	N/A		No	wood		
2nd Ensuite Shower	N/A		No	wood		
HARDWOOD / CARPET						
Living Room	Upgrade 4 Oak buckingham 3 1/4 inch handscraped					
Dining Room	Upgrade 4 Oak buckingham 3 1/4 inch handscraped					
Family/Great Room	Upgrade 4 Oak buckingham 3 1/4 inch handscraped					
Den/Study	N/A					
Kitchen *(Waiver)	Upgrade 4 Oak buckingham 3 1/4 inch handscraped					
Main Foyer *(Waiver)	Upgrade 4 Oak buckingham 3 1/4 inch handscraped					
Main Hall	Upgrade 4 Oak buckingham 3 1/4 inch handscraped					
Upper Hall	Upgrade 4 Oak buckingham 3 1/4 inch handscraped					
Master Bedroom	STD T-04					
Bedroom 2	STD T-04					
Bedroom 3	STD T-04					
Bedroom 4	N/A					
Carpet Underpad	Upgrade 1					
Basement Foyer	N/A					
Other	N/A					
FIREPLACES						
LOCATION	Family Room	MANTLE	NF8			
INSERT & SURROUND	Nero marquina	HEARTH	No			
MIRRORS & ACCESSORIES		PLASTER MOULDING				
Mirrors	See Pes	Crown Moulding	No			
Bathroom Accessories	No	Location	No			
Purchaser has reviewed the colour chart			Site/lot			
FOR TRADE USE			Parkview		23	
Any upgrades in the colour chart must be accompanied with a PES. It is the responsibility of all Trades to inform the builder of any discrepancies on sketches, PES and/or colour charts PRIOR to installation.			Purchaser Initial		Vendor	
** PAGE 1 OF 2 **			44		PC	

Any upgrades in the colour chart must be accompanied with a PES. It is the responsibility of all Trades to inform the builder of any discrepancies on sketches, PES and/or colour charts PRIOR to installation.

ZANCOR HOMES COLOUR CHART

STAIRS, RAILING & PICKETS & STAIR STAIN

Stair Stain / Species:	Stain to match	
Main to 2nd Railing Details:	STD	
Main to Basement Railing Details:	STD	
WHITE Paint Req'd & Where:	N/A	

TRIM

Casing/Baseboards	STD	
Interior Doors	STD	
Interior Door Hardware	STD	
Exterior Door Hardware	STD	

PAINT

Kitchen/Breakfast	Oyster White 25	Master Bedroom	Oyster White 25
Living Room	Oyster White 25	Bedroom 2	Oyster White 25
Dining Room	Oyster White 25	Bedroom 3	Oyster White 25
Family/Great room	Oyster White 25	Bedroom 4	Oyster White 25
Den/Study	Oyster White 25	Ensuite	Oyster White 25
Main/Upper Hall	Oyster White 25	Main/Twin	Oyster White 25
Laundry	Oyster White 25	Basement bath	Oyster White 25
Powder Room	Oyster White 25	3rd Ensuite	Oyster White 25

PLUMBING- UPGRADES TO BE DETAILED ON PES

	FIXTURES	FAUCETS	NOTES
Kitchen	STD	STD	
Powder Room	STD	STD	
Master Ensuite	STD	STD	
Main/Twin	STD	STD	
2nd Ensuite	STD	STD	
BASEMENT	STD	STD	
Other	STD	STD	

ZANCOR APPLIANCE REQUIREMENTS

Appliance Package received in 'Schedule E'		YES / NO	Package Name:
	UPG (SEE PES)	DECLINED	NOTES
GAS LINE	Yes		
WATERLINE to Fridge	No		
Hood Fan Venting SIZE	6 inch		
ELECTRICAL for Built-in Oven	Yes		
ELECTRICAL for Built-in Micro / OTR	Yes		
ELECTRICAL for Gas Stove / Cooktop	Yes		
ELECTRICAL for Bar Fridge	N/A		

DISCLAIMER

INITIALS

Colours of all materials are as close as possible to Builders selection but not necessarily identical due to dye lot variances in manufacturing/manufacturers. Due to construction progress some items may have been pre-selected or installed. In this event the Vendor's selection must be accepted by the purchaser			KG	
Any changes to the colour chart after signing are subject to a \$5000 administration fee plus costs			KG	
Purchaser has checked and acknowledged accuracy of colour and selections before signing.			KG	

SITE:	Parkview	LOT: 23	
PURCHASER(S):	STEVE GURR		Purchaser Signature 11/20/14
HOME #:			Date
CELL #:			
EMAIL:			Purchaser Signature 11/20/14
			Date

FOR TRADE USE

Any upgrades in the colour chart must be accompanied with a PES.

It is the responsibility of all Trades to inform the builder of any discrepancies on sketches, PES and/or colour charts PRIOR to installation.



Purchaser Signature
11/20/14

Decor Consultant Signature
Date

*** PAGE 2 OF 2 ***

Vendor Signature Date

2ND Floor

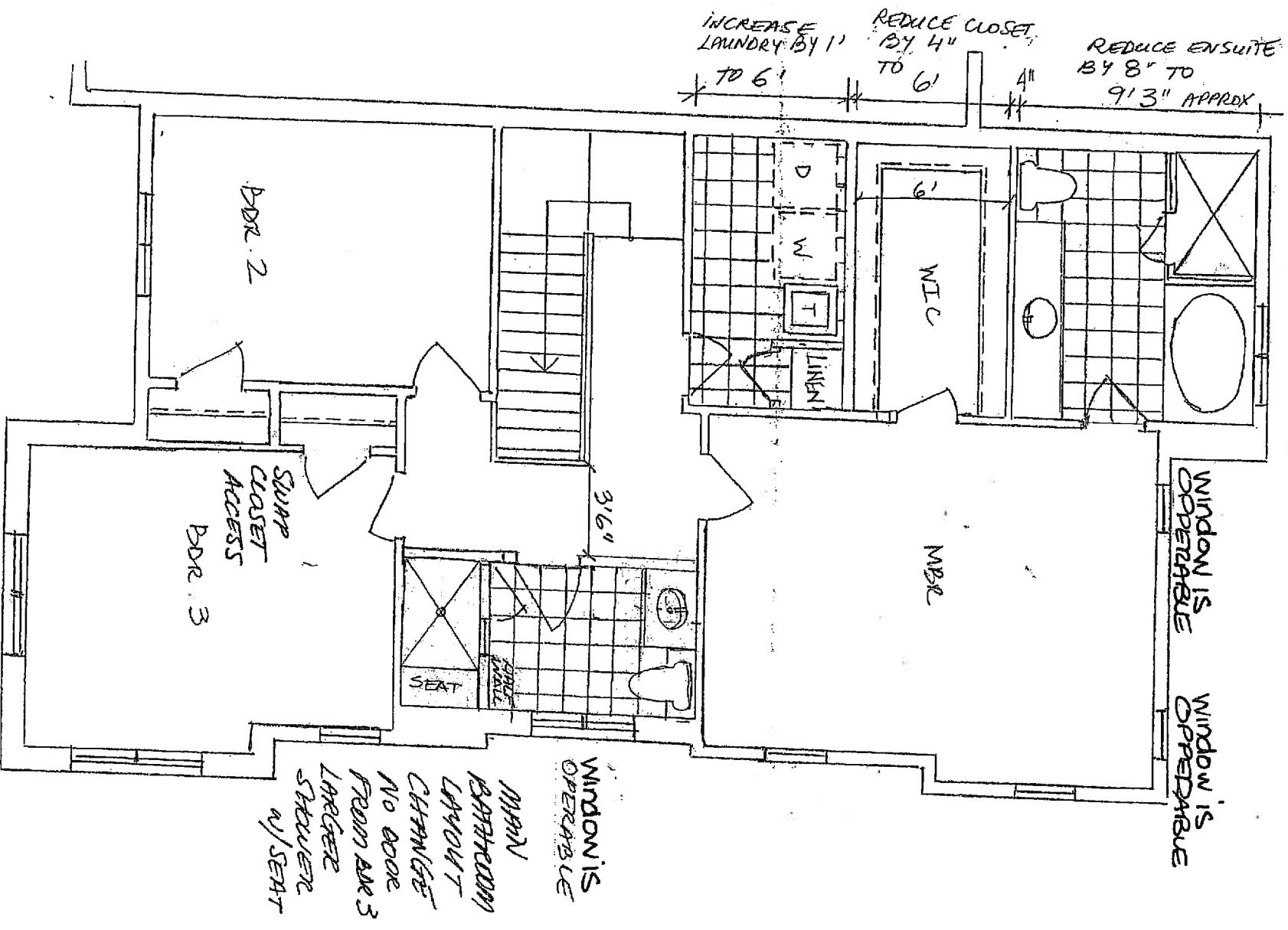

FC DEC 23 2014

PREVIEW TOWNH
UNIT 23 BLOCK E

K. J. J.

December 10th, 2014.

LOT 23
PARKVIEW

HARDWOOD FLOORING IN LIEU OF TILED AREAS WAIVER

REGARDING PROPERTY KNOWN AS:		Plan 40M-2352, Block # _____ Unit # <u>25</u>
		_____, Brooklin, Ontario
PURCHASER:	<u>STEVE GURR</u>	
VENDOR:	Zancor Homes (Parkview) Ltd.	
DATE OF OFFER:		

I/We, STEVE GURR, the owner/s of Block # _____ Unit # _____ in Registered Plan # 40M-2352, confirm request for the installation of hardwood floors in the following areas of the above-mentioned property:

- ☒ Kitchen/Breakfast Area
- ☐ Powder Room
- ☐ Main Bathroom
- ☐ Ensuite Bathroom
- ☐ Laundry Room
- ☒ Other (Specify) Foyer

I/We understand hardwood flooring is classified as a porous material and as such not recommended by the Builder in these areas. I/We understand there is a concern due to possible water and other substances being frequently splashed or spilled onto the floor and in contravention of Ontario Building Code Section 9.30.1.2 (1) "Finished flooring in bathrooms, kitchens, public entrance halls, laundry and general storage areas shall consist of resilient flooring, felted-synthetic-fibre floor coverings, concrete, terrazzo, ceramic tile, mastic or other types of flooring providing similar degrees of water resistance. (See Appendix A)"

I/We are prepared to assume full responsibility for any damage caused to the hardwood floor or subfloor due to moisture absorpency in the mentioned areas, and agree to waive any claims against the Town of Whitby, TARIION and/or the Builder in relation to this matter.

WE HAVE READ, UNDERSTAND AND AGREE TO THE ABOVE TERMS.

Dated at Brooklin, this 21 day of NOV, 2014 in the presence of:

WITNESS: _____ PURCHASER: Kelly Spurr

WITNESS: _____ PURCHASER: _____

Dated at CONCOR this 27TH day of November, 2014 in the presence of:

WITNESS: _____ VENDOR: FC **NOV 27 2014**

STANDARD APPLIANCE WIDTHS

The purchaser acknowledges the following standard spaces for kitchen appliances:

- ☐ Range Conventional – 30" Width
- ☒ Hood Fan – 30" Width (must be the same or larger as range opening as per Ontario Building & Fire Code)
- ☒ Refrigerator – 36" W x 72" H (Approximate - height may change due to bulkheads)
- ☒ Dishwasher – 24" Width
- ☒ 6" Exhaust Vent above stove
- ☐ OTHER _____

*Check all that apply - NON-STANDARD APPLIANCE OPTIONS

NOTE: When upgrading appliances, there may be an additional charge to modify cabinetry and/or electrical and plumbing to accommodate the appropriate size from the manufacturer specifications of each appliance.

MANUFACTURERS SPECIFICATIONS MUST BE ATTACHED

- ☐ **36" / 42"** Stove (Hood fan width will be the same as per Ontario Building Code)
- ☒ Built-In Microwave with Trim Kit
- ☒ Gas Stove
- ☐ Built-In Microwave Drawer with Trim Kit
- ☒ Slide-In Stove
- ☐ Warming Drawer
- ☐ Cooktop
- ☐ OTR – Over The Range Microwave *Plug required
- ☒ * (Gas/Electric – Cut-out Charge & Plug Required)
- ☐ **Built-in Refrigerator/Sub Zero** – If purchasing a side by side or French Door, the wall beside the door may be an issue if it is deeper than 24"
*Applicable charges may apply if required to due to space accommodations
- ☒ Built-In Wall Oven
- ☐ *Note: Refrigerator Door Swing
- ☐ Hood Fan (may require larger vent, charges will apply – **6" is standard**)
- ☐ Wine / Bar Fridge (electrical required)
- ☐ 8" Vent / 10" Vent
- ☐ Steam Oven / Built-In Coffee makers
- ☐ **Chimney hoods** **CENTRE VENT ABOVE STOVE (clearance space will be left with this appliance will not butt up against cabinetry)
- ☐ Cargo Waste Bin systems
- ☐ Front Load Washer & Dryer *(Specs required if installing counter above)
- ☐ Stackable Washer & Dryer

Buy **NOTE:** It is the Purchaser's responsibility to coordinate delivery, installation and hook up of appliances and to ensure they are installed as per Manufacturers specifications after closing.

Buy Purchaser acknowledges responsibility for providing correct specification for such appliances. The purchaser agrees to deliver forthwith to the Builder the manufacturer's appliance specifications where the size exceeds the standard openings.

~~X~~ If specs not received, the standard openings as determined by Zancor Homes will be provided. If rework/repair is required due to late specs received, additional costs will be applied.

Appliance Specifications are to be sent to the Zancor Décor Centre no later than _____

Appliance Specifications received _____

Purchaser Signature  Date _____

Purchaser Signature _____ Date _____

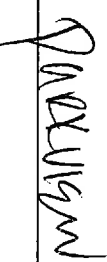
PROJECT  LOT 23

Every effort will be made to ensure the materials selected are as close as possible to the samples provided, however due to variances in manufacturing and properties of natural materials we do not guarantee identical colour matching.

STONE COUNTERTOP JOINTS: Purchaser is aware that one joint will be at each corner and on either side of slide-in-range (if applicable). It will also be where the length of the counter top exceeds the length of a stone slab. Slabs are usually approximately 5' x 8'.

HARDWOOD FLOORING: Due to the natural properties of wood, many variables can affect the overall look of the finished product. Variations include but not limited to wood type, colour/stain and wood grain are significant factors that make exact colour matching impossible. The purchaser acknowledges that the hardwood flooring is a pre-finished product in a controlled environment. Expansion, compression and cupping are characteristics of hardwood flooring once installed in the home. The purchaser acknowledges these may become apparent over time and despite the Builders' efforts to install the hardwood flooring materials in keeping with good workmanship, the Builder shall not be responsible nor held liable for minor variances of fluctuation in hardwood flooring materials.

CABINETRY: Due to the natural properties of wood, slight variations apparent with cabinetry are to be expected. This includes but not limited to wood species, wood grain, colour, finish, product variations, and natural imperfections are all factors that may affect the overall look of the finished product. Such factors make exact colour matching impossible. The type and intensity of lighting in the areas of designated cabinetry placement may also highlight characteristics of cabinetry finish. All cabinets shall be finished with a white melamine interior box unless a finished interior is upgraded. Due to building specifications and/or on-site conditions, certain cabinetry upgrades may not be possible. The purchaser acknowledges that the Builder cannot guarantee the cabinetry finish or provision of certain upgrades and shall not hold the Builder liable for provision of same.

FRAMING-WALK:
You will be contacted by a representative of Zancor Homes to schedule an appointment for your Frame Walk. In order to comply with the Occupational and Safety Act, the Ministry of Labour Guidelines, proper closed-toe shoes are to be worn to ensure the complete safety of our homeowners. ****Please be advised that your frame-walk is intended only as an orientation of your home layout & confirmation for Quality Assurance. We will not accept any changes or additions.****

DATE 11/21/14

23 Parkview



30" Dual Fuel Range

SPECIFICATIONS	
Exterior Finish	Stainless Steel
Overall Width	29 7/8"
Overall Height (to cooking surface)	36 7/8"
Overall Depth	29 1/2"
Oven Interior Capacity	4.5 cu ft
Oven Interior Dimensions	25" W x 16 1/2" H x 19" D
Opening Width	30"
Opening Height (to countertop)	36"
Opening Depth	24"
Electrical Requirements	240/208 V AC 60 Hz, 30 amp circuit
Electrical Rating	5.2 kW at 240 V AC 4.5 kW at 208 V AC
Total Amps	21.7
Shipping Weight	325 lbs

INSTALLATION NOTES

- A Wolf pro wall, chimney, island ventilation hood or hood liner is recommended.
- High altitude conversion kit for LP gas installations above 8,600'. For natural gas above 10,250', contact Wolf customer service.

OVERALL DIMENSIONS

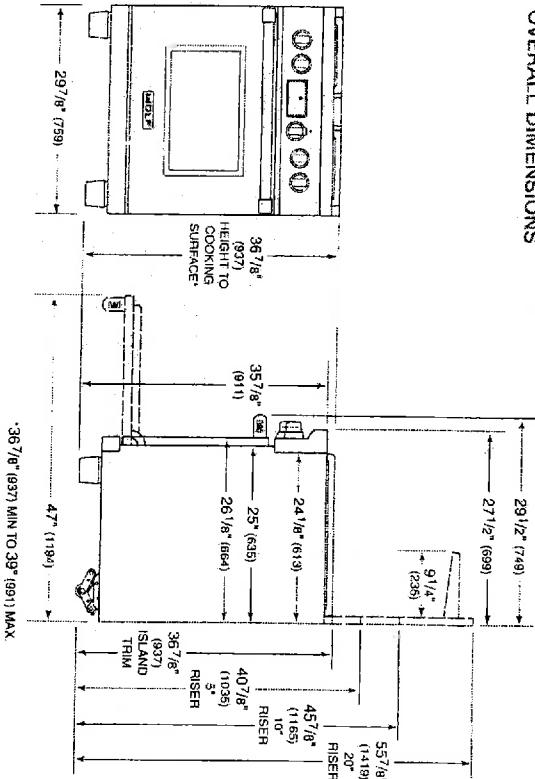

Unit dimensions may vary by ± 1/8".

INSTALLATION SPECIFICATIONS

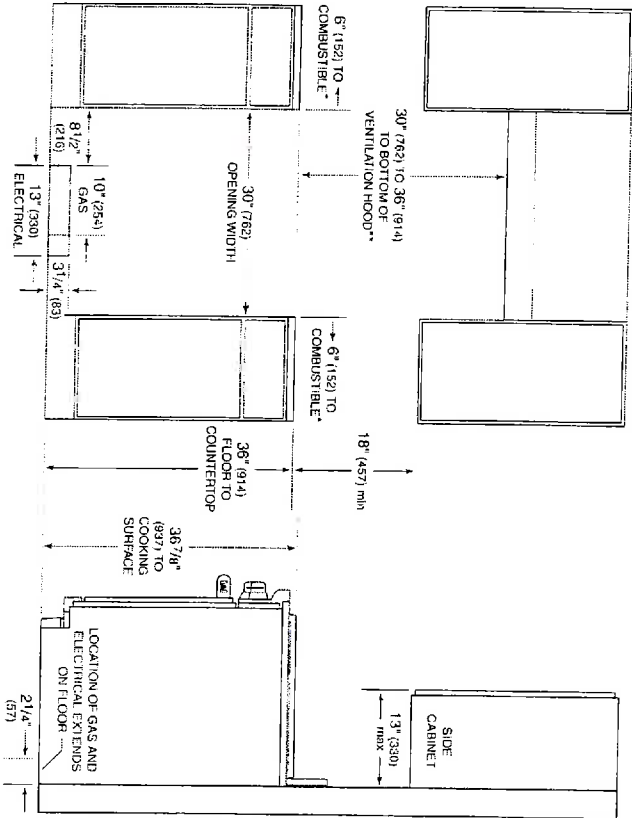

Minimum clearance from rough opening to combustible materials up to 18" (457) above countertop.
**36" (914) minimum clearance from countertop to combustible materials without ventilation hood.
NOTE: For island installations, 12" (305) minimum clearance from back of range to combustible rear wall above countertop.

Dimensions in parentheses are in millimeters unless otherwise specified.

©Wolf Appliance, Inc. all rights reserved. Features and specifications are subject to change at any time without notice.

23 parkview



30" Dual Fuel Range

With Wolf's dual fuel range you have state-of-the-art cooking expertise to meet the discriminating consumers' needs. The dual fuel range offers standard dual-stacked sealed surface burners. The large electric oven features ten cooking modes and the Wolf exclusive dual convection system that delivers even temperature and airflow throughout. The dual fuel range is available in natural or LP gas.

FEATURES

- Stainless steel exterior finish with island trim included.
- Red, black or stainless steel control knobs (specify with range).
- Stainless steel bezels surround all knobs.
- Dual-stacked, sealed burners, all with simmer capabilities and automatic reignition at all settings.
- Melt feature on 9,200 Btu burner.
- Ten cooking modes, temperature probe and self-clean features.
- Porcelain-coated cast iron continuous top grates.
- Pivoting hidden touch control panel.
- Coaxial temperature displaying oven selector knob.
- Cobalt blue porcelain oven interior with halogen lighting.
- Three adjustable oven racks; one full-extension easy glide, one full-extension door glide and one standard.
- Hidden bake element and recessed broil element.
- Spring/damper door hinge system.



Rotating control panel.



Cobalt blue oven interior.

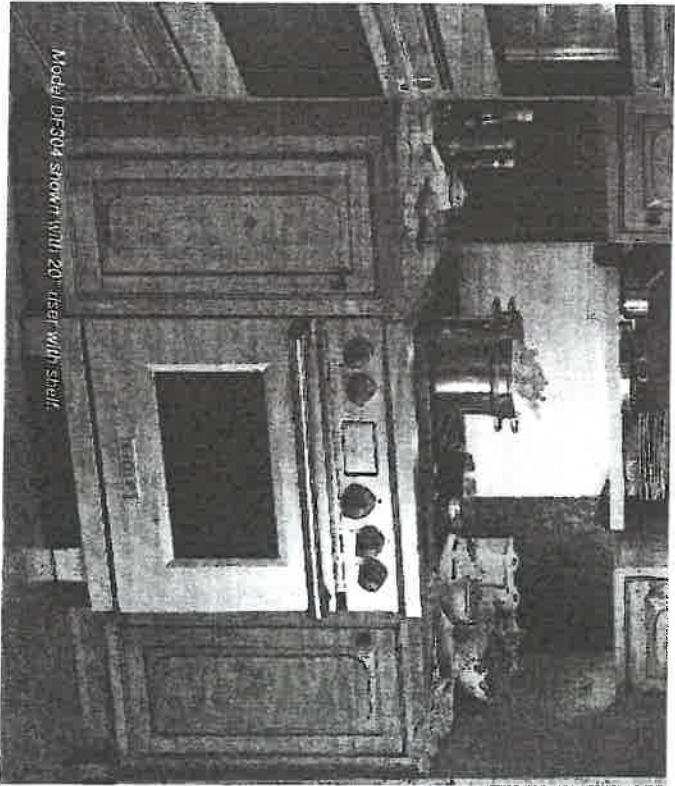

Model DF304

SURFACE FEATURES

Model

Surface Burners

15,000 Btu high / 950 Btu simmer

DF304

Surface Burner

9,200 Btu high / 325 Btu simmer

3

Model number is for natural gas dual fuel range, add (L-P) to the model number for LP gas.

1

ACCESSORIES

- Stainless steel risers in 5" and 10" heights, or 20" riser with shelf.
- Red, black or stainless steel control knobs.
- Chrome or brass bezels.
- One piece porcelain-cast wok grate and single burner grate.
- Porcelain-cast two-burner S-grates — center S-grate also available.
- Set of three standard oven racks.
- One full-extension easy glide rack.
- Broiler pan and temperature probe.
- Bake stone kit.
- Dehydration kit.
- 30" baking sheet kit.
- Front leg extension covers and rear caster covers.
- High altitude conversion kits.

Accessories are available through your authorized Wolf dealer. For local dealer information, visit the find a showroom section of our website, wolfappliance.com.

This appliance is certified by Star-K to meet strict religious regulations in conjunction with specific instructions found on www.star-k.org.

140
Bparkuraw

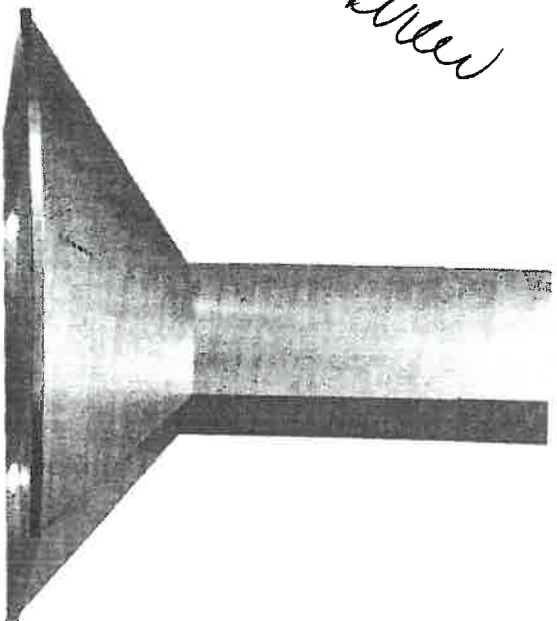

SUS

- Motor: **600 cfm**
- Aluminium die-cast motor housing
- Pressure: **480 Pa**
- Noise level: **63 dBA/4.9 sones**



- Lighting: 2x20W halogen lamps



- Control panel: 4 speed push-button + timer + light switch



- grease filter: anodized aluminium (5+1 layers)
- Stainless steel: AISI 430

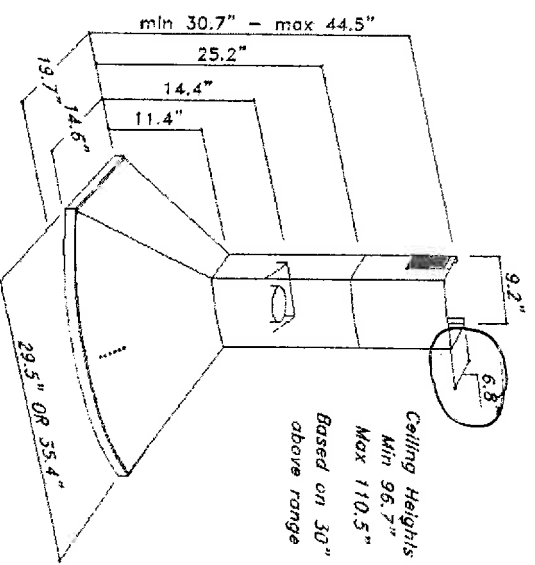

Sirius

D5628XXLS

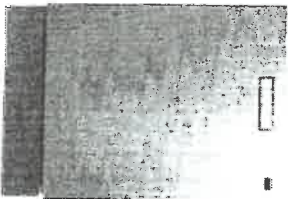

23 partitions

Features

PROGRAMS

- Daily wash
- Heavy wash
- Delicate wash
- Quick wash
- Super quick
- Eco wash
- Rinse and dry
- Rinse and hold

OPTIONS

- High temperature
- Long dry

CLEANING SYSTEMS

- Self cleaning filters
- AquaLevel™ Sensor

DRYING SYSTEM

- Turbo Drying™

COMFORT/EASY OF USE

- Fault indication
- Rinse-aid indication
- Time remaining indicator

SAFETY

- AquaSafe™
- SteamSafe™
- KidLock™ - lock the door

BASKETS

- Lower: Premium

Specifications

GENERAL

- Display type: LED display
- Number of programs: 9
- Noise level: 46 dB(A)
- Number of baskets: 2
- Max loading height upper basket: 9 1/16" (230 mm)
- Max loading height lower basket: 13 3/4" (350 mm)

DIMENSIONS AND INSTALLATION

- Height: 34 3/8" (873 mm)
- Width: 24" (610 mm)
- Depth: 22 7/8" (581 mm)
- Length inlet hose: 66 1/8" (1680 mm)
- Length outlet hose: 41 3/4" (1060 mm)
- Cord length: 46 7/16" (1180 mm)
- Adjustable front legs: Adjustable front legs
- Weight net: 110 lbs
- Weight gross: 115 lbs

TECHNICAL INFORMATION

- Connection rating: 1300 W
- Current: 15 A
- Voltage: 120 V

CONSUMPTION

- Energy class: A++
- Wash performance: A
- Estimated yearly energy consumption: 231 kWh
- Energy consumption/cycle: 1.07 kWh

Setting up your French Door Refrigerator

GETTING READY TO INSTALL THE REFRIGERATOR

Congratulations on your purchase of this Samsung French Door Refrigerator. We hope you enjoy the state-of-art features and efficiencies that this new appliance offers.

Selecting the best location for the refrigerator

Choose :

- A location with easy access to a water supply.
- A location without direct exposure to sunlight.
- A location with a level floor.
- A location with enough space for the refrigerator doors to open easily.
- A location that allows sufficient space to the right, left, back, and top for air circulation. If the refrigerator does not have enough space, the internal cooling system may not work properly.
- A location that allows you to move the refrigerator easily if it needs maintenance or service.
- Do not install the refrigerator in locations where the temperature is over 109 °F (43 °C) or below 41 °F (5 °C).
- Do not locate the refrigerator where it may become wet.

If the refrigerator does not have enough space, the internal cooling system may not work properly. If your refrigerator has an ice maker, allow extra space at the back for the water line connections. When you install the refrigerator next to a fixed wall, you need a minimum clearance of 3 ¾" (95 mm) between the refrigerator and wall to allow the door to swing open.

Important : Make sure that you can easily move your refrigerator to its final location by measuring doorways (both width and height), thresholds, ceilings, stairways, etc. The following chart details the exact height and depth of this Samsung French Door Refrigerator.

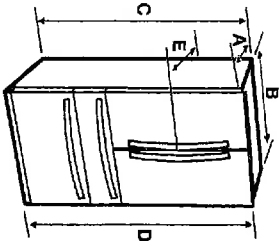

Depth "A"	28.58" (726 mm)
Width "B"	35.74" (908 mm)
Height "C"	68.85" (1719 mm)
Overall Height "D"	69.96" (1777 mm)
Depth "E"	31.02" (788 mm)

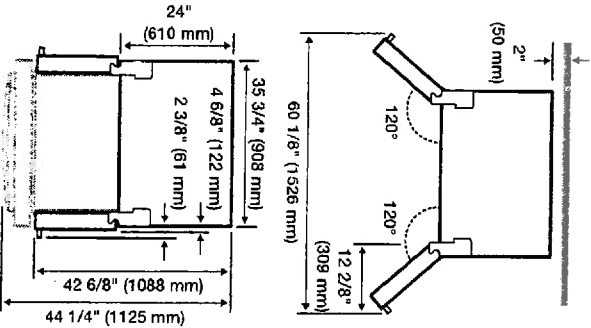

Each measurement based on the design dimension, so it may differ depending on the measuring method.

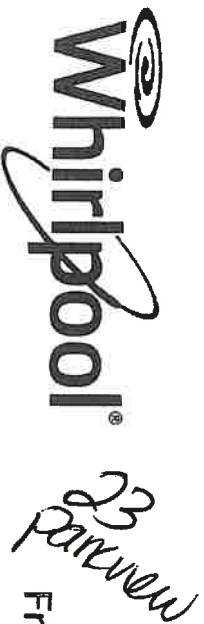

Front-Loading Washer

PRODUCT MODEL NUMBERS
WFW88HEA, WFW94HEA, WFW96HEA

Washer Dimensions:

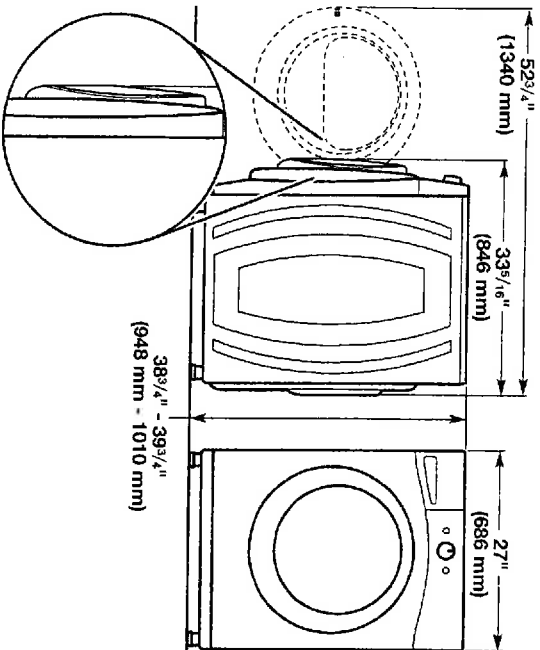

PRODUCT MODEL NUMBERS
WFW61HEB, WFW70HEB, WFW80HEB,
WFW8640B, WFW86HEB

Washer Dimensions:

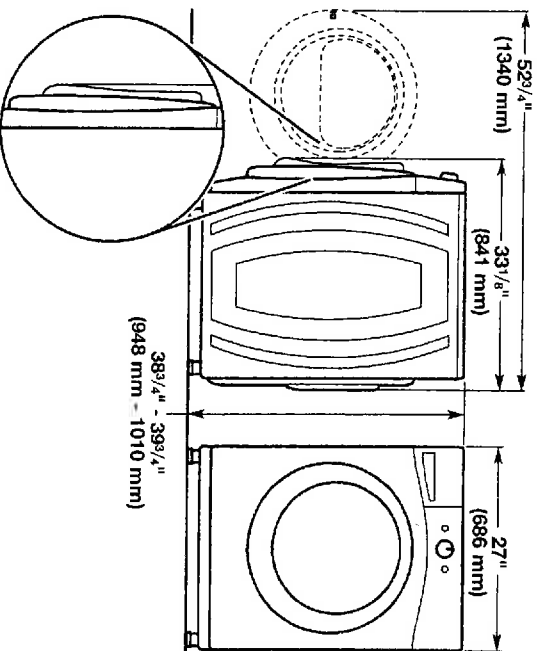

Recessed or closet installation -
stacked washer and dryer

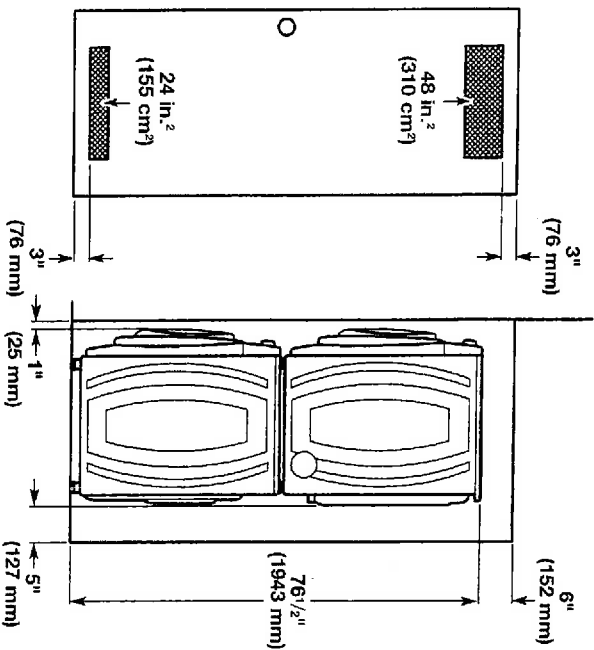

* Add spacing of 1" (25 mm) on all sides of washer/dryer.

Recessed area or closet installation (washer only):

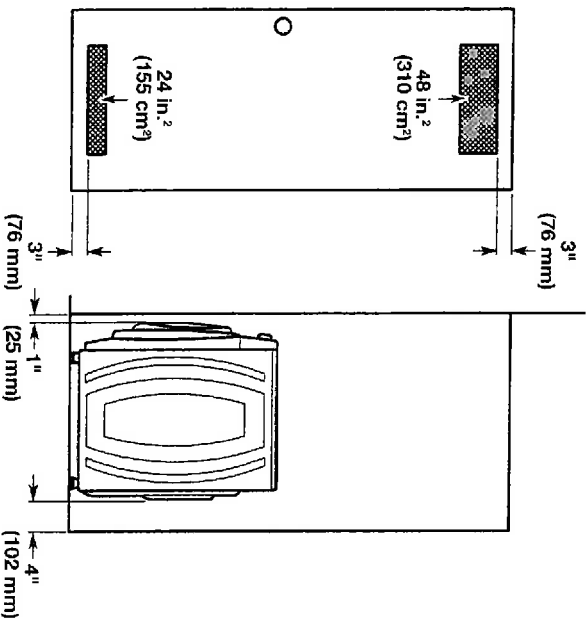

* Add spacing of 1" (25 mm) on all sides of washer.

Custom cabinet installation (washer only):

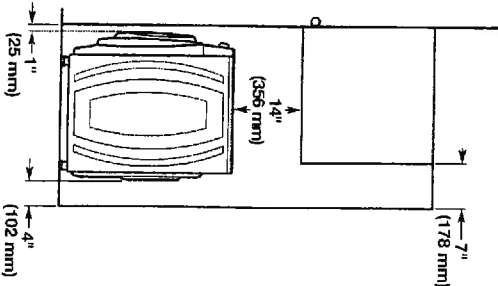

** Recommended 4" (102 mm), minimum 1.5" (38 mm)

Undercounter installation - washer only:

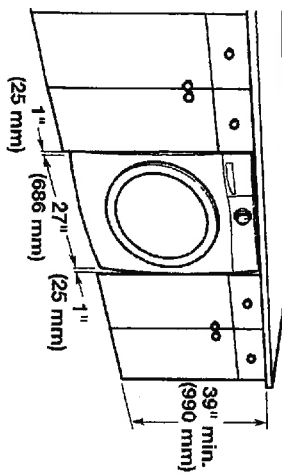

23 Parkview
447

All dimensions show recommended spacing allowed, except for closet door ventilation openings which are the minimum required.

For each arrangement, consider allowing more space for ease of installation and servicing, and spacing for companion appliances and clearances for walls, doors, and floor moldings.

Space must be large enough to allow door to fully open. Add spacing of 1" (25 mm) on all sides of washer to reduce noise transfer. If a closet door or lowered door is installed, top and bottom air openings in door are required.

ELECTRICAL REQUIREMENTS

A 120 volt, 60 Hz., AC only, 15- or 20-amp, fused electrical supply is required. A time-delay fuse or circuit breaker is recommended. It is recommended that a separate circuit serving only this appliance be provided.

DRAIN SYSTEM

Drain system can be installed using a floor drain, wall standpipe, or laundry tub. Select method you need.

IMPORTANT: To avoid siphoning, only 4.5" (114 mm) of drain hose should be inside standpipe. Always secure drain hose with cable tie.

Floor standpipe drain system

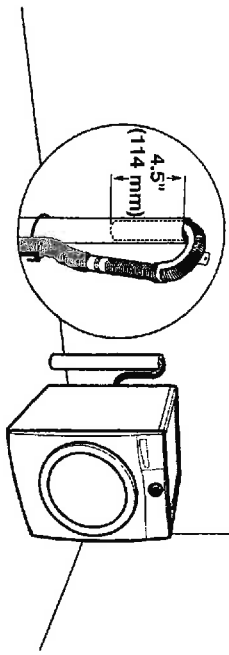

Minimum diameter for a standpipe drain: 2" (51 mm). Minimum carry-away capacity: 17 gal. (64 L) per minute. A 1/4" (6 mm) diameter to 1" (25 mm) diameter Standpipe Adapter Kit is available (Part Number 3363920). Top of standpipe must be at least 30" (762 mm) high; install no higher than 96" (2.44 m) from bottom of washer. If you have an overhead sewer and need to pump higher than 96" (2.44 m), a sump pump and associated hardware are needed. See "Alternate Parts".

Wall standpipe drain system

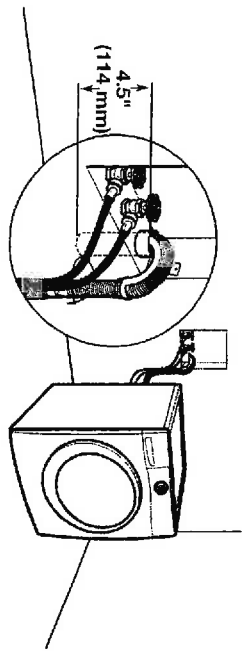

See requirements for floor standpipe drain system.

Laundry tub drain system

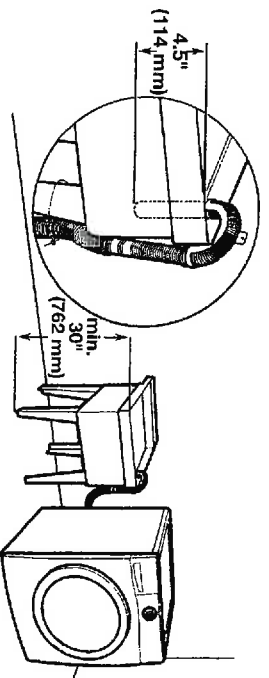

Minimum capacity: 20 gal. (76 L). Top of laundry tub must be at least 30" (762 mm) above floor; install no higher than 96" (2.44 m) from bottom of washer.

Floor drain system

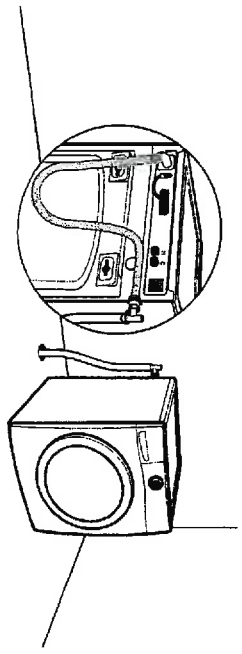

Floor drain system requires a Siphon Break Kit (Part Number 285834), 2 Connector Kits (Part Number 285835), and an Extension Drain Hose (Part Number 285863) that may be purchased separately. See "Alternate Parts". Minimum siphon break height: 28" (710 mm) from bottom of washer. (Additional hoses may be needed.)

Because Whirlpool Corporation policy includes a continuous commitment to improve our products, we reserve the right to change materials and specifications without notice.

Dimensions are for planning purposes only. For complete details, see Installation Instructions packed with product. Specifications subject to change without notice.



Gas Dryer

PRODUCT MODEL NUMBERS

WGD70HEB, WGD71HEB, WGD80HEB, WGD86HEB,
WGD88HEA, WGD94HEA, WGD96HEA, WGD98HEB

DRYER DIMENSIONS

Front view:

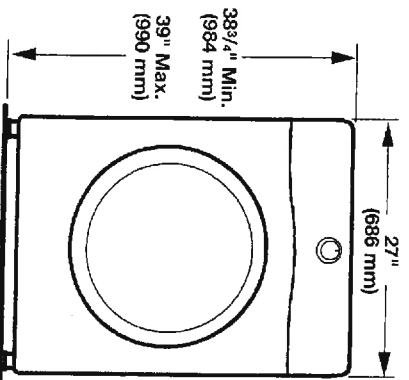

Side view:

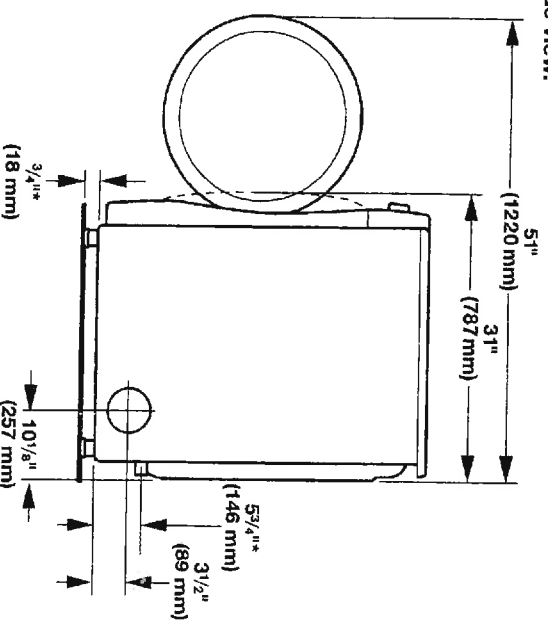

Back view:

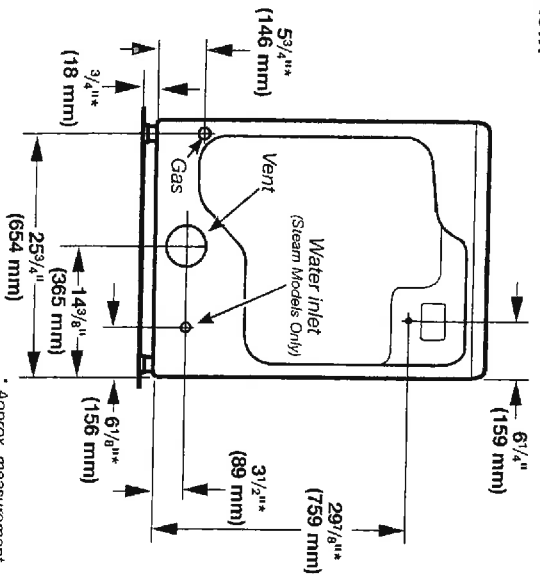

Recommended installation clearances (dryer only):

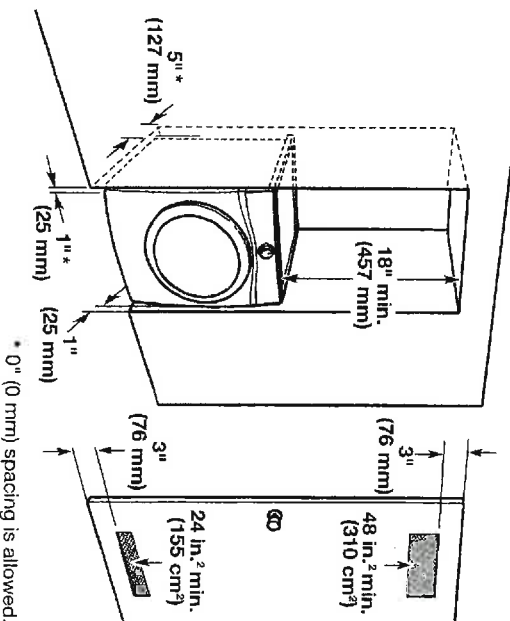

* 0" (0 mm) spacing is allowed.

NOTE: Most installations require a minimum of 5" (127 mm) clearance behind dryer for exhaust vent with elbow. See "Venting Requirements."

Installation spacing for recessed area or closet installation

All dimensions show recommended and minimum spacing allowed.

- Additional spacing should be considered for ease of installation and servicing.
- Additional clearances might be required for wall, door, floor moldings, dryer venting, and gas line.
- Additional spacing should be considered on all sides of the dryer to reduce noise transfer.
- For closet installation, with a door, minimum ventilation openings in the top and bottom of the door are required. Louvered doors with equivalent ventilation openings are acceptable.
- Companion appliance spacing should also be considered.

158

23 parkview

INSTALLATION REQUIREMENTS

GAS SUPPLY REQUIREMENTS

Gas supply This dryer is equipped for use with Natural gas. Dryer can be converted to L.P. gas. When rigid pipe is used it should be 1/2" IPS. When acceptable to the gas supplier and local codes, 3/8" approved tubing may be used for lengths under 20 ft (6.1 m). For lengths over 20 ft (6.1 m), larger tubing should be used. Pipe-joint compounds resistant to the action of L.P. gas must be used. An individual manual shutoff valve must be installed within 6 ft (1.8 m) of the dryer in accordance with the National Fuel Gas Code ANSI Z223.1.

ELECTRICAL REQUIREMENTS

A 120-volt, 60 Hz, AC-only, 15 or 20 amp fused electrical supply is required. A time-delay fuse or circuit breaker and a separate circuit are recommended.

WATER (STEAM MODELS ONLY) REQUIREMENTS

The dryer must be connected to the cold water faucet using new inlet hoses. Do not use old hoses. Do not overtighten. Damage to the coupling can result.

VENTING REQUIREMENTS

Exhaust venting: Exhaust your dryer to the outside. 4" (102 mm) diameter vent is required. Rigid or flexible metal exhaust vent must be used. Do not use plastic or metal foil vet. Exhaust hood must be at least 12" (305 mm) from the ground or any object that may be in the path of the exhaust.

Exhaust hoods:

Recommended Styles:

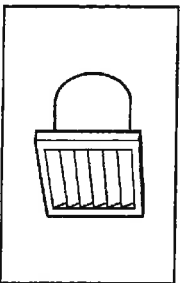

Louvered Hood

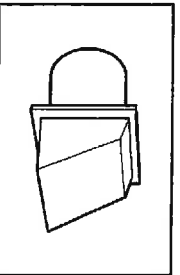

Box Hood

Acceptable Style:

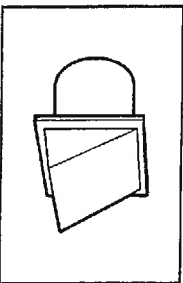

Angled Hood

Determine vent path:

- Select route that will provide straightest and most direct path outdoors.
- Plan installation to use fewest number of elbows and turns.
- When using elbows or making turns, allow as much room as possible.
- Bend vent gradually to avoid kinking.
- Use as few 90° turns as possible.

Determine vent length and elbows needed for best drying performance:

- Use the "Vent System Charts" on the next page to determine type of vent material and hood combinations acceptable to use.

NOTE: Do not use vent runs longer than those specified in "Vent System Charts."

Exhaust systems longer than those specified will:

- Shorten life of dryer.
- Reduce performance, resulting in longer drying times and increased energy usage.

Standard Vent System Chart		
Number of 90° elbows	Type of vent	Angled hoods
0	Rigid metal	64 ft. (20 m)
1	Rigid metal	54 ft. (16.5 m)
2	Rigid metal	44 ft. (13.4 m)
3	Rigid metal	35 ft. (10.7 m)
4	Rigid metal	27 ft. (8.2 m)

Long Vent System Chart*		
Number of 90° elbows	Type of vent	Angled hoods
0	Rigid metal	160 ft. (48.8 m)
1	Rigid metal	150 ft. (45.7 m)
2	Rigid metal	140 ft. (42.7 m)
3	Rigid metal	130 ft. (39.6 m)
4	Rigid metal	120 ft. (36.6 m)

*For Model WGD71HEW only; for all other models, refer to the Standard Vent System Chart above. To find your model number, refer to the model and serial number plate in the inner door well.

NOTE: For long vent systems, use of box/louvered hoods will improve venting regardless of length.

For Steam oven

Appliance and installation dimensions

Wall cabinet installation

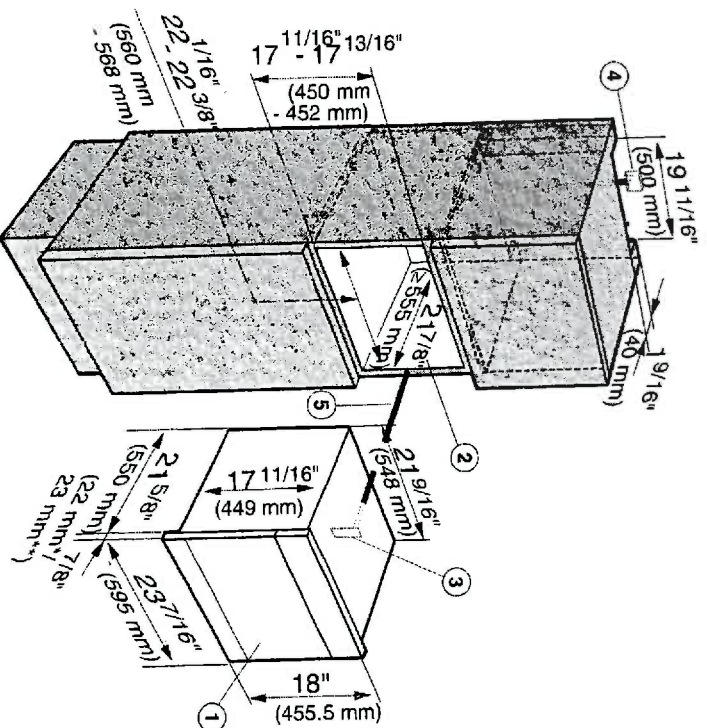

- ① Comb Steam Oven
- ② Installation niche
- ③ Power supply to the appliance
- ④ Recommended location for electrical connection
- ⑤ Power cord

* Appliances with glass front
** Appliances with metal front

5 lower half - 37 mg
100% for 250V, 350V, 60 Hz
vac amps

44

23 parkview

Appliance and installation dimensions

Cut-outs for venting the Combi Steam Oven

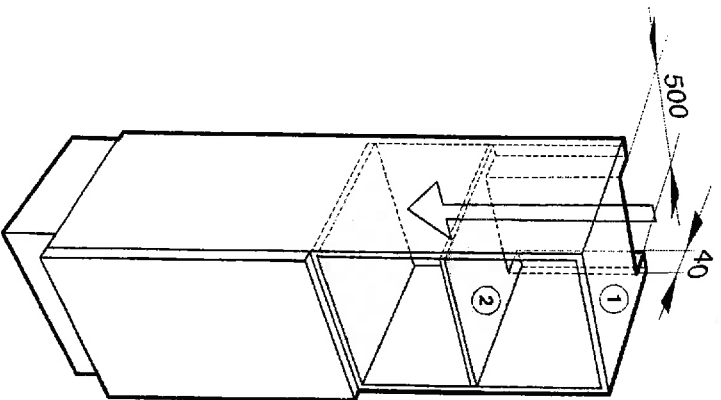

To ensure that the Combi Steam Oven has adequate ventilation, the following cut-outs measuring 19 11/16" x 1 9/16" (500 x 40 mm) must be made:

- ① in the top of the cabinet
- ② in the center shelf above the installation niche

The cabinet housing must not have a back panel fitted behind the installation niche.

For Panasonic Microwave

MWTK76

30" STAINLESS STEEL TRIM KIT

Lot 23
Parkview
PK8

Side View

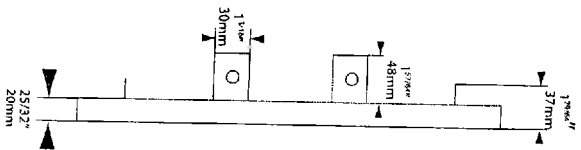

Front View

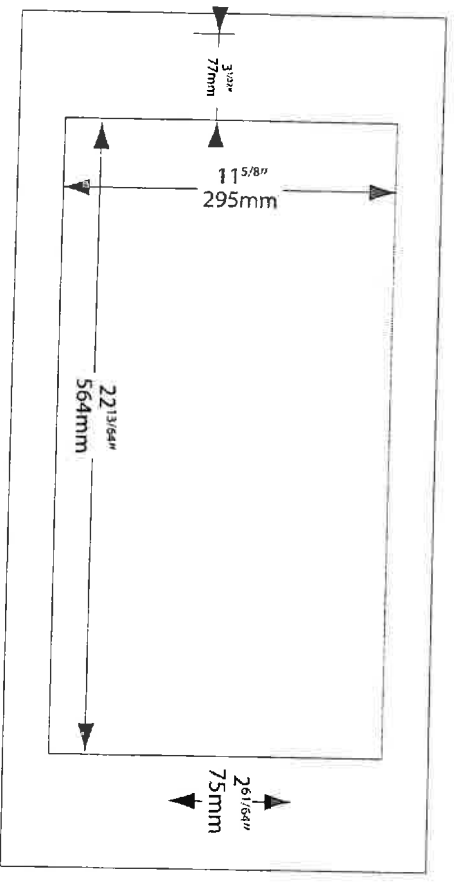

Front View

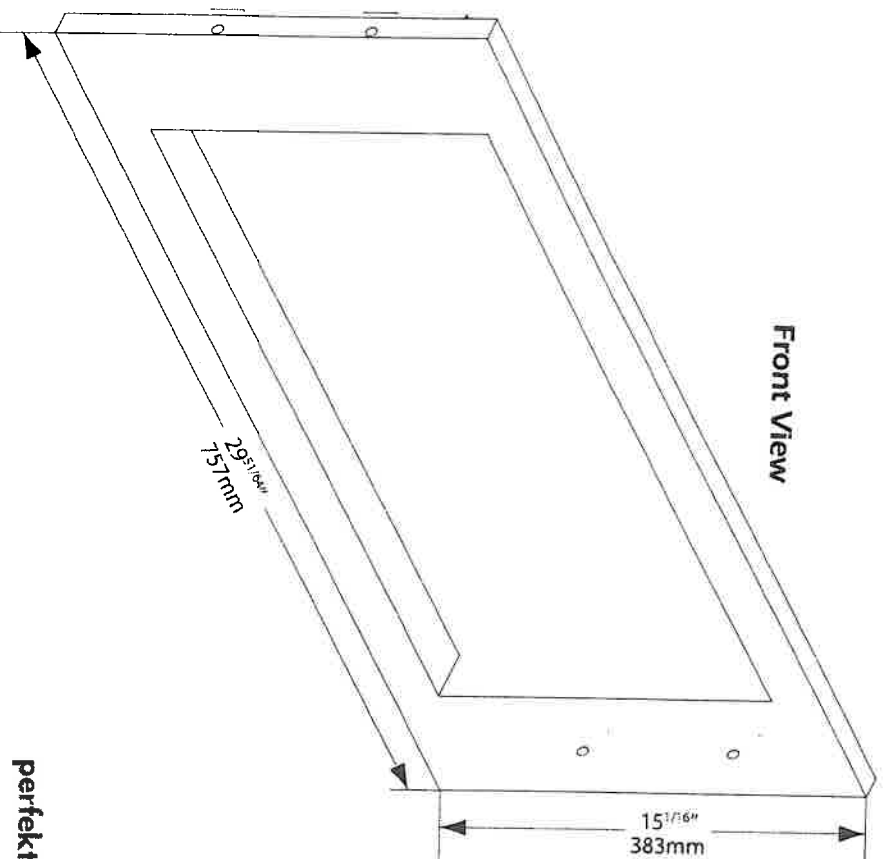

DAEG
perfekt in form und funktion

MWTK76

30" STAINLESS STEEL TRIM KIT

23 part view by

- * For use with Panasonic microwave NNSD797 or equivalent
- * Wooden support provided with MWTK-76 kit
- * Please keep and reuse wood screws provided with the kit
- * Place wooden supports 18^{17/64"} (46.4cm) apart, measured from the center of each support shown in the diagram below

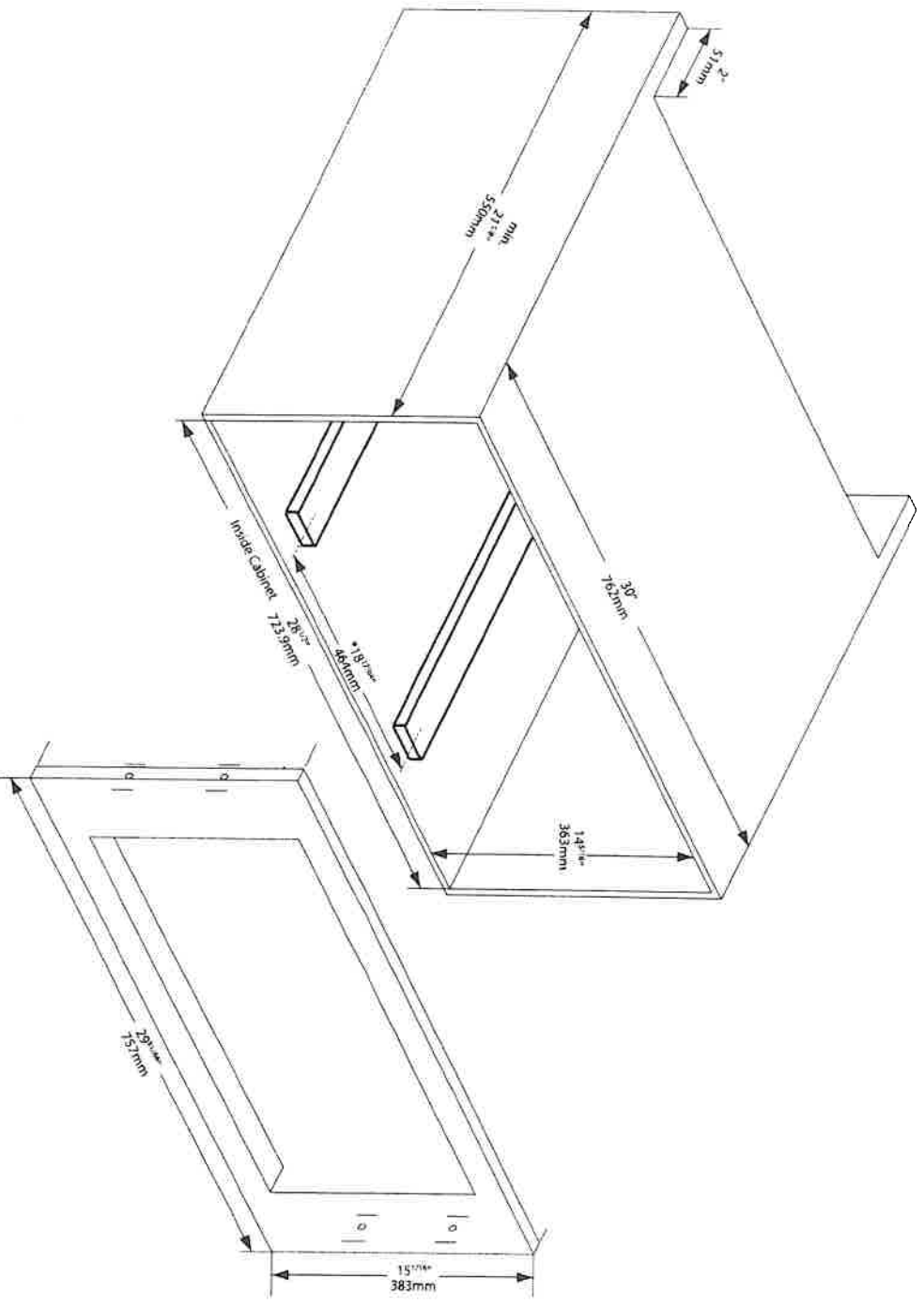

DAEG
perfekt in form und funktion

1.6 cu. ft.
Oven capacity

1200 Watt
Cooking power

304 x 555 x 493 mm
Exterior dimensions (H x W x D)

SEE ALL SPECS

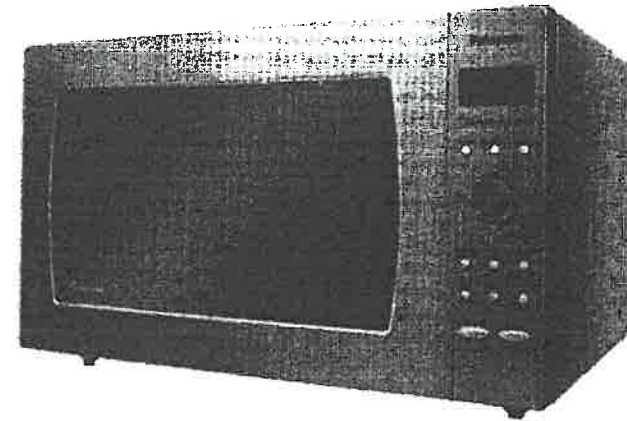

120V 60Hz
1460 W
12.7 Amps

23partnew
Kil

MWTK76

30" STAINLESS STEEL TRIM KIT

178

1. Unscrew the 4 screws holding the 2 pieces of wood in place, and retain the screws.
2. Screw the 2 pieces of wood onto the base of the cabinet. The wooden strips should touch the inside of the front of the MWTK-76, and be positioned with the centre of the wooden strips ($18\frac{1}{2}'' = 46.4\text{cm}$) apart.
3. Being careful not to scratch the microwave door, lift the microwave onto the wooden strips, and move it back about 2 inches.
4. Place the MWTK-76 into position. Use the 4 screws and screw them through the flanges into the side gables.
5. Pull the microwave forward, and align the front of the microwave with the front of the MWTK-76.
6. To stop the microwave from sliding backwards whilst opening it, it might be necessary to attach a piece of wood behind the feet of the microwave, on the wooden supports.
7. Air must be able to flow from the microwave upwards and into the room, or roof space. Failure to comply will void the manufacturer's warranty on the microwave oven.

23
parten

DAEG

perfekt in form und funktion

MWTK76

30" Stainless Steel Trim Kit



perfekt in form und funktion



ZANCOR
HOMES

**FINAL STRUCTURAL REQUEST
ACKNOWLEDGMENT**

LOT No.

23

PLAN No.

Sussex

HOMEOWNER(S)

STEVEN GUER

PROJECT

Parkview

FINAL STRUCTURALS COMPLETED ON

Sept 4/2014

The above purchaser for the above-mentioned property, hereby acknowledge that once my final structural appointment has been completed and signed off, that no further changes, requests or deletions for structural changes will be accommodated.

I understand that a "structural change" refers to, but is not limited to, all the items as they are listed on the *Structural Requirements* checklist which has been reviewed and explained to me by Zancor's Structural Consultant.

If construction on the above noted property has not commenced and Zancor accommodates a request for a structural change I requested have after my final structural appointment has been completed, I fully acknowledge that there will be a minimum administration fee of \$5,000 in addition to the cost of the requested change and that I must sign off on the Purchaser Request for Extras within 48 hours of receiving the quoted price from Zancor.

I acknowledge the facts as explained to me and agree to waive any claims against the vendor or trades in relation to this particular matter.

I read and understand the above terms and conditions.

Dated at

Brockton

4

day of

SEP

2014

Purchaser

Witness

Purchaser

Witness