

SCHEDULE "E-1"

Invoice Number 806

PURCHASER EXTRAS

Consultant:

Vendor: Zancor Homes (KC) Ltd.	Purchasers: BENJAMIN SCHOLTEN and LEESA SCHOLTEN
	Telephone Number: 416-568-6178

Lot / Unit 101	House Type Berwick (50-09) Elev A	Reg. Plan # 65M-4342	Closing Date As Per Agreement	Date Ordered 12-Aug-2016
-------------------	--------------------------------------	-------------------------	----------------------------------	-----------------------------

DESCRIPTION	AMOUNT
<p>4512 Purchaser has requested for tiles to be installed in the furnace area, cantinas and storage area as a late extra.</p> <p>Due to this late extra, Purchaser acknowledges and accepts that the drains have not been installed to accommodate tiles in the above mentioned areas.</p> <p>Purchaser acknowledges and accepts that the tiles will need to be sloped down to the draining - tiles will be cut in order to slope to the drain.</p> <p>Purchaser acknowledges and accepts that the tiles in furnace room will not be installed under the furnace or water tank nor up against the wall behind them, around the furnace only.</p>	
<p>→ PURCHASER TO BE LEFT WITH EXTRA TILES</p>	

I the undersigned representing the Purchaser agree to have read and understand and agree to all the conditions herein. I understand this agreement ("Schedule E-1"), with all items outlined and prices listed supersedes all prior written, oral and/or other communications.

Initials

Conditions:

- The above referenced parties agree to the installation of the following extras at the prices shown above in accordance with the terms and conditions set out in the purchasers extra agreement.
- The prices quoted on this request for extras sheet are contingent upon the extras being ordered within 14 days of acceptance on the offer. Should the Purchaser wish to add any of this items at a later date, then the new prices will be quoted.
- All extras must be paid in full.
- If the sale of the above extras are not completed (due to the purchaser not completing the contract) any amount paid for these extras shall be kept in full by the builder, given that any work on the above extras has begun or if materials have been ordered.
- The Builder does not have to accept any additional extras, upgrades or changes from the Purchaser once this form has been approved by the Builder.
- Any additional extras or upgrades will only be accepted if they are in writing and approved by the Builder. Verbal extras or upgrades will not be acknowledged as part of the agreement.
- All selections are final. Changes to the above are subject to a 20% administration fee. Minimum of \$5000.

Purchaser - BENJAMIN SCHOLTEN

Purchaser - LEESA SCHOLTEN

Design Consultant

Vendor: Zancor Homes (KC) Ltd.

ZANCOR HOMES COLOUR CHART

STAIRS, RAILING & PICKETS & STAIR STAIN

(PAINT)

PAINT NOTE CEILING COLOUR CLOUD WHITE OC-130

Kitchen/Breakfast	INUKSHUK CC-460	Master Bedroom	ETIQUETTE AF-50
Foyer (main Fl) Servery/Pantry	ETIQUETTE AF-50	Bedroom 2&3	INUKSHUK CC -460
Dining Room	INUKSHUK CC-460	Bedroom 4	ETIQUETTE AF-50
Family Room Main Floor	INUKSHUK CC-460	All Closets	ETIQUETTE AF-50
Den	INUKSHUK CC-460	Master Ensuite	ETIQUETTE AF-50 *
Main/Upper Hall/Games Room	ETIQUETTE AF-50	2ND Ensuite	ETIQUETTE AF-50 *
Laundry 2ND Floor&Basement	ETIQUETTE AF-50 *	3 & 4 Ensuite	ETIQUETTE AF-50 *
Powder Room	INUKSHUK CC-460 *	Basement Bath	INUKSHUK CC -460 *
Basement Gym/Spare Room	INUKSHUK CC-460	Master study	ETIQUETTE AF-50
Basement Gym/Spare room closet	ETIQUETTE AF-50	Master Closet	ETIQUETTE AF-50
Basement Foyer/Hall	ETIQUETTE AF-50		
Mudroom	ETIQUETTE AF-50		
Basement Main Area	ETIQUETTE AF-50		

Appliance Package received in 'Schedule E'

YES / NO Package Name:

UPG (SEE PES)	DECLINED	NOTES
ELECTRICAL for Gas Stove / Cooktop		

DISCLAIMER

Colours of all materials are as close as possible to Builders selection but not necessarily identical due to dye lot variances in manufacturing/manufacturers. Due to construction progress some items may have been pre-selected or installed. In this event the Vendors's selection must be accepted by the purchaser

Any changes to the colour chart after signing are subject to a \$5000 administration fee plus costs

Purchaser has checked and acknowledged accuracy of colour and selections before signing.

INITIALS

SITE: ROYAL CASITES 50-9 - A LOT: 101

PURCHASER(S): Benjamin Scholten

Leesa Scholten

HOME #/CELL #

416 568-6178

EMAIL:

DÉCOR NOTES

FOR TRADE USE

Any upgrades in the colour chart must be accompanied with a PES.

It is the responsibility of all Trades to inform the builder of any discrepancies on sketches, PES and/or colour charts PRIOR to installation.

*** PAGE 2 OF 2 ***

ZANCOR HOMES

[Signature]

23 July 2016

Purchaser Signature

Date

[Signature] 23 July 2016

Purchaser Signature

Date

[Signature]

Décor Consultant Signature

Date

FC

JUL 28 2016

Vendor Signature

Date

* specially formulated for humid areas for bathrooms/laundry

ZANCOR HOMES COLOUR CHART

[illegible]

FC

JUL 28 2016



ORDER FORM

TORONTO OFFICE AND SHOWROOM
245 WEST BEAVER CREEK RD. UNIT #2
RICHMOND HILL, ONTARIO L4B 1L1
PHONE: (905) 886-5751
FAX: 905/886-8658

LOT# 101

MODEL: THE BERWICK A
TYPE: 50-09 A CEIL 120" H
ZANCOR HOMES "CASTLES OF KING CITY"

TO: LEESA & BENJAMIN SCHOLTEN	DATE: MAY 31, 2016
E-MAIL: leesa.scholten@bell.net	LOT# 101
PHONE: H. 416-568-6178	MODEL: THE BERWICK A
CELL: C. 416-452-3191	TYPE: 50-09 A CEIL 120" H

APPLIANCE PACKAGE	DOOR STYLE/FINISH	HARDWARE	COUNTER TOP	INSTALLATION
AS NOTED	AS NOTED	AS NOTED	SELECT W/BUILDER	INCLUDED

Item	Description	Total
	SOME STANDARD DOOR STYLE SELECTIONS WILL HAVE COLOUR MATCHED MELAMINE EXPOSED SIDES, PANELS & ACCESSORIES TO SUPPLY & INSTALL THE FOLLOWING UPGRADES IN LIEU OF STANDARD: ALL ELECTRICAL & FIXTURES ARE EXTRA WITH BUILDER	

SUPPLY & INSTALL DECORATIVE FACE HARDWARE FOR THE FOLLOWING;

KITCHEN / ISLAND / SERVERY / FAMILY ROOM BUILT-INS:

1 6" HANDLE #502106180

2 SQUARE KNOB #501238180

MAST. STUDY/ MAST. ENSUITE/BED.4 ENS./POWDER RM/2ND FL. LAUNDRY/BASEMENT LAUNDRY &

3 128MM HANDLE #3921128180

4 SQUARE KNOB #392134180



BED 2 & BED 3 ENSUITES

5 128MM HANDLE #BP810128180

6 SQUARE KNOB #BP81091180

CONTINUED ON NEXT PAGE

TO: LEESA & BENJAMIN SCHOLTEN		DATE: MAY 31, 2016
E-MAIL: leesa.scholten@bell.net		LOT# 101
PHONE: H. 416-568-6178		MODEL: THE BERWICK A
CELL: C. 416-452-3191		TYPE: 50-09 A CEIL. 120" H

MUDROOM		
7	96MM BLACK LEATHER HANDLE #649690180	
8	LARGE DÉCORATIVE HOOK # RH1173021-140	

NOTES:

1. SIZES OF CABINETS ARE SUBJECT TO CHANGE WITHOUT NOTICE BASED ON SITE MEASURE
2. IT IS THE PURCHASERS RESPONSIBILITY TO CO-ORDINATE ALL PLUMBING, ELECTRICAL, MECHANICAL AND STRUCTURAL CHANGES WITH THE BUILDER ANY COSTS ASSOCIATED WITH THESE CHANGES ARE TO BE PAID DIRECTLY TO THE BUILDER

*** ALL CHANGES ARE FINAL UPON SIGNING. ***		SUB TOT/
		HST TAXES 13
		TOT.

By: The SANDERSON-HAROLD Company Limited

KAREN HADDAD

I AM HEREWITH, ACCEPTING THE ABOVE QUOTATION & ATTACHED SKETCHES, WHICH I FULLY UNDERSTAND AND AM ORDERING ACCORDING TO THE FOLLOWING:

*****TERMS: UPGRADES PAYABLE DIRECTLY TO BUILDER*****

DATE: June 2, 2016 CUSTOMER SIGNATURE: 

HUTCH / FRIDGE
WALL

28

LOT. 101
SCHOLTEN

cont. every direction

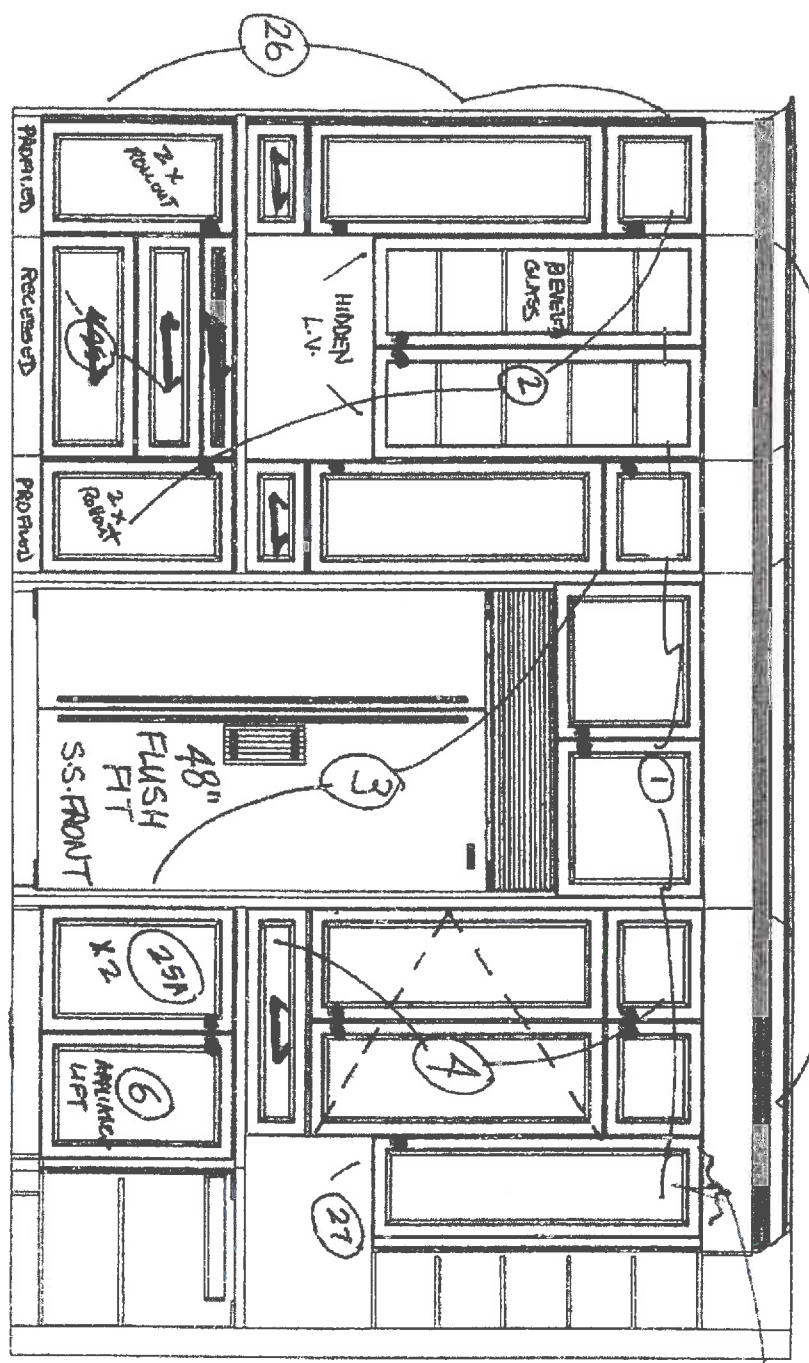

I HAVE READ AND

FULLY UNDERSTAND

THIS LAYOUT FOR COLOCATION

This sketch is provided solely for reference
those items noted on the accompanying
"Upgrades" all other details, dimensions
layouts are for illustrative purposes only and
may not be applicable to the purchaser's
model. All dimensions, specifications, an

CUSTOMER SIGNATURE

KNOB •

HANDLE / PULL

17 knobs
6 pulls

Please sign

1

LOT 101 Date SEPT. 13, 2015
 Purchaser's Signature [Signature]

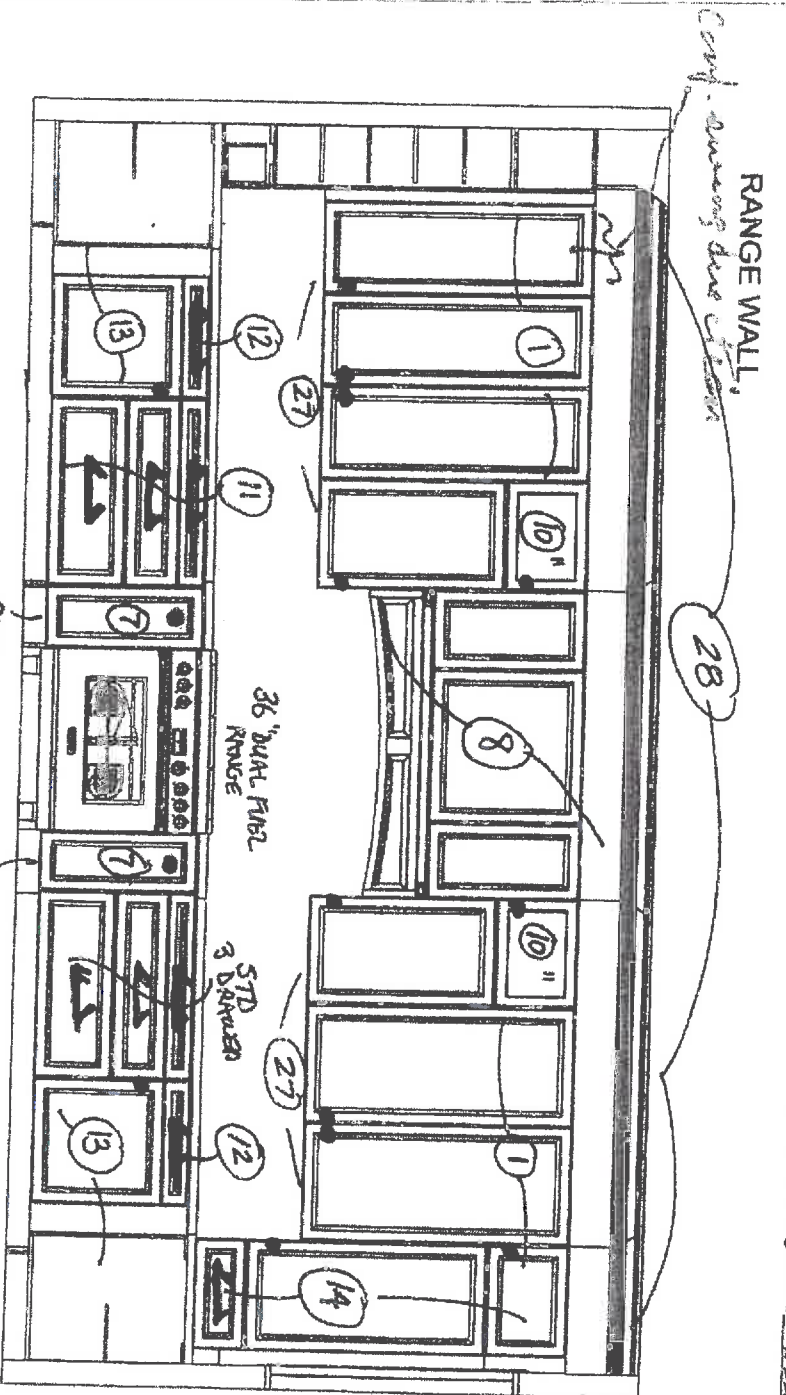

PLEASE READ AND
 SIGNATURE
 DATE

Note: This drawing is an artistic interpretation of the general appearance of the design. It is not meant to be an exact rendition.	20 10/1	Designed: 9/8/2015 Printed: 9/17/2015
---	------------	--

15 knobs
 9 pulls

KNOB •
 HANDLE / pull →

2

SINK / WINDOW WALL

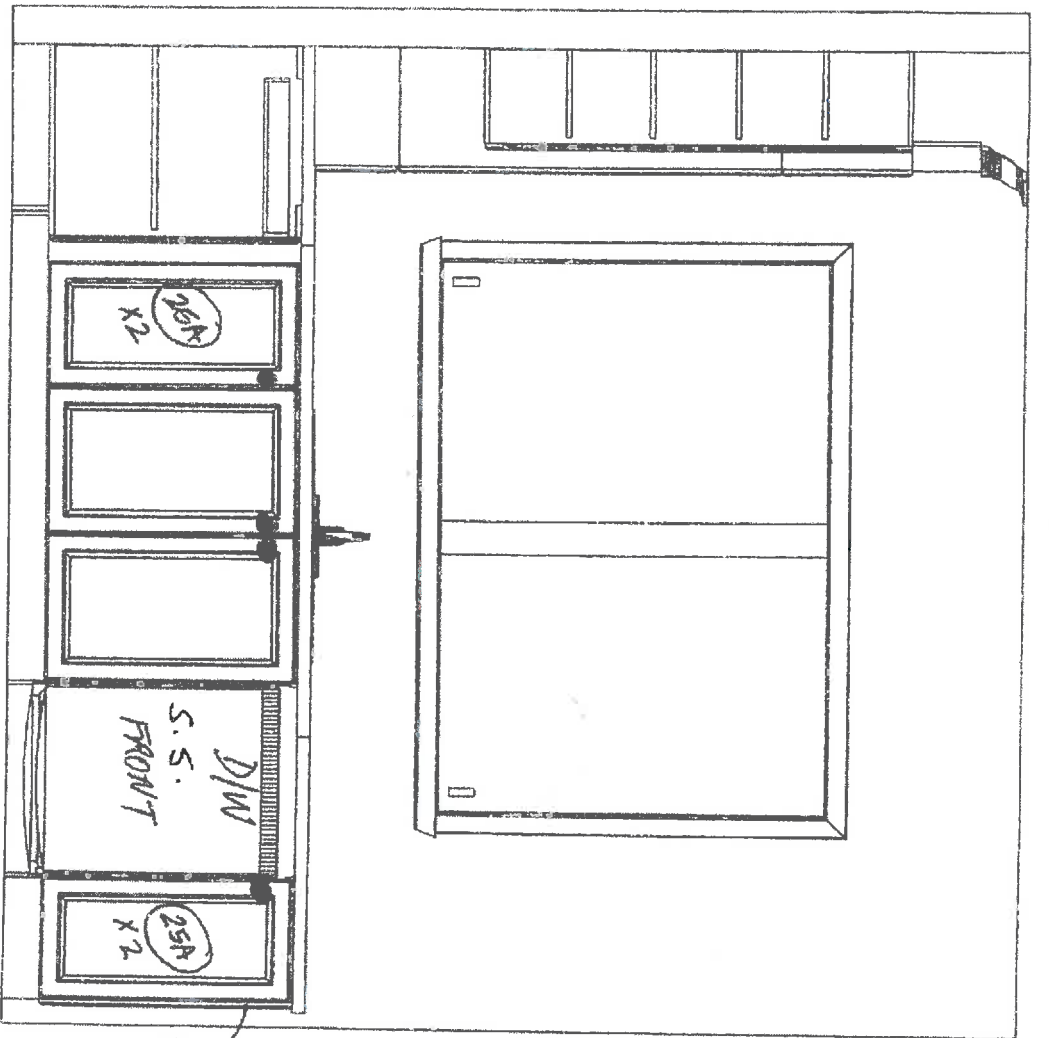

4 knobs

LOT. 101
SCHOLTEN

HAVE READ AND
RETURNED AND
THIS FOR INFORMATION

[Signature]

[Signature]

CUSTOMER SIGNATURE

Knob •

3

LOT. 101
SCHOLTEN

ISLAND FRONT

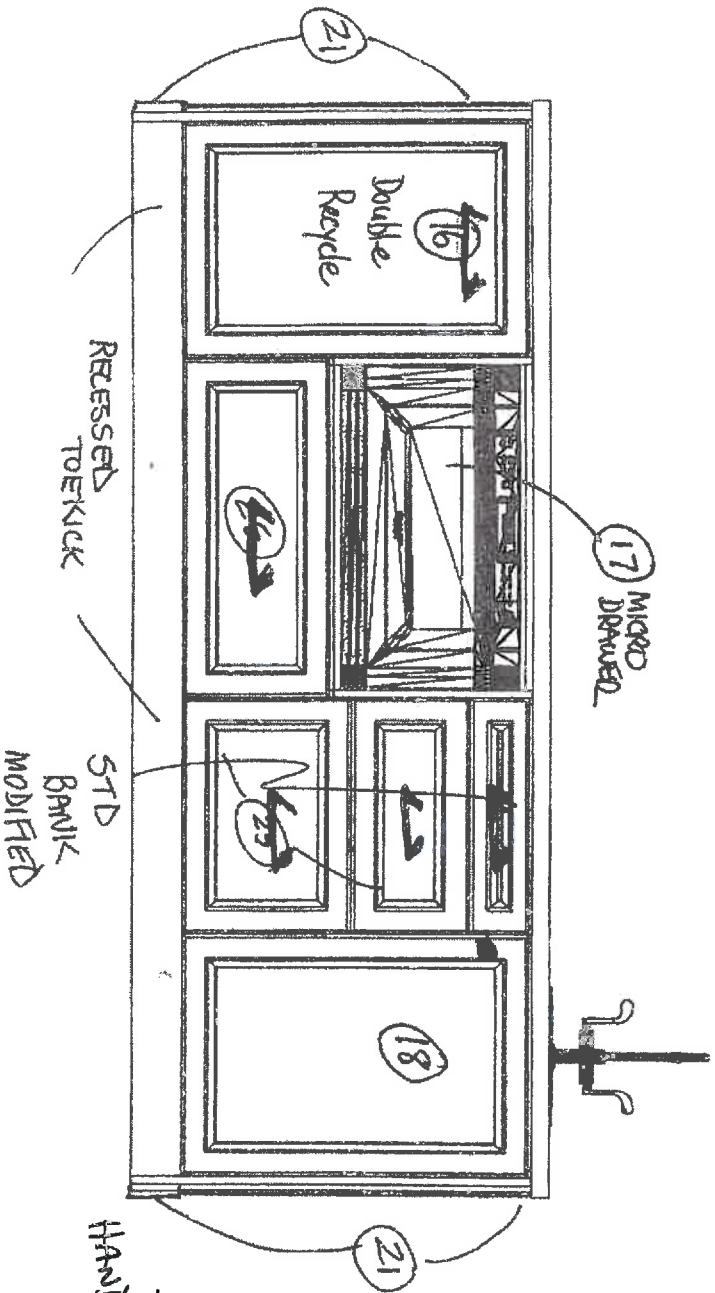

* 1 knob
5 pulls

knob •
HANDLE/PULL

4

This sketch is provided solely for reference. Those items noted on the accompanying "Upgrades" all other details, dimensions layouts are for illustrative purposes only and may not be representative of the actual product.

1 knob
5 pulls

CUSTOMER SIGNATURE

HAVERHILL
RELIABLE
THREE STAR CORPORATION

SERVERY

This sketch is provided solely for reference to those items noted on the accompanying "Upgrades" all other details, dimensions, layouts are for illustrative purposes only and may not be applicable to the purchaser's model. All dimensions, specifications, and locations are only possible and approximate

Site - ZANCOR-CASTLES OF KING CITY
 LOT 101 Date SEP. 18, 2015
 Purchaser's Signature [Signature]

THIS DRAWING AND ALL SPECIFICATIONS ARE THE PROPERTY OF THE DRAWING FIRM AND ARE NOT TO BE REPRODUCED OR USED IN ANY MANNER WITHOUT THE WRITTEN PERMISSION OF THE DRAWING FIRM.

[Signature] [Signature]

NATURE

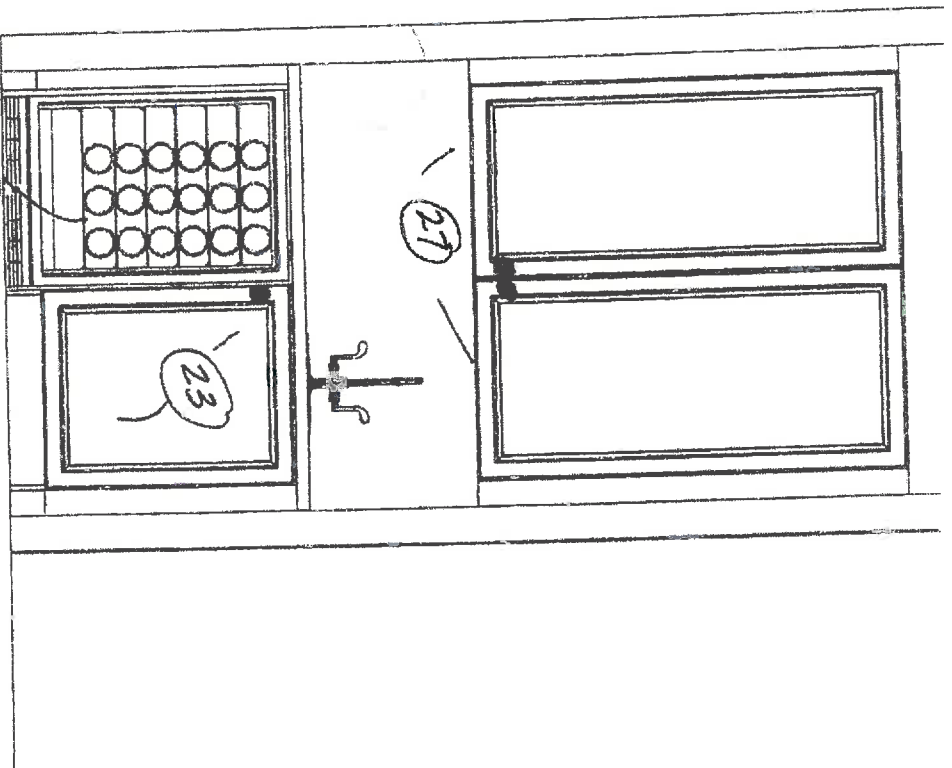

BTR
 FALGOUT 22

Note: This drawing is an artistic interpretation of the general appearance of the design. It is not meant to be an exact rendition.	30 101	Designed: 9/8/2015 Printed: 9/17/2015 Drawing 2 Drawing #: 1
---	-----------	--

5

Site - ZANCOR-CASTLES OF KING CITY
 LOT 101 Date SEPT. 18, 2015
 Purchaser's Signature [Signature]

Sketches
Summary

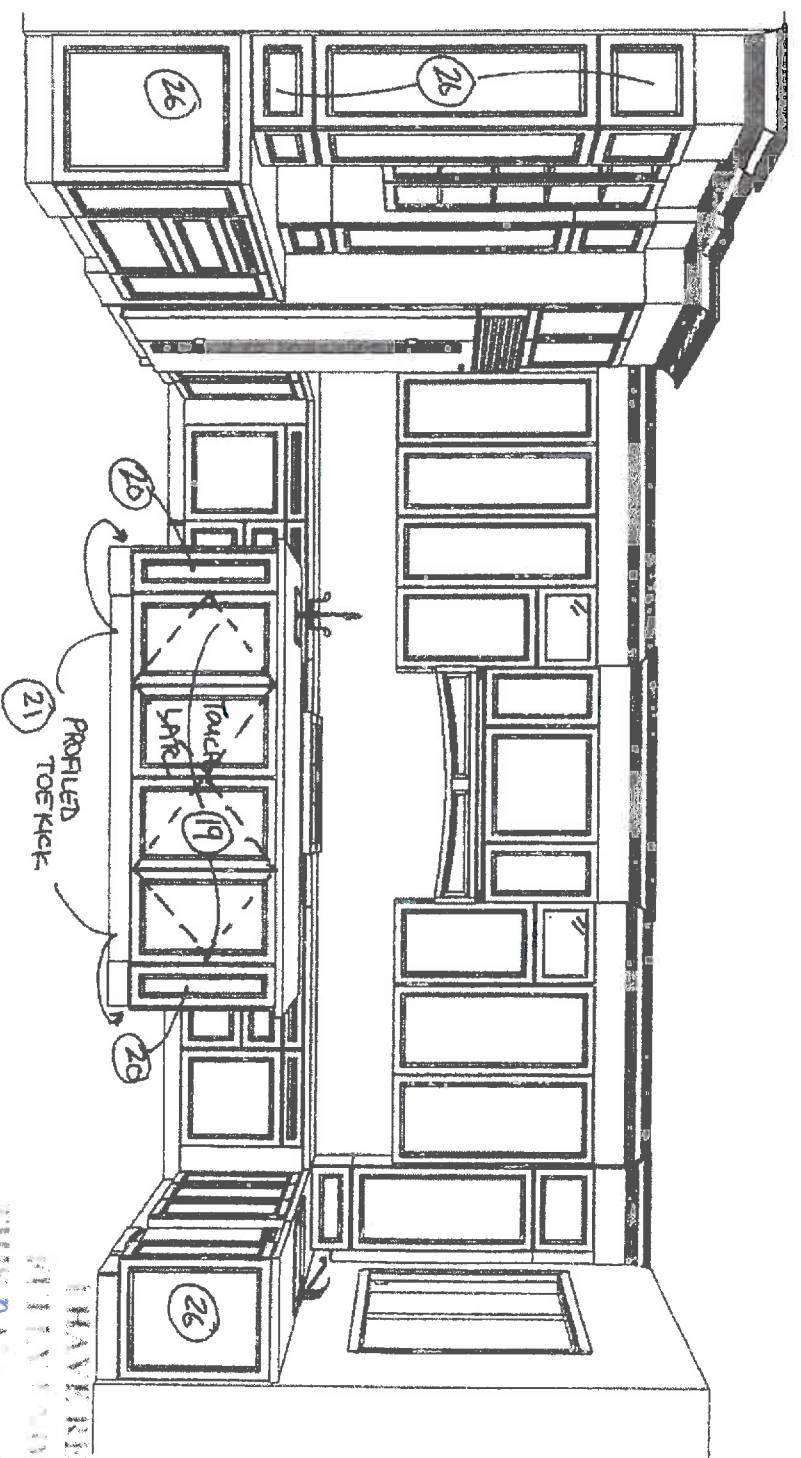

* Kitchen 707022

37 knobs
 20 pulls

knobs •

Handle / Pull →

Note: This drawing is an artistic interpretation of the general appearance of the design. It is not meant to be an exact rendition.

20	Designed: 9/8/2015 Printed: 9/17/2015
101	

CUSTOMER SIGNATURE

[Signature]

6

**LOT. 101
SCHOLTEN**

This sketch is provided solely for reference to those items noted on the accompanying "Upgrades" all other details, dimensions layouts are for illustrative purposes only and may not be applicable to the purchaser's model. All dimensions, specifications, and locations are only possible and approximate

Site - ZANCOR-CASTLES OF KING CITY

LOT 101 Date SEP. 18, 2015

Purchaser's Signature [Signature]

HAVERHILL AND
HILL STREET AND
TRIPPLE STREET

CITY OF SCHOLTON
[Signature]
[Signature]

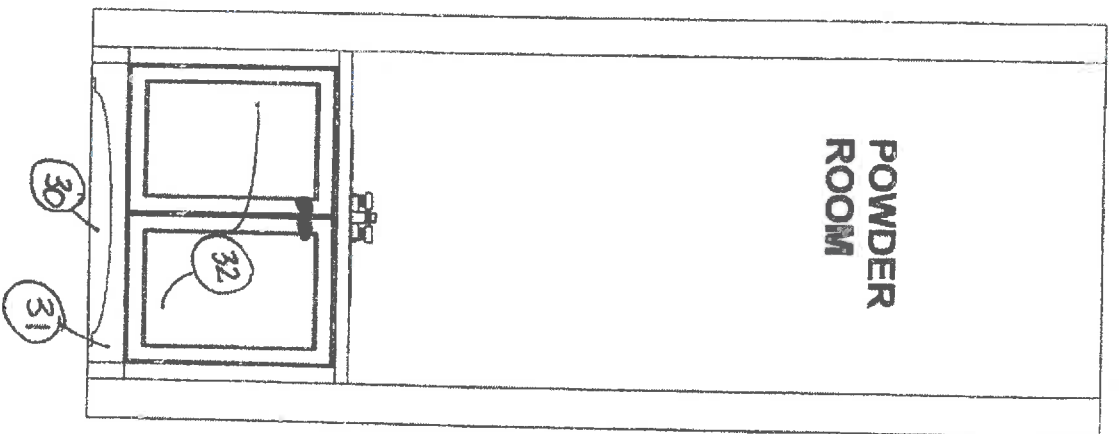

* 2 knobs

Knobs •

7

MASTER ENSUITE

LOT. 101
SCHOLTEN

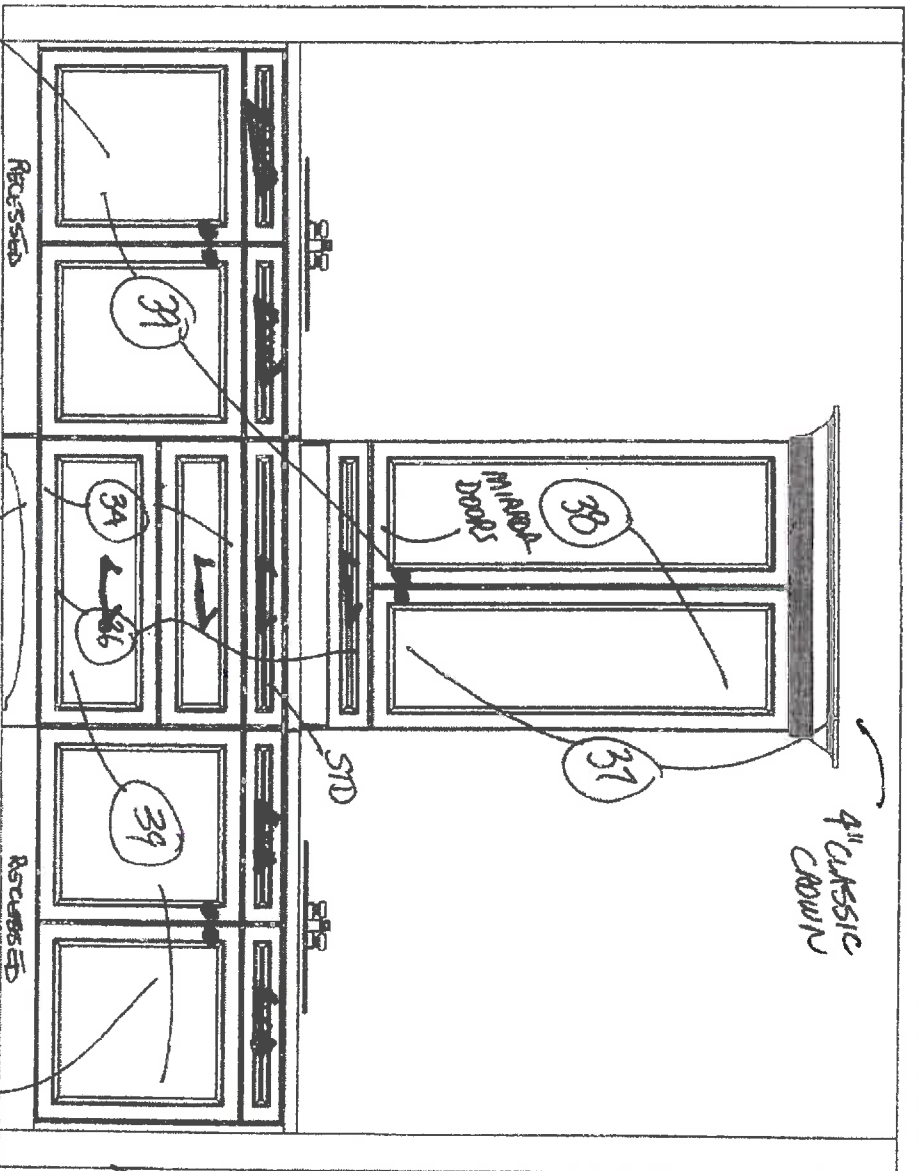

33 KITCHEN
HEIGHT
VANITIES

I HAVE READ AND
FULLY UNDERSTAND
THESE TERMS AND
CONDITIONS

CUSTOMER SIGNATURE

4 6 KNOBS
8 PULLS

KNOB •
HANDLE/PULL

8

2ND FLOOR LAUNDRY

LOT. 101
SCHOLTEN

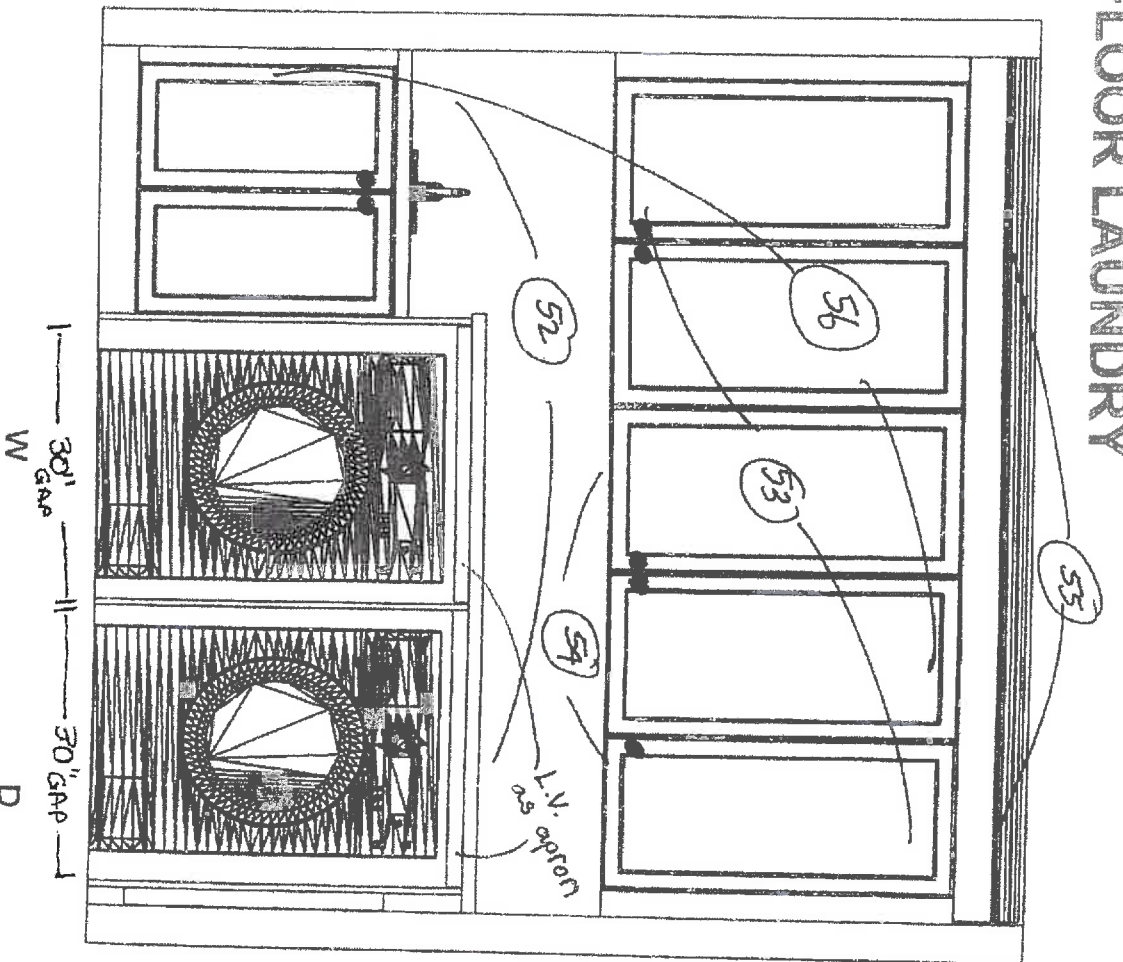

* 7 knobs

Knobs •

9

I HAVE READ AND
FULLY UNDERSTAND
THIS AGREEMENT
AND I AGREE TO
THE TERMS AND
CONDITIONS
HEREIN

BED 4 ENSUITE

(Skin)

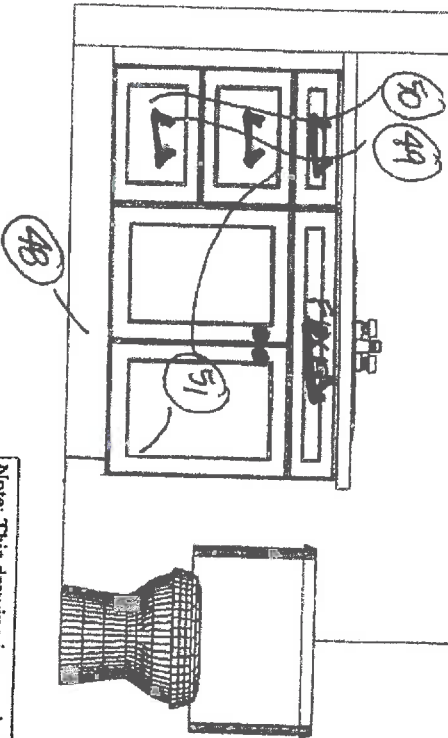

* 2 knobs
4 pulls

knob •
handle / pull →

Note: This drawing is an artistic interpretation of the general appearance of the design. It is not meant to be an exact rendition.

NOT IN SCHEDULE TEN - 50.0 VANITIES

Drawing 9 Drawing # 1

20
Titanium
Designed: 6/30/2015
Printed: 9/17/2015

101

10

CUSTOMER SIGNATURE

[Signature]

[Signature]

LOI. 101
SCHOLTEN

BASEMENT
LAUNDRY

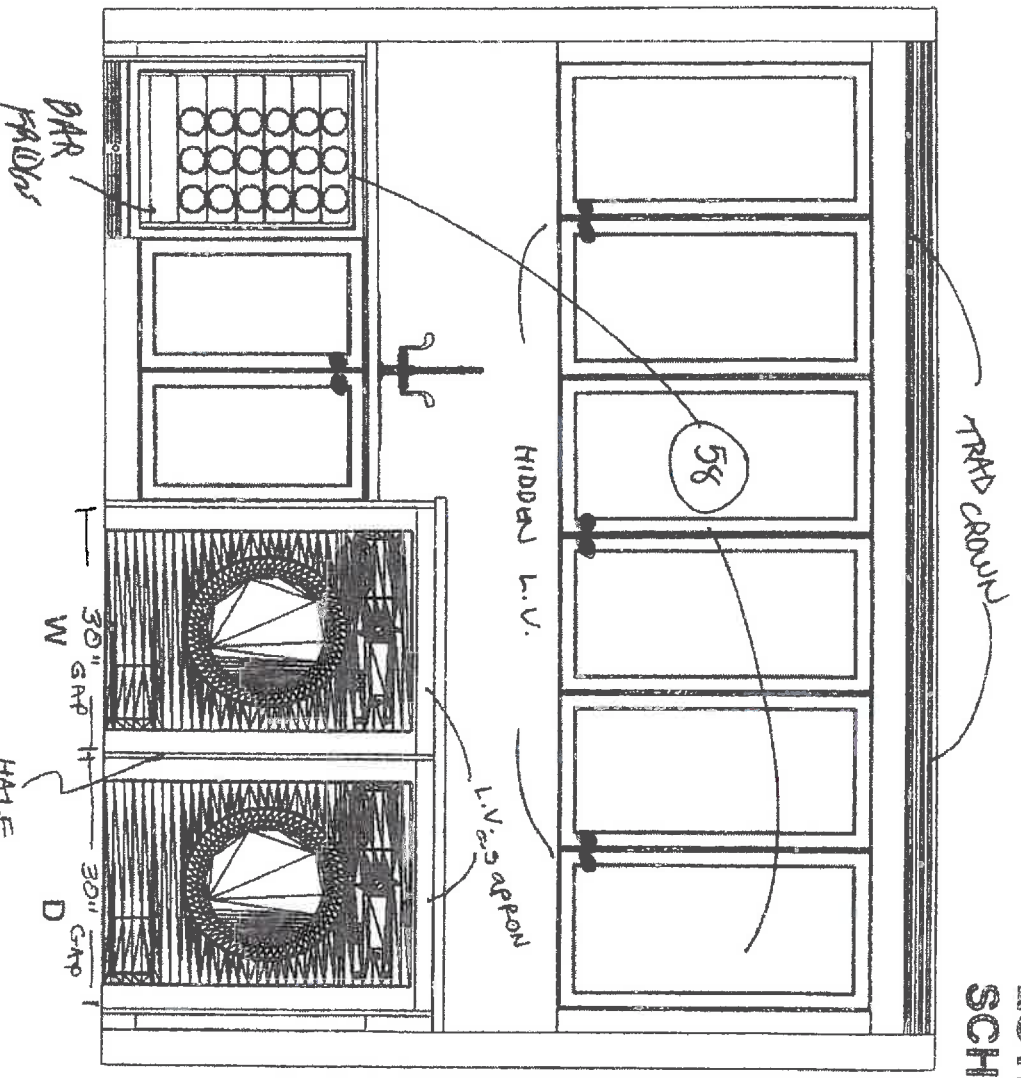

8 K2025

K203 •

(11)

BASEMENT
LAUNDRY
CABINETS
WASHER
DRYER
T.V. SADDON
HIDDEN L.V.
W
D
30\"/>

LOT. 101
SCHOLTEN

BASEMENT BATH

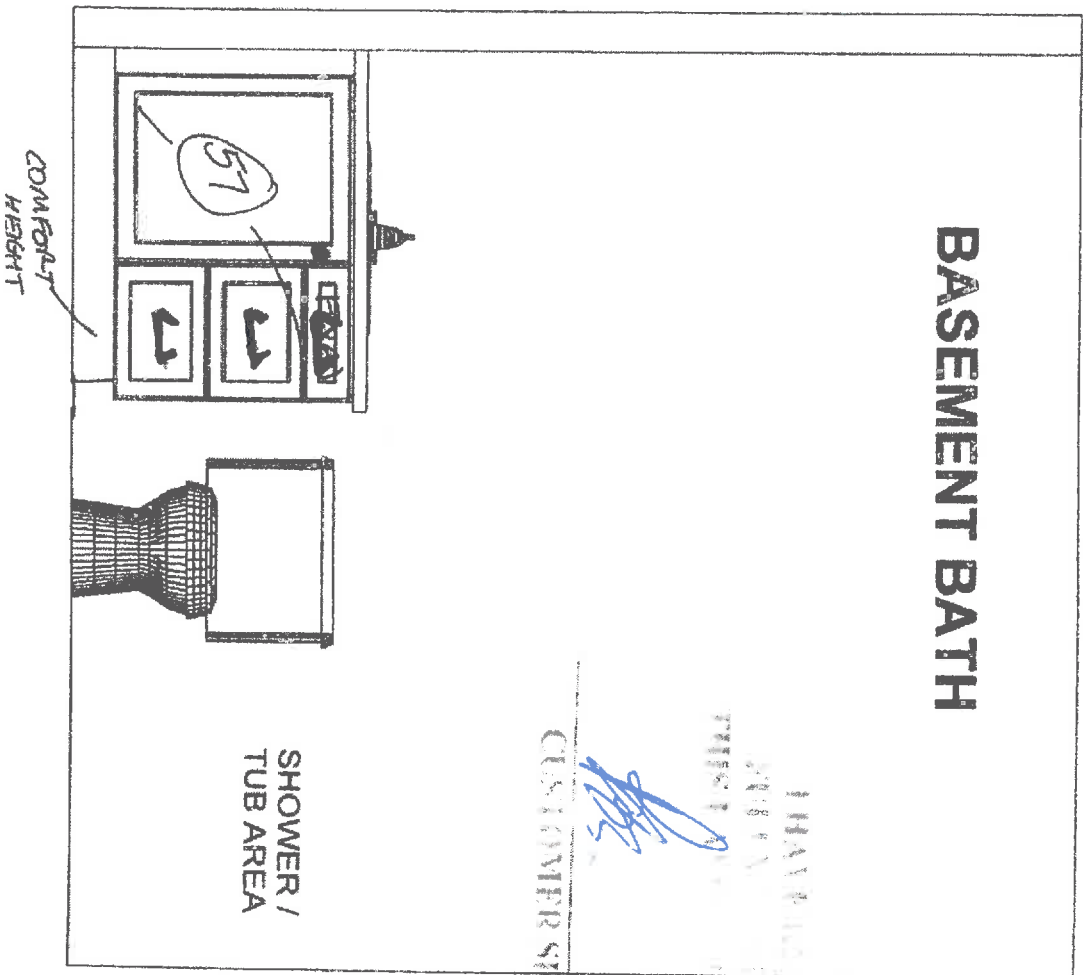

CUSTOMER SIGNATURE

* 1 knob

3 pulls

knob •

Handle / Pull

12

MASTER ENSUITE STUDY BUILT-INS

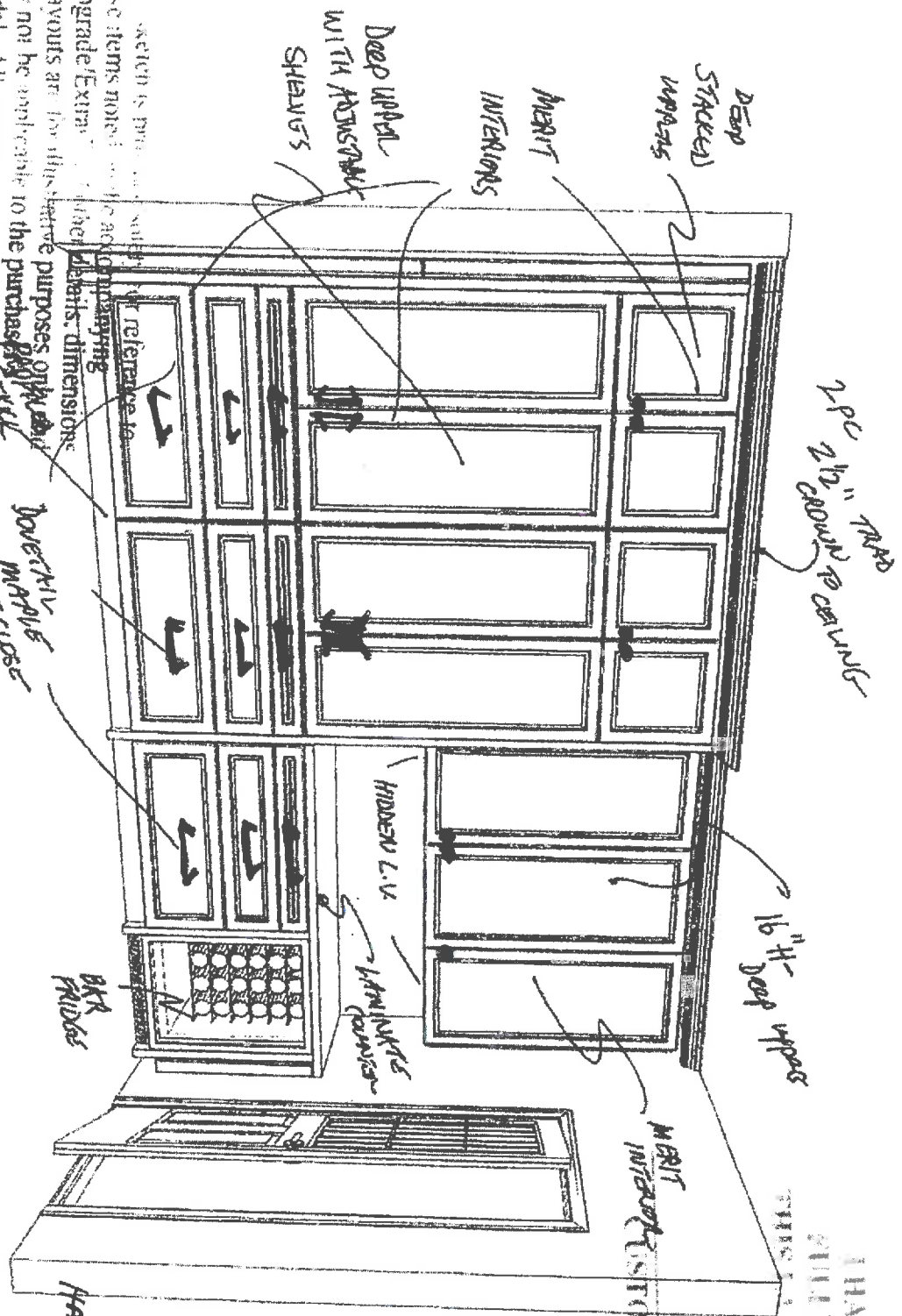

13 KNOBS
HANDLE/PULL

13

Sketch is provided solely for reference to those items noted on the accompanying Upgrade/Extra sheet. Other details, dimensions, layouts are for illustrative purposes only and may not be applicable to the purchase of this model. All dimensions, specifications and location, only if possible and approximate.

Site: ZANCO CASTLES

Lot: 101 Date: Feb 9, 2016

Purchaser Signature: _____

Note: This drawing is an artistic interpretation of the general appearance of the design. It is not meant to be an exact rendition.

MASTER PRIVATE STUDY WITH UPPERS

All

Drawing #: 1

20

Designed: 12/9/2015
Printed: 2/1/2016

CLIVE BRAND
FIREPLACE
FAMILY ROOM
FIREPLACE
BUILT-INS

2PC 4" CLASSIC
CROWN
CROWN
CROWN

38MM
FIXED SHELVES
(5+/-) EQUAL 4-
SPACING
FOR OUTLET SECTIONS

MATCHING
MDF CROWN
TOP

DO NOT
FIX
MDF CROWN
SOFT DRAWERS

80" W x 4"
HEIGHT

FIRE PLACE
AREA
MATERIALS
76 1/2" x 4"

FIBERGLASS
NOT EXACTLY
AS SHOWN

PROVIDE
TOE KICK

HEIGHT
INDICATORS

38MM THICK
FIXED SHELVES
(4 SECTIONS)
3 SHELVES (4 SECTIONS)
WITH EQUAL 4-
SPACING
FOR CROWN SECTIONS

* 4 KNOBS
4 PULLS

HANDLE/PULL

(14)

Sketch is provided for reference to those items noted in accompanying details, dimension layouts are for illustrative purposes only and may not be applied to the purchaser's model. All dimensions, specifications and locations are only if possible and approximate Site ZINCOR CHS/LS

Lot 101 Date Feb 9, 2016

Purchaser Signature

Please Sign

Note: This drawing is an artistic interpretation of the general appearance of the design. It is not meant to be an exact rendition.

FAMILY ROOM FIRE PLACE UNITS 3

20 TECHNOLOGIES
Designed: 12/23/2015
Printed: 2/1/2016

101

All Drawing # 1

MUD ROOM

CUSTOMER SIGNATURE

4" CUPESIC
4" CROWN
CROWN
+ Shelf above

BEFORE BOARD
PICK UP

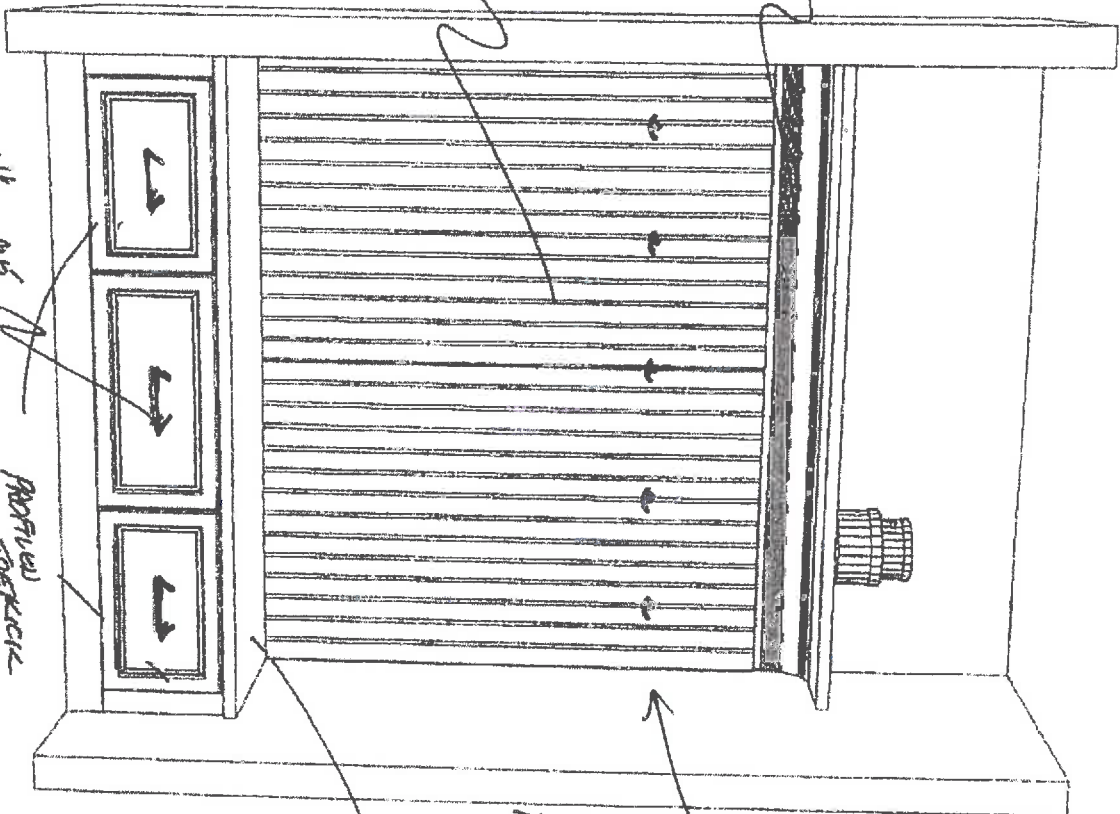

5 Hooks
* 3 pulls

Handle/pulls

MATCHING VENEER
COUNTER TOP AS SET
WITH 2" DUAL HANG
AT FRONT

ARTIST'S
RENDERING

15" HIGH
15" DEEP
DOLE 50 FT
PX DARK WOODS

Note: This drawing is an artistic interpretation of the general appearance of the design. It is not meant to be an exact rendition.

This sketch is provided solely for reference to those items noted on the accompanying upgrade/Extras. All other details, dimensions & layouts are for illustrative purposes only and may not be applicable to the purchaser's model. All dimensions, specifications and locations are only if possible and approximate

Site ZAVCOA CRYSTALS

Lot 101 Date Feb 9, 2016

Purchaser Signature _____

MUD ROOM 2

All

Drawing #: 1

20
Designed: 12/9/2015
Printed: 2/1/2016

101

15