

Lot 28
Phase South
Model Eden (50-07) Elev A
REGINA VOLOVIK

Colours Upgrade Report
The Castles of King City Print Date:19-Sep-16

- PE With Agreement
- LOOK OUT BASEMENT - LARGER BASEMENT WINDOW AT REAR OF HOME NO DECK NO STAIRS
 - Rear Upgrade

COLOURS

ID	Group	Description	Invoice	Date Ordered	
3575 ✓	STRUCTURAL	UPGRADE DOORS ON THE 2ND FLOOR TO 8 FT (16)	663		
3577)	STRUCTURAL	MASTER ENSUITE SHIFT WALL BY APPROX 1 FT , WATER CLOSET TO BE 5 FT INSIDE DEPTH SHIFT WINDOW BY APPROX 1 FT **Rotate tub, elarge shower and extend full wall**	663		
3578)	STRUCTURAL	PLUMBING ADD BIDET CONTRAC CALE BIDET MODEL 4830BLX ,GROHE PARKFIELD FAUCET MODEL 24033000 INCLUDES ROUGH IN INCULDES INSTALLATION	663		
3579)	STRUCTURAL	MASTER BEDROOM DRESSING ROOM CUT WALL BACK TO APPROX 32 INCHES NOTE DEPTH OF WALL TO MATCH OPPOSITE SIDE , ADD STANDARD POST RAILING AND PICKETS DELELTE 2 DOORS INTO DRESSING AREA NOTE HEIGHT (HEADER) OPENING INTO DRESSING ROOM & MASTER BEDROOM 8 FEET	663		
3581 ↓	STRUCTURAL	ELECTRICAL ADD HEATED FLOORS IN MASTER ENSUITE	663		
3582 ↓	STRUCTURAL	UPGRADE ENSUITE 3 TO 32 X 60 FRAMLESS 10 MM GLASS SHOWER IN LIEU OF TUB	663		
3583)	STRUCTURAL	ADD WAFFLE CEILING IN DINING ROOM DESIGN SAME AS LOT 51 MODEL HOME DINING ROOM **CORNICE MOULDING EXTRA COST	663		
3585 ↓	STRUCTURAL	ADD WALK UP APPROX 5-6 RISERS DOUBLE DOORS, EXPOSED CONCRETE WALLS	663		
3618)	STRUCTURAL	ADD OPTIONAL FIRREPLACE IN MAIN FLOOR PARLOUR STANDARD PAINT GRADE MANTLE AND MARBLE SURROUND	663		
4549 ✓	COLOURS	KITCHEN UPGRADES PARIS KITCHENS DATED AUGUST 12, 2016 ✓	809		
4550	COLOURS	TILES FLOOR UPGRADE #6 FOYER AND POWDER ROOM ✓	809		
4551	COLOURS	HARDWOOD UPGRADE # 4 ✓	809		
4552	COLOURS	TRIM AND BASEBOARD UPGRADE # 2 ✓	809		
4553	COLOURS	COUNTER TOPS KITCHEN UPGRADE # 3 INCLUDES RANGE TOP CUT OUT ✓	809		
4554	COLOURS	COUNTER TOP MASTER ENSUITE UPGRADE # 1 ✓	809		
4555	COLOURS	COUNTER TOP POWDER ROOM UPGRADE # 1 ✓	809		
4556	COLOURS	COUNTER TOP UP GRADE # 2 ENSUITE # 2 INCLUDES RECTANGULAR UNDERMOUNT SINK ✓	809		
4557	COLOURS	COUNTER TOP UPGRADE # 1 ENSUITE # 3 INCLUDES RECTANGULAR UNDERMOUNT SINK ✓	809		
4558	COLOURS	COUNTER TOP UPGRADE # 1 ENSUITE # 4 INCLUDES RECTANGUALR UNDERMOUNT SINK ✓	809		
4562	COLOURS	PLUMBING UPGRADE TO POT FILLER CONTEMPORARY MODEL BY MOEN IN CHROME ✓ INSTALL CENTERED BEHIND STOVE	809		
4565	COLOURS	MASTER ENSUITE SHOWER AND WATER CLOSET TO BE CLEAR GLASS IN LIEU OF FROSTED GLASS ✓	809		

Lot 28
Phase South
Model Eden (50-07) Elev A
REGINA VOLOVIK

Colours Upgrade Report
The Castles of King City Print Date:19-Sep-16

4566	COLOURS	TRIM UPGRADE FRENCH DOORS IN (1) DEN AND (2) MAIN HALLWAY TO 3/4 PANEL 1 LITE FROSTED DOOR IN LIEU OF STANDARD FRENCH DOORS ✓	809		
4568	COLOURS	ELECTRICAL FOR BUILT IN WALL OVEN 240 V ✓	809		
4612	COLOURS	HVAC UPGRADE STOVE EXHAUST VENT TO 8 INCHES IN LIEU OF STD 6 INCHES ✓	809		
4617	COLOURS	TILES DECLINED STANDARD TILE BACSPLASH ✓	809		

ZANCOR HOMES COLOUR CHART

CABINETRY / COUNTERTOPS						
	DOOR STYLE	HARDWARE	COUNTERTOP	EDGE		
Kitchen	AS PER PARIS KITCHENS	AS PER PARIS	BIANCO ANTICO (3)	C		
Prep Area	AS PER PARIS KITCHENS	AS PER PARIS	BIANCO ANTICO (3)	C		
Master Ensuite	AS PER PARIS KITCHENS	AS PER PARIS	PLATINUM (1)	H		
2nd Ensuite	AS PER PARIS KITCHENS	AS PER PARIS	K 609 (2)	H		
3rd Ensuite	AS PER PARIS KITCHENS	AS PER PARIS	K 319 (1)	H		
4th Ensuite	AS PER PARIS KITCHENS	AS PER PARIS	K319 (1)	H		
Laundry	AS PER PARIS KITCHENS	AS PER PARIS	PORTICO MARBLE			
Powder Room	AS PER PARIS KITCHENS	AS PER PARIS	EMPERADOR GREY (1)	H		
TILES						
			INSERTS	Shower Jambos		
Kitchen Floor	NA	HARDWOOD				
Breakfast Floor	NA	HARDWOOD				
Kitchen Bk.Splash	DECLINED					
Main Foyer	ALL WHITE LUX 24 X 24 UPGRADE # 6	✓				
Main Hall	NA	✓				
Powder Room	ALL WHITE LUX 24 X 24 UPGRADE # 6	✓				
Laundry	MELINA ICE 13 X 13					
Mud Room	CINQ WHITE 13 X 13	✓				
Basement Foyer	ORLEANS SILVER 20 X 20	✓				
Mstr Ensuite Floor	CALCATTÀ GRIS 20 X 20	✓			✓	PERLATO ROY
Mstr Ensuite Shower wall	CALCATTÀ GRIS 20 X 20	✓				
Master Shower Floor	2 X 2 WHITE	✓				
2nd Ensuite Floor/Tub deck	MELINA CARBON 13 X 13	✓			✓	BIANCA CARR
2nd Ensuite ShowerWall	MELINA CARBON 8 X 10	✓				
2nd Ensuite Shwr Floor	2 X 2 WHITE	✓				
3rd Ensuite Floor	MELINA ICE 13 X 13	✓				
3rd Ensuite Shower Wall	MELINA ICE 8 X 10	✓			✓	BIANCA CARR
3rd Ensuite Shwr Floor	2 X 2 WHITE	✓				
4th Ensuite Floor	MELINA ICE 13 X 13	✓				
4th Ensuite Tub Wall	MELINA ICE 8 X 10	✓				
HARDWOOD / CARPET						
Parlour	VINTAGE SOLID SAWN PEARL WHITE OAK GOTHAM 5"	UPGRADE # 4				
Dining Room	VINTAGE SOLID SAWN PEARL WHITE OAK GOTHAM 5"	UPGRADE # 4				
Family/Great Room	VINTAGE SOLID SAWN PEARL WHITE OAK GOTHAM 5"	UPGRADE # 4				
Den/Study	VINTAGE SOLID SAWN PEARL WHITE OAK GOTHAM 5"	UPGRADE # 4				
Kitchen *(Waiver)	VINTAGE SOLID SAWN PEARL WHITE OAK GOTHAM 5"	UPGRADE # 4				
Main Foyer *(Waiver)	VINTAGE SOLID SAWN PEARL WHITE OAK GOTHAM 5"	UPGRADE # 4				
Main Hall	VINTAGE SOLID SAWN PEARL WHITE OAK GOTHAM 5"	UPGRADE # 4				
Upper Hall	VINTAGE SOLID SAWN PEARL WHITE OAK GOTHAM 5"	UPGRADE # 4				
Master Bedroom	VINTAGE SOLID SAWN PEARL WHITE OAK GOTHAM 5"	UPGRADE # 4				
Bedroom 2	VINTAGE SOLID SAWN PEARL WHITE OAK GOTHAM 5"	UPGRADE # 4				
Bedroom 3	VINTAGE SOLID SAWN PEARL WHITE OAK GOTHAM 5"	UPGRADE # 4				
Bedroom 4	VINTAGE SOLID SAWN PEARL WHITE OAK GOTHAM 5"	UPGRADE # 4				
Carpet Underpad		NA				
Basement Foyer		NA				
Other		NA				
FIREPLACES						
LOCATION	FAMILY ROOM & PARLOUR	✓	MANTLE		NF 8	✓
INSERT & SURROUND	CREMA MARFIL	✓	HEARTH		NA	
MIRRORS & ACCESSORIES						
Mirrors	STANDARD	Crown Moulding		102	✓	
Bathroom Accessories	STANDARD	Location		DINING ROOM	✓	
Purchaser has reviewed the colour chart			LOT / SITE			
FOR TRADE USE			2859 Carolineville			
Any upgrades in the colour chart must be accompanied with a PES. It is the responsibility of all Trades to inform the builder of any discrepancies on sketches, PES and/or colour charts PRIOR to installation.			Purchaser Initial		Vendor	
** PAGE 1 OF 2 **						

FC AUG 25 2016

ZANCOR HOMES COLOUR CHART

STAIRS, RAILING & PICKETS & STAIR STAIN		
Stair Stain / Species:	STAIN TO MATCH GOTHAM	
Main to 2nd Railing Details:	Single collar w/alt Plain w /shoes (0101) R6 (3") grooved oak handrail 3 1/2 sq oak champhered posts	
Main to Basement Railing Details:	Single collar w/alt Plain w /shoes (0101) R6 (3") grooved oak handrail 3 1/2 sq oak champhered posts	
WHITE Paint Req'd & Where:	NA	

TRIM		
Casing/Baseboards	UPGRADE # 2 STEP	
Interior Doors	STANDARD	
Interior Door Hardware	STANDARD	
Exterior Door Hardware	STANDARD	

PAINT		
Kitchen/Breakfast	OC 31 FOGMIST	Master Bedroom OC 31 FOGMIST
Living Room	OC 31 FOGMIST	Bedroom 2 OC 31 FOGMIST
Dining Room	OC 31 FOGMIST	Bedroom 3 OC 31 FOGMIST
Family/Great room	OC 31 FOGMIST	Bedroom 4 OC 31 FOGMIST
Den/Study	OC 31 FOGMIST	Ensuite OC 31 FOGMIST
Main/Upper Hall	OC 31 FOGMIST	4TH Ensuite OC 31 FOGMIST
Laundry	OC 31 FOGMIST	2nd Ensuite OC 31 FOGMIST
Powder Room	OC 31 FOGMIST	3rd Ensuite OC 31 FOGMIST

PLUMBING		
FIXTURES	FAUCETS	NOTES
Kitchen	STANDARD	
Powder Room	STANDARD	
Master Ensuite	STANDARD	
2nd Ensuite	UPGRADE	RECTANGULAR UNDERMOUNT SINK # 4210
3RD Ensuite	UPGRADE	RECTANGULAR UNDERMOUNT SINK # 4210
4TH Ensuite	UPGRADE	RECTANGULAR UNDERMOUNT SINK # 4210
Powder Room	STANDARD	

ZANCOR APPLIANCE REQUIREMENTS		
Appliance Package received in 'Schedule E'		

	UPG (SEE PES)	DECLINED	NOTES
GAS LINE	STANDARD		
WATERLINE to Fridge	STANDARD		
STOVE Venting SIZE	8"		
ELECTRICAL for Built-in Oven/Microwave	UPGRADE		OVEN/MW COMBO
ELECTRICAL for Built-in Micro / OTR	NA		
ELECTRICAL for Gas Stove / Cooktop	STANDARD		
ELECTRICAL for Bar Fridge	NA		

DISCLAIMER		INITIALS
Colours of all materials are as close as possible to Builders selection but not necessarily identical due to dye lot variances in manufacturing/manufacturers. Due to construction progress some items may have been pre-selected or installed. In this event the Vendor's selection must be accepted by the purchaser		

Any changes to the colour chart after signing are subject to a \$5000 administration fee plus costs		
Purchaser has checked and acknowledged accuracy of colour and selections before signing.		

SITE: CASTLES SOUTH	50-7 -A EDEN	LOT: 285	
PURCHASER(S):	Regina Volovik		
HOME #:	647-328 2389		
CELL #:	416 818 2885		

EMAIL:		Purchaser Signature	Date

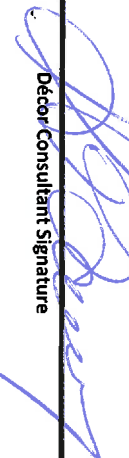
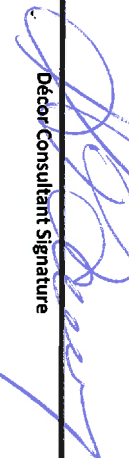
FOR TRADE USE	
Any upgrades in the colour chart must be accompanied with a PES.	
It is the responsibility of <u>all Trades</u> to inform the builder of any discrepancies on sketches, PES and/or colour charts <u>PRIOR</u> to installation.	
	
Décor Consultant Signature	Date
	
	AUG 25 2016

*** PAGE 2 OF 2 ***	Vendor Signature	Date
---------------------	------------------	------

August 28/2016

10/28

15/16

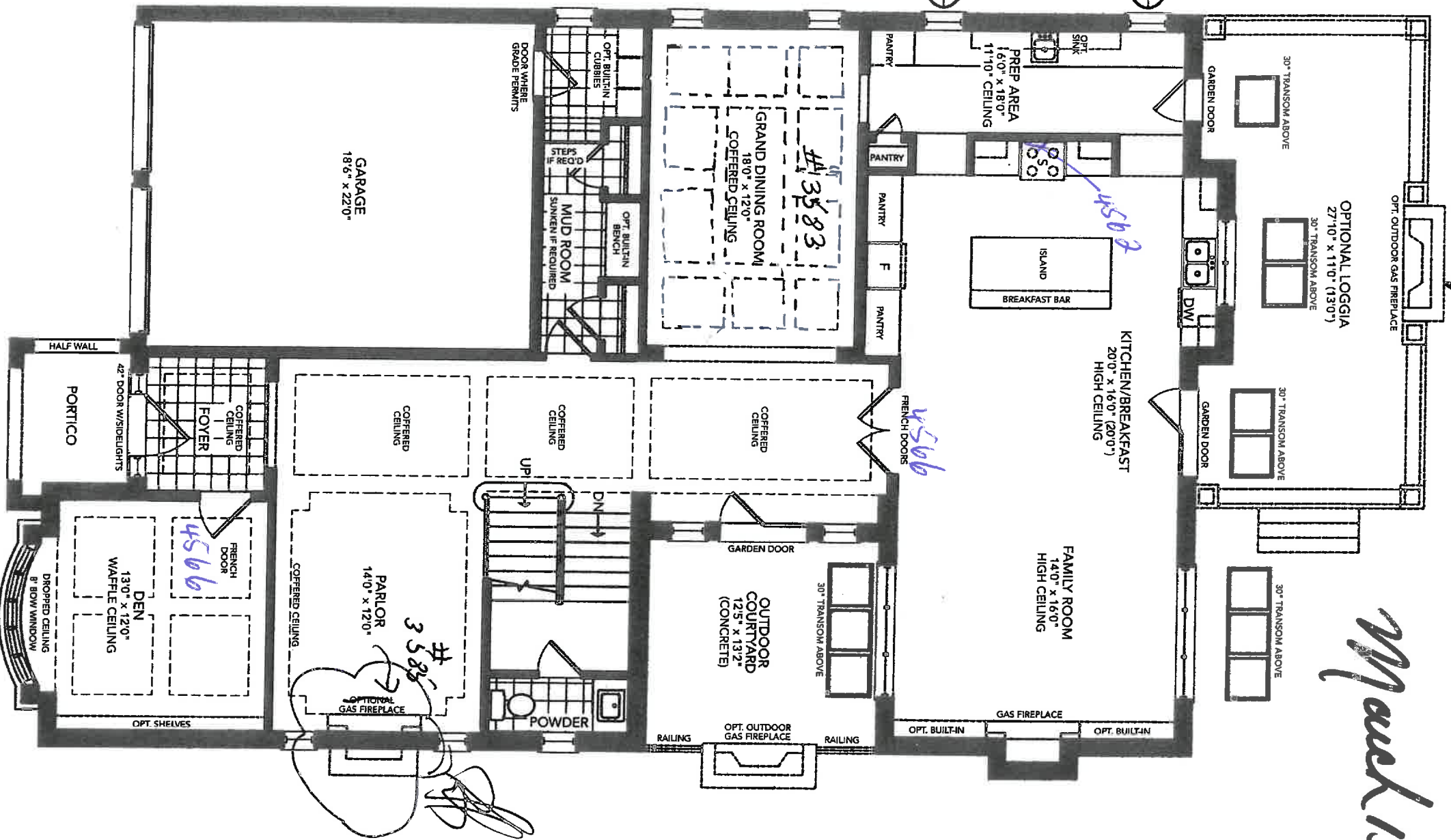

GROUND FLOOR - ELEVATION A

MAR 24 2016

ZANCOR HOMES
EDGE PROFILES (INTERSTONE / REDSTONE)

STANDARD

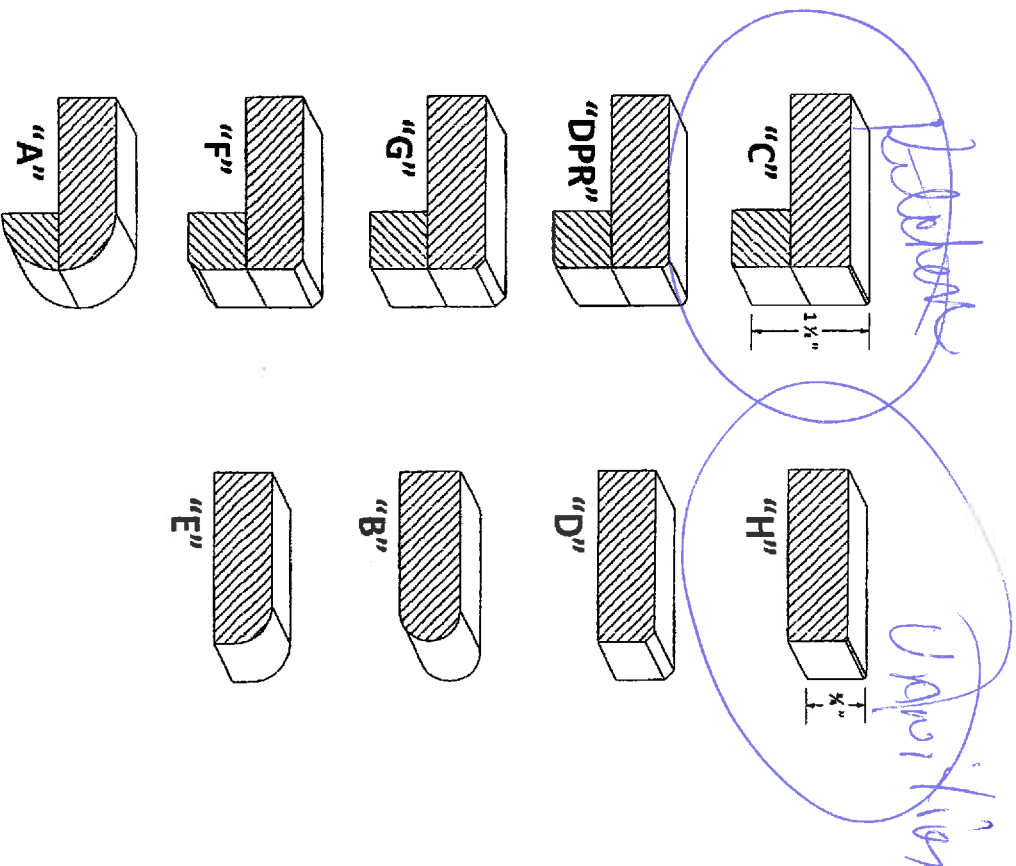

UPGRADES

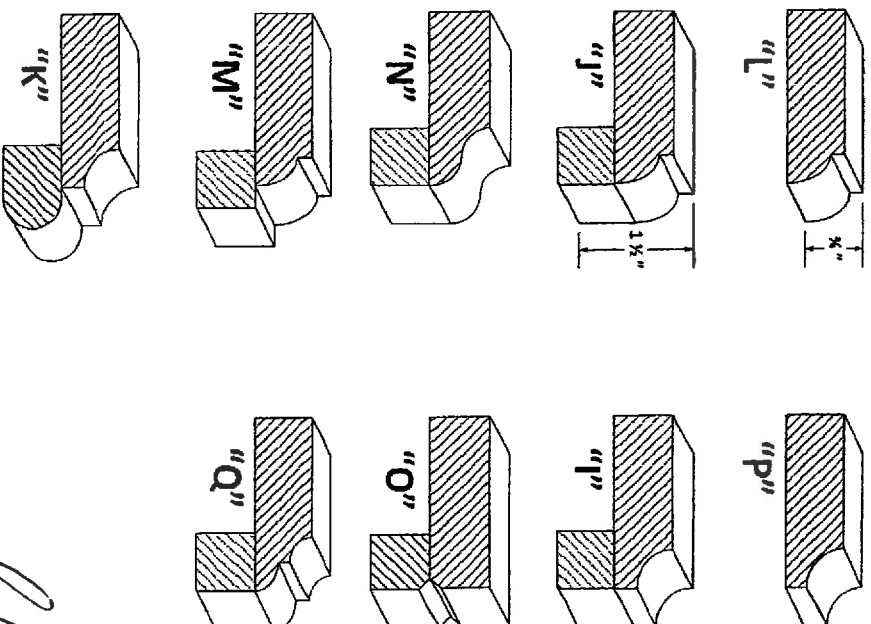

28 Soak
LOT / SITE

PURCHASER SIGNATURE

10

FROM: PARIS KITCHENS

STEPHANIE@PARISKITCHENS.COM

SITE: ZANCOR HOMES: CASTLES OF KING CITY

BUILDER NOTIFICATION FOR APPLIANCE SPECIFICATIONS

Please find attached appliance specifications (if applicable) as provided and signed off by the purchaser. **It is the responsibility of the builder to ensure that any electrical, water supply, gas fittings, venting and any other appliance requirements are reviewed with the purchaser directly.** It is also the responsibility of the builder to ensure that they have all relevant appliance spec's, as required to ensure installation of said appliances.

KITCHEN

NOTATIONS:

- **Standard countertop size** - Homeowner has not advised of any countertop changes (cabinetry below may be adjusted but countertop remains the standard sizing) Builder to confirm with homeowner.
 - ~~Under cabinet valance lighting~~ - Homeowner has requested valance lighting (cabinetry profile of _____ inches has been ordered). Builder to follow-up with homeowner and ensure that lighting meets cabinetry requirements, raised and flush —
 - **Bulkheads:** The kitchen layout is designed with NO BULKHEADS unless otherwise specified by the builder. Builder must alert Paris Kitchens immediately if bulkhead is required.
 - **Structural changes or revisions AFTER purchaser sign-off** : Builder must provide immediate notice to Paris Kitchens if any changes have been made after Paris Kitchens paperwork has been finalized
 - **Duct Notification** - Builder please be advised purchaser has purchased a hood that requires an 8" or 10" duct
- Also, refer to plan for duct location changes. Please refer to appliance package for exact duct size and additional requirements.

MASTER ENSUITE

NOTATIONS:

Kitchen height vanity

ENSUITE BATH 2

NOTATIONS:

Kitchen height vanity

ENSUITE BATH 3

NOTATIONS:

Kitchen height vanity

ENSUITE BATH 4

NOTATIONS:

Kitchen height vanity

LAUNDRY ROOM

NOTATIONS:

All standard selections



TORONTO OFFICE & SHOWROOM
245 WEST BEAVER CREEK RD., UNIT #2
RICHMOND HILL, ONTARIO L4B 1J1
PHONE: 905-886-5751

QUOTATION/ORDER



LOT # 28 S
KING CITY

SITE: ZANCOR HOMES : CASTLES OF KING CITY

TO: REGINA VOLOVIK	DATE : August 12, 2016
E-MAIL: REGINAVOLOVLIK@GMAIL.COM	MODEL TYPE: Eden 50-07
PHONE: 416-818-2885	CEILING HEIGHT: 10 feet

APPLIANCE PACKAGE	DOOR STYLE/FINISH/HARDWARE	COUNTER TOP	INSTALLATION
AS NOTED	AS NOTED	SELECT WITH BUILDER	INCLUDED
STANDARD DOOR STYLE SELECTION WILL HAVE COLOUR MATCHED MELAMINE EXPOSED SIDES, PANELS & ACCESSORIES TO SUPPLY & INSTALL. THE FOLLOWING UPGRADES IN LIEU OF STANDARD. ALL ELECTRICAL & FIXTURES ARE EXTRA WITH BUILDER			

CHARGEABLE ITEMS:

A	GAS COOKTOP - GAS LINE REQUIRED - REFER TO APPLIANCE SPECS FOR DETAILS ADDITIONAL COUNTERTOP MATERIAL MAY BE REQUIRED CONFIRM WITH PURCHASER	ADDITIONAL W/ BUILDER
B	ADDITIONAL WALL OVEN AND MICROWAVE TOWER- ADDITIONAL ELECTRICAL REQUIRED - REFER TO APPLIANCE SPECS FOR DETAILS	ADDITIONAL W/ BUILDER
C	POSSIBLE ADDITIONAL SINK LOCATED IN ISLAND AND SERVERY - REFER TO FLOOR PLAN FOR LOCATION	ADDITIONAL W/ BUILDER
D	ADDITIONAL BAR FRIDGE OPENING - ADDITIONAL ELECTRICAL REQUIRED - REFER TOP FLOOR PLAN FOR LOCATION	ADDITIONAL W/ BUILDER
E	UNDER CABINET LIGHTING - REFER TO FLOOR PLAN FOR LOCATION	ADDITIONAL W/ BUILDER
F	KITCHEN HEIGHT VANITIES MAY AFFECT ELECTRICAL OUTLET OR PLUMBING LOCATIONS	ADDITIONAL W/ BUILDER
SERVERY:		QTY
1	ADDITIONAL BAR FRIDGE OPENING	
SINK WALL :		QTY
2	ADDITIONAL DOUBLE BIN GARBAGE UNIT	
STOVE WALL :		QTY
3	ADDITIONAL GAS COOKTOP CABINET WITH TWO DRAWERS BELOW	
FRIDGE WALL :		QTY
4	WALL OVEN MICROWAVE TOWER WITH ONE DRAWER BELOW IN LIEU OF STANDARD DOUBLE DOOR PANTRY	
KITCHEN AND SERVERY GENERAL UPGRADES:		QTY
5	DOOR STYLE UPGRADE TO SHERWOOD MDF IN DOVE WHITE LOCATED ON STOVE WALL AND SINK WALL INCLUDES TWO TONE CHARGE FOR FRIDGE WALL ISLAND AND SERVERY IN COURTLAND ASHWOOD FINISH	
6	ADDITIONAL STACKED UPPER CABINETS THROUGHOUT KITCHEN AND SERVERY	
7	ADDITIONAL TOP FILLER MATERIAL FOR CROWN MOULDING AND UPGRADE STANDARD CROWN TO CLASSIC CROWN MOULDING	
MASTER ENSUITE:		QTY
8	KITCHEN HEIGHT VANITY	
9	DOOR STYLE UPGARDE TO RICHMOND MDF DOVE WHITE	

X



TORONTO OFFICE & SHOWROOM
245 WEST BEAVER CREEK RD., UNIT #2
RICHMOND HILL, ONTARIO L4B 1L1
PHONE: 905-886-5751

QUOTATION/ORDER



LOT # 28 S
KING CITY

SITE: ZANCOR HOMES : CASTLES OF KING CITY

TO: REGINA VOLOVIK

DATE : August 12, 2016

E-MAIL: REGINAVOLOVNIK@GMAIL.COM

MODEL TYPE: **Eden 50-07**

PHONE: 416-818-2885

CEILING HEIGHT: 10 feet

APPLIANCE PACKAGE	DOOR STYLE/FINISH/HARDWARE	COUNTER TOP	INSTALLATION
AS NOTED	AS NOTED	SELECT WITH BUILDER	INCLUDED

STANDARD DOOR STYLE SELECTION WILL HAVE COLOUR MATCHED MELAMINE EXPOSED SIDES, PANELS & ACCESSORIES TO SUPPLY & INSTALL THE FOLLOWING UPGRADES IN UEU OF STANDARD. ALL ELECTRICAL & FIXTURES ARE EXTRA WITH BUILDER

POWDER ROOM:

10 KITCHEN HEIGHT VANITY

ENSUITE BATH # 2 :

11 KITCHEN HEIGHT VANITY

ENSUITE BATH # 3 :

12 KITCHEN HEIGHT VANITY

ENSUITE BATH # 4 :

13 KITCHEN HEIGHT VANITY

LAUNDRY :

14 STANDARD SELECTIONS

NOTES:

1. SIZES OF CABINETS ARE SUBJECT TO CHANGE WITHOUT NOTICE BASED ON SITE MEASURE.
2. IT IS THE PURCHASERS RESPONSIBILITY TO CO-ORDINATE ALL PLUMBING, ELECTRICAL, MECHANICAL AND STRUCTURAL CHANGES WITH THE BUILDER. ANY COSTS ASSOCIATED WITH THESE CHANGES ARE TO BE PAID DIRECTLY TO THE BUILDER.
3. MELAMINE NOT EXACT MATCH TO WOOD.

The SANDERSON-HAROLD Company Limited

ALL CHANGES ARE FINAL UPON SIGNING

TERMS: UPGRADES PAYABLE DIRECTLY TO BUILDER

SUB TOT,
HST TAXES 13
TOTAL

DESIGNER NAME

STEPHANIE GOOD

I AM HEREWITH, ACCEPTING THE ABOVE QUOTATION & ATTACHED SKETCHES, WHICH I FULLY UNDERSTAND AND AM ORDERING ACCORDINGLY

I AM FULLY AWARE AND ACCEPT THAT THERE WILL BE NO CHANGES AND/OR DELETIONS AFTER SIGNING THIS DOCUMENT.

SHOULD CIRCUMSTANCES CHANGE AND THE BUILDER AUTHORIZES CHANGES, A \$300 (plus HST) ADMINISTRATIVE FEE APPLIES.

CUSTOMER SIGNATURE:

DATE: 12/08/2016

SITE: ZANCOR HOMES : CASTLES OF KING CITY

TO: REGINA VOLOVIK

DATE: August 12, 2016

KITCHEN : SINK WALL AND STOVE WALL

DOOR STYLE / SPECIES:	SHERWOOD MDF	INTERIOR:	STANDARD
COLOUR:	DOVE WHITE	DRAWER TYPE:	STANDARD
ISLAND:	NA	DOORS:	STANDARD
GLASS TYPE:	NA	LIGHT VALANCE:	STRAIGHT LIGHT VALANCE
GLASS CABINET INTERIOR:	NA	FILLER OR CROWN:	CLASSIC CROWN PLUS TFC



COUNTERTOP: BY OTHERS

TOE KICK COLOUR: COLOUR MATCH

KITCHEN : ISLAND FRIDGE WALL AND SERVERY

DOOR STYLE / SPECIES:	COURTLAND MAPLE	INTERIOR:	STANDARD
COLOUR:	ASHWOOD	DRAWER TYPE:	STANDARD
ISLAND:	NA	DOORS:	STANDARD
GLASS TYPE:	NA	LIGHT VALANCE:	STRAIGHT LIGHT VALANCE
GLASS CABINET INTERIOR:	NA	FILLER OR CROWN:	CLASSIC CROWN PLUS TFC
HARDWARE:	DA-94		
DRILLING:	STANDARD		
COUNTERTOP:	BY OTHERS	TOE KICK COLOUR:	COLOUR MATCH



MASTER ENSUITE

DOOR STYLE / SPECIES:	RICHMOND MDF	INTERIOR:	STANDARD
COLOUR:	DOVE WHITE	DRAWER TYPE:	STANDARD
CABINET HEIGHT:	KITCHEN HEIGHT	DOORS:	STANDARD
HARDWARE:	DA-90		
DRILLING:	STANDARD		
COUNTERTOP:	BY OTHERS	TOE KICK COLOUR:	COLOUR MATCH



ENSUITE BATH # 2

DOOR STYLE / SPECIES:	TALEN ALUMINUM EDGE	INTERIOR:	STANDARD
COLOUR:	SILVERLINE	DRAWER TYPE:	STANDARD
CABINET HEIGHT:	KITCHEN HEIGHT	DOORS:	STANDARD
HARDWARE:	DA-96		
DRILLING:	STANDARD		
COUNTERTOP:	BY OTHERS	TOE KICK COLOUR:	COLOUR MATCH



ENSUITE BATH # 3

DOOR STYLE / SPECIES:	TALEN ALUMINUM EDGE	INTERIOR:	STANDARD
COLOUR:	SILVERLINE	DRAWER TYPE:	STANDARD
CABINET HEIGHT:	KITCHEN HEIGHT	DOORS:	STANDARD
HARDWARE:	DA-96		
DRILLING:	STANDARD		
COUNTERTOP:	BY OTHERS	TOE KICK COLOUR:	COLOUR MATCH



ENSUITE BATH # 4

DOOR STYLE / SPECIES:	LAVAL MELMINE	INTERIOR:	STANDARD
COLOUR:	WHITE	DRAWER TYPE:	STANDARD
CABINET HEIGHT:	KITCHEN HEIGHT	DOORS:	STANDARD
HARDWARE:	DA-90		
DRILLING:	STANDARD		
COUNTERTOP:	BY OTHERS	TOE KICK COLOUR:	COLOUR MATCH



LAUNDRY

DOOR STYLE / SPECIES:	HARLOW THERMOFOIL	INTERIOR:	STANDARD
COLOUR:	WHITE	DRAWER TYPE:	STANDARD
		DOORS:	STANDARD
		LIGHT VALANCE:	NONE
		FILLER OR CROWN:	NONE
		HARDWARE:	DA-94
		DRILLING:	STANDARD
COUNTERTOP:	BY OTHERS	TOE KICK COLOUR:	COLOUR MATCH



PLEASE NOTE: ALL SELECTIONS ARE FINAL WITH SIGNATURE.

CUSTOMER SIGNATURE:

DATE: 12/08/2016

Paris Kitchens Appliance Sign-off Form

245 West Beaver Creek Rd, Unit 2, Richmond Hill, On, L4B 1LT | T: 905.886.5751 F: 905.886.8858

SITE: ZANCOR HOMES : CASTLES OF KING CITY

BUILDER NOTIFICATION FOR APPLIANCE SPECIFICATIONS

Please find attached appliance specifications, as provided and signed off by the purchaser. It is the responsibility of the builder to ensure that any electrical, water supply, gas fittings, venting and any other appliance requirements are reviewed with the purchaser directly. It is also the responsibility of the builder to ensure that they have all relevant appliance spec's, as required to ensure installation of said appliances.

Built-in appliance cut-out process:

- ☐ Once a date has been confirmed for the delivery of your appliances please contact our Customer Service Dept. at Paris Kitchens 905.886.5751
- ☐ We require at least **10 BUSINESS DAYS** notice to set up an appointment. We aim to schedule our Service installers to complete the cut-out(s) the day after the appliances have been delivered. Please keep in mind that all appointments are scheduled between Monday to Friday from 8:00am to 3:00pm. (Not including holidays)
- ☐ After our Service installers have completed the cut-out(s), the installation and connection of the appliances can proceed. We do not install or connect appliances; this must be arranged by the homeowner with the appropriate trades.
- ☐ Please sign-off on the attached package of:
APPLIANCE SPECIFICATIONS (PROVIDED BY PURCHASER)

Appliance specs provided:

- ☐
- ☐
- ☐ * SEE ATTACHED SPECS
- ☐ * STANDARD 24" WIDE BAR FRIDGE OPENING APPLIES

Built- In Appliance Installation Application

- ☐ FLUSH INSTALLATION - Built-in Fridge
- ☒ STANDARD INSTALLATION - Built-in Fridge
- ☐ FLUSH INSTALLATION - Built-in Oven/Micro
- ☒ EURO FIT - Built-in Oven/Micro
- ☐ STANDARD INSTALLATION - Built-in Oven/micro
- ☐ RANGE TOP BUMPED OUT BY _____"
- ☐ COOKTOP BUMPED OUT BY _____"

Purchaser Name (please print)

Regina Holovic

Signature



Purchaser Name (please print)

Signature

Standard appliance opening sign-off option:

If you have chosen not to supply appliance model's and specifications you may sign -off on "standard openings" provided below.

In doing this you are responsible that the appliances you purchase will fit into the openings provided.

- ☐ 37" wide X 73" high fridge opening
- ☐ 30 1/2" opening for freestanding range
- ☐ 24 1/8" for D/W
- ☐ 30" opening for hoodfan

☐ microwave _____

Purchaser Name (please print)

Signature



Purchaser Name (please print)

Signature

LOT # 28 S KING CITY

Date: August 12, 2016

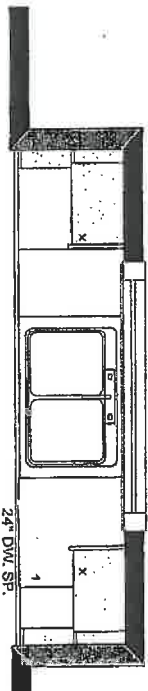

BAR &
FRIDGE

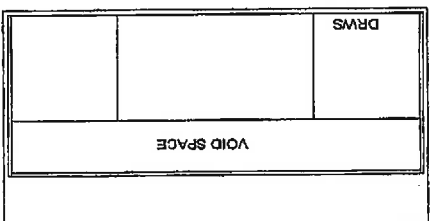
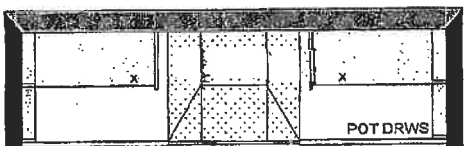

Extended Flush Br. Bar By Others

BUILDER - ZANCOR HOMES
PROJECT - THE CASTLES OF KING CITY
MODEL TYPE - 50-7
ELV A, B, C
CROWN MOULDING X 6
STRAIGHT LIGHT VALANCE X 4
C.TOP BY OTHERS

PANTRY

WALL GIVEN 36\"/>

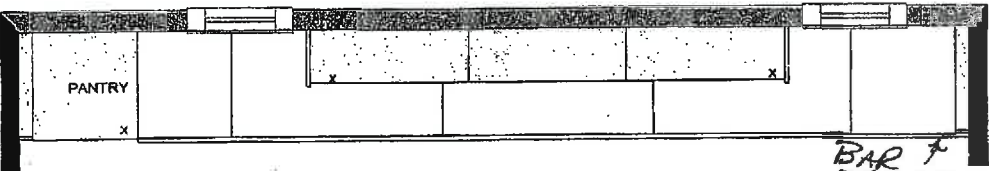

PANTRY

CUST. UPPER

PULL CABS. ALONG FRIDGE WALL

ZANCOR HOMES CASTLES OF KING MODEL 50-07

Note: This drawing is an artistic interpretation of the general appearance of the design. It is not meant to be an exact rendition.

2020
TECHNOLOGIES

Designed :09/08/2016
Printed: 10/08/2016

50-7 KIT LOT 23 AND 28 SOUTH

Drawing 1 Drawing #: 1

P A R I S
KITCHENS

This sketch is provided solely for reference to those items noted on the accompanying "Upgrade" all other details, dimensions and layouts are for illustrative purposes only and may not be applicable to the purchaser's model. All dimensions, specifications, and locations are only if possible and approximate.

BUILDER: ZANCOR HOMES

SITE: King City

LOT: 285

Purchaser Signature

Date:

12/08/2016

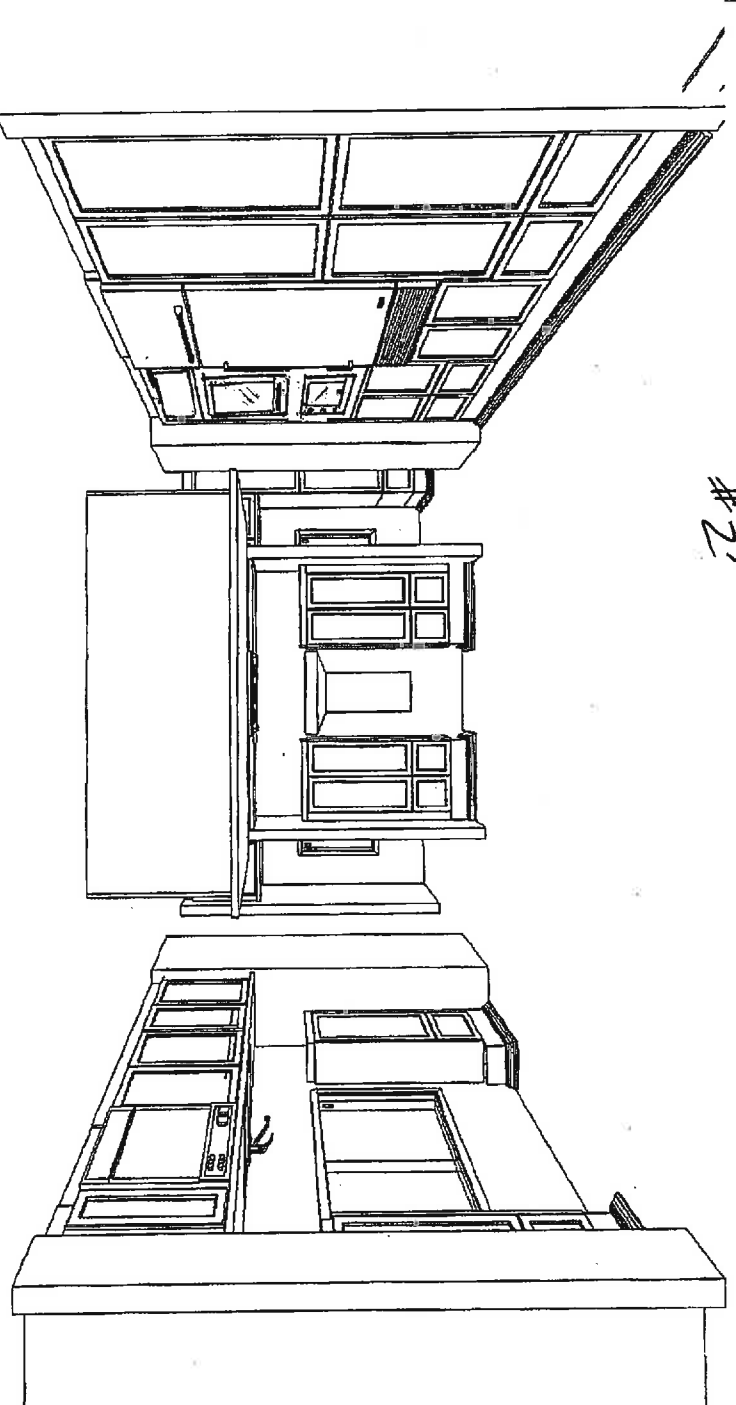
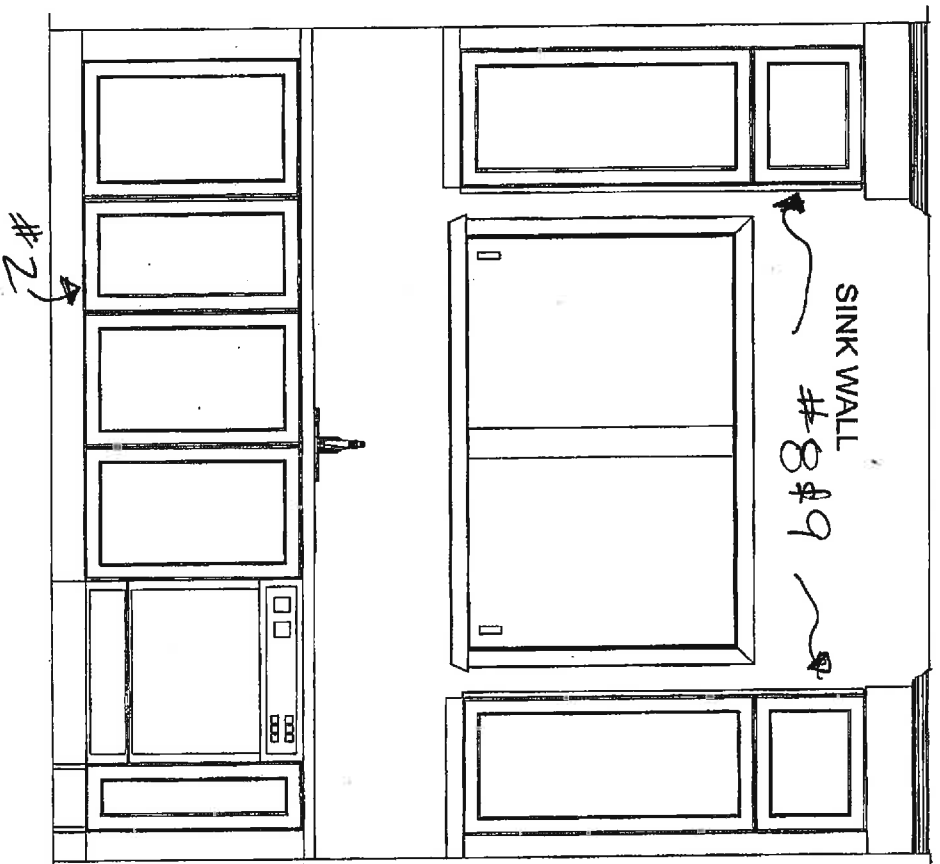

ZANCOR HOMES
CASTLES OF KING
MODEL 50-07

Note: This drawing is an artistic interpretation of the general appearance of the design. It is not meant to be an exact rendition.

2020
TECHNOLOGIES
Designed: 09/08/2016
Printed: 10/08/2016

50-7 KIT LOT

28 SOUTH

Drawing 2 Drawing #: 1

This sketch is provided solely for reference to those items noted on the accompanying "Upgrades" all other details, dimensions and layouts are for illustrative purposes only and may not be applicable to the purchaser's model. All dimensions, specifications, and locations are only if possible and approximate.

P A R I S
KITCHENS
ESTABLISHED IN 1993

BUILDER ZANCOR HOMES

SITE King City

LOT 285

Purchaser Signature

Date: 12/08/2016

STOVE WALL

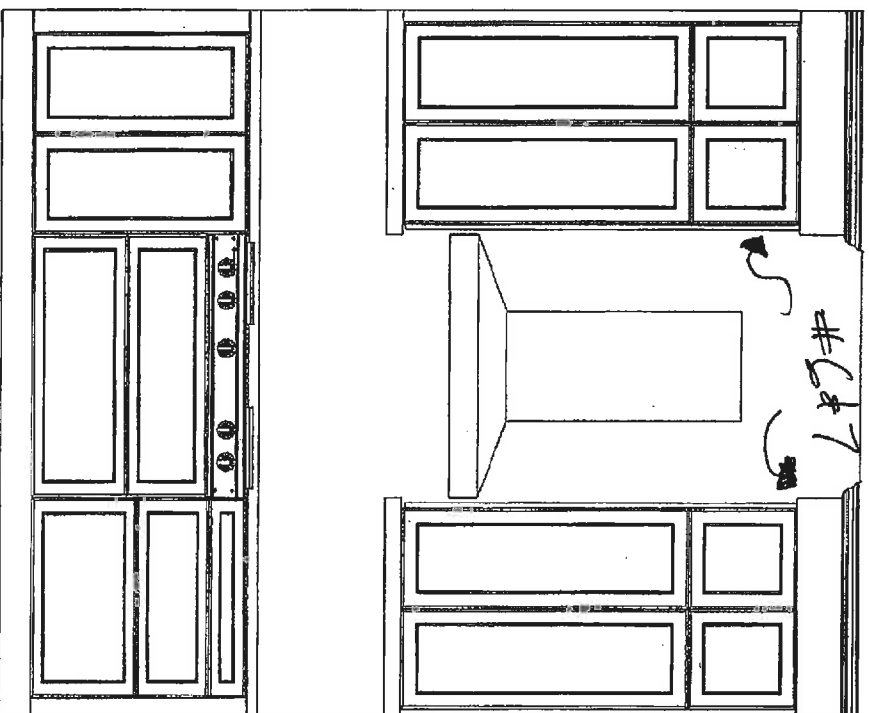

FRIDGE WALL

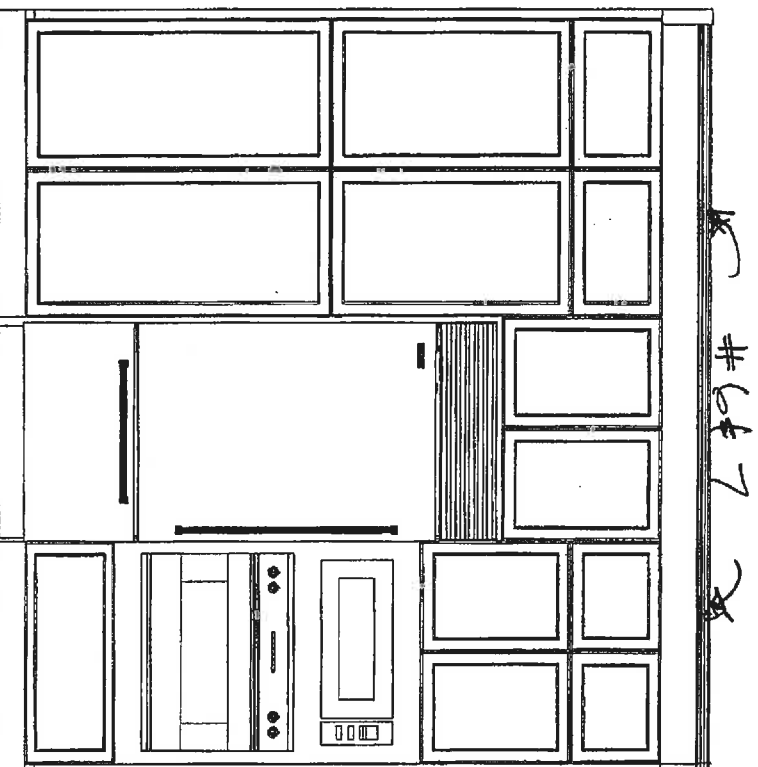

ZANCOR HOMES
CASTLES OF KING
MODEL 50-07

Note: This drawing is an artistic
interpretation of the general
appearance of the design. It is
not meant to be an exact rendition.

2020
TECHNOLOGIES

Designed: 09/08/2016
Printed: 10/08/2016

50-7 KIT LOT

28 SOUTH

Drawing 3

Drawing #: 1



This sketch is provided solely for reference to those items noted on the accompanying "Upgrades" all other details, dimensions and layouts are for illustrative purposes only and may not be applicable to the purchaser's model. All dimensions, specifications, and locations are only if possible and approximate.

BUILDER: ZANCOR HOMES

SITE: King City

LOT:

285

Purchaser Signature

Date:

12/08/2016

SERVERY

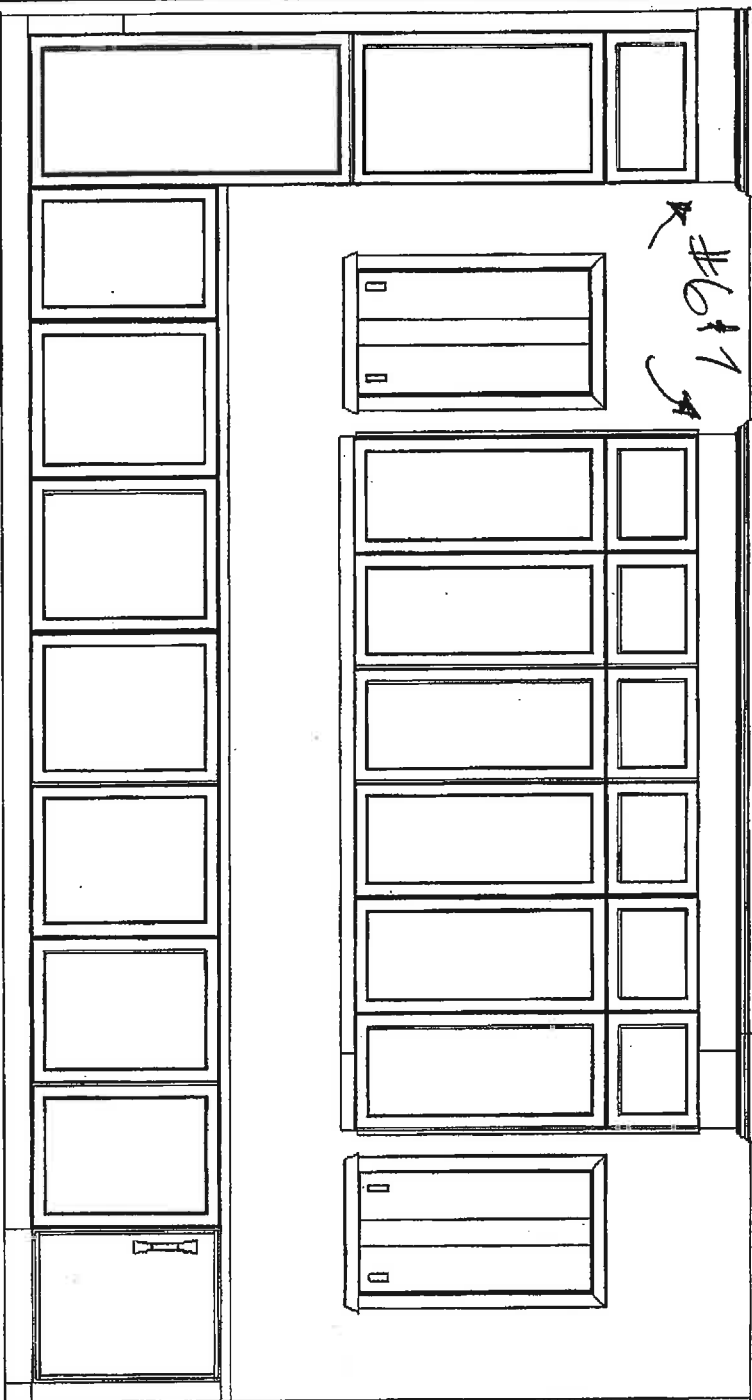

ZANCOR HOMES
CASTLES OF KING
MODEL 50-07

Note: This drawing is an artistic interpretation of the general appearance of the design. It is not meant to be an exact rendition.



Designed : 09/08/2016
Printed: 10/08/2016

50-7 KIT LOT :

28 SOUTH

Drawing 4

Drawing #: 1

This sketch is provided solely for reference to those items noted on the accompanying "Upgrades" at other details, dimensions and layouts are for illustrative purposes only and may not be applicable to the purchaser's model. All dimensions, specifications, and locations are only if possible and approximate.

BUILDER ZANCOR HOMES

SITE

King City

LOT

285

Purchaser Signature

Date:

12/08/2016



ISLAND FRONT VIEW

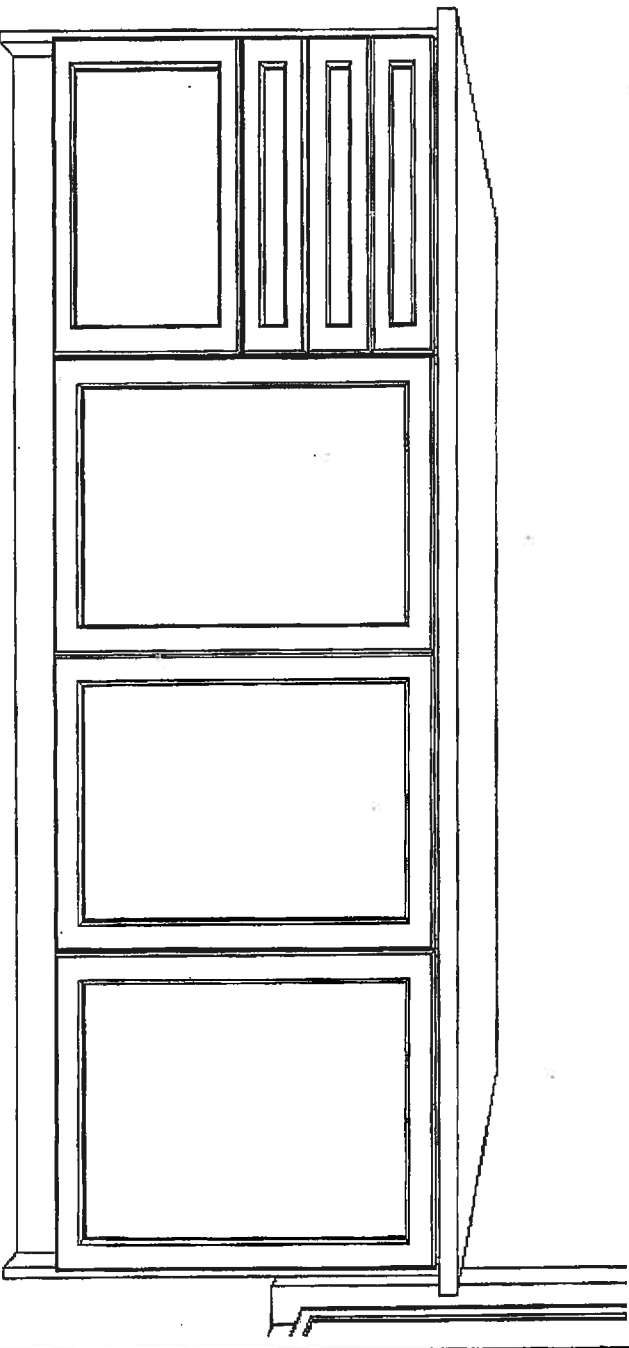

ISLAND BACK VIEW

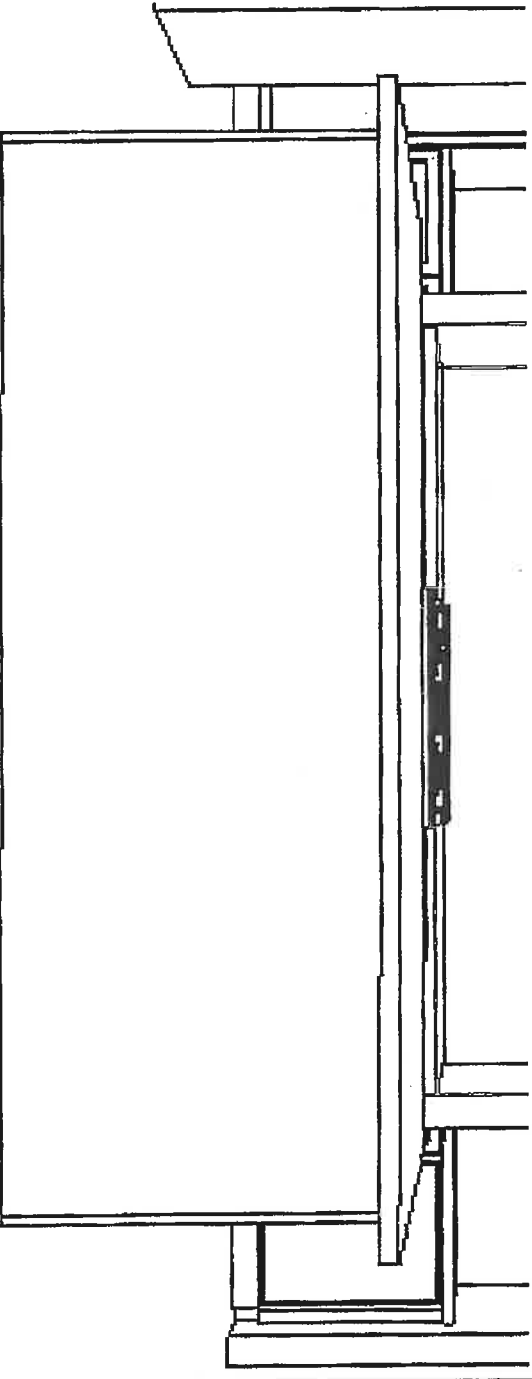

ZANCOR HOMES
CASTLES OF KING
MODEL 50-07

Note: This drawing is an artistic
interpretation of the general
appearance of the design. It is
not meant to be an exact rendition.

2020
TECHNOLOGIES

Designed :09/08/2016
Printed: 10/08/2016

50-7 KIT LOT

28 SOUTH

Drawing 5

Drawing #: 1

PARIS
KITCHENS

This sketch is provided solely for reference to those items noted on the accompanying "Upgrades"
all other details, dimensions and layouts are for illustrative purposes only and may not be
applicable to the purchaser's model. All dimensions, specifications, and locations are only if
possible and approximate.

BUILDER: ZANCOR HOMES

SITE: King City

LOT: 28S

Purchaser Signature

Date:

12/08/2016

POWDER ROOM

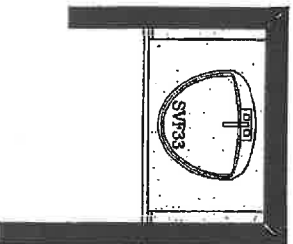

MASTER SPA ENSUITE

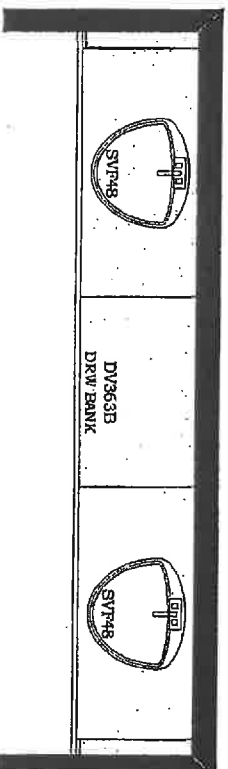

ENSUITE 2

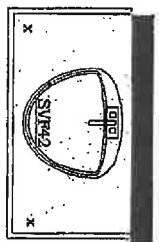

GLASS SHOWER
STALL

TUB
DECK

ENSUITE 3

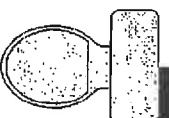
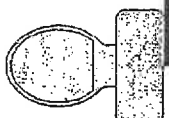
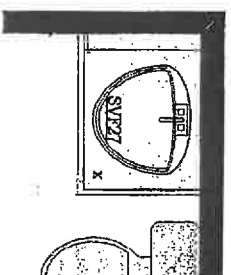

ENSUITE 4

BUILDER - ZANCOR HOMES
PROJECT - THE CASTLES OF KING CITY
MODEL TYPE - 50-7 - STD 4 BED PLAN
ELEV A, B, C

PLASTIC LAMINATE C.TOPS
FOR ALL SECONDARY VANITIES

MASTER ENSUITE - C.TOP BY OTHERS

ZANCOR HOMES
CASTLES OF KING
MODEL 50-07

Note: This drawing is an artistic
interpretation of the general
appearance of the design. It is
not meant to be an exact rendition.

2020
TECHNOLOGIES

Designed 27/10/2015
Printed: 08/08/2016

50-7 VANITIES

Drawing 1

Drawing #: 1

P A R I S
KITCHENS

ESTABLISHED IN 1942

This sketch is provided solely for reference to those items noted on the accompanying "Upgrades" all other details, dimensions and layouts are for illustrative purposes only and may not be applicable to the purchaser's model. All dimensions, specifications, and locations are only if possible and approximate.

BUILDER ZANCOR HOMES

SITE King City

LOT

285

Purchaser Signature

Date

12/08/2016

POWDER ROOM

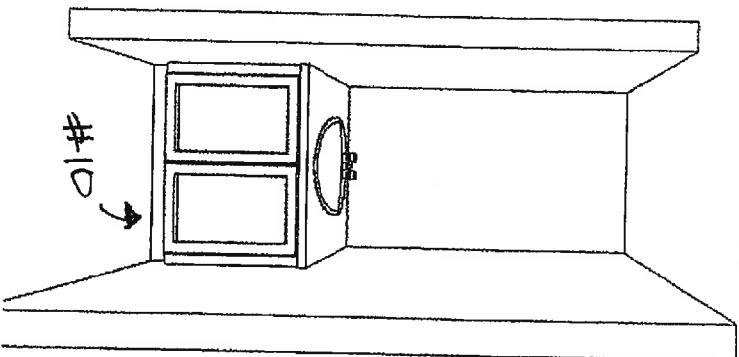

ENSUITE 2

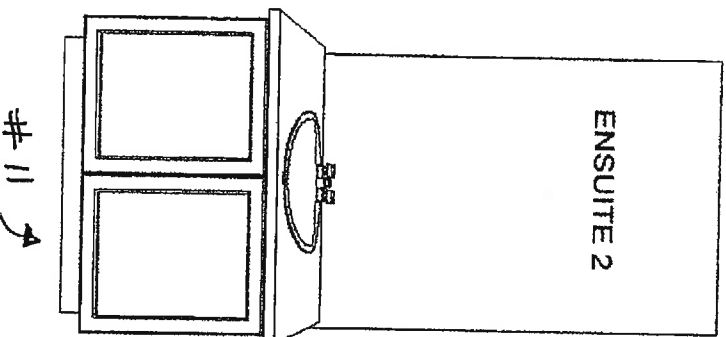

MASTER ENSUITE

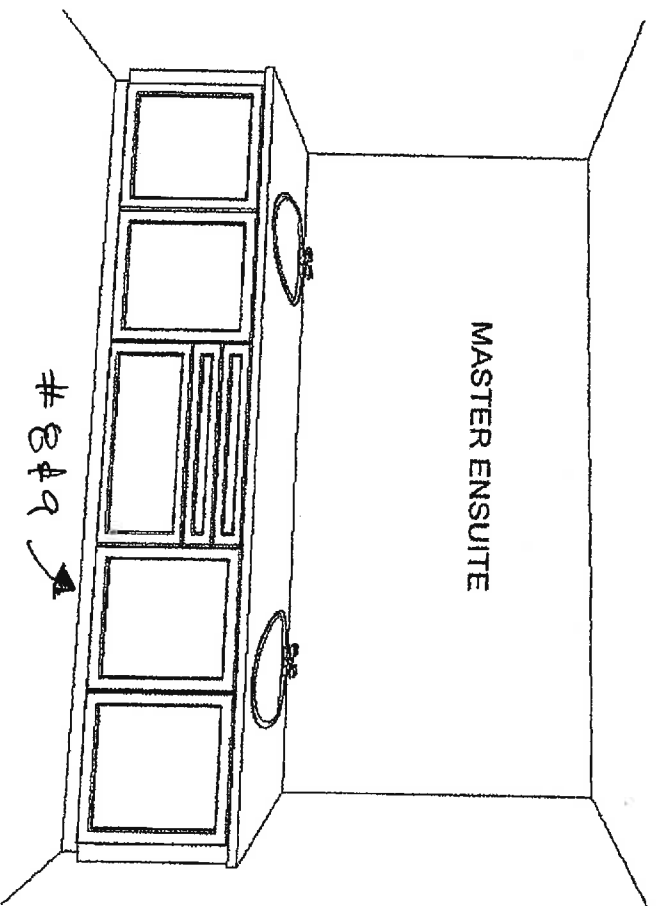

ZANCOR HOMES
CASTLES OF KING
MODEL 50-07
STND 4 BED VANS.



THIS SKETCH IS PROVIDED SOLELY FOR REFERENCE TO THOSE ITEMS NOTED ON THE ACCOMPANYING "ITEMS LIST/EXTRACT". ALL OTHER DETAILS, DIMENSIONS & LA FOUTS ARE FOR THE BUYER'S INFORMATION ONLY. THE BUYER SHALL BE RESPONSIBLE FOR THE BUYER'S INFORMATION AND APPROXIMATE. SITE: 2016/07/19/2016

50-7 VANITIES

LOT # 285
DATE 12/19/2016



Designed: 10/27/2015
Printed: 6/28/2016

Drawing 2 Drawing #: 1

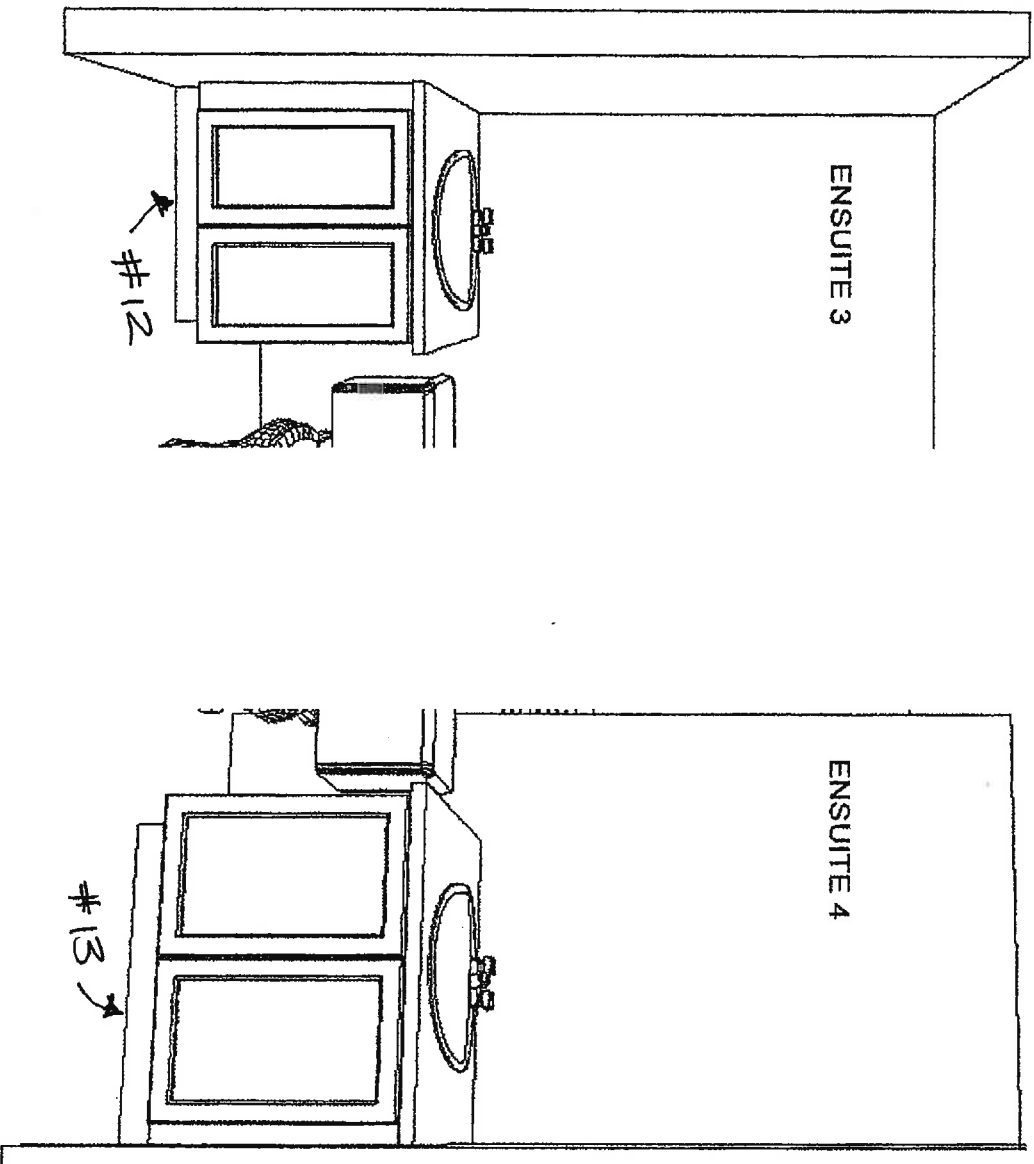

THIS SKETCH IS PROVIDED SOLELY FOR REFERENCE TO PROVIDE GENERAL INFORMATION AND IS NOT TO BE USED FOR ANY OTHER PURPOSES. DETAILS, DIMENSIONS, MATERIALS, AND FINISHES ARE SUBJECT TO CHANGE WITHOUT NOTICE. DIMENSIONS, SPECIFICATIONS AND FINISHES ARE ON THE POSSIBLE AND APPROXIMATE.

SITE: 2nd Floor
LOT # 285
DATE: 10/27/2015
FURNITURE: 2016

Note: This drawing is an artistic interpretation of the general appearance of the design. It is not meant to be an exact rendition.



Designed: 10/27/2015
Printed: 6/28/2016

TAKE OFF

50-7 VANITIES

Drawing 3

Drawing #: 1

**ZANCOR HOMES
CASTLES OF KING
MODEL 50-07
STND. 4 BED VANS.**

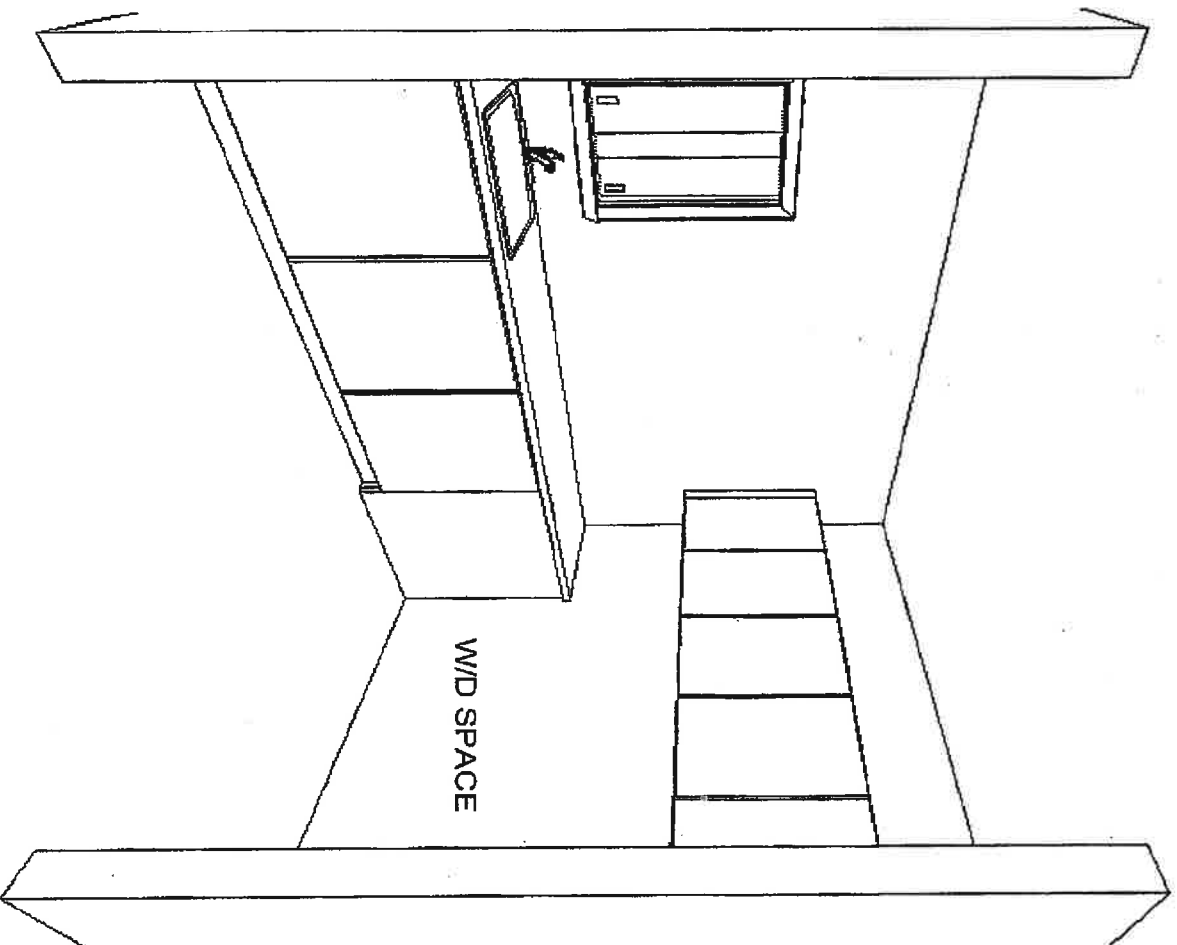

ZANCOR HOMES
CASTLES OF KING
MODEL 50-07
STND 2ND. FLR PLAN

Note: This drawing is an artistic interpretation of the general appearance of the design. It is not meant to be an exact rendition.



Designed :27/10/2015
Printed: 08/08/2016

50-7 LAUNDRY

Drawing 2 Drawing #. 1



This sketch is provided solely for reference to those items noted on the accompanying "Upgrades" all other details, dimensions and layouts are for illustrative purposes only and may not be applicable to the purchaser's model. All dimensions, specifications, and locations are only if possible and approximate.

BUILDER ZANCOR HOMES

SITL. Ling City

LOT: 285

Purchaser Signature

Date: 12/08/2016

MOULDING SIGN-OFF SHEET

LOT # 28 S





KING CITY

SITE: ZANCOR HOMES : CASTLES OF KING CITY

TO: REGINA VOLOVIK

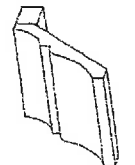
DATE: August 12, 2016

CROWN MOULDINGS - MDF/VENEER

LARGE COVE CROWN	CLASSIC CROWN	TRADITIONAL CROWN	ANGLED CROWN	SMALL CROWN
				
INT	INT	INT	INT	INT
CM93196	CMH96	CM96	CMS96	CM98196



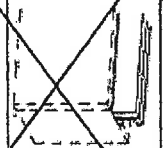
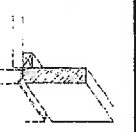
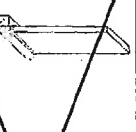
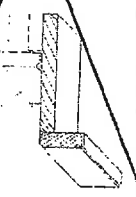



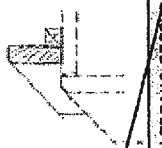
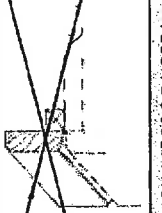
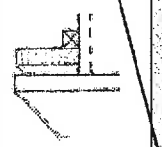



TOP STACK MOULDING

HIGH TOP FILLER	PROFILED FLUSH TOP FILLER	TOP STACK W/ MOULDING	FLYOVER
			
INT	INT	INT	INT
SFT696	TF96	TS96	TM2X96

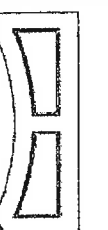

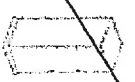
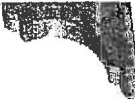

LIGHT VALANCE - MDF/VENEER

RECESSED STRAIGHT	RECESSED SINGLE PROFILE	FLUSH DOUBLE PROFILE	HIDDEN
			
INT	INT	INT	INT
LV96	LV196	LV296	RAS2

MISC MOULDINGS & ACCESSORIES

FURNITURE TOE KICK	ARCHED TOE KICK	ANGLED TOE KICK	BULLNOSE	BEADED VALANCE	ARCHED CAB VALANCE
					
INT	INT	INT	INT	INT	INT
TK96	TKA	SPECIAL	BN96	BEADVAL	CVA
TAPERED LEG	FRENCH LEG	ROUND LEG	SQUARE LEG	AVIGNON BRACKET	MISSION CORBEL
					
INT	INT	INT	INT	INT	INT
TL6	FR6	RL6	SPECIAL	SPECIAL	SPECIAL

THERMOFOIL CROWN & LIGHT VALANCE

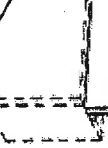
TRADITIONAL CROWN	SHAKER CROWN	STRAIGHT VALANCE	RECESSED SINGLE PROFILE	PROFILED TOP FILLER	6" HIGH TOP FILLER
					
INT	INT	INT	INT	INT	INT
CM96T	CMKT96T	LV96T	LV196T	TF96T	SFT696T

PURCHASER SIGNATURE

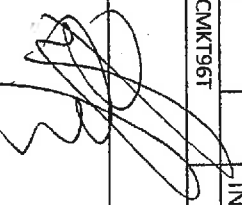

DATE 12/08/2016

SECTIONAL ELEVATION FOR MOUNTING HEIGHT

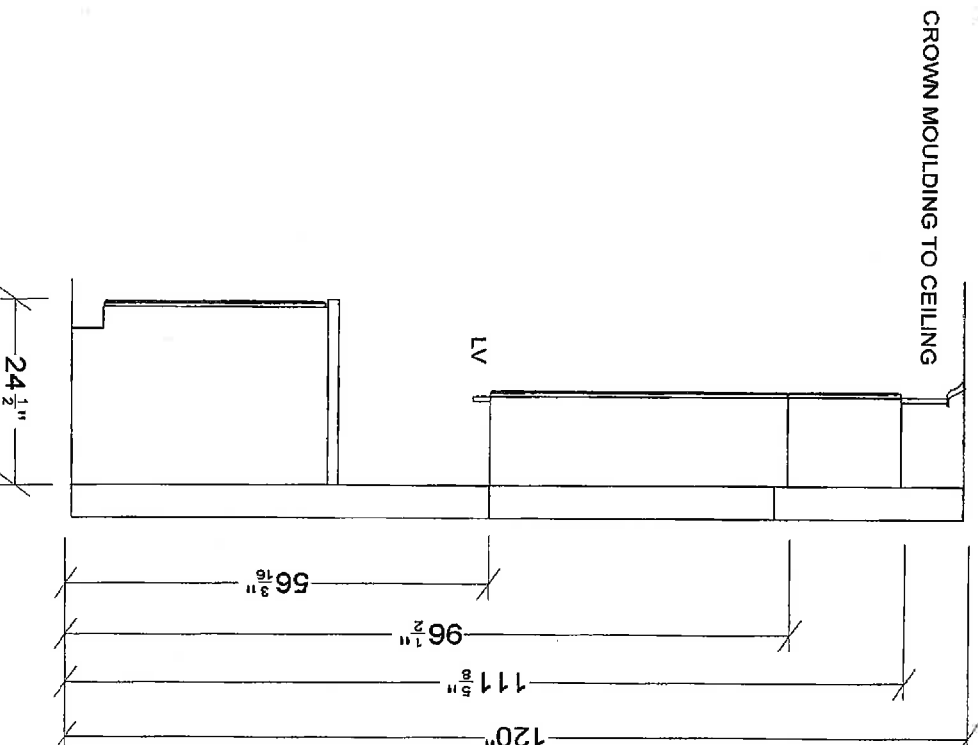

ZANCOR HOMES
SITE: CASTLES OF KING
MODEL TYPE: EDEN 50-07
LOT - 28S

Note: This drawing is an artistic
interpretation of the general
appearance of the design. It is
not meant to be an exact rendition.

P A R I S
KITCHENS

Designed :09/08/2016
Printed: 15/08/2016

DRAWN BY: SG

50-7 KIT LOT

28 SOUTH

Drawing 1

Drawing #: 1

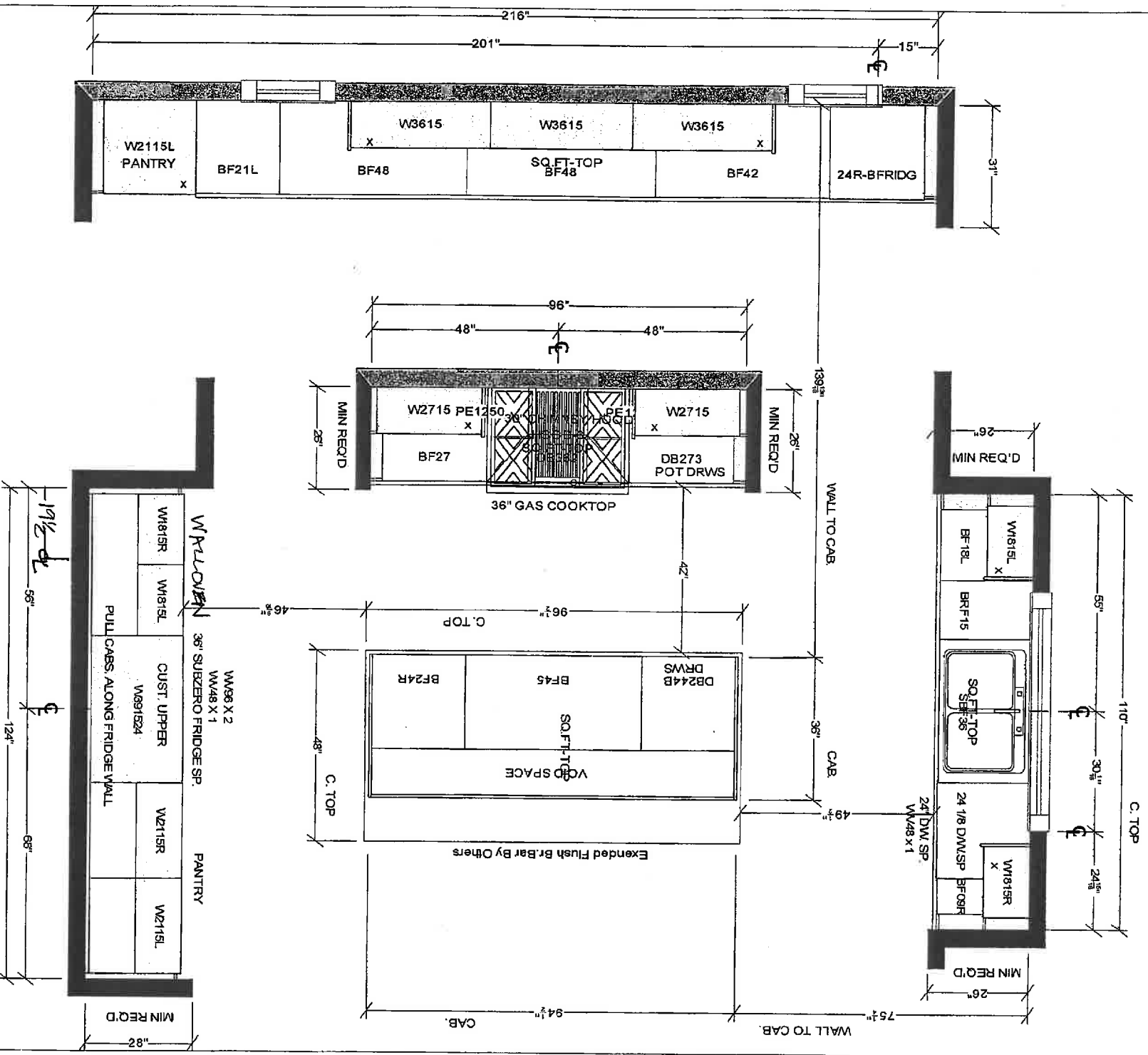

BUILDER - ZANCOR HOMES
PROJECT - THE CASTLES OF KING CITY
MODEL TYPE - 50-7
ELV A, B, C
CROWN MOULDING X 6
STRAIGHT LIGHT VALANCE X 4
C.TOP BY OTHERS

Note: This drawing is an artistic interpretation of the general appearance of the design. It is not meant to be an exact rendition.

Designed : 09/08/2016
Printed: 15/08/2016

50-7 KIT LOT:

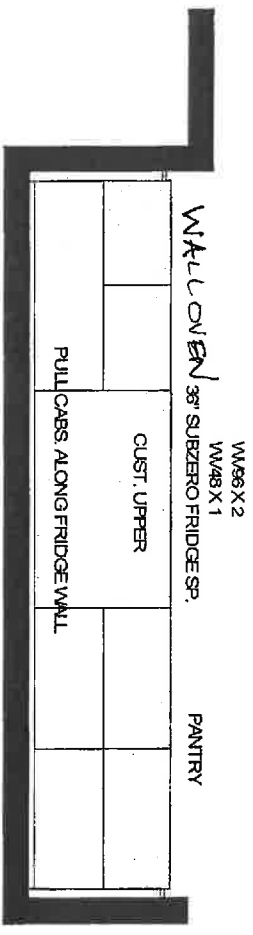
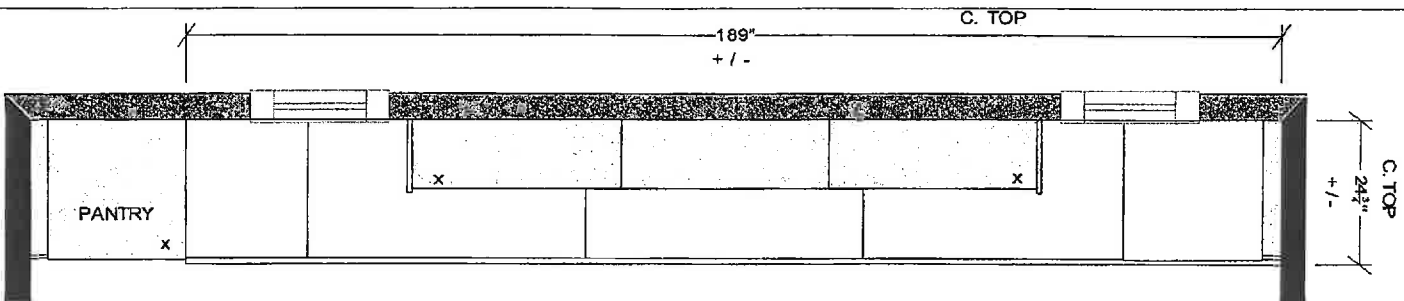
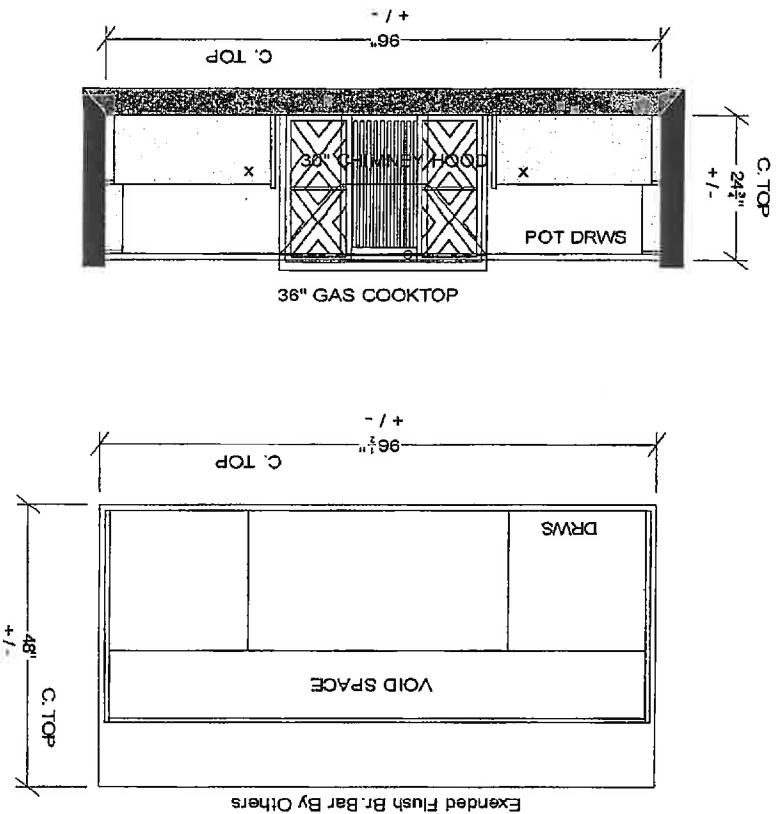
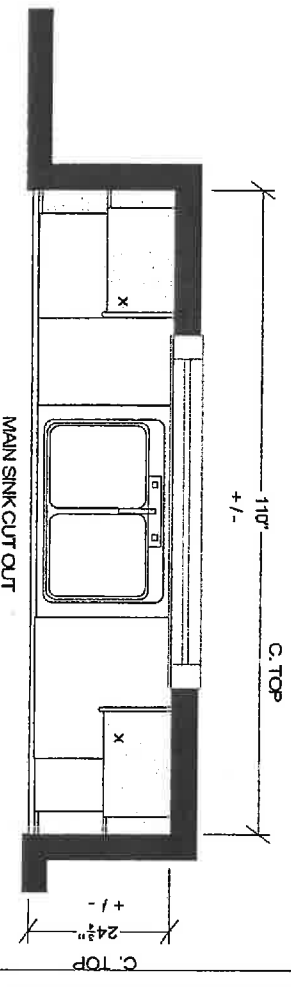

SITE ROUGH-IN COUNTER-TOP

BUILDER - ZANCOR HOMES
PROJECT - THE CASTLES OF KING CITY
MODEL TYPE - 50-7
ELV A, B, C

CROWN MOULDING X 6
STRAIGHT LIGHT VALANCE X 4
C.TOP BY OTHERS

ZANCOR HOMES
SITE: CASTLES OF KING
MODEL TYPE: EDEN 50-07
LOT - 28S

Note: This drawing is an artistic
interpretation of the general
appearance of the design. It is
not meant to be an exact rendition.

PARIS
KITCHENS

Designed :09/08/2016
Printed: 15/08/2016

DRAWN BY: SG

50-7 KIT LOT

28 SOUTH

Drawing 1

Drawing #: 1

ZANCOR HOMES
SITE: CASTLES OF KING
MODEL TYPE: EDEN 50-07
LOT - 28S

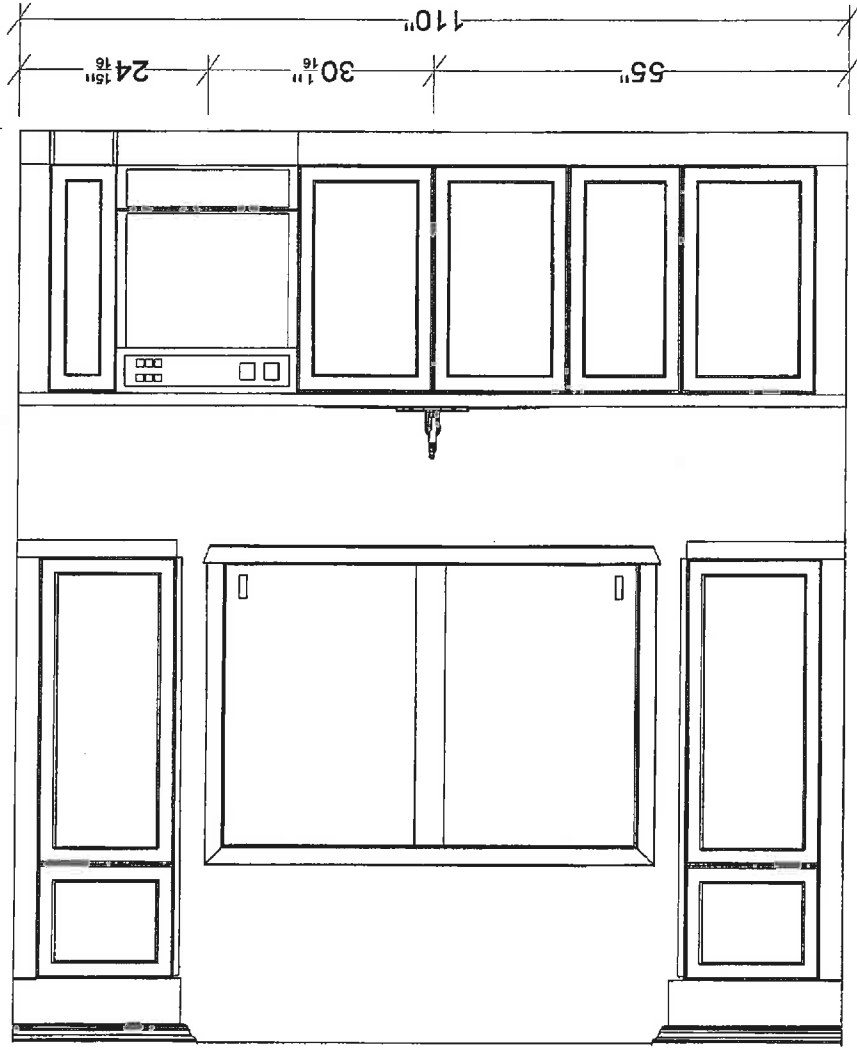

SITE ROUGH-IN
SINK WALL

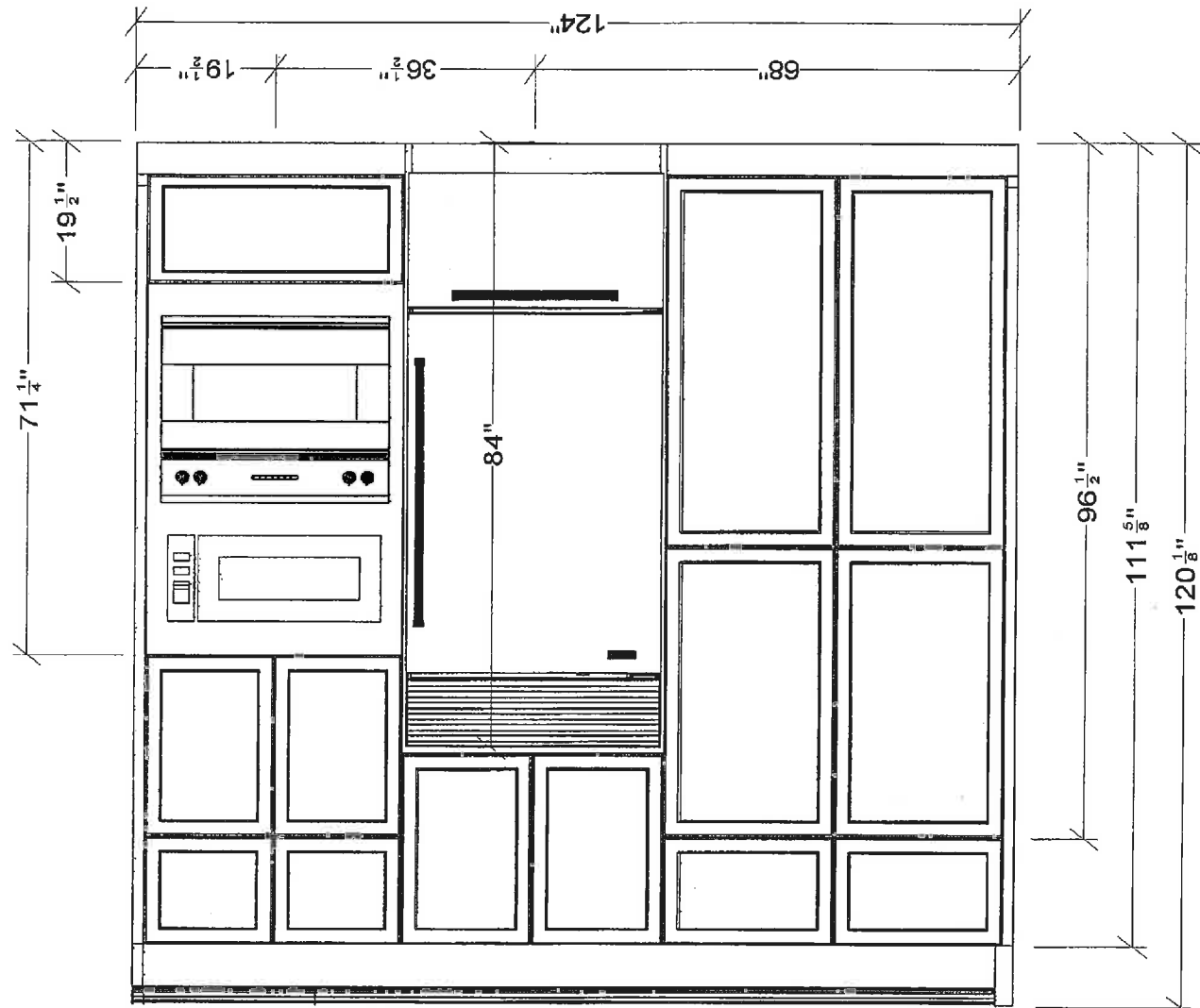

SITE ROUGH-IN
FRIDGE WALL



Note: This drawing is an artistic interpretation of the general appearance of the design. It is not meant to be an exact rendition.

Designed: 09/08/2016
Printed: 15/08/2016
DRAWN BY: SG

Drawing # 1
Drawing # 1

28 SOUTH

50-7 KIT LOT

ZANCOR HOMES
SITE: CASTLES OF KING
MODEL TYPE: EDEN 50-07
LOT - 28S

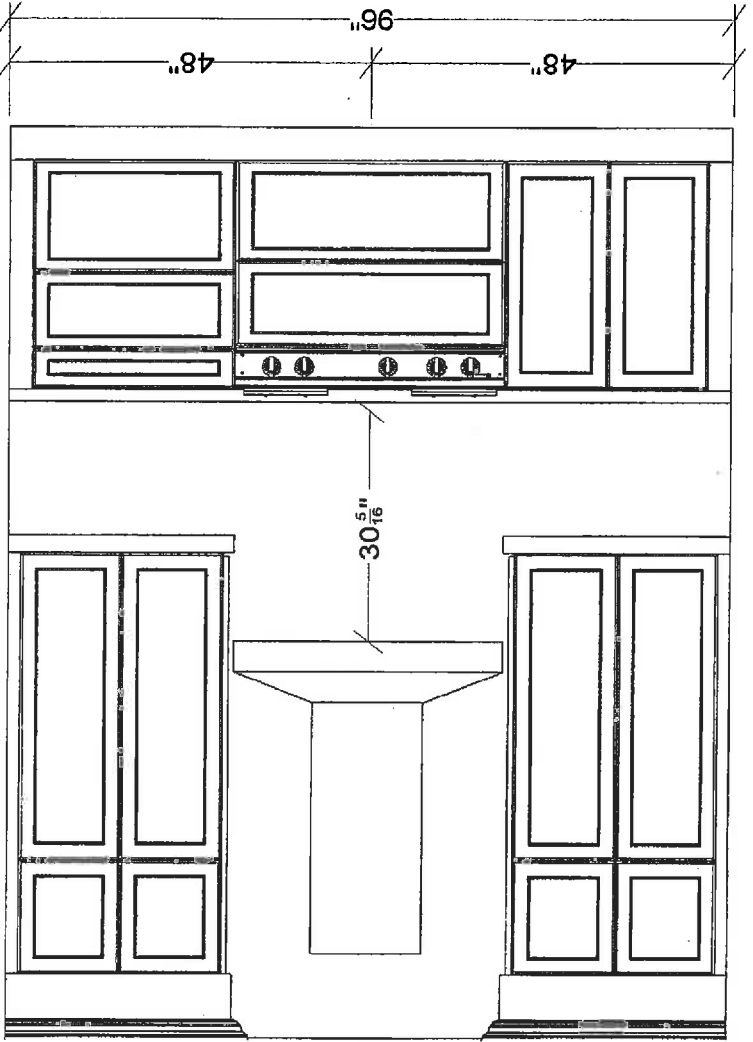

SITE ROUGH-IN
STOVE WALL

Note: This drawing is an artistic interpretation of the general appearance of the design. It is not meant to be an exact rendition.



Designed: 09/08/2016
Printed: 15/08/2016
DRAWN BY: SG

28 SOUTH

50-7 KIT LOT

Drawing 4
Drawing #: 1

ZANCOR HOMES
SITE: CASTLES OF KING
MODEL TYPE: EDEN 50-07
LOT - 28S

50-7 KIT LOT
28 SOUTH
Drawing 4
Drawing #: 1



Not: This drawing is an artistic
interpretation of the general
appearance of the design. It is
not meant to be an exact rendition.
Designed: 09/08/2016
Printed: 15/08/2016
DRAWN BY: SG

SITE ROUGH-IN
SERVERY

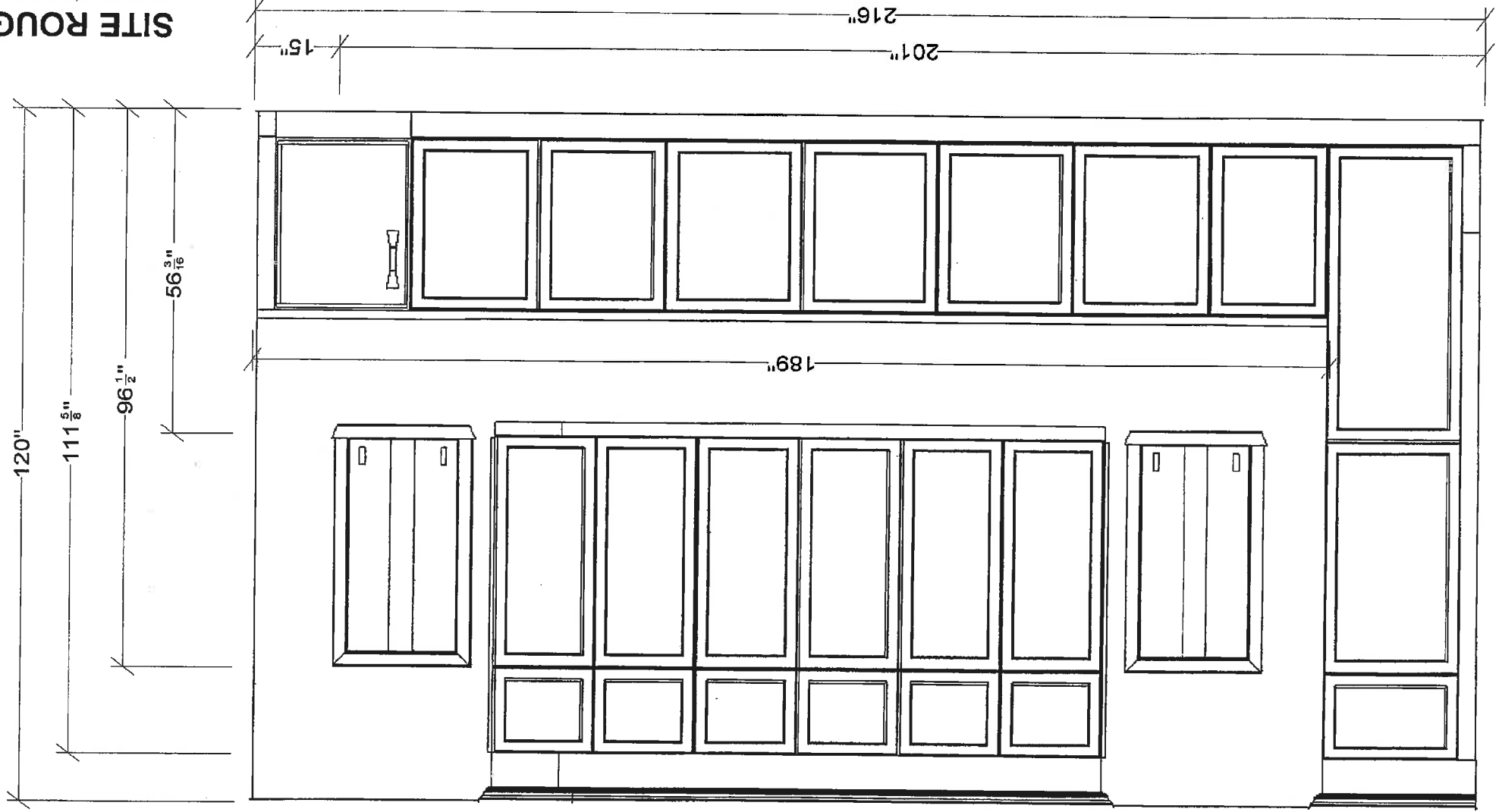

VANITY - ROUGH IN

POWDER ROOM

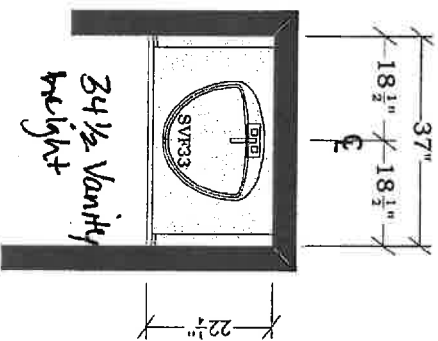

MASTER SPA ENSUITE

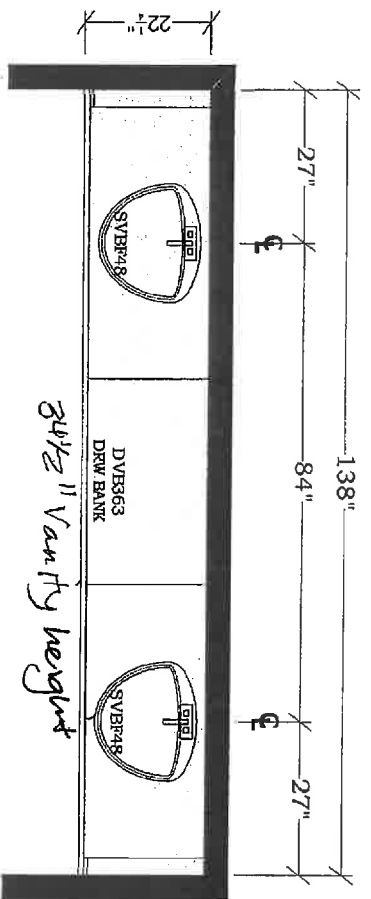

ENSUITE 2

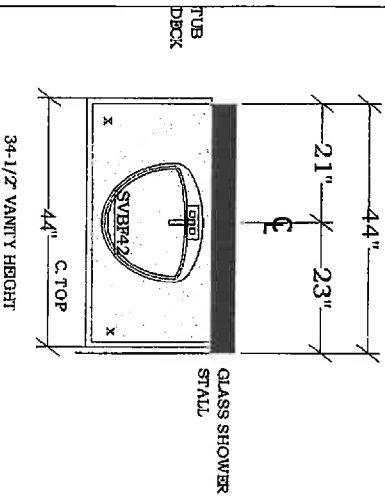

ENSUITE 3

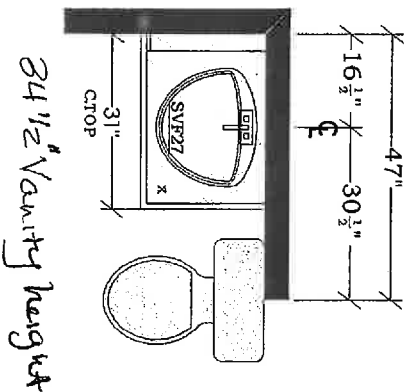

ENSUITE 4

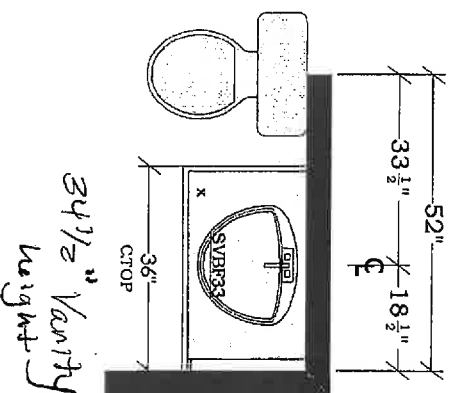

BUILDER - ZANCOR HOMES
PROJECT - THE CASTLES OF KING CITY
MODEL TYPE - 50-7 - STD 4 BED PLAN
ELV A, B, C

PLASTIC LAMINATE C.TOPS
FOR ALL SECONDARY VANITIES

ZANCOR HOMES
SITE: CASTLES OF KING
MODEL TYP: 50-07
LOT - 285

Note: This drawing is an artistic
interpretation of the general
appearance of the design. It is
not meant to be an exact rendition.

P A R I S
KITCHENS

Designed :12/08/2016
Printed: 12/08/2016

DRAWN BY: SG

50-7 VANITIES

Drawing 1 Drawing # - 1

LAUNDRY ROOM

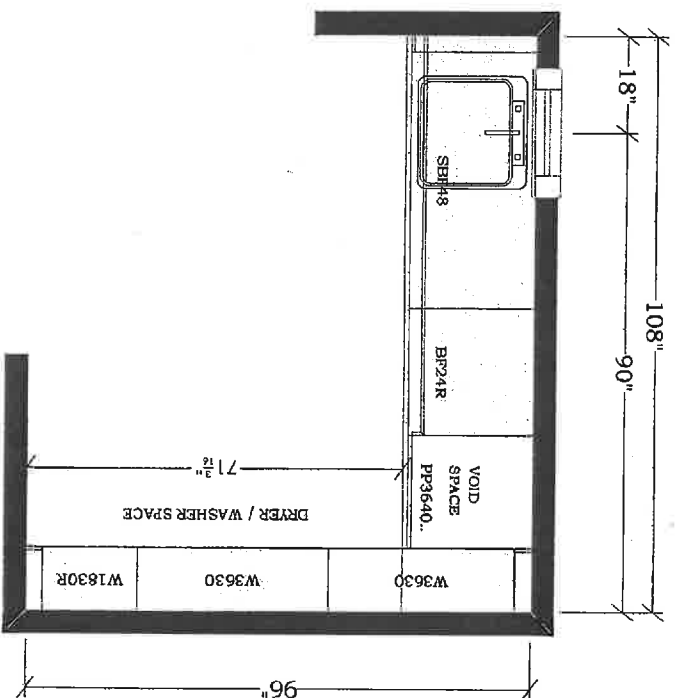

BUILDER - ZANCOR HOMES
PROJECT - THE CASTLES OF KING CITY
MODEL TYPE - 50-7 - STD PLAN
ELV A, B, C

PLASTIC LAMINATE C.TOP INCLUDED

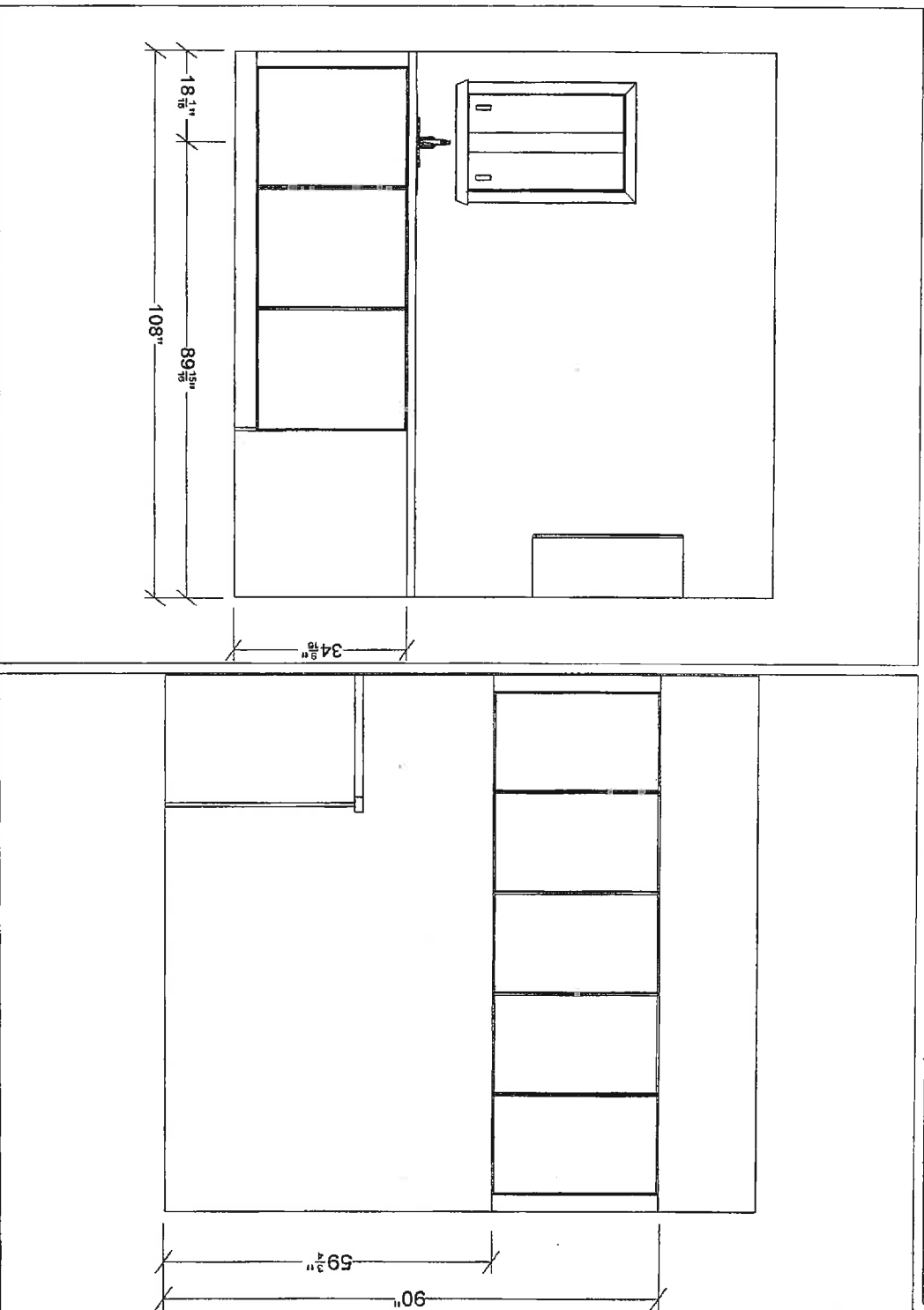

FOR ROUNT IN ONLY

ZANCOR HOMES
SITE: CASTLES OF KING
MODEL TYPE: EDEN 50-07
LOT - 28S

Note: This drawing is an artistic interpretation of the general appearance of the design. It is not meant to be an exact rendition.



Designed :12/08/2016
Printed: 15/08/2016

DRAWN BY: SG

50-7 LAUNDRY

Drawing 1 Drawing #: 1

INTERIOR FINISHES ACKNOWLEDGEMENT / HARDWOOD WAIVER

Purchaser accepts and acknowledges that the Builder reserves the right to substitute materials with those of equal or better quality where the manufacture, scheduling or delivery of materials may directly impact the Builder's ability to meet its' contractual obligations under the Agreement of Purchase and Sale.

PORCELAIN & NATURAL STONES: Due to the properties of natural stones including but not limited to **marble, granite, quartz**, no two pieces are exactly the same. Variations in colour, tone, granularity (pitting, fissures) and pattern are to be expected, including various lighting may affect the overall finished look. Stone should never be cleaned with lemon oil or vinegar. The purchaser acknowledges colour and product variations as well as natural imperfections that may exist with the selection of natural stone materials and shall not hold the Vendor liable for provision of same.

STONE COUNTERTOP JOINTS: Purchaser is aware that one joint will be at each corner and on either side of slide-in-range (if applicable). It will also be where the length of the counter top exceeds the length of a stone slab. Slabs are usually approximately 5'x 8'.

CERAMIC TILES: Due to manufacturing, shade (dye lots), product variations may exist that can affect the overall look of the finished product. Although every effort will be made to ensure the colours and materials selected are as close as possible to the samples, the purchaser acknowledges that the sample tiles supplied in the Design Centre may not be identical to the materials installed in the home.

STAIR STAINS: Due to the natural properties of wood, many variables can affect the overall look of the finished product. Factors including but not limited to wood type, knotting, graining, density, age, humidity, and air temperature can result in substantial variations in stain intensity. The purchaser accepts that although the Vendor will do their best to match stain the unfinished stairs as close as possible to the pre-finished floors, it is not possible to have an identical match and that there MAY be shade differences between the two products.

CABINETRY: Due to the natural properties of wood, slight variations apparent with cabinetry are to be expected. This includes but not limited to wood species, wood grain, colour, finish, product variations, and natural imperfections are all factors that may affect the overall look of the finished product. Such factors make exact colour matching impossible. The type and intensity of lighting in the areas of designated cabinetry placement may also highlight characteristics of cabinetry finish. All cabinets shall be finished with a white melamine interior box unless a finished interior is upgraded. Due to building specifications and/or on-site conditions, certain cabinetry upgrades may not be possible. The purchaser acknowledges that the Builder cannot guarantee the cabinetry finish or provision of certain upgrades and shall not hold the Builder liable for provision of same.

UPGRADES/EXTRAS: All upgrades and additional selections indicated on the colour chart must be accompanied by an upgrades/extras sheet (PES) and full payment otherwise the selection will be invalid. All colour charts and upgrades/extras will not proceed until verified and signed by an authorized signing officer at the Vendor's head office. **CHANGES WILL NOT BE PERMITTED UPON COMPLETION AND SUBMISSION OF THE COLOUR CHART.**

HARDWOOD FLOORING: Due to the natural properties of wood, many variables can affect the overall look of the finished product. Variations include but not limited to wood type, colour/stain and wood grain are significant factors that make exact colour matching impossible. The purchaser acknowledges that the hardwood flooring is a pre-finished product in a controlled environment. Expansion, compression and cupping are characteristics of hardwood flooring once installed in the home. The purchaser acknowledges these may become apparent over time and despite the Builders' efforts to install the hardwood flooring materials in keeping with good workmanship, the Builder shall not be responsible nor held liable for minor variances of fluctuation in hardwood flooring materials.

HARDWOOD WAIVER:

I/We understand hardwood flooring is classified as a porous material and as such not recommended by the Builder in certain areas. I/We understand there is a concern due to possible water and other substances being frequently splashed or spilled onto the floor and in contravention of Ontario Building Code Section 9.30.1.2(1).

"Finished flooring bathrooms, kitchens, public entrance halls, laundry & general storage areas shall consist of resilient flooring, felted-synthetic-fibre floor coverings, concrete, terrazzo, ceramic tile, mastic or other types of flooring providing similar degrees of water resistance."

I/We are prepared to assume full responsibility for any damage caused to the hardwood floor or subfloor due to moisture absorbency in the mentioned areas, and agree to waive any claims against the Township of residence, TARIION and/or the Builder in relation to the matter.

****SEE COLOUR CHART FOR LOCATIONS****

SITE Goodwin South

LOT 285

DATE Aug 23/16