

## STANDARD APPLIANCE OPENINGS

The purchaser acknowledges the following standard spaces for kitchen appliances:

Range Conventional – 30" Width

Hood Fan – 30" Width (must be the same or larger as range opening as per Ontario Building & Fire Code)

Refrigerator – 36" W x 72" H (Approximate - height may change due to bulkheads)

Dishwasher – 24" Width

6" Exhaust Vent above stove

OTHER \_\_\_\_\_

*See Specs*

## UPGRADED APPLIANCE OPENINGS

**\*Check all that apply - NON-STANDARD APPLIANCE OPTIONS**

**NOTE:** When upgrading appliances, there may be an additional charge to modify cabinetry and/or electrical and plumbing to accommodate the appropriate size from the manufacturer specifications of each appliance.

**\*\*MANUFACTURERS SPECIFICATIONS MUST BE ATTACHED\*\***

**36" / 42" Stove** (Hood fan width will be the same as per Ontario Building Code)

Gas Stove

Slide-In Stove

Cooktop

\*(Gas/Electric – Cut-out Charge & Plug Required)

Built-In Wall Oven

Hood Fan (may require larger vent, charges will apply – **6" is standard**)

8" Vent / 10" Vent

**Chimney hoods \*\*CENTRE VENT ABOVE STOVE** (clearance space will be left with this appliance will not butt up against cabinetry)

Built-In Microwave with Trim Kit  
Built-In Microwave Drawer with Trim Kit

Warming Drawer

OTR – Over The Range Microwave \*Plug required

**Built-in Refrigerator/Sub Zero** – If purchasing a side by side or French Door, the wall beside the door may be an issue if it is deeper than 24"

\*Applicable charges may apply if required to due to space accommodations

\*Note: Refrigerator Door Swing

Wine / Bar Fridge (electrical required)

Steam Oven / Built-In Coffee makers

Cargo Waste Bin systems

Front Load Washer & Dryer \*(Specs required if installing counter above)

Stackable Washer & Dryer

*Y* **NOTE:** It is the Purchaser's responsibility to coordinate delivery, installation and hook up of appliances and to ensure they are installed as per Manufacturer's specifications after closing.

*Y* Purchaser acknowledges responsibility for providing correct specification for such appliances. The purchaser agrees to deliver forthwith to the Builder the manufacturer's appliance specifications where the size exceeds the standard openings.

*Y* If specs not received, the standard openings as determined by Zancor Homes will be provided. If rework/repair is required due to late specs received, additional costs will be applied.

Appliance Specifications are to be sent to the Zancor Décor Centre no later than \_\_\_\_\_

Appliance Specifications received \_\_\_\_\_

Purchaser Signature *Tudy* Date *Aug 26/16*

Purchaser Signature \_\_\_\_\_ Date \_\_\_\_\_

PROJECT *Caslin South* LOT *18 South*

36" SEALED BURNER RANGETOP - 6 BURNERS



106185 Aug 26/16

SRT366



FEATURES

- 6 dual-stacked, seamless burners
- Dual-stacked burners go from 20,000 Btu down to a mere breath of flame
- Continuous cast-iron grates for easy movement of pots and pans
- Heavy-gauge stainless steel
- Rigorously tested in our U.S. manufacturing facilities for decades of use
- Exceptional 24/7 support from our Customer Care team in Madison
- Signature red infinite control knobs
- Individual spark ignition system

ACCESSORIES

- Stainless steel, brass or chrome bezels
- High altitude conversion kit
- Cast iron S-grates and wok grate
- Signature red, black or stainless steel control knobs
- 5" and 10" stainless steel risers, and 20" riser with shelf

Accessories available through an authorized Sub-Zero dealer.  
For local dealer information, visit [subzero-wolf.com/localaor](http://subzero-wolf.com/localaor)

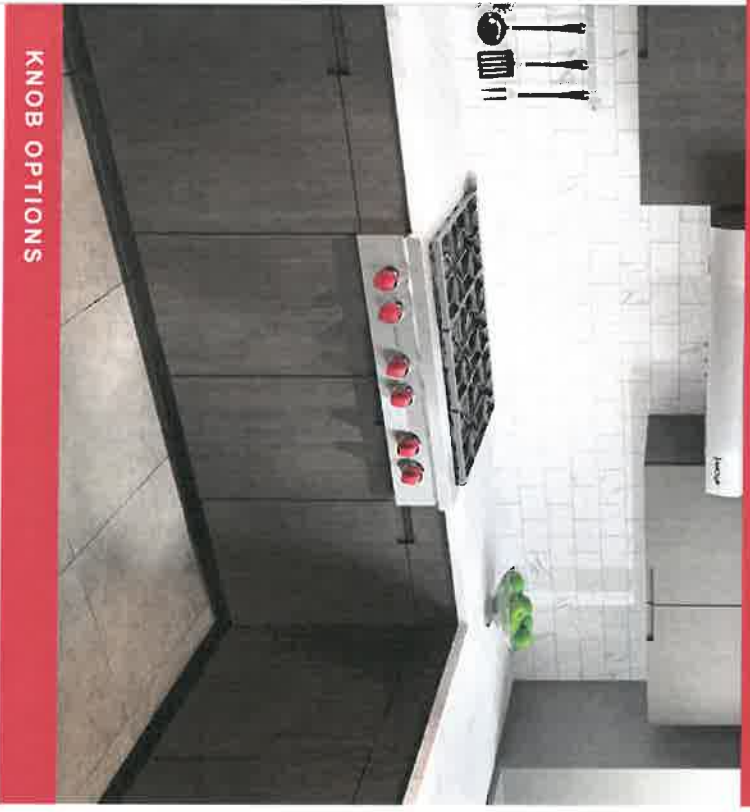

KNOB OPTIONS



TOP CONFIGURATION

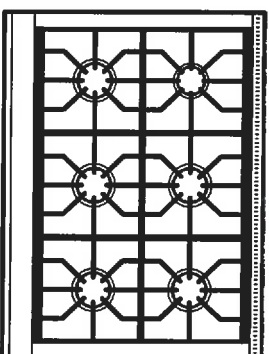

RANGETOP SPECIFICATIONS

rw

- 1 - 9,200 Btu Burner
- 2 - 15,000 Btu Burners
- 2 - 18,000 Btu Burners
- 1 - 20,000 Btu Burner

36" SEALED BURNER RANGETOP - 6 BURNERS



Lo6 18-S

PRODUCT SPECIFICATIONS

- Model SRT366
- Dimensions 35 7/8"W x 8 1/2"H x 28 1/2"D
- Weight 220 lb
- Electrical Supply 110/120 VAC, 60 Hz
- Electrical Service 15 amp dedicated circuit
- Gas Supply 3/4" rigid pipe
- Gas Inlet 1/2" NPT female

ELECTRICAL AND GAS

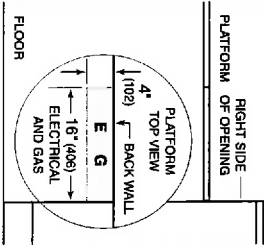

DIMENSIONS

1AUG26/11

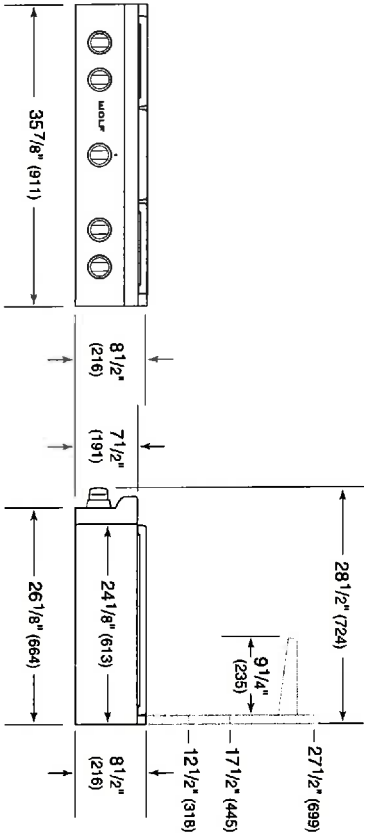

STANDARD INSTALLATION

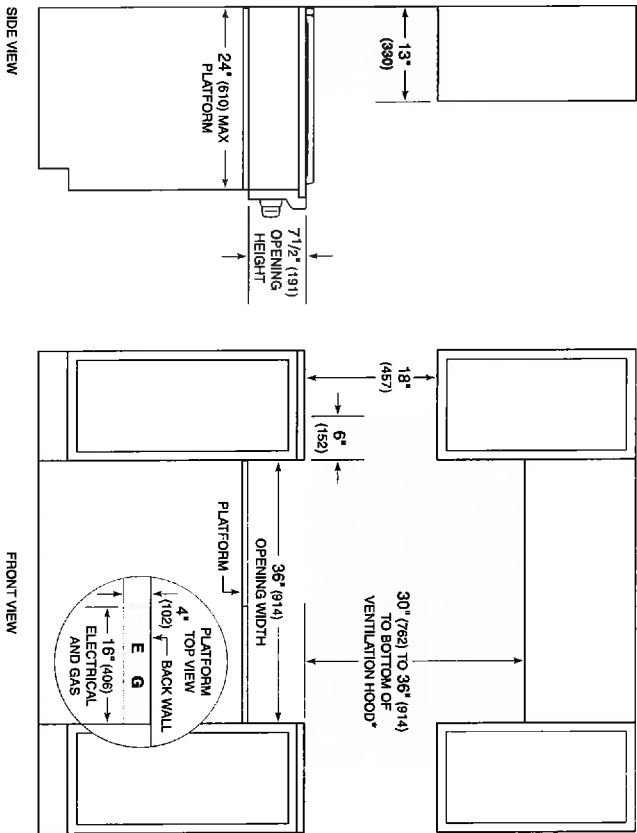

\*Without ventilation hood, 36" (914) minimum clearance countertop to combustible materials, 44" (1118) for charcoal.  
NOTE: Shaded area above countertop indicates minimum clearance to combustible surfaces.  
Electrical and gas supply cannot be located within this area.  
For island installation, 12" (305) minimum clearance back of range to combustible rear wall above countertop.

WV

48" BUILT-IN SIDE-BY-SIDE REFRIGERATOR/FREEZER

SUB-ZERO

PRODUCT SPECIFICATIONS

Model	BI-48S/S
Dimensions	48"W x 84"H x 24"D
Door Clearance	30"
Weight	630 lb
Refrigerator Capacity	19.1 cu ft
Freezer Capacity	9.8 cu ft
Electrical Supply	115 VAC, 60 Hz
Electrical Service	15 amp dedicated circuit
Plumbing Supply	1/4" OD copper, braided stainless steel or PEX tubing
Plumbing Pressure	35-120 psi

ELECTRICAL

PLUMBING

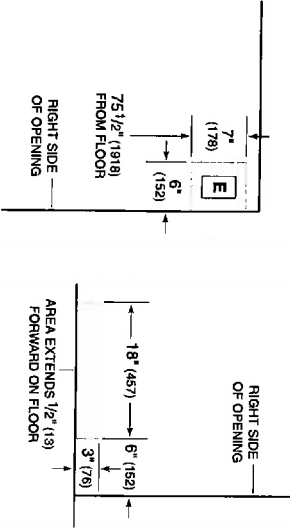

INTERIOR VIEW

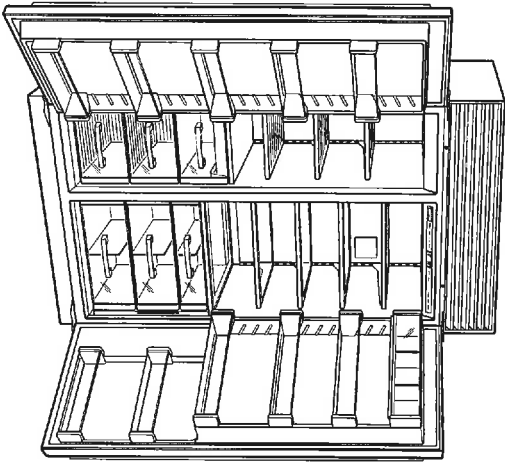

This illustration is intended for interior reference only and may not represent the exterior of the model being specified.

DIMENSIONS

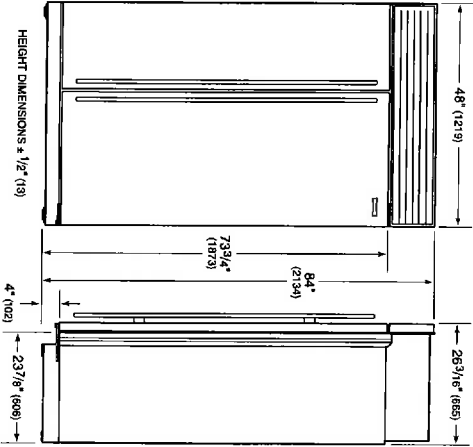

16618-5  
Aug 26/16  
YU

STANDARD INSTALLATION

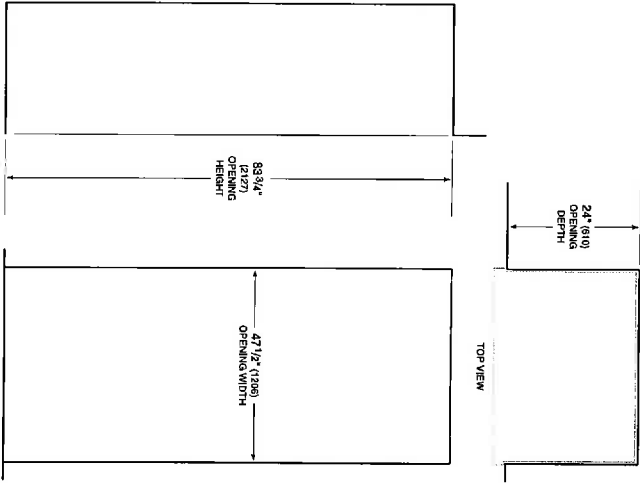

NOTE: Shaded line represents profile of unit.

24" STANDARD MICROWAVE OVEN



PRODUCT SPECIFICATIONS

Model	MS24
Weight	50 lb
Electrical Supply	120 VAC, 60 Hz
Electrical Service	15 amp dedicated circuit
Overall Capacity	2 cu ft
Power Cord Length	4 feet

ELECTRICAL

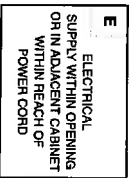

E

INSTALLATIONS WITH ACCESSORY TRIM

Accessory trim may affect overall product dimensions and opening dimensions. Refer to [Reveal](#) for more information.

DIMENSIONS

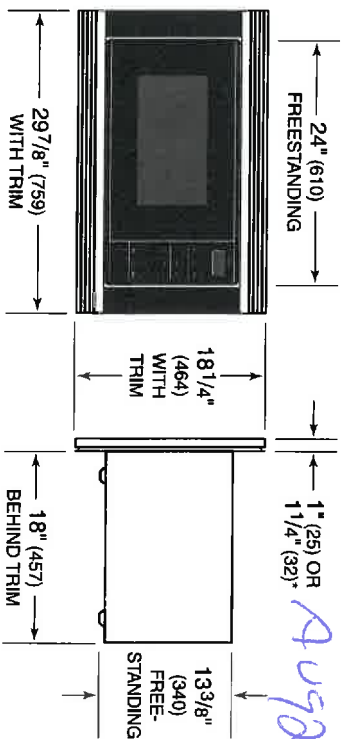

\*1" (25) for professional and transitional trim and 1 1/4" (32) for contemporary trim.

rw

24" STANDARD MICROWAVE OVEN



MS24

FEATURES

Gourmet mode cooks automatically from preset recipes

Quick-start controls for popular items

"Keep Warm" mode

Use freestanding or built into cabinetry

Sleek, black glass design

1200 watts of power

Rigorously tested in our U.S. manufacturing facilities for decades of use

Exceptional 24/7 support from our Customer Care team in Madison

Installs standard or flush inset

ACCESSORIES

Trim kits to match Wolf ovens

Accessories available through an authorized Sub-Zero dealer.  
For local dealer information, visit [subzero-wolf.com/locator](http://subzero-wolf.com/locator).

Lot 185

AUG26/16

YUL



TRIM OPTIONS

E SERIES STAINLESS



E SERIES BLACK



M SERIES STAINLESS



M SERIES BLACK





808744 - Wolf 30" (762) Microwave Trim Kit  
Installation Instructions

106185

⚠ WARNING

TO AVOID ELECTRICAL SHOCK, SHUT OFF POWER BEFORE BEGINNING INSTALLATION.

⚠ CAUTION

This kit includes metal parts that have sharp edges, handle with care to avoid possible injury.

**NOTE:** This Microwave trim kit is designed only for Wolf Microwave Ovens specifying 801527, 807056 or 808744 on rating label on the left side wall of oven cavity.

**NOTE:** Before beginning remove turn table from microwave cavity.

CONTAINS:	QTY	DESCRIPTION	QTY	DESCRIPTION
	1	Ductwork, MW24	4	Self Tapping Screw - #8-18x1/2
	2	Screw, #8-15x1/2 Truss Hd	1	Mtg Brkt, RT - MW
	1	Assembled Trim Kit	1	Mtg Brkt, LT - MW
	6	6-18x1 Tpg Screw Type A	1	Installation Instructions
	2	Trim, MW24 Polycarbonate		

The Wolf Microwave Trim Kit (MWTRIM/5) is used only with the Wolf Microwave Model MW24. This model can also be installed above a Wolf SO30.

The cabinet or wall opening must be the following dimensions:

Height: 17" (432)  
Width: 27-1/2" (699)  
Depth: 20" (508) min.

WJ

INSTALLATION PROCEDURE:

1. Locate properly grounded 3-prong receptacle 4" (102) from right side and 4" (102) up from bottom of microwave oven cabinet (See Cabinet Dimensions).

**NOTE:** You must have a properly grounded, 3-prong outlet installed by a qualified electrician. Do not use a GFCI outlet, as this may cause product operation interruptions.

2. The floor of the opening should be constructed of plywood strong enough to support weight of oven and floor load (about 100lbs./ 45 kg). The floor should be level for proper operation of oven.  
**NOTE:** Be sure to check local building code as it may require that the opening be enclosed with sides, ceiling and rear partition. The proper functioning of the oven does not require the enclosure.

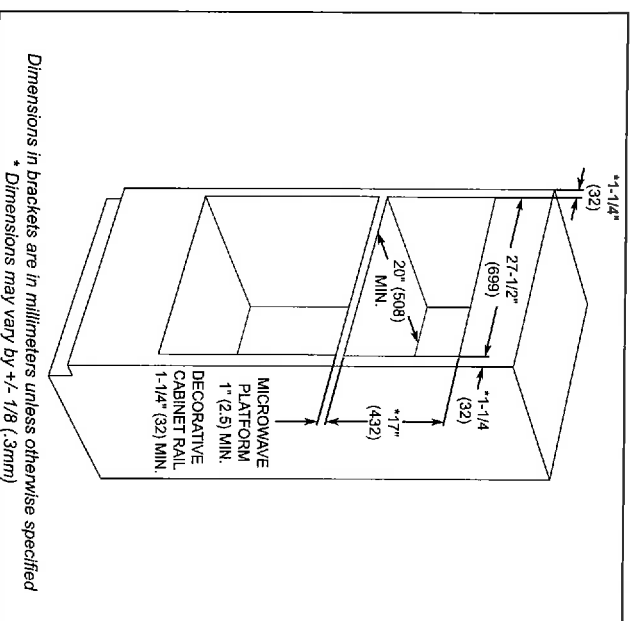

Cabinet Dimensions



10618-5

Aug 26/11

## 808744 - Wolf 30" (762) Microwave Trim Kit Installation Instructions

3. Locate mounting brackets. Pre-drill pilot holes before installing screws to avoid damage to cabinet or trim kit hardware. Attach mounting brackets with supplied screws, making sure brackets do not extend beyond front surface of cabinet (See Figure 1).
4. Center exhaust duct assembly in opening. When centered correctly, its flanges will be tightly against lower front edge of opening. Secure with mounting screws (See Figure 2).
5. Place oven adjacent to wall or cabinet opening, then plug power supply cord into electrical outlet.
6. Carefully guide oven into opening. Slide oven onto exhaust duct assembly.  
**NOTE: Avoid pinching power cord between oven and wall.**
7. Position frame assembly to be square with oven. Carefully place frame assembly on oven. Check that it is level (See Figure 3).
8. Secure frame assembly with mounting screws (See Figure 4).
9. Snap the polycarbonate trim pieces into place covering the screw holes.

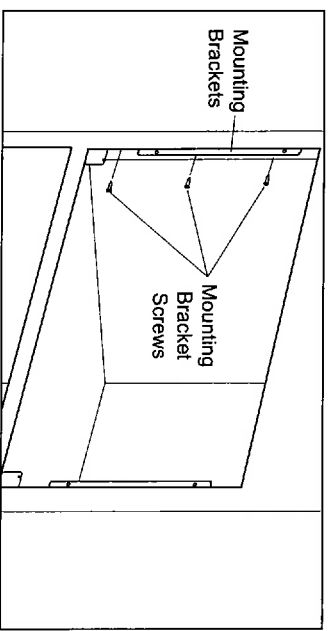

Figure 1. Mounting Brackets

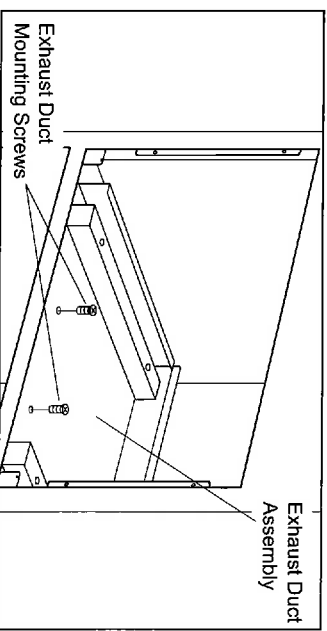

Figure 2. Exhaust Duct Assembly

W

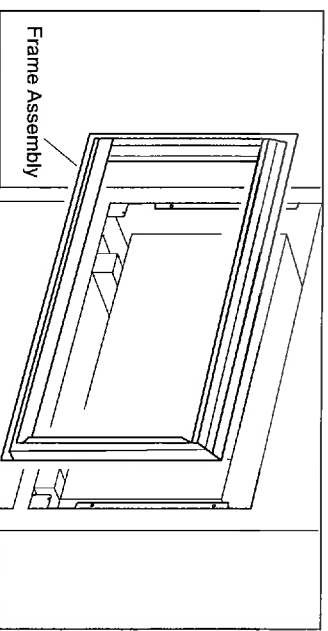

Figure 3. Frame Assembly

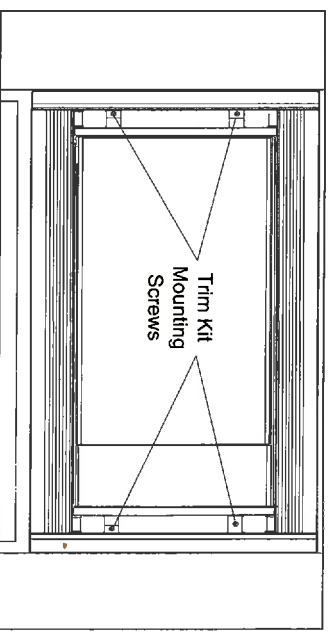

Figure 4. Trim Kit Screws



# WF42H5200AP

Samsung Front-Load Washer

Lot 18-5

4.8 cu. ft. Capacity IEC

## Features

- Steam Washing
- Smart Care™
- Self Clean+
- VRT® – Vibration Reduction Technology
- Diamond Drum® Design
- Direct Drive Motor
- 1200 rpm Maximum Spin Speed
- Internal Water Heater
- 9 Preset Wash Cycles
- 10 Options
- Garments!

Aug 26/16

## Convenience

- Child Lock
- Door Lock
- Dispenser Trays: Main Wash, Softener, Bleach



Smart Care



Self Clean+

**10** ENERGY STAR® rated:  
CEE Tier 3  
MEF: 3.20  
WCF: 2.90  
95 kWh/yr

Available Colour:



two

## Signature Features

### STEAM WASHING

- Powerful steam removes stains.
- No pre-treatment needed.

### SMART CARE

- Troubleshoot with your smartphone.
- Perform a quick diagnosis of your washer right from your smartphone.\*

\*Available on Google Play and the App Store.



Ranked "Highest in Customer Satisfaction with Clothes Washers" in 2013 & 2014 by J.D. Power and Associates.



Achieved the U.S. Environmental Protection Agency's 2014 ENERGY STAR® "Most Efficient" designation.

SAMSUNG

# WF42H5200AP

Samsung Front-Load Washer

1618-5

## Installing Options

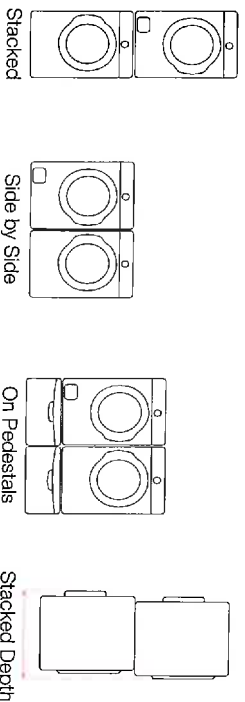

## Installing Your Washer

### 1. Alcove or closet installation

Minimum clearances for closet and alcove installations:

Sides - 1"  
Rear - 5 7/8"  
Top - 17"  
Closet Front - 2"

If the washer and dryer are installed together, the closet front must have at least a 72" unobstructed air opening. Your washer alone does not require a specific air opening.

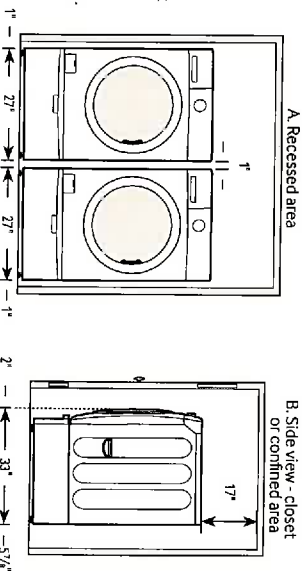

## Dimensions

### 2. With optional pedestal base or stacking kit

Required Dimensions for Installation with Pedestal

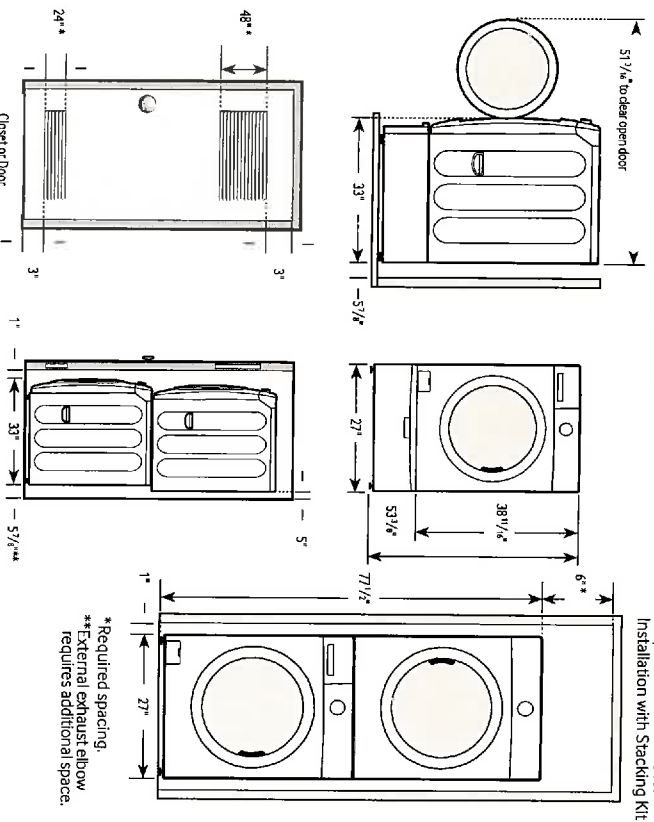

Required Dimensions for Installation with Stacking Kit

\*Required spacing.  
\*\*External exhaust elbow requires additional space.

4.8 cu. ft. Capacity IEC  
9 Preset Wash Cycles: Average 116

Normal, Heavy Duty, Permanent Press, Sanitize, Allergen, Bedding, Delicates, Quick Wash, Rinse and Spin

### 10 Options:

Steam, Self Clean+, Delay End, My Cycle, Extra Rinse, Extra Spin, Sound, Spin Only, Child Lock, Smart Care

### 4 Temperature Settings:

Hot, Warm, Eco Warm, Cold

### 4 Spin Settings:

High, Medium, Low, No Spin

### 3 Soil Settings:

Heavy, Normal, Light

### Dispenser Trays:

Main Wash, Softener, Bleach

### Warranty

One (1) Year Parts and Labour  
Two (2) Years Control Board  
Three (3) Years Stainless Steel Drum  
Ten (10) Years Direct Drive Motor

### Product Dimensions & Weight (WxHxD)

Dimensions: 27" x 38 1/2" x 33"

Weight: 194 lbs

### Shipping Dimensions & Weight (WxHxD)

Dimensions: 29 1/4" x 41 11/16" x 34 5/8"

Weight: 203 lbs

Colour	Model #	UPC Code
Platinum	WF42H5200AP	887276963082

Matching Dryer (Electric/Gas)	Model #	UPC Code
Platinum	DV42H52001P	887776957135

Platinum	Model #	UPC Code
	DV42H5200GP	887776963735

YUW

SAMSUNG

Actual colour may vary. Design specifications and colour availability are subject to change without notice. Non-metric weights and measurements are approximate. Minimum clearances are recommendations only. Samsung received the highest numerical score for front-load washers in the proprietary J.D. Power and Associates 2014 Laundry Appliance Satisfaction Study is based on more than 6,600 evaluations from customers who purchased clothes washers during the past 24 months. The study was fielded from January through March 2014. Your experiences may vary. Visit [jdpower.com](http://jdpower.com) for more information. The ENERGY STAR Most Efficient 2014 designation recognizes the most efficient products among those that qualify for the ENERGY STAR program. These exceptional clothes washers represent the leading edge in energy efficient products. © 2014 Samsung Electronics Canada Inc. All rights reserved. Samsung is a registered trademark of Samsung Electronics Co. Ltd. used with permission.

# D5436XLS

**Turbo Drying**

- Top tray for bowls and cutlery
- Upper basket type: Premium
- Lower basket type: Premium
- Separate removable basket
- Number of place settings: 16

**Top tray functions**

- InstantLift™ - smart height adjustment of the top tray
- Divisible and removable trays
- Rack for knives and utensils
- Rack for bowls and cups
- Telescopic rails

**Upper basket functions**

- Tight mesh base
- Multi position wine shelf left
- Multi position wine shelf right
- Fixed pin rows
- Fixed glass support
- Wide knife stand

**Lower basket functions**

- Foldable/divisible pin rows rear
- Separate removable basket

**Programs**

- Sanitization wash
- Normal wash
- Heavy wash
- Quick wash
- ECO wash

**Options**

- Delayed start

**Cleaning systems**

- Number of spray zones: 9
- Number of spray arms: 3
- WideClean™ - extra washing power for pots and pans
- SCS - Super Cleaning System™
- Aqua Level™ Sensor
- Stainless steel spray arms

**Drying system**

- Turbo Drying™

**Features**

- 8 stainless steel parts
- Time remaining indicator
- Voice signal for the end of washing cycle
- Hidden heater
- KidSafe - lockable controls

**Water safety**

- Few sealing points outside the container
- Long lasting steam welded tank
- Waterproof external base
- Exterior float
- Aqua Detect™ Sensor
- Aqua Level™ Sensor
- Stand-by water protection
- Yes
- Max time water intake
- Sound alarm
- Anti-block drain pump

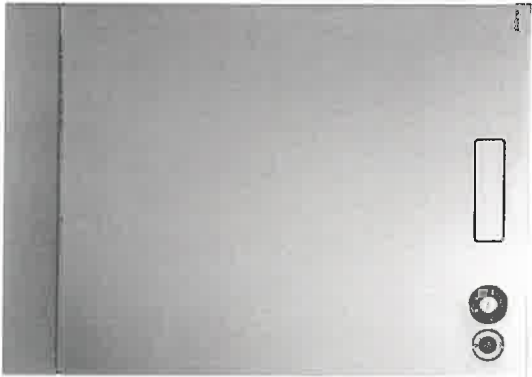

**Installation**

- Adjustable feet
- Multi fit outlet hose
- Fixed high loop outlet hose
- Trim kit

EAN code: 3838942042188  
code: 492231

**General**

- Product: Dishwasher
- Mode of installation: Built-in
- Size: XL (ADA height compliant)
- Touch Screen Display
- Number of programs: 7
- Noise level: 46 dB(A)
- Number of baskets: 3
- EAN code: 3838942042188

**Dimensions and installation**

- Height: 32 5/16 (820 mm)
- Width: 23 15/16 (608 mm)
- Depth: 22 7/8 (581 mm)
- Packaging height: 35 1/16 (890 mm)
- Packaging width: 25 5/16 (640 mm)
- Packaging depth: 26 3/4 (680 mm)
- Length electrical cord: 46 7/16 (1180 mm)
- Length inlet hose: 66 1/8 (1680 mm)
- Length outlet hose: 41 3/4 (1060 mm)
- Weight net: 101 lbs
- Weight gross: 109 lbs

**Technical information**

- Voltage: 120 V
- Current: 15 A

**Consumption**

- Energy consumption/cycle: 0.87 kWh

two

Lot 18-5

AUG 26/16

30" E SERIES TRANSITIONAL BUILT-IN SINGLE OVEN



SO30TE/S/TH



FEATURES

- 10 cooking modes make meals easy
- Three adjustable oven racks
- Cobalt blue porcelain interior
- Self clean, delayed start, timed cook, Sabbath mode and more
- Installs flush with surrounding cabinetry
- Dual convection oven for faster, more consistent cooking
- Temperature probe lets you know when it's done
- Rigorously tested in our U.S. manufacturing facilities for decades of use
- Exceptional 24/7 support from our Customer Care team in Madison
- Hidden bake element and recessed broil element

ACCESSORIES

- 30" baking sheet
- Bake stone kit (stone, rack and peel)
- Dehydration kit (racks and door stop)
- Full-extension easy glide oven rack
- Temperature probe and broiler pan
- Set of three standard oven racks

Accessories available through an authorized Sub-Zero dealer. For local dealer information, visit [subzero-wolf.com/locator](http://subzero-wolf.com/locator).



YU

30" E SERIES TRANSITIONAL BUILT-IN SINGLE OVEN



PRODUCT SPECIFICATIONS

Model	SO30TES/TH	
Dimensions	29 7/8"W x 27 7/8"H x 23 3/4"D	25"W x 16 1/2"H x 19"D
Oven 1 Interior Dimensions		
Overall Capacity	4.5 cu ft	
Usable Capacity	2.8 cu ft	
Door Clearance	22"	
Weight	273 lb	
Electrical Supply	240/208 VAC, 60 HZ	
Electrical Service	30 amp Dedicated circuit	
Conduit Length	4 feet	



WV

30 amp Dedicated circuit

4 feet

ELECTRICAL

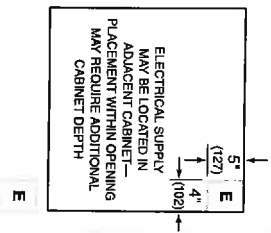

DIMENSIONS

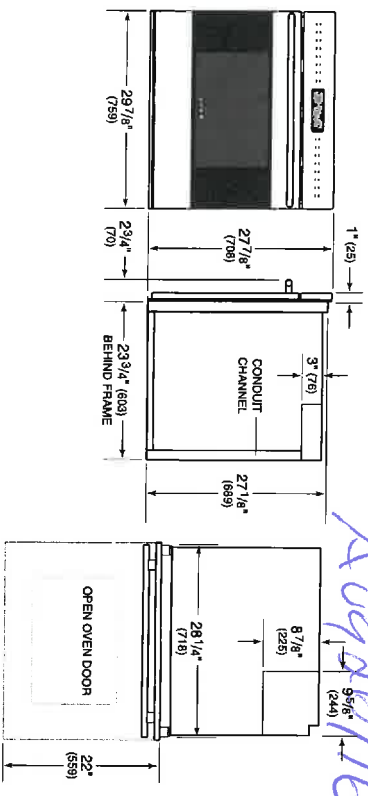

STANDARD INSTALLATION

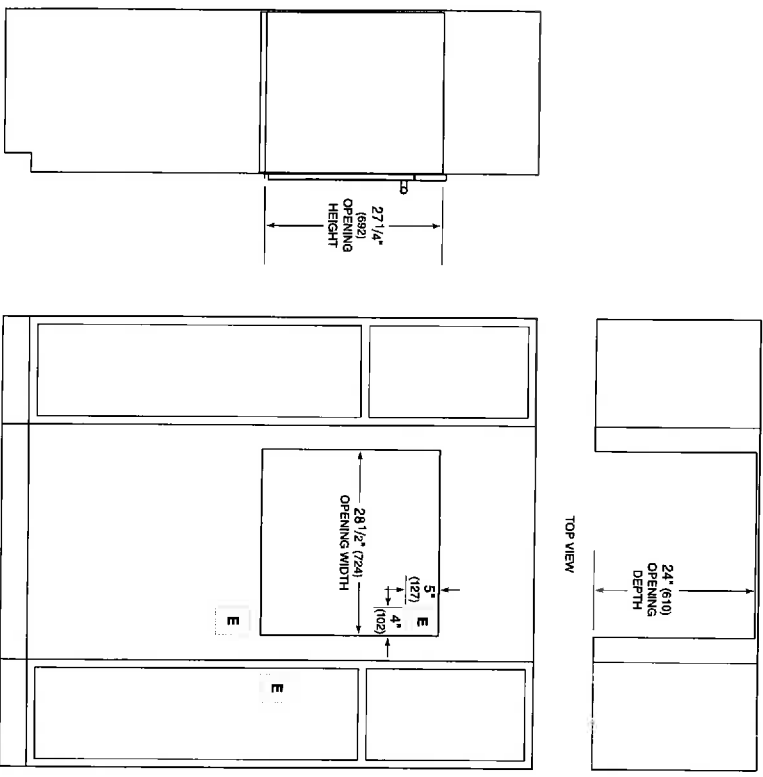

NOTE: Location of electrical supply within opening may require additional cabinet depth.

Open Galaxy S9 Key Visual  
Home->Consumer->Home Appliances->Washers & Dryers->Dryers->  
DV42H5200EW 7.5 cu.ft Electric Front-Load Dryer (White)

6618-5  
Aug 26/16  
Print-friendly  
WHERE TO BUY

DV42H5200EW/AC \$949.99 0 REVIEWS

- OVERVIEW
- FEATURES
- TECH SPECS
- GALLERY
- REVIEWS
- ACCESSORIES
- COMPATIBLE PRODUCTS

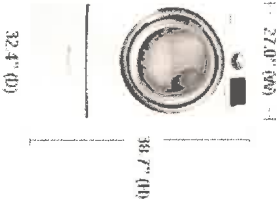

Bullet view

Table view

Features

- 7.5 cu.ft Capacity
- Smart Care available
- Door Trim available
- Interior Light available
- LED Display
- Powder Coat
- Door Safety available
- Filter Check Indicator available
- 4 Way
- Neat White exterior color
- Steam available

Cycles

- 11 drying cycles
- Air Fluff available
- Quick Dry Manual Dry available
- Time Dry available
- Bedding available
- Heavy Duty available
- Normal available
- Perm Press available
- Sanitize available
- Delicates available
- Refresh available
- Wrinkle Away available

Physical Specifications

- 27 x 39.7 x 32.4\" Net Dimension
- 57 kg Net Weight

Matching Washer Model

WF42H5100AW/A2

tw

Energy & Performance

- Electric
- 240 V
- 5300 W
- 42 min drying cycle time
- 3.01 lbs/kWh

Options & Settings

- Number of Options x 10 ea
- Mixed Load Bell available
- Wrinkle Prevent available
- Adjust Time available
- My Cycle available
- Child Lock available
- Signal On / Off available
- Drum Light available
- Smart Care available



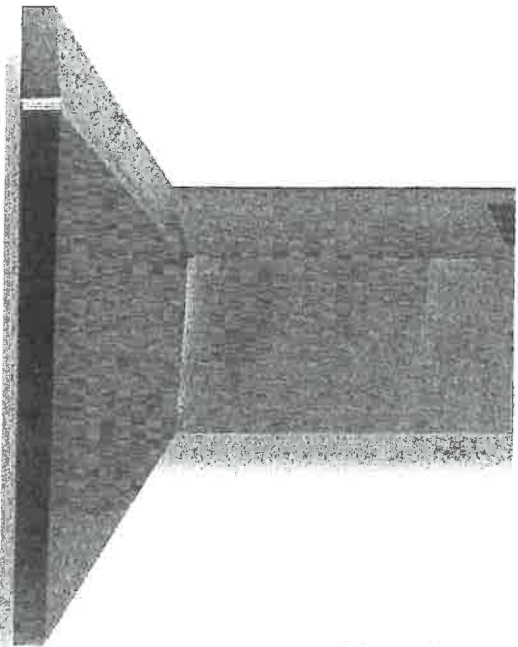

Lot 18-5

SU54  
SU54

Aug 26/11

## SU54

- SU54 36" 48" Motor: 2 x EBM 1100 cfm (Duct Size 8")
- ~~SU54 36" 48" Motor: 2 x EBM 600 cfm (Duct Size 6")~~
- Pressure: 800 Pa
- Noise level: 66 dBA/5.1 sones

### Lighting:

- 2x20W Halogen lamps in 30" version
- 2x20W Halogen lamps in 36" version
- 4x20W Halogen lamps in 48" version

- Control panel: 4 speed push-button + timer + light switch

- grease filter: commercial style baffle filters
- Stainless steel: AISI 430



YUJ

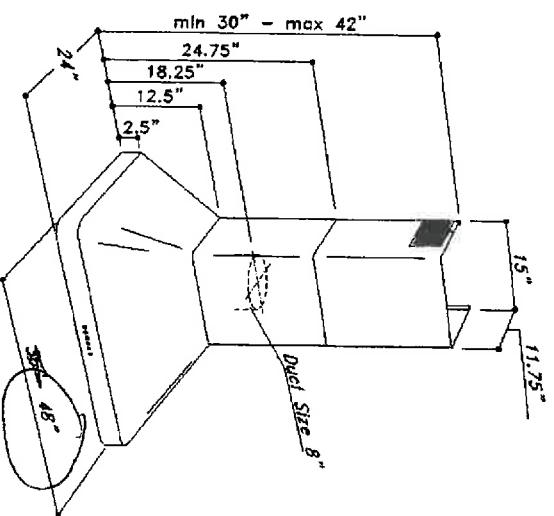
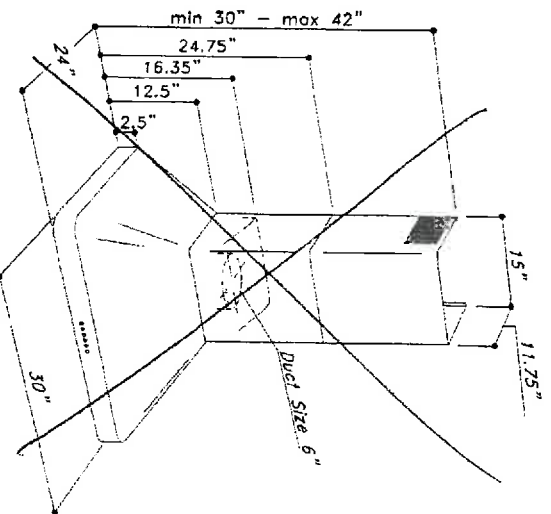

# Sirius

## 48" BUILT-IN SIDE-BY-SIDE REFRIGERATOR/FREEZER

SUB•ZERO

BI-48S/S

Lot 18-5 ★K

### FEATURES

Dual refrigeration keeps food fresher longer  
Air purification system fights spoilage, odors

Crispers and deli drawers in low-temp, high-humidity zones for optimum freshness

Microprocessor control assures peak performance

Water-filtration system reduces contaminants, chlorine taste and odor

Freshness cards for maximum food preservation

Rigorously tested in our U.S. manufacturing facilities to ensure at least 20 years of heavy use

Exceptional 24/7 support from our Customer Care team based in Madison, Wisconsin and just footsteps from our factory

"Soft bright" interior lighting

Magnetic door seal system locks in cold air

Automatic ice maker with "max ice" feature

Adjustable shelves for maximum convenience

### ACCESSORIES

Stainless steel kickplate

Grilles for 83" or 88" finished height (84" is standard)

Side panel mounting kit

Accessories are available through an authorized Sub-Zero dealer. For local dealer information, visit [subzero-wolf.com/locator](http://subzero-wolf.com/locator)



### HANDLE OPTIONS

PRO



TUBULAR



### PRODUCT DETAILS

#### REFRIGERATOR

- 4 Adjustable glass shelves
- 1 Stationary glass shelf
- 1 High-humidity drawer with divider
- 2 Storage drawers with divider
- 3 Adjustable door shelves
- 2 Stationary door shelves
- Adjustable dairy compartment

#### FREEZER

- 3 Adjustable wire shelves
- 1 Stationary solid shelf
- 3 Storage drawers
- 5 Adjustable door shelves
- Automatic ice maker

YUJ